

# PARK MODELS

Glendale Recreational Vehicles



# 2003 BUYER'S GUIDE

BUILDING QUALITY RECREATIONAL VEHICLES SINCE 1950

# BUYERS' GUIDE 2003

## Park Models



380 PA Rose decor scheme

380 PA spacious kitchen and breakfast bar area

## Park Model Specifications

MODEL	34C	390C	399C	340PA	356PA	364PA	380PA	382PA	391PA
<b>SLEEPS</b> (standard build)	4	4-7	4-8	4	4	4	4-8	4-8	4
<b>LENGTH</b> (overall including hitch)	34'	40'-2"	39'-4"	32'-5½"	35'-9"	35'-9"	39'-9½"	42'	39'-11"
<b>LENGTH</b> (hitch removed)	31'-7½"	38'-2½"	36'-10½"	29'-10"	33'-10"	33'-1½"	37'-5½"	39'-5½"	38'
<b>OVERALL EXTERIOR HEIGHT</b> (including all standard equipment)	10'-2"	11'-3"	11'-3"	12'-2"	12'-2"	12'-2"	12'-4"	12'-4"	12'-2"
<b>INTERIOR HEIGHT MEASUREMENTS</b> (floor to ceiling maximum)	82½"	94"	94"	94"	94"	94"	94"	94"	94"
<b>OVERALL SETUP WIDTH</b> (slide outs open)	10'-11"	11'-2½"	11'-2½"	12'	12'	12'	12'	14'-3"	11'-2½"
<b>MAIN BODY WIDTH</b>	96"	102"	102"	102"	102"	102"	102"	102"	102"
<b>INTERIOR WIDTH</b> (main body)	92½"	96"	96"	94"	94"	94"	94"	94"	94"
<b>RECOMMENED AWNING LENGTH</b> (To cover both front patio door and rear entry door.)	24'	24'	22'	22'	22'	24'	22'	22'	24'

# PARK MODEL

## 34C 2003 Cottager

by Glendale RV

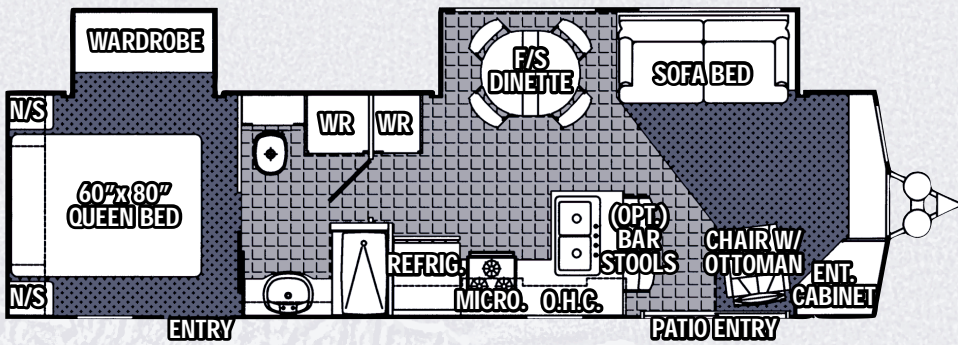

### CONSTRUCTION

**SIDEWALLS:** 2" x 2" sidewall framing. Thick fiberglass batt insulation blankets the sidewall structure. All framework is positioned at 16" O.C. construction standards. Aluminum exterior siding (.025" gauge) includes baked enamel smooth finish with built in U.V. shielding to provide years of high luster appearance and "easy clean" finish surface.

**ROOF:** Quiet, durable, and seamless rubber roof membrane is bonded to 3/8" oriented strand board. Full 5 1/2" tapered crown roof structure provides outstanding strength and superior water drainage. Tapered bow truss framing. Thick fiberglass batt insulation.

**FLOOR:** 5/8" tongue and groove plywood flooring. Screwed and glued to 2" x 3" main floor frame. Seamless Darco polyethylene moisture barrier between chassis and floor. Seam guard under vinyl floor coverings.

**CHASSIS:** 7" steel tube frame construction. Specially formulated chassis undercoating provides many years of corrosion and paint protection.

**SLIDE OUT SPECIFICATIONS:** "No step" flush floor design between main body and slide outs. "Maintenance free" slide out system self supports.

**INTERIOR CABINET DOORS:** Oak panel cabinet doors with brass hardware. T&G inter-locking cabinet door miters. Many cabinets feature center shelves for stacking convenience.

**WINDOWS:** "Awning Style" window openings provide "protected ventilation" in rainy weather. Opening the vent creates an awning, so the window can be opened for fresh air while channeling water outward from the vehicle wall. Screens are removable.

### APPLIANCES

**REFRIGERATOR:** Large double door residential style Fridgidaire 14.4 cubic foot capacity.

**RANGE:** *Wedgewood* H/O 21", 3 burner, piezo ignitor.

**FURNACE:** *Hydro-Flame* auto-ignition 35,000 BTU ducted in floor heat system.

**MICROWAVE OVEN:** *Dometic* 1.3 cubic foot with turntable.

**AIR CONDITIONER:** Ceiling is ducted for **OPTIONAL Dometic Briskair** 13,500 BTU air conditioner. Duct system is thermal insulated to prevent condensation build up, provide quiet operation, and to allow maximum efficiency of the optional air conditioner.

### ENTERTAINMENT

**STEREO:** AM/FM stereo and CD Player.

**TV HOOKUP:** Coax cable hookup in bedroom and living area.

### PLUMBING

**WATER HEATER:** *Atwood* fast recovery 10 gal. LP operation.

### HOLDING TANK CAPACITY:

Sewage Tank: 49 gal.

### ELECTRICAL

Exterior courtesy light and switch at patio door. Exterior and interior G.F.I circuits.

**HOOKUP:** 30 Amp.

### OTHER STANDARD FEATURES

Flush floor between slide outs and main floor of Park Model, oak finished free standing dinette, sofa bed, wire rack wardrobe shelving, 110V lighting, polished brass hardware, plush carpeting with premium underpad in livingroom and bedroom, detachable hitch assembly, sliding wardrobe doors, 2 x 30 lb. propane bottles, smoke detector, Ikea style chair, 60"x 80" orthopedic quality coil inner spring queen bed.

### OPTIONAL EQUIPMENT

Storm windows, TV Antenna with booster, house type toilet, 13,500 BTU roof mount air conditioner, A&E 24' aloe/white awning with center rafter, 2 bar stools.

All specifications subject to change without notice or obligation.



Selected floor plan layouts offer our "Optional Bar Stools"

34'	Overall Length
31'-7 1/2"	Overall Length with Hitch Removed
96"	Main Body Width
92 3/4"	Interior Width
10' 2"	Overall Height
82 3/4"	Interior Height
10' 11"	Overall Width with Slideouts Open

Go RVing  
Life's A Trip™

# PARK MODEL

## 390C 2003 Cottager

by Glendale RV

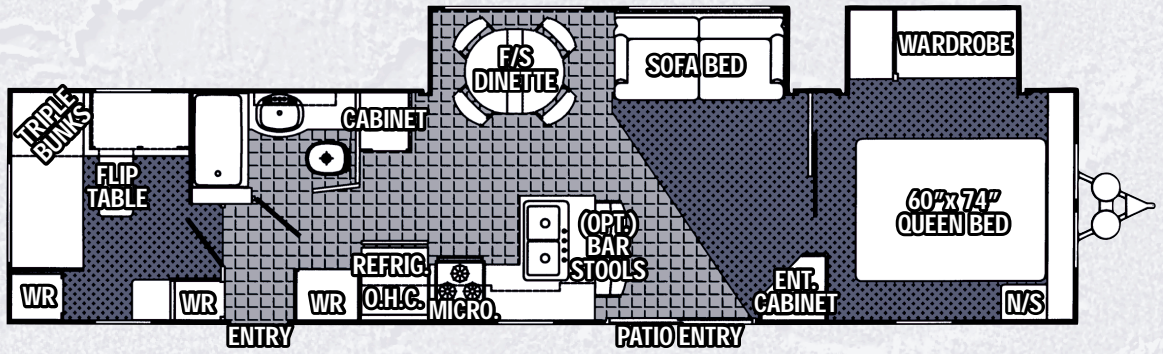

### CONSTRUCTION

**SIDEWALLS:** 2" x 2" sidewall framing. Thick fiberglass batt insulation blankets the sidewall structure. All framework is positioned at 16" O.C. construction standards. Aluminum exterior siding (.025" gauge) includes baked enamel smooth finish with built in U.V. shielding to provide years of high luster appearance and "easy clean" finish surface.

**ROOF:** Quiet, durable, and seamless rubber roof membrane is bonded to 3/8" oriented strand board. Full 5 1/2" tapered crown roof structure provides outstanding strength and superior water drainage. Tapered bow truss framing. Thick fiberglass batt insulation.

**FLOOR:** 5/8" tongue and groove plywood flooring. Screwed and glued to 2" x 4" main floor frame. Seamless Darco polyethylene moisture barrier between chassis and floor. Seam guard under vinyl floor coverings.

**CHASSIS:** 12" steel tube frame construction. Specially formulated chassis undercoating provides many years of corrosion and paint protection.

**SLIDE OUT SPECIFICATIONS:** "No step" flush floor design between main body and slide outs. "Maintenance free" slide out system self supports.

**INTERIOR CABINET DOORS:** Oak panel cabinet doors with brass hardware. T&G inter-locking cabinet door miters. Many cabinets feature center shelves for stacking convenience.

**WINDOWS:** "Awning Style" window openings provide "protected ventilation" in rainy weather. Opening the vent creates an awning, so the window can be opened for fresh air while channeling water outward from the vehicle wall. Screens are removable.

### APPLIANCES

**REFRIGERATOR:** Large double door residential style Fridgidaire 14.4 cubic foot capacity.

**RANGE:** *Wedgewood* H/O 21", 3 burner, piezo ignitor.

**FURNACE:** *Hydro-Flame* auto-ignition 40,000 BTU ducted in floor heat system.

**MICROWAVE OVEN:** *Dometic* 1.3 cubic foot with turntable.

**AIR CONDITIONER:** Ceiling is ducted for **OPTIONAL Dometic Briskair** 15,000 BTU air conditioner. Duct system is thermal insulated to prevent condensation build up, provide quiet operation, and to allow maximum efficiency of the optional air conditioner.

### ENTERTAINMENT

**STEREO:** AM/FM stereo and CD Player.

**TV HOOKUP:** Coax cable hookup in bedroom and living area.

### PLUMBING

**WATER HEATER:** *Atwood* fast recovery 10 gal. LP operation.

**HOLDING TANK CAPACITY:**

Sewage Tank: 49 gal.

### ELECTRICAL

Exterior courtesy light and switch at patio door. Exterior and interior G.F.I. circuits.

**HOOKUP:** 30 Amp.

### OTHER STANDARD FEATURES

Flush floor between slide outs and main floor of Park Model, oak finished free standing dinette, sofa bed, wire rack wardrobe shelving, smoke detector, 110V lighting, polished brass hardware, plush carpeting with premium underpad in livingroom and bedroom, detachable hitch assembly, sliding wardrobe doors, 2 x 30 lb. propane bottles, 60" x 74" orthopedic quality coil inner spring queen bed.

### OPTIONAL EQUIPMENT

2 bar stools, storm windows, TV antenna with booster, house type toilet, 15,000 BTU air conditioner, 24' aloe/white awning with center rafter.

### OPTIONAL REAR BEDROOM AREA

Gaucht/bunk floor plan available pre-production.

40'-2"  
Overall Length

38'-2½"  
Overall Length with  
Hitch Removed

102"  
Main Body Width

96"  
Interior Width

11' 3"  
Overall Height

94"  
Interior Height

11' 2½"  
Overall Width with  
Slideouts Open

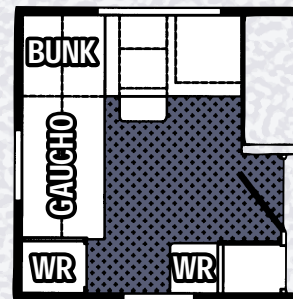

Go RVing  
Life's A Trip™

# PARK MODEL

## 399C 2003 Cottager

by Glendale RV

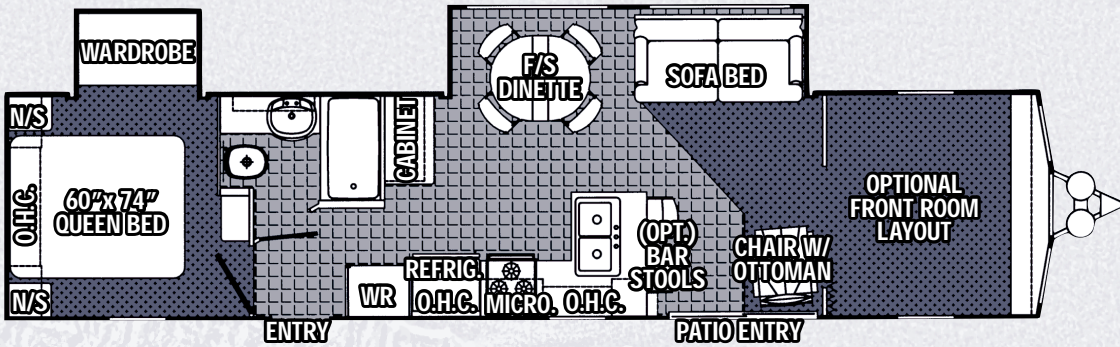

### CONSTRUCTION

**SIDEWALLS:** 2" x 2" sidewall framing. Thick fiberglass batt insulation blankets the sidewall structure. All framework is positioned at 16" O.C. construction standards. Aluminum exterior siding (.025" gauge) includes baked enamel smooth finish with built in U.V. shielding to provide years of high luster appearance and "easy clean" finish surface.

**ROOF:** Quiet, durable and seamless rubber roof membrane is bonded to 3/8" oriented strand board. Full 5 1/2" tapered crown roof structure provides outstanding strength and superior water drainage. Tapered bow truss framing. Thick fiberglass batt insulation.

**FLOOR:** 5/8" tongue and groove plywood flooring. Screwed and glued to 2" x 4" main floor frame. Seamless Darco polyethylene moisture barrier between chassis and floor. Seam guard under vinyl floor coverings.

**CHASSIS:** 12" steel tube frame construction. Specially formulated chassis undercoating provides many years of corrosion and paint protection.

**SLIDE OUT SPECIFICATIONS:** "No step" flush floor design between main body and slide outs. "Maintenance free" slide out system self supports.

**INTERIOR CABINET DOORS:** Oak panel cabinet doors with brass hardware. T&G inter-locking cabinet door miters. Many cabinets feature center shelves for stacking convenience.

**WINDOWS:** "Awning Style" window openings provide "protected ventilation" in rainy weather. Opening the vent creates an awning, so the window can be opened for fresh air while channeling water outward from the vehicle wall. Screens are removable.

### APPLIANCES

**REFRIGERATOR:** Large double door residential style Fridgidaire 14.4 cubic foot capacity.

**RANGE:** Wedgewood H/O 21", 3 burner, piezo ignitor.

**FURNACE:** Hydro-Flame auto-ignition 40,000 BTU ducted in floor heat system.

**MICROWAVE OVEN:** Dometic 1.3 cubic foot with turntable.

**AIR CONDITIONER:** Ceiling is ducted for OPTIONAL Dometic Briskair 15,000 BTU air conditioner. Duct system is thermal insulated to prevent condensation build up, provide quiet operation, and to allow maximum efficiency of the optional air conditioner.

### ENTERTAINMENT

**STEREO:** AM/FM stereo and CD Player.

**TV HOOKUP:** Coax cable hookup in bedroom and living area.

### PLUMBING

**WATER HEATER:** Atwood fast recovery 10 gal. LP/Electric operation.

**HOLDING TANK CAPACITY:**

Sewage Tank: 49 gal.

### ELECTRICAL

Exterior courtesy light and switch at patio door. Exterior and interior G.F.I circuits.

**HOOKUP:** 30 Amp.

### OTHER STANDARD FEATURES

Flush floors between slide outs and main floor of park model, wire rack wardrobe shelving, smoke detector, 110V lighting, polished brass hardware, plush carpeting with premium underpad in livingroom and bedroom, detachable hitch assembly, sliding wardrobe doors, 2 x 30 lb. propane bottles, Ikea style chair, 60" x 74" orthopedic quality coil inner spring queen bed, sofa bed.

### OPTIONAL EQUIPMENT

2 bar stools, storm windows, TV antenna with booster, house type toilet, 22' A&E aloe/white awning with center rafter, 15,000 BTU air conditioner, front room slideout.

#### OPTIONAL FRONT ROOM LAYOUTS

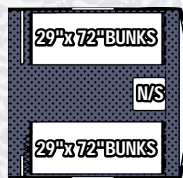

Front Room Bunks

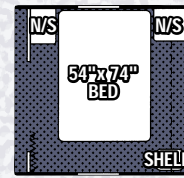

Front Bedroom



Front Bunk Room and Mini Dinette

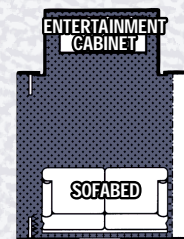

Front Den with Optional Slideout

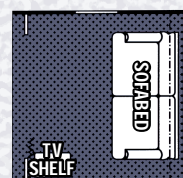

Front Den

39'-4"  
Overall Length

36'-10 1/2"  
Overall Length with Hitch Removed

102"  
Main Body Width

96"  
Interior Width

11' 3"  
Overall Height

94"  
Interior Height

11' 2 1/2"  
Overall Width with Slideouts Open

# PARK MODEL

## 340PA 2003 Park Model

by Glendale RV

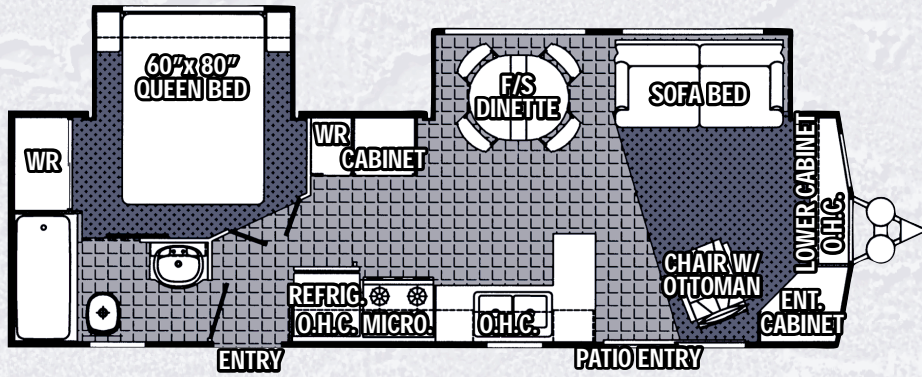

### CONSTRUCTION

**SIDEWALLS:** 2" x 3" sidewall framing. Thick fiberglass batt insulation blankets the sidewall structure. All framework is positioned at 16" O.C. construction standards. Aluminum exterior siding (.025" gauge) includes baked enamel smooth finish with built in U.V. shielding to provide years of high luster appearance and "easy clean" finish surface.

**ROOF:** Quiet, durable and seamless rubber roof membrane is bonded to 3/8" spruce plywood. Full 5 1/2" tapered crown roof structure provides outstanding strength and superior water drainage. Tapered bow truss framing. Thick fiberglass batt insulation.

**FLOOR:** 5/8" tongue and groove plywood flooring. Screwed and glued to 2" x 4" main floor frame. Seamless Darco polyethylene moisture barrier between chassis and floor. Seam guard under vinyl floor coverings.

**CHASSIS:** 7" steel tube frame construction. Specially formulated chassis undercoating provides many years of corrosion and paint protection.

**SLIDE OUT SPECIFICATIONS:** "No step" flush floor design between main body and slide outs. "Maintenance free" slide out system self supports.

**INTERIOR CABINET DOORS:** Raised panel oak cabinet doors with brass hardware. T&G inter-locking cabinet door miters. Many cabinets feature center shelves for stacking convenience. "Easy Glide" metal roller system on all drawers.

**WINDOWS:** "Awning Style" window openings provide "protected ventilation" in rainy weather. Opening the vent creates an awning, so the window can be opened for fresh air while channeling water outward from the vehicle walls. Screens are removable. Metal venetian blinds.

### APPLIANCES

**REFRIGERATOR:** Large double door residential style *Frigidaire* 16.5 cubic foot capacity.

**RANGE:** *Frigidaire* 30" free standing residential style range, white finish, white oven door.

**FURNACE:** *Hydro-Flame* auto-ignition 40,000 BTU ducted in floor heat system.

**MICROWAVE OVEN:** 30" 1.4 cubic foot *Frigidaire* microwave includes turntable, programmable, and built in range hood vent.

**AIR CONDITIONER:** *Dometic* 15,000 BTU thermal insulated ducted in ceiling cool air system.

### ENTERTAINMENT

**STEREO:** Programmable 3 disc CD plus AM/FM stereo and cassette.

**TV HOOKUP:** Coax cable hookup in bedroom and living area.

**TELEPHONE JACK:** 2 Std. equip.

**SATELLITE HOOK UP:** Park Model is pre-wired for quick dish connection.

### PLUMBING

Combination pull out style white single lever kitchen tap with rinse attachment. White polished fiberglass kitchen area double sink.

**WATER HEATER:** *Atwood* fast recovery 10 gal. LP/Electric operation.

**HOLDING TANK CAPACITY:**  
Sewage Tank: 49 gal.

### ELECTRICAL

Exterior courtesy light and switch at patio door. Exterior and interior G.F.I. circuits.

**HOOKUP:** 30 Amp.

### OTHER STANDARD FEATURES

Flush floors between slide outs and main floor of Park Model, wire rack wardrobe shelving, 110V lighting, polished brass hardware, plush carpeting with premium underpad in livingroom and bedroom, detachable hitch assembly, sliding wardrobe doors, 2 x 30 lb. propane bottles, chair with ottoman, 60"x 80" orthopedic quality coil inner spring queen bed.

### OPTIONAL EQUIPMENT

Storm windows, TV antenna with booster, house type toilet, day/night shades, ceiling fan, glass shower doors, central vacuum, wall-away recliner in place of chair with ottoman, A&E 22' aloe/white awning with center rafter.

32'-5 1/2"  
Overall Length

29'-10"  
Overall Length with  
Hitch Removed

102"  
Main Body Width

94"  
Interior Width

12' 2"  
Overall Height

94"  
Interior Height

12'  
Overall Width with  
Slideouts Open



The best in brand name reliability shown here are: *Frigidaire* 16.5 Cu. ft. freezer, *Frigidaire* 30" microwave and *Frigidaire* 30" range.

# PARK MODEL

## 356PA 2003 Park Model

by Glendale RV

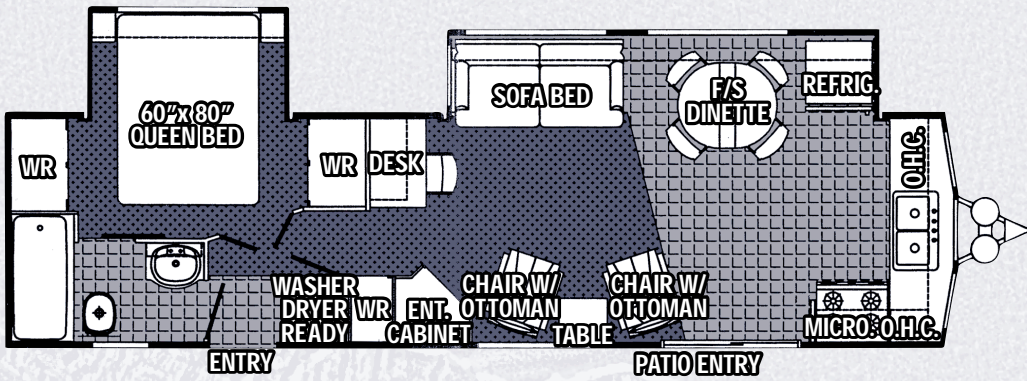

### CONSTRUCTION

**SIDEWALLS:** 2" x 3" sidewall framing. Thick fiberglass batt insulation blankets the sidewall structure. All framework is positioned at 16" O.C. construction standards. Aluminum exterior siding (.025" gauge) includes baked enamel smooth finish with built in U.V. shielding to provide years of high luster appearance and "easy clean" finish surface.

**ROOF:** Quiet, durable and seamless rubber roof membrane is bonded to 3/8" spruce plywood. Full 5 1/2" tapered crown roof structure provides outstanding strength and superior water drainage. Tapered bow truss framing. Thick fiberglass batt insulation.

**FLOOR:** 5/8" tongue and groove plywood flooring. Screwed and glued to 2" x 4" main floor frame. Seamless Darco polyethylene moisture barrier between chassis and floor. Seam guard under vinyl floor coverings.

**CHASSIS:** 12" steel tube frame construction. Specially formulated chassis undercoating provides many years of corrosion and paint protection.

**SLIDE OUT SPECIFICATIONS:** "No step" flush floor design between main body and slide outs. "Maintenance free" slide out system self supports.

**INTERIOR CABINET DOORS:** Raised panel oak cabinet doors with brass hardware. T&G inter-locking cabinet door miters. Many cabinets feature center shelves for stacking convenience. "Easy Glide" metal roller system on all drawers.

**WINDOWS:** "Awning Style" window openings provide "protected ventilation" in rainy weather. Opening the vent creates an awning, so the window can be opened for fresh air while channeling water outward from the vehicle walls. Screens are removable. Metal venetian blinds.

### APPLIANCES

**REFRIGERATOR:** Large double door residential style Frigidaire 16.5 cubic foot capacity.

**RANGE:** Frigidaire 30" free standing residential style range, white finish, white oven door.

**FURNACE:** Hydro-Flame auto-ignition 40,000 BTU ducted in floor heat system.

**MICROWAVE OVEN:** 30" 1.4 cubic foot Frigidaire microwave includes turntable, programmable, and built in range hood vent.

**AIR CONDITIONER:** Dometic 15,000 BTU thermal insulated ducted in ceiling cool air system.

### ENTERTAINMENT

**STEREO:** Programmable 3 disc CD plus AM/FM stereo.

**TV HOOKUP:** Coax cable hookup in bedroom and living area.

**TELEPHONE JACK:** 2 Std. equip.

**SATELLITE HOOK UP:** Park Model is pre-wired for quick dish connection.

### PLUMBING

Combination pull out style white single lever kitchen tap with rinse attachment. White polished fiberglass kitchen area double sink.

**WATER HEATER:** Atwood fast recovery 10 gal. LP/Electric operation.

**HOLDING TANK CAPACITY:**

Sewage Tank: 49 gal.

### ELECTRICAL

Exterior courtesy light and switch at patio door. Exterior and interior G.F.I circuits

**HOOKUP:** 30 Amp.

### OTHER STANDARD FEATURES

Flush floors between slide outs and main floor of Park Model, wire rack wardrobe shelving, 110V lighting, polished brass hardware, plush carpeting with premium underpad in livingroom and bedroom, detachable hitch assembly, sliding wardrobe doors, 2 x 30 lb. propane bottles, 2 chairs with ottoman, 60"x 80" orthopedic quality coil inner spring queen bed, washer/dryer ready, sofa bed, desk chair.

### OPTIONAL EQUIPMENT

\*Electric fireplace insert, storm windows, TV antenna with booster, house type toilet, day/night shades, ceiling fan, glass shower doors, central vacuum, 2 wall-away recliners in place of chairs with ottomans, A&E 22' aloe/white awning with center rafter.

### WASHER/DRYER READY



Many park models include pre-wiring and plumbing for washer/dryer installations.

(Washer/dryer appliances not available from Glendale RV)

**35'-9"**  
Overall Length

**33'-10"**  
Overall Length with  
Hitch Removed

**102"**  
Main Body Width

**94"**  
Interior Width

**12' 2"**  
Overall Height

**94"**  
Interior Height

**12'**  
Overall Width with  
Slideouts Open

# PARK MODEL

## 364PA 2003 Park Model

by Glendale RV

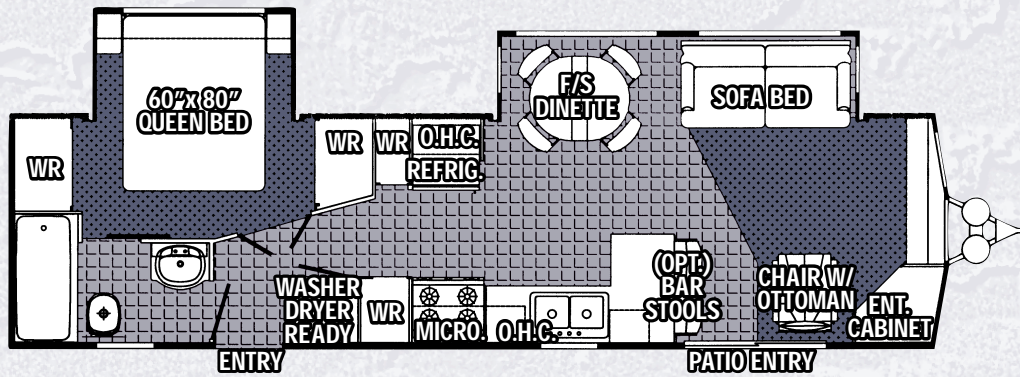

### CONSTRUCTION

**SIDEWALLS:** 2" x 3" sidewall framing. Thick fiberglass batt insulation blankets the sidewall structure. All framework is positioned at 16" O.C. construction standards. Aluminum exterior siding (.025" gauge) includes baked enamel smooth finish with built in U.V. shielding to provide years of high luster appearance and "easy clean" finish surface.

**ROOF:** Quiet, durable, and seamless rubber roof membrane is bonded to 3/8" spruce plywood. Full 5 1/2" tapered crown roof structure provides outstanding strength and superior water drainage. Tapered bow truss framing. Thick fiberglass batt insulation.

**FLOOR:** 5/8" tongue and groove plywood flooring. Screwed and glued to 2" x 4" main floor frame. Seamless Darco polyethylene moisture barrier between chassis and floor. Seam guard under vinyl floor coverings.

**CHASSIS:** 12" steel tube frame construction. Specially formulated chassis undercoating provides many years of corrosion and paint protection.

**SLIDE OUT SPECIFICATIONS:** "No step" flush floor design between main body and slide outs. "Maintenance free" slide out system self supports.

**INTERIOR CABINET DOORS:** Raised panel oak cabinet doors with brass hardware. T&G inter-locking cabinet door miters. Many cabinets feature center shelves for stacking convenience. "Easy Glide" metal roller system on all drawers.

**WINDOWS:** "Awning Style" window openings provide "protected ventilation" in rainy weather. Opening the vent creates an awning, so the window can be opened for fresh air while channeling water outward from the vehicle walls. Screens are removable. Metal venetian blinds.

### APPLIANCES

**REFRIGERATOR:** Large double door residential style Frigidaire 16.5 cubic foot capacity.

**RANGE:** Frigidaire 30" free standing residential style range, white finish, white oven door.

**FURNACE:** *Hydro-Flame* auto-ignition 40,000 BTU ducted in floor heat system.

**MICROWAVE OVEN:** 30" 1.4 cubic foot Frigidaire microwave includes turntable, programmable, and built in range hood vent.

**AIR CONDITIONER:** Dometic 15,000 BTU thermal insulated ducted in ceiling cool air system.

### ENTERTAINMENT

**STEREO:** Programmable 3 disc CD plus AM/FM stereo.

**TV HOOKUP:** Coax cable hookup in bedroom and living area.

**TELEPHONE JACK:** 2 Std. equip.

**SATELLITE HOOK UP:** Park Model is pre-wired for quick dish connection.

### PLUMBING

Combination pull out style white single lever kitchen tap with rinse attachment. White polished fiberglass kitchen area double sink.

**WATER HEATER:** *Atwood* fast recovery 10 gal. LP/Electric operation.

**HOLDING TANK CAPACITY:**

Sewage Tank: 49 gal.

### ELECTRICAL

Exterior courtesy light and switch at patio door. Exterior and interior G.F.I. circuits.

**HOOKUP:** 30 Amp.

### OTHER STANDARD FEATURES

Flush floor between slide outs and main floor of park model, oak finished free standing dinette includes table top surface extension, sofa bed, wire rack wardrobe shelving, 110V lighting, polished brass hardware, plush carpeting with premium underpad in livingroom and bedroom, detachable hitch assembly, sliding wardrobe doors, 2 x 30 lb. propane bottles, chair with ottoman, 60" x 80" orthopedic quality coil inner spring queen bed, washer/dryer ready.

### OPTIONAL EQUIPMENT

Electric fireplace insert, bar stools, storm windows, TV antenna with booster, house type toilet, day/night shades, ceiling fan, glass shower doors, central vacuum, wall-away recliner in place of chair with ottoman.

### Pre-Production Optional Floor Plan

Desk area and desk chair in place of chair with ottoman.



35'-9"  
Overall Length

33'-1 3/4"  
Overall Length with  
Hitch Removed

102"  
Main Body Width

94"  
Interior Width

12' 2"  
Overall Height

94"  
Interior Height

12'  
Overall Width with  
Slideouts Open



# PARK MODEL

# 380PA

2003 Park Model  
by Glendale RV

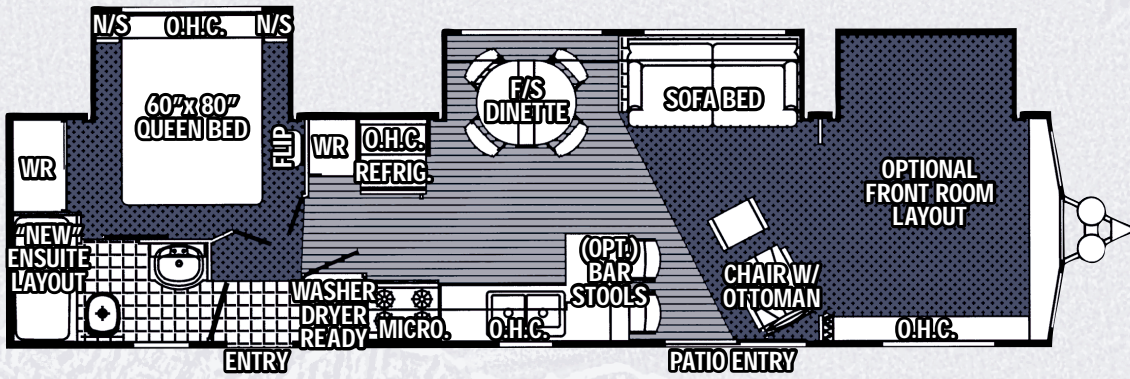

## CONSTRUCTION

**SIDEWALLS:** 2" x 3" sidewall framing. Thick fiberglass batt insulation blankets the sidewall structure. All framework is positioned at 16" O.C. construction standards. Aluminum exterior siding (.025" gauge) includes baked enamel smooth finish with built in U.V. shielding to provide years of high luster appearance and "easy clean" finish surface.

**ROOF:** Quiet, durable, and seamless rubber roof membrane is bonded to 3/8" spruce plywood. Full 5 1/2" tapered crown roof structure provides outstanding strength and superior water drainage. Tapered bow truss framing. Thick fiberglass batt insulation.

**FLOOR:** 5/8" tongue and groove plywood flooring. Screwed and glued to 2" x 4" main floor frame. Seamless Darco polyethylene moisture barrier between chassis and floor. Seam guard under vinyl floor coverings.

**CHASSIS:** 12" steel tube frame construction. Specially formulated chassis undercoating provides many years of corrosion and paint protection.

**SLIDE OUT SPECIFICATIONS:** "No step" flush floor design between main body and slide outs. "Maintenance free" slide out system self supports.

**INTERIOR CABINET DOORS:** Raised panel oak cabinet doors with brass hardware. T&G inter-locking cabinet door miters. Many cabinets feature center shelves for stacking convenience. "Easy Glide" metal roller system on all drawers.

**WINDOWS:** "Awning Style" window openings provide "protected ventilation" in rainy weather. Opening the vent creates an awning, so the window can be opened for fresh air while channeling water outward from the vehicle walls. Screens are removable. Metal venetian blinds.

## APPLIANCES

**REFRIGERATOR:** Large double door residential style Frigidaire 16.5 cubic foot capacity.

**RANGE:** Frigidaire 30" free standing residential style range, white finish, white oven door.

**FURNACE:** Hydro-Flame auto-ignition 40,000 BTU ducted in floor heat system.

**MICROWAVE OVEN:** 30" Frigidaire microwave includes turntable, programmable, and built in range hood vent.

**AIR CONDITIONER:** Dometic 15,000 BTU thermal insulated ducted in ceiling cool air system.

## ENTERTAINMENT

**STEREO:** Sanyo programmable 3 disc CD plus AM/FM stereo.

**TV HOOKUP:** Coax cable hookup in bedroom and living area.

**TELEPHONE JACK:** 3 Std. equip.

**SATELLITE HOOK UP:** Park Model is pre-wired for quick dish connection.

## PLUMBING

Combination pull out style white single lever kitchen tap with rinse attachment. White polished fiberglass kitchen area double sink.

**WATER HEATER:** Atwood fast recovery 10 gal. LP/Electric operation.

**HOLDING TANK CAPACITY:**

Sewage Tank: 49 gal.

## ELECTRICAL

Exterior courtesy light and switch at patio door. Exterior and interior G.F.I circuits.

**HOOKUP:** 30 Amp.

## OTHER STANDARD FEATURES

The 380PA features oak flooring in the galley area and wainscoting in the main area.

Flush floors between slide outs and main floor of park model, wire rack wardrobe shelving, 110V lighting, polished brass hardware, plush carpeting with premium underpad in livingroom and bedroom, detachable hitch assembly, sliding wardrobe doors, 2 x 30 lb. propane bottles, chair with ottoman, 60"x 80" orthopedic quality coil inner spring queen bed, washer/dryer ready, sofa bed, 15,000 BTU air conditioner.

## OPTIONAL EQUIPMENT

Electric fireplace insert, bar stools, storm windows, TV antenna with booster, house type toilet, day/night shades, ceiling fan, central vacuum, wall-away recliner in place of chair with ottoman, 22' A&E aloe/white awning with center rafter.

### OPTIONAL FRONT ROOM LAYOUTS



Front Dinette & Bunks

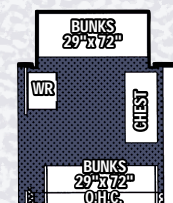

Front Bunk Room

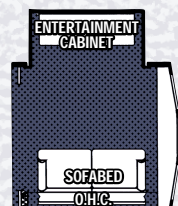

Front Den



Front Bed

39'-9 1/2"  
Overall Length

37'-5 1/2"  
Overall Length with  
Hitch Removed

102"  
Main Body Width

94"  
Interior Width

12' 4"  
Overall Height

94"  
Interior Height

12'  
Overall Width with  
Slideouts Open

# PARK MODEL 391PA 2003 Park Model by Glendale RV

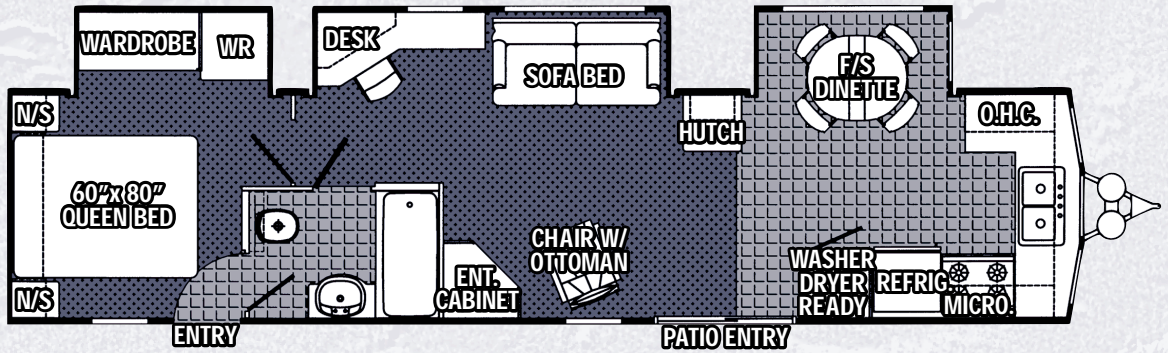

## CONSTRUCTION

**SIDEWALLS:** 2" x 3" sidewall framing. Thick fiberglass batt insulation blankets the sidewall structure. All framework is positioned at 16" O.C. construction standards. Aluminum exterior siding (.025" gauge) includes baked enamel smooth finish with built in U.V. shielding to provide years of high luster appearance and "easy clean" finish surface.

**ROOF:** Quiet, durable, and seamless rubber roof membrane is bonded to 3/8" spruce plywood. Full 5 1/2" tapered crown roof structure provides outstanding strength and superior water drainage. Tapered bow truss framing. Thick fiberglass batt insulation.

**FLOOR:** 5/8" tongue and groove plywood flooring. Screwed and glued to 2" x 4" main floor frame. Seamless Darco polyethylene moisture barrier between chassis and floor. Seam guard under vinyl floor coverings.

**CHASSIS:** 12" steel tube frame construction. Specially formulated chassis undercoating provides many years of corrosion and paint protection.

**SLIDE OUT SPECIFICATIONS:** "No step" flush floor design between main body and slide outs. "Maintenance free" slide out system self supports.

**INTERIOR CABINET DOORS:** Raised panel oak cabinet doors with brass hardware. T&G inter-locking cabinet door miters. Many cabinets feature center shelves for stacking convenience. "Easy Glide" metal roller system on all drawers.

**WINDOWS:** "Awning Style" window openings provide "protected ventilation" in rainy weather. Opening the vent creates an awning, so the window can be opened for fresh air while channeling water outward from the vehicle walls. Screens are removable. Metal venetian blinds.

## APPLIANCES

**REFRIGERATOR:** Large double door residential style Frigidaire 16.5 cubic foot capacity.

**RANGE:** Frigidaire 30" free standing residential style range, white finish, white oven door.

**FURNACE:** Hydro-Flame auto-ignition 40,000 BTU ducted in floor heat system.

**MICROWAVE OVEN:** 30" 1.4 cubic foot Frigidaire microwave includes turntable, programmable, and built in range hood vent.

**AIR CONDITIONER:** Dometic 15,000 BTU thermal insulated ducted in ceiling cool air system.

## ENTERTAINMENT

**STEREO:** Programmable 3 disc CD plus AM/FM stereo.

**TV HOOKUP:** Coax cable hookup in bedroom and living area.

**TELEPHONE JACK:** 3 Std. equip.

**SATELLITE HOOK UP:** Park Model is pre-wired for quick dish connection.

## PLUMBING

Combination pull out style white single lever kitchen tap with rinse attachment. White polished fiberglass kitchen area double sink.

**WATER HEATER:** Atwood fast recovery 10 gal. LP/Electric operation.

**HOLDING TANK CAPACITY:**  
Sewage Tank: 49 gal.

## ELECTRICAL

Exterior courtesy light and switch at patio door. Exterior and interior G.F.I. circuits

**HOOKUP:** 30 Amp.

## OTHER STANDARD FEATURES

Flush floor between slide outs and main floor of park model, oak finished free standing dinette includes table top surface extension, sofa bed, living area desk, wire rack wardrobe shelving, 110V lighting, polished brass hardware, plush carpeting with premium underpad in livingroom and bedroom, detachable hitch assembly, sliding wardrobe doors, 2 x 30 lb. propane bottles, chair with ottoman, 60"x 80" orthopedic quality coil inner spring queen bed, desk chair, washer/dryer ready.

## OPTIONAL EQUIPMENT

Electric fireplace insert, Storm windows, TV antenna with booster, house type toilet, day/night shades, ceiling fan, glass shower doors, central vacuum, wall-away recliner in place of chair with ottoman, 24' aloe/white awning with center rafter.



All Park Avenue series oak free-standing dinettes include centre leaf insert.

39'-11"  
Overall Length

38'  
Overall Length with  
Hitch Removed

102"  
Main Body Width

94"  
Interior Width

12' 2"  
Overall Height

94"  
Interior Height

11'-2 1/2"  
Overall Width with  
Slideouts Open

# PARK MODEL

## 382PA 2003 Park Model

by Glendale RV

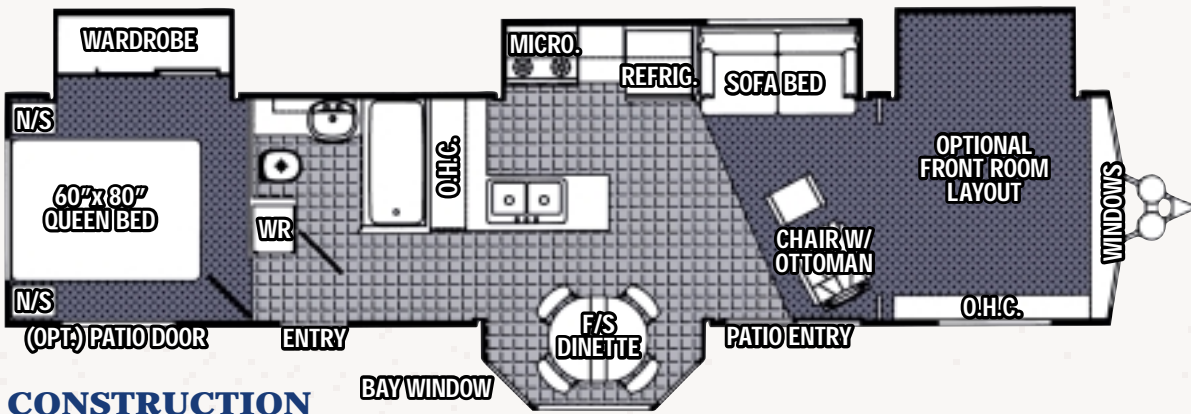

### CONSTRUCTION

**SIDEWALLS:** 2" x 3" sidewall framing. Thick fiberglass batt insulation blankets the sidewall structure. All framework is positioned at 16" O.C. construction standards. Aluminum exterior siding (.025" gauge) includes baked enamel smooth finish with built in U.V. shielding to provide years of high luster appearance and "easy clean" finish surface.

**ROOF:** Quiet, durable, and seamless rubber roof membrane is bonded to 3/8" spruce plywood. Full 5 1/2" tapered crown roof structure provides outstanding strength and superior water drainage. Tapered bow truss framing. Thick fiberglass batt insulation.

**FLOOR:** 5/8" tongue and groove plywood flooring. Screwed and glued to 2" x 4" main floor frame. Seamless Darco polyethylene moisture barrier between chassis and floor. Seam guard under vinyl floor coverings.

**CHASSIS:** 12" steel tube frame construction. Specially formulated chassis undercoating provides many years of corrosion and paint protection.

**SLIDE OUT SPECIFICATIONS:** "No step" flush floor design between main body and slide outs. "Maintenance free" slide out system self supports.

**INTERIOR CABINET DOORS:** Raised panel oak cabinet doors with brass hardware. T&G inter-locking cabinet door miters. Many cabinets feature center shelves for stacking convenience. "Easy Glide" metal roller system on all drawers.

**WINDOWS:** "Awning Style" window openings provide "protected ventilation" in rainy weather. Opening the vent creates an awning, so the window can be opened for fresh air while channeling water outward from the vehicle walls. Screens are removable. Metal venetian blinds.

### APPLIANCES

**REFRIGERATOR:** Large double door residential style Frigidaire 16.5 cubic foot capacity.

**RANGE:** Frigidaire 30" free standing residential style range, white finish, white oven door.

**FURNACE:** Hydro-Flame auto-ignition 40,000 BTU ducted in floor heat system.

**MICROWAVE OVEN:** 30" Frigidaire microwave includes turntable, programmable, and built in range hood vent.

**AIR CONDITIONER:** Dometic 15,000 BTU thermal insulated ducted in ceiling cool air system.

### ENTERTAINMENT

**STEREO:** Programmable 3 disc CD plus AM/FM stereo.

**TV HOOKUP:** Coax cable hookup in bedroom and living area.

**TELEPHONE JACK:** 3 Std. equip.

**SATELLITE HOOK UP:** Park Model is pre-wired for quick dish connection.

### PLUMBING

White Double Fiberglass style kitchen sink with rinse attachment. Single white lever faucet, tub and surround.

**WATER HEATER:** Atwood fast recovery 10 gal. LP/Electric operation.

**HOLDING TANK CAPACITY:**

Sewage Tank: 49 gal

### ELECTRICAL

Exterior courtesy light and switch at patio door. Exterior and interior G.F.I circuits.

HOOKUP: 30 Amp

### OTHER STANDARD FEATURES

Flush floors between slide outs and main floor of Park Model, wire rack wardrobe shelving, 110V lighting, polished brass hardware, plush carpeting with premium underpad in livingroom and bedroom, detachable hitch assembly, sliding wardrobe doors, 2 x 30 lb. propane bottles, chair with ottoman, 60" x 80" orthopedic quality coil inner spring queen bed, sofa bed.

### OPTIONAL EQUIPMENT

\*Electric fireplace insert, oak flooring, storm windows, TV antenna with booster, house type toilet, day/night shades, ceiling fan, glass shower doors, central vacuum, wall-away recliner in place of chair with ottoman, bedroom patio door, 22' A&E aloe/white awning with center rafter.

### NEW OPTIONAL ROOM LAYOUTS

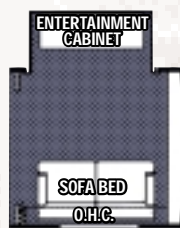

Front Den Model

\*Opt. Fireplace insert can be installed into Den area Entertainment Cabinet



Front Double Bed



Front Mini-Dinette and Bunks



Front Bunk Room

### Optional Vanity Slideout

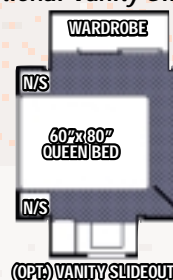

(OPT) VANITY SLIDEOUT

42'  
Overall Length

39'-5 1/2"  
Overall Length with Hitch Removed

102"  
Main Body Width

94"  
Interior Width

12' 4"  
Overall Height

94"  
Interior Height

14'-3"  
Overall Width with Slideouts Open

YEAR LIMITED  
**3** STRUCTURE  
WARRANTY

Please be sure to visit our web site  
[www.glendalerv.com](http://www.glendalerv.com)

You can travel with confidence knowing that Glendale provides specific structural warranty coverage for a period of 3 years. All of our warranty commitments are valid in both Canada and the United States. All appliances are "NAME BRAND" highly regarded products. See dealer for complete warranty details.



*382 PA Bay Window area in our blue decor scheme*

*Dealer:*

**GLENDALER V**



Glendale Recreational Vehicles  
145 Queen Street  
Strathroy, Ontario N7G 3J6