



FLAIR-Floor Plans, Standard Features and Options



Flair



FLAIR-Class A Gas-2006



Floor Plans

* Sleeping accommodations are based on designed sleeping areas and may be greater than Sleeping Capacity Weight Rating (SCWR) found on the Cargo Carrying Capacity label located in each RV. Sleeping accommodations are based on standard layout. Optional furniture may increase or decrease sleeping accommodations.

31A

Double Slide-Out

Sleeping Accommodations: 4*

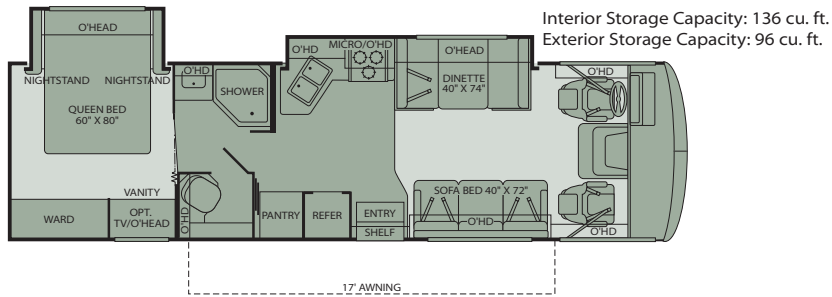

33R

Double Slide-Out

Sleeping Accommodations: 4*

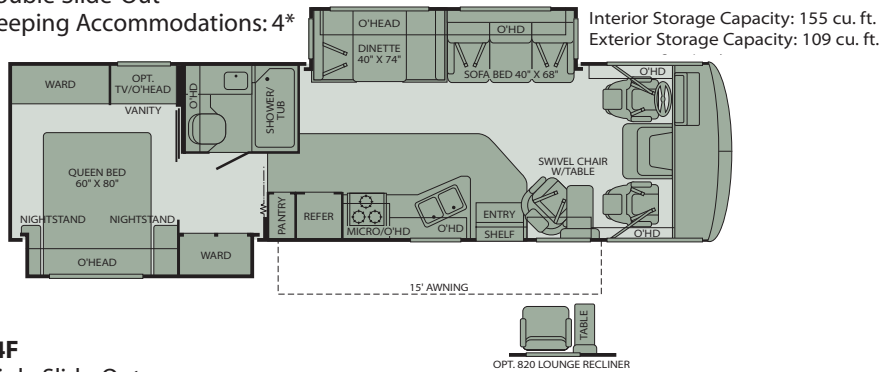

34F

Triple Slide-Out

Sleeping Accommodations: 4*

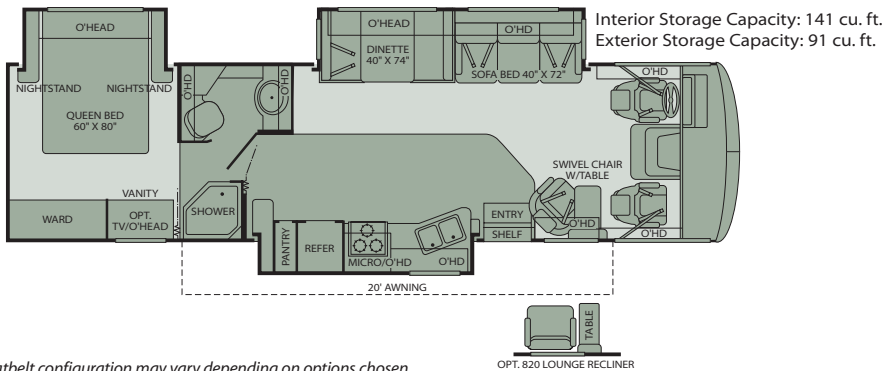

Seatbelt configuration may vary depending on options chosen.

Weights and Measurements



FORD®/WORKHORSE™	31A	33R	34F
Engine Displacement (Liters)	6.8/8.1	6.8/8.1	6.8/8.1
Wheelbase (Inches)	208/208	208/208	228/228
GVWR (lbs)¹	20,500/20,700	20,500/20,700	22,000/22,000
Front GAWR (lbs)²	7,000/7,500	7,000/7,500	7,500/8,000
Rear GAWR (lbs)²	13,500/13,500	13,500/13,500	14,500/14,500
Base Weight (lbs)³	16,300/16,350	16,900/16,950	17,450/17,600
GCWR (lbs)⁴	25,500/25,700	25,500/25,700	26,000/26,000
Hitch Rating Weight (lbs)[†]	5,000/5,000	5,000/5,000	5,000/5,000
Tongue Weight (lbs)[†]	500/500	500/500	500/500
Fuel Capacity (gal)	75/75	75/75	75/75

DIMENSIONS AND CAPACITIES

Overall Length⁵	32' 2"	34' 2"	34' 8"
Overall Height (with A/C)	12' 0"	12' 0"	12' 0"
Overall Width (maximum)^{6,7}	102"	102"	102"
Interior Height (maximum)	79"	79"	79"
Interior Width (maximum)	96"	96"	96"
Fresh Water Holding Tank (gal)	80	80	100
Grey Water Holding Tank (gal)	58	58	58
Black Water Holding Tank (gal)	42	42	42
Appliance Propane Tank (gal) (WC)⁸	25	25	25
Water Heater Tank (gal)	6	6	6

Liquid Weight Reference: Water (gal) = (8.3 lbs/3.8 kgs) Fuel (gal) = (6.1 lbs/2.8 kgs) Propane (gal) = (4.2 lbs/1.9 kgs)

Metric Conversion: Multiply pounds x 0.453 to obtain kilograms. Multiply gallons x 3.785 to obtain liters.

CHASSIS

Model: Ford®/Workhorse™	Transmission: 5-Speed Automatic with Overdrive/ 6-Speed Automatic with Overdrive
Engine: 6.8L Triton® V10/8.1L Vortec™ V8	
Horsepower: 362HP/340HP	Alternator Amps: 130 Amp/145 Amp
Torque: 457 lb-ft @ 4750 RPM/455 lb-ft @ 3200 RPM	Tires: 245/70R 19.5(F)/245/70R 19.5(G)

- GVWR (Gross Vehicle Weight Rating) is the maximum permissible weight of this fully loaded motor home. The GVWR is equal to or greater than the sum of the unloaded vehicle weight plus the cargo carrying capacity.
 - GAWR (Gross Axle Weight Rating) is the maximum permissible loaded weight a specific axle is designed to carry.
 - Base Weight is the estimated weight of the motor home without fuel, options, water, cargo or passengers.
 - GCWR (Gross Combined Weight Rating) is the value specified by the motor home manufacturer as the maximum allowable loaded weight of this motor home with its towed vehicle. Towing and braking capacities may be different. Refer to Fleetwood and chassis manufacturer's manuals for complete information.
 - Length taken from front bumper to rear bumper (excludes accessories).
 - Excludes safety equipment and awnings.
 - Motor homes feature a body-width over 96" which will restrict your access to certain roads. Before purchasing, you should research any state and/or province road laws which may affect your usage.
 - Tank manufacturer's listed water capacity (WC). Actual propane capacity is 80% of water listing as required by the safety code.
- † The chassis manufacturer recommends the installation of a supplemental brake control system to activate the brakes on the vehicle or trailer you are towing. Hitch receiver ratings expressed are maximum for the hitch receiver installed and may require the purchase of additional equipment that is dependant on the weight of the towed load. Consult with hitch receiver manufacturer for further information.

Standard Features



Interior

THROUGHOUT

- **Deluxe Roller Bearing, Full Extension Drawer Guides**
- **Plush Wall-to-Wall Carpet w/Carpet Pad**
- 120V/12V AC/DC Converter
- 3 Interior Decors
- 3-Way Water Pump Switch
- 34,000 BTU Furnace (30,000/20,000 BTU on 34F)
- 6-Gallon Quick-Recovery Water Heater w/Direct Spark Ignition
- Central Electrical Panel
- Coordinated Cabinet Hardware
- Demand Water Pump w/Filter

DRIVER CONVENIENCE

- **AM/FM Radio w/CD Player**
- **Driver/Front Passenger Captain's Chairs with Reclining Back/Slide Controls**
- 3-Point Seat Belts at Driver & Front Passenger Seats
- Automotive A/C Heater Combo
- Auxiliary Start Circuit
- Battery Shut-Off Switch
- Cruise Control
- Double Swivel Sun Visors w/Map Pockets
- Interior Lighting
- Intermittent Wiper Control

LIVING ROOM

- **Day/Night Pleated Shades**
- **Flexsteel® Furniture**

GALLEY

- **1.0 cu. ft. Microwave Oven w/Electronic Touch Pad**
- **8 cu. ft. Dometic® Double Door Refrigerator**
- **Large, Double Stainless Steel Sink**
- 3-Burner High-Output Range w/Oven
- Adjustable Cabinet Shelves (Select Cabinets)
- Fan-Tastic® Power Roof Vent
- Flat Panel Base Cabinet Doors
- Folding Range Cover
- Radius Corner Cabinetry
- Raised-Panel Cabinet Doors

BEDROOM

- **Restonic® Innerspring Mattress**
- Bedsprad w/Decor Pillows

BATHROOM

- **Skylight in Tub/Shower**
- **Toilet Tank San-T-Flush™ System**
- Coordinated Bath Accessories
- Marine Toilet

SAFETY/CONVENIENCE

- 10 ABC Fire Extinguisher
- Carbon Monoxide Detector/Alarm
- Propane Detector/Alarm
- Smoke Detector/Alarm

- Dual Battery Charge Control
- Electronic Climate Control Systems (33R & 34F)
- Real Wood Construction Drawers
- Solid Divider Doors
- Telephone Jack in Dash
- Wall Switches
- Water Heater Bypass

- Low Profile Engine Cover
- Map Lights (Driver & Passenger)
- Monitor Panel
- Radio Switch-Main/Auxiliary Power
- Soft-Surface Automotive Dash
- Tilt Steering Wheel
- Video Control Center

- Residential Seat Styling
- TV Antenna

- Rangehood w/Light & Fan
- Single-Lever Faucet
- Solid Surface Countertop Edging
- Vinyl Flooring
- Wastebasket

- Rear Speakers
- Second Phone Jack

- Molded Tub/Shower Enclosure
- Vinyl Flooring

Exterior

THROUGHOUT

- **3 Colorway Graphics to Match Decor**
- **Awning Rail/Drip Molding (Both Sides)**
- **Fiberglass Front/Rear Caps**
- 30-amp Service
- 4.0kW Onan® MicroQuiet Generator (Select Models)

AUTOMOTIVE

- Dual 6V w/Deep-Cycle House Batteries
- Trailer Hitch with 7-Point Electrical Hook-Up†
- Valve Stem Extenders
- Wheel Simulators

SAFETY/CONVENIENCE

- **Power Entry Step**
- Entry Assist Handle
- Entry Door w/Screen Door & Deadbolt Lock
- Porch Light (Doorside)
- Remote Heated Rear View Mirrors

BODY STRUCTURE

- **Royal Tuff-Ply Roof**
- **Vacu-bond® Upper/Lower Floors**
- Aluminum Interlocking Floor/Wall/Ceiling Framing

STORAGE

- **EZ-Store Compartment on Living Area Slide-Outs**
- Basement Storage
- Continuous One-Piece Compartment Bulb Seal

- 5.5kW Onan® Generator (33R & 34F)
- ABS Wheel Well Trims
- Dual Patio Receptacles
- Large Headlamps
- Mud Flaps
- Park Cable Receptacle
- Patio Awning
- Radius Roof w/Ducted A/C
- Roof A/C High Efficiency w/Solar Panel (Dual A/C on 33R & 34F)
- Roof Ladder
- Single Motor Windshield Wipers w/Wet Arm
- Spare Tire
- Steel Surface on Bulkhead

† The chassis manufacturer recommends the installation of a supplemental brake control system to activate the brakes on the vehicle or trailer you are towing. Hitch receiver ratings expressed are maximum for the hitch receiver installed and may require the purchase of additional equipment that is dependant on the weight of the towed load. Consult with hitch receiver manufacturer for further information.

- Utility Compartment w/Exterior Shower

- Basement Floor Configuration
- Coach Vibration Isolators
- Heated Water & Holding Tank Compartments
- Large, Curved Aerodynamic Bonded Windshield

- Hidden, Stainless Steel Latch Rods
- Insulated Aluminum Luggage Doors w/Single Paddle Metal Latches & Stainless-Steel Hinges
- Lighted Luggage Compartments
- Rotomolded Polyethylene Luggage Compartments

Options

THROUGHOUT (EXTERIOR)

- 5.0kW Generator Upgrade w/Electronic Climate Control & Dual A/C (31A Only)
- Digital Satellite System Manual Lift/Digital Image

BEDROOM

- Television

DRIVER CONVENIENCE

- Dual Glazed Windows
- Rear Vision Camera
- Ultraleather™ Driver and Passenger Chairs

LIVING ROOM

- DVD/VCR Combo Player
- Lounge Recliner

AUTOMOTIVE

- 4-Point Automatic Leveling Jacks
- Ford® Chassis with 6.8L Triton® V10 Engine
- Workhorse™ Chassis with 8.1L Vortec™ Engine

Fleetwood Advantages

- **Complete TuffPEX® Plumbing System**
- **EZ Glide® Slide-Out System w/EZ Store**

- **Power Platform Construction***
- **Royal Tuff-Ply Radius Roof w/Ducted A/C & Flat Ceiling**

- **Vacu-bond® Walls w/Smooth High-Gloss Exterior Tuff-Coat® Fiberglass**

Bold Denotes Fleetwood's Key Features

* Denotes Fleetwood Exclusives

Setting the Standard in Motor Home Quality.

Fleetwood® prototypes are exposed to thousands of miles of durability testing. Those components that don't survive are redesigned until they do. This sets our standard in safety and durability.

Royal Tuff-Ply roofing technology is one of the most durable roofing materials on the market and also reflects sunlight to reduce chalking. White roof material minimizes heat build-up, keeping the temperature cool and comfortable.

Reliable TuffPEX® plumbing runs throughout each vehicle creating a durable seal on all internal tubing. TuffPEX® assures water flow and functions in colder temperatures. The TuffPEX® system is an industry leader in quality plumbing.

For each outer wall, Fleetwood uses one seamless, solid piece of its exclusive Tuff-Coat® fiberglass composite. It resists UV rays, cracks and impacts. Our products look newer longer and that's a big plus at resale time.

To assure a strong, weather-resistant structure, Fleetwood Vacu-bonds® all sidewalls, floors and ceilings to a durable aluminum or steel frame. The Vacu-bond® process is unmatched by many competitors.

IMPORTANT — PLEASE READ: Product information, photography and illustrations included in this publication were as accurate as possible at the time of printing. For further product information and changes, please visit our website at www.fleetwoodrv.com or contact your local Fleetwood dealer. Prices, materials, design and specifications are subject to change without notice. All weights, fuel, liquid capacities and dimensions are approximate. Fleetwood has designed its recreational vehicles to provide a variety of uses for its customers. Each vehicle features optimal seating, sleeping, storage and fluid capacities. The user is responsible for selecting the proper combination of loads (i.e. occupants, equipment, fluids, cargo, etc.) to ensure that the vehicle's capacities are not exceeded.

What Drives You?

Maybe it's feeling like you're the only one on Earth. Perhaps it's the unique sense of closeness with the great outdoors. Or, it might be the joy that comes from spending quality time with family and friends. Whatever the reason, we know that you have a strong drive to experience everything that comes with spending time on the road. And for more than 50 years, we've shared that passion with you. Because we're RV enthusiasts ourselves, you can see our passion in the vehicles we design and build. Own a Fleetwood, and you'll feel like you're not just traveling, but embarking on an experience unlike any other. Set your own course for adventure and get out there and explore the world around you. Once you do, you'll see what it is that drives us — it's you.

RV OWNERCARE* is a limited one-year/15,000-mile coach warranty and three-year/50,000-mile structural warranty, whichever occurs first, and it is fully transferable for the first 12 months. RV OWNERCARE is one of the RV industry's most comprehensive programs and includes systems, appliances, components and construction, with no deductible and no service charge. RV OWNERCARE coverage is provided from a company that will be around in the future to service your needs. See your nearest Fleetwood dealer for a full explanation of benefits and restrictions.

FLEETWOOD TRAVELCADE CLUB As a Fleetwood owner, you're eligible to become a member of our owners' group, Fleetwood Travelcade Club. It's a perfect way to meet other Fleetwood owners who love to travel across America and share in the RV lifestyle. Call (877) 577-2560 or visit www.fleetwood.com/clubs to learn more and join the fun!



www.fleetwoodrv.com

*For complete info see your Fleetwood dealer. ©2005. Fleetwood Enterprises, Inc. Printed in the USA. Inventory control number FL06F2 10/05.

FLEETWOODRV.COM To locate a dealer near you, visit our website or call 1-800-444-4905. We can also be contacted at Fleetwood Customer Relations, P.O. Box 7638, Riverside, CA 92513-7638.

IMPORTANT—PLEASE READ Product information, photography and illustrations included in this publication were as accurate as possible at the time of printing. For further product information and changes, please visit our website at www.fleetwoodrv.com or contact your local Fleetwood dealer. Prices, materials, design and specifications are subject to change without notice. All weights, fuel, liquid capacities and dimensions are approximate. Fleetwood has designed its recreational vehicles to provide a variety of uses for customers. Each vehicle features optimal seating, sleeping, storage and fluid capacities. The user is responsible for selecting the proper combination of loads (i.e.: occupants, equipment, fluids, cargo, etc.) to ensure that the vehicle's capacities are not exceeded.

Your local Fleetwood dealer is:

