

2003 AEROLITE

THE
ORIGINAL

Aerolite



EXPANDED HORIZONS • *LIGHTWEIGHT TRAVEL TRAILERS & EXPANDABLES*



Aerolite

7' Models

The industry's original ultra lightweight trailer, the Aerolite 7' model line offers more storage than you'd believe possible in an ultra lightweight unit. Always the leader in innovation, the Aerolite 7' features the ingenious Stor-More, a huge exterior storage area, along with an abundance of special features and amenities throughout each unit.

Oak trim sofa slide, high end decors and large kitchens and baths make the Aerolite 7' perfect for any family



The huge Stor-More exterior storage area gives you extra room for gear and equipment



25BG with Stor-More feature

25FBSL in Sand Green



Aerodynamic lightweight and easy to tow

2003
Aerolite 7'
Travel Trailer
Floor Plans

A19FB

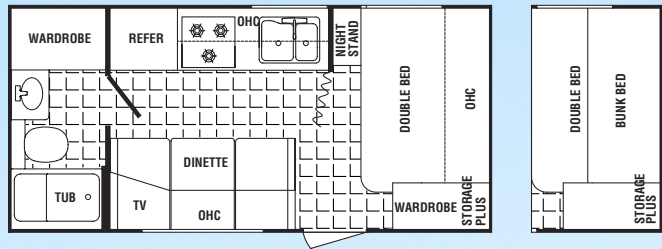

A21RDB

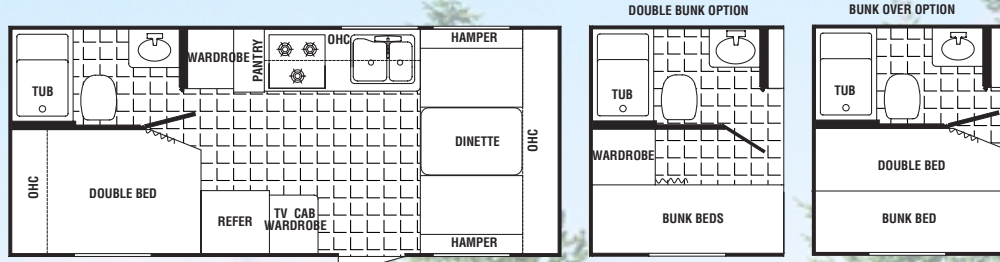

A25BG

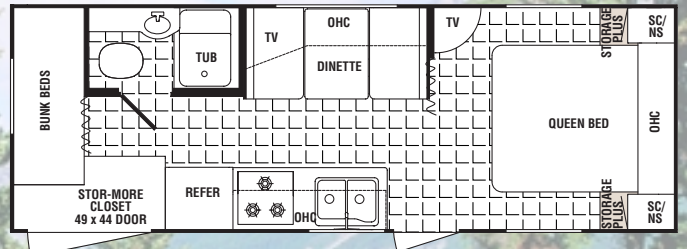

A23FB

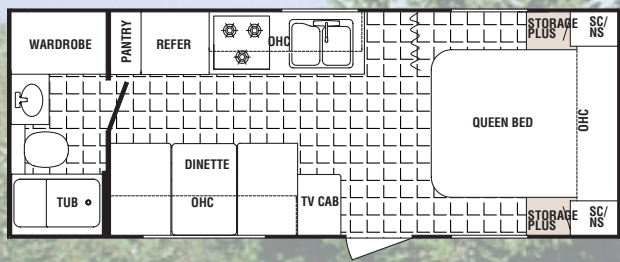

A25FBH

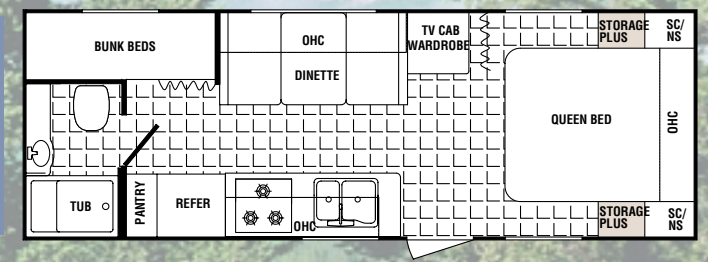

A23RDB

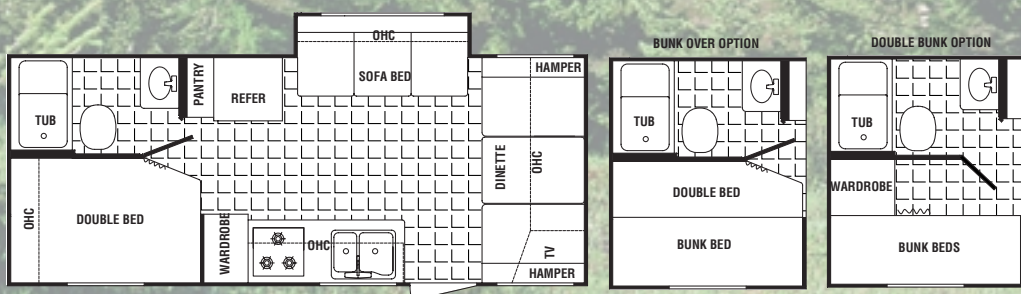

A25FB-SL

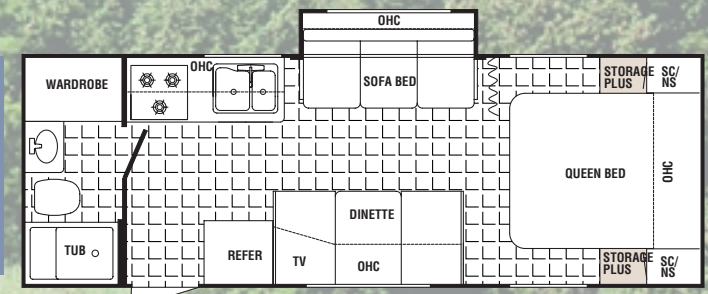

Aerolite

8' Models

*B*uilt with an ultra lightweight all aluminum super structure, the Aerolite 8' is aerodynamically designed for easy towing and handling without giving up interior living space. With floor plans available featuring double width slides and every unit loaded with standard features and amenities, we're sure to have the model that's right for your family. Aerolite 8 - the new standard in ultra lightweight travel trailers.



Aluminum framed, laminated walls,
floor and roof

Aerolite 8'-30GS

30GS in Fall Blue



30GS with kitchen and sofa slide features an oversize wardrobe with lots of storage!



30GS with queen bed, sofa, dinette and bunks. Sleeps 8.

2003
Aerolite 8'
Travel Trailer
Floor Plans

A25FQ

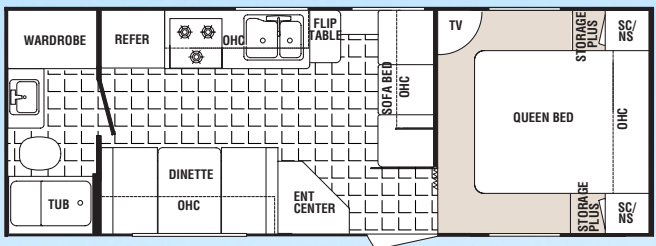

A26QS

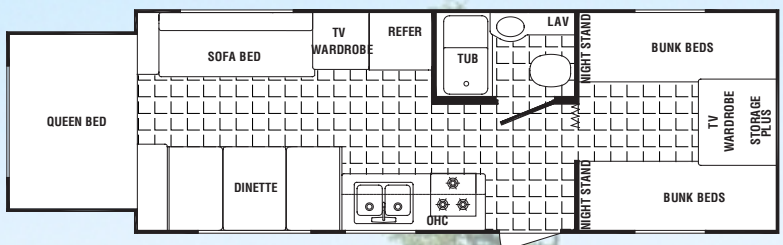

A28RL

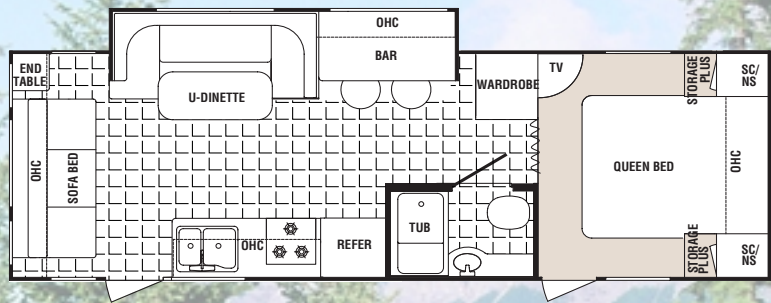

A26RK

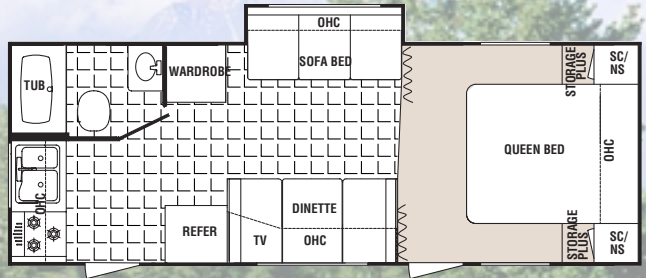

A30FB

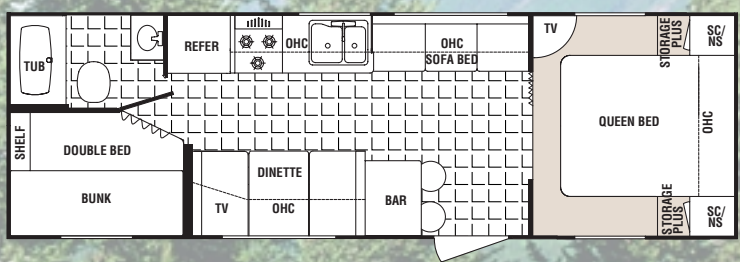

A30FB DOUBLE BUNK OPTION

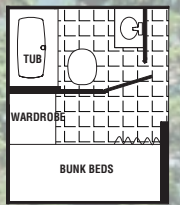

A30FB TRIPLE BUNK OPTION

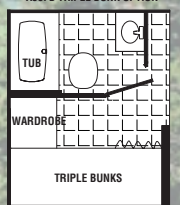

A27BH

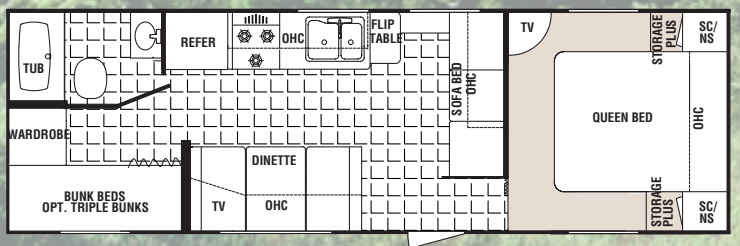

A30GS

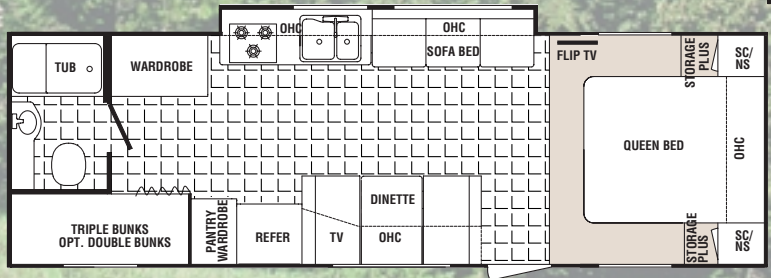



Cub

The Aerolite Cub is packed with features without packing a big price. Its innovative design includes a European style ultra lightweight frame and all aluminum super structure that give it strength and durability along with towing ease. For active families on the go, expandable travel trailers add sleeping space without adding length and extra weight to the unit. Bunk ends feature sturdy CAVLAR-15 tents that carry a 5-year warranty to ensure top quality and satisfaction.



2003 Cub
Expandable
Travel Trailer
Floor Plans

C160

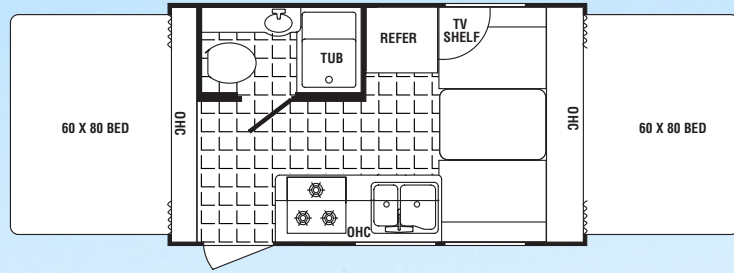

C190

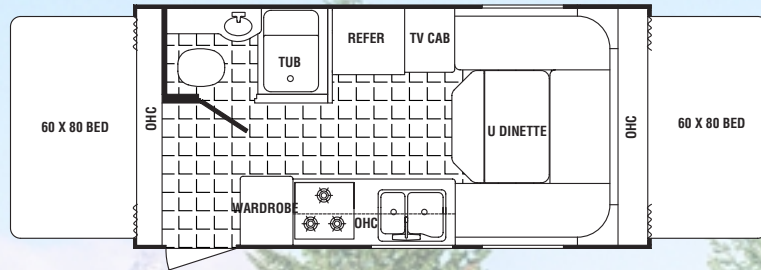

C195

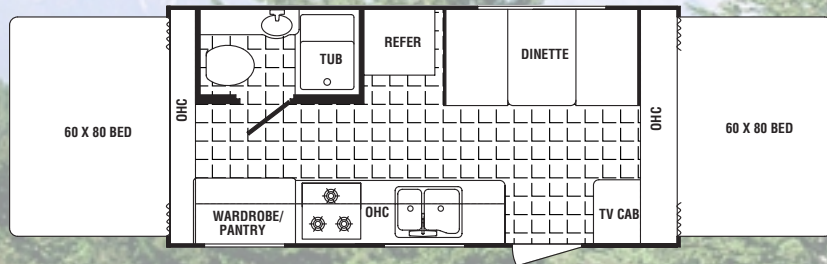

C210

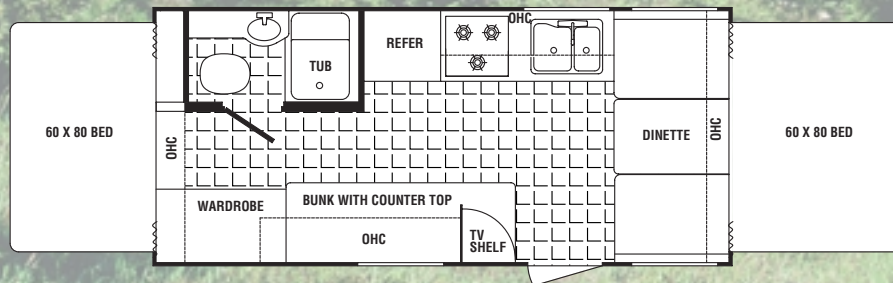

C210 Floor Plan Options

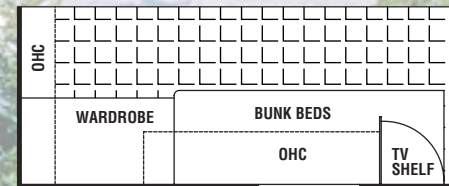

DOUBLE BUNK OPTION

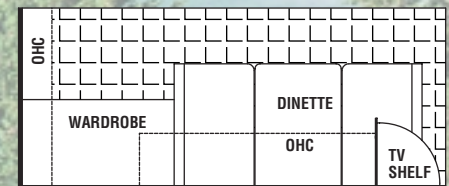

DINETTE OPTION

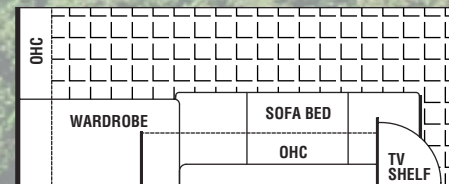

SOFA OPTION

2003 Cub
Expandable
Travel Trailer
Floor Plans

C214

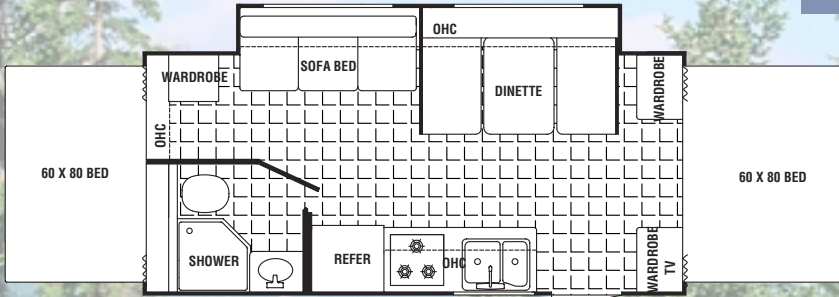

C230F

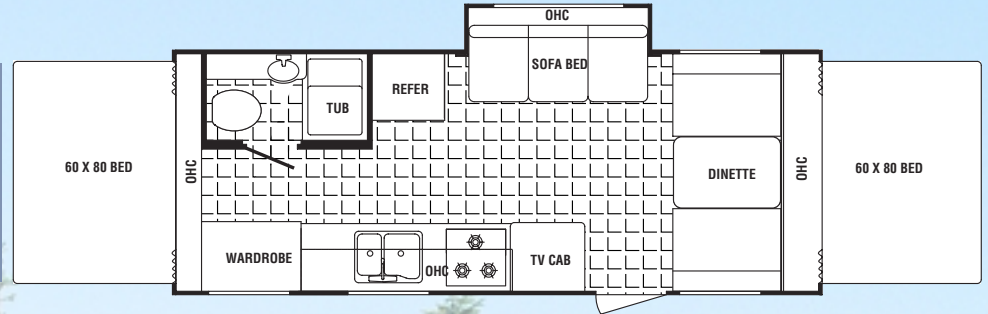

C230R

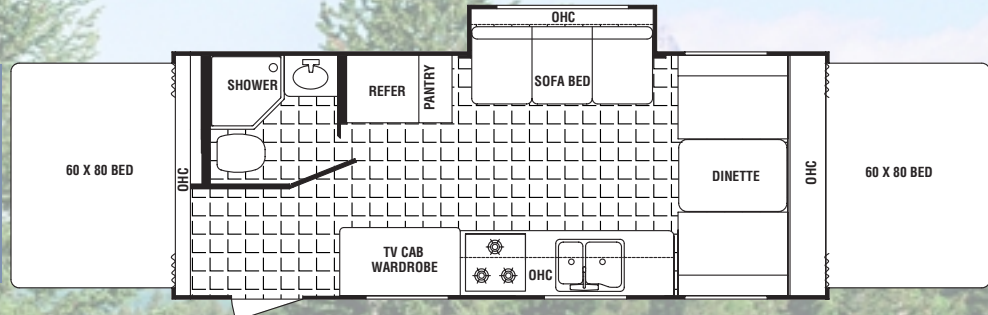

C215

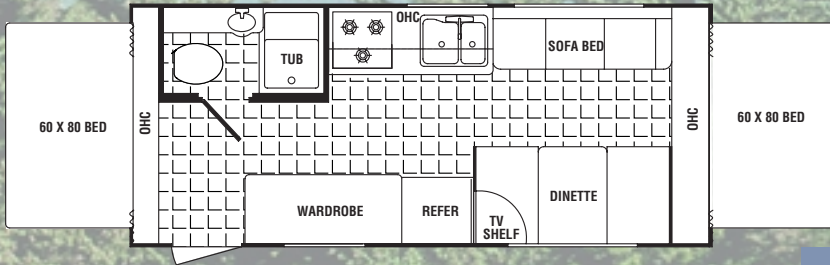

C236

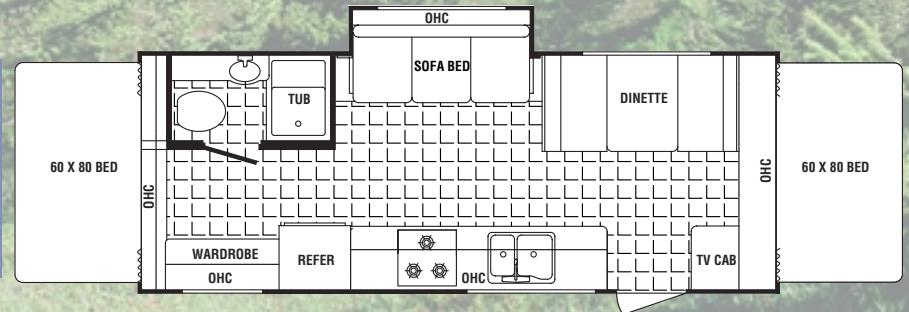

2003
Travel Trailer
Standards
& Options

CUB SEVENS EIGHTS

Standard Exterior Features	CUB	SEVENS	EIGHTS
Norco lightweight frame	•	•	•
AL-KO independent torsion axles suspension	•	•	•
Tandem axles (N/A Cub C160) with 4 wheel electric brakes	•	•	•
Single step	•	•	•
EPDM one piece seamless rubber roof	•	•	•
Corrosion-free laminated Darco underbelly	•	•	•
Welded aluminum laminated frame (roof, floor and walls)	•	•	•
Front mounted battery tray	•	•	•
Rain gutter with corner downspouts	•	•	•
Four corner stabilizer jacks	•	OPT	OPT
2-20 lb. LP bottles with ABS cover	•	•	•
2-30 lb. LP bottles with ABS cover	•	•	•
26" radius entry door	•	•	•
ABS wheel wells	•	•	•
Ozite carpet in pass thru storage areas	•	•	•
Colored ABS fender skirts	•	•	•
Tinted radius clamp ring windows	•	•	•
Full front ABS cap with enclosed LP bottles and battery	•	•	•
Flush combo entry latch/dead bolt lock	•	•	•
Standard Appliances and Electrical	CUB	SEVENS	EIGHTS
Sub floor thermostatically controlled heated fresh water tank (Not CSA)	•	•	•
Norcold single door gas/electric refrigerator	•	•	•
Norcold double door gas/electric refrigerator	OPT	OPT	•
Systems monitor panel	•	•	•
Forced air DSI furnace with wall thermostat	20M BTU	20M BTU	30M BTU
Ducted heat	•	•	•
Pre-wired for A/C	•	•	•
Pre-wired for cable TV	•	•	•
Pre-wired for stereo	•	•	•
Range hood with 12 volt light and exhaust fan	•	•	•
6 gallon gas water heater with bypass	•	•	•
Fire extinguisher	•	•	•
LPG leak detector	•	•	•
Smoke detector	•	•	•
Solid state converter with built-in battery charger	•	•	•
Patio light	•	•	•
3 burner high output range with oven	•	•	•
3 burner high output range	•	•	•
Standard Interior Features	CUB	SEVENS	EIGHTS
Shower curtain	•	•	•
Residential tile-like linoleum	•	•	•
Power roof vent in bathroom	•	•	•
Décor wallpaper border	•	•	•
Demand water pump	•	•	•
Bathroom medicine cabinet (not all models)	•	•	•
TV shelf	•	•	•
Mini blinds throughout	•	•	•
Fiberlink bathtub	•	•	•
Towel storage bin in bathroom	•	•	•
5" thick dinette cushions	•	•	•
Trash bag holder	•	•	•
Coat rack	•	•	•
Magazine rack	•	•	•

CUB SEVENS EIGHTS

Standard Interior Features (continued)	CUB	SEVENS	EIGHTS
Double bowl white acrylic sink with high rise faucet with dual sink covers	•	•	•
Oak mortise tenon cabinet doors	•	•	•
Safety cable on front and rear bunks	•	•	•
Powder coated radius tent poles	•	•	•
Pin-up lights in the bedroom	•	•	•
Glass décor light over dinette table	•	•	•
Adjustable pantry shelves (not all models)	•	•	•
Décor coordinated bedspread	•	•	•
Skylight roof vents	•	•	•
Optional Features	CUB	SEVENS	EIGHTS
Heated waste holding tanks (Not CSA)	•	•	•
DSI water heater (gas/electric)	•	•	•
Spare tire with cover	•	•	•
13.5 air conditioning	•	•	•
Spray-away wash station	•	•	•
AM/FM/CD Player	•	•	•
Microwave	•	•	•
Oven with range (N/A A30GS)	•	•	STD
Awning	•	•	•
Stove cover	•	•	•
6 cubic foot double door refrigerator	•	•	STD
Bunk light with fan	•	•	•
Water filter system	•	•	•
Vitco RVQ grill	•	•	•
Sand pads on jacks	•	•	•
TV antenna	•	•	•
Tub surround	•	•	STD
ABS slide tray (pass thru storage)	•	•	•
Bedroom carpet	•	•	STD
Fantastic vent	•	•	•
Roof rack and ladder (N/A 26RK)	•	•	•
Skylight in bathroom	•	•	•
Safety glass	•	•	•

2003
Weights and
Measures/
Fabrics

Sand
Green



Fall
Blue



Imperial
Rose & Green



Cub Expandable Travel Trailer Weight Chart

	C160	C190	C195	C210	C210B	C210D	C210S	C214	C215	C230F	C230R	C236
Traveling Length	16'4"	19'	19'8"	21'9"	21'9"	21'9"	21'9"	22'	22'	23'8"	23'8"	23'9"
Expanded Length	20'6"	23'6"	23'6"	25'6"	25'6"	25'6"	25'6"	25'6"	25'6"	27'6"	27'6"	27'6"
Exterior Width	7'6"	7'6"	7'6"	7'6"	7'6"	7'6"	7'6"	7'6"	7'6"	7'6"	7'6"	7'6"
Exterior Height (with A/C)	9'5"	9'5"	9'5"	9'5"	9'5"	9'5"	9'5"	9'5"	9'5"	9'5"	9'5"	9'5"
Hitch Dry Weight	216	300	284	348	348	348	348	318	366	448	360	346
Gross Vehicle Weight	3716	4700	4684	4748	4748	4748	4748	4718	4766	4848	4760	4746
Unloaded Vehicle Weight	2674	2928	3126	3338	3338	3338	3338	3606	3344	3656	3368	3720
Net Cargo Capacity	1042	1772	1558	1360	1360	1360	1360	1112	1422	1192	1392	1026
Fresh Water Capacity	30	30	30	30	30	30	30	30	30	30	30	30
Dual Holding Tanks Cap.	62	62	62	72	72	72	72	62	62	62	62	62
Tire Size	ST205/75D14C for all											
Furnace Size (BTU's)	20	20	20	20	20	20	20	20	20	20	20	20

Aerolite 7' Travel Trailer Weight Chart

	A19FB	A21RDB	A23FB	A23RDB	A25BG	A25FBBH	A25FBSL
Length	19'4"	21'9"	23'8"	23'7"	25'7"	25'11"	25'
Exterior Width	7'5"	7'5"	7'5"	7'5"	7'5"	7'5"	7'5"
Exterior Height	9'5"	9'5"	9'5"	9'5"	9'5"	9'5"	9'5"
Hitch Dry Weight	248	356	262	454	242	226	250
Gross Vehicle Weight	4648	4756	4662	4854	4642	4626	4650
Unloaded Vehicle Weight	2978	3186	3446	3330	3600	3646	3904
Net Cargo Capacity	1706	1570	1216	1524	1042	980	746
Fresh Water Capacity	30	30	30	30	30	30	30
Dual Holding Tanks Cap.	72	62	62	72	62	62	62
Tire Size	ST205/75D14C for all						
Furnace Size (BTU's)	20	20	20	20	20	20	20

Aerolite 8' Travel Trailer Weight Chart

	A25FQ	A26QS	A26RK	A27BH	A28RL	A30FB	A30GS
Length	27'1"	TBD	27'5"	30'	30'2"	30'3"	30'
Exterior Width	8'	8'	8'	8'	8'	8'	8'
Exterior Height	9'9"	9'9"	9'9"	9'9"	9'9"	9'9"	9'9"
Hitch Dry Weight	440	TBD	432	312	356	228	328
Gross Vehicle Weight	6040	TBD	6032	5912	5956	5888	5928
Unloaded Vehicle Weight	4072	TBD	4194	4524	4788	4468	4622
Net Cargo Capacity	1968	TBD	1838	1388	1168	1420	1306
Fresh Water Capacity	30	30	30	30	30	30	30
Dual Holding Tanks Cap.	62	62	62	62	62	62	62
Tire Size	ST205/75D14C for all						
Furnace Size (BTU's)	30	30	30	30	30	30	30



DARE TO COMPARE VALUE CHECK LIST

Before you make your purchase decision, compare Aerolite's features to the competition. We are sure you will agree that Aerolite is the best trailer for the best price in the industry.

	AEROLITE	COMPETITION
<i>Construction Features</i>		
2 Year Bumper to Hitch Warranty - The Best in the Industry	✓	
5 Year Structural Warranty	✓	
12 Year Rubber Roof Warranty	✓	
1 year Customer Care Roadside Assistance Program Included with Purchase	✓	
Welded Aluminum Structure (Floor, Roof, Walls)	✓	
Laminated Fiberglass Walls	✓	
Norco Ultra-lite Chassis	✓	
Rubber Torsion Axle(s)	✓	
14" Tires	✓	
26" Radius Entry Door	✓	
Clamp Ring Radius Corner Windows	✓	
Flush Mount Radius Corner Luggage Doors	✓	
Large Storage-plus Pass Thru Storage Compartments (Most Models)	✓	
High Intensity Porch Light with Interior and Exterior Switch	✓	
Corrosion Resistant ABS LP Bottle Cover	✓	
Standard Heat Pad on Fresh Water Tank	✓	
Fresh and Waste Water Tanks Mounted Below Floor - Allows for Extra Interior Storage	✓	
"Rain Gutter" Moldings with Drip Spout	✓	
<i>Interior Features</i>		
Tile-like Linoleum	✓	
Oak Framed, Mortise & Tenon Construction Cabinet Doors	✓	
Mini Blinds On All Windows	✓	
Ducted Heat	✓	
Norcold Refrigerator w/Adjustable Temperature Settings	✓	
Wall Mounted Monitor Panel	✓	

	AEROLITE	COMPETITION
<i>Interior Features (cont.)</i>		
6 gal. Gas Water Heater - Water Heater By-pass for Winterization	✓	
Hard Valances with Lambrequins (Living Room)	✓	
Hard Valances with Sculptured Curtains (Bedroom Only)	✓	
Cable TV Jack - Standard	✓	
Gas Support Struts on Beds for Access to Extra Storage	✓	
TV Shelf and Outlet in Bedroom	✓	
Power Roof Vent in Bath	✓	
Fiberlink (Fiberglass/ABS) Bathtub	✓	
Fiberlink One Piece Tub Surround (8's Only)	✓	
Large, Dual Bowl, Acrylic Kitchen Sink	✓	
Flush Mount, Form Fitted Sink Covers (2)	✓	
High Rise Faucet	✓	
Roll Over Style Sofa (Bed)	✓	
<i>Optional Features</i>		
13.5 BTU Air Conditioner	✓	
Spare Tire w/Cover	✓	
TV Antenna	✓	
Awning	✓	
Exterior Vitco Grill	✓	
Exterior Spay Away Wash Station (15' Coiled Hose)	✓	
Safety Glass	✓	
Water Filter	✓	
Fiberlink 1 Piece Tub Surround (Expandables & 7's)	✓	
1 cu ft/1000 Watt Microwave Oven	✓	
Features subject to change without notice. Not all features available on all products.		

Just Show Your Card & Go!

We build our products better and we protect you with the industry's best warranty coverage, but we know that sometimes things can go wrong on the road. So when you become the proud owner of a new Aero, it's just the beginning of our exclusive 'round-the-clock Customer Care Program.

Customer Care provides complete and fully paid roadside assistance, emergency road service, and special warranty support benefits that go with you wherever you travel. You get immediate access to fast, dependable service when and where you need it.

Add our toll-free warranty and service appointment assistance and a technical assistance hot line and you have the security and peace of mind of full-time support.

Our exclusive 24-hour Customer Care benefits include:

- Fully paid emergency roadside assistance
- Free jump starts
- Free fuel delivery
- Free lock-out service
- Free on-site mechanical service in the event of a breakdown
- 24-hour technical hot line
- Toll-free service appointment scheduling nationwide
- Warranty service assistance at over 6,800 qualified service agencies
- Free customer trip routing and map service.

At Aero we want you to be able to enjoy your new trailer or fifth wheel to the fullest. That's why we've provided Aero Customer Care to take care of the problems that could spoil your travels.

Product information, specifications, and photography in this brochure were as accurate as possible at time of printing. Photographs may contain some features that are optional on your vehicle. Since we continually strive to improve our products, actual products may differ. Prices and specifications are subject to change without notice. **All capacities are approximate and dimensions are nominal. Some features shown are optional and may be different or unavailable in Canada.** Vehicles are designed for recreational use only and not intended for use as a primary residence.



This brochure is printed on recycled paper as part of Thor's corporate effort to minimize waste and conserve our natural resources. Providing safe, fuel-efficient recreational vehicles is Thor's way of further demonstrating our role as the industry leader in safeguarding our nation's environment.

Aero invites you to check out the following companies to further enhance your RV experience:



rvaa.com



funroads.com



reeseprod.com



rbwindustries.com



trailair.com

The Industry's Best Warranty- By Far!

We're so confident in the design and construction of our products that they are covered by Thor's exclusive Full 2-Year Standard Warranty: "Hitch-to-bumper" coverage to protect your RV investment.

Your Full 2-Year Warranty Includes:*

- Refrigerator
- Furnace
- Range
- Microwave
- Water pump
- House stereo
- Slide-out Mechanisms
- Power converter
- Plumbing
- Electrical
- Doors
- And much more...
- LP tanks
- Water heater
- TV antenna
- Lavatory
- Awnings

*See individual company warranty statements for details.

Why a Thor Product Is Your Best RV Value:

Thor Industries, Inc., listed on the New York Stock Exchange, proudly traces its history back over seventy years to the pioneering days of the RV industry with the founding of Airstream, the industry's oldest and most renowned brand. Our total commitment to quality and our philosophy of putting our customers first has led to our continuous growth. Today, Thor is the largest builder of RVs. Thor's strong financial condition and years of solid growth are your assurance that we will be here to serve you for years to come. We think this extra peace of mind is important when you are making a significant investment. Because our customers are always #1 with us, we work harder than other manufacturers to satisfy you.



THOR
AMERICA'S BEST RV VALUE

305 Steury Ave. • Goshen, IN 46528

574.534.1224 • Fax 574.533.3807

Service, Warranty and Parts 574.537.0700

www.aero-rv.com

Your Local Dealer