

CHATEAU

C l a s s C M o t o r h o m e s



Chateau

Class C

CHATEAU



Whether you just enjoy the great outdoors...or whether you're looking forward to putting a lifetime of work behind you and visiting all the glorious sights our great land has to offer, the Chateau Class C motorhome will let you fulfill your dreams.

If you want a comfortable, dependable way to travel...

If you want beautiful and convenient surroundings...

If you want unique floorplans and generous sleeping space...

If you want strict construction standards...

If you want *QUALITY*...

You want the Chateau Class C Motorhome!

Chateau Sport

Like the Chateau, the Chateau Sport is built with high quality workmanship. The Chateau Sport offers great standard features and is the perfect vehicle for those who prefer a shorter motorhome with greater economy.



The bathrooms are carefully designed for maximum efficiency and convenience, with generous storage and complete privacy. (Garden shower n/a on the Sport models)

Most of the bedrooms feature island queen beds with matching bedspreads and window treatments. For extra storage convenience, the bed frames are fitted with gas lift-struts for easy access to the valuable under bed storage compartment.



Class C

CHATEAU



The Chateau motorhome is available in a slideout floorplan for added daily living space. And this year we've added the 23J slideout in the Chateau Sport model. These slideout floorplans dramatically increase the living room area and come standard with overhead cabinet storage in the slide room as an added convenience.

Easy to operate, Chateau slideouts are built for reliability and long life and are sure to add even greater value to your motorhome investment.

CHATEAU INTERIORS



Waterville Blue



Waterville Green



Waterville Taupe



The Chateau's impressive exterior storage features Roto-Cast® storage compartments. These seamless compartments virtually eliminate the possibility of water intrusion. This proven technology also provides a quiet, strong and insulated storage area for all your valued belongings.



Chateau Class C**Standard Features****Construction/Exterior**

- 1 1/2 x 1 1/2", 16 gauge steel welded floor system
- Factory-installed awning
- Factory-installed hitch
- Full rear frame extension, engineered to maintain structural integrity and towing efficiency
- Fully-insulated ceiling ducted air conditioning and in-floor residential-style heating
- Fully laminated roof, walls and floors incorporating energy-saving high-density block foam insulation
- Fully-welded tubular aluminum roof and sidewall cage construction
- Heated and enclosed Roto-cast® holding tanks
- Large pass-through exterior storage compartment
- Patented E.M.T. system which is a rubber mounting suspension system on the chassis that absorbs and isolates road vibration for a smoother ride
- Premium one-piece rubberized roof
- Seamless roto-cast® storage compartments
- Seamless fiberglass exterior sidewalls
- Wheel liners
- Widebody design

Standard Features**Appliances**

- 13,500 BTU ducted roof air conditioner (front)
- Cable TV hook-up
- Coleman direct cool air conditioner
- Electronic ignition water heater w/standard water heater bypass kit
- Fiberglass running boards
- Fully-equipped galley which includes: a double-door refrigerator, high-output 3-burner gas range w/oven, residential-style microwave and high-quality roller guides on all drawers
- Generator
- Name brand appliances
- Premium digital AM/FM cassette stereo

Comfort/Convenience/Safety

- Bedroom TV cabinet
- Deluxe exterior mirrors
- Easy-access flip-up storage sofa
- Front TV cabinet (n/a w/entertainment ctr)
- Innerspring mattress with comforter
- LP leak and CO detectors
- Radius corner entry door & compartment doors
- Residential linoleum (galley area)
- Rubber tread entry steps
- Spacious overhead cabinetry w/ raised dark oak doors
- User-friendly hook-ups conveniently grouped in the driver side rear section on most models
- Wood grain dash

Chateau Class C**Options**

- 13" color TV w/remote (front w/swivel)
- 13" color TV w/remote (bedroom)
- 4.0 KW Onan® generator
- Automatic electric step
- Barrel chairs, P.S. (31' only)
- Battery disconnect
- Convection microwave w/3-burner range top
- Day/Night shades throughout
- Deluxe AM/FM stereo with CD player
- Emergency start
- Entertainment Center w/25" TV & slide out bunk (n/a on diesel 31')
- Ford diesel engine (n/a 31S)
- Heated, remote exterior mirrors
- Outside entertainment center
- Outside shower
- Power windows and locks
- Propane generator conversion
- Skylight (std. on 31N)
- Twin beds with nightstand (31' models only)
- Twin beds with wardrobe (28' only)
- Video cassette recorder

CHATEAU SPORT

Class C

Chateau Sport Class C**Standard Features****Construction/Exterior**

- 1 1/2 x 1 1/2", 16 gauge steel welded floor system
- Factory-installed awning
- Full rear frame extension, engineered to maintain structural integrity and towing efficiency
- Fully laminated roof, walls and floors incorporating energy-saving high-density block foam insulation
- Fully-welded tubular aluminum roof and sidewall cage construction
- Large pass-through exterior storage compartment (26Q & 28A only)
- Long limousine-style wheel base for a smooth and safe ride
- Patented E.M.T. system which is a rubber mounting suspension system on the chassis that absorbs and isolates road vibration for a smoother ride
- Premium one-piece rubberized roof
- Radius-corner entry door
- Seamless roto-cast® storage compartments
- Seamless fiberglass exterior sidewalls
- Widebody design

Standard Features**Appliances**

- 13,500 BTU roof air conditioner (front)
- Electronic ignition water heater w/standard water heater bypass kit
- Fully-equipped galley which includes: a double-door refrigerator, high-output 3-burner gas range, residential-style microwave and high-quality roller guides on all drawers
- Name brand appliances
- Premium digital AM/FM cassette stereo

Comfort/Convenience/Safety

- Bedroom TV cabinet (26' & 28' only)
- Front TV cabinet (n/a w/entertainment ctr)
- LP leak and CO detectors
- Mattress with comforter
- Rubber tread entry steps
- Seatbelts throughout
- Spacious overhead cabinetry
- User-friendly hook-ups conveniently grouped in the driver side rear section on most models
- Windshield privacy curtain

Chateau Sport**Options**

- 13" color TV w/remote (front w/swivel)
- 13" color TV w/remote (bedroom)
- 4.0 KW Onan® generator
- 5.0 Generac generator
- Additional bifold door (hallway)
- Aluminum running boards
- Automatic electric step
- Battery disconnect
- Convection microwave w/3-burner range top
- Day/Night shades throughout
- Deluxe exterior mirrors
- Deluxe AM/FM CD player
- Emergency start
- Entertainment center w/19" TV & slideout bunk
- Entertainment center w/25" TV & slideout bunk (23J only)
- Heated holding tanks
- Hitch
- Outside entertainment center (n/a 21RB)
- Oven w/3 burner H.O. range top
- Power windows and locks (Ford only)
- Raised oak cabinet doors
- Skylight
- Twin beds w/wardrobe (26' & 28')
- Video cassette recorder

21RB



22RK



23A

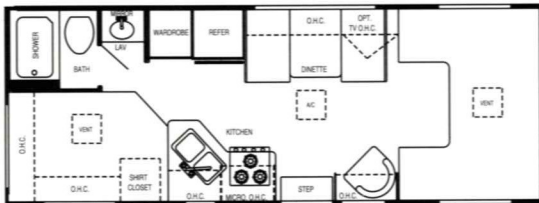

23J



26Q

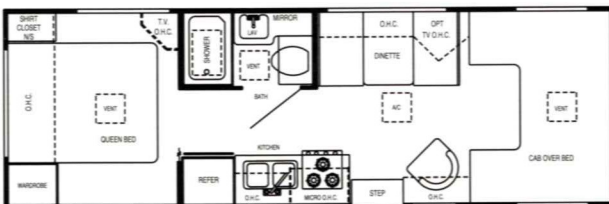

28A



28D

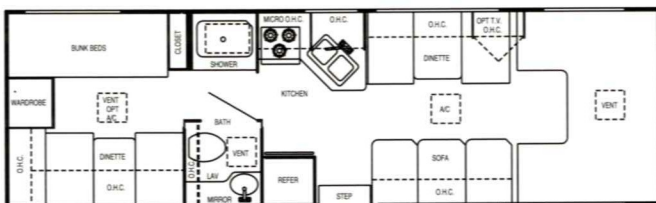

**Twin Bed
Option
(28' only)**

28A

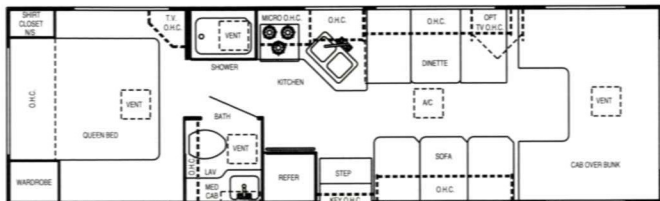

31QSB



31N

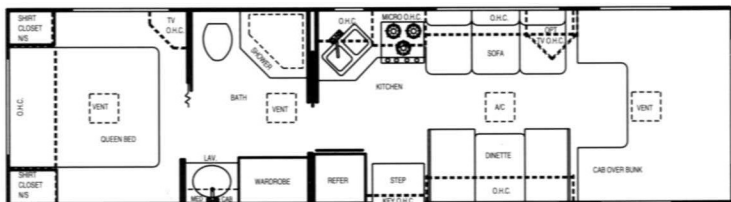

31S

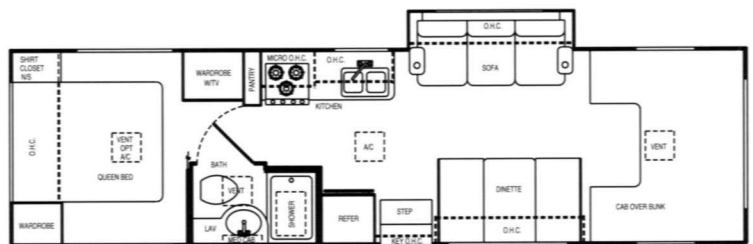

31Z

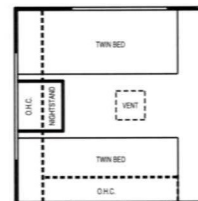
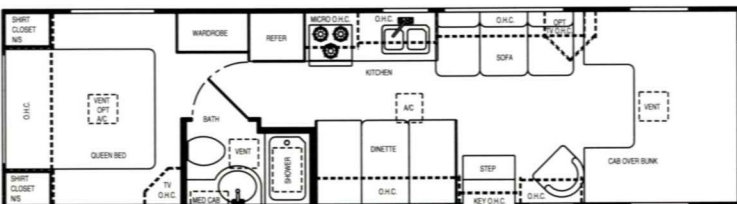

Twin Bed
Option
(31' only)

	Chateau Sport							Chateau				
2000 Chateau Class C	21RB	22RK	23A	23J	26Q	28A	28D	28A	31N	31QSB	31S	31Z
Ford Engine	-	6.8L	6.8L	6.8L	6.8L	6.8L	6.8L	6.8L	6.8L	6.8L	6.8L	6.8L
Wheel Base	-	174"	158"	180"	176"	190"	190"	190"	208"	208"	218"	216"
GVWR	-	11,500	11,500	14,050	11,500	14,050	14,050	14,050	14,050	14,050	14,050	14,050
GAWR (Front)	-	4,600	4,600	4,600	4,600	4,600	4,600	4,600	4,600	4,600	4,600	4,600
GAWR (Rear)	-	7,800	7,800	9,450	7,800	9,450	9,450	9,450	9,450	9,450	9,450	9,450
UVW	-	9,565	9,655	10,930	10,260	10,800	10,935	11,380	11,755	11,650	12,390	12,200
GCWR	-	18,500	18,500	20,000	18,500	20,000	20,000	20,000	20,000	20,000	20,000	20,000
NCC	-	1,935	1,845	3,120	1,240	3,250	3,115	2,670	2,295	2,400	1,660	1,850
Chevy Engine	5.7L	-	5.7/7.4L	-	5.7/7.4L	7.4L	7.4L	-	-	-	-	-
Wheel Base	138"	-	159"	-	177"	191"	191"	-	-	-	-	-
GVWR	11,500	-	11,500/ 12,300	-	11,500/ 12,300	12,300	12,300	-	-	-	-	-
GAWR (Front)	4,300	-	4,300	-	4,300	4,300	4,300	-	-	-	-	-
GAWR (Rear)	8,250	-	8,250/ 8,600	-	8,250/ 8,600	8,600	8,600	-	-	-	-	-
UVW	8,560	-	8,915/ 9,700	-	9,930/ 10,100	10,420	10,615	-	-	-	-	-
GCWR	13,500	-	13,500/ 17,000	-	13,500/ 17,000	17,000	17,000	-	-	-	-	-
NCC	2,940	-	2,585/ 2,600	-	1,570/ 2,200	1,880	1,685	-	-	-	-	-
Exterior Length (w/o ladder)	22'3"	23'6"	24'5"	24'8"	27'4"	29'4"	29'4"	29'2"	31'7"	31'0"	32'1"	32'3"
Exterior Height w/ A/C	10'8"	10'8"	10'8"	10'10"	10'8"	10'8"	10'8"	11'6"	11'6"	11'6"	11'6"	11'6"
Exterior Width	99"	99"	99"	99"	99"	99"	99"	99"	99"	99"	99"	99"
Interior Width	96"	96"	96"	96"	96"	96"	96"	96"	96"	96"	96"	96"
Interior Height	79 3/4"	79 3/4"	79 3/4"	79 3/4"	79 3/4"	79 3/4"	79 3/4"	79 3/4"	79 3/4"	79 3/4"	79 3/4"	79 3/4"
Awning Size	12'0"	13'0"	15'0"	15'0"	13'0"	14'0"	14'0"	14'0"	16'0"	16'0"	16'0"	16'0"
Fuel Ford/Chevy (Gal.)	-/35	55/-	55/55	55/-	55/55	55/55	55/55	55/-	55/-	55/-	55/-	55/-
LPG (Pounds)	51	51	51	51	51	51	51	51	51	51	51	51
Fresh Water (Gal.)	29	29	41	26	41	41	41	41	41	41	41	41
Waste Water (Gal.)	22	21	22	25	25	25	25	30	30	30	30	30
Gray Water (Gal.)	21	21	21	25	20	21	21	35	35	35	35	35
Furnace BTU's	25,000	25,000	25,000	25,000	31,000	31,000	31,000	31,000	31,000	31,000	31,000	31,000

Product information, specifications and photography in this brochure were as accurate as possible at time of printing. Since we continually strive to improve our products, actual products may differ. Prices and specifications are subject to change without notice. All capacities are approximate and dimensions are nominal. Some features or options may be different or unavailable in Canada.

Vehicle Loading-Every effort has been made to provide the greatest number of options for the recreation vehicle owner. Along with these choices comes the responsibility to manage the loads that are imposed by the choices so that they remain within the manufacturer's specified chassis weight limits. Do not overload the recreation vehicle.

Dry weights based on standard features; optional equipment not included. Net carrying capacity (NCC) determined by subtracting unloaded vehicle weight (UVW) from gross vehicle weight (GVWR) and includes fluids, options and cargo. Liquid capacities and weights are approximations only.

Most models are designed to be manufactured on either a Ford Motor

Company or General Motors Chassis. Both chassis' are designed to fully utilize Four Winds International's patented E.M.T. (Energy Mount Transfer System.) This proven innovation in chassis design completely isolates the body of the motorhome from the chassis by utilizing a series of carefully placed, heavy-duty, high performance rubber grommets. The E.M.T. system increases road comfort and stability and improves road handling, while virtually eliminating the transfer of vibration and road noise to the interior of the coach. This unique system is another example of Chateau's state-of-the-art technology and superior design and construction.



YOUR LOCAL DEALER

THOR'S "2 + 2" WARRANTY

2 year limited structural warranty and
2 years on major components



This brochure is printed on recycled paper as part of Thor's corporate effort to minimize waste and conserve our natural resources. We know you will join us in this effort to maintain North America's great outdoors. For who appreciates the natural beauty of our open spaces more than an RV'er?



Chateau

FOUR WINDS INTERNATIONAL

P.O. Box 1486 • Elkhart, IN 46515-1486

(219)266-1111 • Fax (219)294-8971

www.fourwinds-rv.com