

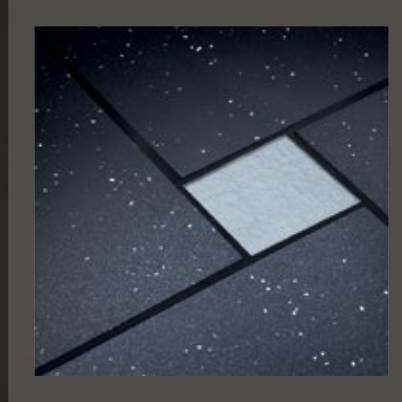

2014
KING AIRE
Luxury Motor Coach

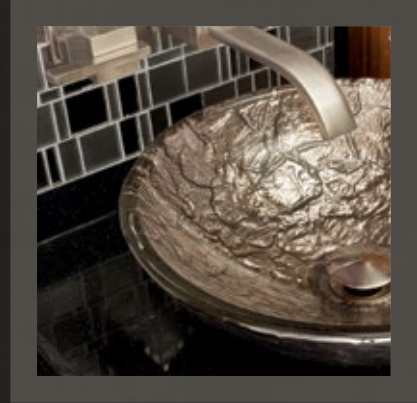

NEWMAR • 2014 KING AIRE

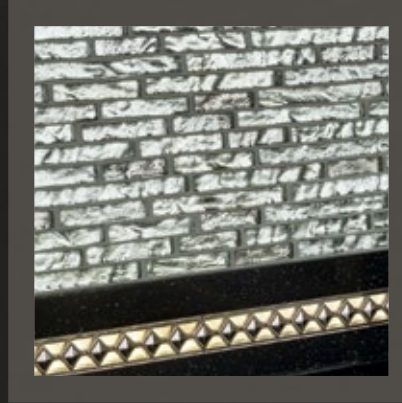

WHEN YOU KNOW THE DIFFERENCE SM

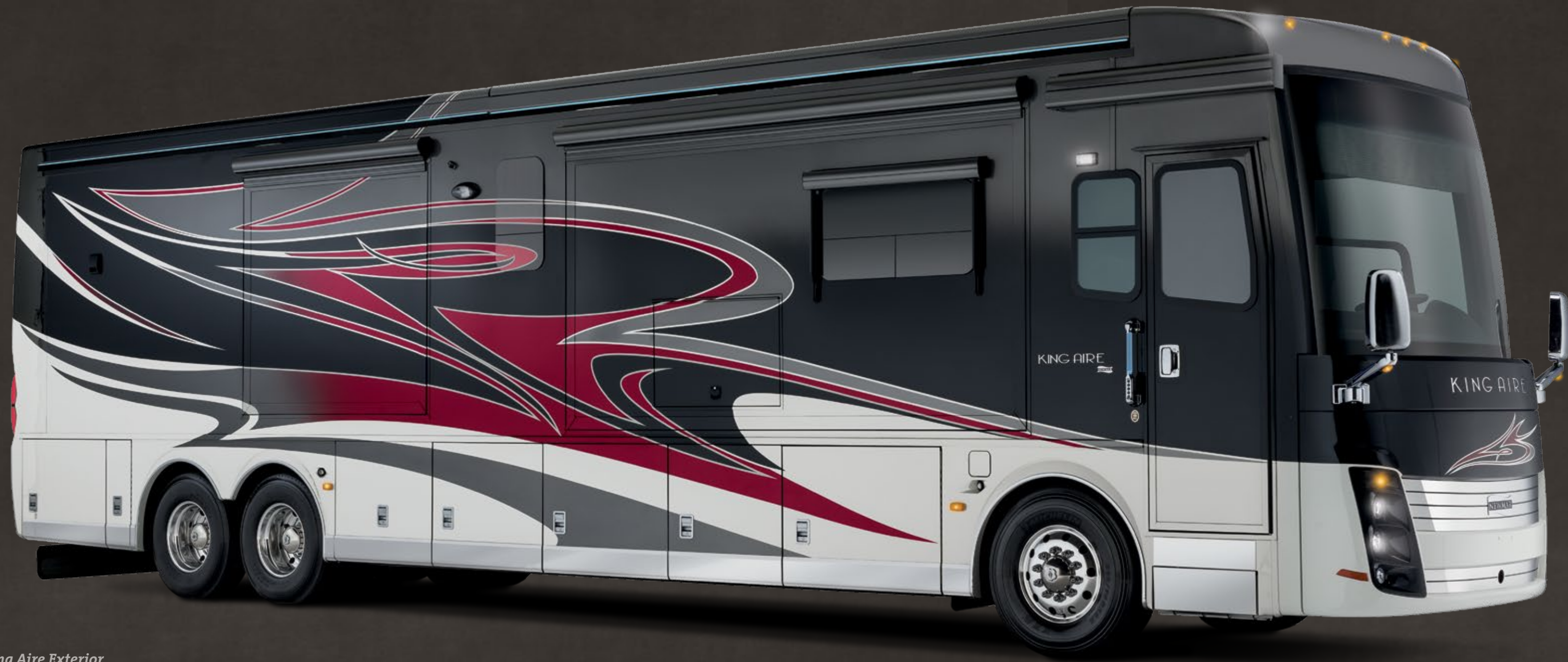

King Aire Exterior
Floor plan #4593 in Steel Exterior

2014 King Aire

Your quest ends.
Your story begins.

If every picture tells a story, then the vision in front of you is closer to a legend. The 2014 King Aire matches the latest in innovative performance with Newmar's timeless craftsmanship and attention to detail, such as a dazzling and durable Full-Paint Masterpiece™ Finish with blended gradation, a stunning graphics package, and the power of a 600 HP Cummins turbo diesel. And that gorgeous exterior is exceeded only by the full spectrum of high-end residential amenities waiting inside. Make King Aire part of your own story. And live happily ever after.



WHEN YOU KNOW THE DIFFERENCE SM



Newmar's Brightest Star

King Aire offers LED lighting around its perimeter, beneath the Girard® NOVA awnings, and even underneath the slide-outs.



The ride you richly deserve.

When it's time to take command of the road, King Aire more than lives up to its name. Driving is both satisfying and safe, thanks to Newmar's Comfort Drive™ that lets you steer with a light grip and optional Vorad® Safety Cruise collision avoidance.

And the innovative bridge construction of the Spartan® K3 Chassis allows a cargo bay that's among the largest in the industry, complete with standard power slide trays, dual side access and automatic LED lighting throughout the storage area.

Features at a glance:

- Full-paint Masterpiece™ Finish with super clear coat
- Spartan® K3 Tag Axle Chassis with 600HP Cummins ISX Engine
- Comfort Drive™ Steering with power control
- Cummins Onan® Quiet Diesel™ Generator



Spartan Chassis is a leader in the design and engineering of components which deliver superior performance and exceptional safety ratings.



King Aire Interior

Floor plan #4593 with Montego Décor Style and Ginger Glazed High-Gloss Cherry Cabinetry – Breathtaking from any perspective.

Where good taste is the main ingredient.

The galley area of the 2014 King Aire is a recipe for exquisitely modern kitchen design. The floor literally sparkles from a thousand tiny stars of recycled glass, while woven patterned metallic glass accents complement adjacent walls.

The highlight is truly the dual sink topped with a residential style Moen one-handle pullout faucet. Composed of durable Hard Roc borosilicate glass designed to withstand extreme temperatures and corrosive chemicals, the sink is set off by an illuminated glass inlay backsplash and LED accents that surround each bowl.

Features at a glance:

- Sony® 46" LED HDTV on televisor*
- Villa Sofa/Euro Booth dinette ensemble with powered adjustable table*
- Power duo day/night privacy window shades
- Sony® tablet with Silverleaf® multiplex control app

* Optional

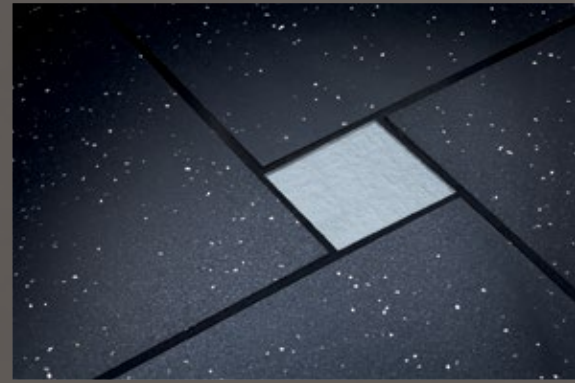

The King Aire Kitchen ▶
For those with a taste for real luxury.

Luxury by design.

The King Aire is crafted to fulfill every owner's wish for the best in style, comfort and convenience. To that end, Newmar uses only the most highly regarded names in residential décor to make their finest luxury coach a reality. Like new quilted-top Ultra Leather furniture created by Villa to Newmar specifications. Or custom-colored carpet designed by Fabrica.

In King Aire's main living area, entertainment complements elegance with a 46" Sony® high definition system on a televator lift, conveniently accessible from the included Sony® S-Pad tablet that provides full remote functionality plus Silverleaf cabin control.

Features at a glance:

- Sony® 46" LED HDTV on televator*
- Villa Sofa/Euro Booth dinette ensemble with powered adjustable table*
- Power duo day/night privacy window shades
- Sony® tablet with Silverleaf® multiplex control app

* Optional



Your Table Is Waiting ▶

King Aire's countless amenities make it a supremely comfortable place for friends to gather.



A regal place to rest.

Space and light are among the essentials of residential livability. Those elements are in ample supply in the 2014 King Aire, most notably in the master bedroom. LED lighting from new vertical fascias and overhead sources makes this one of the brightest and most vibrant coaches in the Newmar line.

Storage abounds in spacious dresser cabinetry with room for the most abundant wardrobe. You'll even find versatile space over the king size Select Comfort Sleep Number® Bed, a most luxurious place to relax while you enjoy the room's Sony® 40" LED TV and Blu-Ray® player.

Features at a glance:

- King size bed with Sleep Number® control mattress
- Sony® 40" LED HDTV with Blu-Ray® player
- Two piece stacked washer and dryer
- Accent lights in ceiling, lambrequins, kitchen, bed base, fascia trim and dash



Set the Perfect Mood ▶

King Aire's plush headboard hides versatile lighting controls for room and coach



Indulge yourself in something special.

Newmar understands that a luxury coach shouldn't just look like home; it should *feel* like home. There's no better example than the King Aire master bath, where twin vessel glass sinks make a spectacular statement of residential style. Adding to the bold look are chrome fixtures that project directly from wall to bowl.

Fitting into the home-like ambience is a roomy 40" x 32" shower with edge-to-edge mirror-finish walls of custom-made glass and metal tile. Add in bountiful storage options, plus an equally charming half-bath, and it becomes clear that for gracious travel, King Aire takes the crown.

Features at a glance:

- Polished solid surface shower walls with floor-to-ceiling tiling
- Demand water system with Aquajet™ "ES" pump
- Polished solid surface half bath counter with single sink
- Electric heat under floor tile*

*Optional

◀ **Left:** Polished solid surface double vanity features vessel sinks of Hard Roc glass.

◀ **Right:** Clear glass shower enclosure with optional fold-down teak seat.

KING AIRE EXTERIOR DECOR



Steel Exterior



Pearl Exterior

KING AIRE INTERIOR DECOR

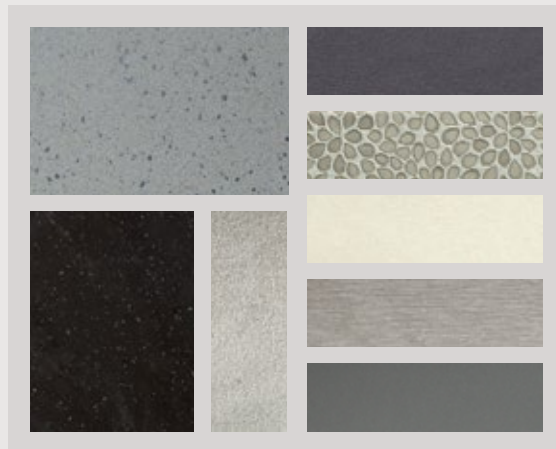

Boca Interior

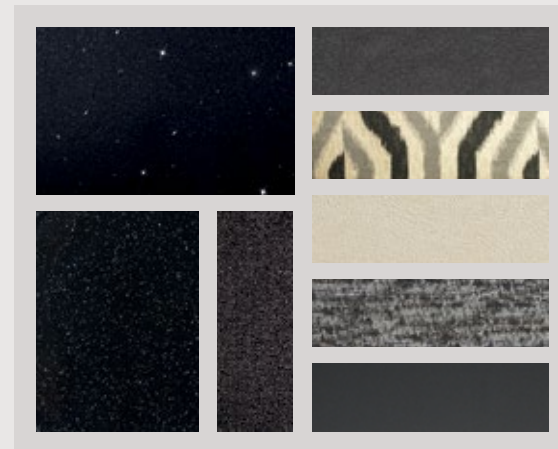

Montego Interior

WOOD OPTIONS



Sable Maple High-Gloss

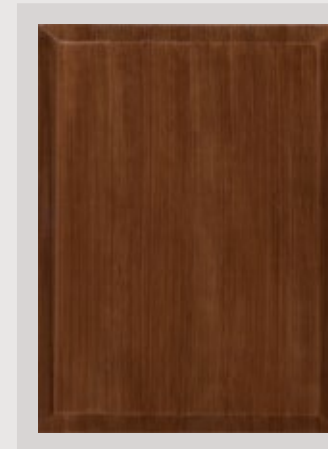

Ginger-Glazed Cherry High-Gloss



Mocha Exterior



Midnight Exterior

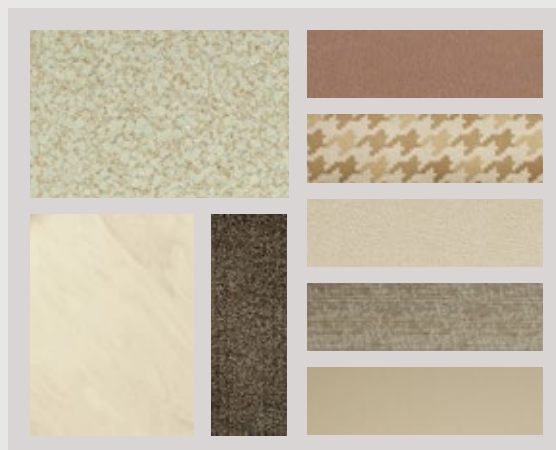

Avery Interior

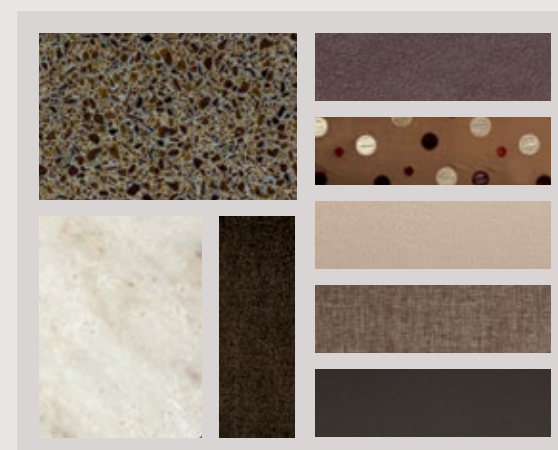

Vero Interior

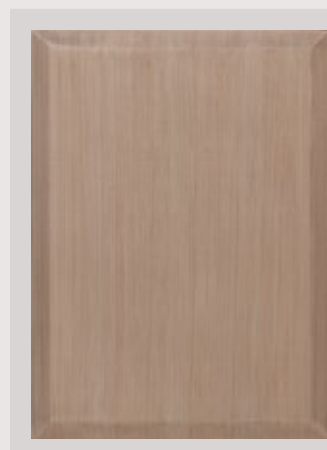

Rattan-Glazed Maple High-Gloss



Amaretto-Glazed Maple High-Gloss

KING AIRE FLOOR PLANS

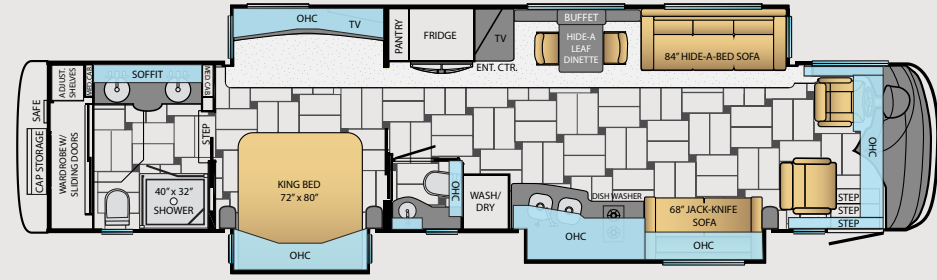

4584

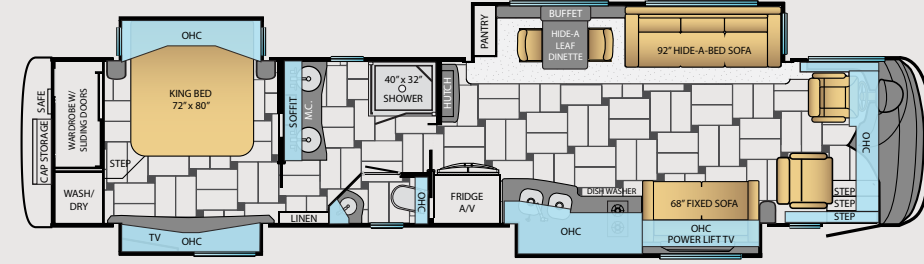

4592

KING AIRE FLOOR PLANS

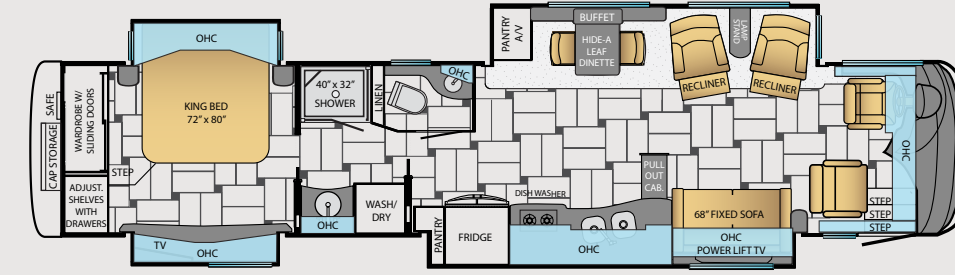

4594

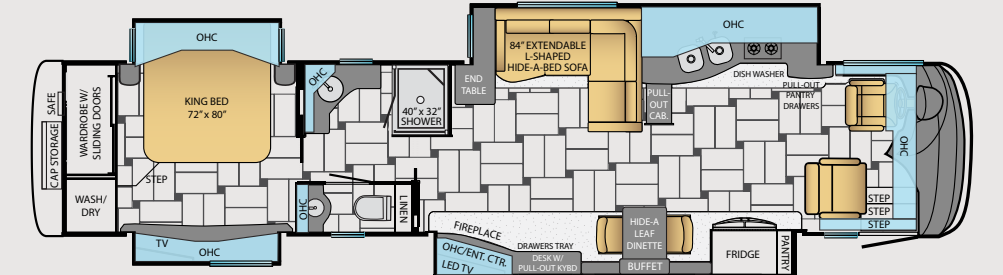

4597

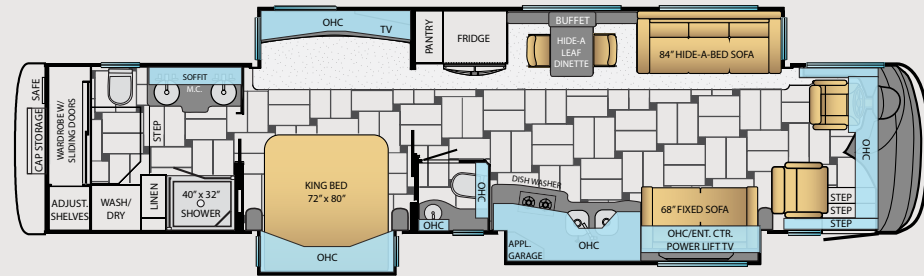

4593

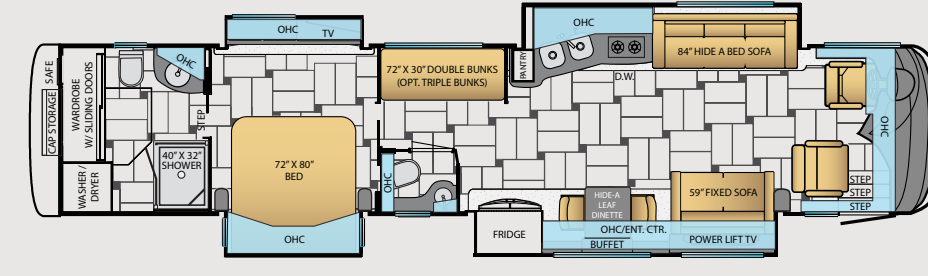

4599

FLOOR PLAN SPECIFICATIONS

Floor Plan	App. Overall Length	Width	App. Overall Height	Interior Width	Interior Height	Grey Tank	Sewage Tank	Water Tank	Propane Tank	Furnace
4584	44' 11"	101.5"	13' 4"	95.5"	84"	80 gal	60 gal	140 gal	22 gal	50,000 btu
4592	44' 11"	101.5"	13' 4"	95.5"	84"	80 gal	60 gal	140 gal	22 gal	50,000 btu
4593	44' 11"	101.5"	13' 4"	95.5"	84"	80 gal	60 gal	140 gal	22 gal	50,000 btu

FLOOR PLAN SPECIFICATIONS

Floor Plan	App. Overall Length	Width	App. Overall Height	Interior Width	Interior Height	Grey Tank	Sewage Tank	Water Tank	Propane Tank	Furnace
4594	44' 11"	101.5"	13' 4"	95.5"	84"	80 gal	60 gal	140 gal	22 gal	50,000 btu
4597	44' 11"	101.5"	13' 4"	95.5"	84"	80 gal	60 gal	140 gal	22 gal	50,000 btu
4599	44' 11"	101.5"	13' 4"	95.5"	84"	80 gal	60 gal	140 gal	22 gal	50,000 btu

KING AIRE FEATURES & OPTIONS



Chassis Features

Built specifically for Newmar with the highest quality in handling, safety, performance, and dependability.

Spartan® K3 Tag Axle Chassis with 600Hp Cummins® ISX Engine

Allison® 4000 MH Transmission

Automatic Traction Control

Comfort Drive™ Steering With Power Column and Adjustable Control

Alcoa Dura-Brite Aluminum Wheels

Hydraulic Leveling Jacks

Power Tilt-and-Telescope VIP Smart Wheel with Black Leather

Memory Settings for Drivers Seat, Pedals, Steering Wheel and Exterior Mirrors

Cruise Control

Recessed Fuel Fills with Crossover to Fill from Either Side

Back-Up Alarm

Anti-Lock Braking System

Remote Engine Start Station

Front and Rear/Tag Disc Brakes

Electronic Chassis Information Display in Dash

Tire Pressure Monitor System

Air Leveling Control System

Chassis Service Center

Leece-Neville 270 Amp Alternator

55 Degree Cramp Angle

OPTIONS

Vorad® Adaptive Cruise System



Air Conditioning & Heating

Total Comfort Air Conditioning and Hydronic Zone Heating systems make climate control simple and effective.

Three 15M Penguin™ Heat Pump Central Air Conditioners with Remote Control Thermostat

Hydronic Zone Heating System

Roof Air Conditioning Drainage System

Propane Gas Leak Detector

Dash Heater & High Output Air Conditioner

Driver/Passenger Dash Overhead Ventilation System

OPTIONS

Electric Heat Under Floor Tile

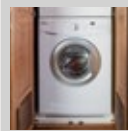

Appliances

All of the amenities of a fine home are integrated in the Newmar design, in both form and capabilities.

30" Advantium™ Speedcook Microwave Oven with Two Burner Cooktop

Polished Solid Surface Range Cover

Whirlpool® Bottom Freezer French Door Refrigerator with Icemaker and Water Dispenser

Dometic® Freezer on Pullout Tray

Whirlpool® Two Piece Stacked Washer and Dryer

Fireplace in Living Area*

Central Vacuum with Deluxe Tool Kit

OPTIONS

All-Electric Operation with Kenyon Cooktop and Eight Extra Batteries *

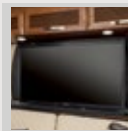

Audio, Video & Accessories

Stay entertained on the road and off, with spectacular visual and sound options from industry leaders.

Sony® LED TV & Blu Ray Player in Living and Bedroom Areas (TV Sizes Vary per Floorplan)*

Sony® 46" LED TV on Televator in Living Area*

External Entertainment Center Located in Storage Compartment with Sony 40" LED TV

Trip Tek™ Electronic Travel Information (Displayed on Rearview Monitor)

Video Security Cameras with Monitor

Sony® Surround Sound System with Bose Acoustimass Speaker System & Sub-Woofers

Sony® Tablet with Silverleaf® App

Bose® Wave Radio with CD Player in Bedroom

*Nav-N-Go™® Navigation System Displayed on Dash Touch Screen Monitor

High Definition component Wiring

Sirius® Satellite Radio-Ready with Antenna (Does not include SIRIUS® Monthly Subscription)

Secondary Multiple Touch Screen Control in Bedroom

Satellite Dish Prep

Winegard® Power Lift Digital TV Antenna

Infra-Red Reapter® System to Operate Audio/Video Components

OPTIONS

Sony® 40" LED TV in Front Overhead Cabinet*

Sony® 46" LED TV on Televator*

Exterior Entertainment Center Located in Sidewall with Sony® 40" LED TV

Remote-Controlled Rearview Color Camera

Winegard® In-Motion Satellite without Receiver

Security System

Extra Monitor for Navigation System on Passenger Side

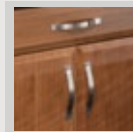

Cabinets & Furniture

Amish craftsmanship and elegance in design meld the wood cabinetry and furniture seamlessly with the Newmar interior.

Sable Maple High Gloss Hardwood Unitized Cabinets with Fully Overlaid Cabinet Doors

Polished Solid Surface Countertop in Kitchen with Undermounted Glass Sink

Dinette Styles Vary, See Floorplans for Availability*

Polished Solid Surface Countertop in Bathroom with Integrated Bowl or Vessel

Polished Solid Surface Countertop on Bedroom Nightstands and Chests

Residential Style Full Extension Ball Bearing Drawer Guides

Concealed Hinges on Cabinet Doors

Villa™ Furniture

Heated Front Seats with Power Lumbar, Footrest, Recline & Oversized Passenger Seat

Cedar Paneling in Rear Wardrobe

Lifts on Bed Top

Pullout Pantry Shelves*

Passenger Seat Work Station

Sleep Number® Premier Air Mattress

Power Sofa in Door Side Slideout*

OPTIONS

Amaretto Glazed Maple High Gloss Hardwood Cabinets

Rattan Maple Glazed High Gloss Hardwood Cabinets

Ginger Glazed Cherry High Gloss Hardwood Cabinets

Villa™ Ultra Leather Sofa/Dinette Ensemble with Two Folding Chairs*

Villa™ Two Ultra Leather/Vinyl Recliners*

Villa™ Extenda "L" Sofa on off Door Side*

Villa™ Extenda Flex Dinette with Two Folding Chairs*

Villa™ Sofa/Euro Booth Dinette Ensemble with Two Folding Chairs*

Traditional Décor Styling Package

Bar Dinette*

Overhead Cabinet Above Sofa/Dinette Area*

Power Bed/Sofa Base*

Massage Feature Added to Driver/Passenger Seats



Electrical Features

A Newmar coach's electrical and lighting system is designed for maximum reliability, functionality, and style.

12.5 kW Cummins Onan® Diesel Quiet Generator on Hydraulic Slide

50 Amp Electrical Service with Flexible Cord

Eight 6-Volt AGM House Batteries on Pullout Tray

5 Watt Solar Panel

Solar Prep Wire from Roof to Charge House Batteries

Battery Disconnect Switch

Two 2800 Watt Pure Sine Inverters

Midship Side Turn Signals

Recessed Docking Lights

Engine Block Heater

LED Interior Lighting

Exterior LED Accent Lights Below Door Side Slideout & Perimeter of Unit

LED Lights on Girard Side Awnings

ICC Light Flasher Switch

Accent Lights in Ceiling, Lambrequins, Kitchen, Bed Base, Fascia Trim & Dash

Silverleaf® Multiplex Control System

Interior Courtesy Lights

Emergency Engine Start Switch

12-Volt Auxiliary Recept

110-Volt Exterior Recept

Automatic Generator Start

Manually Operated Hold-To-Run Slideout Switch

Bluetooth Interface for Keyless Entry and Air Conditioning

Recept with Built in USB Charger at Dinette and Bedroom Dresser Cabinet

OPTIONS

Roof-Mounted Spot Light

Six Sunforce Flexible 95-Watt Solar Panels on Roof

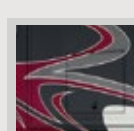

Exterior Features

The Full-Paint Masterpiece Finish is one of the most beautiful and durable in the industry, with the goal of a perfect finish, every time.

Full-Paint Masterpiece™ Cut & Buff Finish with Nano Shield Protection

Exterior Painted Graphics Blended from Top Down

Chrome Trim Package

Convex Exterior Chrome Mirrors with Remote Control, Defrost, Turn Signals & Side View Cameras

Dual Latch Front Door with Power Flush Stepwell Cover

Power Locking Baggage Doors

Rear Hitch for Towing Car

Holding Tank Levels Displayed in Exterior Water Works Compartment

Lighted Exterior Storage Compartments with Cargo Liner

Stainless Steel Kick Panel at Entrance Door

Keyless Entry with Doorbell and Touch Pad

Automatic Step for Entrance Door

Undercoating

Rear Protective Stainless tow Guard

Large Storage Tray

Two Power Sliding Storage Trays

Powered Door Lift for Engine Access

OPTIONS

Vinyl Graphics Extended Through Windows

Stainless Steel Trim Kit for Exterior Compartment Doors



Interior Features

Flooring – both tile and carpet – is installed with Newmar's own in-house process, ensuring the best in quality and longevity, as well as the finest fit.

Designer Feature Ceiling

Auto Motion Power Dual Window Shades and Lambrequins

Auto Motion Power Shades for Windshield and Driver/Passenger Side Windows

Polished Solid Surface Window Sills

Polished Porcelain Floor Tile in Kitchen, Bedroom, Living Room and Entrance Areas

Shoe Storage Shelves Recessed into Rear Cap Wardrobe

Carpeting on Slideout Floors

Safe Located in Bedroom Wardrobe

Quilted Bedspread, Matching Bed Skirt and Accent Pillows

10 Bc fire Extinguisher, Carbon Monoxide and Smoke Detectors

OPTIONS

Power Silhouette Window Shades

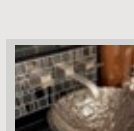

Plumbing & Bath Features

The Demand Water System's residential flow response ensures that the comfort and reliability of home are never far away.

Demand Water System with Aquajet™ "ES" Pump

Dometic® Concerto China Bowl Stool in Center Bath (Macerator Stool in Rear Bath)*

Solid Surface Shower Surround with Decorative Inserts

Three Monitor Panels (Two in Front and One in Bedroom)

Manabloc® Plumbing System

Auto Water-Fill System

Whole House Water Filter

Power Rewind Water-Hose Reel

Stainless Steel Front on Exterior Convenience Wash Station

Fold Down Shower Seat

Sewage and Grey Holding Tank Rinse

OPTIONS

RV Sanicon System



Windows, Vents & Awnings

Experience as much – or as little – of the outdoors as you want in comfort and style.

Frameless Double-Pane Tinted Safety-Glass Windows

Fan-Tastic® Vent with Rain Sensor in Kitchen Area and Bathroom

Driver's-Side Power Window

Girard® Slideout Covers, Power Awnings on Windows and Entrance Door

Two Girard® Nova Power Side Awnings with Wind Sensor, Remote Control & LED Lights

One Piece Bonded Tinted Windshield

Skylight Above Shower

OPTIONS

Large Window Above Bed Concealed with Sliding Doors

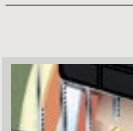

Construction Features

From the chassis on up, Newmar coaches are built to be dependable, durable, comfortable, and beautiful.

Power Lock Arms on All Slideout Rooms

5/8" Foam Insulation Laminated in Sidewalls and Ceiling

Gelcoated Fiberglass Exterior Sidewalls, Front and Rear Cap

Aluminum-Frame Sidewalls and Roof Construction, 16" on Center

Fiberglass Roof with Walkable Decking

Polar Pak R19 Batten insulation in Roof

*Check with dealership on floor plan availability and complete listing of features.

KING AIRE CONSTRUCTION

The Spartan® K3's strong chassis with 20,000 lb. IFS (Independent Front Suspension) is the highest performing motor coach ever. Its tubular truss web frames and substructure beams form a foundation stable enough to allow extensive pass-through storage. This – and King Aire's GVWR of 54,000 pounds, with a 14,000 pound tag axle – allows King Aire to expand beyond its chassis footprint, creating extra living space. Its Cummins® ISX 600 HP engine gives you incredible maneuverability and power, even on steep inclines.

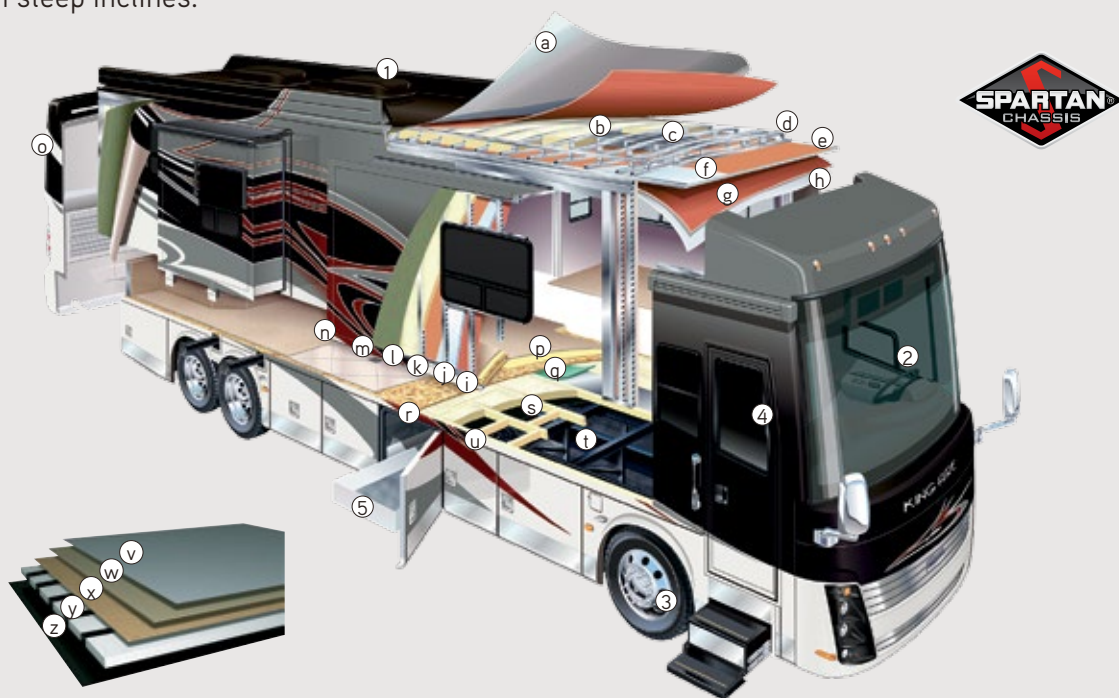

KING AIRE SPECIFICATIONS

Floor Plan	Engine HP	Axle Ratio	Fuel Cap.	Wheel Base	Front GAWR*	Rear GAWR*	Tag GAWR*	GVWR*	GCWR*	App. UVW	App. NCC
4584	600	430	200 gal.	292+TAG	20,000 lb.	20,000 lb.	14,000 lb.	54,000 lb.	69,000 lb.	46,900 lb.	7,100 lb.
4592	600	430	200 gal.	292+TAG	20,000 lb.	20,000 lb.	14,000 lb.	54,000 lb.	69,000 lb.	46,900 lb.	7,100 lb.
4593	600	430	200 gal.	292+TAG	20,000 lb.	20,000 lb.	14,000 lb.	54,000 lb.	69,000 lb.	46,900 lb.	7,100 lb.
4594	600	430	200 gal.	292+TAG	20,000 lb.	20,000 lb.	14,000 lb.	54,000 lb.	69,000 lb.	46,900 lb.	7,100 lb.
4597	600	430	200 gal.	292+TAG	20,000 lb.	20,000 lb.	14,000 lb.	54,000 lb.	69,000 lb.	46,900 lb.	7,100 lb.
4599	600	430	200 gal.	292+TAG	20,000 lb.	20,000 lb.	14,000 lb.	54,000 lb.	69,000 lb.	46,900 lb.	7,100 lb.

ROOF R-VALUE = 24

- a. Fiberglass Roof
- b. Fiberglass Batten Insulation
- c. A/C Ducting
- d. Aluminum Rafter Framing
- e. Kraft Paper Vapor Barrier
- f. 5/8" Bead Foam
- g. 3/16" Panel
- h. Padded Vinyl Overlay

SIDEWALL R-VALUE = 11

- i. 3/16" Plywood Interior Wall
- j. 5/8" Bead Foam
- k. Kraft Paper Vapor Barrier
- l. Fiberglass Batten Insulation
- m. 3/16" Plywood Exterior Wall
- n. Composite One-Piece Gelcoat Exterior Sidewall
- o. Aluminum Framing with 3 1/2" Header Above

FLOOR R-VALUE = 16

- p. Carpet/Tile
- q. Carpet Padding
- r. 5/8" Floor Decking
- s. Fiberglass Batten Insulation
- t. 2"x 3" Wood Framing
- u. Polyethylene Moisture Barrier

BASEMENT R-VALUE = 4

- v. Cargo Liner
- w. 3/8" Floor Decking
- x. 3/16" Luan Panel
- y. 1 1/2" Bead Foam
- z. Aluminum Sheeting with Steel Support Rails to Prevent Bowing and Flexing

1. 15M Penguin™ Heat Pump Central Air Conditioners (3)
2. One-Piece Bonded Windshield
3. Coated Aluminum Wheels
4. Frameless, Double-Pane, Tinted Safety-Glass Windows
5. Side-Hinged Baggage Doors

Lengths, heights, widths and dry weights are approximate. Weight will vary based on optional equipment added to the above base weight.

GAWR: Gross Axle Weight Rating is the maximum permissible weight for an axle.

GVWR: Gross Vehicle Weight Rating is the maximum permissible weight for a fully loaded motor coach.

GCWR: Gross Combination Weight Rating is the value specified by the manufacturer of the vehicle as the maximum allowable loaded weight of this motor coach and any towed trailer or towed vehicle.

UVW: Unloaded Vehicle Weight is the weight of this motorcoach as built at the factory with full fuel, engine oil and coolants. The UVW does not include cargo, fresh water, propane gas or dealer-installed accessories.

NCC: Net Carrying Capacity is the maximum weight of all occupants, including the driver, personal belongings, food, fresh water, waste water, propane gas, tools, tongue weight of towed vehicle, dealer-installed accessories, etc., that can be carried by the motor coach.

*Specifications supplied by the chassis manufacturer.

Trust.

The strongest possible foundation for a motor coach.

According to Newmar president Matthew Miller, "Customers say they're loyal to us because they trust us to stand behind our products – from support, parts and service to paying our warranties. It feels good to own a coach that has all of that behind it."

How do we sustain this high level of service? At Newmar, there's a Miller way of doing things. These principles guide us every day. Courtesy. Integrity. And reliability. So when you buy from Newmar, you know that every single person who touches your coach or talks with you has your back. Period.

Our Partners.

Where the finest names in quality and performance are along for the ride.

Newmar strives to offer the best motor coach experience possible, and to that end we partner with the most prestigious names in mobile lifestyle, entertainment, and technology. Depending on the Newmar motor coach you choose, our compliments range from Sony's comprehensive audio, video, communications and information technology to Freightliner and Spartan's superior and dependable chassis designs. Newmar only accepts best-in-class performance from the most trusted names in the business. At Newmar, that's our difference. And our promise.



▲ Mahlon Miller, Newmar founder, and Matthew Miller, Newmar president, lifelong motor coach enthusiasts



2014 King Aire

NEWMAR EXPRESS LIMITED WARRANTY

Every King Aire Diesel Pusher is backed by Newmar's one-year limited warranty/unlimited miles. Ask your Newmar dealer for details.

LIMITED FIVE-YEAR STRUCTURAL WARRANTY

If any part of your Newmar recreational vehicle superstructure (which is the steel/aluminum structure of the sidewall, roof or frame) fails to perform properly within five years from the date of purchase because of faulty workmanship or material supplied by Newmar, it will be repaired without charge for either parts or labor by Newmar. This structural warranty is available only to the original purchaser and is non-transferable.

Some features in our literature are optional. Colors and finishes are photographic representations. The actual materials may look different. Prices, specifications and floorplans are subject to change at Newmar's discretion, without prior notice or obligation. Please see your dealer for actual samples and specifications.



WHEN YOU KNOW THE DIFFERENCE SM

NEWMAR CORPORATION
355 N DELAWARE ST
PO BOX 30
NAPPANEE IN 46550-0030
574-773-7791 Fax 574-773-2895

www.newmarcorp.com