

STREAMLITE

SPORT

QUALITY, VALUE & INNOVATION SINCE 1983



STREAMLITE
SPORT





1 Solid Maple Glazed Chestnut Cabinet Doors w/ Mortise and Tenon Construction: A rich, contemporary design that will last .

2 4 Different Décors by Milliman Design: Quality, beauty and durability by a top design team. We even finish off by adding lambrequins to your windows.

3 Large Contoured Countertops: Up-to-date styling that give you abundant counter space.

4 Deep Well Sinks with High-Rise Faucets in Kitchen: No more worrying which pans to bring on your trip. They all fit.

5 Congoleum® No-Wax Vinyl Flooring: A step above the rest. Easy to clean and lasting luxury even after the mud is tracked in after a sudden down pour.

6 Hardwood Screwed Stiles: No staples! All stiles are pocket-screwed for strength and longevity.

7 Large Double Door Refrigerator: This high quality appliance will preserve the temperature of your goods. It keeps your picnic needs fresh with state of the art insulation and seals.

8 Ducted Above Floor Furnace: Keep the heat in the unit. We duct above floor so you don't fight the elements outside. Makes sense!!

9 6 feet, 6 inches: That's how much of interior height we give you. 80 inches gives you headroom and us more area to put cabinetry for you.



— relax.
 ————— enjoy.
 ————— save.

Don't settle just because you're concerned about fuel economy. The ultra lightweight Streamlite Sport has all of the comforts of home in six innovative floor plans that won't break you at the pump. The details separate the Sport from the rest.

Yes, there is a trailer that makes camping affordable. Start creating memories that will last a lifetime in a Streamlite Sport!

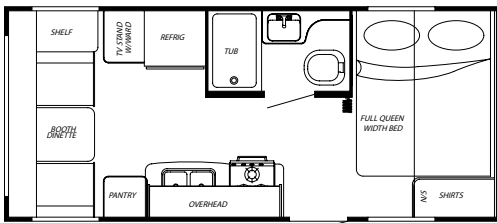

20 TRD

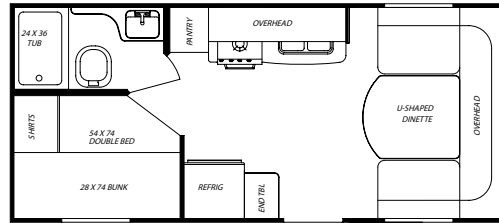

21 TSB

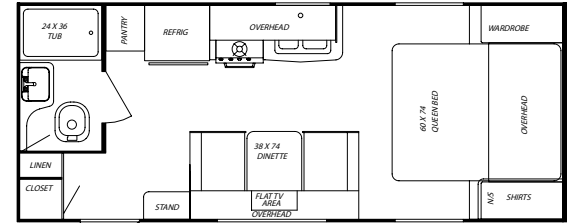

22 TRB

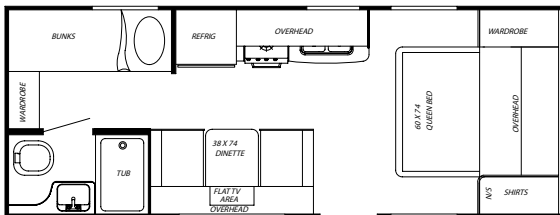

24 RBH

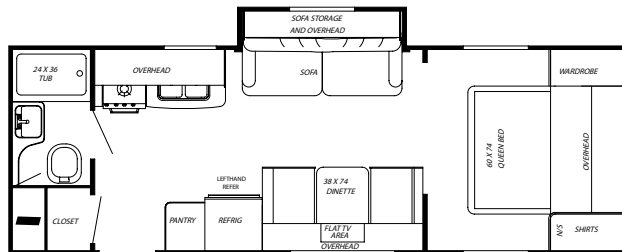

25 TSS

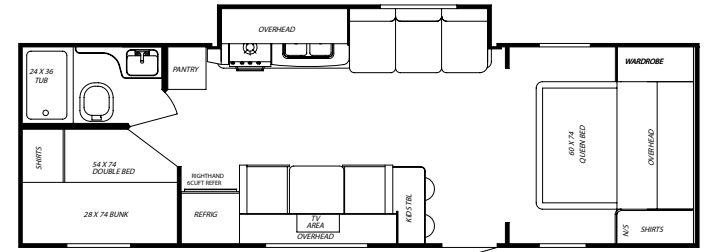

27 BKS

MODEL NAME	20TRRD	21TSB	22TRB	24RBH	25TSS	27BKS
Length Apx.	22' 4"	22'	24'	25'	27' 10"	30' 6"
Net Carrying Cap.	2640	2557	2207	2527	3112	3023
Hitch Weight	440	400	360	560	520	500
Total Dry Weight	3360	3403	3643	3593	4368	4437
Fresh Water	44	44	44	44	44	44
Black Water	37	37	37	37	37	37
Gray Water	37	37	37	37	37	37

STREAMLITE
 SPORT

standards & options

exterior

- Low Center of Gravity
- Powder-Coated 6' I-Beams
- Double-Step Entry
- 3500 lb. Leaf Spring Suspension
- 14' Trailer Rated Tires
- 10" Electric Brakes
- Galvanized Steel Wheel Wells
- Welded Aluminum Framed Laminated Walls
- Welded Aluminum Framed Laminated Floors
- All Route-Outs Framed for Added Strength
- Truss Roof with Lightweight Decking
- Vinyl Roof
- Electric-Powered Slide-Out
- Easy Lube Hubs

- Dual LP Bottles 40 lbs.
- Ext. Height 119" with A/C
- Radius Windows with Tinted Glass
- Radius Entry Door with Window
- Insulated Radius Luggage Doors
- Large Window at Dinette
- Porch Security Light
- Eye-Catching Exterior Graphics
- Roto-Cast Holding Tanks
- Pre-Wired for Roof A/C

appliances & equipment

- 2-Door Refrigerator
- 3-Burner Range Top
- Power Range Hood with Light
- 55 Amp Converter
- Monitor Panel
- Power Bath Vent
- Medicine Cabinet with Mirror
- Shower Curtain
- 20,000 BTU Furnace

interior

- 4 Designer Interiors

- 80" Interior Headroom
- Solid Lumber Core Framed Cabinets
- Mortise/Tenon Hardwood Cab Doors
- Large 60/40 Galley Sinks
- Residential Valances with Lambrequins
- Mini Blinds for Privacy
- No-Wax Seamless Vinyl Flooring
- Reversible Dinette Cushions
- Wall Border
- Lightweight Poly Mattress
- Formica Counter Tops

options

- 4-Stab Jacks with Sand Pads
- TV Antenna with Cable
- Awning
- Tub Surround
- 6 Gal. DSI Electric Water Heater
- Sink Cover
- 14" Spare with Mounting Kit
- Outside Spray Port
- AM/FM/CD Player with Exterior

- Speakers
- 13.5 BTU Roof A/C
- 19" LCD TV
- Tinted Safety Glass
- Exterior Gas Grill
- Oven
- Microwave
- Frt Expandable(21 TSB Only)
- 2 Bar Stools (27 BKS Only)

Decor Options



Family owned for 25 years, Gulf Stream Coach is a leading manufacturer of high quality and high value RV products that are distributed through a partnership of independent dealers who are focused on exceeding customer expectations.

Located in the heart of the Amish country, the Gulf Stream complex covers over 200 acres and includes more than 1.5 million square feet of state-of-the-art manufacturing facilities fostering the most creative and innovative culture in the RV industry.

Gulf Stream has been awarded the prestigious Platinum Recreational Vehicle Manufacturer Quality & Productivity Award multiple times in recognition of our commitment to producing quality recreational vehicles.

Your family and friends will feel safe and comfortable in a Gulf Stream travel trailer or fifth wheel. Compare and you will see the exceptional value!

2-YEAR Warranty!

In addition to our standard one year warranty, Gulf Stream Coach, Inc., offers an exclusive 24 month warranty on structural components. In addition, major component manufacturers are providing 24 month warranties on their products installed in Gulf Stream units such as refrigerators, antenna, furnace, water heater, air conditioner, awning, range, microwave and more. See the official written Gulf Stream Coach, Inc., Warranty for details. *for purposes of this warranty, "structural components" shall be limited to the structure of the side walls, front and back walls, roof and floor.

www.gulfstreamrv.com



POST OFFICE BOX 1005

NAPPANEE, IN 46550

• YOUR GULF STREAM COACH DEALER •

For more information and available options, contact your local Gulf Stream dealer, www.gulfstreamRV.com or Gulf Stream Coach, Inc. Gulf Stream Coach, Inc., reserves the right to make changes in prices, colors, materials, components and specifications and to discontinue models at any time without notice or obligation. Gulf Stream Coach, Inc., assumes no responsibility for any error in type or print reproduction of specifications or floorplans in this brochure. Photographs may show equipment or items that are optional and are not included in the purchase price of the coach. Test drive and review a current model at your nearest Gulf Stream dealer. © 2002 Gulf Stream Coach, Inc., Nappanee, Indiana U.S.A. 6/09