

ROCKWOOD

Freedom • Premier • High Wall • Hard Side

ROCKWOOD Freedom • Premier • High Wall • Hard Side







Rockwood

Freedom

Yes, you're camping, but that does not mean your comfort stays home. Residential living standards that make life easy make camping easy.

Features like the three-speed Create-A-Breeze ventilation fan to pull in fresh outside ambient air so you remain comfortable at night, and swing level galley to keep kitchen utensils in their place are simple amenities that add tremendously to the comfort of your vacation. It's your vacation. Do it right.



Standards & Options

Metal drawer guides (Std.)



Outside grill with work table (Std. Freedom, Premier, Hard Side, High Wall Opt. LTD)



Plywood Bed Ends (N/A Hard Side)



Crank Down Stabilizer Jack (Std.)



Easy glide scissorpole bed supports (Except LTDs)



Under floor 20 gallon water tank (Except LTDs)

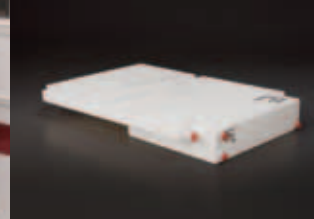

Heated Mattress (Std. Opt.)



Swing down galley (Except LTDs)







Rockwood

Premier

The Rockwood Premier is the premier tent camper on the market today.

It is loaded with features that make your camping experience more enjoyable. From the expansive sliding storage trunk for that extra cargo space, to a comfortable, heated, inner-spring mattress, for a peaceful night's sleep and the convenient power lift system for easier setup are some of the basic features that really make your camper a Premier.



Standards & Options

Hanging Shirt Bar
(Std. Premier & High Wall)

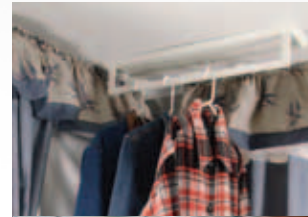

Sliding Storage Trunk
(Some Models)



Fantastic Fan
(Except LTDs.)



Outside Shower
(Incl. w/ Hot Water Pkg: Std: Premier, Hard Side, High Wall and Opt: Freedom)



Water Pump
(Std.)



Bunk Light and Fan
(Std. Premier & High Wall)



Port-a-Potty
(Std. on Selected Floorplans)



Water Filter
(Std. with Hot Water Heater)



One-Piece Door
(Except LTDs, Hard Side)







Rockwood

High Wall

*Wanting to camp but don't want to "rough it?"
Welcome to the Rockwood High Wall Series.*

We have designed this series for the camping family who wants the refinement of larger vacationing units in a light-weight camper. Ample counterspace, upgraded appliances and tasteful interiors make this camper a gorgeous option to experience.



Standards & Options

Add-a-Room with Privacy Panels
(Opt. all Models Except Hard Side)



Power Lift
(Std. Premier, Hard Side High Wall and Freedom XR models Opt. LTD. and Freedom)



Hanging Wardrobe
(Opt. all Models Except Freedom, Hard Side & LTD's)



Hanging Pantry
(Opt. all Models Except Hard Side LTD's)



Beautiful hardwall shower with a residential-style flush toilet complete with a 12-gallon black water holding tank.
(Std. High Wall Except HW257)



Exterior Speaker
(Std. Premier, Hard Side & High Wall)



AM/FM Stereo with CD Player
(Std. Premier, Hard Side & High Wall)



Rockwood

Construction



- 1) Three Stage Double Arm Lifter Posts (NA Hard Side)
- 2) Fiberglass Vacuum Bonded Radius Roof w/ No Center Seam (NA Hard Side)
- 3) Five-Piece Vinolon Supreme Tenting (NA Hard Side)
- 4) E-Z Crank Down Stabilizer Jacks w/Sand Pads
- 5) Full Perimeter Aluminum Bed Frames (NA Hard Side)
- 6) Plywood Bunk Ends (NA Hard Side)
- 7) Seven-Way Pigtail Wiring
- 8) Under Floor 20 Gallon Fresh Water Tank (LTDs 11 Gallon Above Floor)
- 9) Powder Coated Tubular Steel Frame
- 10) Powder Coated Rafter Poles and Bed Bows (NA Hard Side)
- 11) Air Conditioner Reinforcing Laminated Into Roof (NA Hard Side)
- 12) Steel Radial Tires
- 13) Easy Lube Axles (Except LTDs)
- 14) Smooth Fiberglass Vacuum Bonded Exterior (NA on Freedoms)
- 15) One-Piece Door (Except LTDs & Hard Side)

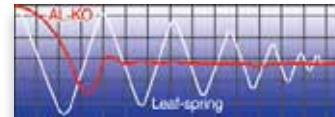
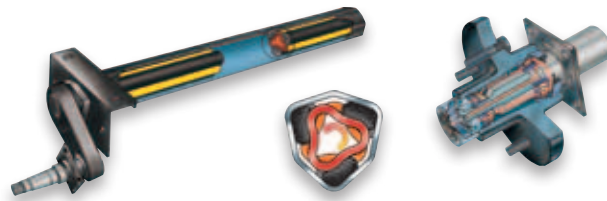

The UltraLube™ Hubs allow you to repack bearings quickly and easily without disassembly.

ALKO® AXLES AND EASY LUBE HUBS

AL-KO Axles offer many advantages over conventional axles:

- Fully Independent Wheel Suspension
- No Metal to Metal Contact and No Springs, Shackles, Hangers, or U-bolts to Break or Wear Out
- Lower Trailer Center of Gravity For Improved Stability

Note: Torsion Axles on Premiers, HS's and HW's only. Easy-Lube Hubs on all units except LTDs.





Rockwood

Hard Side

When you combine the solid exterior of a travel trailer with a Premier tent camper, you get the Rockwood Hard Side Series, giving your camping experience the best of both.

Bringing a smooth, fiberglass vacuum bonded exterior with a quick, easy set up, while retaining the towing and storage advantages of a tent camper, the Hard Side camper is the perfect blend.



Hard Side Awning & Screen Room option.

FLOORPLANS & SPECIFICATIONS

A102

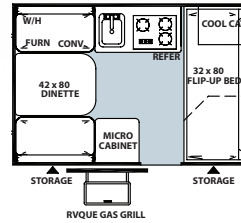

A122

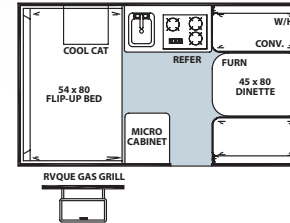

A124

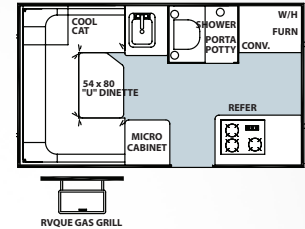

A127TH

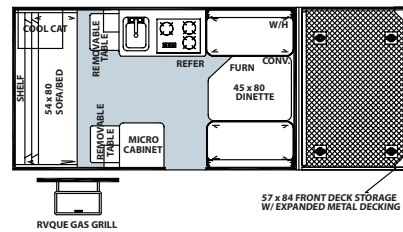

A128S

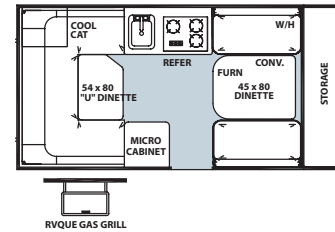

A122BH

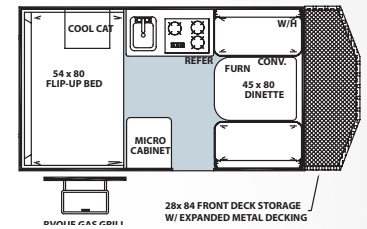

Specifications

Model number of any particular unit does not necessarily reflect the overall length of the unit itself. Dry weight are estimates.

MODEL	A102	A122	A124	A127TH	A128S	A122BH
GVWR (Gross Vehicle Weight Rating)	2415	3261	3250	3835	3152	3277
BASE/DRY UNIT WEIGHT	1666	1861	1829	2098	1916	1921
BASE DRY HITCH WEIGHT	252	261	253	335	262	277
BASE DRY AXLE WEIGHT	1414	1600	1829	1763	1654	1197
CARGO CAPACITY	816	1217	1217	1532	1217	1217
BOX SIZE	10'	12'	12'	12'	12'	12'
TRAILER SIZE (Closed w/ Hitch)	15' 1"	17' 1"	17' 1"	22' 1"	18' 11"	18' 2"
HEIGHT (Closed)	60"	60"	60"	62"	60"	60"
FRESH WATER CAPACITY	26	26	26	26	26	26

Rockwood

Premier

Specifications

Model number of any particular unit does not necessarily reflect the overall length of the unit itself. Dry weight are estimates.

MODEL	1904	1907BH	2317G	2514G	2516G
GVWR (Gross Vehicle Weight Rating)	3212	3283	3358	3303	3292
BASE/DRY UNIT WEIGHT	1986	1996	2445	2446	2473
BASE DRY HITCH WEIGHT	258	283	358	303	292
BASE DRY AXLE WEIGHT	1728	1713	2087	2143	2181
CARGO CAPACITY	1017	1268	894	838	800
BOX SIZE	10'	10'	12'	12'	12'
TRAILER SIZE (Closed w/ Hitch)	17' 1"	17' 3"	19' 1"	19' 1"	19' 1"
HEIGHT (Closed)	57"	57"	61"	61"	61"
TRAILER LENGTH (Open)	20' 4"	20' 2"	23' 9"	23' 9"	23' 9"
FRESH WATER CAPACITY	26	26	26	26	26

1904

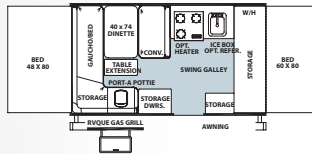

1907BH

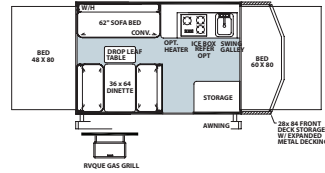

2317G

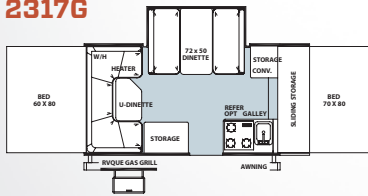

2514G

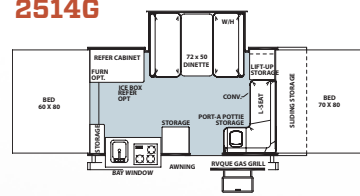

2516G

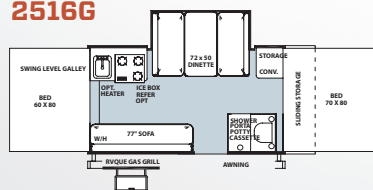

Rockwood

High Wall

Specifications

Model number of any particular unit does not necessarily reflect the overall length of the unit itself. Dry weight are estimates.

MODEL	HW257	HW 276	HW 277	HW296
GVWR (Gross Vehicle Weight Rating)	3815	3779	3859	4573
BASE/DRY UNIT WEIGHT	2773	2806	2959	3135
BASE DRY HITCH WEIGHT	315	279	359	373
BASE DRY AXLE WEIGHT	2458	2527	2600	2762
CARGO CAPACITY	1042	935	862	1217
BOX SIZE	12'	14'	14'	16'
TRAILER SIZE (Closed w/ Hitch)	19' 1"	19' 4"	19' 4"	21' 4"
HEIGHT (Closed)	68"	68"	68"	68"
TRAILER LENGTH (Open)	23' 9"	25' 9"	25' 9"	27' 9"
FRESH WATER CAPACITY	26	26	26	26
GRAY WATER CAPACITY	6	12	12	12
BLACK WATER CAPACITY	N/A	12	12	12

HW257

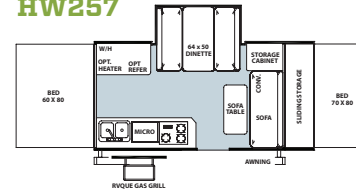

HW276

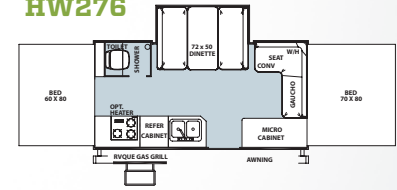

HW277

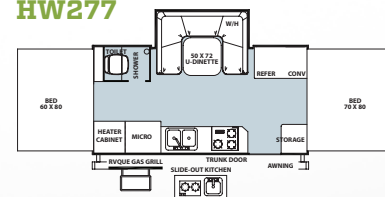

HW296

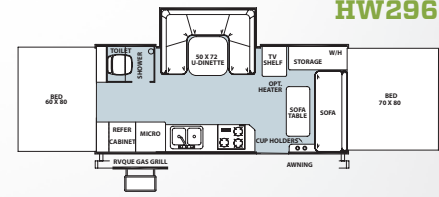

1910

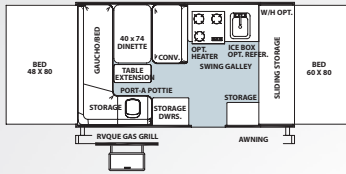

1950

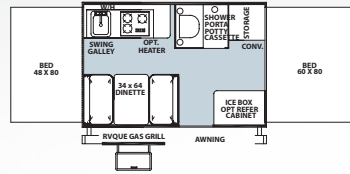

1970

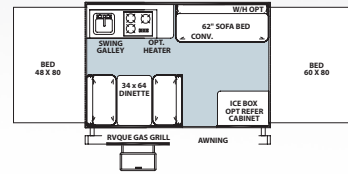

1980

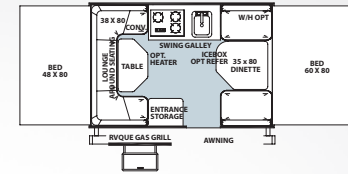

2270

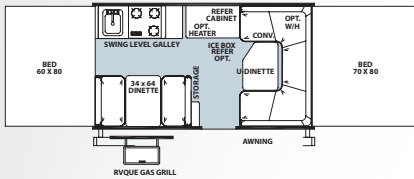

2280

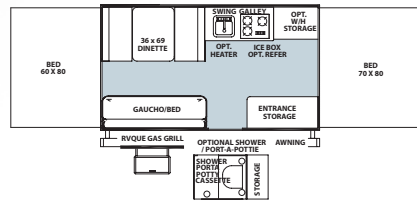

2280BH

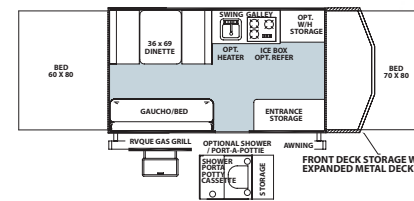

2318G

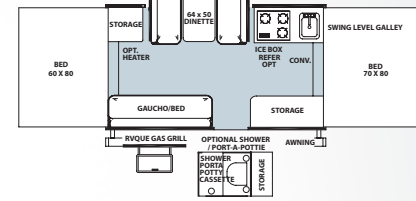

2560G

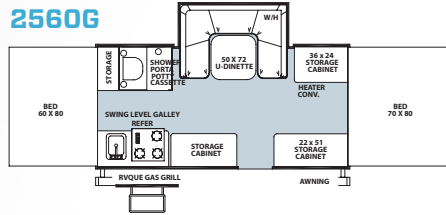

232XR

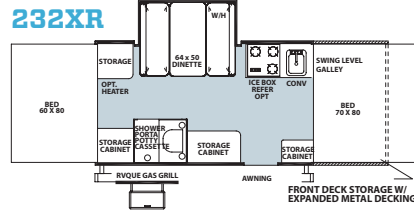

282TXR

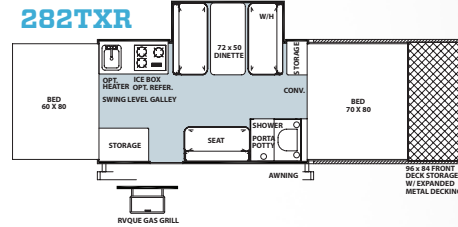

Rockwood Freedom

Specifications

Model number of any particular unit does not necessarily reflect the overall length of the unit itself. Dry weight are estimates.

MODEL	1910	1950	1970	1980	2270	2280	2280BH	2318G	2560G	1640LTD	1940LTD	232XR	282TXR
GVWR (Gross Vehicle Weight Rating)	2983	2876	2786	2768	3043	3081	3100	3063	3249	2148	2274	3810	5579
BASE/DRY UNIT WEIGHT	1867	1732	1764	1737	2006	2050	2064	2153	2364	1344	1493	2579	2975
BASE DRY HITCH WEIGHT	233	240	252	219	293	331	350	313	249	190	174	310	219
BASE DRY AXLE WEIGHT	1634	1492	1512	1518	1713	1719	1714	1840	2115	1154	1319	2269	2756
CARGO CAPACITY	1097	917	866	866	966	966	1017	891	866	683	762	1212	2317
BOX SIZE	10'	10'	10'	10'	12'	12'	12'	12'	14'	8'	10'	12'	12'
TRAILER SIZE (Closed w/ Hitch)	17' 1"	15' 3"	15' 3"	15' 3"	17' 2"	17' 2"	18' 8"	17' 2"	19' 2"	12'	14'	21' 9"	26'
HEIGHT (Closed)	57"	57"	57"	57"	57"	57"	57"	57"	57"	57"	57"	62.5"	62.5"
TRAILER LENGTH (Open)	20' 4"	20' 1"	20' 1"	20' 1"	23' 10"	23' 10"	23' 10"	23' 10"	25' 10"	17' 1"	20' 1"	26' 5"	30' 8"
FRESH WATER CAPACITY	20	26	20	20	20	20	20	20	26	11	11	26	26

Rockwood Tent Camper Standards & Options Standards & Options are subject to change

Models	LTD	F	P	HS	HW	Models	LTD	F	P	HS	HW	Models	LTD	F	P	HS	HW	
STANDARD & OPTIONAL FEATURES																		
Cherry Interior with "Tile-Look" Linoleum	--	--	S	S	S	Three Burner Stove with Oven	--	--	--	--	S	2 Single Ceiling Lights	S	--	--	--	--	
Hickory Interior with "Tile-Look" Linoleum	S	S	--	--	--	Microwave	--	--	--	S	S	3 Single Ceiling Lights	--	S	--	--	--	
Two-Tone Fabric Interiors	S	S	S	S	S	Large Built-In Icebox	S	S	S	--	--	2 Double Ceiling Lights	--	--	--	S	--	
Residential Style Kitchen Faucet w/ Electric Water Pump	S	S	S	S	--	1.9 Cubic Ft. Refrigerator	0	0	--	--	--	3 Double Ceiling Lights w/ Jacks for Accessories	--	--	S	--	S	
Stainless Steel Look Appliances and Sink	--	--	--	S	S	3 Way Refer 2.5 cu. ft. 110V & 12V	--	--	0	S	--	Bunk Light with Fan	--	--	S	--	S	
Double Pan Sink with High Rise Faucet	--	--	--	--	S	Extra Large 4.0 cu. ft. Refrigerator	--	--	--	--	0	LP Leak Detector	S	S	S	S	S	
Electric Water Pump	S	S	S	S	S	Free Standing Lite-Ply Table - High Pressure Laminate	S	S	S	S	S	Carbon Monoxide Detector	0	0	0	0	0	
Hot Water Package (Incl. Water Filter, Outside Shower, Six Gallon DSI Hot Water Heater) (F: 1910, 1970, 1980, 2270, 2280, 2280BH, 2318G)	--	0*	S	S	S	Comfortable Family Style Dinette w/ 4" Reversible Cushions	S	OPA	S	S	S	Privacy Curtains	S	OPA	S	S	S	
Port-a-Potty (F: 1910 Only P: 1904, 2514G HS: A122, A122BH, A128S, A127TH)	--	S*	S*	S*	--	Residential Style Raised Panel Doors	--	--	S	S	S	Lined Privacy Curtain	--	--	S	S	S	
Shower Cassette Package Incl. Water Filtration System, Six Gallon DSI Hot Water Heater, Demand Water Pump, and Cassette Toilet (Opt. F: 2280, 2280BH, 2318G) (Std. F: 1950, 2560G, 232XR, 282TXR P: 2516G, HS: A124)	--	S*/0*	S*	S*	--	Wood Drawers w/ Metal Guides	S	S	S	S	S	Roof Valances	--	OPA	S	--	S	
Hard Wall Shower with Residential Flush Toilet (N/A HW257)	--	--	--	--	S*	Large Clothes Bar	--	--	S	S	S	Quilted Top Bed Mattresses	S	S	--	--	--	
Fold Over Galley with Upper and Lower Storage (Std. P: 2514G Only)	S	--	S*	--	--	Hanging Wardrobe	--	--	0	--	0	Quilted Top Innerspring Mattresses (HS: A122, A122BH Only)	--	--	S	S*	S	
Two Burner Free-Standing Range	S	--	--	--	--	Hanging Pantry	--	0	0	--	0	Thermostatically Controlled Heated Mattresses (HS: A122, A122BH Only)	0	0	0	S*	0	
Swing Level Galley with Storage (N/A P: 2514G, 2317G)	--	S	S*	--	--	AM/FM Stereo with CD player	--	--	S	S	S	Leaf-Spring Axle	S	S	--	--	--	
Permanently Mounted 3-Burner Indoor Range w/ Stove Cover	--	S	S	S	--	TV Outlet with Cable and Satellite Hook Up	--	S	S	S	S	Independent Torsion Axles	--	--	S	S	S	
						LCD TV (HW296 Only)	--	--	--	--	S*	Easy Lube Axles	--	S	S	S	S	
						25 Amp Converter w/ Built in Battery Charger	S	--	--	--	--	Spare Tire, Cover and Mount	S	OPB	OP1	S	OP1	
						35 Amp Converter w/ Built in Battery Charger	--	S	S	S	S	12" Radial Tires	S	--	--	--	--	
						12V Safety Switch	S	S	S	S	S	13" Radial Tires with Aluminum Wheels	--	S	S	S	--	
						Roof Vent	S	--	--	--	--	14" Radial Tires with Aluminum Wheels	--	--	--	--	S	
						Create-A Breeze Three Speed Fantastic Fan	--	SO	SO	SO	SO	15" Mud Rover Radial Tires, Aluminum Wheels & Shocks (Std. F: 232XR, 282TXR Only)	--	S*	--	--	--	
						Air Conditioner Wiring Kit	0	0	0	--	0	Electric Brakes	0	S	S	S	S	
						10k BTU Cool Cat Heat Pump	--	--	--	S	--	Sliding Storage Tray on All Front Trunk Models (Except P: 1904, HS: A128S)	--	S*	S*	S*	S*	
						13.5k BTU Air Conditioner	--	--	--	--	0							
						20k BTU Forced Air Furnace w/ Electric Ignition	0	0	0	0	0							
						Interior Floor Lights	--	--	--	S	S							

LTD = LIMITED,
F = FREEDOM,
P = PREMIER,

HS = HARD SIDE,
HW = HIGH WALL

S = STANDARD
SO = STANDARD OPTION
O = OPTIONAL

-- NOT AVAILABLE
* = SELECTED MODELS
OP = OPTIONAL PACKAGE



Models	LTD	F	P	HS	HW
28.5" Front Storage Deck w/ Removable Deck Railing (Std. F: 2280BH, P:1907BH, HS: A122BH Only)	--	S*	S*	S*	--
48" Front Storage Deck (Std. F: 232XR, HS: A127TH Only)	--	S*	--	S*	--
96" Front Storage Deck (Std. F: 282TXR Only)	--	S*	--	--	--
Power Lift System (Std. F: 232XR, 282TXR)	0	0	S	--	S
Battery Box and Wiring Kit	0	S	S	S	S
20 lb. LP Bottle	S	S	S	--	--
(2) 20 lb. LP Bottles (Std. F: 232XR, 282TXR Only)	--	S*	--	--	--
Dual 20 lb. LP Bottles with Cover	--	0	0	S	S
Automatic LP Regulator	--	0	0	S	S
Diamond Plated Front Cap	--	--	--	S	S
Diamond Plated Front, Rear and Side Skirt (F: 232XR, 282TXR Only)	--	S*	--	--	--
Awning	S	OPB	OP1	--	OP1
Awning/Screen Room	--	--	--	0	--
Screen Room w/ Privacy Panels	0	0	0	--	0
Outdoor Gas Grill w/ Worktable	0	S	S	S	S
Outside Speaker	--	--	S	S	S
Patio Light (LTD: 1940 Only)	S*	OPA	S	S	S
Courtesy Light on Front (F: 2280BH, 232XR, 282TXR P: 1907BH HS: All Models)	--	S*	S*	S	--
110V Exterior Outlet (LTD: 1940 only)	S*	OPA	S	S	S
Black Water Hose Storage (HW: N/A HW257)	--	--	--	--	S*
Installed Door Step	S	OPB	OP1	S	OP1
Installed Double Step (F: 232XR, 282TXR Only)	--	S*	--	--	--
One Piece Screen Door	--	S	S	--	S

Models	LTD	F	P	HS	HW
Folding Grab Handle	--	S	S	S	S
Exterior Graphic Design	S	S	S	S	S
Option Package 1 (Incl. Spare Tire, Tire Bracket, Tire Cover, Installed Step, Awning)	--	--	0	--	0
Option Pkg. B (Incl. Spare Tire, Tire Bracket, Tire Cover, Installed Step, Awning)	--	0	--	--	--
Option Pkg. A (Incl. Privacy Curtains, Roof Valances, 4" Foam Cushions w/ Cover, Under Floor 20 Gallon Fresh Water Tank, A/C Bracing, Patio Light, 110V Exterior Outlet)	--	0	--	--	--

STANDARD CONSTRUCTION FEATURES

Completely Enclosed Living Area	--	--	--	S	--
Fiberglass Vacuum Bonded Roof with Metal Interior Roof	--	--	--	S	--
Large Rear Roof Tinted Sky Light with Shade	--	--	--	S	--
Two Front Roof Tinted Windows with Shades	--	--	--	S	--
Fiberglass Vacuum Bonded Radius Roof w/ No Center Seam	S	S	S	--	S
Steel Air Conditioner Vent Reinforcing Laminated Into Roof	S	OPA	S	--	S
3-Stage Double Arm Lifter Posts	S	S	S	--	S
Smooth Fiberglass Vacuum Bonded Exterior	--	--	S	S	S
Lower Door Operational in Closed Position	S	S	S	--	S
Five Piece Sectionalized Vinolon Supreme Tenting and Slide Out	S	S	S	--	S

Models	LTD	F	P	HS	HW
Plywood Bunk Ends	S	S	S	--	S
Full Perimeter Aluminum Bed Frames	S	S	S	--	S
Easy Glide Scissor Pole Bed Supports	--	S	S	--	S
Powder Coated Rafter Poles and Bed Bows	S	S	S	--	S
Tinted Vinyl Windows	S	S	S	--	S
Large, Opening Picture Window	--	--	--	S	--
One Piece Undercoated Structure wood Floor	S	S	S	S	S
Powder Coated Tubular Steel Frame	S	S	S	S	S
Rear Crank Down Stabilizer Jacks w/ Sand Pads	S	--	--	--	--
(4) E-Z Crank-Down Stabilizer Jacks w/ Sand Pads	--	S	S	S	S
Seamless, High Density Polyethylene Wheel Wells	S	S	S	S	S
11 Gallon Fresh Water Tank	S	--	--	--	--
Under Floor 20 Gallon Fresh Water Tank	--	OPA	S	S	S
12 Gallon Gray Water Holding Tank (HW: N/A HW257)	--	--	--	--	S*
6 Gallon Gray Water Holding Tank (HW: HW257 Only)	--	--	--	--	S*
12 Gallon Black Water Holding Tank (HW: N/A HW257)	--	--	--	--	S*
2000 lb. Tongue Jack w/ Swivel Wheel	S	S	S	S	S
Power Front Jack	--	--	--	0	0
7-Way Pigtail Plug	S	S	S	S	S

LTD = LIMITED,
F = FREEDOM,
P = PREMIER,

HS = HARD SIDE,
HW = HIGH WALL

S = STANDARD
SO = STANDARD OPTION
O = OPTIONAL

-- NOT AVAILABLE
* = SELECTED MODELS
OP = OPTIONAL PACKAGE



PRE-DELIVERY INSPECTION FACILITY

20,000 square feet of quality assurance. The bare essentials for a premium product. This state-of-the-art facility gives immediate daily feedback to production for quality assurance in every unit built.



Forest River, Inc. encourages our customers to purchase their Forest River products from a local dealership whenever possible for the following reasons:

It is the goal of Forest River, Inc. that all of our RV owners fully enjoy the RV experience and that customer satisfaction meets or exceeds their expectations!

- 1) Forest River, Inc. dealers are independently owned and operated businesses so priority service and scheduling is at their discretion and is often provided to customers that purchased their unit at that dealership.
- 2) Purchasing locally allows customers to establish meaningful relationships with a dealer, enhancing the RV experience through assistance with product questions, user tips or RV regulations for your state or country, and much more!
- 3) Canadian customers must meet requirements to bring an RV purchased out of the country to their home. These requirements may involve additional inspections and certifications, taxes and fees. Your local Canadian Dealer is a professional at meeting these requirements.
- 4) Scheduling timely warranty repairs and adjustments through a local dealership provides far greater flexibility and convenience to you, the customer!

YOUR ROCKWOOD DEALER



Rockwood Tent Camper

Warranty

For details on Rockwood's complete warranty program, see your Rockwood dealer. When it comes to backing products with the same quality and commitment it does when it begins the manufacturing process, the only name you have to remember when you're looking for a recreational vehicle is Rockwood. Rockwood offers the following additional limited warranties to the original purchasers. Consult written warranty for details.

1. Five-year roof warranty, 2. Twenty-five-year floor warranty, 3. Five-year frame warranty, 4. Five-year tent warranty, 5. Five-year warranty on torsion axle suspension, 6. Limited life-time warranty of lifter system, 7. One-year bumper to bumper. Ask your dealer about the available lifetime structural warranty.



Learn More
Scan this barcode using a QR Reader on your smart phone to learn more about Forest River.



A Berkshire Hathaway company.

201 West Elm Millersburg, IN 46543 www.forestriverinc.com/rockwood 574.642.2640

All specifications contained herein are based on the latest product information at time of printing. Forest River reserves the right to make changes in colors, materials, equipment and specifications at any time without notice and assumes no responsibility for any errors in this brochure. Litho. U.S.A. FOR 0905