



2006



# PRESIDENTIAL<sup>®</sup> SUITE

BIG STORAGE FOR BIG ADVENTURES



SUITE = 148 CUBIC FEET OF STORAGE

## INTERIOR

- Insulated Bathroom Deck
- New Single Pedestal Kitchen Table
- New Dinnette Chairs
- New Slide Fascia
- New Window Treatment
- Rounded Corian Counter Tops
- Euro Style Recliner Chairs
- New Rounded Shower
- Fully Extended Drawer Guides
- Mood Lighting in Bedroom Area
- Crown Molding

## EXTERIOR

- New Front Cap Design
- New Rear Cap Design
- New Graphic/Paint Design
- New Water Management System
- 40lb. L.P. Tanks
- Heated Storage Area
- Sealed Baggage Doors
- Gel Coat Fiberglass Storage Doors
- Upgraded Storage Floor Material

## APPLIANCES

- LCD TV's

# FLOORPLANS

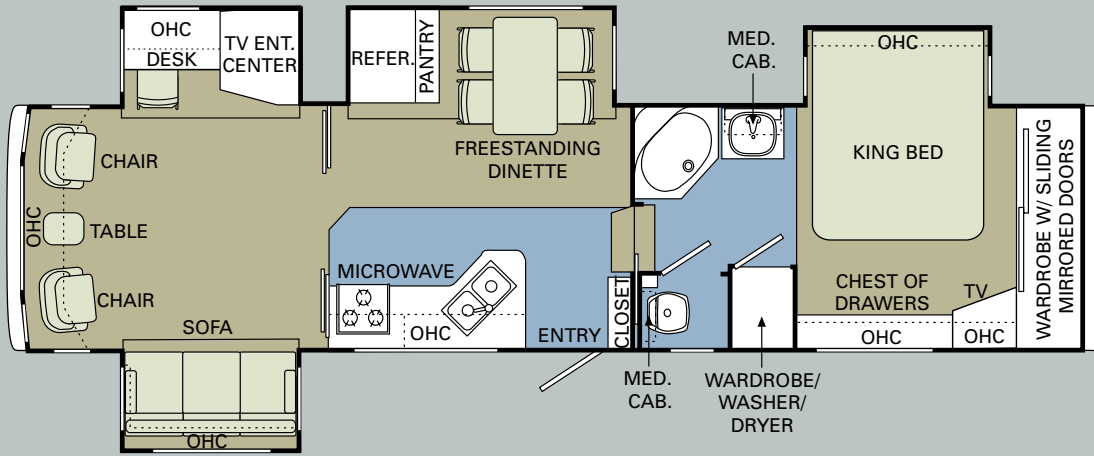

37 RLQ

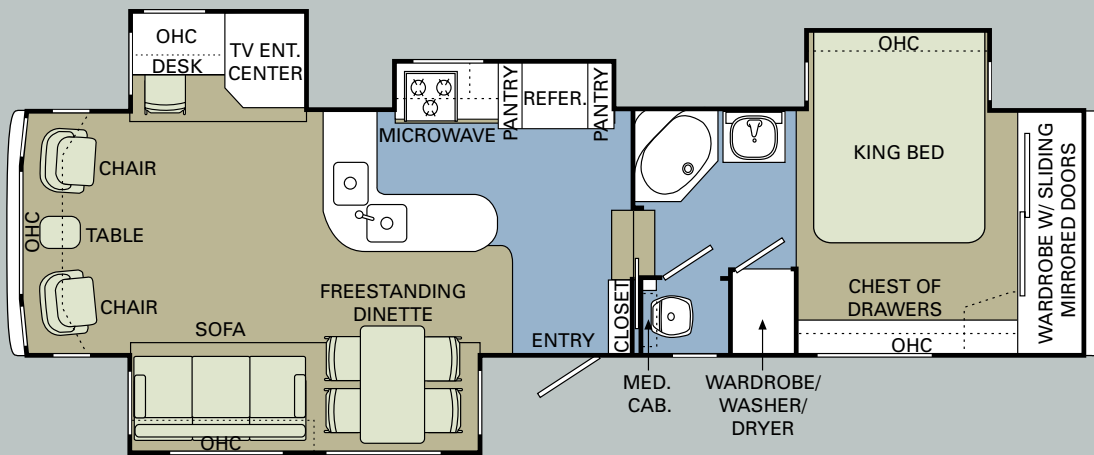

37 SKQ

Carpet
  Linoleum

606 Nelson's Parkway  
 Wakarusa, IN 46573  
[www.holidayrambler.com](http://www.holidayrambler.com)  
 (800) 245-4778



**MONACO COACH CORPORATION**

Monaco is traded on the New York Stock Exchange under the listing MNC. © 2005, Monaco Coach Corporation 11/05 NPN:BROHPres Litho in USA.

