

20

ENDEAVOR®

06



HOLIDAY RAMBLER®

*This is Living®*





## LOOKING FOR A BESTSELLER? GET THE WHOLE STORY HERE.

---

Year after year, there are dozens of reasons the Endeavor is one of the most popular coaches on the road. And they all come down to one thing: high-end luxury with down-to-earth affordability. Whether this is your first motorhome or your seventh — whether you're a young family or simply young at heart — this is the perfect fit. Behind the wheel, you'll have the muscle of 400 HP and the performance of the incomparable Roadmaster chassis. And in the living quarters, you'll find more comfort and versatility than you ever dreamed possible. Yes, this is a popularity contest. And the 2006 Endeavor is sure to win.

## WE'RE RAISING THE ROOF!

Yes, there's more excitement in 2006 than ever before, and it all starts with the new ceiling height — a full seven feet. The added spaciousness is further enhanced in the innovative new 40PAQ floorplan, shown at left, by two large windows in the large dinette area (the exterior is shown below). Whichever floorplan you choose, it's a difference you'll truly appreciate. Yes, from the designer carpeting to the soft touch padded ceiling, the Endeavor gives you seven feet to jump for joy.

A) In the bedroom, we've designed the perfect place for you to unwind. With a wardrobe closet, dresser and overhead cabinets, you'll find plenty of storage space to keep things tidy. And for entertainment, there's a 20" TV (a 20" LCD TV on the 40PRO) and an optional AM/FM/CD/DVD player. A queen bed with hardwood framed headboard is standard, and a king bed makes an enticing option (40PDQ).



**IT'S THE FINISHING TOUCHES THAT CREATE A HOME.**

One look around, and you'll be impressed by the celebrated residential styling of a Holiday Rambler. It all starts with the high quality woodwork, with raised panel hardwood cabinet doors, decorative hardwood slide-out fascia, crown molding in the living area and bedroom and decorative hardwood/fabric window boxes throughout the coach. To unify the interior decor, the Endeavor features satin nickel cabinetry hardware, bathroom accessories and decorative light fixtures.



A) Highlights of the bathroom include the one-piece fiberglass shower (a bathtub is standard on the 40DST), with decorative glass door and two towel bars. The vanity and medicine cabinet offer plenty of secure storage for all your essentials, and you'll love the stylish, easy-to-clean solid surface bathroom countertop with integrated sink and Corian® backplash.







## A PLACE WHERE ROMANCE IS ALIVE AND WELL.

The Endeavor's kitchen and dining area are perfect for entertaining family and friends or simply whipping up a magical dinner for two. You'll find exceptionally well-organized workspace and storage space, highlighted by the polished solid surface countertop with a handy fold-up extension. This marvel of efficiency also features built-in storage for the sink and cooktop covers, an overhead cabinet with an adjustable shelf and a silverware drawer with an organizer to keep everything in its place. The top-notch appliances include a large stainless steel four-door refrigerator with ice maker, a high-output three-burner cooktop and a versatile stainless steel microwave/convection oven.



A

A) You'll enjoy the bright, window-filled dinette area with its ingenious legless solid surface table top (a round hardwood table is standard on the 40PAQ) and two beautifully styled chairs and two folding chairs.

## A MOTORCOACH THAT LOVES TO MOTOR.

You'll take the helm of 400 horsepower in a cockpit that's filled with luxurious comforts and advanced systems. The seats are plush, durable Ultraleather™ (stylish distressed OptimaLeather™ on the Liz Claiborne decors) with six-way power controls on the pilot's seat and a power footrest for the co-pilot. The entertainment center is located above the cockpit, with a 24" flatscreen TV (or the optional 26" LCD TV) and the impressive home theater system with VCR and DVD player and surround sound speakers.



### 1-PIECE WINDSHIELD

The Endeavor's contemporary styling is accented by some remarkable features that make it also one of the safest coaches on the road. Our exclusive Panaview™ 1-piece windshield provides the largest unobstructed view in the industry. Slender side pillars increase your peripheral vision and the wipers are conveniently mounted below your field of view. The 17.5" chrome power heated mirrors with turn signals are also mounted on the front cap — so you don't have to turn your head away from the road.



Mission Hills | 40PDQ ▲



A  
C





- A) The automotive-style dash features an eagle burl instrumentation panel and a lighted VIP Smartwheel® that's Multiplexed with controls for the wipers, ICC and cruise control.
- B) A color rear vision system with audio and an adjustable camera lets you see and hear what's behind the coach. A new upgrade this year is an optional 3-camera system with an adjustable center camera.

- C) The Onan® 8.0 kW Quiet Diesel generator is accessed through the front cap on a manual slide-out tray, making it easy to service.
- D) The coach's array of batteries is easily reached for servicing, thanks to the side-hinged compartment door and the convenient slide-out tray.
- E) The Roadmaster chassis provides for large pass-through storage spaces, accommodating larger items with ease. In addition, our side-hinged baggage doors are easier to open, give you a better view and make it a snap to load and unload.

WHERE ALL THE DETAILS COME TOGETHER.

Holiday Rambler has long set the standard with warm, inviting interiors that feature a perfect harmony of fabrics, accents and carpeting. We've also led the way with stunning woodwork and superb craftsmanship, including raised panel cabinet doors, hardwood end panels and heavy-duty ball bearing guides. Select the combination that suits you best to customize your Endeavor and make it distinctively your own.

- A. BEDSPREAD
- B. SOFA
- C. CORIAN®
- D. ACCENT
- E. CARPET

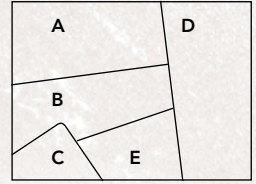

EXTERIOR COLORS/WOODS/FABRICS



BLACKWOOD MANOR II featuring fabrics by Liz Claiborne

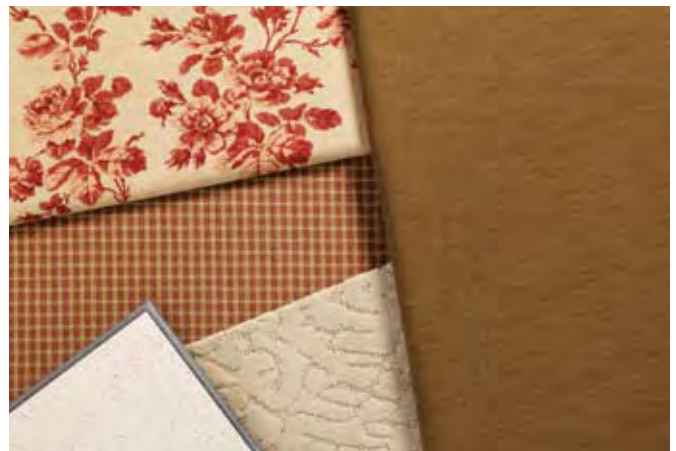

CANYON MOSAIC featuring fabrics by Liz Claiborne



BLACK TIE

**BETTER  
STAIN  
PROTECTION**

Manufactured in, not added on. For added protection against stains, soil repellent is applied to virtually all upholstery fabric during the finishing process for superior coverage.\*

\*Brand and application of upholstery fabric protection may vary depending on date recreational vehicle was manufactured.



MISSION HILLS



PROVENCE BLUE



ZINFANDEL



EXTERIOR COLORS/WOODS/FABRICS

**Endeavor hardware**

Our elegant cabinet hardware design features a satin nickel finish.



NEW VINTAGE OAK



NEWPORT CHERRY



CHAMPAGNE SELECT

## ROADMASTER R-SERIES CHASSIS

At the heart of the 2006 Endeavor is the Roadmaster Raised Rail RR8R-Series chassis. Designed for the high performance standards of a luxury motorcoach, the chassis is custom-built to the exact specifications of each floorplan. Giving you unbeatable ride and handling along with many innovative features. We invite you to take a few minutes and discover all the ways Roadmaster offers you the very best in safety, reliability, comfort and convenience.



### ALUMAFRAME® CONSTRUCTION SINCE 1966:

The Endeavor features Holiday Rambler's exclusive Alumaframe® Superstructure. Our revolutionary system of aluminum C-Channel crossmembers runs the entire length of the unit, with double-welded intersections for added strength. This rigid design is both lighter and sturdier than wood or tubular aluminum frames — and much more reliable than butt-welded or screwed joint designs. From dirt roads to potholes, you can count on Alumaframe® to handle the relentless stresses of the road and provide superior structural integrity for many years to come.



A steel cage cockpit gives the Roadmaster chassis incomparable strength and safety in the front of the coach.

Every Roadmaster chassis features a steel firewall for added protection in the cockpit.

The main rails feature an exclusive raised rail design which provides for larger full pass-through storage bays with flush floors. Other highlights include a 3/8" thick frame rail — compared to the 1/4" of other manufacturers — and a stacked aluminum intercooler and radiator for optimum heat transfer and cooling.

Dual fuel fill allows you to fill the tank from either side of the coach, for greater convenience and flexibility at the pump.

**Truss System with Rust Inhibitor:**  
This steel truss system is engineered as part of the chassis and provides outstanding strength and rigidity plus pass-through storage. In addition, the structure is pre-primed and coated with a rust-inhibiting paint.

CHASSIS AND CONSTRUCTION

### SLIDE-OUT CONSTRUCTION:

When you get a Holiday Rambler, you can be sure the slide-out boxes are some of the strongest and most reliable you'll find anywhere. They feature our exclusive multi-layer construction to give you maximum insulation and to reduce the chance of warping, twisting or shifting.

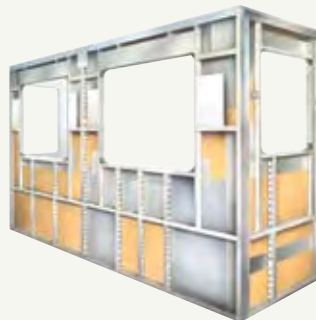

### SIDEWALL CONSTRUCTION: (left to right)

- Gel coat fiberglass
- Interlocking C-Channel filled with 1-1/2" fiberglass insulation glued in place so it doesn't sag or leave spaces uninsulated
- Vapor barrier
- Bead foam saves energy and provides a thermal insulative barrier
- Interior paneling



Wood



Aluminum  
(Butt-Welded)



Alumaframe®  
(C-Channel)



Eight air bags work in conjunction with eight gas-powered shock absorbers to prevent road trauma from ever reaching the coach.

Monitored leveling sensors continually adjust the air pressure at each axle to maintain a level ride and eliminate nosediving, weight transfer, and floating on curved roads. This system also stabilizes the coach on uneven surfaces.



**Cummins® ISL 400 Diesel Engine:**  
The Endeavor features a gutsy standard Cummins® ISL 400 diesel engine with Allison® 3000 MH 6-speed World Transmission and electronic shifter.

**Engine Mounting:**  
The three-point engine mounting system lowers the coach's center of gravity and reduces the amount of vibration that reaches the coach. The mounting also makes the engine easier to service.

A 10,000 lb. tow hitch rating is the highest in its class.

Automatic Traction Control (ATC) eliminates wheel slippage in slick conditions and heightens control. The Anti-Lock Braking system (ABS) gives you superior stopping power, especially on steep grades. Together, these sophisticated systems offer the very best safety on the road.



**ROOF CONSTRUCTION:** (top to bottom)

- One-piece peaked fiberglass roof
- Luaun backing
- Thick, tapered bead foam insulation
- Aluminum double I-beam superstructure filled with fiberglass insulation
- Vapor barrier
- Structure foam: thermal insulative barrier
- 1/2" bead foam insulation
- Foam padding for extra insulation
- Padded vinyl ceiling

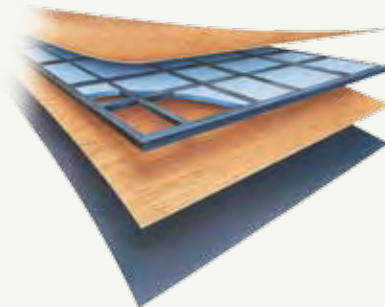

**FLOOR CONSTRUCTION:** (top to bottom)

- Structurwood™
- 1 1/2" x 1 1/2" square tubular frame
- Blue foam
- Luaun
- Darco

| BODY CONSTRUCTION: FEATURES  |  | OPTIONS   |
|--|--|---|
| <ul style="list-style-type: none"> <li>• Alumaframe® Superstructure</li> <li>• Steel Cage Cockpit Construction</li> <li>• One-Piece Peaked Fiberglass Roof with Fiberglass Insulation</li> <li>• Panaview™ 1-Piece Windshield</li> <li>• 84" Interior Height</li> <li>• Smooth Gel Coat Fiberglass Exterior Walls</li> <li>• Front Molded Fiberglass Cap</li> <li>• Rear Molded Fiberglass Cap with Integrated Air Intake</li> <li>• One-Piece Generator Access Door</li> <li>• Rear Engine Door Struts</li> <li>• Angled Fiberglass Engine Cover</li> <li>• Steel Framed Floor on Steel Trusses</li> <li>• Laminated Structurwood™ Flooring</li> <li>• Electric Flush-Floor Stepwell Cover</li> <li>• Interior Paneling with 3/4" Insulation</li> </ul> | <ul style="list-style-type: none"> <li>• Foam Insulated Floor Framing with Luaun Backer</li> <li>• 17.5" Chrome Power Heated Mirror with Turn Signal</li> <li>• Side-Hinged Baggage Doors; All Door Locations with Redesigned Extrusion and Latch Locations</li> <li>• Fog Lights</li> <li>• Flush-Mount Metal Fuel Doors</li> <li>• One-Piece Polyethylene Pass-Through Storage Compartment</li> <li>• Slide-Out Battery Tray</li> <li>• Full-Length Mud Flap</li> <li>• 3M Film Front Mask</li> <li>• Deluxe Full-Body Paint</li> <li>• Interior Entry Step Storage</li> <li>• Roof Ladder</li> <li>• Undercoating</li> </ul>  | <ul style="list-style-type: none"> <li>• Storage Bay Slide-Out Tray</li> <li>• Standard Run Savings Package Includes: 3-Camera Rear Vision System with Audio and Adjustable Center Camera, Solid Surface Kitchen Sink, Pillow Top Mattress, Auto Generator Start, 50 Amp Electric Power Cord Reel, RV Sani-Con Tank Drainage System, Exterior Tank Monitor Gauge</li> </ul> |
| CHASSIS/ENGINE/SUSPENSION: FEATURES  |  |   |
| <ul style="list-style-type: none"> <li>• Roadmaster Raised Rail RR8R-Series Chassis</li> <li>• Cummins® 400 HP ISL Engine with Allison® 3000 MH 6-Speed World Transmission and Electronic Shifter</li> <li>• Torque (@ 1,300 RPM): 1,200 lbs./ft. Max</li> <li>• Engine Displacement: 540"/8.8L</li> <li>• Aluminum Rear-Mount Radiator with CAC Cooler</li> <li>• Dual Fuel Fill</li> <li>• 160 Amp Alternator</li> <li>• Rear Axle Ratio: 4.30:1</li> <li>• Goodyear Radial Tires: 275/80R/22.5</li> <li>• Pre-Wire for Supplemental Braking System</li> </ul>   | <ul style="list-style-type: none"> <li>• Polished Aluminum Wheels</li> <li>• Cushion Air Glide Suspension with Eight Outboard-Mounted Air Bags and Eight Monroe® Shock Absorbers</li> <li>• Anti-Lock Braking System with Full Air Brakes</li> <li>• Automatic Traction Control</li> <li>• Exhaust Braking System</li> <li>• Auto Slack Adjusters on Brakes</li> <li>• Engine Block Heater</li> <li>• Rock Shield to Radiator</li> <li>• 10,000 Lb. Hitch Receiver with Seven-Point Connector</li> <li>• Fully Automatic Hydraulic Leveling Jacks</li> </ul>   |   |
| COCKPIT: FEATURES  |  | OPTIONS   |
| <ul style="list-style-type: none"> <li>• Automotive Dash with Eagle Burl Instrumentation Panel</li> <li>• CD Player/Radio with Sirius-Ready Compatibility and Weather Band</li> <li>• Power Sunvisors</li> <li>• Pilot and Co-Pilot Pull-Down Sunshades</li> <li>• Wood Framed Cabinet Doors with Smoked Glass over Front Entertainment Center System</li> <li>• Cockpit Front and Side Overhead Cabinet Doors Top Hinged with Self-Supporting Hinges</li> <li>• Adjustable Brake and Accelerator Pedals</li> <li>• 110V, 12V and Phone Outlet</li> <li>• Color Rear Vision System with Audio and Adjustable Camera</li> </ul>   | <ul style="list-style-type: none"> <li>• Lighted VIP Smartwheel® Multiplexed Steering Wheel with Controls for Windshield Wipers, ICC and Cruise Control</li> <li>• Intermittent Windshield Wipers</li> <li>• 10 Quart Tank for Windshield Fluid with Fluid Sensor to Tank and Low Wash Indicator on Dash</li> <li>• Audible Turn Signals</li> <li>• Roof-Mounted Air Horn</li> <li>• CB Prep</li> <li>• Ultraleather™ Six-Way Power Pilot and Co-Pilot Seats with Power Footrest</li> <li>• New Style Distressed OptimaLeather™ Pilot and Co-Pilot Seats with Blackwood Manor II and Canyon Mosaic Decors by Liz Claiborne</li> <li>• Power Steering</li> <li>• Color-Coordinated Carpeted Floor Mats</li> </ul> | <ul style="list-style-type: none"> <li>• 3-Camera Rear Vision System with Audio and Adjustable Center Camera</li> <li>• 10 Disc CD Changer</li> <li>• Auxiliary Defroster</li> <li>• Aladdin™ Junior System</li> </ul>  |

Due to the large variety of options and floorplan arrangements available to our customers, actual weights for each unit can differ significantly. Holiday Rambler provides a weight sticker on each unit we produce which includes that unit's tank capacities and approximate weight. Consult your local Holiday Rambler dealer for unit availability and further information.

The information printed in this brochure reflects product design, fabrication, and component parts at the date of printing. The manufacturer reserves the right, at any time, to make changes in product design or material or component specifications as its sole option, without notice. This includes the substitution of components of a different brand or trade name, which will result in comparable performance. All information printed in this brochure is subject to change after the date of printing. Some features shown or mentioned in this brochure are optional and may only be available in selected floorplans. Photographs may show props or decorations that are not standard equipment on Holiday Rambler models. Holiday Rambler, the HR logo and its design, are registered trademarks. All other products and company names are trademarks and/or registered trademarks of their respective holders.

While the color of the motorhome's exterior and the interior fabrics depicted in this sales brochure are fair and reasonable depictions, the colors depicted may not be an exact match of the actual colors because of the variances in photo-processing and variances caused by inserting the photographs within the sales brochure. Due to product improvements, changes during the model year and/or transcription errors that may occur, information represented within this brochure may not be accurate at the time of your purchase. If certain information is significant to your purchasing decision, please confirm the information with your dealer prior to submitting your order.

The actual overall length of the recreational vehicle may differ from that indicated in the brochure due to variances in the manufacturing process and/or installed components. The actual length may be greater or less than that indicated.

Component part and appliance manufacturers issue limited warranties covering those portions of the recreational vehicle not covered by the Limited Warranties issued by Monaco Coach Corporation. To learn which specific component parts and appliances are excluded from the Limited Warranties issued by Monaco Coach Corporation, please contact your selling dealership or Monaco Coach Corporation directly, or review the warranty packet inside the recreational vehicle.

| APPLIANCES AND ACCESSORIES: FEATURES  | OPTIONS   |   |
|---|---|---|
| <ul style="list-style-type: none"> <li>• Large Stainless Steel Four-Door Refrigerator with Ice Maker</li> <li>• High-Output 3-Burner Cooktop without Oven</li> <li>• Removable Solid Surface Range Covers</li> <li>• Stainless Steel Microwave/Convection Oven</li> <li>• 24" Flatscreen Stereo Color TV with Remote Control in Cockpit Overhead</li> <li>• 20" Color TV with Remote Control in Bedroom (N/A: 40PRQ)</li> <li>• 20" LCD Color TV with Remote Control in Bedroom (40PRQ)</li> </ul>  | <ul style="list-style-type: none"> <li>• TV Antenna with Jacks</li> <li>• Home Theater System with DVD and VCR Player with Surround Sound Speakers</li> <li>• Exterior Hook-Ups for DSS Dish and Cable</li> <li>• Digital Satellite System Prep</li> <li>• Interior Cable TV Hook-Up and Telephone Jacks</li> <li>• Exterior Gas Line Hook-Up Prep for LP Accessories</li> <li>• Washer/Dryer Prep</li> </ul>   | <ul style="list-style-type: none"> <li>• Dometic Sidewise Stainless Steel 14 Cu. Ft. 2-Way Two-Door Refrigerator with Ice Dispenser in the Door (N/A: 40DST, 40PAQ)</li> <li>• High-Output Three-Burner Range with Oven (N/A: 40PET)</li> <li>• Combination Washer/Dryer</li> <li>• Bedroom Clock Radio AM/FM/CD/DVD Player</li> <li>• 26" Flatscreen LCD TV in Front Cockpit Overhead</li> <li>• Fully Automatic Digital Satellite System</li> <li>• In-Motion Digital Satellite System</li> </ul> |
| INTERIOR: FEATURES  | OPTIONS   |   |
| <ul style="list-style-type: none"> <li>• New Vintage Oak Cabinetry</li> <li>• Raised Panel Hardwood Cabinet Doors</li> <li>• Hardwood Cabinet End Panels</li> <li>• Self-Supporting Top-Hinged Overhead Storage Doors and Positive Catches on All Other Doors</li> <li>• Heavy-Duty Ball Bearing Drawer Guides</li> <li>• Crown Molding in Bedroom and Living Area</li> <li>• Metal Interior Grab Handle on Dash at Entry Door</li> <li>• Satin Nickel Cabinetry Hardware and Bath Accessories</li> <li>• Polished Solid Surface Kitchen Countertop with Stainless Steel Sink with Two Sink Covers</li> <li>• Polished Solid Surface Kitchen Countertop Extension</li> <li>• Polished V-Grooved Corian® Backsplash in Galley</li> <li>• Silverware Drawer with Organizer Kitchen Base Cabinets</li> <li>• Solid Surface Bathroom Countertop with Integrated Sink</li> <li>• Corian® Lavatory Backsplash with Decorative Mirror</li> <li>• Solid Surface Dinette Table Top (N/A: 40PAQ)</li> <li>• Round Dinette Table with Hardwood Top (40PAQ)</li> <li>• Solid Surface Nightstand Tops</li> </ul> | <ul style="list-style-type: none"> <li>• Kitchen Overhead Cabinet with Adjustable Shelf</li> <li>• Sink and Stove Top Cover Storage Area inside Kitchen Base Cabinet</li> <li>• Ceramic Tile in Kitchen and Bath</li> <li>• Flooring in front of Rear Bedroom Cabinet Area to Match Kitchen Floor</li> <li>• Tile Entry</li> <li>• Designer Carpeting in Living Area and Bedroom</li> <li>• Engine Rug Cover</li> <li>• Soft Touch Padded Vinyl Ceiling</li> <li>• Hardwood Slide-Out Fascia with Decorative Center Block</li> <li>• Decorative Hardwood/Fabric Window Boxes Throughout Coach</li> <li>• Hardwood Framed Headboard with Fabric Inserts</li> <li>• Two Towel Bars on Shower Door</li> <li>• Oversized Rear Wardrobe Closet with Mirror Doors and Frames in Satin Nickel (N/A: 40PRQ)</li> <li>• Bedroom Dresser with Solid Surface Countertop</li> <li>• Accent Mirror on Refrigerator Wall</li> <li>• Bathroom Lavatory Mirror</li> <li>• Blackout Day/Night Pleated Shades in Living Area and Bedroom (Mini Blinds in Private Bath and Kitchen Window)</li> <li>• Soil Repellant Protection on Fabric</li> </ul> | <ul style="list-style-type: none"> <li>• Decors: Zinfandel, Mission Hills, Provence Blue, Black Tie</li> <li>• Special Decor: Canyon Mosaic and Blackwood Manor II featuring fabrics by Liz Claiborne</li> <li>• Wood Choice: Newport Cherry and Champagne Select</li> <li>• Solid Surface Kitchen Sink</li> </ul>  |
| FURNITURE: FEATURES   | OPTIONS   |   |
| <ul style="list-style-type: none"> <li>• Legless Dinette Table with Two Chairs and Two Folding Chairs (N/A: 40PAQ)</li> <li>• Round Hardwood Dinette Table with Two Style Dinette Chairs and Two Folding Chairs (40PAQ)</li> <li>• Roadside: Fabric Easy Bed Sofa</li> <li>• Curbside: Fabric Barrel Chair (40PAQ)</li> <li>• Curbside: Fabric Easy Bed Sofa (N/A: 40PAQ)</li> <li>• Queen Bed with Solid Surface Nightstands</li> </ul>  | <ul style="list-style-type: none"> <li>• Roadside: Fabric Hide-A-Bed with Air Mattress</li> <li>• Roadside: Fabric Ultra Flex Relaxation Center (N/A: 40PET)</li> <li>• Curbside: Ultraleather™ Hide-A-Bed with Air Mattress (N/A: 40PET, 40PAQ)</li> <li>• Curbside: Ultraleather™ Magic Bed Sofa (N/A: 40PET, 40PAQ)</li> <li>• Curbside: Ultraleather™ Easy Bed Sofa (N/A: 40PAQ)</li> <li>• Curbside: Ultraleather™ J-Lounge with Drawer (N/A: 40PAQ)</li> </ul>  | <ul style="list-style-type: none"> <li>• Curbside: Ultraleather™ Recliner (40PAQ)</li> <li>• Curbside: OptimaLeather™ Euro-Recliner with Ottoman, Heat and Massage (40PAQ)</li> <li>• Curbside: Computer Workstation with 26" LCD TV and Ultraleather™ Euro-Recliner with Ottoman, Heat and Massage (N/A: 38PDD, 40PAQ, 40PET)</li> <li>• Pillow Top Mattress</li> <li>• King Bed with One Nightstand (40PET, 40PDD)</li> <li>• Booth Dinette (N/A: 40PET, 40PAQ)</li> </ul>                        |

| ELECTRICAL SYSTEMS AND LIGHTS: FEATURES  |  | OPTIONS   |
|--|--|---|
| <ul style="list-style-type: none"> <li>• 50 Amp 12V Distribution Panel and Power Cord</li> <li>• Onan® 8.0 kW Quiet Diesel Generator on Manual Slide-Out</li> <li>• Four 6V Deep Cycle Batteries</li> <li>• Two 12V Heavy-Duty Chassis Batteries</li> <li>• Battery Disconnect Switch at Front Door</li> <li>• Battery Boost Switch in Cockpit</li> <li>• 2,000 Watt Inverter</li> <li>• Recessed Docking Lights</li> <li>• Porch Light and Exterior Step Light on Same Switch</li> <li>• Lighted Interior Steps</li> <li>• Lights in Outside Storage Compartments with Switch on Passenger Console and Utility Bay</li> <li>• 110V Outlet in Outside Storage Compartment</li> </ul> | <ul style="list-style-type: none"> <li>• Underhood Utility Light</li> <li>• Redesigned Convenience Center in Hallway</li> <li>• Fluorescent Light(s) under Kitchen Overhead</li> <li>• Fluorescent Ceiling Lights Throughout</li> <li>• Decorative Satin Nickel Lighting Package</li> <li>• Fluorescent Ceiling Lights inside Living Area Slide-Out House</li> <li>• Decorative Framed Longer Galley Fluorescent Ceiling Light</li> <li>• Energy Management System</li> <li>• Directional Map Lights on Bottom of Front TV Cabinet</li> <li>• Halogen Light on Driver and Passenger Overhead</li> <li>• Pre-Wire for Solar Panel</li> <li>• Halogen Lights under Living Room, Dining Room, Bed Overhead and Bedroom Dresser Overhead Cabinets</li> </ul> | <ul style="list-style-type: none"> <li>• Auto Generator Start</li> <li>• Solar Panel</li> <li>• Power Cord Reel</li> </ul>  |
| PLUMBING AND LP SYSTEMS: FEATURES  |  | OPTIONS   |
| <ul style="list-style-type: none"> <li>• Demand Water System and Water Pump</li> <li>• 10 Gallon LP Gas/Electric Water Heater with Electronic Ignition DSI Water Heater</li> <li>• Single-Lever Kitchen Faucet with Pullout Sprayer</li> <li>• Separate Satin Nickel Faucet for Filtered Water</li> <li>• Satin Nickel Bathroom Faucet</li> <li>• Single-Handle Satin Nickel Shower Faucet with Slide Bar</li> <li>• Water Heater Bypass Valve</li> <li>• Water Pump Switch in Convenience Center, Kitchen Galley and Service Bay Area</li> </ul>  | <ul style="list-style-type: none"> <li>• Thetford China Toilet</li> <li>• Thetford China Toilet Electronic Thetford Silent Plus (40DST)</li> <li>• Shower inside Wet Bay with Hot/Cold Water</li> <li>• No-Fuss Flush Holding Tank Rinsing System</li> <li>• Gravity and Pressurized Water Fill</li> <li>• Insulated Systems Compartment with Easy Access to Hook-Ups</li> <li>• Soap Dispenser inside Utility Bay</li> <li>• One-Piece Fiberglass Shower (N/A: 40DST)</li> <li>• Satin Aluminum Shower Door Frame with Decorative Glass</li> </ul>  | <ul style="list-style-type: none"> <li>• RV Sani-Con Tank Drainage System</li> <li>• Electric Automatic Winterization</li> <li>• Power Water Hose Reel (N/A: 40PRQ)</li> <li>• Exterior Tank Monitor Gauge in Wet Bay</li> <li>• Bathtub (Standard on 40DST)</li> </ul> |
| HEATING, VENTS AND AIR CONDITIONING: FEATURES  |  | OPTIONS   |
| <ul style="list-style-type: none"> <li>• Dual 13.5M BTU Roof Air Conditioner with Ducted Air, Heat Pumps and Digital Thermostat Control</li> <li>• Dual Zone Electronic Ignition Furnaces — 51M BTU: 31M and 20M BTU</li> <li>• Electronic Dash Air Conditioner/Heat Climate Control System</li> </ul>   | <ul style="list-style-type: none"> <li>• In-Floor Ducted Heating System</li> <li>• Fantastic 12V Attic Fan with Rain Sensor with Electronic Wall Thermostat in Kitchen</li> <li>• 12V Attic Fan in Private Bath with Wall Control of Automatic Dome and Fan Power</li> <li>• 12V Heater in Wet Bay</li> <li>• Metal Floor Registers Satin Nickel</li> </ul>  | <ul style="list-style-type: none"> <li>• Fantastic 12V Attic Fan with Rain Sensor and Electronic Wall Thermostat — Private Bath</li> </ul>  |
| WINDOWS, DOORS AND AWNINGS: FEATURES   |  | OPTIONS   |
| <ul style="list-style-type: none"> <li>• Radius Flush-Mount Dual Pane Safety Glass Dark Tinted Windows</li> <li>• Front Entry Door with Removable Screen and Anti-Skid Steps</li> <li>• Exterior Entry Door Grab Handle</li> <li>• Metal Interior Grab Handle on Dash at Entry Door</li> </ul>   | <ul style="list-style-type: none"> <li>• Keyless Entry</li> <li>• Eclipse Automatic Patio Awning</li> <li>• Topper Slide-Out Awnings Living Area and Bedroom</li> <li>• Automatic Front Door Awning</li> <li>• Tinted Skylight in Bathroom with Protecta Glaze</li> </ul>  | <ul style="list-style-type: none"> <li>• Window Awnings on All Slide-Out House Windows Except Slide-Out Windows under Patio Awning</li> </ul>   |
|  |  | <b>OPTIONS</b> <ul style="list-style-type: none"> <li>• Bedroom Window Awning on Sidewall (38PDD, 38PST, 40DST, 40PET)</li> </ul>   |
| SAFETY: FEATURES   |  |   |
| <ul style="list-style-type: none"> <li>• Fire Extinguisher</li> <li>• Deadbolt Lock on Entrance Door</li> <li>• 120V GFI Protected Circuit</li> </ul>  | <ul style="list-style-type: none"> <li>• LP Gas Detector</li> <li>• Smoke Detector</li> <li>• Carbon Monoxide Detector</li> </ul>  | <ul style="list-style-type: none"> <li>• Driver and Passenger Three-Point Integrated Seat Belts</li> <li>• Third Brake Safety Light</li> <li>• Egress Window(s)</li> </ul>  |



| Weights                        | 38PDD  | 38PST  | 40DST  | 40PET  | 40PRO  | 40PAQ  | 40PDQ  |
|--------------------------------|--------|--------|--------|--------|--------|--------|--------|
| Gross Vehicle Weight Rating    | 33,000 | 33,000 | 33,000 | 33,000 | 33,000 | 33,000 | 33,000 |
| Gross Combined Weight Rating*  | 43,000 | 43,000 | 43,000 | 43,000 | 43,000 | 43,000 | 43,000 |
| Front Gross Axle Weight Rating | 13,000 | 13,000 | 13,000 | 13,000 | 13,000 | 13,000 | 13,000 |
| Rear Gross Axle Weight Rating  | 20,000 | 20,000 | 20,000 | 20,000 | 20,000 | 20,000 | 20,000 |

| Measurements    |         |         |         |         |         |         |         |
|-----------------|---------|---------|---------|---------|---------|---------|---------|
| Wheelbase       | 237"    | 237"    | 261"    | 261"    | 261"    | 261"    | 261"    |
| Overall Length  | 38' 10" | 38' 10" | 40' 10" | 40' 10" | 40' 10" | 40' 10" | 40' 10" |
| Overall Height  | 12' 10" | 12' 10" | 12' 10" | 12' 10" | 12' 10" | 12' 10" | 12' 10" |
| Interior Height | 84"     | 84"     | 84"     | 84"     | 84"     | 84"     | 84"     |
| Interior Width  | 94.5"   | 94.5"   | 94.5"   | 94.5"   | 94.5"   | 94.5"   | 94.5"   |
| Exterior Width  | 100.5"  | 100.5"  | 100.5"  | 100.5"  | 100.5"  | 100.5"  | 100.5"  |

| Tank Capacities**   |     |     |     |     |     |     |     |
|---------------------|-----|-----|-----|-----|-----|-----|-----|
| Water Heater (Gal.) | 10  | 10  | 10  | 10  | 10  | 10  | 10  |
| Gray Tank (Gal.)    | 62  | 62  | 62  | 62  | 62  | 62  | 62  |
| Black Tank (Gal.)   | 40  | 40  | 40  | 40  | 40  | 40  | 40  |
| Fresh Tank (Gal.)   | 100 | 100 | 100 | 100 | 100 | 100 | 100 |
| Fuel Tank (Gal.)    | 100 | 100 | 100 | 100 | 100 | 100 | 100 |
| LP Tank (Gal.)***   | 39  | 39  | 39  | 39  | 39  | 39  | 39  |

\* Towing capacity is limited by GCWR; your vehicle's towing capacity is the difference between the GCWR and the actual vehicle weight, including all water, fuel, passengers and cargo. Your towed vehicle should be equipped with auxiliary brakes if the weight of the towed vehicle exceeds 1,000 lbs. Consult your Owner's Manual for further towing information.

\*\* Variances in the fabrication and installation of the tanks may cause the actual "usable capacity" to be greater or less than the capacities designated above.

\*\*\* Actual filled LP capacity is 80% of listing due to safety shut-off required on tank.

## AT HOLIDAYRAMBLER.COM, WE'RE ALWAYS OPEN.

Visit our website anytime day or night to check out the latest product news and updates. You can also take a factory tour, find a dealer near you, get information on club events and much more. It's also an easy way to contact us via e-mail.

[www.holidayrambler.com](http://www.holidayrambler.com)



## WE'VE GOT YOUR BACK.

- Live customer support 24/7/365
- 350 Nationwide Service Centers
- Free first-year enrollment in our Owner Advantage Roadside Assistance Program
- Call 1-800-634-0855 or 1-800-650-7337 to arrange a tour of one of our state-of-the-art production facilities in Indiana or Oregon.



38PDD

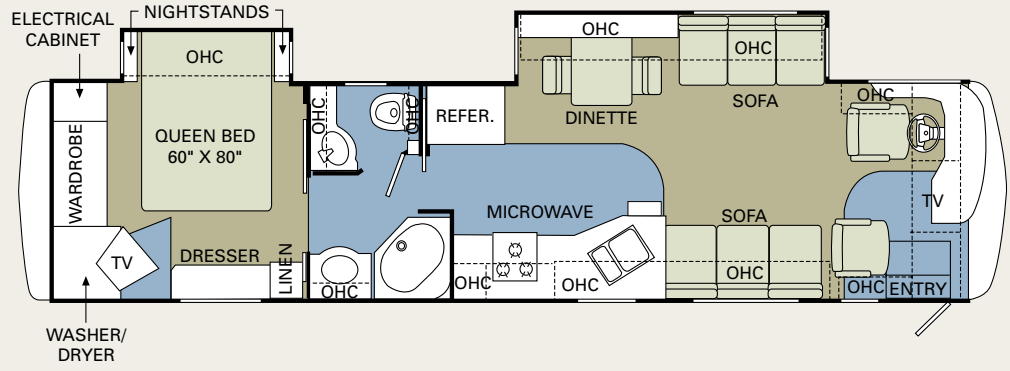

38PST

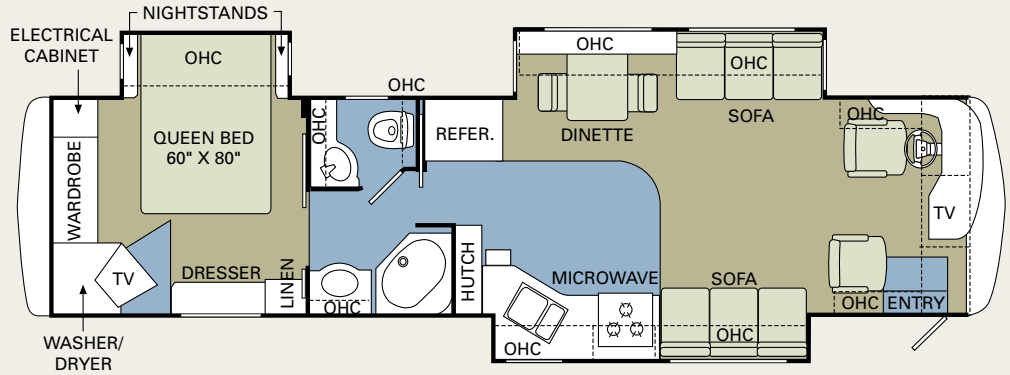

40DST

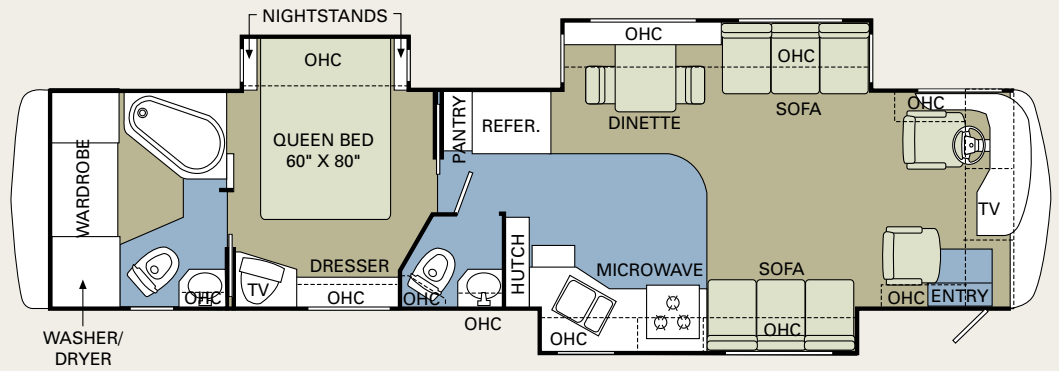

40PET

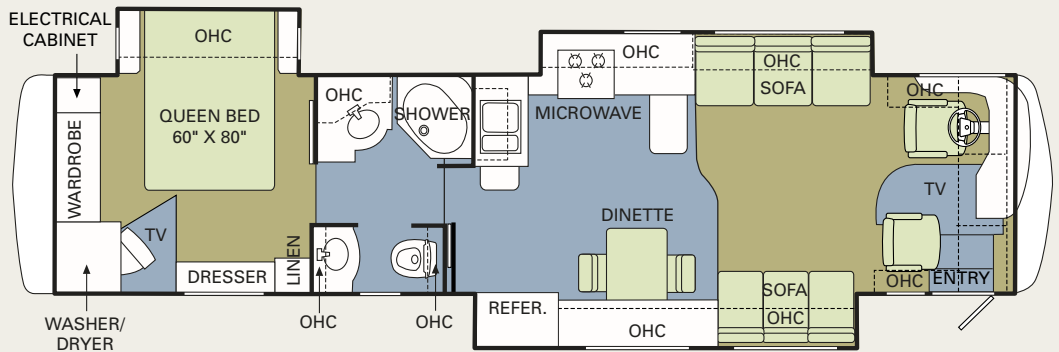

Carpet
  Tile

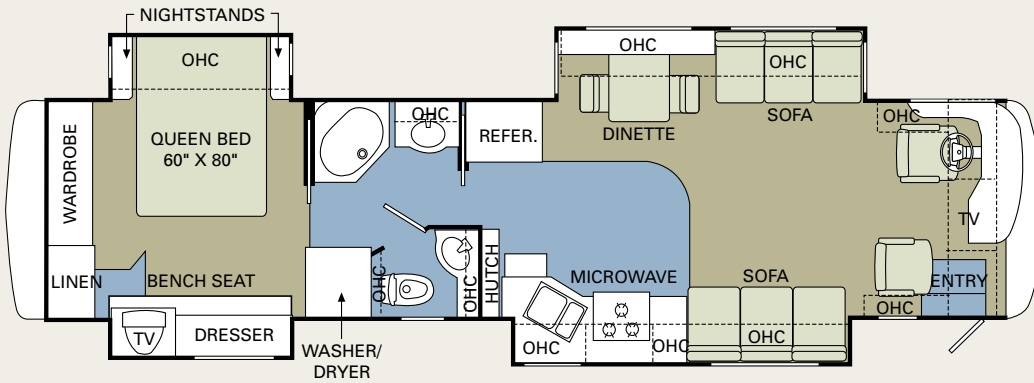
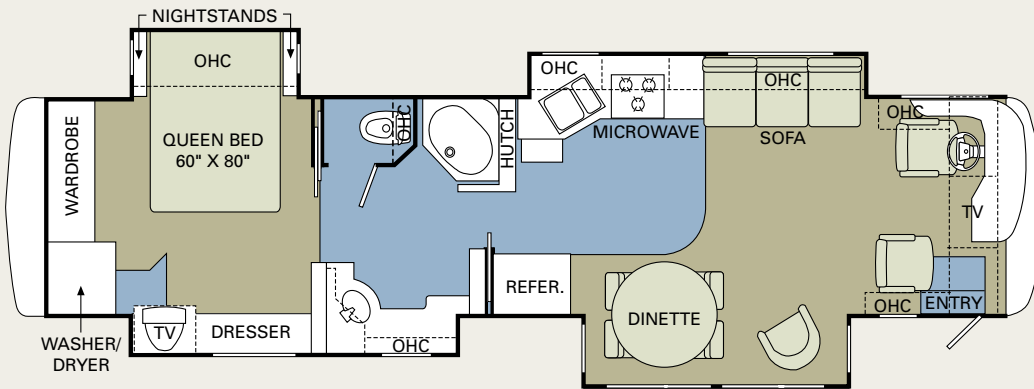
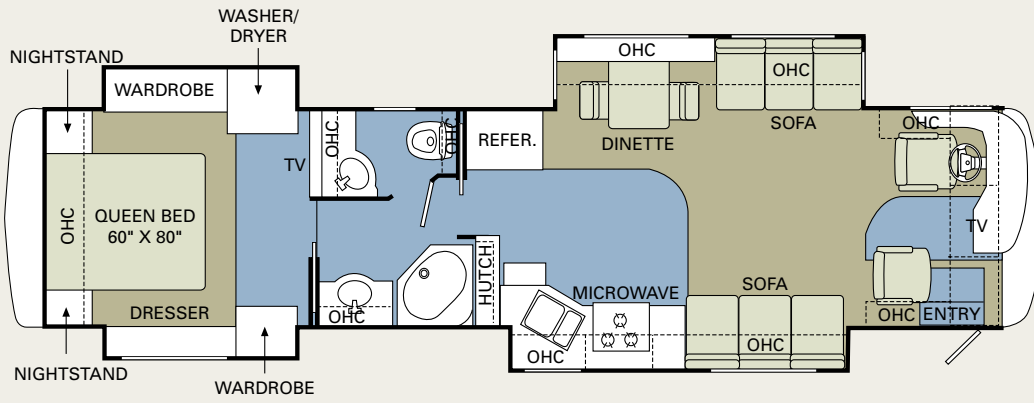

# 20 ENDEAVOR® 06



Thank you for taking a closer look at the 2006 Endeavor. In addition to the state-of-the-art technologies and creature comforts you'll see here, this luxury diesel coach includes countless conveniences and safety innovations you'll want to experience firsthand. Poke around. Kick the tires. Open and shut every door and drawer — twice. And most importantly, take a drive. You can count on our expert sales team to answer all your questions and demonstrate why this truly is the best experience the road has to offer.

## WARRANTIES

**12 MONTH/24,000 MILE** basic limited warranty

**5 YEAR/50,000 MILE** limited warranty on aluminum or steel frame structure of sidewall, roof, front and rear cap

**3 YEAR/36,000 MILE** limited warranty on Roadmaster chassis

Applies to certain models. See owner's manual for complete details.

## ALL EYES ON THE ROAD AHEAD.

If you're considering a Holiday Rambler, chances are you share our pioneer spirit. For us, it goes back to 1953, the year we introduced our first travel trailer. Since then, our countless innovations have helped create a rich, rewarding lifestyle — and a new way for families like yours to go exploring.

Yes, we're proud of our heritage — but we're not looking back. In these pages, you'll discover that we continue to lead the entire industry. With exciting new features, powerful chassis, remarkable floorplans and, as always, more ways of keeping you and your loved ones safe.

Whether you're looking for the value of a towable, the convenience and economy of a gas motorhome or the top-of-the-line luxury of a diesel coach — Holiday Rambler has an unbeatable model for your budget. Because in 2006, one thing's for sure. We're still paving the way.



**HOLIDAY RAMBLER®**

*This is Living®*

606 Nelson's Parkway Wakarusa, IN 46573

[www.holidayrambler.com](http://www.holidayrambler.com)  
(800) 245-4778

  
MONACO COACH CORPORATION

Monaco is traded on the New York Stock Exchange under the listing MNC.  
© 2005, Monaco Coach Corporation 01/06 NPN: BROHEND Litho in USA.

