

2006



ALUMASCAPE® SUITE

BIG STORAGE FOR BIG ADVENTURES



SUITE = 148 CUBIC FEET OF STORAGE

INTERIOR

- Insulated Bathroom Deck
- New Single Pedestal Kitchen Table
- New Dinnette Chairs
- New Slide Fascia
- New Window Treatment
- Rounded Corian Counter Tops
- Euro Style Recliner Chairs
- New Rounded Shower
- Fully Extended Drawer Guides
- Mood Lighting in Bedroom Area
- Crown Molding

EXTERIOR

- New Front Cap Design
- New Rear Cap Design
- New Graphic/Paint Design
- New Water Management System
- 40lb. L.P. Tanks
- Heated Storage Area
- Sealed Baggage Doors
- Gel Coat Fiberglass Storage Doors
- Upgraded Storage Floor Material

APPLIANCES

- LCD TV's

FLOORPLANS

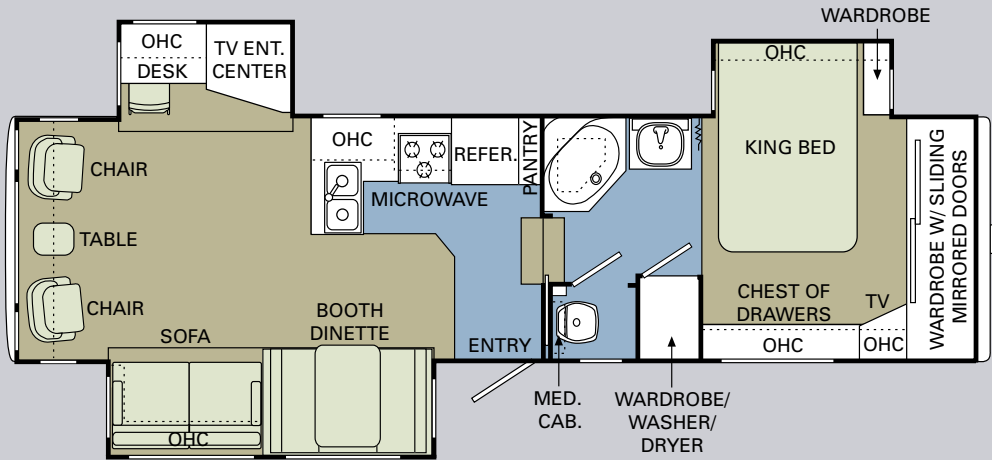

33 SKT

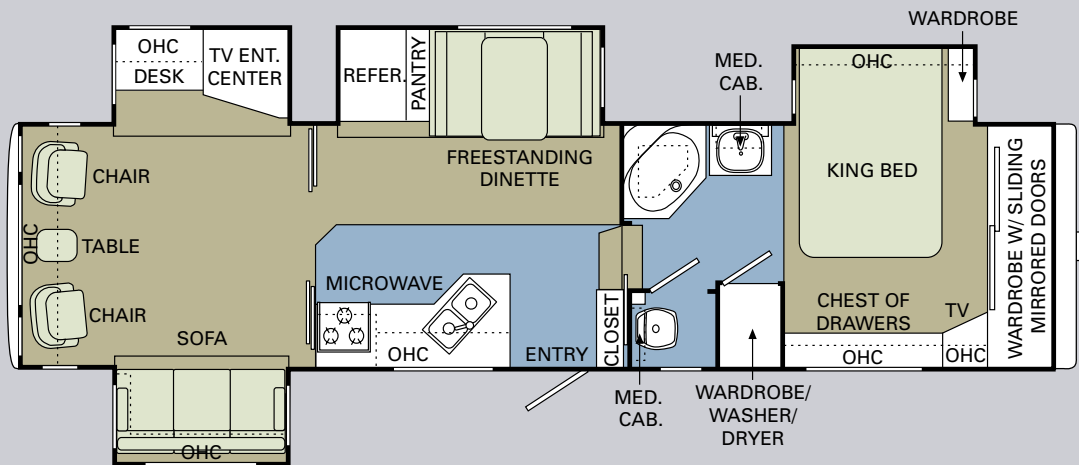

36 RLQ

Carpet
 Linoleum

606 Nelson's Parkway
 Wakarusa, IN 46573
 www.holidayrambler.com
 (800) 245-4778



MONACO COACH CORPORATION

Monaco is traded on the New York Stock Exchange under the listing MNC. © 2005, Monaco Coach Corporation
 11/05 NPN: BROHALUMA Litho in USA.

