



HOLIDAY RAMBLER®

*This is Living®*

**Alumaframe Construction**  
**Newport Cherry Raised**  
**Panel Cabinets**  
**Aggressively Priced**



# NEW 2007 ALUMASCAPE



## Body and Frame Construction

Alumaframe Superstructure  
 10" I-Beam Frame  
 Smooth .040 Aluminum Exterior Walls  
 Front Molded Fiberglass Cap  
 Tall Main Slide-out, 6'-1" Interior Height  
 Color Coordinated Painted Skirts  
 Molded ABS Fender Skirts  
 Aluminum Rims

1-1/2" Steel Framed Sub-Floor  
 Laminated and Insulated Bathroom Floor  
 Aluminum Roof Structure w/Double I-Beam Roof Rafter 16" On-Center  
 9-Layer Roof and 6-Layer Sidewall Construction  
 Brite TEK™ Exterior Roof Material  
 Flat Floor Slide-Out - Main Living Area  
 Enclosed and Heated Underbelly  
 Insulated Oversized Exterior Storage Door  
 Linoleum Floor in Alcove Storage Area  
 Frame Mounted Entry Step  
 Front Power Landing Jacks  
 6,000 lb. Super Lube Tandem Axles w/Electric Brakes  
 Radial Tires w/Stylized 16" Wheels  
 Stabilizer Jacks (2 rear)  
 Spare Tire w/Sport Wheel and Carrier

**Appliances**  
 8 cu. ft. Refrigerator  
 Microwave w/Touch Control  
 High Output 3-Burner Range with Oven  
 Systems Monitor Panel on Range Hood  
 Home Theater Surround Sound System

**Interiors**  
 Newport Cherry Cabinets w/Arched Raised Panels  
 Raised Panel Refrigerator Door

Decorative Slide-Out Room Fascia w/Trim and Accents  
 Laminate Countertop w/Corian Accent Edge  
 Carpeting and Pad in Living Area, Hallway and Bedroom  
 Linoleum in Kitchen, Bathroom and Entry Area  
 Decorative Glass in Overhead Cabinet Doors  
 Pantry/Closet at Front Entry Door

**Furniture**  
 Bedroom Slide-Out w/Chest of Drawers  
 Wood Booth Dinette  
 Fabric Glider Recliner  
 Hide-A Bed Sofa  
 Swing-up Bunk Bed

**Electrical Systems and Lights**  
 Decorative Wall Light w/Swing Arm in Living Area  
 12V Incandescent Ceiling Lights  
 Water Heater Switch  
 Electrical Management System - 30AMP  
 Two (2) Exterior Security Lights  
 12 Volt Disconnect Switch & Battery Box  
 Solar Prep  
 TV Antenna w/Signal Booster  
 Cable TV Hook-up

**Plumbing and L.P. Systems**  
 Stainless Steel Kitchen Sink w/High Profile Single Handle Faucet  
 10 gal. L.P. Gas/Elect. Water Heater  
 Bathroom Sink w/Brushed Nickel Faucet  
 Brushed Nickel Shower Fixtures  
 Neo-Angle Shower w/Glass Door  
 Lighted Water Management System  
 Water Heater By-pass Kit  
 Zurn PEX Water Lines 25 year/10 Year Warranty  
 No-Fuss Flush Holding and Tank Rinsing System  
 Two 30 lb. L.P. Tanks w/Automatic Changeover

## Heating, Vents and Air Conditioning

35M BTU Hydroflame Electronic Ignition Furnace  
 In-floor Ducted Heating System  
 12V Roof Vent in Bathroom  
 One Carrier 13,500 BTU Rooftop Air Conditioner  
 Wire Prep and Ducting for 2nd A/C w/Optional 50 Amp Service

## Windows, Doors and Awnings

DarkTinted Radius Windows  
 Tinted Skylight in Bathroom  
 Patio Awning  
 30" Radius Main Entrance Door with Anti-skid Steps  
 Swing-Out Entry Door Handle  
 Window in Stool Room

**Window Treatments**  
 Rear Bay Window w/Pleated Day/Blackout Shade  
 Pleated Day/Black Out Shades in Living Area(s) and Bedroom  
 Mini Blinds, Soft Valances and Decorative Drapery Panels Throughout

## Options

Décor: New Latte, Sage Meadow  
 High Gloss Gelcoat Fiberglass Sidewalls  
 23" LCD TV w/HD Tuner and Mounting Bracket  
 High Back Desk Chair  
 Free-Standing Dinette Table w/Four Wood Chairs  
 50 Amp Electrical Management Service  
 Generator Prep  
 Ceiling Fan  
 One Carrier 15.0 High Capacity Rooftop A/C  
 Second Carrier 13,500 BTU Rooftop A/C  
 Attic Fan w/Thermo and Rain Sensor in Bedroom

<b>Weights</b>	<b>33CKT</b>	<b>34BHT</b>	<b>Measurements</b>	<b>33CKT</b>	<b>34BHT</b>	<b>Tank Capacities</b>	<b>33CKT</b>	<b>34BHT</b>
GVWR	14,400	14,400	Overall Length	35' 10"	36' 3"	Water Heater	10	10
Hitch Weight	2,040	2,260	Overall Height	12' 9"	12' 9"	Grey Tank	40/40	40/40
Axle(s) Weight	6,000	6,000	Exterior Width	98"	98"	Black Tank	40	40/40
Unloaded Vehicle Weight	10,380	10,660				Fresh Tank	50	50
Net Carrying Capacity	4,020	3,740				L.P. Tank	30 (2)	30 (2)
Tire Size/Load Range	16" D	16" D						

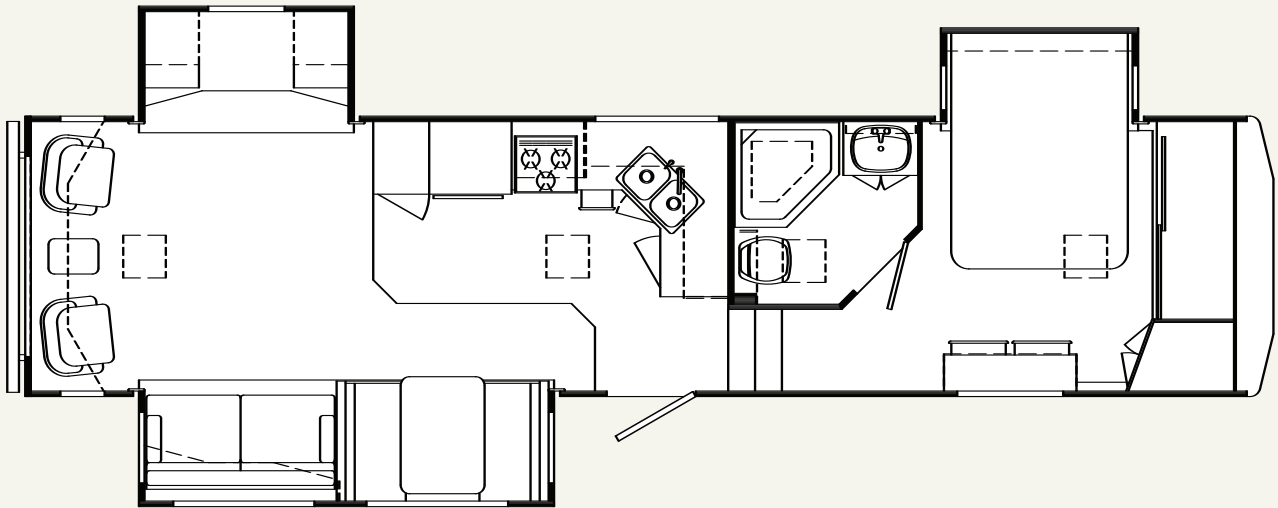

**33CKT**

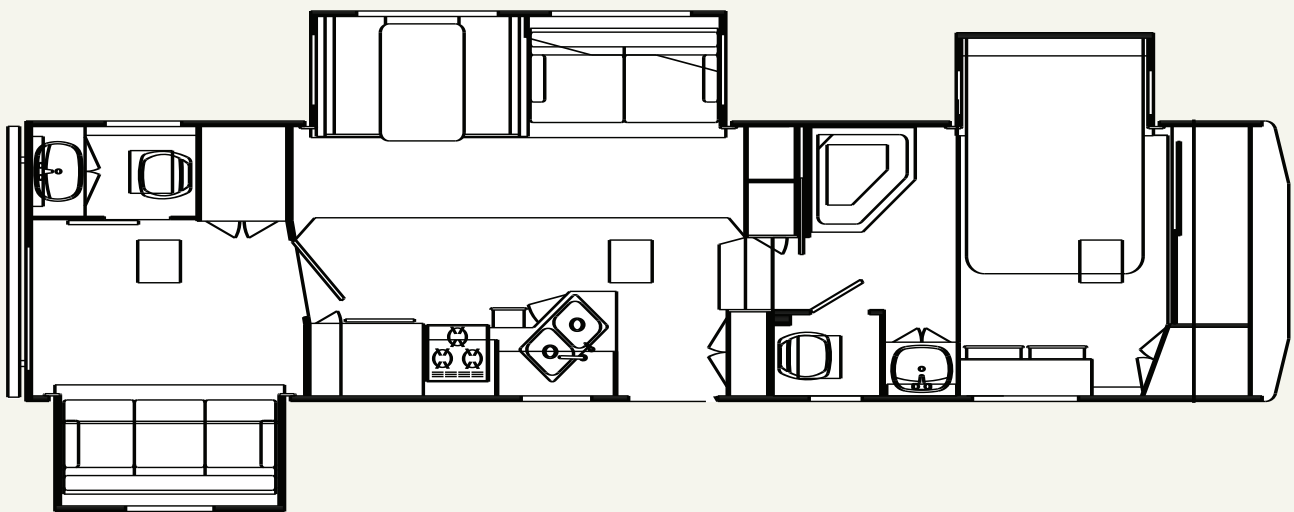

**34BHT**