

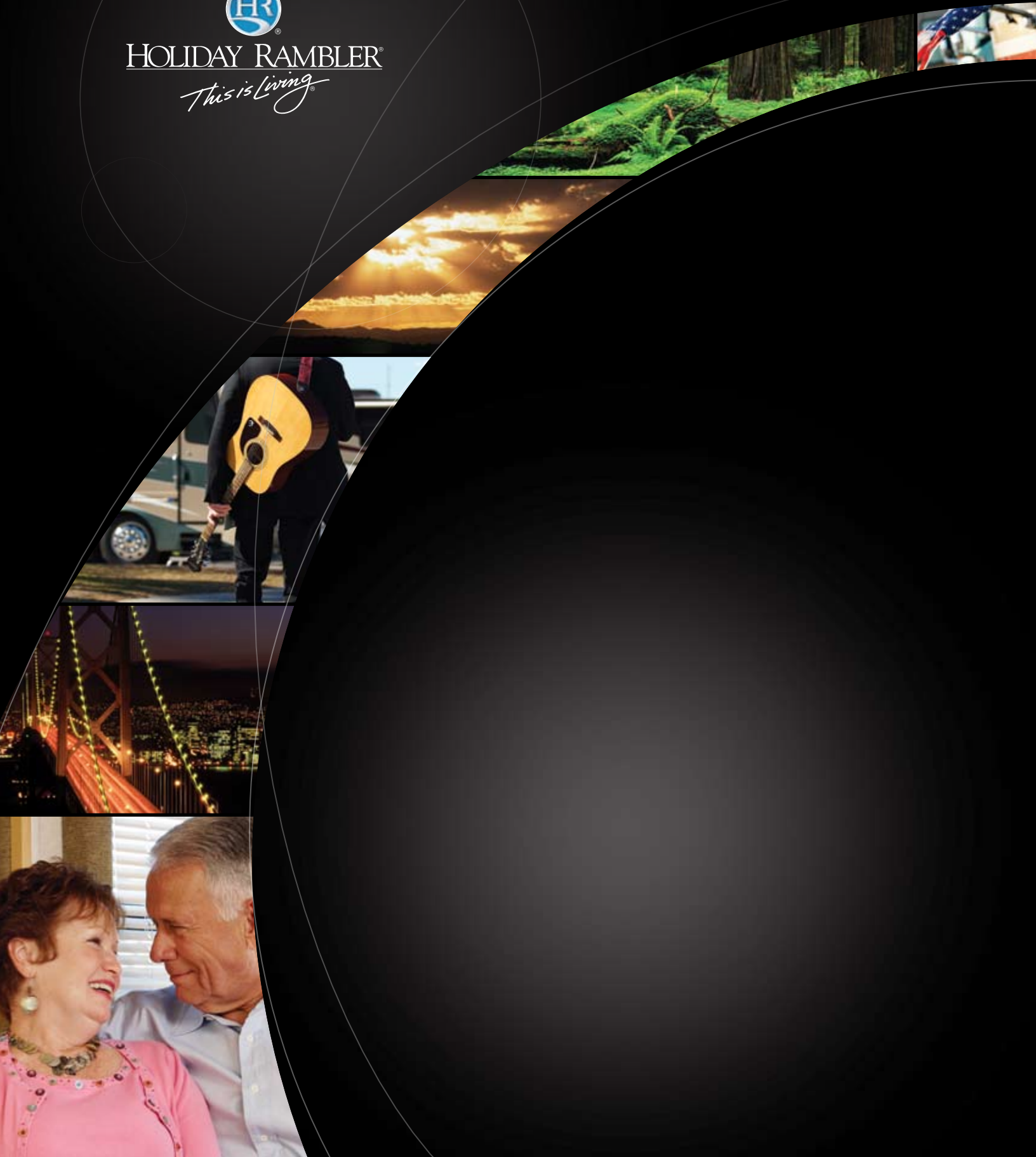

HOLIDAY RAMBLER®

This is Living





AMBASSADOR®

A BEAUTIFUL REFLECTION OF YOU.

Holiday Rambler makes it easy to take your style on the road. We offer a variety of decors – each as lovely as the next with rich fabrics, lustrous woods, eye-catching accents and stunning exterior graphics. So the problem isn't finding a look you like, it's narrowing it down to just one.

- A. BEDSPREAD
- B. SOFA
- C. ACCENT
- D. CARPET

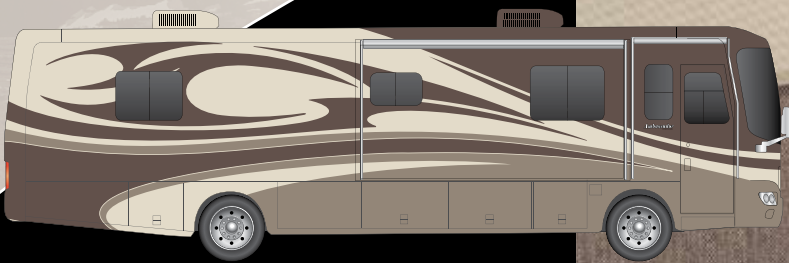
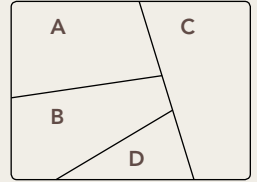

SAND PEBBLE

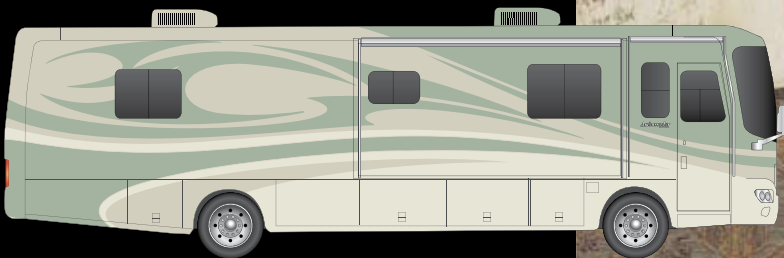

SPANISH MOSS



AMBASSADOR HARDWARE

Great design can be found in the details, like our stylish cabinet hardware with a satin nickel finish.



Manufactured in, not added on. For added protection against stains, soil repellent is applied to virtually all upholstery fabric during the finishing process for superior coverage.*

*Brand and application of upholstery fabric protection may vary depending on date recreational vehicle was manufactured.



NEW VINTAGE OAK



CHAMPAGNE SELECT



NEWPORT CHERRY

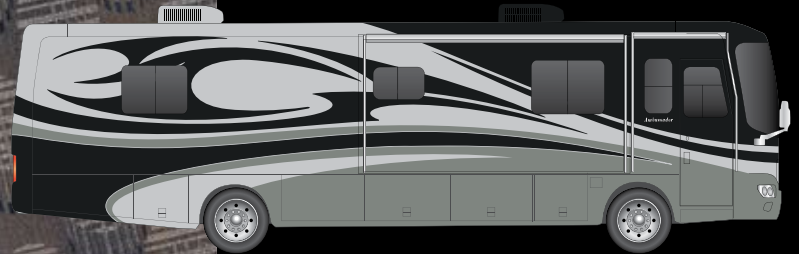

MIRAGE

HOLIDAYRAMBLER.COM

Log on to our website anytime, night or day. It's your link to everything Holiday Rambler, including product news and updates, club events, dealer and service center info and much more. Take it for a test drive today.





AMBASSADOR®

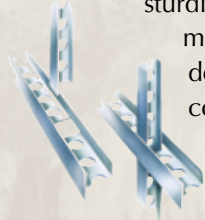

Alumaframe®

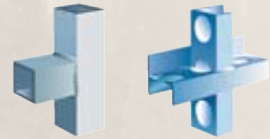

Aluminum
(Butt-Welded)

Alumaframe®
(C-Channel)

1 The Ambassador features Holiday Rambler's exclusive Alumaframe® Superstructure. Our revolutionary system of interlocking aluminum H and C-Channel crossmembers runs the entire length of the unit, with double-welded intersections for added strength. This rigid design is both lighter and sturdier than tubular aluminum frames — and much more reliable than butt-welded or screwed joint designs. From dirt roads to potholes, you can count on Alumaframe® to handle the relentless stresses of the road and provide superior structural integrity for many years to come.

2 A steel cage cockpit gives the Roadmaster chassis incomparable strength and safety in the front of the coach.

3 Every Roadmaster chassis features a steel firewall for added protection in the cockpit.

4 Stacked aluminum intercooler and radiator for optimum heat transfer and cooling.

5 Dual fuel fill allows you to fill the tank from either side of the coach, for greater convenience and flexibility at the pump.

ROADMASTER RAISED RAIL RR8R CHASSIS

The 2007 Ambassador owes its remarkable performance to the Roadmaster Raised Rail RR8R Series chassis. You'll marvel at the seamless ride and handling that's only possible in a chassis that's designed exclusively for a luxury motorcoach and custom-built to the exact specifications of each floorplan. We invite you to take a few minutes and discover all the ways Roadmaster offers you the very best in safety, reliability, comfort and convenience.

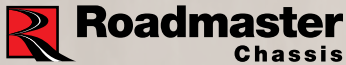
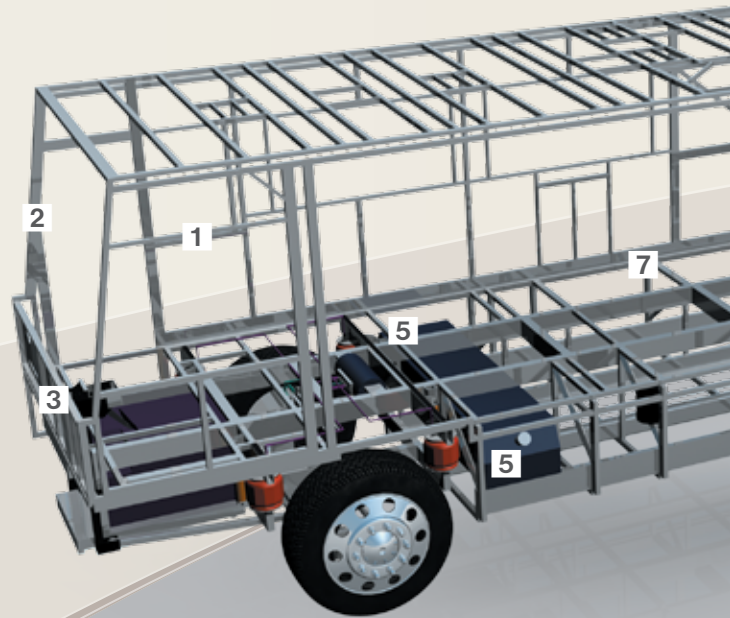

9-LAYER ROOF (top to bottom)

- One-piece peaked fiberglass roof
- Luaun backing
- Thick, tapered bead foam insulation
- Aluminum double I-beam superstructure filled with fiberglass insulation
- Vapor barrier
- Structure foam: thermal insulative barrier
- 1/2" bead foam insulation
- Foam padding for extra insulation
- Padded vinyl ceiling

6 Eight outboard-mounted air bags work in conjunction with eight gas-powered shock absorbers to prevent road trauma from ever reaching the coach.

7 This steel truss system is engineered as part of the chassis and provides outstanding strength and rigidity, as well as the convenience of pass-through storage. To prevent corrosion, the structure is pre-primed and coated with rust-inhibiting paint.

8 Monitored leveling sensors continually adjust the air pressure at each axle to maintain a level ride and eliminate nosediving, weight transfer and floating on curved roads. This system also stabilizes the coach on uneven surfaces.

9 The exclusive raised rail design provides for larger full pass-through storage bays with flush floors. Other features include a 3/8" thick frame rail — compared to the 1/4" of other manufacturers.

10 A 10,000 lb. tow hitch rating is the highest in its class.

11 The Ambassador features a gutsy standard Cummins® ISC 330 diesel engine with Allison® 3000 MH 6-Speed World Transmission and electronic shifter.

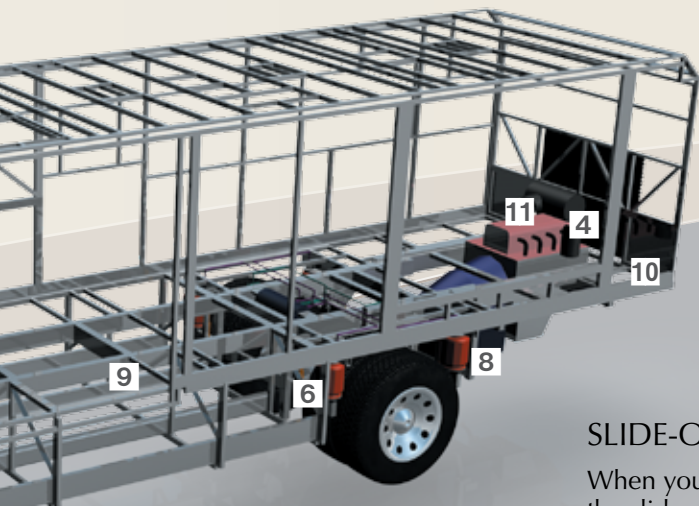

SLIDE-OUT CONSTRUCTION

When you purchase a Holiday Rambler, you can be sure the slide-out boxes are some of the strongest and most reliable you'll find anywhere. They feature our exclusive multi-layer construction to give you maximum insulation and to reduce the chance of warping, twisting or shifting.

5-LAYER EXTERIOR WALL (left to right)

- Gel coat fiberglass
- Interlocking C-Channel filled with 1-1/2" fiberglass insulation glued in place so it doesn't sag or leave spaces uninsulated
- Vapor barrier
- Bead foam saves energy and provides a thermal insulative barrier
- Interior paneling

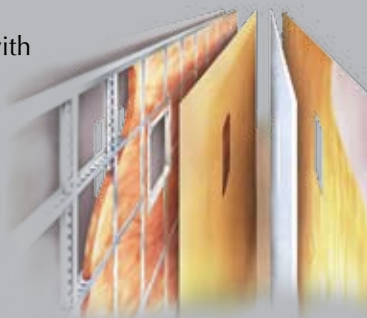

5-LAYER FLOOR (top to bottom)

- Structurwood™
- 1-1/2" x 1-1/2" square tubular frame
- Blue foam
- Luaun
- Darco

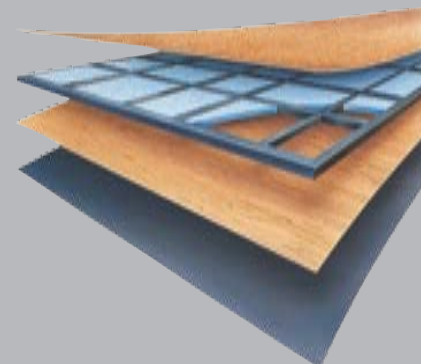



BODY CONSTRUCTION: FEATURES

- Alumaframe® Superstructure
- Steel Cage Cockpit Construction
- Peaked One-Piece Fiberglass Roof with Fiberglass Insulation
- Smooth Gel Coat Fiberglass Exterior Walls
- Panaview™ 1-Piece Front Windshield
- 84" Interior Height
- Front and Rear Molded Fiberglass Cap
- One-Piece Generator Access Door
- Rear Engine Doors with Struts
- Steel Framed Floor on Steel Trusses
- Laminated Structurwood™ Flooring
- Electric Flush-Floor Stepwell Cover
- Interior Paneling with 3/4" Insulation
- Foam Insulated Floor Framing with Luaun Backer
- 17.5" Chrome Head Power Heated Remote Mirrors
- Flush-Mounted Metal Fuel Doors
- 30" Deep Bedroom Slide-Outs
- Side-Hinged Baggage Doors
- One-Piece Polyethylene Pass-Through Storage Compartment
- Wheel Mud Flaps
- Full-Length Mud Flap

- 3M Film Front Mask
- Deluxe Full-Body Paint
- Roof Ladder
- Undercoating

OPTIONS

- Storage Bay Slide-Out Tray, Pass-Through
- Slide-Out Battery Tray

CHASSIS/ENGINE/SUSPENSION: FEATURES

- Roadmaster Raised Rail Chassis RR8R
- Cummins® ISC 330 Engine with Allison® 3,000 MH 6-Speed World Transmission and Electronic Shifter
- Engine Displacement: 8.3L/506 Cu. In.
- Torque: 950 lbs./ft. Max. Net at 1,300 RPM
- Polished Stainless Steel Engine Exhaust Tailpipe Tip
- Fuel Tank Capacity 100 Gallon
- Dual Fuel Fill
- 160 Amp Alternator
- Rear Axle Ratio: 4.30:1
- Radial Tires: 275/70R/22.5
- Polished Aluminum Wheels
- 8 Gas Shocks
- 8 Outboard-Mounted Air Bags
- Anti-Lock Braking System with Full Air Brake
- Automatic Traction Control
- Exhaust Brake
- Auto Slack Adjusters
- Pre-Wire for Supplemental Braking System
- Transmission Temperature Gauge
- Air Cleaner Restrictor Gauge
- Fuel and Water Separator
- Remote Transmission Fill
- Automatic Leveling System (3-Point)
- 10,000 Lb. Hitch Receiver with Dual Connector (4-Pin or 7Pin)

COCKPIT: FEATURES

- New Automotive Dash with Oxford Burl Wood Instrumentation Panel
- 12V Chassis Battery Gauge on Dash
- CD Player/Radio with DVD Player, Sirius-Ready Compatibility, Weather Band, IR Repeater Remote
- Wood-Framed Cabinet Doors with Smoked Glass over Front Entertainment Center Systems (N/A: 40SKT)
- Rear Vision System with Audio and Adjustable Camera
- Adjustable Brake and Accelerator Pedals
- Intermittent Windshield Wipers
- 6-Quart Tank for Windshield Fluid with Fluid Sensor to Tank and Low Wash Indicator on Dash
- Tilt/Telescopic Steering Wheel
- Cruise Control
- Power Steering
- ICC Light Switch to Driver's Side Console
- Audio Low Air Alarm
- Air Horns
- Molded Co-Pilot Side Console with Two-Tier Cup Holder
- Front Power Sunvisors with Integrated Motor
- Pilot and Co-Pilot Pull-Down Sunshades
- OptimaLeather™ Six-Way Power Pilot Seat
- OptimaLeather™ Six-Way Power Co-Pilot Seat with Powered Footrest
- Carpeted Driver and Passenger Floor Mats

OPTIONS

- Interior Solar Privacy Sunscreens
- Sirius Radio Satellite System with 6 Months Pre-Paid Activation
- 3-Camera Rear Vision System with Audio and Adjustable Center Camera
- Aladdin™ Junior System
- Auxiliary Defroster

APPLIANCES AND ACCESSORIES: FEATURES

- Large Four-Door Refrigerator with Ice Maker
- High-Output 3-Sealed Burner Cooktop without Oven
- Removable Solid Surface Range Covers
- Convection Spacesaver Microwave
- 24" Stereo Color TV with Remote Control in Cockpit Overhead (N/A: 40SKT)
- 32" Flatscreen LCD TV in Living Area Hutch (Replaces Front Cockpit TV) (40SKT)
- 20" Color TV with Remote Control in Bedroom (N/A: 40SKT, 40DFT)
- 20" LCD Color TV with Remote Control in Bedroom (40SKT, 40DFT)
- TV Antenna
- Home Theater Surround Sound System Added to In-Dash Stereo with DVD Player
- Exterior Hook-Ups for DSS Dish and Cable
- CB Prep
- Digital Satellite System Prep
- Interior Cable TV Hook-Up and Telephone Jacks
- Exterior Gas Line Hook-Up Prep for LP Accessories
- Washer/Dryer Prep (40PLQ)

OPTIONS

- High-Output 3-Sealed-Burner Range with Oven
- Combination Washer/Dryer (N/A: 40PLQ)
- Combination Washer/Dryer (40PLQ Available with Washer/Dryer Cabinet; Replaces One Barrel Chair)
- 32" Flatscreen LCD TV in Front Cockpit Overhead (N/A: 40SKT)
- Dometic Sidewise 14 Cu. Ft. 2-Way Refrigerator with Ice Dispenser in the Door (N/A: 38PDQ, 40DFT)
- Stainless Steel Package: Includes Stainless Steel Refrigerator, Microwave, and Cooktop
- Central Vacuum
- Fully Automatic Digital Satellite System
- Exterior Entertainment Center (26" LCD/AM/FM/CD Radio with Two Speakers)

INTERIOR: FEATURES

- New Vintage Oak Cabinetry
- Cathedral Cabinet Doors on All Upper Cabinets
- Hardwood Cabinet End Panels
- Refrigerator Raised Panel Hardwood Inserts
- Decorative Wallboard
- Wainscoting and Chair Rail (40DFT)
- New Wallpaper Border Bath
- Self-Supporting Top-Hinged Overhead Storage Doors and Positive Catches on All Other Doors
- Heavy-Duty Ball-Bearing Drawer Guides
- Wood Cabinet Drawer Boxes
- Metal Interior Grab Handle on Dash at Entry Door
- Satin Nickel Finish Cabinetry Hardware and Bath Accessories
- Polished Radius Solid Surface Kitchen Countertop with Under-Mounted Plexus-Stone Sink with Two Sink Covers
- Toe Kicks Kitchen and Bath Base Cabinets
- Corian® Solid Surface Radius Profile Bath Lavatory Countertop with Integrated Bowl
- Pullout Countertop Extension with Drawers and Corian® Top (40PDQ)
- Flip-Up Countertop Extension for Lavatory in Rear Bathroom (40DFT)
- Dinette Tops Laminated with Corian® Solid Surface Edge
- All Other Countertops Hardwood with Round Edge, Except Kitchen Bath Lavatory, and Dinette
- Kitchen Overhead Cabinets with Adjustable Shelf
- Spice Cabinet over Microwave
- Kitchen Galley Range Backsplash behind Cooktop: Prefabricated Ceramic Tile with Corian® Molding
- Entryway Laminate Tile Flooring
- Kitchen and Bath Laminate Tile Flooring
- Textured Style Nylon Carpeting with Pad in Living Area and Bedroom
- Soft Touch Padded Vinyl Ceiling
- Hardwood Slide-Out Fascia Design with Fluted Accents and New Decorative Center Block
- TV Hutch Cabinet in Living Area with Glass Doors on Overhead Cabinet (40SKT)
- Hall Cabinet (40SKT)
- Decorative Accent Mirror (Refrigerator Wall or Rear Wall at End of Front Slide-Out beside Refrigerator (38PDQ, 40PLQ)
- Decorative Glass Doors for Living Room Hutch Cabinets (40SKT)
- Decorative Picture in Bedroom (N/A: 40DFT)
- Decorative Picture (40SKT, 40DFT)
- Hardwood Raised Panel Bathroom Door
- Crown Molding in Bedroom and Living Area on All Open Walls
- Medicine Cabinet with Adjustable Shelves (N/A on Angled Cabinets)
- Bathroom Lavatory Mirror
- Towel Bar inside Private Bath
- Two Towel Rings in Bathroom
- Oversized Rear Wardrobe Closet with Deluxe Mirrored Door Frames Satin Nickel with Decorative Hardwood Header (N/A: 40PLQ)
- Bedroom Dresser Foot of Bed and Decorative Furniture Leg (40SKT)
- Bedroom Wardrobe Slide-Out Foot of Bed (N/A: 40SKT)
- Bedspread with Two Decorative Pillows
- Hardwood Headboard with Fabric Inserts
- Blackout Day/Night Pleated Shades in Living Area and in Bedroom
- Mini-Blinds in Kitchen and Bathroom
- Soil Repellant Protection on Fabric

OPTIONS

- Decors: Sand Pebble, Spanish Moss, Mirage
- Wood Choice: Newport Cherry and Champagne Select

SAFETY: FEATURES

- Fire Extinguisher
- Deadbolt Lock on Entrance Door
- 120V GFI Protected Circuit Kitchen, Bath, and Exterior
- LP Gas Detector
- Smoke Detector
- Carbon Monoxide Detector
- Driver and Passenger Three-Point Seatbelts
- Third Brake Safety Light
- Egress Window



ELECTRICAL SYSTEMS AND LIGHTS: FEATURES

- 50 Amp 120V Distribution Panel and Manual Retracting Power Cord Reel
- Energy Management System
- 2,000 Watt Inverter
- Onan® 8.0 kW QD Diesel Generator
- Four 6V House Batteries
- Two 12V Heavy-Duty Chassis Batteries
- Battery Disconnect Switch at Front Door
- 12V and 110V Outlet in Cockpit Area
- Porch Light and Exterior Step Light on Same Switch
- Exterior Power Entry Step with Light
- Interior Stepwell Entry Step Lights
- Lights in Outside Storage Compartments
- 120V Receptacles in Outside Storage Compartment
- Underhood Utility Light
- Receptacle and Phone Jack in Dinette Area
- Directional Swivel Bullet Map Lights Pilot and Co-Pilot Seats
- Halogen Light on Driver and Passenger Overhead
- Convenience Center in Hallway
- Fluorescent Light(s) under Kitchen Overhead
- Fluorescent Ceiling Lights Throughout
- Fluorescent Ceiling Lights inside Living Area Slide-Out House
- Decorative Framed Galley Ceiling Fluorescent Light with Skylight
- Decorative Lighting Satin Nickel Living Room Wall Light, Dinette Overhead, and Cosmetic Vanity Light
- Halogen Lights under Living Room and Dining Room Dresser Overhead Cabinets
- Gem Lights over Bed Satin Nickel Finish with His and Hers Switches

OPTIONS

- Exterior Tank Monitor Gauge in Wet Bay

PLUMBING AND LP SYSTEMS: FEATURES

- Kitchen Composite Under-Mounted Sink with Single Lever Satin Nickel Faucet with Pullout Sprayer
- Separate Satin Nickel Faucet for Filtered Water
- Bath Lavatory Faucet Single Handle Satin Nickel
- Demand Water System and Water Pump
- Water Pump Switch in Convenience Center, Kitchen Galley and Service Bay Area
- 10 Gallon LP Gas/Electric Water Heater with Electronic Ignition
- Winterization Valving System
- Water Heater Bypass Valving
- Porcelain Toilet with Sprayer (N/A: 40SKT, 40DFT)
- China Toilet Electronic Silent Plus (40SKT, 40DFT)
- No-Fuss Flush Holding Tank Rinsing System
- Insulated Systems Compartment with Easy Access to Hook-Up
- Shower inside Wet Bay with Hot/Cold Water
- Soap Dispenser inside Utility Bay
- Gravity and Pressurized Water Fill
- Contained Storage Area for Sewer Hose (N/A with RV Sani-Con System Option)
- One-Piece Round Shower with Reeded Glass Door (40PDQ)
- One-Piece Neo-Angled Shower with Obscured Glass Door (N/A: 40PDQ, 40DFT)
- One-Piece Pear Shaped Tub with Obscured Glass Door (40DFT)
- Satin Nickel Shower Door Frame with Decorative Glass
- Satin Nickel Shower Faucet with Slide Bar and Shut-Off Valve at Shower Head

OPTIONS

- RV Sani-Con 1 System, Holding Tank Flush System; This Option Replaces Contained Storage Area for Sewer Hose
- Power Water Hose Reel
- Neo-Angled Bathtub

FURNITURE: FEATURES

- Queen Bed with Overhead Cabinet and Nightstands
- Legless Dream Dinette System with Arched Back Wood Booth Dinette (N/A: 40DFT, 40PDQ)
- Freestanding Dinette with Full-Length Wall Cabinet and Two Freestanding Chairs and Two Folding Chairs (40DFT, 40PDQ)
- Roadside: Fabric Wall Hugger Sofa with Two Pillows
- Curbside: Fabric Wall Hugger Sofa with Two Pillows
- Rear Bedroom: Two Fabric Barrel Chairs and Flip-Up Table (40PLQ)

OPTIONS

- King Bed with One Nightstand (40PDQ)
- Queen Bed Select Comfort Air Mattress
- King Bed Select Comfort Air Mattress (40PDQ)
- Roadside: Fabric Hide-A-Bed Sofa with Air Mattress and Two Pillows (N/A: 40PLQ)
- Roadside: Wraparound Computer Desk with OptimaLeather™ Euro-Recliner with Heat and Massage (N/A: 40SKT, 40DFT)
- Curbside: OptimaLeather™ Wall Hugger Sofa with Two Pillows
- Curbside: OptimaLeather™ Hide-A-Bed Sofa with Air Mattress and Two Pillows (N/A: 40SKT, 40DFT)
- Bedroom: Fabric Wall Hugger Sofa (40PLQ)
- Freestanding Dinette with Full-Length Wall Cabinet and Two New Style Freestanding Chairs and Two Folding Chairs (N/A: 40PDQ, 40DFT)

WINDOWS, DOORS AND AWNINGS: FEATURES

- Radius Flush-Mounted Dual Pane Safety Glass Dark Tinted Slider Windows
- Automatic Front Door Awning
- Front Entry Door with Removable Screen and Anti-Skid Steps
- Exterior Entry Door Grab Handle
- Metal Interior Grab Handle on Dash at Entry Door
- Eclipse Automatic Patio Awning
- Topper Slide-Out Awnings Living Area and Bedroom
- Window Awnings on All Slide-Out House Windows, Except Kitchen Windows and Slide-Out Windows under Patio Awning
- Tinted Skylight in Bathroom with Protecta Glaze
- Protecta Glaze Tinted Plexiglas® Skylight in Kitchen with Pleated Shade

OPTIONS

- Bedroom Skylight with Shade (40PLQ)
- Keyless Entry

HEATING, VENTS AND AIR CONDITIONING: FEATURES

- Dual 13.5M BTU Roof Air Conditioner with Ducted Air, Heat Pumps, and Digital Thermostat Control
- Electronic Ignition Furnace (One 31M BTU and One 20M BTU)
- Electronic AC/Heat Climate Control System
- Bath Powered Attic Fan with Wall Control of Automatic Dome and Fan Power
- Kitchen Powered Attic Fan with Wall Control of Automatic Dome and Fan Power
- 12V Heater in Wet Bay
- Wood Louver Air Return Grill for Furnace
- Metal Floor Registers Satin Nickel

OPTIONS

- Ceiling Fan in Bedroom (N/A: 38PDQ, 40SKT)
- Fantastic 12V Attic Fan with Rain Sensor with Electronic Wall Thermostat in Kitchen
- Fantastic 12V Attic Fan with Rain Sensor with Electronic Wall Thermostat in Bath

Weights (Lbs.)*	38PDQ	40PDQ	40SKT	40PLQ	40DFT
Gross Vehicle Weight Rating	33,000	33,000	33,000	33,000	33,000
Gross Combined Weight Rating	43,000	43,000	43,000	43,000	43,000
Gross Axle Weight Rating (Front)	13,000	13,000	13,000	13,000	13,000
Gross Axle Weight Rating (Rear)	20,000	20,000	20,000	20,000	20,000

Measurements

Wheelbase	237"	261"	261"	261"	261"
Overall Length	38' 10"	40' 10"	40' 10"	40' 10"	40' 10"
Overall Height (Including A/C)	12' 6"	12' 6"	12' 6"	12' 6"	12' 6"
Interior Height (Increased Height to 84")	84"	84"	84"	84"	84"
Interior Width	94.5"	94.5"	94.5"	94.5"	94.5"
Exterior Width	100.5"	100.5"	100.5"	100.5"	100.5"

Tank Capacity (Gal.)**

Water Heater	10	10	10	10	10
Gray Tank	60	60	60	60	60
Black Tank	40	40	40	40	40
Fresh Tank	100	100	100	100	100
Fuel Tank	100	100	100	100	100
LP Tank***	40	40	40	40	40

* Towing capacity is limited by GCWR; your vehicle's towing capacity is the difference between the GCWR and the actual vehicle weight, including all water, fuel, passengers and cargo. Your towed vehicle should be equipped with auxiliary brakes if the weight of the towed vehicle exceeds 1,000 lbs. Consult your Owner's Manual for further towing information.

** All tank capacities are estimated based upon calculations provided by the tank manufacturers and represent approximate capacities. The actual "usable capacity" may be greater or less than the estimated capacities based upon fabrication and installation of the tanks.

*** Actual filled LP capacity is 80% of listing due to safety shut-off required on tank.

The actual overall length of the recreational vehicle may differ from that indicated in the brochure due to variances in the manufacturing process and/or installed components. The actual length may be greater or less than that indicated. Due to the large variety of options and floorplan arrangements available to our customers, actual weights for each unit can differ significantly. Holiday Rambler provides a weight sticker on each unit we produce which includes that unit's tank capacities and approximate weight. Consult your local Holiday Rambler dealer for unit availability and further information. The information printed in this brochure reflects product design, fabrication, and component parts at the date of printing. The manufacturer reserves the right, at any time, to make changes in product design or material or component specifications as its sole option, without notice. This includes the substitution of components of a different brand or trade name which will result in comparable performance. All information printed in this brochure is subject to change after the date of printing. Some features shown or mentioned in this brochure are optional and may only be available in selected floorplans. Photographs may show props or decorations that are not standard equipment on Holiday Rambler models. Holiday Rambler, the Holiday Rambler logo and its design, are registered trademarks. All other products and company names are trademarks and/or registered trademarks of their respective holders. While the color of the motorhome's exterior and the interior fabrics depicted in this sales brochure are fair and reasonable depictions, the colors depicted may not be an exact match of the actual colors because of the variances in photo-processing and variances caused by inserting the photographs within the sales brochure. Due to product improvements, changes during the model year and/or transcription errors that may occur, information represented within this brochure may not be accurate at the time of your purchase. If certain information is significant to your purchasing decision, please confirm the information with your dealer prior to submitting your order. Component part and appliance manufacturers issue limited warranties covering those portions of the recreational vehicle not covered by the Limited Warranties issued by Monaco Coach Corporation. To learn which specific component parts and appliances are excluded from the Limited Warranties issued by Monaco Coach Corporation, please contact your selling dealership or Monaco Coach Corporation directly, or review the warranty packet inside the recreational vehicle.

2007 FLOORPLANS ■ CARPET ■ TILE

38 PDQ

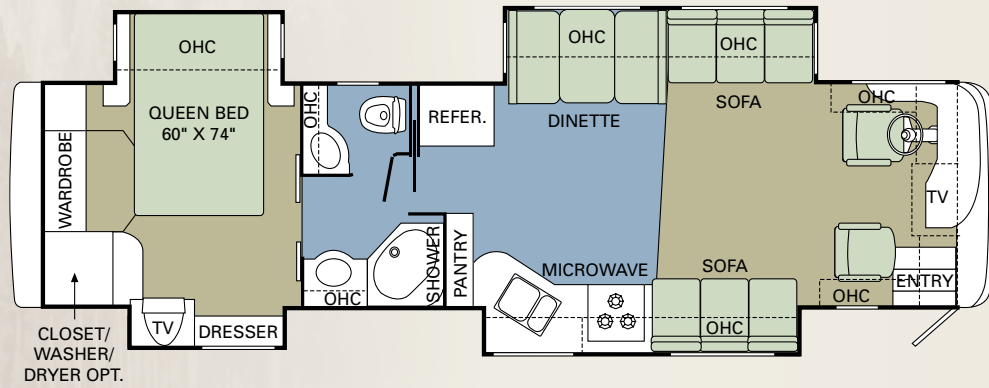

40 PDQ

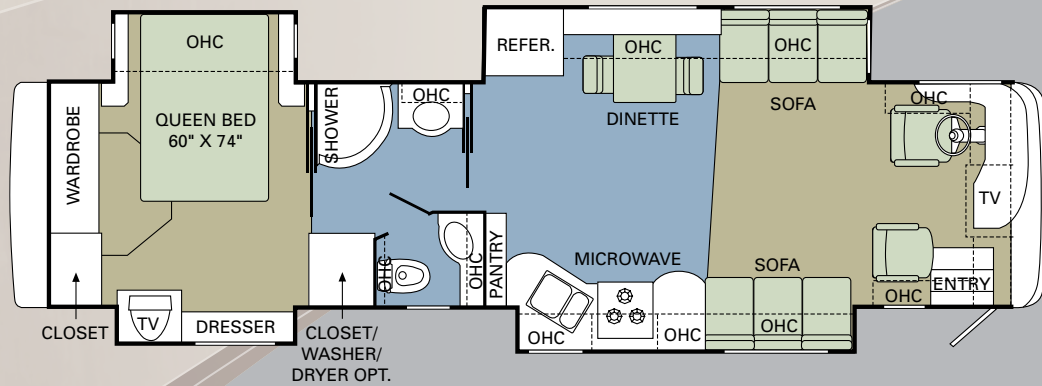

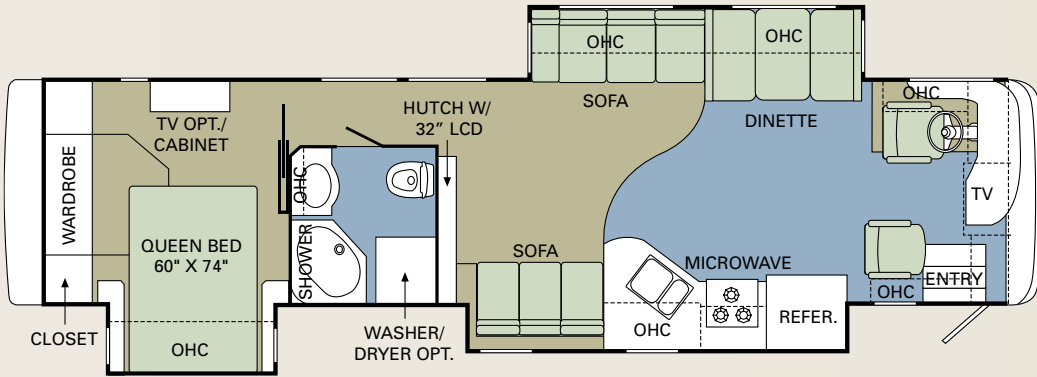

40SKT

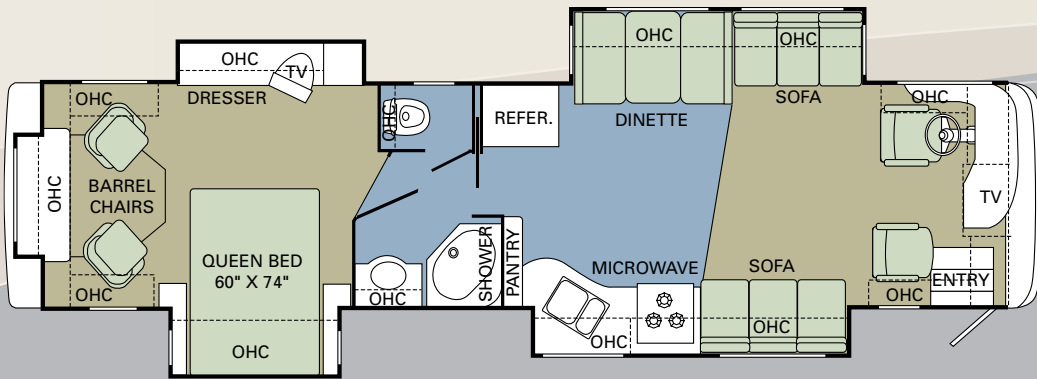

40PLQ

EXCLUSIVE HYDRAULIC

FULL-WALL SLIDE
 PANA suite

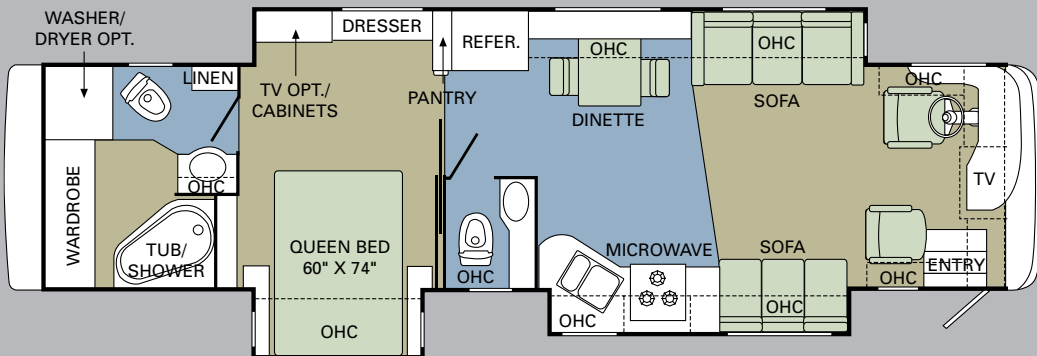

40DFT

THE POWER BEHIND THE NAME.

At Holiday Rambler, every one of our RVs shares something special – something that’s hard to describe, but easy to recognize. It’s that unique touch that makes Holiday Rambler stand apart. It’s our complete dedication to quality at every level – from the designers who create unique looks to the craftsmen who apply the finishing touches. It’s our unbeatable service, which gives you 24-hour availability, 365 days a year. It’s a commitment to safety and a tradition of innovation. And finally, it’s the best people in the business. The Holiday Rambler difference. It’s in every RV we make – including yours.



HOLIDAY RAMBLER®
This is Living®

DEALER:

606 Nelson’s Parkway Wakarusa, IN 46573
www.holidayrambler.com (800) 245-4778



ASSISTANCE
SALES • TECH • ROADSIDE



WE’RE HERE.
ANYTIME, EVERY TIME.

- Reach us anytime – literally – via our live customer support line.
- Drive in to one of our 350 Service Centers.
- Enjoy the first year free when you enroll in our Owner Advantage Roadside Assistance Program.
- See where it all begins with a tour of one of our facilities in Indiana or Oregon. Call 1-800-650-7337 or 1-800-634-0855 to find out more.

WARRANTIES

12 MONTH/24,000 MILE
basic limited warranty

5 YEAR/50,000 MILE limited
warranty on aluminum or steel
frame structure of sidewall,
roof, front and rear cap

3 YEAR/36,000 MILE limited
warranty on Roadmaster chassis

Applies to certain models. See owner’s
manual for complete details.

MONACO COACH CORPORATION

Monaco is traded on the New York Stock Exchange under the listing MNC.
© 2006, Monaco Coach Corporation 6/06 NPN:BROHAMB Litho in USA.

MNC
LISTED
NYSE

