

2007 ADMIRAL®



HOLIDAY RAMBLER®

This is Living®





This is Living®





30SFS | CHAMPAGNE SELECT | INDIGO PALMS

YOUR FUTURE IS WAITING.

No one can see into the future, but with a 2007 Admiral, your future looks bright — filled with adventure, family fun, travel and new friends. Admiral wins you over right from the start with a new front grille and cool exterior graphics for a dynamic look. Once inside, Admiral is full of surprises with an overall roomy feel and residential features including wallpaper borders and nylon carpeting with pads in the living area and bedroom. It's easy to make yourself at home with comfortable furniture, including sizable sofas that can be upgraded to hide-a-beds for extra guests. Admiral's innovative floorplans make the most of whichever size you choose, so there's

always plenty of room for everyone. And, you'll find a place for all their stuff thanks to plenty of overhead cabinets with self-supporting top-hinged doors.

LIVING LARGE.

Live big with Holiday Rambler's exclusive PanaSuite™ full-wall slide. A single slide that gives you more uninterrupted space at the touch of a button. It's a big idea that you'll find on Admiral's 33SFS floorplan and the 30SFS Admiral SVE.



A BEAUTIFUL REFLECTION OF YOU.

Holiday Rambler makes it easy to take your style on the road. We offer a variety of decors — each as lovely as the next with rich fabrics, lustrous woods, eye-catching accents and stunning exterior graphics. So the problem isn't finding a look you like, it's narrowing it down to just one.

- A. BEDSPREAD
- B. SOFA
- C. ACCENT
- D. CARPET

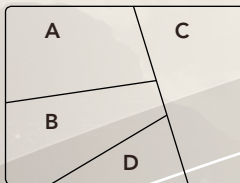

MOROCCAN SUNSET



Full-Body Paint



Standard



SVE



BETTER STAIN PROTECTION



Manufactured in, not added on. For added protection against stains, soil repellent is applied to virtually all upholstery fabric during the finishing process for superior coverage.*

*Brand and application of upholstery fabric protection may vary depending on date recreational vehicle was manufactured.

INDIGO PALMS



Full-Body Paint



Standard



SVE





NEW VINTAGE OAK



NEWPORT CHERRY



CHAMPAGNE SELECT



ADMIRAL HARDWARE

Admiral features an elegant cabinet hardware design with a stylish satin nickel finish.



GREAT LAKES



Full-Body Paint



Standard



SVE



BROWN SUGAR



Full-Body Paint



Standard



SVE

ALUMAFRAME® CONSTRUCTION SINCE 1966:

The Admiral features Holiday Rambler's exclusive Alumaframe® Superstructure. Our revolutionary system of aluminum C-Channel crossmembers runs the entire length of the unit, with double-welded intersections for added strength. This rigid design is both lighter and sturdier than tubular aluminum frames — and much more reliable than butt-welded or screwed joint designs. From dirt roads to potholes, you can count on Alumaframe® to handle the relentless stresses of the road and provide superior structural integrity for many years to come.

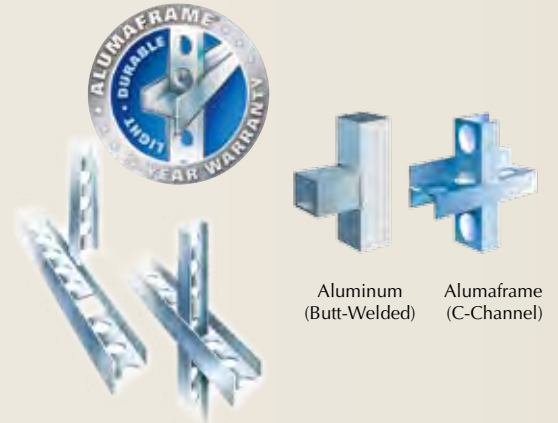

Aluminum (Butt-Welded) Alumaframe (C-Channel)

SLIDE-OUT CONSTRUCTION:

When you purchase a Holiday Rambler, you can be sure the slide-out boxes are some of the strongest and most reliable you'll find anywhere. They feature our exclusive multi-layer construction to give you maximum insulation and to reduce the chance of warping, twisting or shifting.

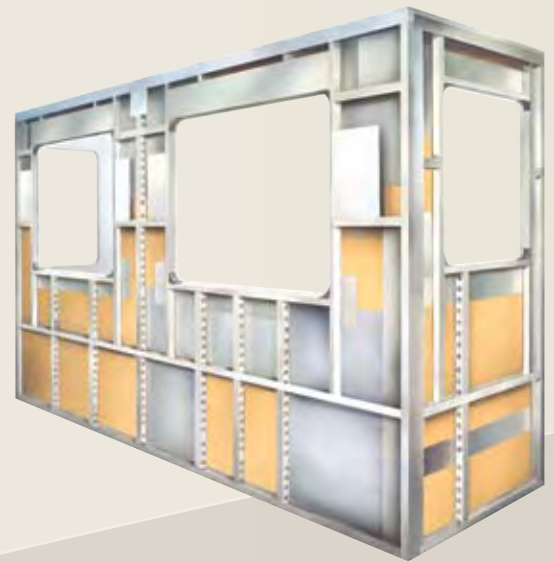

9-LAYER ROOF CONSTRUCTION

(top to bottom)

- One-piece peaked fiberglass roof
- Luaun backing
- Thick, tapered bead foam insulation
- Aluminum double I-beam superstructure filled with fiberglass insulation
- Vapor barrier
- Structure foam: thermal insulative barrier
- 1/2" bead foam insulation
- Foam padding for extra insulation
- Padded vinyl ceiling



5-LAYER SIDEWALL CONSTRUCTION

(left to right)

- Smooth gel coat fiberglass is standard; smooth .060 aluminum is standard on SVE models
- Interlocking C-Channel filled with 1-1/2" fiberglass insulation bonded in place so it doesn't sag or leave spaces uninsulated
- Vapor barrier
- Bead foam adds comfort, saves energy and provides a thermal insulative barrier
- Interior paneling

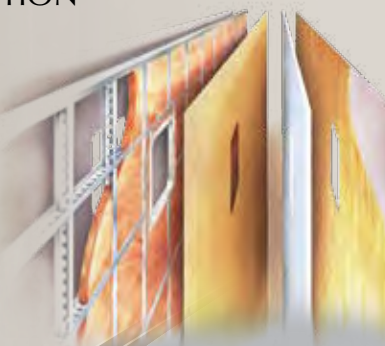

4-LAYER FLOOR CONSTRUCTION

(top to bottom)

- Structurwood™
- Blue foam insulation
- 1-1/2" aluminum tube
- Three-ply poly underbelly

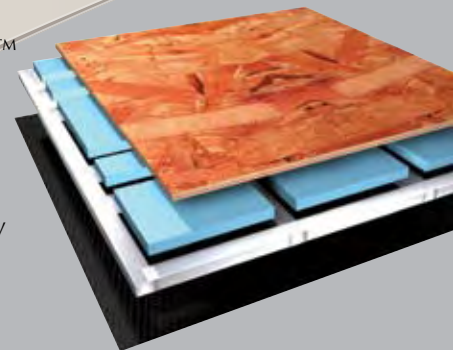

H O L I D A Y R A M B L E R . C O M

Log on to our website anytime, night or day. It's your link to everything Holiday Rambler, including product news and updates, club events, dealer and service center info and much more. Take it for a test drive today.



BODY CONSTRUCTION: FEATURES

- Alumaframe® Superstructure
- Steel Cage Cockpit Construction
- Peaked One-Piece Fiberglass Roof with Fiberglass Insulation
- Smooth Gel Coat Fiberglass Exterior Walls
- Front and Rear Molded Fiberglass Caps
- Panaview™ 1-Piece Front Windshield
- Interior Height 84"
- Aluminum Framed Floor on Steel Trusses
- Laminated Structurwood™ Flooring
- Interior Paneling with 3/4" Insulation
- Foam Insulated Floor Framing with 3-Ply Underbelly
- Power Heated Remote Exterior Mirrors
- 30" Deep Bedroom Slide-Out Houses (N/A: 33SFS, 34SBD, 37PRT)
- Pass-Through Storage Bays under Slide-Outs
- Side-Hinged Baggage Doors
- Painted Mask and Skirt with Vinyl Exterior Graphics
- Undercoating

OPTIONS

- Deluxe Full-Body Paint with Vinyl Graphics — Any Awning Selected with Full-Body Paint Will Have Metal Cover
- 3M Film Front Mask
- Standard Run Savings Package: Soft Touch Vinyl Pilot and Co-Pilot Seats, 3-Camera Rear Vision System, Power Sunvisors, Pilot and Co-Pilot Side Window Pull-Down Sunshades, 20" Color TV with Remote Control in Bedroom, Home Theater Surround Sound System with Sub-Woofer, Hardwood Raised Panel Doors on Refrigerator, Energy Management System, 600 Watt Inverter, Storage Compartment Tank Monitor Gauge, Fantastic 12V Attic Fan with Rain Sensor with Electronic Wall Thermostat in Bath, 12V Heater in Wet Bay, Eclipse Automatic Patio Awning

FORD 22,000 LB. CHASSIS/ENGINE/SUSPENSION (N/A: 33SFS)

- 6.8L 3-Valve V-10 Gasoline Engine with Electronic Fuel Injection
- Engine Displacement: 6.8 Liters 415 Cu. In.
- Power: 362 HP
- Torque: 457 lbs./ft.
- TorqShift 5-Speed Automatic Overdrive Transmission with Tow/Haul Mode
- Fuel Tank Capacity 75 Gallon
- 130 Amp Alternator
- Rear Axle Ratio 5.38:1
- Radial Tires 235/80R 22.5G
- Polished Aluminum Wheels
- Leaf Spring Suspension
- 4-Wheel Anti-Lock Disc Brakes
- Heavy-Duty Front Track Bar with Bilstein® Shock Absorbers
- Fully Automatic Hydraulic Leveling System
- Pre-Wire for Supplemental Braking System
- 4,000 Lb. Hitch Receiver with Dual Connector 4-Pin or 7-Pin
- Smart Structure II

WORKHORSE 22,000 LB. CHASSIS/ENGINE/SUSPENSION

- 8.1L V-8 Gasoline Engine with Electronic Fuel Injection
- Engine Displacement: 8.1 Liters 496 Cu. In.
- Power: 340 HP Torque: 455 lbs./ft.
- 6-Speed Automatic Transmission with Overdrive

- Fuel Tank Capacity 75 Gallon
- 145 Amp Alternator
- Rear Axle Ratio 5.86:1
- Radial Tires 235/80R 22.5G
- Stainless Steel Wheel Liners
- Leaf Spring Suspension
- ABS Brake System
- Fully Automatic Hydraulic Leveling System
- Pre-Wire for Supplemental Braking System
- 4,000 Lb. Hitch Receiver with Dual Connector 4-Pin or 7-Pin
- Smart Structure II

COCKPIT: FEATURES

- Fiberglass Automotive Dash with Vinyl Covering, with Oxford Burl Instrumentation Panel
- CD Player/Radio with DVD Player, Sirius-Ready Compatibility, Weather Band, Remote, and Four Speakers
- Multi-Positioned Sunvisors
- Rear Vision System Prep
- Fabric Pilot and Co-Pilot Recliner Seats
- Six-Way Power Pilot Seat
- Dash Workstation
- Secure Front Cab over TV with Steel Framing

OPTIONS

- Six-Way Power Co-Pilot Seat
- Soft Touch Vinyl Pilot and Co-Pilot Seats
- Sirius Radio Satellite System with 6 Months' Pre-Paid Activation
- GPS Navigation System (Requires Rear Vision System)
- Single Camera Rear Vision System with Audio and Adjustable Camera
- 3-Camera Rear Vision System with Audio and Adjustable Center Camera
- Power Sunvisors
- Pilot and Co-Pilot Side Window Pull-Down Sunshades
- Interior Sunscreens
- CB Radio Prep
- Driver's Side Door with Power Window

APPLIANCES AND ACCESSORIES: FEATURES

- Large Double-Door Refrigerator
- High-Output 3-Burner Cooktop without Oven
- Spacesaver Convection Microwave with Touch Control
- 24" Stereo Color TV with Remote Control in Cockpit Overhead
- DVD and Video Control Box with Booster and RF Modulator. Control Boxes Allow DVD Player to Play Video in Bedroom TV
- Wiring for DVD Player Hook-Up to Both TV Locations
- Exterior Hook-Ups for DSS Dish and Cable
- Interior Cable TV Hook-Up and Telephone Jacks
- Digital Satellite System Prep
- Exterior Gas Line Hook-Up Prep for LP Accessories

OPTIONS

- Large Double-Door Refrigerator with Ice Maker
- Large 10 Cu. Ft. Double-Door Refrigerator with Ice Maker
- Large Four-Door Refrigerator with Ice Maker (N/A with Pantry) (N/A: 33SFS)
- High-Output Three-Burner Range with Oven
- Washer/Dryer Prep (N/A: 33SFS, 34SBD, 37PRT, 37PCT)
- Combination Washer/Dryer (Requires Washer/Dryer Prep Option) (N/A: 33SFS, 34SBD, 37PRT, 37PCT)



- Central Vacuum System
- 20" Color TV with Remote Control in Bedroom
- Fireplace with Decorative Hardwood Frame (37PRT)
- Home Theater Surround Sound System with Sub-Woofer, Added to In-Dash Stereo with DVD Player
- Exterior Entertainment Center, CD Player Radio with Two Speakers

INTERIOR: FEATURES

- New Vintage Oak Cabinetry
- Raised Panel Cathedral Upper Cabinet Doors and Wardrobe Doors, Flat Panel Doors on Base Cabinets
- Heavy-Duty Ball Bearing Drawer Guides
- Satin Nickel Cabinetry Hardware and Bath Accessories
- Pullout Countertop Extension with Two Drawers Built In (N/A: 33SFS, 37PCT)
- Countertops Are Laminate with Perm-Edge
- Kitchen Pantry next to Refrigerator with Full-Height Roll-Out Storage Cabinet (N/A with Four-Door Refrigerator Option)
- Bevel V-Grooved Mirror behind Stove Area (33SFS)
- Laminate Tile Flooring Kitchen, Bath and Entry
- Nylon Carpeting with Pad in Living Area and Bedroom
- Wood Slide-Out Fascia with Vinyl Inserts on Legs
- Elongated Beveled Octagon Living Area or Bedroom Mirror (N/A: 33SFS)
- Hutch with Glass Doors and Back Lighted Glass (37PRT, 37PCT)
- French Style Door into Bedroom (37PRT, 37PCT)
- Side Wardrobe Closet with Deluxe Mirror Door Frames Satin Nickel Finish (33PBD)
- Bedroom Swing-Away TV Cabinets (Stationary 33SFS, 36DBD)
- Bedspread with Two Decorative Pillows
- Decorative Fabric Headboard (N/A: 37PRT)
- Blackout Day/Night Pleated Shades in Living Area and in Bedroom, Mini Blinds in Kitchen and Bathroom, Where Applicable
- Soil Repellant on Fabric, Teflon® Fabric Protection

OPTIONS

- New Decors: Moroccan Sunset, Indigo Palms, Great Lakes, Brown Sugar
- Wood Choice: Newport Cherry, Champagne Select
- Hardwood Raised Panel Doors on Refrigerator IPO Black ABS Refrigerator Insert

FURNITURE: FEATURES

- Queen Bed with Nightstands (N/A: 37PRT)
- Murphy Bed with Side Cabinets: Fabric Jackknife Sofa Located on Bottom Side of Murphy Bed (37PRT)
- Roadside Bedroom Slide-Out, Fabric Jackknife Sofa, Two Pillows (37PRT)
- Arched Back Wood Booth Dinette, with Legless Dream Dinette Countertop and Drawer (N/A: 33SFS)
- Forward-Facing Seatbelts in Booth Dinette inside Living Area Slide-Out (N/A: 33SFS)
- Freestanding Dinette with Two Freestanding Chairs and Two Folding Chairs (33SFS)

- Roadside: Fabric Jackknife Sofa, Two Pillows on All Sofas
- Fabric Swivel Glider Barrel Chair
- Roadside Dresser below Bedroom Window (36DBD)
- Fabric Swivel Glider Barrel Chair with Desk and Desk Chair Bedroom (37PCT)

OPTIONS

- Roadside Front of Coach: Fabric Hide-A-Bed Sofa with Two Pillows
- Roadside Front of Coach: Fabric Hide-A-Bed Sofa with Air Mattress, and Two Pillows
- Soft Touch Vinyl Swivel Recliner Chair IPO Fabric Swivel Glider Barrel Chair
- OptimaLeather™ Euro-Recliner Chair with Ottoman IPO Barrel Chair
- Two Fabric Swivel Glider Barrel Chairs with Center Lift-Up Table IPO Desk and Desk Chair Bedroom (37PCT)
- Bedroom Desk IPO Dresser (36DBD)
- Hallway Bunks with 15" LCD TV and AV Game Plate Built into Outside of Bath Wall, with Bunk Ladder (34SBD)
- Freestanding Dinette with Two Freestanding Chairs and Two Folding Chairs (N/A: 33SFS)

ELECTRICAL SYSTEMS AND LIGHTS: FEATURES

- 50 Amp 120V Distribution Panel and Cord
- 60 Amp Electronic 12V Power Converter
- Onan® 5.5 kW Gas Generator
- Two 6V House Batteries
- Battery Disconnect Switches
- 12V and 110V Outlet in Cockpit Area
- Fluorescent Ceiling Lights Throughout
- Satin Nickel Halogen Lights under Living Room and Dining Room Overhead Cabinets

OPTIONS

- 50 Amp Energy Management System
- 600 Watt Inverter
- Storage Compartment Tank Monitor Gauge

PLUMBING AND LP SYSTEMS: FEATURES

- Stainless Steel Kitchen Sink with Single Lever Brushed Nickel Faucet
- Separate Brushed Chrome Faucet for Filtered Water
- Satin Nickel Bath Lavatory Faucet
- Demand Water System and Water Pump
- 10 Gallon LP Gas/Electric Water Heater with Electronic Ignition
- Winterization Valving System
- No-Fuss Flush Holding Tank Rinsing System
- Insulated Systems Compartment with Easy Access to Hook-Up
- Gravity and Pressurized Water Fill
- One-Piece Fiberglass Shower
- Satin Nickel Shower Door Frame with Obscure Glass
- Rounded Satin Nickel Shower Door Frame with Decorative Glass

OPTIONS

- RV Sani-Con 2 System, Holding Tank Flush System with Hanging Bracket for Hose
- Bathtub IPO Shower (Rounded Shower Stalls Will Be Neo-Angled with Tub Option)

HEATING, VENTS AND AIR CONDITIONING: FEATURES

- Dual 13.5M BTU Air Conditioner, with Ducted Air and Wall Thermostats
- 35M BTU Electronic Ignition Furnace
- Electronic Dash AC/Heat Climate Control System
- In-Floor Ducted Heating System with Metal Floor Registers
- Kitchen Powered Attic Fan with Wall Control of Automatic Dome and Fan Power
- Bath Powered Attic Fan with Wall Control of Automatic Dome and Fan Power

OPTIONS

- Dual 13.5M BTU Air Conditioner with Heat Pumps
- Fantastic 12V Attic Fan with Rain Sensor with Electronic Wall Thermostat Kitchen
- Fantastic 12V Attic Fan with Rain Sensor with Electronic Wall Thermostat in Bath
- 12V Heater in Wet Bay, Heat Pad on Fresh Tank

WINDOWS, DOORS AND AWNINGS: FEATURES

- Radius Flush-Mounted Dual Pane Windows Safety Glass Dark Tinted
- Rear Wall Bedroom Window (N/A: 33SFS, 36DBD)
- Bathroom Window (N/A: 33PBD, 33SFS, 34SBD)
- Radius Entrance Door with Clear Glass, Roller Shade, Screen Door and Anti-Skid Steps
- Topper Slide-Out Awnings Living Area and Bedroom
- Protecta Glaze Tinted Plexiglas® Skylight in Bathroom

OPTIONS

- Poly-Weave Patio Awning
- Eclipse Poly-Weave Automatic Patio Awning
- Poly-Weave Window Awnings Living Area Slide-Out House Windows
- Bedroom Skylight 30" x 30" Decorative Wood Framed with Shade (37PCT)
- Poly-Weave Side Window Awning Bedroom (33SFS, 34SBD, 36DBD)

Weights (Ford 22,000 Lb. Chassis)*	33PBD	33SFS	34SBD	36DBD	37PRT	37PCT
Gross Vehicle Weight Rating	22,000	N/A	22,000	22,000	22,000	22,000
Gross Combined Weight Rating	26,000	N/A	26,000	26,000	26,000	26,000
Front Gross Axle Weight Rating	7,500	N/A	7,500	7,500	7,500	7,500
Rear Gross Axle Weight Rating	14,500	N/A	14,500	14,500	14,500	14,500

Weights (Workhorse 22,000 Lb. Chassis)*	33PBD	33SFS	34SBD	36DBD	37PRT	37PCT
Gross Vehicle Weight Rating	22,000	22,000	22,000	22,000	22,000	22,000
Gross Combined Weight Rating	26,000	26,000	26,000	26,000	26,000	26,000
Front Gross Axle Weight Rating	8,000	8,000	8,000	8,000	8,000	8,000
Rear Gross Axle Weight Rating	14,500	14,500	14,500	14,500	14,500	14,500

Measurements

Wheelbase	228"	228"	228"	242"	242"	242"
Overall Length	34' 3"	34' 3"	35' 2"	36' 9"	36' 9"	37' 4"
Overall Height, Including A/C	12' 6"	12' 6"	12' 6"	12' 6"	12' 6"	12' 6"
Interior Height	84"	84"	84"	84"	84"	84"
Interior Width	94.5"	94.5"	94.5"	94.5"	94.5"	94.5"
Exterior Width	100.5"	100.5"	100.5"	100.5"	100.5"	100.5"

Tank Capacities**

Water Heater	10	10	10	10	10	10
Gray Tank (Ford/Workhorse)	45	54	40	42/39	45	45
Black Tank (Ford/Workhorse)	54	42	42	42/39	54	54
Fresh Tank	60	60	60	60	60	60
LP Tank ***	24	24	24	24	24	24

* Towing capacity is limited by GCWR; your vehicle's towing capacity is the difference between the GCWR and the actual vehicle weight, including all water, fuel, passengers and cargo. Your towed vehicle should be equipped with auxiliary brakes if the weight of the towed vehicle exceeds 1,000 lbs. Consult your owner's manual for further towing information.

** All tank capacities are estimated based upon calculations provided by the tank manufacturers and represent approximate capacities. The actual "usable capacity" may be greater or less than the estimated capacities based upon fabrication and installation of the tanks.

*** Actual filled LP capacity is 80% of listing due to safety shut-off required on tank.

The actual overall length of the recreational vehicle may differ from that indicated in the brochure due to variances in the manufacturing process and/or installed components. The actual length may be greater or less than that indicated. Due to the large variety of options and floorplan arrangements available to our customers, actual weights for each unit can differ significantly. Holiday Rambler provides a weight sticker on each unit we produce which includes that unit's tank capacities and approximate weight. Consult your local Holiday Rambler dealer for unit availability and further information. The information printed in this brochure reflects product design, fabrication, and component parts at the date of printing. The manufacturer reserves the right, at any time, to make changes in product design or material or component specifications as its sole option, without notice. This includes the substitution of components of a different brand or trade name which will result in comparable performance. All information printed in this brochure is subject to change after the date of printing. Some features shown or mentioned in this brochure are optional and may only be available in selected floorplans. Photographs may show props or decorations that are not standard equipment on Holiday Rambler models. Holiday Rambler, the Holiday Rambler logo and its design, are registered trademarks. All other products and company names are trademarks and/or registered trademarks of their respective holders. While the color of the motorhome's exterior and the interior fabrics depicted in this sales brochure are fair and reasonable depictions, the colors depicted may not be an exact match of the actual colors because of the variances in photo-processing and variances caused by inserting the photographs within the sales brochure. Due to product improvements, changes during the model year and/or transcription errors that may occur, information represented within this brochure may not be accurate at the time of your purchase. If certain information is significant to your purchasing decision, please confirm the information with your dealer prior to submitting your order. Component part and appliance manufacturers issue limited warranties covering those portions of the recreational vehicle not covered by the Limited Warranties issued by Monaco Coach Corporation. To learn which specific component parts and appliances are excluded from the Limited Warranties issued by Monaco Coach Corporation, please contact your selling dealership or Monaco Coach Corporation directly, or review the warranty packet inside the recreational vehicle.

2007 FLOORPLANS ■ CARPET ■ TILE

33PBD

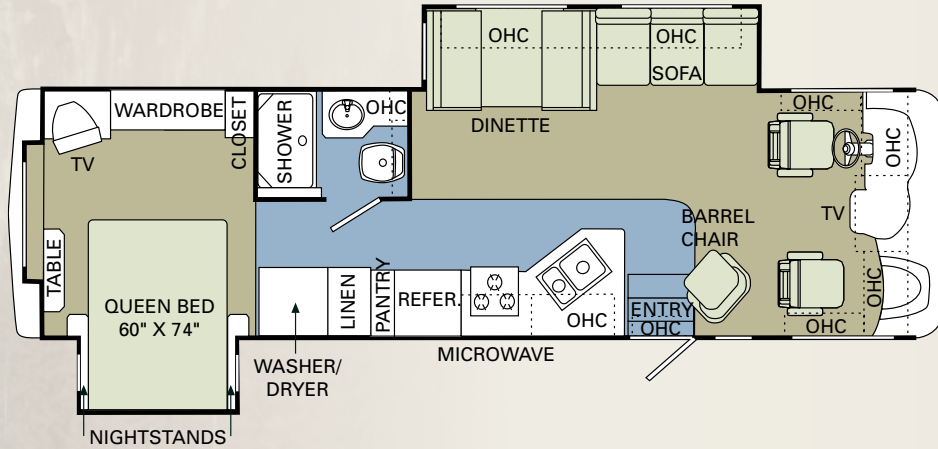

EXCLUSIVE HYDRAULIC

FULL-WALL SLIDE
 ▼ PANASUITE

33SFS

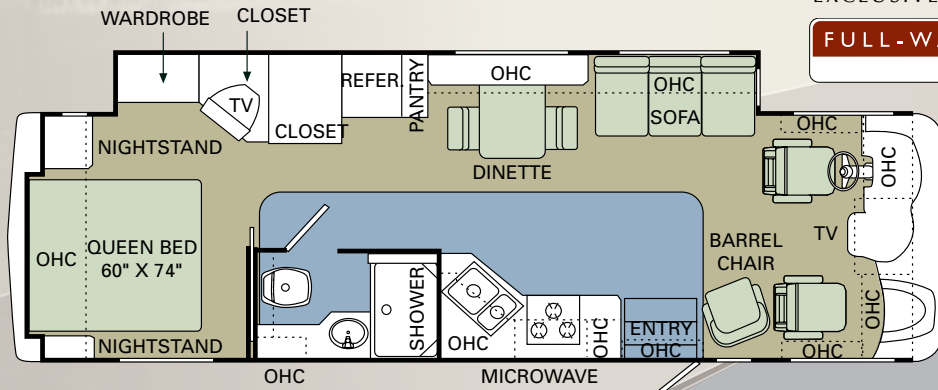

34SBD

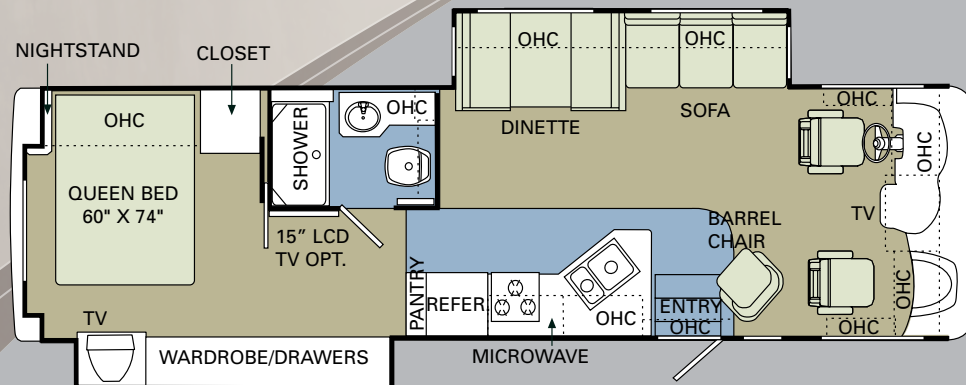

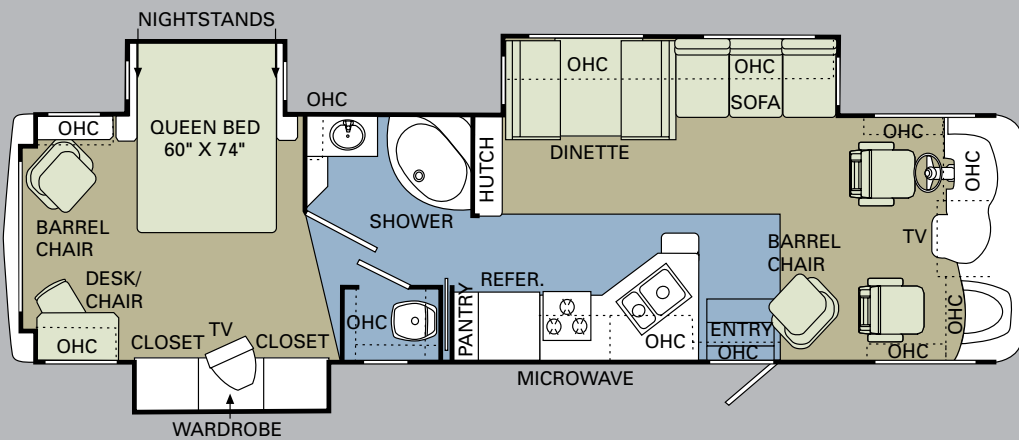
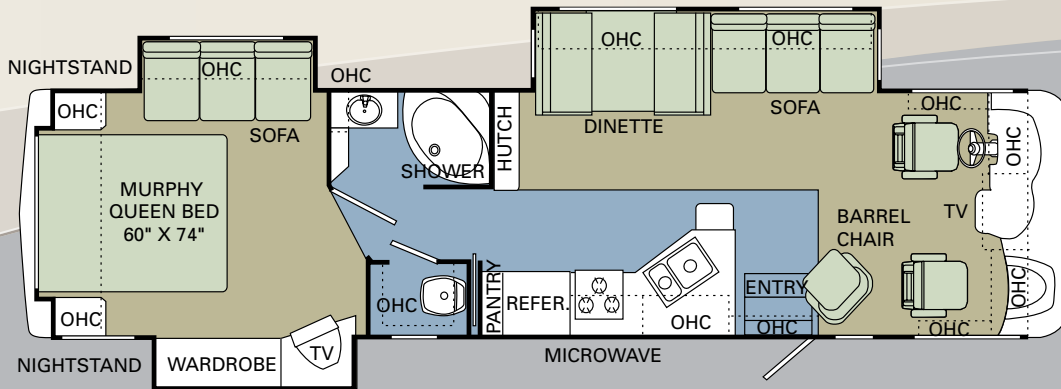
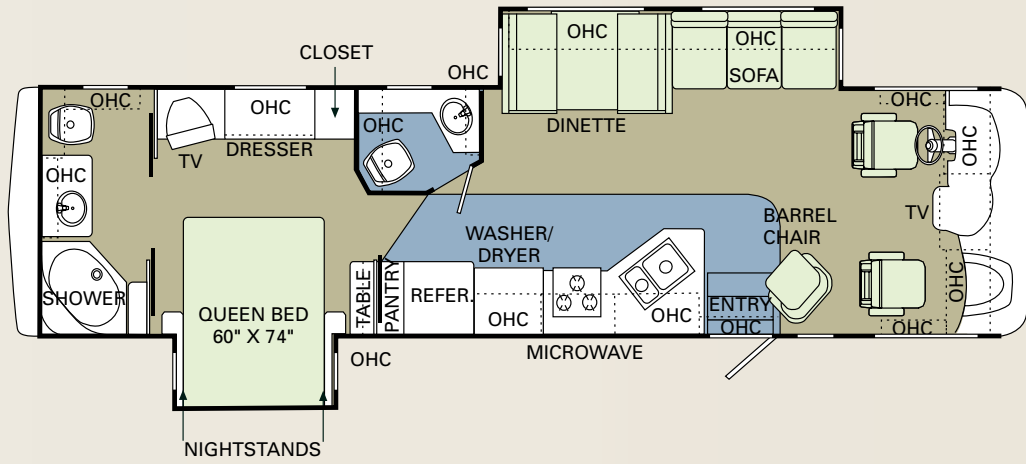

BODY CONSTRUCTION: FEATURES

- Alumaframe® Superstructure
- Steel Cage Cockpit Construction
- Peaked One-Piece Fiberglass Roof with Fiberglass Insulation
- Smooth Aluminum Exterior Walls
- Front and Rear Molded Fiberglass Caps
- Panaview™ 1-Piece Front Windshield
- Interior Height 84"
- Aluminum Framed Floor on Steel Trusses
- Laminated Structurwood™ Flooring
- Interior Paneling with 3/4" Insulation
- Foam Insulated Floor Framing with 3-Ply Underbelly
- Black Front-Mounted Exterior Mirrors
- 30" Deep Bedroom Slide-Out Houses (N/A: 30PBS, 30SFS)
- Pass-Through Storage Bays under Slide-Outs
- Side-Hinged Baggage Doors
- New Painted Skirt and Mask with Vinyl Exterior Graphics
- Undercoating

OPTIONS

- Rear Ladder
- Standard Run Savings Package: Rear Ladder, Fully Automatic Hydraulic Leveling System, Rear Vision System with Audio and Adjustable Camera, Six-Way Power Pilot Seat, Bi-Fold Range Cover, 20" Stereo Color TV with Remote Control in Bedroom, 6 Gallon LP Gas/Electric Water Heater with Electronic Ignition, DSI, 12V Heater in Wet Bay Vinyl Patio Awning

FORD 20,500 LB. AND 22,000 LB. CHASSIS/ENGINE/SUSPENSION

(20,500 LB. N/A: 33PBD)

(22,000 LB. N/A: 30PBS, 30PDD, 30SFS)

- 6.8L 3-Valve V-10 Gasoline Engine with Electronic Fuel Injection
- Engine Displacement: 6.8 Liters 415 Cu. In.
- Power: 362 HP Torque: 457 lbs./ft.
- TorqShift 5-Speed Automatic Overdrive Transmission with Tow/Haul Mode
- Fuel Tank Capacity 75 Gallon
- 130 Amp Alternator
- Rear Axle Ratio 5.38:1
- Radial Tires 245/70R X 19.5 F (Ford 20,500 Lb.)
- Chrome Wheel Covers (Ford 20,500 Lb.)
- Radial Tires 235/80R 22.5G (Ford 22,000 Lb.)
- Stainless Steel Wheel Liners (Ford 22,000 Lb.)
- Leaf Spring Suspension
- 4-Wheel Anti-Lock Disc Brakes
- Heavy-Duty Front Track Bar with Bilstein® Shock Absorbers
- Pre-Wire for Supplemental Braking System
- Hitch Receiver with Dual Connector 4-Pin or 7-Pin
- SmartStructure II

WORKHORSE 20,700 LB. AND 22,000 LB. CHASSIS/ENGINE/SUSPENSION

(20,700 LB. N/A: 33PBD)

(22,000 LB. N/A: 30PBS, 30PDD, 30SFS)

- 8.1L V-8 Gasoline Engine with Electronic Fuel Injection
- Engine Displacement: 8.1 Liters 496 Cu. In.
- Power: 340 HP Torque: 455 lbs./ft.
- 6-Speed Automatic Transmission with Overdrive
- Fuel Tank Capacity 75 Gallon
- 145 Amp Alternator
- Rear Axle Ratio 5.13:1 (Workhorse 20,700 Lb.)
- Radial Tires 245/70R x 19.5F (Workhorse 20,700 Lb.)
- Rear Axle Ratio 5.86:1 (Workhorse 22,000 Lb.)
- Radial Tires 235/80R 22.5G (Workhorse 22,000 Lb.)
- Stainless Steel Wheel Liners
- Leaf Spring Suspension
- ABS Brake System
- Pre-Wire for Supplemental Braking System
- Hitch Receiver with Dual Connector 4-Pin or 7-Pin
- SmartStructure II

OPTIONS

- Fully Automatic Hydraulic Leveling System
- Stainless Steel Wheel Simulators (Standard on Workhorse Chassis) (N/A: 33PBD) (Required Option, Ford Chassis)

COCKPIT: FEATURES

- Fiberglass Automotive Dash with Vinyl Covering, with Oxford Burl Instrumentation Panel
- CD Player/Radio with DVD Player, Sirius-Ready Compatibility, Weather Band, Remote, and Six Speakers
- Multi-Positioned Sunvisors
- Rear Vision System Prep
- Soft Touch Vinyl Pilot and Co-Pilot Recliner Seats
- Wood-Framed Cabinet Doors with Smoked Glass over Front Entertainment Center Systems
- Secure Front Cab over TV with Steel Framing

OPTIONS

- Six-Way Power Pilot Seat
- Sirius Radio Satellite System with 6 Months' Pre-Paid Activation
- Single Camera Rear Vision System with Audio and Adjustable Camera
- GPS Navigation System (Requires Rear Vision System)
- Interior Sunscreens

APPLIANCES AND ACCESSORIES: FEATURES

- Double-Door Refrigerator
- High-Output 3-Burner Cooktop without Oven
- Microwave with Touch Control and Under-Mounted Range Hood
- 24" Stereo Color TV with Remote Control in Cockpit Overhead
- TV Antenna
- DVD and Video Control Box with Booster and RF Modulator; Control Boxes Allow DVD Player to Play Video in Bedroom TV

- Exterior Hook-Ups Cable TV
- Digital Satellite System Prep
- Exterior Gas Line Hook-Up Prep for LP Accessories

OPTIONS

- Large Double-Door Refrigerator
- High-Output Three-Burner Range with Oven
- Bi-Fold Range Cover
- Convection Microwave with Touch Control and Under-Mounted Range Hood
- Central Vacuum System
- 20" Stereo Color TV with Remote Control in Bedroom

INTERIOR: FEATURES

- New Vintage Oak Cabinetry
- Heavy-Duty Ball Bearing Drawer Guides
- Satin Nickel Cabinetry Hardware and Bath Accessories
- Laminate Countertops with Laminate Perm-Edge
- Kitchen Countertop Extension (N/A: 33PBD)
- Kitchen Pantry next to Refrigerator (33PBD)
- Linoleum Flooring in Kitchen and Bath
- Nylon Carpeting with Pad in Living Area and Bedroom
- Bedspread
- Fabric Headboard
- Blackout Day/Night Pleated Shades in Living Area and in Bedroom
- Soil Repellant on Fabric, Teflon® Fabric Protection

OPTIONS

- New Decors: Moroccan Sunset, Indigo Palms, Great Lakes, Silver Circle
- Wood Choice: Newport Cherry, Champagne Select

FURNITURE: FEATURES

- Queen Bed with Nightstands
- Bedroom Desk (30PDD)
- Arched Back Wood Booth Dinette, with Side-Sliding Table Top (N/A: 30SFS)
- Freestanding Dinette with Two Freestanding Chairs and Two Folding Chairs (30SFS)
- Roadside Fabric Jackknife Sofa, One Pillow
- Fabric Swivel Glider Barrel Chair (33PBD)

OPTIONS

- Forward-Facing Seatbelts in Booth Dinette inside Living Area Slide-Out (N/A: 30SFS)
- Roadside Fabric Hide-A-Bed Sofa with One Pillow

ELECTRICAL SYSTEMS AND LIGHTS: FEATURES

- 30 Amp 120V Distribution Panel and Power Cord
- 60 Amp Electronic 12V Power Converter
- Onan® 4.0 kW Gas Generator
- Two 6V House Batteries
- Battery Disconnect Switches
- 12V and 110V Outlet in Cockpit Area
- Exterior Power Entry Step, with Light
- Decorative Satin Nickel Dinette Overhead

- Two Single Pancake Lights under Living Room Overhead Cabinets
- Single Pancake Lights over Bed with His and Hers Switches

PLUMBING AND LP SYSTEMS: FEATURES

- Kitchen White Double Bowl Sink with Chrome High-Profile Double Handle Faucet
- Satin Nickel Bath Lavatory Faucet
- Demand Water System and Water Pump
- 6 Gallon LP Water Heater with Electronic Ignition
- Winterization Valving System
- No-Fuss Flush Holding Tank Rinsing System
- Insulated Systems Compartment with Easy Access to Hook-Up
- Gravity and Pressurized Water Fill
- ABS Shower with Surround
- Shower Faucet with Shower Hose, and Head with Shut-Off

OPTIONS

- 6 Gallon LP Gas/Electric Water Heater with Electronic Ignition
- Satin Nickel Shower Door Frame with Obscure Glass

HEATING, VENTS AND AIR CONDITIONING: FEATURES

- One 13.5M BTU Air Conditioner with Ducted Air and Analog Wall Thermostat, Low-Profile Ford and Workhorse (N/A: 33PBD)
- One 13.5M BTU and One 11.0M BTU Air Conditioner with Ducted Air and Wall Analog Thermostat, Low-Profile Ford and Workhorse (33PBD)
- Electronic Ignition Furnace (31M BTU: 30PBS, 30PDD, 30SFS) (35M BTU: 33PBD)
- Electronic Dash AC/Heat Climate Control System
- In-Floor Ducted Heating System with Metal Floor Registers
- Living Area 12V Roof Vent
- Bath 12V Roof Vent

OPTIONS

- One 15M BTU Air Conditioner with Ducted Air and Analog Wall Thermostat, Low-Profile Ford and Workhorse (N/A: 33PBD)
- Living Area Powered Attic Fan with Wall Control of Automatic Dome and Fan Power
- Bath Powered Attic Fan with Wall Control of Automatic Dome and Fan Power
- 12V Heater in Wet Bay

WINDOWS, DOORS AND AWNINGS: FEATURES

- Radius Flush-Mounted Single Pane Safety Glass Dark Tinted Slider Windows
- Radius Entrance Door with Clear Glass, Roller Shade, Screen Door and Anti-Skid Steps
- Topper Slide-Out Awnings
- Protecta Glaze Tinted Plexiglas® Skylight in Bathroom

OPTIONS

- Poly-Weave Patio Awning
- Rear Wall Bedroom Window (30PDD) (Required on 33PBD)



ADMIRAL® SVE

Weights (Ford 20,500 Lb. / 22,000 Lb. Chassis)*

	30PBS	30PDD	30SFS	33PBD
Gross Vehicle Weight Rating	20,500 / N/A	20,500 / N/A	20,500 / N/A	N/A / 22,000
Gross Combined Weight Rating	25,500 / N/A	25,500 / N/A	25,500 / N/A	N/A / 26,000
Front Gross Axle Weight Rating	7,000 / N/A	7,000 / N/A	7,000 / N/A	N/A / 7,500
Rear Gross Axle Weight Rating	13,500 / N/A	13,500 / N/A	13,500 / N/A	N/A / 14,500

Weights (Workhorse 20,700 Lb. / 22,000 Lb. Chassis)*

	30PBS	30PDD	30SFS	33PBD
Gross Vehicle Weight Rating	20,700 / N/A	20,700 / N/A	20,700 / N/A	N/A / 22,000
Gross Combined Weight Rating	25,700 / N/A	25,700 / N/A	25,700 / N/A	N/A / 26,000
Front Gross Axle Weight Rating	7,500 / N/A	7,500 / N/A	7,500 / N/A	N/A / 8,000
Rear Gross Axle Weight Rating	13,500 / N/A	13,500 / N/A	13,500 / N/A	N/A / 14,500

Measurements

	30PBS	30PDD	30SFS	33PBD
Wheelbase	190"	190"	190"	228"
Overall Length	31'	31'	31'	34' 3"
Overall Height, Including Air Conditioner	12' 6"	12' 6"	12' 6"	12' 6"
Interior Height	84"	84"	84"	84"
Interior Width	94.5"	94.5"	94.5"	94.5"
Exterior Width	100.5"	100.5"	100.5"	100.5"

Tank Capacities**

	30PBS	30PDD	30SFS	33PBD
Water Heater (Gal.)	6	6	6	6
Gray Tank (Gal.)	42	43	43	42
Black Tank (Gal.)	42	45	45	42
Fresh Tank (Gal.)	60	60	60	60
LP Tank (Gal.)***	18	18	18	18

* Towing capacity is limited by GCWR; your vehicle's towing capacity is the difference between the GCWR and the actual vehicle weight, including all water, fuel, passengers and cargo. Your towed vehicle should be equipped with auxiliary brakes if the weight of the towed vehicle exceeds 1,000 lbs. Consult your owner's manual for further towing information.

** All tank capacities are estimated based upon calculations provided by the tank manufacturers and represent approximate capacities. The actual "usable capacity" may be greater or less than the estimated capacities based upon fabrication and installation of the tanks.

*** Actual filled LP capacity is 80% of listing due to safety shut-off required on tank.

2007 FLOORPLANS

■ CARPET | ■ TILE

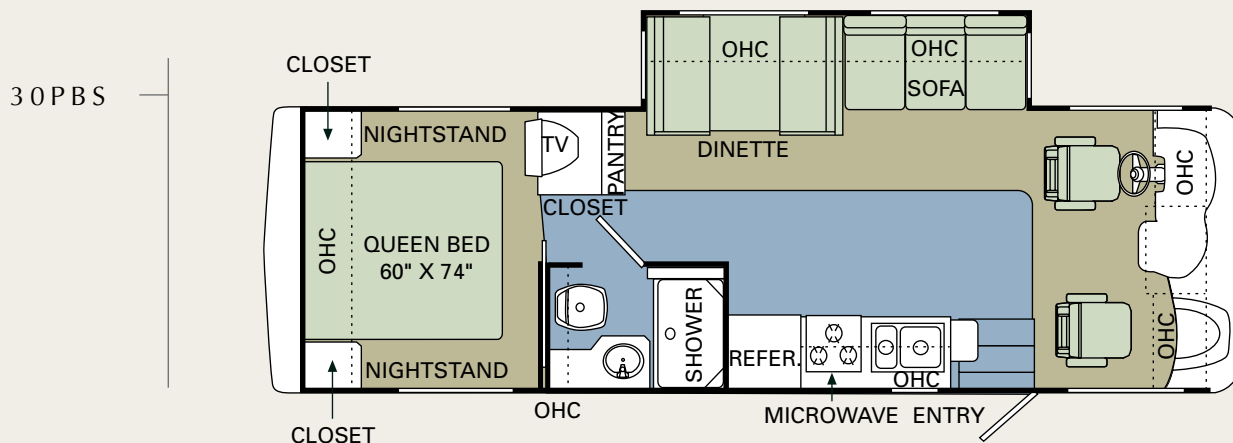

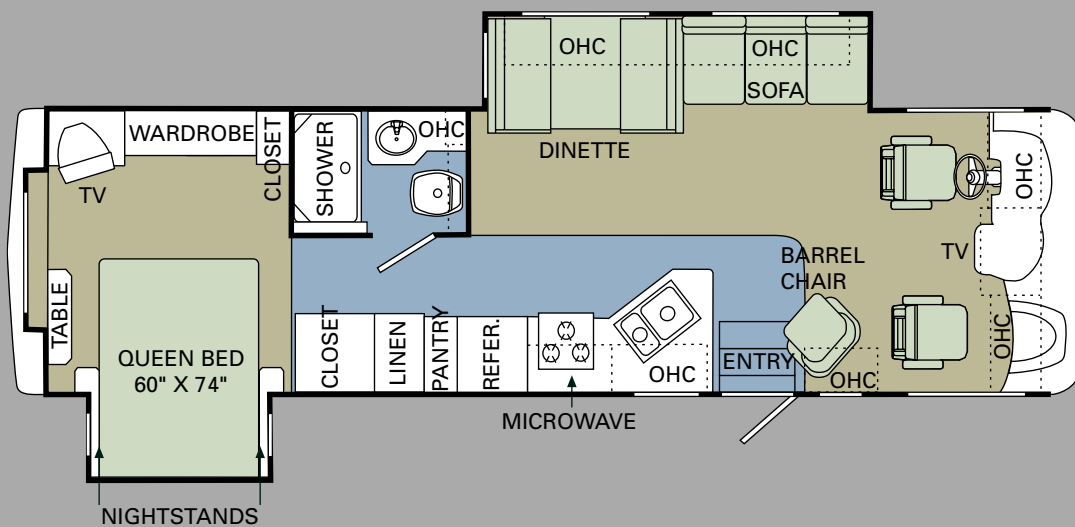
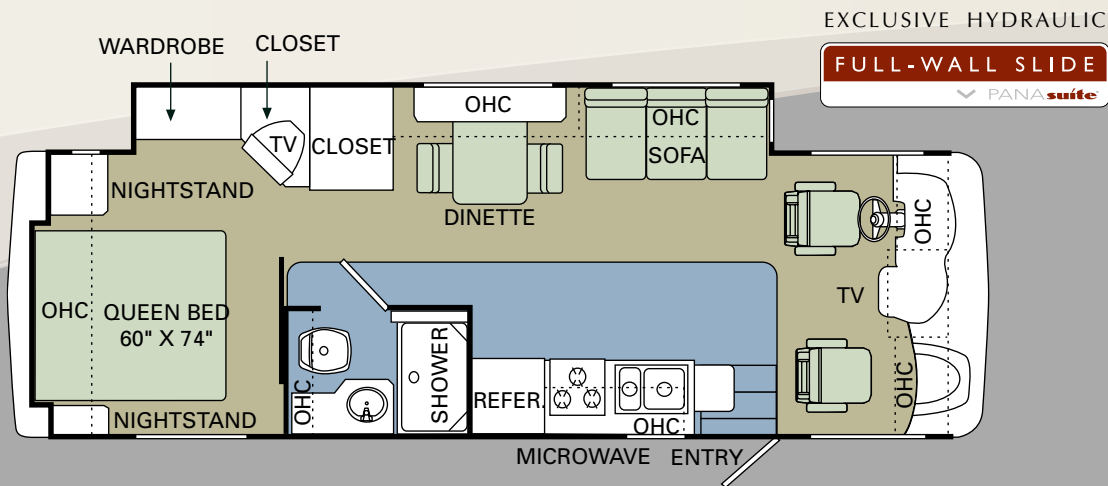
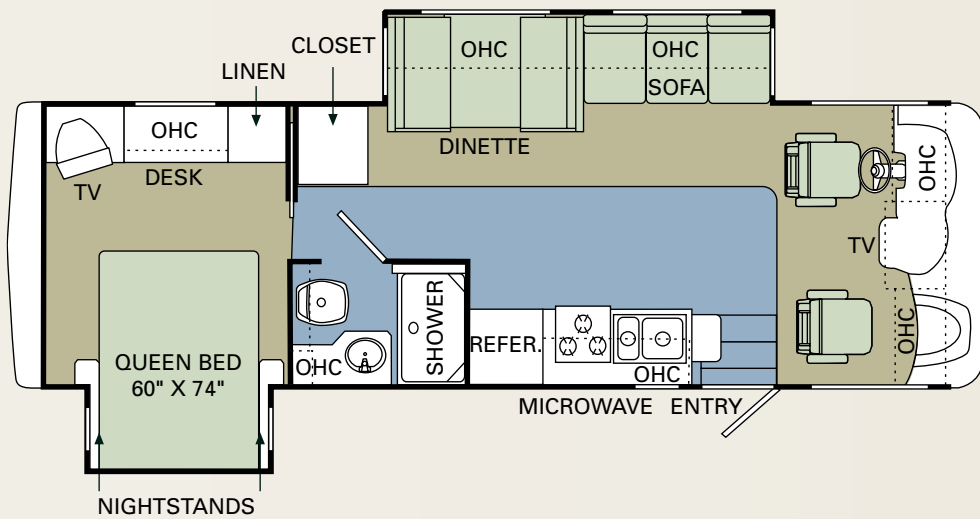



2007 ADMIRAL®



THE POWER BEHIND THE NAME.

At Holiday Rambler, every one of our RVs shares something special — something that's hard to describe, but easy to recognize. It's that unique touch that makes Holiday Rambler stand apart. It's our complete dedication to quality at every level — from the designers who create unique looks to the craftsmen who apply the finishing touches. It's our unbeatable service, which gives you 24-hour availability, 365 days a year. It's a commitment to safety and a tradition of innovation. And finally, it's the best people in the business. The Holiday Rambler difference. It's in every RV we make — including yours.



HOLIDAY RAMBLER®

This is Living®

DEALER:

606 Nelson's Parkway Wakarusa, IN 46573
www.holidayrambler.com (800) 245-4778



ASSISTANCE

SALES • TECH • ROADSIDE



WE'RE HERE.
ANYTIME, EVERY TIME.

- Reach us anytime — literally — via our live customer support line.
- Drive in to one of our 350 Service Centers.
- Enjoy the first year free when you enroll in our Owner Advantage Roadside Assistance Program.
- See where it all begins with a tour of one of our facilities in Indiana or Oregon. Call 1-800-650-7337 or 1-800-634-0855 to find out more.

WARRANTIES

12 MONTH/24,000 MILE
basic limited warranty

5 YEAR/50,000 MILE limited
warranty on aluminum or steel
frame structure of sidewall,
roof, front and rear cap

3 YEAR/36,000 MILE limited
warranty on Roadmaster chassis

Applies to certain models. See owner's
manual for complete details.



MONACO COACH CORPORATION

Monaco is traded on the New York Stock Exchange under the listing MNC.
© 2006, Monaco Coach Corporation 11/06 NPN:BROHADM Litho in USA.

