

# HI-LO

***GOES THE EXTRA MILE.***



**2008 CATALOG**







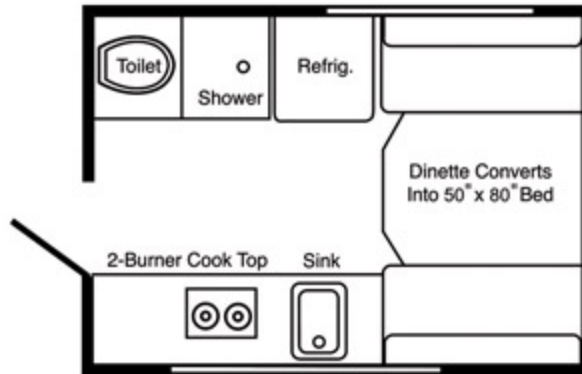

Model 15T			
Length	15' *	UVW	2100 lbs
Width	94" **	GVWR	2990 lbs
Height	69" **	Axles	1
Tires	13"	Sleeps	2-4
Holding Tanks	Fresh 15.5 Gal	Gray 32 Gal	Black 18 Gal

\*Not including spare tire \*\*Does not include projections or optional items.

The all new 15T is lightweight, compact and convenient, and yet still offers all the benefits of a Hi-Lo trailer.



Hi-Lo is pleased to announce the addition of the all new 15T model to the 2008 production year. This lightweight trailer will be sure to accommodate your every expectation as you head to your next destination. This rear-entry trailer will comfortably sleep two to four people, and still offers all the benefits and amenities of a larger self-contained camper.





# HI-LO TowLite 17T

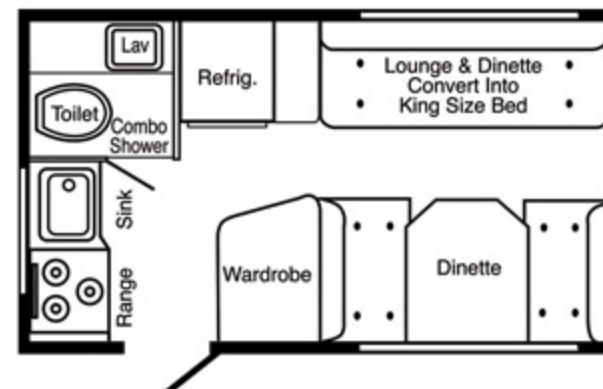

The aluminum skirting on all TowLite models adds a finished, more appealing look, without the expense of molded ABS skirting.

## Model 17T

Length	17' 8" **	UWV	2497 lbs
Width	94" **	GVWR	3840 lbs
Height	71" **	Axles	1
Tires	15"	Sleeps	2-4
Holding Tanks	Fresh 30 Gal	Gray 32 Gal	Black 18 Gal

\*Not including spare tire \*\*Does not include projections or optional items.

## The Sporty 17' TowLite

retains the roomy KING SIZE BED and offers a dinette as well. The light weight, easy towing and small storage requirements of this model make it the ideal choice for small families with a limited budget and limited vacation time. It comfortably sleeps a family of four and still offers the storage and convenience of a fully self contained unit. The new interior colors make the 17T an eye catching weekend resort at a price the young family can afford.





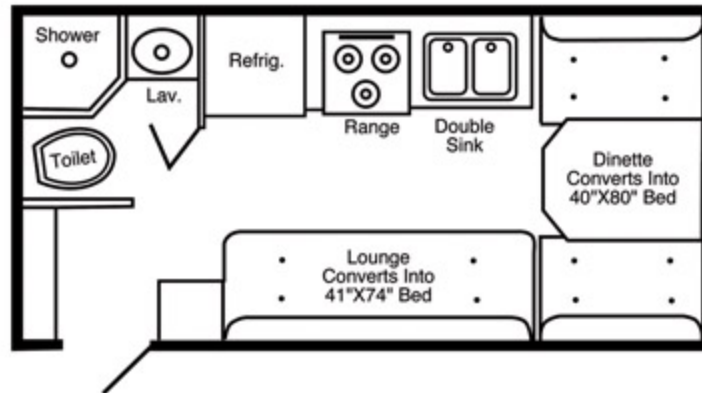

## Model 19T

Length	19' *	UVW	2690 lbs
Width	94" **	GVWR	3840 lbs
Height	71" **	Axles	1
Tires	15"	Sleeps	4-6
Holding Tanks	Fresh 30 Gal	Gray 32 Gal	Black 18 Gal

\*Not including spare tire \*\*Does not include projections or optional items.

The TowLite 19T is compact, efficient and practical, and yet still offers the storage and convenience of a self-contained trailer.



Hi-Lo is excited to continue the 2008 model year with the 19T. We are certain that the 19T will exceed your every expectation as you relax in the roomy living area. The open, airy feel of the 19T will comfortably sleep four to six people, and offers surprisingly spacious elbow room. Step inside this lightweight trailer and experience a big trailer in a little package.





# HI-LO TowLite 22T

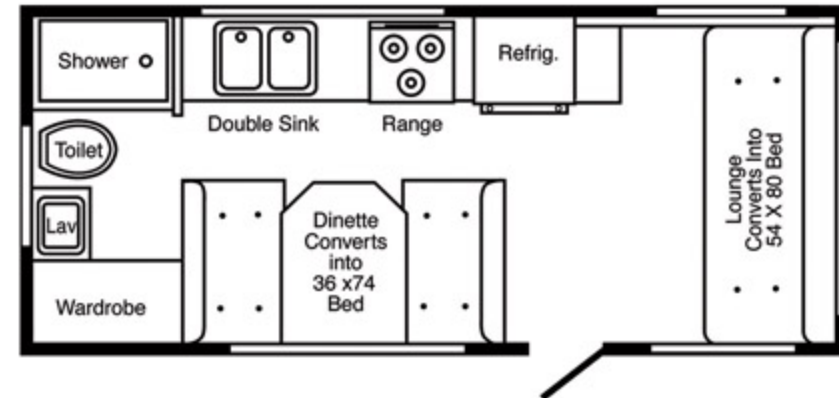

Modern styling and a beautiful interior make the 22T a smart choice for the growing family. Why not test tow a Hi-Lo at your dealer today?

## Model 22T

Length	22' 4" **	UVW	3332 lbs
Width	94" **	GVWR	5500 lbs
Height	71" **	Axles	2
Tires	4-15"	Sleeps	4-6
Holding Tanks	Fresh 30 Gal	Gray 32 Gal	Black 30 Gal

\*Not including spare tire \*\*Does not include projections or optional items.

Inside your 22T you'll find two separate sleeping areas and a third bed option. The dinette table for four easily converts into a double bed to sleep two adults comfortably. It incorporates a full size bathroom with a separate toilet and shower as well as a wardrobe and lavatory sink. Under each dinette seat you will find handy storage compartments that you can use to store bedding or other large essentials. There are also many other storage areas such as under the couch, in the overhead cabinets and in the wardrobe closet.





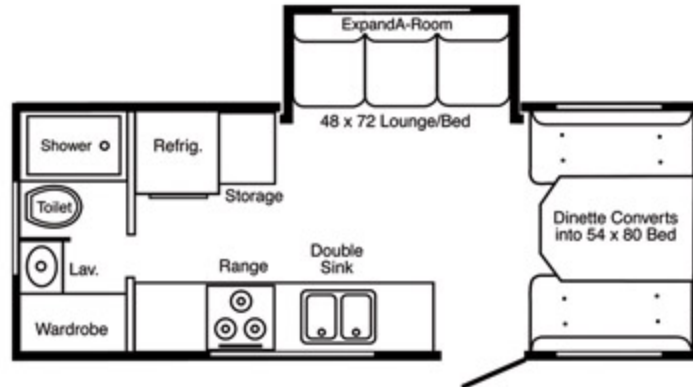

Model 24T			
Length	24' 3" *	UVW	4009 lbs
Width	94" **	GVWR	6000 lbs
Height	77" **	Axles	2
Tires	4-15"	Sleeps	4-6
Holding Tanks	Fresh 30 Gal	Gray 32 Gal	Black 30 Gal

\*Not including spare tire \*\*Does not include projections or optional items.

All Hi-Lo models have the same easy, lifetime warranted hydraulic lift system that raises or lowers the trailer in only 15 seconds.



Interior room is dramatically improved in the 24T thanks to the exclusive ExpandA-Room which opens easily to provide you more living space for longer, more comfortable stays. The 24T is the smallest Hi-Lo to utilize the tip-out concept to add room without the complications and vulnerability of a mechanical slide-out room. With the push of a button, the ExpandA-Room flips out to reveal a comfortable couch, which converts into a generous double bed.





# HI-LO TowLite 27T

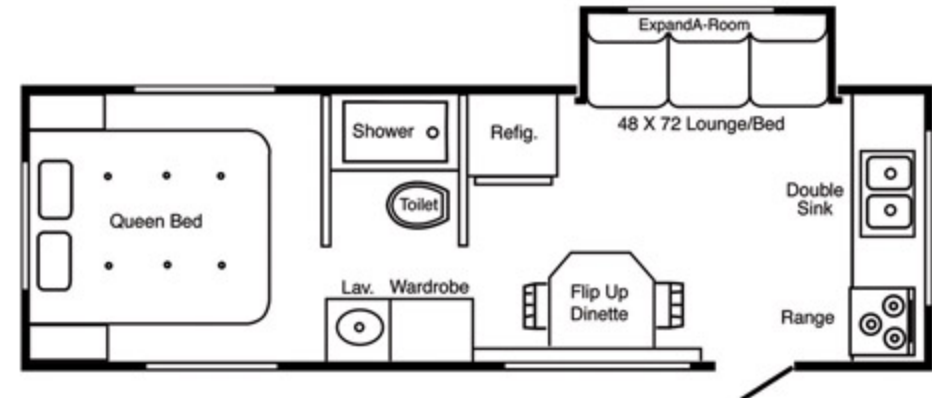

The rubber suspension system and designer sport wheels and tires add an extra measure of beauty, stability and ride comfort.

Model 27T			
Length	27' 5" **	UVW	4379 lbs
Width	94" **	GVWR	6500 lbs
Height	77" **	Axles	2
Tires	15"	Sleeps	4-6
Holding Tanks	Fresh 30 Gal	Gray 30 Gal	Black 30 Gal

\*Not including spare tire \*\*Does not include projections or optional items.

The 27T TowLite represents a remarkable value in a trailer of this size and amenities. The ExpandA-Room offers a luxurious lounge which makes a comfortable bed quickly and easily. The wide open kitchen allows free movement without interfering with the living areas. You'll be at home with the walk-a-round queen size bed in the rear of the trailer. The bathroom is big enough to serve as a changing room and also acts as a privacy barrier between the living area and the bedroom.





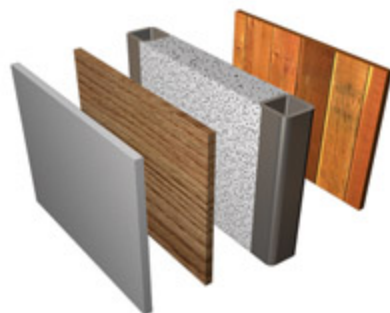

**Super Durable Fully Laminated Construction**  
Hi-Lo construction is a laminated sandwich of durable roof and fiberglass side walls, both with backer board, polystyrene foam, aluminum tubing and plywood interior paneling.

## Aerodynamic Design

Hi-Lo Classic's molded fiberglass front design, gives a better air flow, setting the pace for the future.

## Ultra Modern Windshield

in all Classic models gives a beautiful panoramic view of the outside and a feeling of spaciousness to the interior.

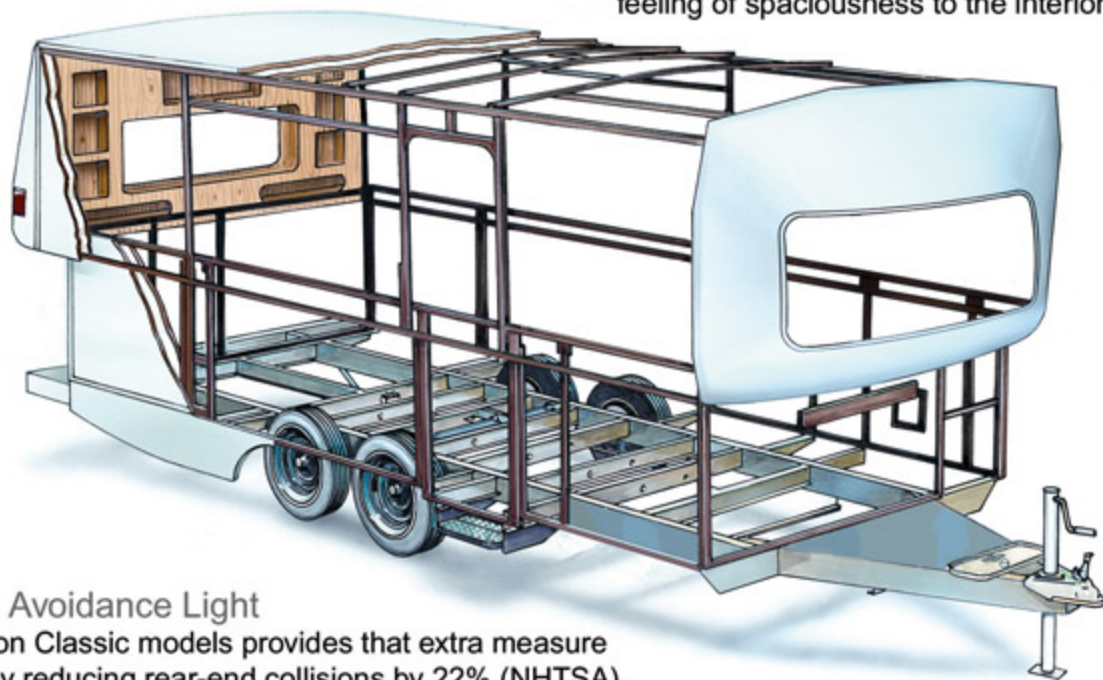

## Collision Avoidance Light

Standard on Classic models provides that extra measure of safety by reducing rear-end collisions by 22% (NHTSA).



**Rubber Suspension System**, designer sport wheels and tires add an extra measure of beauty, stability, and ride comfort to each Hi-Lo trailer, making it the BEST and safest towing travel trailer.

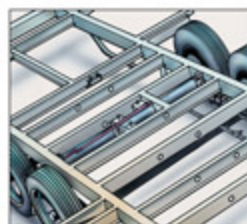

**Heavy Duty Hydraulic Cylinder** capable of developing over 17,000 lbs of force.



The optional detachable tongue shortens the overall length by 2', making more models garagable.



Battery storage leaves room for an optional second battery.

## EXPAND UP AND OUT



All you have to do is push a button to raise or lower your HI-LO trailer. The lifetime guaranteed hydraulic system has proven itself in thousands of trailers for many years.



## ExpandA-Room

opens up the living space giving the feel of a much larger trailer.



# HI-LO GOES THE EXTRA MILE.



## WHY BUY A HI-LO?

Hi-Lo Trailer Co. is proud to introduce its all new and vastly improved line of telescoping travel trailers for the 2008 season. Hi-Lo revolutionized the travel trailer industry over 50 years ago by offering a trailer that stores compactly, tows more safely and yet offers four season camping with all of the comfort and convenience expected from an upright trailer. Our goal is to provide you with a trailer that tows safely, saves fuel, lives comfortably and lasts for many years. Our factory is located in Bellville, Ohio in the heart of Amish country. We take great pride in quality, craftsmanship and attention to detail. We invite you to order our free DVD that demonstrates how our trailers are built, and the benefits of towing a low profile trailer. You will be glad you learned more about the best towing trailer on the planet... Hi-Lo. Thank you for your interest in Hi-Lo Trailers: the safest most fuel efficient trailer on the road. We are glad that you are considering our product and are confident that we offer something to fulfill your needs. Now we invite you to spend some time in each of the eight models we offer this year, by visiting our web page ([www.hilotrailer.com](http://www.hilotrailer.com)), your nearest dealer, or by calling the factory for current information.



# FUEL EFFICIENT. ENVIRONMENTALLY FRIENDLY. LOW PROFILE. LOW POLLUTION TOWING.



FUEL EFFICIENCY / CONSUMPTION TEST

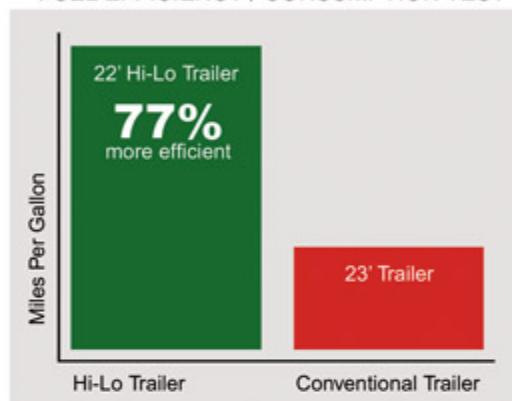

Hi-Lo proved its fuel efficiency in a fuel consumption test conducted by Transportation Research Center.

Hi-Lo's low travel profile gives greater stability at all speeds by reducing sway and buffeting caused by large passing vehicles and cross winds.



# HI-LO Classic 25C

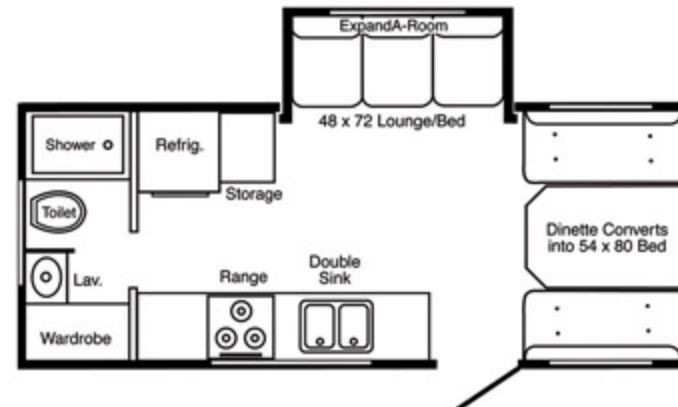

The 25C blends the spacious family-oriented floor plan of the 24T with the luxurious Classic compliments and styling.

## Model 25C

Length	25' *	UWV	4717 lbs
Width	100" **	GVWR	6300 lbs
Height	79" **	Axles	2
Tires	4-15"	Sleeps	4-6
Holding Tanks	Fresh 30 Gal	Gray 32 Gal	Black 30 Gal

\*Not including spare tire \*\*Does not include projections or optional items.

The remarkably large kitchen and generous sleeping areas make the 25C an excellent choice for longer stays. With the Expand-A-Room deployed there is room for several people to move around without the hassle of a narrow floor plan.





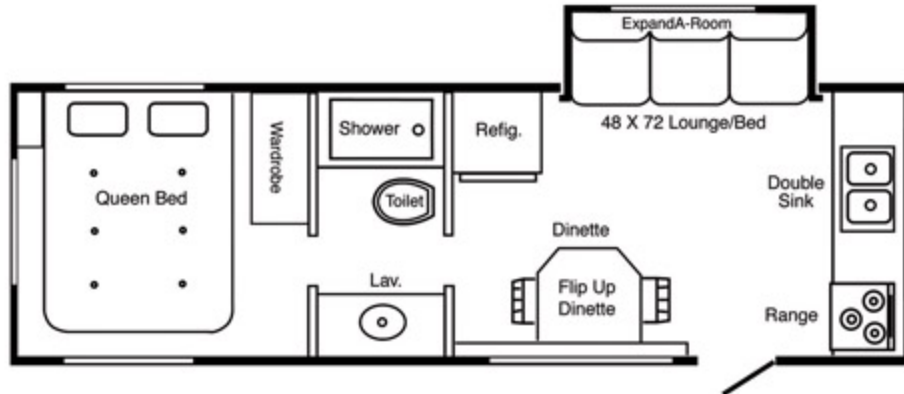

## Model 28C

Length	28' 9" **	UVW	5320 lbs
Width	100" **	GVWR	7000 lbs
Height	79" **	Axles	2
Tires	15"	Sleeps	4
Holding Tanks	Fresh 30 Gal	Gray 32 Gal	Black 32 Gal

\*Not including spare tire \*\*Does not include projections or optional items.

The 28C has aerodynamic fiberglass end caps with a wrap around windshield for a fantastic panoramic view.



The luxurious interior of the 28C has an airy, more spacious atmosphere that gives you that "good feeling" from the moment you step inside. With space at a premium, you'll come to love the ExpandA-Room which easily deploys in seconds to give you the feel of a much larger trailer without the added towing stress. The 28C Classic is designed with extended camping in mind. You'll love the wide kitchen with open space for freedom of movement.





# TRAVEL AND LIVING

Some models can be stored in the garage, which saves storage fees and allows you to comply with zoning laws. A detachable tongue is available on certain models.



The 24T and 25C models feature an eight foot long kitchen with a microwave and a LP gas oven option.



Live In  
Comfort  
and Style

Cook outside and be with the gang. This outside kitchen has a 110V outlet, offering space for cooking, a coffee pot, or watching television.



## UP FOR LIVING OR DOWN FOR TRAVEL, HI-LO IS SIMPLY THE BEST





# SPECIFICATIONS

DESCRIPTION	15T	17T	19T	22T	24T	27T	25C	28C
Hydraulic Lift System	S	S	S	S	S	S	S	S
Battery 12V Heavy Duty	S	S	S	S	S	S	S	S
12 V Power Converter	45 AMP	45 AMP	45 AMP	45 AMP	45 AMP	45 AMP	45 AMP	45 AMP
Keyed Security Dead Bolt	S	S	S	S	S	S	S	S
Rubber Suspension Axles	Single	Single	Single	Tandem	Tandem	Tandem	Tandem	Tandem
10" Electric Brakes All Wheels	S	S	S	S	S	S	S	S
3 burner Range Top	S	S	S	S	S	S	S	S
Range Hood w/Vent	N/A	N/A	N/A	S	S	S	N/A	N/A
Kitchen Sink	Single	Single	Single	Double	Double	Double	Double	Double
Demand Water System	15.5 Gal	30 Gal	30 Gal	30 Gal	30 Gal	30 Gal	30 Gal	30 Gal
Automatic Changeover Regulator	O	O	O	O	O	O	S	S
Skylight Roof Vent ***	2	2	3	3	3	4	3	4
Skylight Dome	N/A	N/A	N/A	S	S	S	S	S
Sun Shade Front Window	S	S	S	S	S	S	S	S
Pleated Day/night Shades	S	S	S	S	S	S	S	S
Toilet, Shower & Water Heater	S	S	S	S	S	S	S	S
110V DSI Water Heater	O	O	O	O	O	O	S	S
Holding Tank-2	50 Gal	50 Gal	62 Gal	62 Gal	62 Gal	60 Gal	62 Gal	64 Gal
Furnace BTU	12,000	12,000	16,000	16,000	16,000	25,000	16,000	25,000
Durable Aluminum Roof	S	S	S	S	S	S	S	S
Refrigerator – 3 Way	3 cu. ft.	3 cu. ft.	3 cu. ft.	4 cu. ft.	4 cu. ft.	4 cu. ft.	5 cu. ft.	5 cu. ft.
Retractable Awning	O	O	O	O	O	O	O	O
Double 20 lb. Gas Bottles & Cover	S	S	S	S	S	S	N/A	N/A
Double 30 lb. Gas Bottles & Cover	O	O	O	O	O	O	S	S
LP Gas Oven	O	O	O	O	O	O	S	S
Microwave Oven	O	O	O	O	O	O	O	O
Air Conditioner 13,500 BTU	O	O	O	O	O	O	O	O
TV Antenna	O	O	O	O	O	O	S	S
AM/FM CD Player	O	O	O	O	O	O	S	S
Entertainment Package	N/A	O	O	O	O	O	O	O
Cable TV Jack & Phone Jack	O	O	O	O	O	O	S	S
Front Overhead/Side Cabinets	O	O	O	O	O	1-S	S	1-S
Swing-Away Front Bunk	O	O	O	O	O	N/A	O	N/A
Stabilizer Jacks	O	O	O	O	O	O	S	S
Power Hitch Jack	O	O	O	O	O	O	S	S
Spare Tire Package	O	O	O	O	O	O	S	S
15" Alloy Wheels	O	O	O	O	O	O	S	S
Rear Bumper Storage	N/A	S	S	S	S	S	S	S
Side Storage Pods	O-1	O-3	O-3	O-3	O-3	O-3	S	S
Single Sink Cover	S	O	O	O	O	O	S	S
Outside Utility Shelf	N/A	S	S	S	S	N/A	N/A	N/A
Outside Washdown	N/A	O	O	O	O	O	S	S
Outside Light	S	S	S	S	S	S	S	S
Manual Lift System – Backup	O	O	O	O	O	O	S	S
Monitoring System	N/A	S	S	S	S	S	S	S
Solar Charger	O	O	O	O	O	O	S	S
2500 Watt LP Generator	N/A	O	O	O	O	O	O	O
Detachable Tongue	O	O	O	O	N/A	N/A	N/A	N/A
Heat Strip for A/C	O	O	O	O	O	O	O	O

## GENERAL SPECIFICATIONS

Length (Does Not Include Spare)	15'	17'8"	19'	22'4"	24'	27'5"	25'	28'9"
Width**	94"	94"	94"	94"	94"	94"	100"	100"
Traveling Height**	69"	71"	71"	71"	77"	77"	79"	79"
Interior Height	75 ½"	75 ½"	75 ½"	75 ½"	75 ½"	75 ½"	78"	78"
Axle Weight (lbs.) (Approx.)	1940	2197	2310	2842	3483	3629	4057	4472
Hitch Weight (lbs.) (Approx.)	260	300	380	490	520	760	660	850
Unloaded Vehicle Weight*	2100	2497	2690	3332	4009	4379	4717	5320
Tire Size	13"	15"	15"	15"	15"	15"	15"	15"
Sleeping Capacity	2-4	2-4	4-6	4-6	4-6	4	4-6	4



SLEEPING AREA	15T	17T	19T	22T
Dinette Bed Size	50" x 80"	36" x 74"	40" x 80"	36" x 74"
Lounge Bed Size	N/A	74" x 80"	41" x 74"	54" x 80"
Bunk Bed Size	44" x 84"	44" x 84"	44" x 84"	44" x 84"
Stationary Bed	N/A	N/A	N/A	N/A

SLEEPING AREA	24T	27T	25C	28C
Dinette Bed Size	54" x 80"	N/A	54" x 88"	N/A
Lounge Bed Size	48" x 72"	48" x 72"	48" x 72"	48" x 72"
Bunk Bed Size	44" x 84"	N/A	44" x 90"	N/A
Stationary Bed	N/A	60" x 75"	N/A	60" x 75"

S = Standard  
O = Optional

\*Weight will vary by standard and optional features.

\*\*Does not include projections or optional items.

\*\*\*Optional A/C replaces one roof vent.

Note: All standard and optional features are available at the time of printing. Hi-Lo however reserves the right to improve and/or modify the product, which may change the specifications, models and feature availability. Check with your local Hi-Lo dealer for updated information.



HI-LO – Leading the RV Industry in Safety, Durability and Livability Since 1957

**Test-Tow Our**  
***Fuel Efficient Travel Trailer***  
**At Your Authorized HI-LO Dealer Today.**

Visit our website at [www.hilotrailer.com](http://www.hilotrailer.com) to find a dealer near you and to locate available inventory, or call the factory at 800-337-6490 for current information.

***Lifetime Limited Warranty on Lifting System***

Hi-Lo warrants to the original purchaser that it will repair or replace (through its authorized service centers) any part of your Hi-Lo hydraulic lifting system (excluding the battery), which becomes broken or inoperative due to defects in material or workmanship. In addition, Hi-Lo warrants that it will repair or replace (through its authorized service centers) any part of your Hi-Lo travel trailer found defective due to defects in material or workmanship within 12 months from date of original purchase. (Components such as tires, running gear, power converter, battery, plumbing & electrical fixtures, refrigerator, range, etc. are subject to separate warranties issued by other manufacturers.)



HI-LO TRAILER CO.  
500 South Main Street  
Bellville, Ohio 44813  
800.337.6490