

390C PARK MODEL

2006 MODEL YEAR
By Glendale RV
www.glendalerv.com

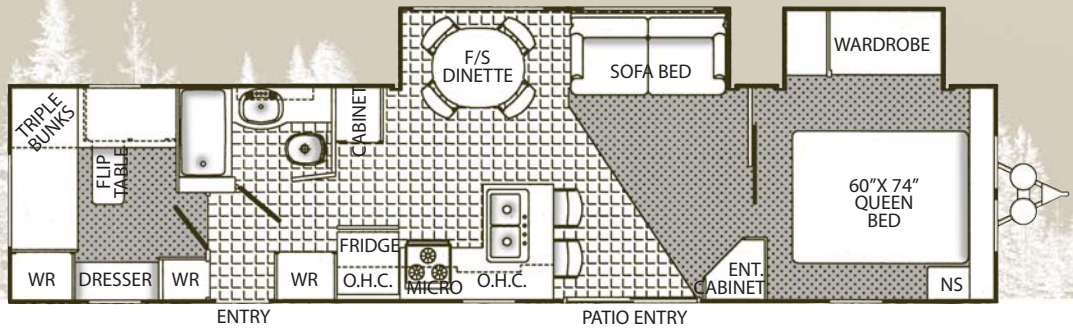

OPTIONAL REAR BEDROOM AREA

Gaucha/bunk floor plan available pre-production

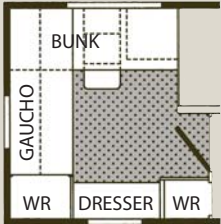

Sage Interior



Sage Interior



Taupe Interior



390C Bedroom Layout

OVERALL LENGTH	LENGTH WITH HITCH REMOVED	MAIN BODY WIDTH	INTERIOR WIDTH	INTERIOR HEIGHT	OVERALL HEIGHT	OVERALL SETUP W/ SLIDEOUTS OPEN
40'-2"	38'-2½"	102"	96"	94"	11'-3"	11'-2½"

CONSTRUCTION

SIDEWALLS: 2"X2" sidewall framing. Thick fiberglass batt insulation blankets the sidewall structure. All frame work is positioned at 16" O.C. construction standards. Aluminum exterior siding (.025" gauge) includes baked enamel smooth finish with built in U.V shielding to provide years of high luster appearance and "easy clean" finish surface.

ROOF: Quiet, durable, and seamless rubber roof membrane is bonded to 3/8" spruce plywood. Full 5 1/2" tapered crown roof structure provides outstanding strength and superior water drainage. Tapered bow truss framing. Thick fiberglass batt insulation.

FLOOR: 5/8" tongue and groove plywood flooring. Screwed and glued to 2"x4" main floor frame. Seamless Darco polyethylene moisture barrier between chassis and floor. Seam guard under vinyl floor coverings.

CHASSIS: 12" steel tube frame construction. Specially formulated chassis undercoating provides many years of corrosion and paint protection.

SLIDE OUT SPECIFICATIONS: "No step" flush floor design between main body and slide outs. "Maintenance free" slide out system self supports.

INTERIOR CABINET DOORS: Raised panel Oak cabinet doors with brush nickel hardware. T&G interlocking cabinet door miters. Many cabinets feature center shelves for stacking convenience.

WINDOWS: "Awning Style" window openings provide "protected ventilation" in rainy weather. Opening the vent creates an awning, so the window can be opened for fresh air while channeling water outward from the vehicle wall. Screens are removable. Metal Venetians.

APPLIANCES

REFRIGERATOR: Large double door residential style. GE 16 cubic foot capacity

RANGE: Wedgewood H/O 21", 3 burner, piezo ignitor

FURNACE: Hydro-Flame auto-ignition 40,000 BTU ducted in floor heat system.

MICROWAVE OVEN: Dometic 1.3cubic foot with turntable

AIR CONDITIONER: Ceiling is ducted for OPTIONAL Dometic Briskair 15,000 BTU air conditioner. Duct system is thermal insulated to prevent condensation build up, provide quiet operation, and to allow maximum efficiency of the optional air conditioner

ENTERTAINMENT

TV HOOKUP: Coax cable hookup in bedroom and living area

PLUMBING

Traveler Lite foot pedal toilet with hand sprayer, Large double white fiberglass sink in kitchen, with a white single lever swing faucet. Bathroom vanity includes a brushed nickel single lever faucet, with single white oval sink.

WATER HEATER: Atwood fast recovery 10 gal. LP operation.

HOLDING TANK CAPACITY:

Sewage Tank: 49 gal

ELECTRICAL

Exterior courtesy light and switch at patio door.

Exterior and interior G.F.I circuits

HOOKUP: 30 Amp

OTHER STANDARD FEATURES

Flush floor between slide outs and main floor of park model, oak finished free standing dinette, sofa bed, wire rack wardrobe shelving, smoke detector, 110V lighting, brushed nickel hardware, plush carpeting with premium underpad in livingroom and bedroom, detachable hitch assembly, sliding wardrobe doors, 2 x 30lb. Propane bottles, 60"x74" orthopedic quality coil inner spring queen bed. 2 bar stools.

OPTIONAL EQUIPMENT

TV antenna with booster, house type toilet, 15,000 BTU air conditioner, 24' Pewter/White awning with center rafter.

* All specifications subject to change without notice or obligation 04/24/2006

DEALER:



GLENDALERV



145 Queen Street
Strathroy, ON
N7G 3J6