

FOREST RIVER PRESENTS

ROCKWOOD ROO

ULTRA LIGHT WEIGHT EXPANDABLES

ROCKWOOD ROO





ROCKWOOD ROO · MODEL 233

Rockwood Roo

Rockwood redefines camping by having the necessities of residential living on the camp site. It's all in the details. Features like the heated innerspring mattresses so you remain warm at night, and metal drawer guides to keep drawers gliding open and shut, are simple amenities that add tremendously to the comfort of your vacation. It's your vacation. Do it right.



A



B



C



D



E



F



G



H



I

- A** RVQ grill (*Opt.*)
- B** Outside speaker (*Opt.*)
- C** Exterior shower (*Std.*)
- D** Fantastic Fan (*Std. Opt.*)
- E** Bunk Cables (*Std.*)
(*No poles needed*)
- F** Bunk Light Fan (*Std.*)
- G** Water Filter (*Std. Opt.*)
- H** Heated Innerspring
Mattresses (*Std. Opt.*)
- I** Optional Cream Interior with
Stainless Steel Appliances



ROCKWOOD ROO • MODEL 233

Rockwood Roo

Family convenience, quality, and fun have all been wrapped up into one expandable trailer Rockwood calls the Roo. The Roo is loaded with amenities your family will enjoy every day they camp. The Rockwood Roo focuses on easy set-up and camping comfort so all your family has to do is enjoy the fun. With the Roo, we are confident that fun won't be a problem.



A



D



B



C



E



F

- A** Power Awning with Adjustable Rain Dump
- B** Radius Roofs
- C** Towel Bar (*Std.*)
- D** Hardwood Doors & Drawers
- E** Aluminum Rims (*Opt.*)
- F** 20" LCD TV with 5.1 Digital Dolby Surround Sound and DVD (*Std. on some models*)

ROCKWOOD ROO · STANDARDS & OPTIONS

EXTERIOR FEATURES

- Radius Roofs
- Aluminum Frame (Floor, Sidewall, & Roof)
- Vacuum Bonded Filon Fiberglass Sidewalls
- Automotive Radial Tires
- Alpha One-Piece Vinyl Roof
- Radius Corner Windows and Doors
- Torsion Axle w/ Rubber-Ryde Suspension
- Outside Shower
- Two-20lb Gas Bottles
- Gas/Electric Refrigerator
- Electric Motor for Slide Out
- Decorative Frame Skirting
- Aluminum Bed and Dinette Frame
- Insulation Factors R-7 Side Wall, R-12 Floors and R-14 Ceiling
- Industrial Lockable Bed Latches
- Bed Cable System (No Poles)
- 14" Tires with Double Step
- Molded Bottle Cover
- Front Stabilizer Jacks

INTERIOR FEATURES

- Raised Panel Solid Wood Cabinet Doors
- Tub Surround
- Screwed and Glued Cabinetry

ROO SPECIFICATIONS

MODEL	17	183	183RD	19	21SS	232	232L	233	233S	238	23SS	21RS	23RS
GVWR (Gross Vehicle Weight Rating)	3852	4373	6573	4341	5143	6286	6410	5404	5864	5082	5879	4830	5618
Base/Dry Unit Weight	2789	3102	4002	3070	3872	4215	4484	3533	3993	3997	4008	3559	3747
Base/Dry Hitch Weight	352	238	906	239	645	286	410	433	565	682	509	594	625
Base/Dry Axle Weight	2437	2864	3096	2831	3227	3929	4074	3100	3428	3315	3499	2965	3122
Cargo Capacity	1025	1233	2533	1233	1233	2033	1888	1833	1833	1047	1833	1233	1833
Length	18' 11"	20' 3"	28' 9"	20' 3"	21' 4"	23' 4"	33' 4"	23' 9"	23' 9"	23' 4"	24' 6"	21' 8"	23' 9"
Trailer Length (Open)	22' 11"	24' 9"	29' 3"	24' 9"	25' 6"	32' 1"	36' 10"	27' 9"	27' 9"	27' 4"	28' 6"	25' 2"	27' 3"
Width	96"	96"	96"	96"	96"	96"	96"	96"	96"	96"	96"	96"	96"
Height w/o A/C	112"	112"	112"	112"	112"	112"	112"	112"	112"	112"	112"	112"	112"
Interior Height	78"	78"	78"	78"	78"	78"	78"	78"	78"	78"	78"	78"	78"

Model number of any particular unit does not necessarily reflect the overall length of the unit itself. Dry weight are estimates.

- Decorative Valances w/ Mini Blinds
- Three Burner Gas Range
- Six Gallon Gas Water Heater
- Water Heater By-Pass
- Monitor Panel
- Phone Jack
- Bathroom Skylight
- 55 Amp Converter
- 50/50 Jalousie Windows
- Bunk Fan/Light Combination with Each Tip Out
- Large Dinette Picture Window
- Residential One-Piece Double Sink Cover/ Cutting Board
- Indoor/Outdoor Table
- Drawer Guides
- Digital AM/FM/Cassette/CD/DVD w/ Remote
- Directional Reading Lights on Sofa Slides
- Foot Flush Toilets

ROO OPTIONS

- Create-A-Breeze Three Speed Fantastic Vent
- Heated Mattresses
- Water-Pur Filtration
- Conventional Oven
- Microwave
- Sliding Front Storage Tray (Where Available)

- Spare Tire, Carrier, & Cover
- Awning
- Outside Gas Grill & Worktable
- Electronically Controlled Heated Holding Tanks
- Safety Glass
- CSA Coding
- Optional Slate, Tan, or Cypress Décor
- Optional Stainless Steel Appliances
- Optional Cream Interior w/ Stainless Steel Appliances
- Aluminum Wheels
- Double Door Refrigerator (17, 183, 19)
- Outside Speaker
- DSI Gas/Electric Hot Water Heater
- 13.5 K BTU Ducted A/C (Except 17, 183, 19)
- 13.5 K BTU Air Conditioner (17, 183, 19 only)
- Power Awning With Adjustable Rain Dump (N/A on 17, 19, 21RS, 23RS)
- 15" LCD TV
- Tire Pressure Monitoring System
- Power Jack
- Raised Refer Panel Fronts
- Slide Topper
- Storm Windows
- Chrome-look Wheel Covers
- Extra Create-a-Breeze Fan (N/A on 17, 19, 232)
- TV Antenna w/ Cable & Satellite Hook-Up
- Carbon Monoxide Detector



ROCKWOOD ROO · FLOORPLANS

17

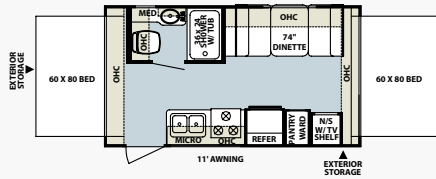

183

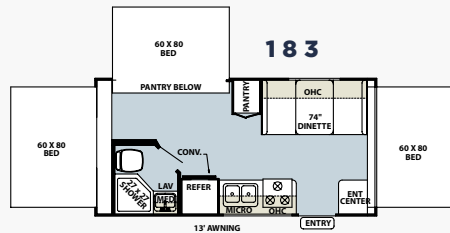

183RD

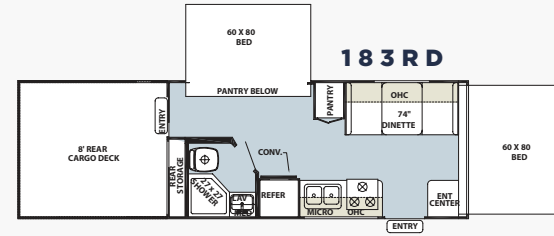

19

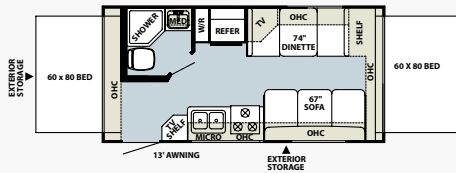

21SS

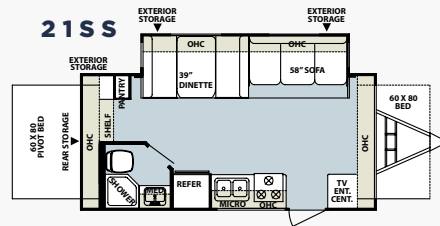

232

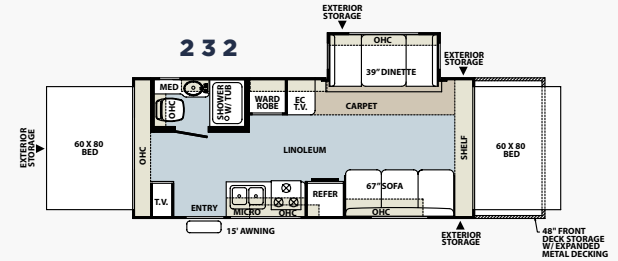

232L

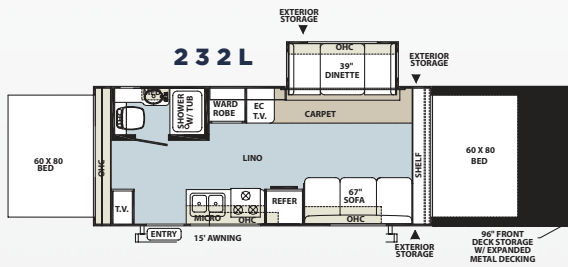

233

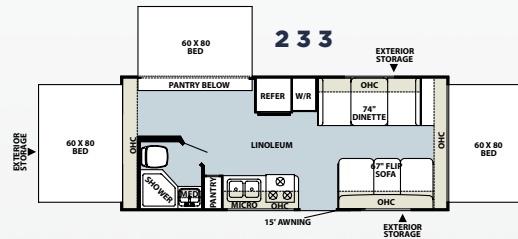

233S

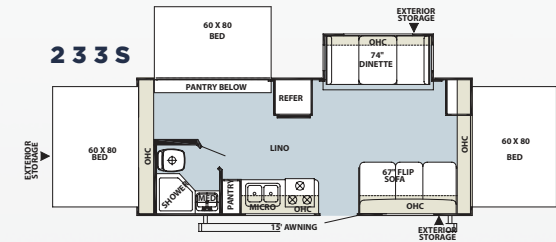

23SS

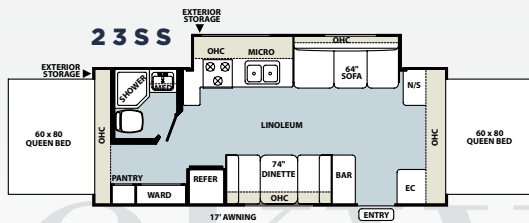

21RS - HARD SLIDE

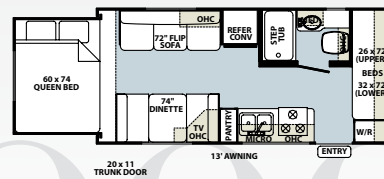

23RS - HARD SLIDE

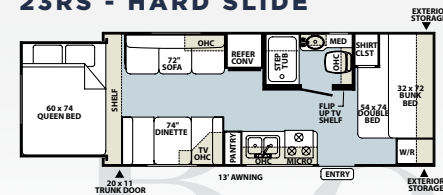

FOREST RIVER'S HALLMARK OF EXCELLENCE:
PRE-DELIVERY INSPECTION FACILITIES

PEACE OF MIND.

Forest River has yet another exclusive feature to offer: One year of free roadside assistance will be given to every 2009 Rockwood customer. This is just one more way to say "Thank you" and to ensure an enjoyable traveling experience.



**THAT'S 20,000 SQUARE FEET OF QUALITY ASSURANCE.
THE BARE ESSENTIALS FOR A PREMIUM PRODUCT.**

Brought online in 2005, Forest River is proud of its state-of-the-art test facility. This beautiful building blends many of the old tried and true methods of testing our diverse types of RVs with new innovative ways of solving quality issues. Being centrally located to most Forest River manufacturing facilities, this 20,000 square foot PDI (Pre-delivery Inspection) test building gives immediate daily feedback to individual managers. This assures the production facilities that nothing has slipped by the plant's quality assurance personnel and the units are "green" and ready to ship.

YOUR ROCKWOOD DEALER

For details on Rockwood's complete warranty program, see your Rockwood dealer. When it comes to backing products with the same quality and commitment it has when it begins the manufacturing process, the only name you have to remember when you're looking for a recreational vehicle is Rockwood. Rockwood offers the following additional limited warranties to the original purchasers. Consult written warranty for details.

1. Twelve-year vinyl roof warranty,
2. Two-year fiberglass warranty,
3. Five-year axle warranty,
4. Five-year tent warranty,
5. One-year bumper to bumper warranty,
6. Available second-year warranty



All specifications contained herein are based on the latest product information at time of printing. Forest River reserves the right to make changes in colors, materials, equipment and specifications at any time without notice and assumes no responsibility for any errors in this brochure.