

THE BUNKBEDS (optional on most models) add to the available sleeping space, while increasing the fun-factor twofold for the kid in all of us!

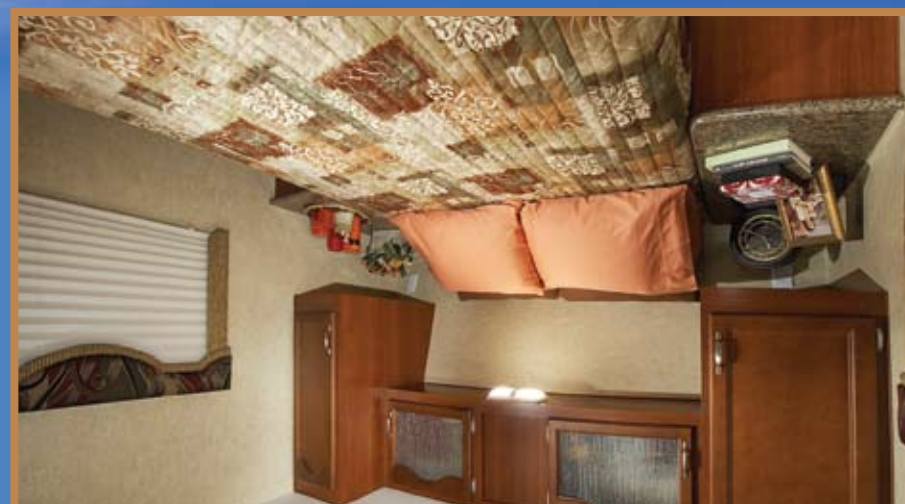

THE BEDROOM is a dream come true, combining comforts, like an inner-spring mattress, with functional features, like a wardrobe that accommodates full size hangers and abundant under-bed storage.



THE BATHROOM — with its tub/shower, skylight and flush toilet—is enough to make you swear off tents forever.

THE GALLEY features a double-bowl sink, 3-burner range with 16" oven, refrigerator, microwave, and a flip-up counter extension (excludes Sport models). No half-baked kitchen here!



THE LIVING ROOM let's you do exactly that. Open up the sofa bed and grab a nap (after turning off the decor light fixtures, of course). Or just relax with a cool drink. Don't worry if you spill, the wood-textured vinyl flooring can take it.



Mallard shown in Gemstones interior décor with Plantation Cherry wood finish.

THE ENTERTAINMENT isn't only outdoors—thanks to the AM/FM/CD player, or optional AM/FM/CD/DVD/MP3 player. Prefer the Big Game to big games? Add an LCD TV with DVD player (except on Sport models) and you're all set.



THE GARAGE STORAGE (optional) gives you plenty of extra room to store all those odds 'n' ends you like to bring along.



THE OVERHEAD GALLEY STORAGE, conveniently located above the sink, keeps items handy, and hidden, behind raised panel doors.



THE DINETTE gives you room to graze at mealtime, and enough table space—and overhead lighting—to take on a jigsaw puzzle (jigsaw puzzle after dessert).



GET READY TO HEAR "WHY DIDN'T WE DO THIS SOONER?" Packing it all up and heading for the hills (or the river, or the beach) is now as easy as hitching up your Mallard to your truck or SUV. Everything you need is right inside. And speaking of the inside, you're gonna love what we've done with the place. Go ahead, make yourself at home.



WHY MALLARD?

PASSION
We're truly passionate about the RV lifestyle. Fleetwood was founded by RV enthusiasts, and that tradition continues today.

QUALITY
There's no cutting corners. Skilled craftsmen build every Fleetwood RV for maximum durability and longevity.

SERVICE
Help is nearby. When you need an upgrade or repair, you'll find Fleetwood dealers all across North America ready to assist you.

WARRANTY
Exclusive RV Ownercare warranty. See your Fleetwood dealer for details.

TRUST
More people trust Fleetwood. After all, we've spent over 50 years perfecting RVs, earning the loyalty of generations of RVers.

LIGHT DUTY TOWABLE OFFERED



MALLARD & MALLARD SPORT

CONTACT US

To locate a dealer near you, visit our website at www.fleetwoodrv.com or call 1-800-444-4905. We can also be contacted at Fleetwood Customer Relations, P.O. Box 1007, Decatur, IN 46733.

FLEETWOOD TRAVELCADE CLUB

As a Fleetwood owner, you're invited to become a member of the Fleetwood Travelcade Club. It's the perfect way to meet other Fleetwood owners who love to travel across America and share in the RV lifestyle. Visit our website at www.fleetwoodrv.com/owners_clubs to learn more and join the fun.

RV OWNERCARE

See your local dealer for complete details.

IMPORTANT—PLEASE READ

Product information, photography and illustrations included in this publication were as accurate as possible at the time of printing. For further product information and changes, please visit our website at www.fleetwoodrv.com or contact your local Fleetwood dealer. Prices, materials, design and specifications are subject to change without notice. All weights, fuel, liquid capacities and dimensions are approximate. Fleetwood has designed its recreational vehicles to provide a variety of uses for customers. Each vehicle features optimal seating, sleeping, storage and fluid capacities. The user is responsible for selecting the proper combination of loads (i.e.: equipment, fluids, cargo, etc.) to ensure that the vehicle's capacities are not exceeded.

Your Local Fleetwood Dealer is:



To Our Customers...

To make sure that you get the maximum satisfaction out of your recreational vehicle purchase, there are several things you should know:

1. Learn all you can about the travel trailer or fifth wheel you're planning to buy. Don't rely on word of mouth. Get the facts about the actual trailer length, width, unloaded weight with options, Gross Vehicle Weight Rating, and Cargo Carrying Capacity. These are usually available in the manufacturer's sales literature or from the Cargo Carrying Capacity Label located in each trailer. Be sure to check this information before you decide which unit to buy.
 2. Verify the towing capacity of your tow vehicle. If you don't know, or aren't sure, you can ask at your automotive dealership or contact your tow vehicle manufacturer. Be sure to match your tow vehicle's tow rating to the Gross Vehicle Weight Rating (not dry weight) of the trailer you are considering. To help Fleetwood travel trailer customers estimate this total weight, our Gross Vehicle Weight Ratings reflect the maximum weight of the trailer when fully loaded for camping. Be sure the weight of the tow vehicle plus the Gross Vehicle Weight of your trailer does not exceed the Gross Combined Weight Rating (GCWR) of the tow vehicle.
- Taking these simple steps before you buy will help ensure that your trailer and tow vehicle combination is just what you wanted.

See you on the trail!

**WHEN YOU'VE GOT A MALLARD,
YOU WON'T WAIT 'TIL WINTER
TO MIGRATE.**

APPEALING DÉCORS | FUNCTIONAL FLOOR PLANS

RESIDENTIAL COMFORTS | LIGHT DUTY MODELS

2009 MALLARD

FLEETWOOD
Driven to Explore

MALLARD FLOOR PLANS



21CKS Single Slide-Out, Sleeps 6-7*

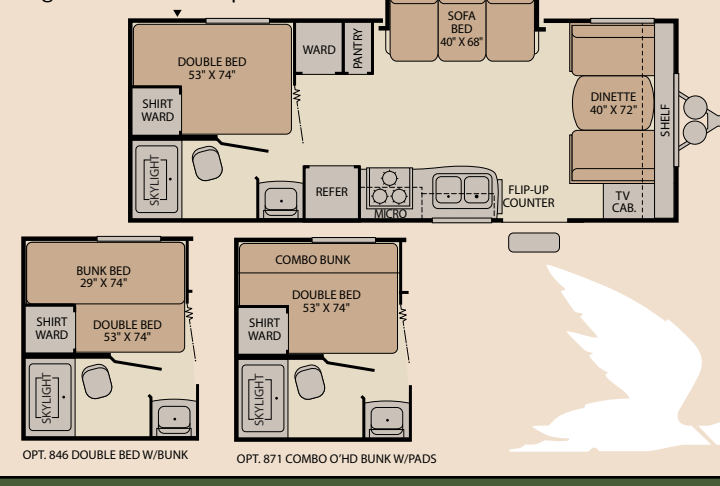

23RKS Single Slide-Out, Sleeps 6*

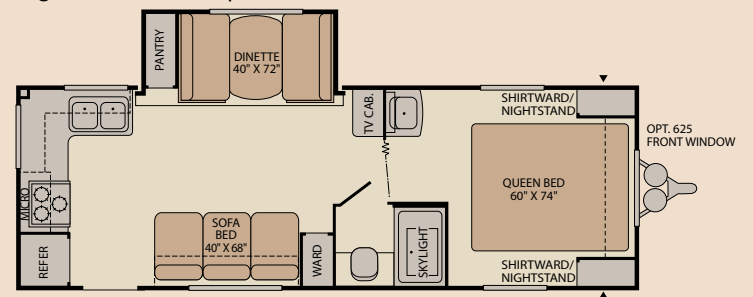

25RLS Single Slide-Out, Sleeps 6*

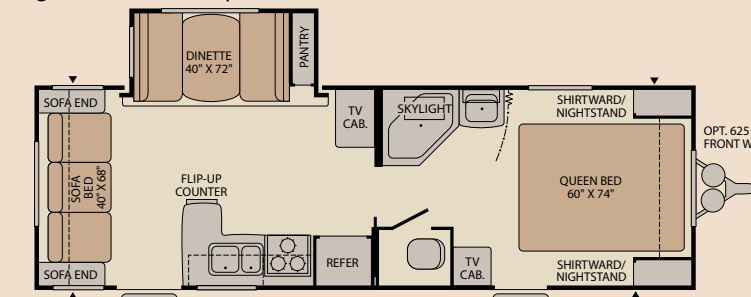

26RLS Single Slide-Out, Sleeps 6*

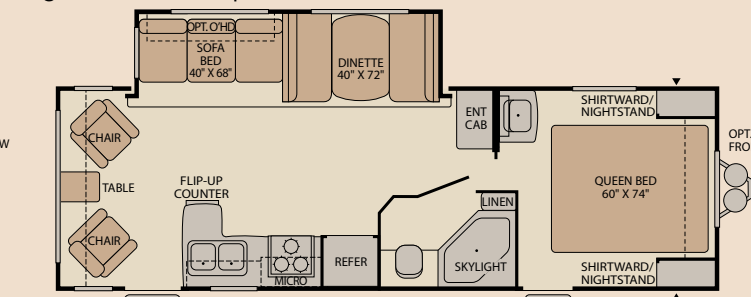

24FQGS Single Slide-Out, Sleeps 6*

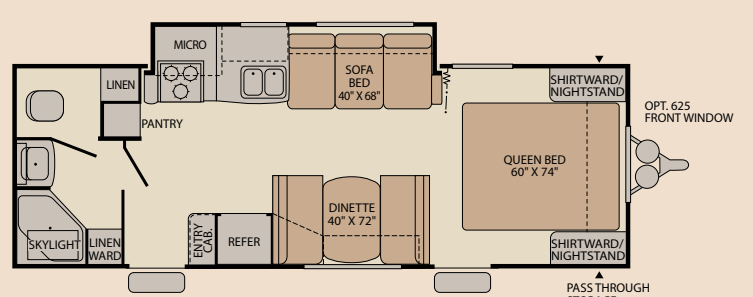

26BKS Single Slide-Out, Sleeps 6*

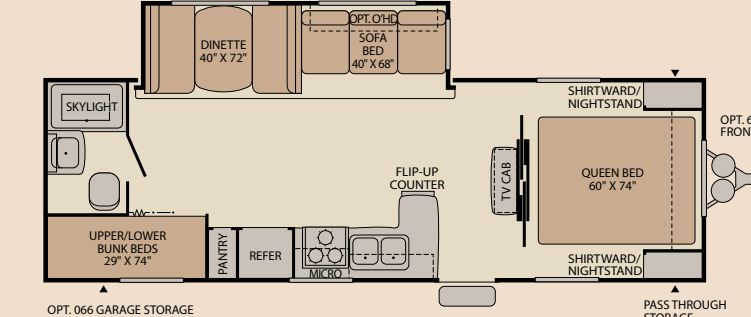

27RBS Single Slide-Out, Sleeps 6-7*

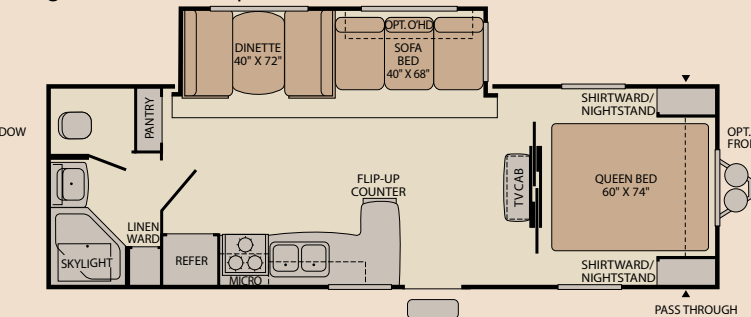

MALLARD SPORT FLOOR PLANS

18CK Sleeps 6-7*

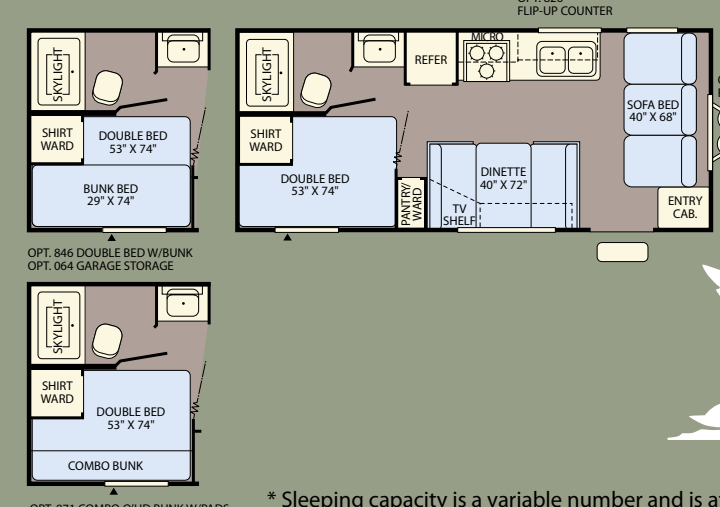

20FQ Sleeps 6-7*

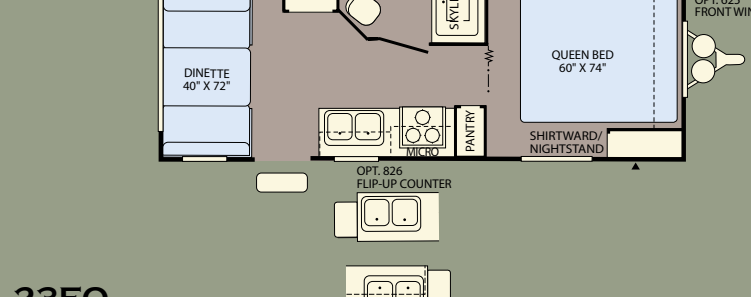

24BH Sleeps 6-7*

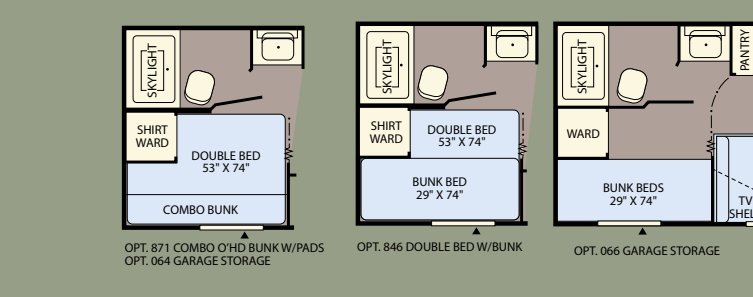

23FQ Sleeps 6-7*

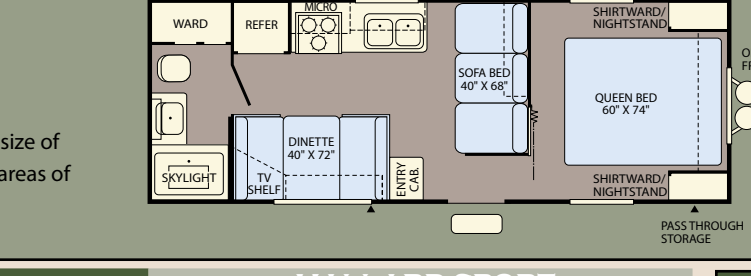

28BH Sleeps 8-9*

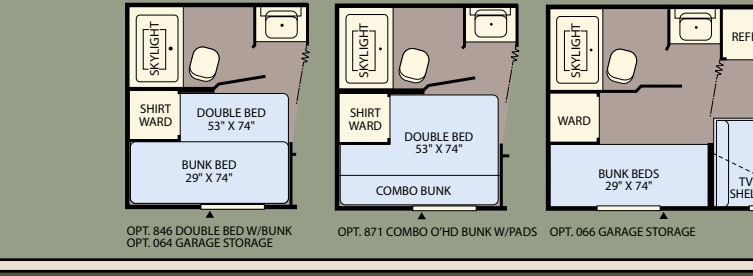

* Sleeping capacity is a variable number and is affected by items such as size of occupant, options and floor plan. Some models are not available in all areas of the country. Please see your local dealer for model availability.
▲ = Exterior Storage

MALLARD TRAVEL TRAILERS								MALLARD SPORT				
WEIGHTS	21CKS	23RKS	24FQGS	25RLS	26BKS	26RLS	27RBS	18CK	20FQ	23FQ	24BH	28BH
GVWR (lbs) ¹	6,400	7,900	7,000	7,900	8,000	7,900	8,000	5,600	5,800	6,400	5,800	7,400
Gross Dry Weight (lbs) ^{2,6}	4,198	5,582	4,856	5,795	5,595	5,521	5,883	4,000	3,936	4,264	4,005	4,591
Cargo Carrying Capacity (lbs) ^{3,6}	2,202	2,318	2,144	2,105	2,405	2,379	2,117	1,600	1,864	2,136	1,795	2,809
Hitch Dry Weight (lbs) ^{2,6,9}	636	691	408	576	518	801	780	345	520	496	453	549
DIMENSIONS & CAPACITIES												
Length (Feet & Inches) ^{4,6,8}	24' 8"	27' 6"	27' 4"	28' 11"	29' 3"	29' 1"	29' 6"	22' 3"	23' 9"	26' 1"	26' 8"	29' 7"
Height (Feet & Inches) ^{5,6}	10' 7"	10' 11"	10' 7"	10' 11"	10' 11"	10' 11"	10' 11"	10' 7"	10' 7"	10' 7"	10' 7"	10' 7"
Fresh Water Holding Tank (gal) ^{6,7}	50	50	50	50	50	50	50	40	40	40	40	40
Grey Water Holding Tank (gal) ^{6,7}	40	40/40	40	40	40	40/20	40	40	40	40	40	40
Black Water Holding Tank (gal) ^{6,7}	40	40	40	40	40	40	40	40	40	40	40	40
Propane Capacity (lbs) ^{6,7}	60	60	60	60	60	60	60	40	40	40	40	40
Tire Size (Load Range)	ST205/75 14C	ST225/75 15D	ST205/75 14C	ST225/75 15D	ST225/75 15D	ST225/75 15D	ST225/75 15D	ST205/75 14C	ST205/75 14C	ST205/75 14C	ST205/75 14C	ST205/75 14C

MALLARD INTERIOR DÉCOR CHOICES



MALLARD CONSTRUCTION

- ENGINEERED RADIUSED CEILING TRUSS**
- Helps to ensure strength and water runoff.
- ARCTIC WHITE SEAMLESS, ONE-PIECE RUBBER ROOF**
- Provides the ideal weather seal.
- INTERIOR WALL PANEL**
- Features a durable, easy-to-clean, decorative vinyl.
- STEEL CHASSIS**
- Provides optimal strength, durability and performance.
- WOOD DECKING**
- Provides a solid backbone for the roof construction.
- WOOD FRAMED SIDEWALL**
- Provides a solid foundation for the sidewall construction.
- R-7 FIBERGLASS INSULATION**
- Helps to ensure interior comfort in every season.
- .024" ALUMINUM SIDING**
- Complete with a baked on enamel paint, this aluminum siding offers rigidity while still being affordable.
- 5/8" TONGUE AND GROOVE DECKING**
- Provides structural strength floor construction.
- STUDS 16" ON CENTER**
- Utilizing residential framing methods, this is the structural component of our front section.
- FLOOR JOISTS**
- Provides the foundation for the underbelly.
- UNDERBELLY**
- Is a lightweight, seamless, durable weather barrier (available).

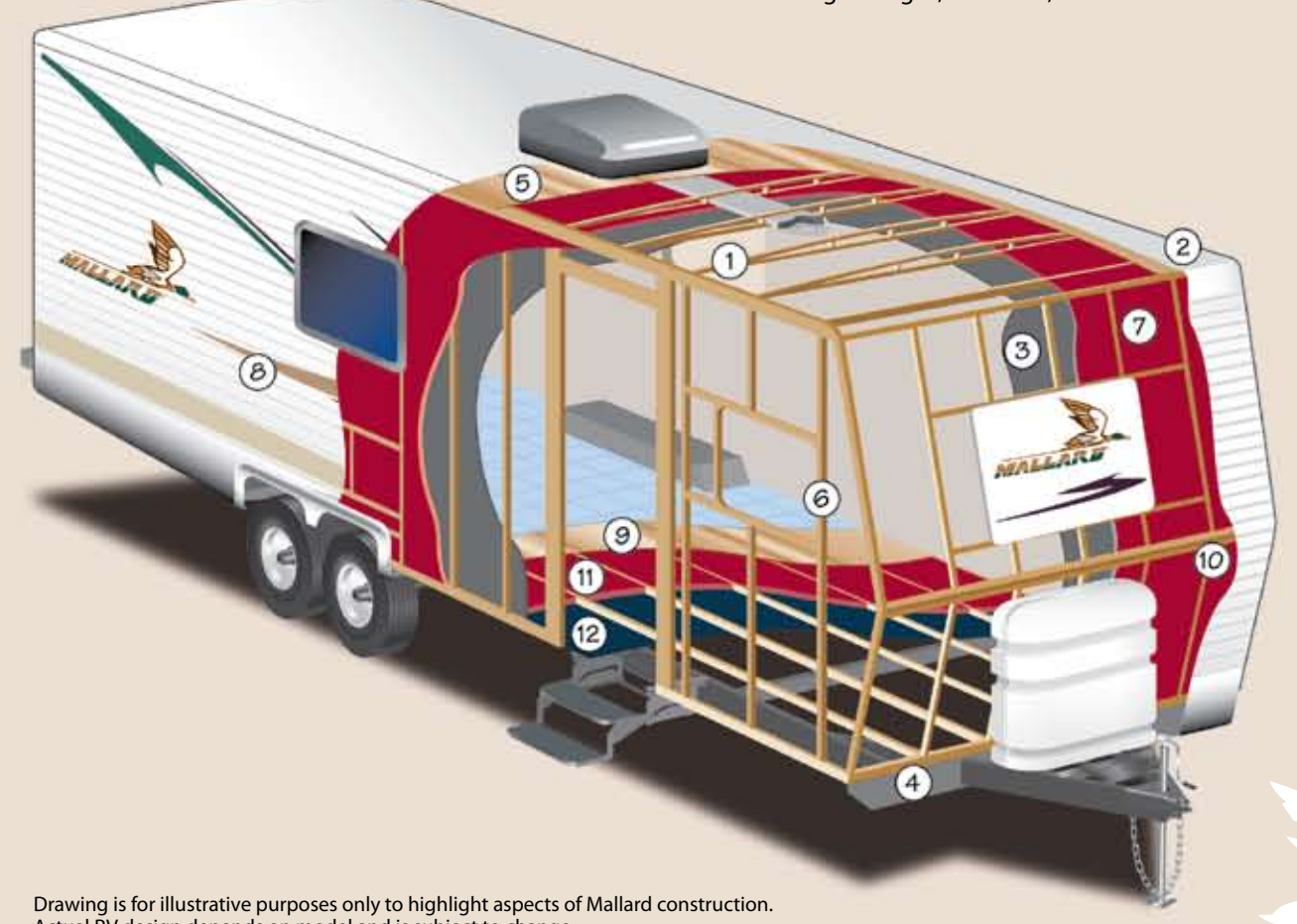

STANDARD

- #### INTERIOR - THROUGHOUT
- 120 Volt Central Electrical Panel
 - 120 Volt GFI Circuit Protection (Galley/Bath/Patio)
 - 6 Gallon Propane/12 Volt DSI (Direct Spark Ignition) Water Heater
 - Box Wrapped Valance Window Treatment
 - Ceiling Mount Décor Light Over Dinette and Sofa (Excludes Sport Models)
 - Double-Light Fixtures (Most Areas)
 - Dual 7 Gallon Propane Cylinders w/Regulator and Auto-Changeover (Except Sport)
 - Hydro Flame® Forced Air, Direct Spark Ignition Furnace w/Thermostat
 - In-Ceiling Air Conditioner Ducting (Most Models)
 - In-Floor Furnace Ducting (Excludes Sport Models)
 - Interior Lights w/Wall Switch
 - Large TV Location (Most Models)
 - Mini-Blinds Throughout (Except Bunk Windows)
 - Raised Panel Overhead Doors in Living Areas
 - Solid State Converter w/Built-In Battery Charger
 - Stereo AM/FM CD Player
 - Sofa Throw Pillows (2)
 - Valance Lambrequins in Living Areas (Excludes Sport Models)
 - Wall Mount Décor Light on Large Slide-Outs (Excludes Sport Models)
 - Wall Mounted Systems Monitor Panel
 - Water Heater Bypass
 - Wired for Roof Air Conditioner
 - Residential Grade Wood Textured Vinyl Flooring
- #### GALLEY
- Double Bowl Sink
 - Flip-Up Counter Extension (Excludes Sport Models)
 - Double Handle High Rise Faucet
 - Deluxe 3 Panel Wood Grain Refrigerator Insert (Excludes Sport Models)

EXTERIOR - THROUGHOUT

- Stabilization Jacks/2 Pair (Excludes Sport Models)
 - 120 Volt Patio Receptacle
 - Arctic White Gloss Exterior Metal Finish
 - Fiberglass Insulation
 - Front Gravel Guard
 - Full Color Decorative Exterior Graphics
 - LPG Cover
 - Molded Wheel Well Skirts (Excludes Sport Models)
 - Patio Awning
 - Radius Aluminum Sidewall Skirting (Excludes Sport Models)
 - Radius Corner Entry Door (Excludes Sport Models)
 - Radius Corner Luggage Doors (Excludes Sport Models)
 - ABS Molded Entry Step Trim (Excludes Sport Models)
 - Radius Corner Safety Glass Windows
 - Security Light (Except Sport)
 - Screen Door
 - Rear Bumper w/Sewer Hose Carrier
 - Slide-Out End Wall Window
 - Seamless, One-Piece Rubber Roof
 - Structural I-Beam Cambered Chassis
 - Square Entry Door (Sport Models)
 - Square Corner Luggage Doors (Sport Models)
 - Sub-Floor Fresh Water Holding Tank (Most Models)
 - Truss Roof Rafter
 - TV Antenna
- #### STORAGE
- Locking, Insulated Luggage Doors
 - Large Pass Through Storage (Most Models)

OPTIONS

- #### INTERIOR - THROUGHOUT
- 13,500 Btu Air Conditioner
 - 15,000 Btu Air Conditioner (Excludes Sport Models)
 - Day/Night Shades (Excludes Sport Models)
 - 6-Gallon Propane/12V/110V DSI (Direct Spark Ignition) Water Heater (Excludes Sport Models)
 - Front Window w/Rock Guard
 - Bedroom Carpet (Most Models)
 - Stereo AM/FM/CD/DVD/MP3 Player (Excludes Sport Models)
 - Upgrade Mattress (Excludes Sport Models)
 - LCD TV w/DVD (Excludes Sport Models)
 - Range Cover
 - Sink Lids (2)
 - Pot and Pan Drawer
 - Glass Shower Enclosure (Excludes Sport Models)
 - Porcelain Toilet (Excludes Sport Models)
 - Slide Room Enhancement Package (Excludes Sport Models)
 - Double Bed w/Bunk Combo (Select Models)
 - Flip-Up Counter (Sport Models)
 - ABS Tub Shower Enclosure (Sport Models)
 - Combo Overhead Bunk (Select Models)
 - Front Overhead Cabinet (18CK)
- #### EXTERIOR - THROUGHOUT
- Enclosed Chassis (Excludes Sport Models)
 - Upgrade Radial Tires
 - Exterior Shower
 - Garage Storage (Most Models)
 - Spare Tire and Carrier
 - Stabilizer Jacks (Sport Models)
 - Exterior Speakers
 - Ladder (Excludes Sport Models)
 - 7-Gallon Propane Cylinders w/Regulator and Auto-Changeover (Sport Models)
 - Easy Winterization Kit
 - Electric Awning (Excludes Sport Models)

SAFETY/CONVENIENCE

- 26" Wide Main Entry Door w/Window
- 4-Wheel Electric Brakes
- Break-Away Emergency Disconnect Brake
- Carbon Monoxide Detector/Alarm
- Fire Extinguisher
- Flush Mount Entry Door Latch w/Deadbolt Lock
- Patio Light w/Interior Switch
- Propane Detector/Alarm
- Retractable Entry Step w/Non-Skid Strip
- Smoke Detector/Alarm

1. GVWR (Gross Vehicle Weight Rating) is the maximum permissible weight of this trailer when fully loaded. It includes all weight at the trailer axle(s) and tongue or pin.
2. All dry weights are based on the standard model and do not include optional features or equipment.
3. Cargo Carrying Capacity is determined by subtracting Gross Dry Weight from GVWR. Cargo includes all fluids, optional features, equipment, and personal cargo.
4. Length is measured from hitch or pin box to rear bumper (excludes accessories). Trailer length includes hitch; fifth wheel includes standard pin box.
5. Actual height may be lower, based on option offerings. Consult with your dealer to obtain actual height for the unit you are interested in.
6. Approximate.
7. Water weight equals 8.3 lbs per gallon. Propane weight equals 4.2 lbs per gallon.
8. Add 10" if equipped with optional spare tire and carrier.
9. Hitch weights are dependent upon how the trailer is equipped with options, on-board cargo, and tank fluid levels. Actual hitch weights may be higher or lower than shown. It is recommended that the tow vehicle and hitch for your trailer have sufficient capacity to accommodate the Gross Vehicle Weight Rating of the selected trailer.
N/A = Not available at the time of printing.

Drawing is for illustrative purposes only to highlight aspects of Mallard construction. Actual RV design depends on model and is subject to change.