

WHY FORMULA?



QUALITY

There's no cutting corners. Skilled craftsmen build every Fleetwood RV for maximum durability and longevity.



WARRANTY

Exclusive RV Ownercard warranty. See your Fleetwood dealer for details.



PASSION

We're truly passionate about the RV lifestyle. Fleetwood was founded by RV enthusiasts, and that tradition continues today.



SERVICE

Help is nearby. When you need an upgrade or repair, you'll find Fleetwood dealers all across North America ready to assist you.



TRUST

More people trust Fleetwood. After all, we've spent over 50 years perfecting RVs, earning the loyalty of generations of RVers.

CONTACT US

To locate a dealer near you, visit our website at www.fleetwoodrv.com or call 1-800-444-4905. We can also be contacted at Fleetwood Customer Relations, P.O. Box 1007, Decatur, IN 46733.

FLEETWOOD TRAVELCADE CLUB

As a Fleetwood owner, you're invited to become a member of the Fleetwood Travelcade Club. It's the perfect way to meet other Fleetwood owners who love to travel across America and share in the RV lifestyle. Visit our website at www.fleetwoodrv.com/owners_clubs to learn more and join the fun.

RV OWNERCARE

See your local dealer for complete details.

IMPORTANT—PLEASE READ

Product information, photography and illustrations included in this publication were as accurate as possible at the time of printing. For further product information and changes, please visit our website at www.fleetwoodrv.com or contact your local Fleetwood dealer. Prices, materials, design and specifications are subject to change without notice. All weights, fuel, liquid capacities and dimensions are approximate. Fleetwood has designed its recreational vehicles to provide a variety of uses for customers. Each vehicle features optimal seating, sleeping, storage and fluid capacities. The user is responsible for selecting the proper combination of loads (i.e.: equipment, fluids, cargo, etc.) to ensure that the vehicle's capacities are not exceeded.

Your Local Fleetwood Dealer is:

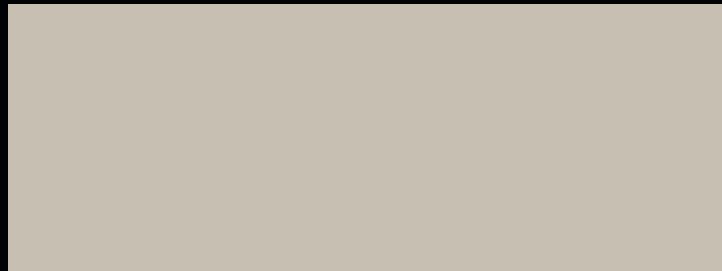

To Our Customers...

To make sure that you get the maximum satisfaction out of your recreational vehicle purchase, there are several things you should know:

1. Learn all you can about the travel trailer or fifth wheel you're planning to buy. Don't rely on word of mouth. Get the facts about the actual trailer length, width, unloaded weight with options, Gross Vehicle Weight Rating, and Cargo Carrying Capacity. These are usually available in the manufacturer's sales literature or from the Cargo Carrying Capacity Label located in each trailer. Be sure to check this information before you decide which unit to buy.

2. Verify the towing capacity of your tow vehicle. If you don't know, or aren't sure, you can ask at your automotive dealership or contact your tow vehicle manufacturer. Be sure to match your tow vehicle's tow rating to the Gross Vehicle Weight Rating (not dry weight) of the trailer you are considering. To help Fleetwood travel trailer customers estimate this total weight, our Gross Vehicle Weight Ratings reflect the maximum weight of the trailer when fully loaded for camping. Be sure the weight of the tow vehicle plus the Gross Vehicle Weight of your trailer does not exceed the Gross Combined Weight Rating (GCWR) of the tow vehicle.

Taking these simple steps before you buy will help ensure that your trailer and tow vehicle combination is just what you wanted.

See you on the trail!



Fleetwood's Ultimate Extreme Line - brought to you by a group of dedicated RV professionals that understand and enjoy the toy hauler lifestyle as much as you do!

FORMULA



IT'S THE BEST OF BOTH WORLDS

A cozy living space mom would love and an "out of sight" garage for your muddy toys.



FORMULA



Formula shown in Bad Blue.





FORMULA

THE BEST OF BOTH WORLDS



MULTI-PURPOSE GARAGE in Formula provides endless flexibility. Store your dirty toys out of view from the rest of the gorgeous living space. Hang out with your friends after a long ride and take advantage of the fold-over sofa and table, the electric queen bed, convenient flip-down beverage holders, and TV shelf. (TV, as shown, not included.)

LARGE DUAL-ENTRY BATHROOM in Formula features a glass-enclosed shower, a residential-styled sink, toilet, and a wall-mounted beverage holder. How handy is that?



THE FULL EXTENSION DRAWERS smoothly glide out all the way, so that you can easily reach items in the back.



FORMULA 385SA2G shown in Ebony interior décor with Plantation Cherry wood finish. Just consider Formula as your favorite second home. **THE GALLEY** features a refrigerator, 3-burner range, oven and microwave. Above the wall to the garage is a cozy loft with queen bed.



CENTRALIZED CONTROLS are command central for your Formula. Because we located the switches and gauges in a convenient, centralized area, you don't have to go searching to find the right button.

ROCK THE BOX II™ SOUND SYSTEM (optional) includes 10 speakers, a huge sub woofer, and 2 power amplifiers that provide awesome sound and will make the neighbors jealous.



LIVING ROOM in Formula was made for fun! Kick back on the sofa bed and watch your favorite show on the available wall-mounted LCD TV with DVD Player. Enjoy a family meal at the comfy dinette.

MASTER BEDROOM provides an oasis for Mom and Dad to relax and recharge after a day of teaching junior to ride his quad at the sand dunes.



FORMULA - FLOOR PLANS

335MD2G
Double Slide-Out • Sleeps 6 - 8*

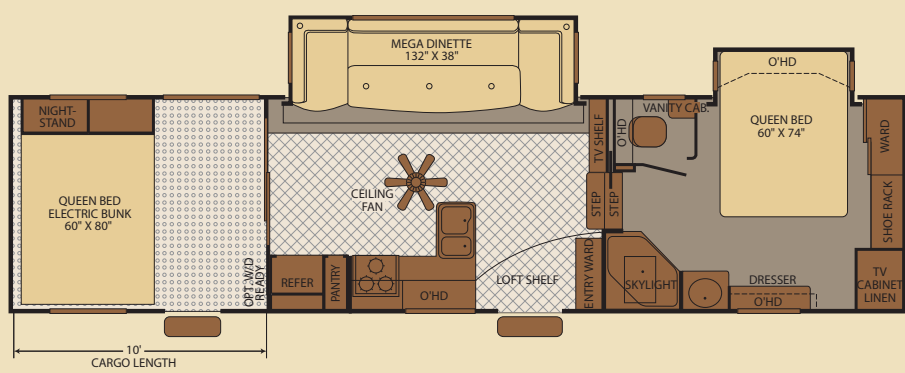

385SA2G
Double Slide-Out • Sleeps 8 - 10*

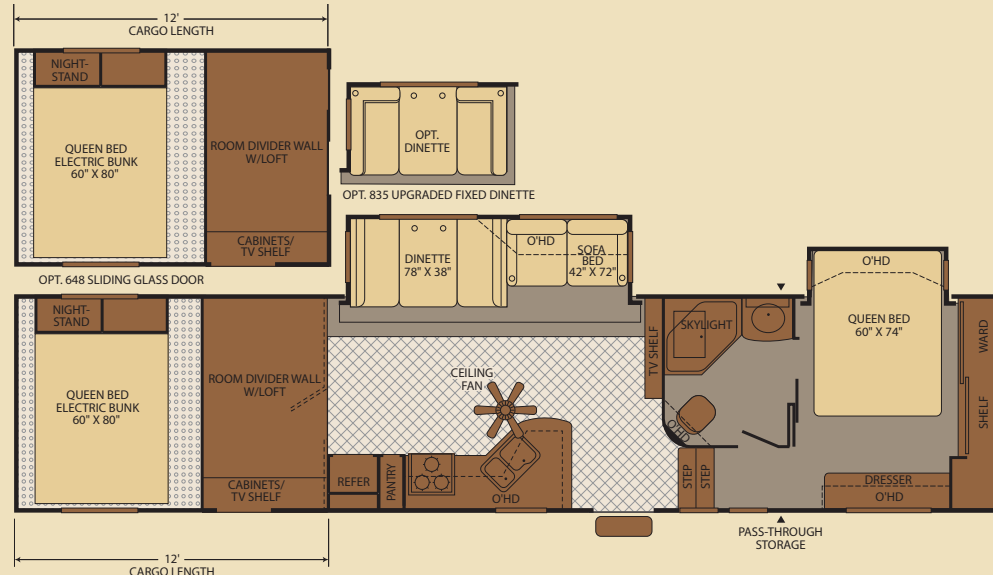

395SA3G
Triple Slide-Out • Sleeps 8 - 10*

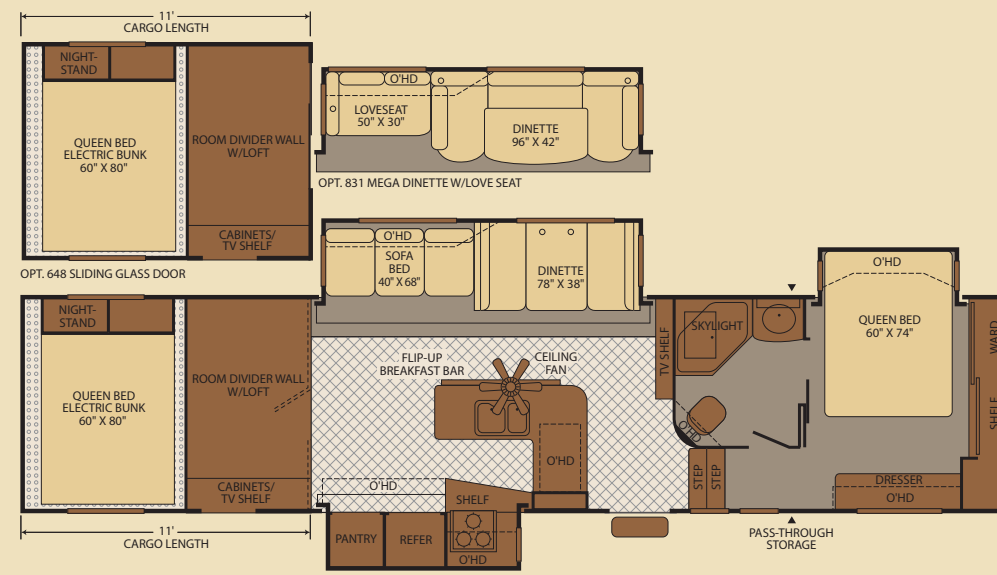

* Sleeping capacity is a variable number and is affected by items such as size of occupant, options and floor plan. Some models are not available in all areas of the country. Please see your local dealer for model availability.

▲ = Exterior Storage

FORMULA - WEIGHTS AND MEASUREMENTS

DIMENSIONS & CAPACITIES

	335MD2G	385SA2G	395SA3G
Length (Feet & Inches) ^{5,6}	36' 7"	39' 11"	39' 11"
Height (Feet & Inches) ^{5,6}	13' 5"	13' 5"	13' 5"
Fresh Water Holding Tank (gal) ^{6,7}	120	120	120
Grey Water Holding Tanks (gal) ^{6,7}	40/40	40/40	40/40
Black Water Holding Tank (gal) ^{6,7}	40	40	50
Propane Capacity (lbs) ^{6,7}	60	30	30
Tire Size (Load Range)	ST235/80R16(D)	ST235/80R16(D)	ST235/80R16(D)

WEIGHTS

	335MD2G	385SA2G	395SA3G
GVWR (lbs) ¹	N/A	17,200	17,500
Gross Dry Weight (lbs) ^{2,6}	N/A	11,750	12,260
Cargo Carrying Capacity ^{3,6}	N/A	5,450	5,240
Hitch Dry Weight (lbs) ^{2,6,8}	N/A	2,222	2,373

FORMULA - INTERIOR DECOR CHOICES

EBONY

LIVING ROOM

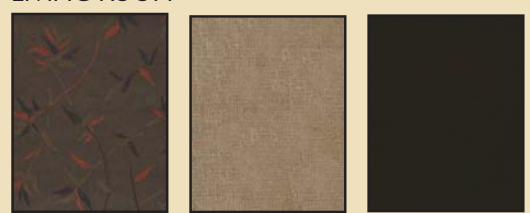

BEDROOM

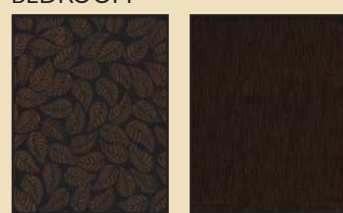

RAVEN

LIVING ROOM



BEDROOM



WOOD CHOICES

PLANTATION CHERRY

SYMPHONY CHERRY



STANDARD FEATURES

INTERIOR - THROUGHOUT

- Residential Styled Furniture
- 15,000 Btu Air Conditioner
- 10 Gallon Propane Water Heater with Direct Spark Ignition
- Full Systems Monitor Panel with FUEL Logo
- 90 Amp Converter
- Hydro Flame® Forced Air Furnace with Direct Spark Ignition
- Residential Ceiling Fan with Lights
- Commercial Grade Carpet & Linoleum
- Whole House Water Filtration System
- Hidden Hinge Cabinetry
- Halogen Lighting

LIVING ROOM

- Solid Window Valances and Lambrequins
- Night Shades
- Built-In Video Center for LCD TV
- Large Overhead Cabinets with Built In Directional Reading Lights
- Fixed Dinette/Sleeper (Model Specific)
- Décor Lighting
- Residential Sofa Sleeper with Built In Cup Holders (Model Specific)
- AM/FM/CD Stereo with 6 Speakers (4 Inside, 2 Outside)
- Cable TV Hookup
- Satellite Antenna Prep

GALLEY

- Residential Style Laminate Galley Countertop with Double Bowl Sink
- Matching Sink Lids
- Residential Roller Bearing Drawer Guides
- 22" Oven with 3-Burner (1 High-Output) Range
- 8 cu. ft. Double Door Refrigerator
- Microwave with Electronic Touch Pad
- Residential Style Brushed Nickel Finished

Faucet with Hand Sprayer

- Large Pantry
- Fluorescent Lighting
- Mini Blinds
- Range Hood with 12V Light & Exhaust Fan
- Under Sink Waste Basket
- Flip-Up Breakfast Bar (395SA3G)

MASTER BEDROOM

- Queen Size Bed with Under Bed Storage
- Overhead Storage Cabinets
- Large Dresser of Drawers
- Full Width Mirrored Wardrobe with Shelves
- Headboard
- Overhead Storage Shelf
- His and Hers Bullet Reading Lights

BATHROOM

- Large "Jack and Jill" Dual Entry Bathroom
- Residential Styled Lavatory Countertop with Coordinating Sink
- Neo Angle ABS Tub and Shower with Foot Rest
- Glass Tub and Shower Enclosure
- Porcelain Foot Pedal Toilet
- Towel Bars (2) & Ring
- Flip Down Cup Holder
- Medicine Cabinet with Mirrored Door & Shelves
- Power Exhaust Roof Vent
- Skylight

LOFT

- Reading Lights
- Queen Size Bed with Ladder & Privacy Curtain
- Storage Cabinets
- TV Compartment

FORMULA - FEATURES

GARAGE

- Commercial Grade Non-Slip Flooring
- Heavy Duty Cargo Tie Down Tracks (3) with Adjustable Tie Downs (6)
- Flush Floor Tie Downs (3)
- Electric 12V Bunk with Queen Mattress
- Large Overhead Corner Cabinets
- TV Compartment
- White Board (Select Models)
- Fluorescent and Incandescent Lighting
- Engineered In Beavertail Departure Angle
- Full 96" Ramp Door Opening
- Flip Down Cup Holders
- Miniblinds
- Diamond Plate Wall Trim

SAFETY/CONVENIENCE

- Carbon Monoxide Detector/Alarm
- Fire Extinguisher
- Propane Detector/Alarm
- Smoke Detector/Alarm
- 12 Volt Disconnect
- RAM Air Vents - Garage

EXTERIOR - THROUGHOUT

- 7' 2" Ramp Door with 3,500 lb. Rating, Integrated Locks, Protective Stop Bumpers & Non-Skid Surface
- Walk On Roof with Retractable Ladder
- Manual Awning
- Exterior Shower
- Large Finished Pass Through Storage
- Enclosed Centralized Docking Station
- Tank Flush System (Solid Tank)
- Dual 7 Gallon (30 lb.) Propane Tanks
- Triple Axles with E-Z Lube® Hubs
- 16" Steel Wheels
- Low Pressure Propane Bib with Quick Release Fitting
- Triple Entry Step

FRESH WATER TANK QUICK DRAIN KNIFE VALVE

- R 11 Fiberglass Insulation (Ceiling)
- R 7 Fiberglass Insulation (Floor, Sidewall, Front Section)
- Upgraded Graphics Package
- Weather Resistant Exterior Speakers
- Exterior Washer with Pressurized Nozzle
- Base Camp Flood Lights (2)
- Ramp Area Flood Lights (2)
- Pet/Toy Security Rings (2)
- Chassis Mount Spare Tire (Radial)
- TV Antenna
- Scissor Stabilizer Jacks
- Large Folding Entry Door Grab Bar
- Power Front Jacks

SAFETY/CONVENIENCE

- 50 AMP Service
- Deep Tint Safety Glass Windows
- 120V GFI Circuit Protection (Galley/Bath/Patio)
- 120V Patio Receptacle
- Back-Up Lights
- Locking Storage Compartments
- Amber Patio Light

STORAGE

- Luggage Doors Radius Corner (Where Applicable)
- Carpeted Luggage Compartments
- Power Cord Storage

BODY STRUCTURE

- Full 102" Wide Construction
- Enclosed and Heated Chassis
- Cambered Chassis
- High Gloss Fiberglass Laminated Sidewalls with Welded Aluminum Frame
- Full Length Engineered Sub Floor - Living & Garage Areas
- Front Fiberglass Cap with Accent Light
- Enclosed Upper Deck Area

OPTIONS

INTERIOR

- U-Shaped Mega Dinette and Love Seat Combination (395SA3G)
- Fixed Dinette Upgrade (385SA2G)
- Wall Mounted LCD Flat Screen TV with DVD Player - Living Room
- Sliding Glass Door - Garage
- Wall Mounted LCD TV with DVD Player - Bedroom
- Rock the Box II™ Audio Entertainment System: Custom Designed 11 Speaker (Including 12" Sub Woofer) MP3 Ready Stereo System with Two Power Amplifiers, Dedicated Power Converter & External Weather Resistant Controls
- Comfort Air Power Roof Vent with Remote Control - Galley
- Aluminum Storage Cabinet with Fold Down Work Shelf and Paper Towel Holder - Garage
- 13,500 Btu Secondary Air Conditioner
- Dual Pane Windows with Deep Tint
- Dual Electric Bunks with Sofa - Garage
- Removable Carpet Kit - Garage
- Deluxe Pillow Shams - Bedroom

EXTERIOR

- Electric Awning
- Retractable Ramp Door Screen Partition
- 5.5 kW Onan® Generator with Pump Station and Tank (30 Gal.)
- Integrated 3 Gal. Air Tank Compressor with 25 Ft. Hose
- All New FUEL Amphitheater™: 7' x 7' Outside Movie Screen with Weather Resistant Video Hook Ups
- All New Custom 16" Aluminum Wheels
- Heavy Duty Flip Down Diamond Plate Ramp Extension

- GVWR (Gross Vehicle Weight Rating) is the maximum permissible weight of this trailer when fully loaded. It includes all weight at the trailer axle(s) and tongue or pin.
- All dry weights are based on the standard model and do not include optional features or equipment.
- Cargo Carrying Capacity is determined by subtracting Gross Dry Weight from GVWR. Cargo includes all fluids, optional features, equipment, and personal cargo.
- Length is measured from hitch or pin box to rear bumper (excludes accessories). Trailer length includes hitch; fifth wheel includes standard pin box.
- Actual height may be lower, based on option offerings. Consult with your dealer to obtain actual height for the unit you are interested in.
- Approximate.
- Water weight equals 8.3 lbs per gallon. Propane weight equals 4.2 lbs per gallon.
- Hitch weights are dependent upon how the trailer is equipped with options, on-board cargo and tank fluid levels. Actual hitch weights may be higher or lower than shown. It is recommended that the tow vehicle and hitch for your trailer have sufficient capacity to accommodate the Gross Vehicle Weight Rating of the selected trailer. Toy Haulers are intended to have a concentrated load in the rear.

Toy haulers feature a body width over 96" which will restrict your access to certain roads. Before purchasing, you should research any state and/or province road laws which may affect your usage.

IMPORTANT - PLEASE READ: Product information, photography and illustrations included in this publication were as accurate as possible at the time of printing. For further product information and changes, please visit our website at www.fleetwoodrv.com or contact your local Fleetwood dealer. Prices, materials, design and specifications are subject to change without notice. All weights, fuel, liquid capacities and dimensions are approximate. Fleetwood has designed its recreational vehicles to provide a variety of uses for customers. Each vehicle features optimal seating, sleeping, storage and fluid capacities. The user is responsible for selecting the proper combination of loads (i.e., equipment, fluids, cargo, etc.) to ensure that the vehicle's capacities are not exceeded.

ROCK-SOLID!™ CONSTRUCTION

BUILT MEGA-STURDY WITH AN ALUMINUM FRAME, SMOOTH LAMINATED WALLS AND LAMINATED SUBFLOOR.



RAMP EXTENSION

(optional) makes it easier to load your toys with this heavy-duty diamond-plate panel that flips over to cover the lip of the ramp door.

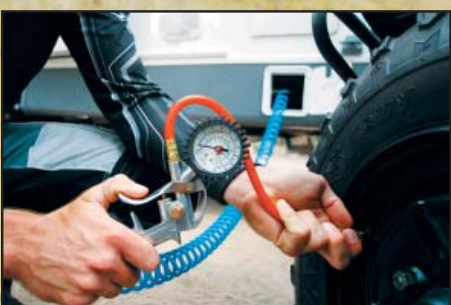

AIR COMPRESSOR

(optional) is perfect for inflating dirt bike tires or beach balls. (Be the life of the party! Impress your friends!)



PASS-THROUGH STORAGE

is where you put the XXL gear like camp chairs, ice chests, firewood and gear bags. Rubber flooring and tie-downs ensure your stuff stays put.



FUELING STATION

(optional) lets you gas up and ride off fast. So you can lose the jugs!

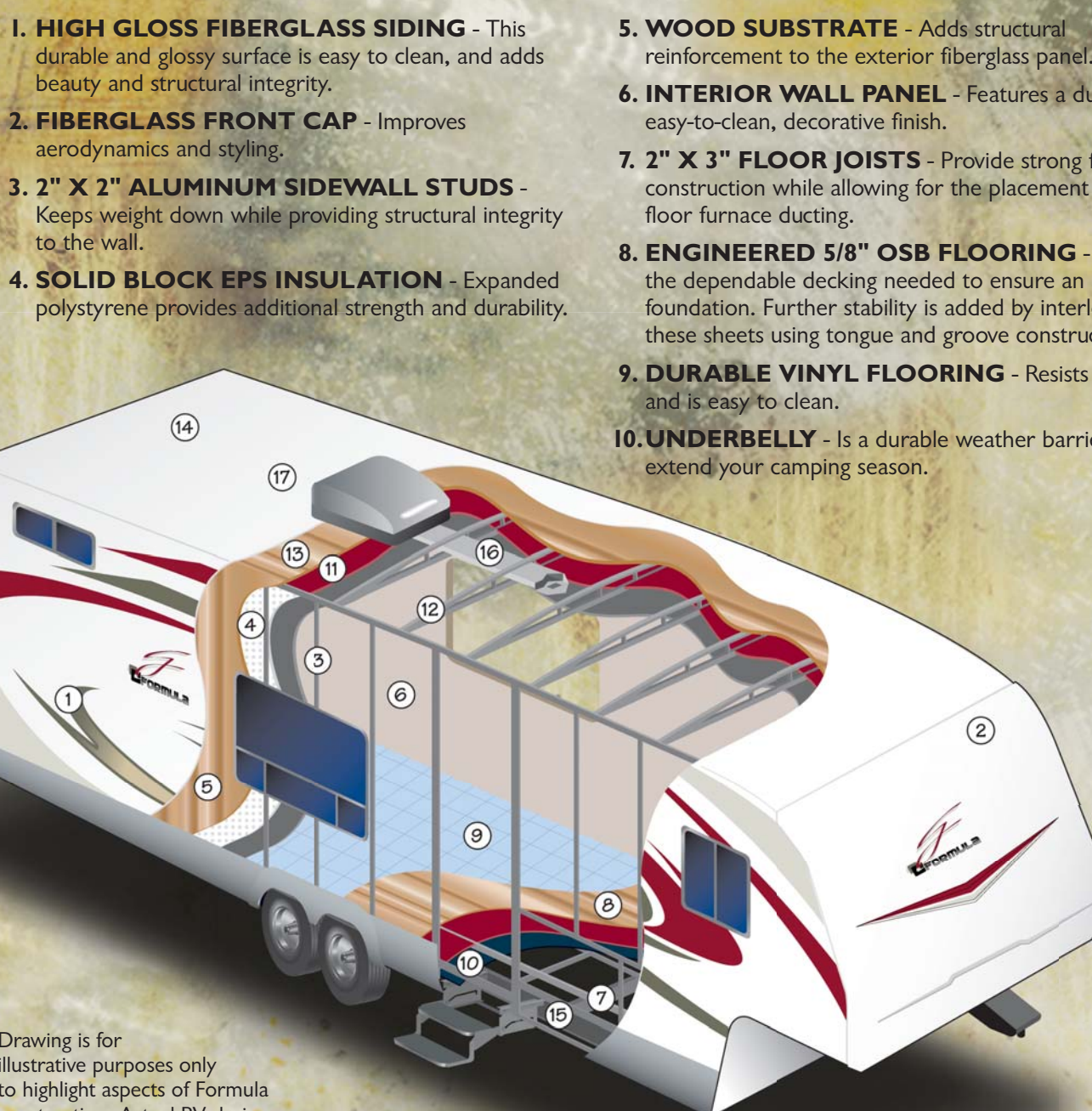

Drawing is for illustrative purposes only to highlight aspects of Formula construction. Actual RV design depends on model and is subject to change.

II. R11 FIBERGLASS INSULATION IN CEILING

- As in your home, helps to ensure interior comfort in every season.

12. ENGINEERED RADIUSED CEILING TRUSS

Helps to ensure strength and water runoff.

13. ENGINEERED OSB ROOF SUBSTRATE

- Is designed to maximize strength, is sealed to ensure moisture resistance and provides a solid backbone for the synthetic rubber roof construction.

14. ONE-PIECE SEAMLESS SYNTHETIC RUBBER ROOF MEMBRANE

- Provides the ideal weather seal and is warranted for 12 years.

15. REINFORCED CAMBERED STEEL CHASSIS

- Provides optimal strength, durability, and performance.

16. DUCTED IN-CEILING AIR CONDITIONING

- Efficiently distributes cool air.

17. DUCTED IN-CEILING GARAGE HEATING & AIR CONDITIONING

- Now get both cool air and heat in the garage area.

ALL NEW FUEL AMPHITHEATER™ (optional)

Entertain family and friends with movies and video games, shown on the large 7' x 7' screen. Exterior video and power connections make it easy.



Shown above in Rad Red.