

EXCURSION™

CLASS A DIESEL

WHAT A FIVE-STAR HOTEL LOOKS  
LIKE ON SIX WHEELS.



2009 EXCURSION

FLEETWOOD®





## LIFE IS BETTER AT THE TOP.

For those who live life on a grand scale, Excursion is a motor home of equal magnitude. With a heightened sense of style and the finest amenities, Excursion wraps you in a bubble of luxury wherever you travel. The lush fabrics, the natural grained wood cabinetry and contemporary appliances all work together beautifully. Just like a designer home, crown molding and halogen dimmers are used throughout. In fact, our 40X model features a 40" Samsung® LCD HDTV in the center of the coach for a home theatre experience. You have high expectations... Excursion surpasses them.

### Quality



There's no cutting corners. Skilled craftsmen build every Fleetwood RV for maximum durability and longevity.



EXCURSION



### WHY BUY EXCURSION?



#### Impressive Exterior

The sheer sophistication of Excursion is striking. Be prepared to turn a lot of heads.





**Excursion 40X** shown in Coriander interior décor with Plantation Cherry wood cabinetry.



**Two Euro-Style Recliners** provide the best seats in the house to watch a movie. And not just any seats – these are ultra-stylish, covered in genuine leather. (Standard in the 40Q and 40X models, optional in other models.)



**The Front Entertainment Center** is like your own private movie theater. After a day at the beach, you might watch a surf movie on the 32" Samsung® LCD HDTV (40" midship LCD HDTV available on 40X - shown above), DVD player and Dolby® 5.1 theater sound system with front, rear and center speakers, and a subwoofer. Or, enjoy home movies or video games with the RCA TV jacks.

### Cummins® 360HP Diesel Engine

As one of the finest performing diesel engines in the world, this Cummins® ISC 8.3L engine provides mighty power underfoot.

### Luxurious Décor

With decorator touches coordinated throughout, it's as nice as a grand hotel.

### Top-Of-The-Line Components

Just as you'd expect, the coach is equipped with brand name appliances, electronics and furnishings.

### Upscale Conveniences

Excursion anticipates your every need, with an array of conveniences to save you time and trouble.

### Spacious Floor Plan Designs

Choose from five floor plans to fit your personal style, including two with full-wall slide-outs.





## A DISPLAY OF YOUR GOOD TASTE.

With its sleek lines and high-end appliances, the galley is as beautiful as it is functional. We've used the very best components, from the solid surface countertops to the exquisite cabinetry to the stainless steel finishes. Of course, the appliances are brand names you trust, such as Norcold® and GE®. And to keep them running flawlessly, we've added a 2000-watt pure sine inverter to deliver clean, pure AC power.

### Trust



More people trust Fleetwood. After all, we've spent over 50 years perfecting RVs, earning the loyalty of generations of RVers.



EXCURSION



**The Residential Grade Sink and Faucet** features a Blanco™ stainless steel double sink with a clean, contemporary look. The artful wand faucet features single-lever control with dispensers for soap and hand lotion (selected models).



**The Free-Standing Dinette with Credenza** (optional) would fit right in at a fine restaurant, and its slim profile frees up more floor space. The credenza is the perfect place for a few candles so you can enjoy dinner by candlelight.





**The Galley** features a four-door Norcold® 12 cu. foot refrigerator with a water dispenser in the door and an ice maker to cool your drinks. In addition to the GE® 2-burner cook-top, the GE® convection microwave cooks and bakes food in a fraction of the time of a conventional oven. And to keep these appliances running flawlessly, we've added a 2000 watt pure sine inverter to deliver clean, pure AC power.



**The Kitchenaid® Dishwasher** (optional) is a great place to wash and store your dishes.



**Fully Extending Drawers** allow you to store things at the very back.

**The Cabinets** hold the ingredients for gourmet meals and light snacks. Select models feature pull-out baskets that make packing faster. Simply fill them inside your kitchen at home, then slide into Excursion's pantry.



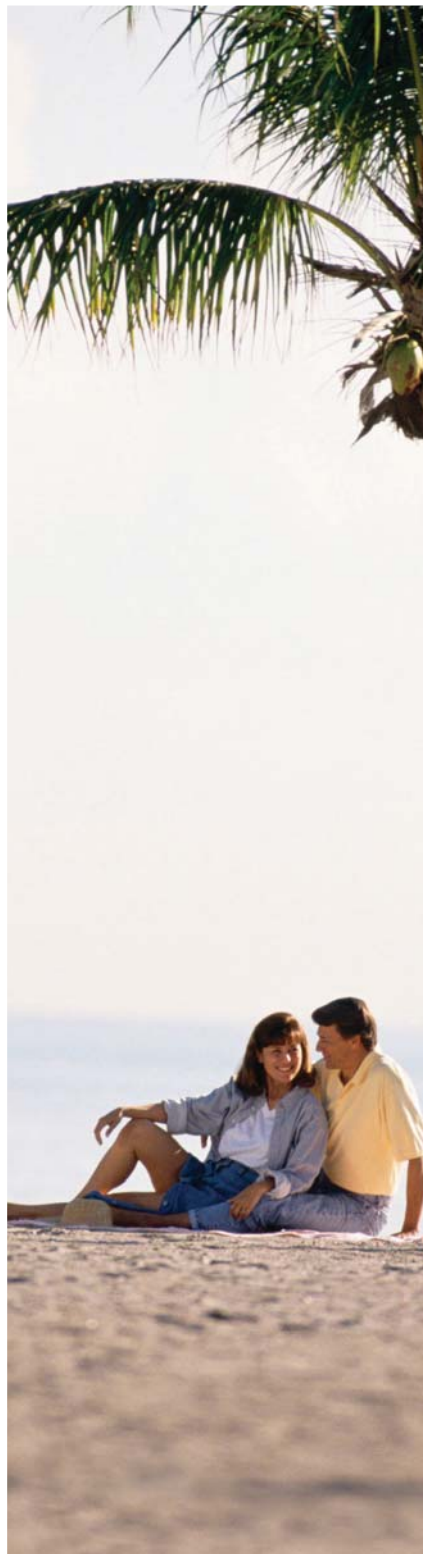

## THERE'S NO TIPPING REQUIRED.

It's easy to mistake the bedroom for a hotel suite. All the hallmarks are here: the posh décor, pampering conveniences and spacious layout. In fact, the 30" bedroom slide-out delivers more room than ever before. Reading in bed by luminous halogen lighting, you may feel as if you're staying in a grand hotel. But then you remember – you haven't had to unpack and repack at every stop on your trip.

### Passion



We're truly passionate about the RV lifestyle. Fleetwood was founded by RV enthusiasts, and that tradition continues today.



EXCURSION



**The Bathroom** provides a lavish setting to get ready for the day. Start off with a water massage from the adjustable showerhead. Rinse your razor under the sparkling Moen® faucet gracing the solid surface countertop. The cabinetry holds your cosmetics and grooming supplies, with vanity lighting and mirror to help you look your best.



**The Washer/Dryer Combo** (optional) performs double duty, washing and drying your clothes while you roll down the highway. It's hidden away behind handsome cabinetry.





**The Bedroom Entertainment Center** brings your favorite shows to your bedside with a wall-mounted 26" Samsung® LCD HDTV and DVD player. Below sits the handsome dresser, providing first-class accommodations for your linens.



**The Cedar-Lined Wardrobe** keeps your clothing well organized and wrinkle-free. Heading out for a night at the theater? Double-check your appearance in the full-length mirrors, then give yourself a standing ovation!



**The Bedroom Suite** includes a heavenly Restonic® queen-size pillowtop innerspring mattress. Before you nod off, flick the bedside switch to turn the generator off. In the morning, your first step is onto the plush Fabrica™ carpeting. Even your feet feel pampered.

**The Adjustable Sleep Number® Air Mattress** (optional) ends pillow-fights. You like the mattress soft, and your other half likes it firm? No problem, just customize each side independently with the remote at your bedside. (King size optional in 40Q and 40T models.)







## THIS FIVE-STAR RESORT HAS 360 HORSEPOWER.

No matter how ritzy, a hotel simply can't travel with you. Yet Excursion can. You'll enjoy trips through picturesque landscapes, crystal clear behind your expansive, one-piece windshield. The rolling hills slide by effortlessly, thanks to 360 horses under your foot.

**Power Visors** cut the sun's glare with the touch of a button, allowing you to make adjustments with precision. And when it's time for privacy, the visors extend all the way to the dash to close out the world.



**The Ultraleather™ Driver and Passenger Seats** feature sleek lines and designer style with supple Ultraleather™ covering. But their real beauty is inside. They've been engineered to reduce fatigue during those long hours on the road with a Flexsteel® frame and adjustable armrests. The seats are heated to keep you cozy in the cold, and the passenger seat includes a power footrest.







The **Cockpit Area** wraps around you to deliver a superior driving experience. The VIP steering wheel tilts and telescopes to suit your frame and features several key controls for added convenience. The drive flies by with an AM/FM radio with CD player and it's Sirius Satellite Radio® ready.



The **360HP Cummins® ISC 8.3L Engine** powerfully pushes you over hills and through valleys with 1050 foot pounds of torque. It also has the muscle to tow a vehicle behind you for touring the nearby town.



**Keyless Remote Entry** lets you lock and unlock your Excursion with the push of a button. It also turns a light on in the coach to help you see in the dark.



The **Ergonomically Designed Instrument Panel** places all the controls at your fingertips. The large, backlit gauges are easy to read at a glance, even at night. And the Information Center continuously monitors your coach's performance on the road and even provides a pre-trip checklist for added safety.



The **Pioneer® Color Back-Up Monitor/Navigation System** features rear and side cameras that allow you to check your towed vehicle and view behind it. It also features a satellite ready radio with an iPod® hook up and bluetooth.



## PRESTIGE BY THE FOOT, BEAUTY BY THE MILE.

The sheer size of Excursion is remarkable, but once you look closer, there's even more to appreciate. The ultra-smooth sidewalls, with their highly polished paint, reflect light as if you're looking in a mirror. Excursion's full-body paint is carefully applied using a two-step process and DuPont® paint for maximum durability and undeniable beauty.

Pacific Blue  
Scheme 2\*



Raceway Red  
Scheme 2\*



\* See your Fleetwood dealer or visit our website at [www.fleetwoodrv.com](http://www.fleetwoodrv.com) to view all graphic and color choices.

 EXCURSION

White Diamond  
Scheme 2\*



Mocha  
Scheme 2\*



Iron  
Scheme 2\*



Twilight  
Scheme 1\*

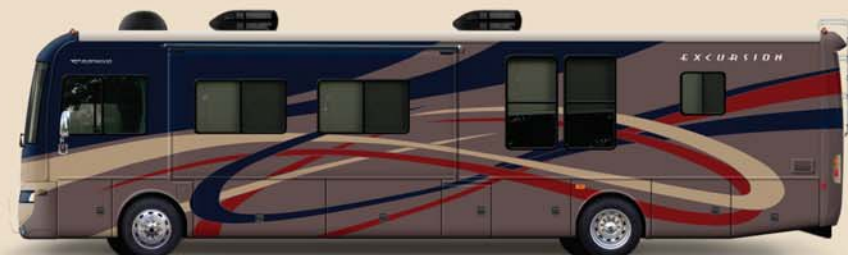



# DAZZLE THEM WITH YOUR DÉCOR.

Friends will be impressed with your sense of style. You don't have to tell them it was as easy as picking one fabric palette and one wood finish. Our designers coordinated everything from the designer lighting to the fabric patterns, but you can pocket the compliments.

## CARBON

Living/Dining Room



Sofa



Dinette Cushions



Ultraleather™  
Driver and Front  
Passenger Seats,  
Sofa (optional)

Bedroom



Bedsread



Pillow Shams



Throw Pillows

## SOUTHERN COMFORT

Living/Dining Room



Sofa



Dinette Cushions

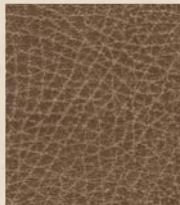

Ultraleather™  
Driver and Front  
Passenger Seats,  
Sofa (optional)

Bedroom



Bedsread



Pillow Shams



Throw Pillows

## CORIANDER

Living/Dining Room



Sofa



Dinette Cushions

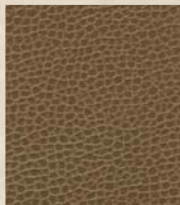

Ultraleather™  
Driver and Front  
Passenger Seats,  
Sofa (optional)

Bedroom



Bedsread



Pillow Shams



Throw Pillows

## WOOD FINISHES



Symphony Cherry



Plantation Cherry



## YOU'VE GOT THE WORLD BY THE TAILLIGHTS.

Excursion owners enjoy a wide range of amenities, even on the outside. Here are just a few of our favorites.

- ① **Electric Awnings** for the patio and entry door provide a shady outdoor area to sip iced tea and enjoy the fresh air. And should the wind kick up when you're out on the links, the main awning will retract, thanks to the wind sensor.
- ② **The Illuminated Entry Handle** glows from within, helping you to see at night and accenting your coach dramatically.
- ③ **Stylish Chrome Heated Mirrors** with side view cameras add sparkling flair, and stay warm to prevent dew or frost build-up for a clearer view.
- ④ **The Front Cap and One-Piece Windshield** exudes sophistication. The raised chrome logos highlight Excursion's status.



Vehicle shown in White Diamond Scheme 2 exterior graphics.

- ① **Dual Air Conditioning Units** are mounted on top to improve cooling, and create more room for storage below.
- ② **Storage Compartments** feature side swinging insulated aluminum doors. You can open the single paddle latches with one hand, and the lighted interiors help you see your gear at night.
- ③ **High-Mounted Taillights** are easy to see, even over towed vehicles, to warn tailgaters away.
- ④ **4-Point Automatic Leveling System** levels your coach at the push of a button.



Vehicle shown in White Diamond Scheme 2 exterior graphics.





**The Side View Cameras** are built right into the mirrors and transmit to the driver's area monitor. The cameras are controlled by the driver to help you see blind spots in the adjacent lanes. Once you're docked, they're handy for extra security.



**The Spotlight** sheds some light on your after-dark beach party. Who needs tiki torches when you can move the spotlight easily with a wireless remote?

**Exterior Grill And Kitchenette** (optional) extends so you can hold a backyard-style barbecue anywhere. Includes a propane grill, refrigerator, sink with hot and cold running water, storage areas, and even outlets for your blender.



**The Utility Compartment** lets you empty the holding tanks from one central place. Made of non-corrosive roto-cast with smooth radius corners it's easy to clean. It also features recessed storage area for gloves, chemicals, and cleaning supplies. Central location includes full coach water filter, water pump, water heater bypass and dual water fills.



**MAKING THE GREAT OUTDOORS EVEN GREATER.**

Whether you're parked next to a sandy beach or a stadium full of fans, Excursion offers additional features to make the outdoors more enjoyable.



# POWER BRIDGE CHASSIS™.

## PART HERCULES, PART EINSTEIN. ALL YOURS.

It's strong. It's smart. And it's here to change the way you travel. Created with your every need in mind, the all-new Power Bridge Chassis brings you sleek engineering, a smooth ride and convenience like you've never imagined. Feast your eyes on storage compartments so big, you'll never have to unpack. Experience balance and handling so incredible, you'll never want the trip to end. With so many surprises built-in to every nook and cranny, it's the soul of the ultimate RV. Harness the power.

**WASTE NOT, WANT NOT.** The Power Bridge Chassis is more than just a well-oiled machine. Every available inch is configured to maximize your storage capacity – so you'll never want for extra space.

**OPEN AS THE ROAD.** Huge and versatile, pass through storage compartments let you pack items side to side, back to front, and even diagonally.

**EASY RIDER.** Offering unparalleled strength, the Power Bridge Chassis has been engineered for an improved ride and handling.

**TURN ON THE WATERWORKS.** With a super-sized fresh water tank, long showers are never in short supply.

**ALL ACCESS PASS.** An ingenious integrated raceway means quick access to electrical wiring and plumbing. This translates into easier maintenance for you.

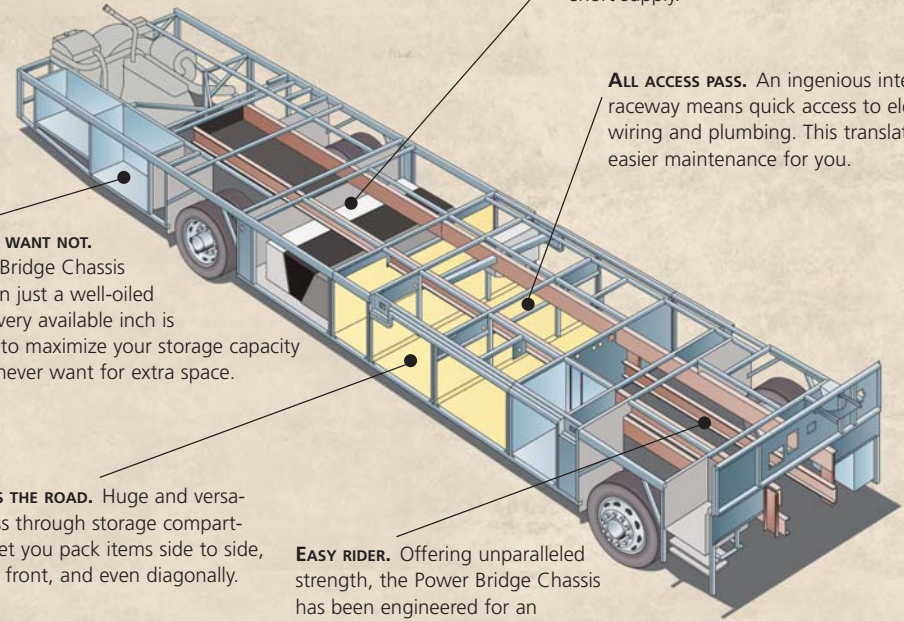

Drawings are for illustrative purposes only to highlight aspects of motor home construction. Actual motor home design depends on model and is subject to change.

† The chassis manufacturer recommends the installation of a supplemental brake control system to activate the brakes on the vehicle or trailer you are towing. Hitch receiver ratings expressed are maximum for the hitch receiver installed and may require the purchase of additional equipment that is dependent on the weight of the towed load. Consult with hitch receiver manufacturer for further information.

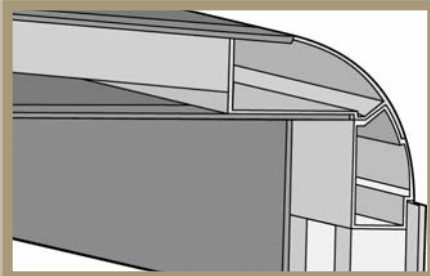

**Interlocking Ceiling-to-Sidewall Construction** helps keep the box square. This assures a proper cabinet fit.

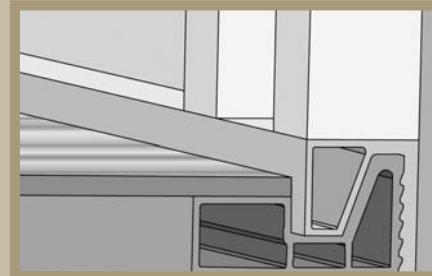

**Interlocking Floor-to-Sidewall Construction** locks tightly to keep out water, dust and noise, and helps eliminate squeaks and rattles.

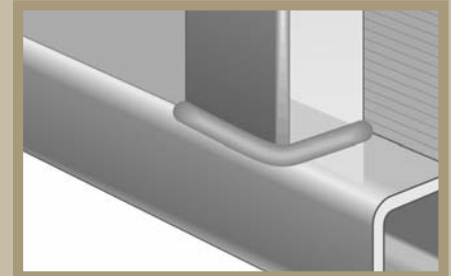

**Vacu-Bond® Sidewall Construction** creates a strong, weather-resistant structure. The sidewalls, floor and ceiling are Vacu-bonded to a durable metal frame, far superior to the pinch roll method our competitors often use.





**Patio Storage Center** provides a place for your patio set-up tools or BBQ utensils. The storage center is equipped with both a 12V and 120V plug to recharge your flashlights or charge up that remote controlled car.



**Pass-Through Storage** is new on Excursion for 2009. This big space holds chairs, sports gear and more – and you can access it from either side of the coach.



**The Pull-Out Tray** (optional) keeps your smaller items together so they don't get scattered. It's a great place to stock your extra refreshments before they move to the refrigerator.



## THE MOST IMPORTANT FEATURE IN EXCURSION: PEACE OF MIND.

Fleetwood engineers have designed dozens of safety features into Excursion, from blind-spot cameras to help you change lanes safely, to the safety inspection checklist on the information center monitor, to the four-wheel ABS air brakes. We're proud to say we meet all Federal Motor Home Vehicle Safety Standards for your protection. Combined with Fleetwood's superior construction, the result is a coach you can depend on for high quality and safety.

### Safety



You've got precious cargo. So we've engineered dozens of innovative safety features into our motor homes to give you more peace of mind.



EXCURSION



# EXCURSION FLOOR PLANS

## 39R

### Full-Wall Slide, Triple Slide-Out

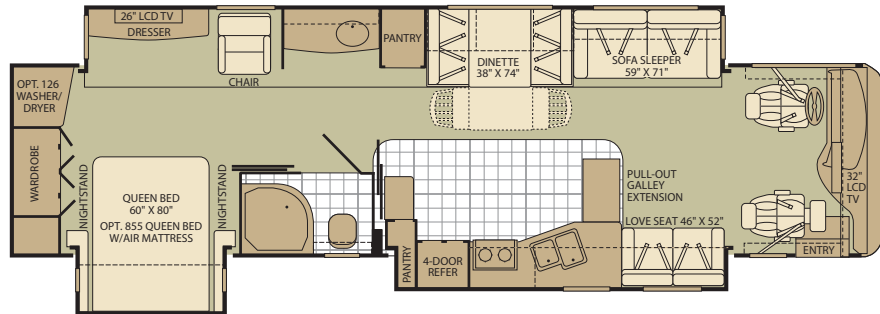

Interior Storage Capacity: 187 cu. ft.  
Exterior Storage Capacity: 203 cu. ft.

- Industry leading full-wall slide with opposing slide in the living room
- Residential dresser in the bedroom with multiple drawers
- Available Options: 126, 128, 495, 821, 832, 833, 855, 874

## 40E

### Triple Slide-Out

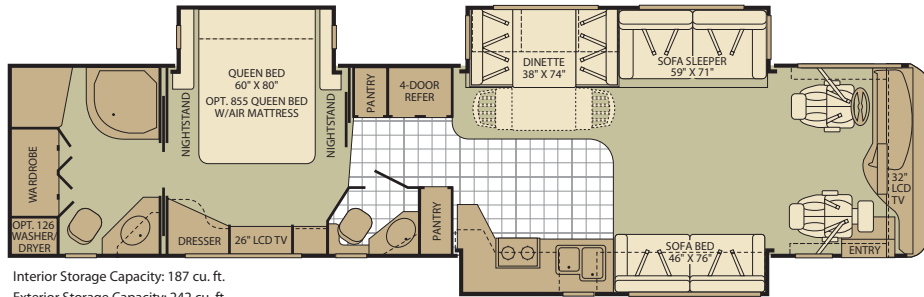

Interior Storage Capacity: 187 cu. ft.  
Exterior Storage Capacity: 242 cu. ft.

- Unique in class rear bath, bath and a half layout
- Seating for up to 14 people in the living and dining room
- Available Options: 126, 128, 495, 832, 833, 855

## 40Q

### Full-Wall Slide, Double Slide-Out

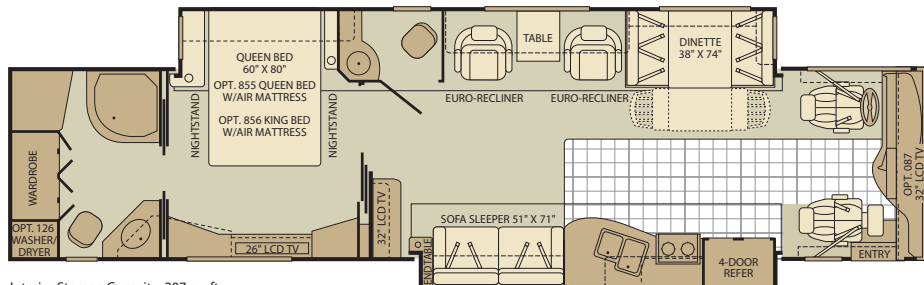

Interior Storage Capacity: 207 cu. ft.  
Exterior Storage Capacity: 242 cu. ft.

- Industry leading mid-coach home theater floor plan
- Industry leading full-wide slide provides expansive space
- Available Options: 87, 126, 128, 174, 495, 635, 832, 833, 855, 856



## 40T

### Full-Wall Slide, Triple Slide-Out

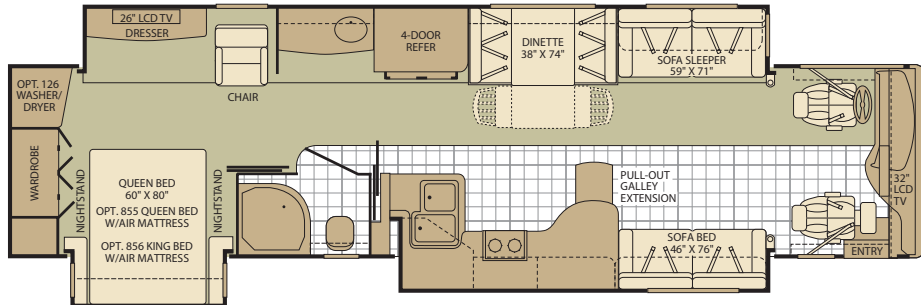

Interior Storage Capacity: 197 cu. ft.  
 Exterior Storage Capacity: 242 cu. ft.

- Industry leading full-wall slide floor plan
- Large counter space for functional entertaining
- Available Options: 126, 128, 142, 495, 832, 833, 855, 856

## 40X

### Triple Slide-Out

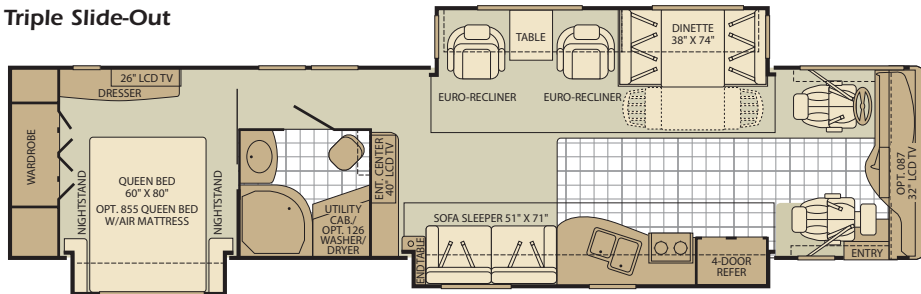

Interior Storage Capacity: 195 cu. ft.  
 Exterior Storage Capacity: 242 cu. ft.

- Industry leading mid-coach home theater floor plan
- Side aisle bathroom for maximum privacy and space
- Available Options: 87, 126, 128, 174, 495, 635, 832, 833, 855

## Service



Help is nearby. When you need an upgrade or repair, you'll find Fleetwood dealers all across North America ready to assist you.

Seatbelt configuration may vary depending on options chosen.

## OPTIONS

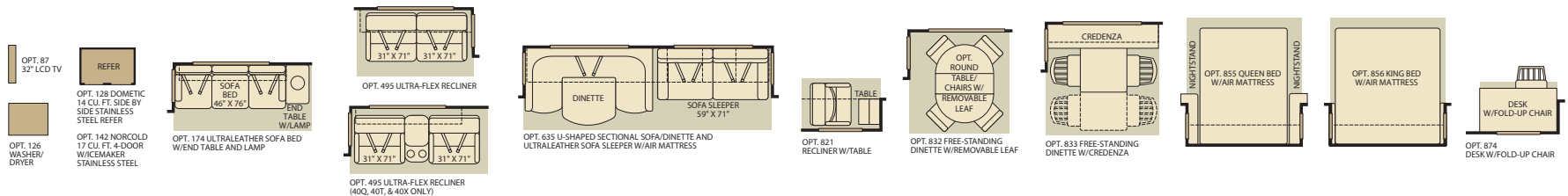



## STANDARD FEATURES

### INTERIOR

#### INTERIOR - THROUGHOUT

- 10 Gallon, w/16 Gallon, Output Quick Recovery Water Heater w/Direct Spark Ignition (Gas/Electric)
- 20,000/30,000 Btu Dual Furnaces
- 84" Interior Ceiling Height
- Complete TuffPEX Plumbing System
- Crown Molding w/Decorative Corner Caps
- Deluxe Day/Night Roller Blinds
- Deluxe Roller Bearing, Full Extension Drawer Guides and Transit-Ship Locks
- Demand Water Pump w/Filter
- Dual Roof Mounted A/C High Efficiency, Chill Grill w/Solar Panel and on Front A/C
- Solid Wood Face Frame Cabinets
- Hardwood Cabinet Doors/Drawers
- Plush Carpet w/Carpet Pad
- Solid Surface Countertops and Sink Covers
- Vinyl Padded Ceiling
- Wall Switches (Includes Switches for Ceiling Lights and Vents)
- Water Heater Bypass
- Whole Coach Water Filtration System
- Wood Finish Return Air Intake for Furnace
- Laminate Flooring Entry to Galley
- Central Vacuum System

#### DRIVER CONVENIENCE

- Adjustable 3 Point Seat Belts at Driver and Front Passenger Seats (with adjustable shoulder straps)
- Pioneer® AM/FM/CD Stereo w/Navigation, Sirius Satellite Radio® Ready
- Color Back-Up Monitor w/Side Cameras Integrated in Mirrors
- Auxiliary Start Circuit
- Backlit Switches and Gauges
- Battery Disconnect System
- CB Radio Ready
- Cruise Control
- Driver/Passenger Powered Side Shades
- Driver/Front Passenger Ultraleather™ Captain's Chairs w/Reclining Back/Slide Controls/Power/Heated/Adjustable Arms
- Denso® High-Output Auto A/C Heater Combo
- Passenger Armrest w/Integrated Magazine Rack
- Passenger Seat w/Power Footrest & Adjustable Armrest
- Power Driver/Front Passenger Sun Visors
- Radio Switch Main/Auxiliary Power
- Soft Surface Automotive Dash
- Smart Wheel with Tilt/Telescoping Steering Wheel

#### GALLEY

- 1.4 cu.ft. Convection Microwave Oven w/Stainless Steel Front
- Norcold® 12 cu.ft. 4 Door Stainless Steel Refrigerator w/Ice Maker and Water Dispenser
- 2 Burner, High-Output Electric Flat Panel Cook Top
- Adjustable Cabinet Shelves (Select Cabinets)
- Fan-Tastic® Power Roof Vent w/Wall Switch
- Laminate Floor Tile
- Large, Double Stainless Steel Sink
- Single Lever Galley Faucet w/Pullout Sprayer
- Six Person Pull-Out Dinette Table (Select Models)

- Slide-Out Dinette Bins w/Latches
- Soap and Lotion Dispensers (Select Models)
- Under Galley Shelving and Wastebasket
- Window Over Sink (Select Models)

#### LIVING ROOM

- Samsung® 32" LCD HDTV (40" on the 40X Model)
- DSS/Mobil Auto Tracking Satellite Dish (Covered)
- Samsung® DVD Home Theater Sound System w/Hidden Surround Sound Speakers
- Accent/Night Lighting in Overhead
- Easy Sweep Laminate Flooring Entry to Galley
- Flexsteel® Residential Seat Styling
- TV Antenna w/Signal Booster
- Ultraleather™ Sofa Bed (40E and 40T)
- Ultraleather™ Sofa Sleeper
- Ultraleather™ Love Seat (39R)

#### BEDROOM

- Bedspread w/Decor Pillows
- Cabinet Storage Above the Bed
- Coffered Ceiling
- Mirrored Wardrobe Doors
- Remote Generator Start
- Restonic® Deluxe Pillow Top Innerspring Mattress
- Ventilated Rear Wardrobe w/Cedar Lining, Carpeted Floor and Wire Organizer
- Wardrobe Lighting
- Bedroom Entertainment Center w/Samsung® 26" LCD HDTV and DVD Player

#### BATHROOM

- Cabinet Toe Kicks
- Coordinated Bath Accessories
- Fan-Tastic® Power Roof Vent w/Wall Switch
- Hardwood Bath Door/Trims
- Laminate Floor Tile
- Lighted Assist Handle
- Molded Shower Enclosure w/Skylight
- Porcelain Toilet w/Water Saver
- Stainless Steel Sink

#### SAFETY/CONVENIENCE

- Carbon Monoxide Detector/Alarm
- Energy Management System (EMS) w/Soft Start
- Fire Extinguisher
- Multiple Seatbelt Locations
- Propane Detector/Alarm
- Smoke Detector/Alarm
- Neutral Loss, Low and High Voltage Protection

### EXTERIOR

#### EXTERIOR - THROUGHOUT

- 120V/12V AC/DC Converter
- 120V/12V Wire Raceways
- 2000 Watt Pure Sine Wave Inverter w/Remote
- 4 Point Automatic Levelers
- 50 Amp Service
- 8.0 kW Onan® Quiet Diesel Generator
- Awning Rail/Drip Molding (Both Sides)
- Dual Battery Charge Control
- Dual Pane Windows w/Screens
- Fiberglass Front Quarter Panels
- Side Swinging Luggage Doors
- Fiberglass Front/Rear Caps w/High Mounted Taillights
- Fiberglass Wheel Well Trims

- Full-Body Paint
- Remote/Heated Rear View Chrome Mirrors w/Side View Cameras
- Utility Compartment w/Exterior Shower
- Water Pump Switch (Multiple Locations)
- Weather Pro Power Awnings (Patio Awning Includes Wind Sensor)
- Front and Mid Coach Docking Lights

#### AUTOMOTIVE

- 10,000 lb. Weight Distributing Hitch Receiver w/7 Pin Electrical Hook-Up<sup>1</sup>
- 360HP Cummins® ISC 8.3L Engine
- Aluminum Wheels
- Dual Fuel Fill (One on Each Side)
- Fog Lamps
- Freightliner® Chassis
- Large One-Piece Bonded-in Windshield
- Mud Flaps
- Color Rear and Side Vision Cameras w/Monitor in Radio
- Single Motor Diesel Equipment Windshield Wipers w/Wet Arm
- Tire Valve Extenders
- Underhood Utility Light
- Chrome Spotlight w/Remote Control

#### SAFETY/CONVENIENCE

- 4 Wheel ABS Air Brakes
- 20' Sewer Hose
- Automotive Safety Glass
- Central Electrical Panel
- Dual Fresh Water Fills
- Daytime Running Lights
- Doorside Patio Receptacle
- Entry Door w/Screen Door and Deadbolt Lock
- Four 6V/Deep Cycle House Batteries
- Keyless Entry Remote
- Lighted Entry Assist Handle
- Park Cable Receptacle
- Dual Porch Lights (Doorside)
- Power Entry Step
- Roof Ladder
- Toilet Tank San-T-Flush™ System
- Touch Sensor Tank Monitoring System

#### STORAGE

- Continuous One-Piece Compartment Bulb Seal
- Hidden, Stainless Steel Latch Rods
- Insulated Aluminum Luggage Doors w/Single Paddle Metal Latches and Stainless Steel Hinges
- Lighted Luggage Compartments
- Pass Through Storage
- Side Swinging Luggage Doors

#### BODY STRUCTURE

- Aluminum Interlocking Floor/Wall/Ceiling Framing
- Color Coordinated Royal Tuff-Ply Roof
- Heated Water and Holding Tank Compartments
- Royal Tuff-Ply Radius Roof w/Ducted A/C
- Vacu-bond® Upper/Lower Floors
- Full-Wall Slide (Patent Pending)
- Power Bridge Chassis™ (Fleetwood Exclusive)

## OPTIONS

### INTERIOR

- Automatic Generator Start System
- CSA Package (Canadian Specs)\*\*
- Heat Pumps
- Washer/Dryer

### GALLEY

- 14 cu.ft. Dometic® Stainless Steel Frost-Free Refrigerator
- Free-Standing Dinette w/Credenza
- Free-Standing Table and Chairs
- 17 cu.ft. Norcold® 4 Door Refrigerator w/Ice Maker and Water Dispenser in Door (40T)

### LIVING ROOM

- Samsung® 32" LCD HDTV in Front Overhead (40Q and 40X Only)
- Ultraleather™ Sofa Sleeper w/Air Mattress
- Leather Euro Recliner Free-Standing (Select Models)
- Desk (39R)

### BEDROOM

- Queen Adjustable Air Mattress
- King Adjustable Air Mattress (40Q and 40T)

### EXTERIOR

- Entertainment Center w/Samsung® 32" LCD HDTV and Stereo
- Diamond Shield Clear Front Protective Mask
- Exterior Grill and Kitchenette
- Window Awning Package

## FLEETWOOD ADVANTAGES

- **Power Bridge Chassis™ (Fleetwood Exclusive)**
- **Vacu-bond® Walls w/Smooth High Gloss Exterior Tuff-Coat® Fiberglass**
- **Large One-Piece Bonded-in Windshield**
- **Pass Through Storage**
- **Side Swinging Luggage Doors**
- **84" Interior Ceiling Height**
- **Neutral Loss, Low and High Voltage Protection**

\*\*CSA standards may require substitution or deletion to achieve conformance.



## WEIGHTS AND MEASUREMENTS

### FREIGHTLINER® CHASSIS

MODELS	39R	40E	40Q	40T	40X
Engine Displacement (Liters)	8.3	8.3	8.3	8.3	8.3
Wheelbase (Inches)	252"	276"	276"	276"	276"
GVWR (lbs) <sup>1</sup>	32,000	32,000	32,000	32,000	32,000
Front GAWR (lbs) <sup>2</sup>	12,000	12,000	12,000	12,000	12,000
Rear GAWR (lbs) <sup>2</sup>	20,000	20,000	20,000	20,000	20,000
GCWR (lbs) <sup>3</sup>	42,000	42,000	42,000	42,000	42,000
Hitch Rating Weight (lbs) <sup>4</sup>	10,000	10,000	10,000	10,000	10,000
Tongue Weight (lbs) <sup>4</sup>	1,000	1,000	1,000	1,000	1,000
Fuel Capacity (gal)	100	100	100	100	100

### DIMENSIONS & CAPACITIES

MODELS	39R	40E	40Q	40T	40X
Overall Length <sup>4</sup>	39' 6"	41' 6"	41' 6"	41' 6"	41' 6"
Overall Height (with A/C)	12' 10"	12' 10"	12' 10"	12' 10"	12' 10"
Overall Width (maximum) <sup>5,6</sup>	102"	102"	102"	102"	102"
Interior Height (maximum)	84"	84"	84"	84"	84"
Interior Width (maximum)	96"	96"	96"	96"	96"
Fresh Water Holding Tank (gal)	100	100	100	100	100
Grey Water Holding Tank (gal)	75	75	75	75	75
Black Water Holding Tank (gal)	50	50	50	50	50
Appliance Propane Tank (gal) (WC) <sup>7</sup>	37.5	37.5	37.5	37.5	37.5
Water Heater Tank (gal)	10	10	10	10	10

Liquid Weight Reference: Water (gal) = (8.3 lbs/3.8 kgs) Fuel (gal) = (7.1 lbs/3.2 kgs) Propane (gal) = (4.2 lbs/1.9 kgs)

Metric Conversion: Multiply pounds x 0.453 to obtain kilograms. Multiply gallons x 3.785 to obtain liters. Multiply liters x 61 to obtain cubic inches.

- GVWR (Gross Vehicle Weight Rating) is the maximum permissible weight of this fully loaded motor home. The GVWR is equal to or greater than the sum of the (UVW) unloaded vehicle weight plus (OCCC) occupant and cargo carrying capacity.\*
- GAWR (Gross Axle Weight Rating) is the maximum permissible loaded weight a specific axle is designed to carry.
- GCWR (Gross Combined Weight Rating) is the value specified by the motor home manufacturer as the maximum allowable loaded weight of this motor home with its towed vehicle. Towing and braking capacities may be different. Refer to Fleetwood and chassis manufacturer's manuals for complete information.
- Length is measured from front bumper to rear bumper (excludes accessories).
- Excludes safety equipment and awnings.
- Motor homes feature a body-width over 96" which will restrict your access to certain roads. Before purchasing, you should research any state and/or province road laws which may affect your usage.
- Tank manufacturer's listed water capacity (WC). Actual propane capacity is 80% of water listing as required by the safety code.

### CHASSIS

**Model:** Freightliner®

**Engine:** Cummins® ISC 8.3L

**Horsepower:** 360HP

**Torque:** 1050 lbs-ft

**Alternator:** 170 Amp Leece Neville®

**Transmission:** Allison® 3000MH 6-Speed w/Electronic Shifter

### Warranty



Exclusive RV ownercare warranty.  
See your Fleetwood dealer for details.

**EXCURSION™**  
CLASS A DIESEL

† The chassis manufacturer recommends the installation of a supplemental brake control system to activate the brakes on the vehicle or trailer you are towing. Hitch receiver ratings expressed are maximum for the hitch receiver installed and may require the purchase of additional equipment that is dependent on the weight of the towed load. Consult with hitch receiver manufacturer for further information.

N/A = Not available at time of printing.

\*UVW and OCCC are found on the label containing the federal certification tag in each RV.

**IMPORTANT— PLEASE READ:** Product information, photography and illustrations included in this publication were as accurate as possible at the time of printing. For further product information and changes, please visit our website at [www.fleetwoodrv.com](http://www.fleetwoodrv.com) or contact your local Fleetwood dealer. Prices, materials, design and specifications are subject to change without notice. All weights, fuel, liquid capacities and dimensions are approximate. Fleetwood has designed its recreational vehicles to provide a variety of uses for its customers. Each vehicle features optimal seating, sleeping, storage and fluid capacities. The user is responsible for selecting the proper combination of loads (i.e. occupants, equipment, fluids, cargo, etc.) to ensure that the vehicle's capacities are not exceeded.



# EXCURSION™

CLASS A DIESEL

## RV OWNERCARE\*

Limited one-year/15,000-mile coach warranty and three-year/50,000-mile structural warranty, whichever occurs first, and it is fully transferable for the first 12 months. RV OWNERCARE is one of the RV industry's most comprehensive programs and includes systems, appliances, components and construction, with no deductible and no service charge. RV OWNERCARE coverage is provided from a company that will be around in the future to service your needs. See your nearest Fleetwood dealer for a full explanation of benefits and restrictions.

## CONTACT US

To locate a dealer near you, visit our website at [www.fleetwoodrv.com](http://www.fleetwoodrv.com) or call 1-800-444-4905. We can also be contacted at Fleetwood Customer Relations, P.O. Box 1007, Decatur, IN 46733.

## FLEETWOOD MOTOR HOME CLUBS

As a Fleetwood owner, you're invited to become a member of several Fleetwood motor home clubs. Becoming a club member is the perfect way to meet other Fleetwood owners who love to travel across America and share in the RV lifestyle. Visit our website at [www.fleetwoodrv.com/owners\\_clubs](http://www.fleetwoodrv.com/owners_clubs) to learn more and join the fun.



YOUR LOCAL FLEETWOOD DEALER IS:

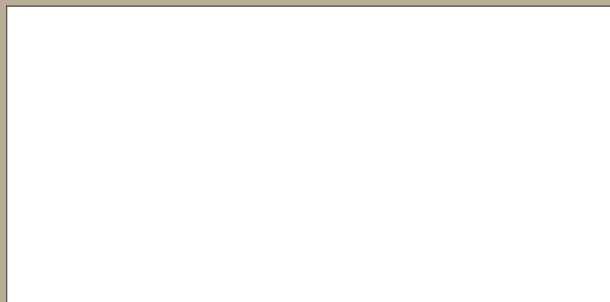

\*For complete info see your Fleetwood dealer.

©2008. Fleetwood Enterprises, Inc.  
Printed in the USA. Inventory Control Number EXC09B2, 11/08.  
Model Year 2009, Second Edition.

## IMPORTANT—PLEASE READ

Product information, photography and illustrations included in this publication were as accurate as possible at the time of printing. For further product information and changes, please visit our website at [www.fleetwoodrv.com](http://www.fleetwoodrv.com) or contact your local Fleetwood dealer. Prices, materials, design and specifications are subject to change without notice. All weights, fuel, liquid capacities and dimensions are approximate. Fleetwood has designed its recreational vehicles to provide a variety of uses for customers. Each vehicle features optimal seating, sleeping, storage and fluid capacities. The user is responsible for selecting the proper combination of loads (i.e. occupants, equipment, fluids, cargo, etc.) to ensure that the vehicle's capacities are not exceeded.

## WHY FLEETWOOD?



### Quality

There's no cutting corners. Skilled craftsmen build every Fleetwood RV for maximum durability and longevity.



### Trust

More people trust Fleetwood. After all, we've spent over 50 years perfecting RVs, earning the loyalty of generations of RVers.



### Passion

We're truly passionate about the RV lifestyle. Fleetwood was founded by RV enthusiasts, and that tradition continues today.



### Safety

You've got precious cargo. So we've engineered dozens of innovative safety features into our motor homes to give you more peace of mind.



### Service

Help is nearby. When you need an upgrade or repair, you'll find Fleetwood dealers all across North America ready to assist you.



### Warranty

Exclusive RV ownercare warranty. See your Fleetwood dealer for details.

 **FLEETWOOD**  
Driven to Explore