

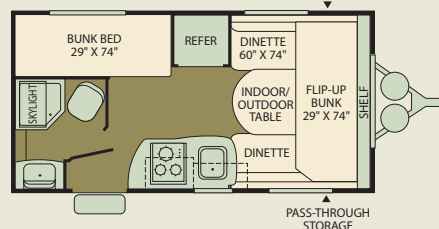

7' WIDE FLOOR PLANS

716FD
Sleeps 4-5*



718FQ
Sleeps 3-4*

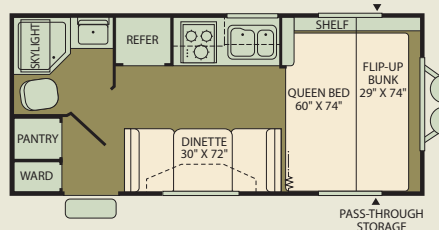

719RB
Sleeps 2-3*

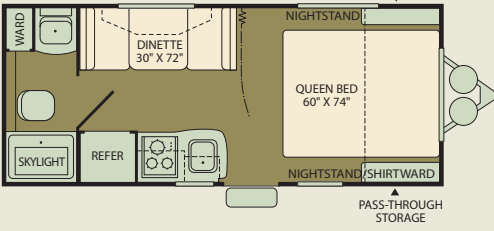

721FBS
Single Slide-Out • Sleeps 4-5*

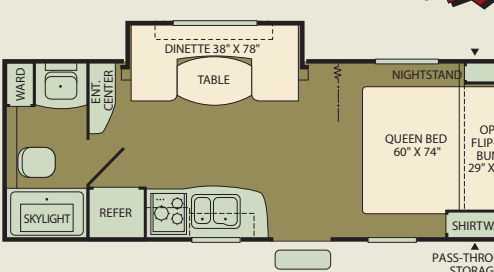

8' WIDE FLOOR PLANS

210RB
Sleeps 4-5*

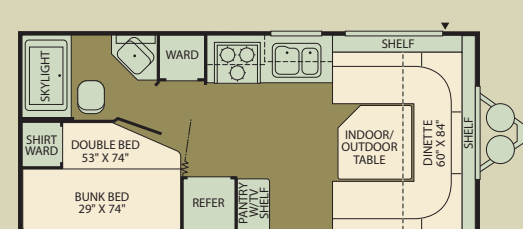

210FQ
Sleeps 3-4*

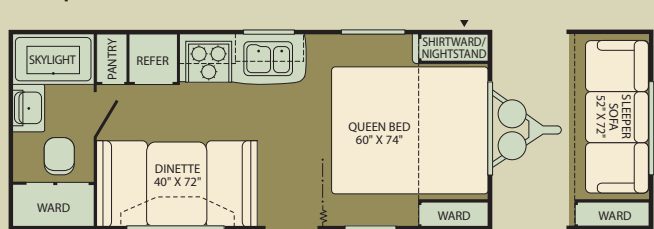

8' WIDE SUPER SLIDE FLOOR PLANS

230RSS
Single Slide-Out • Sleeps 8* **NEW FLOOR PLAN**

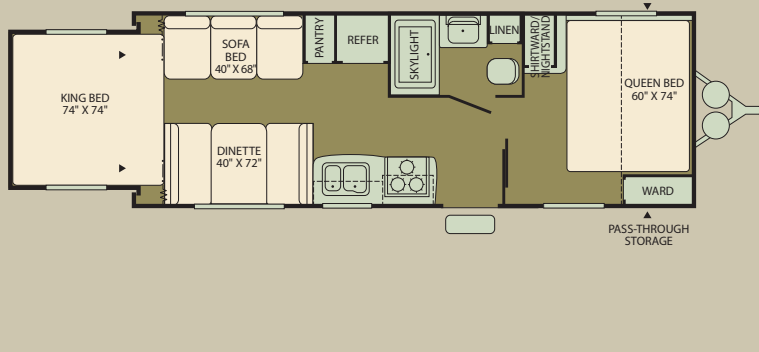

240RBSS
Single Slide-Out • Sleeps 5-6* **NEW FLOOR PLAN**

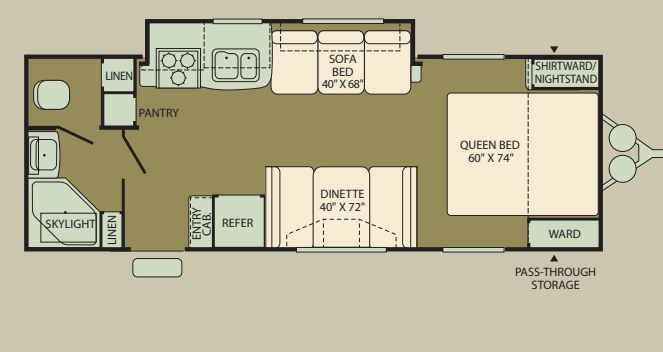

250RSS
Double Slide-Out • Sleeps 9* **NEW FLOOR PLAN**

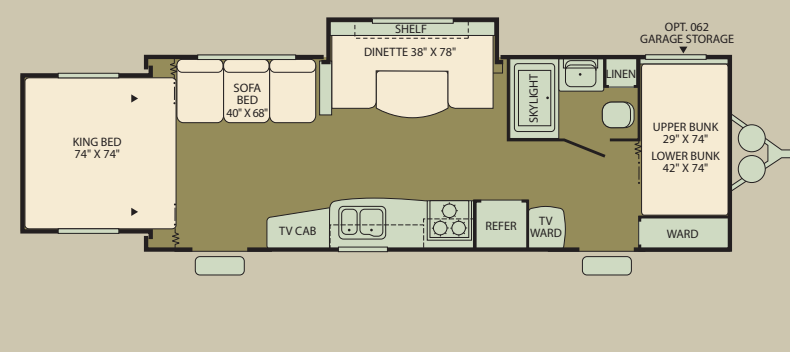

260RKSS
Single Slide-Out • Sleeps 5-6* **NEW FLOOR PLAN**

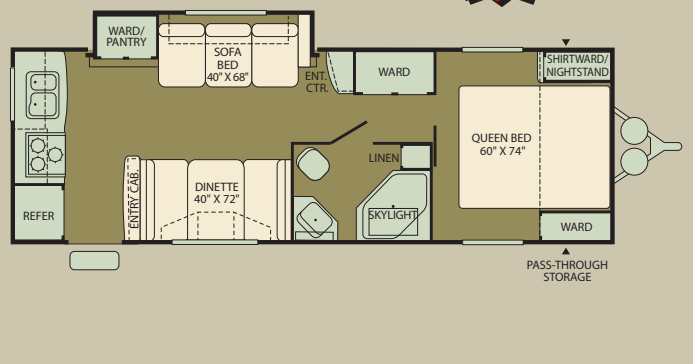

280BHSS
Single Slide-Out • Sleeps 7-8* **NEW FLOOR PLAN**

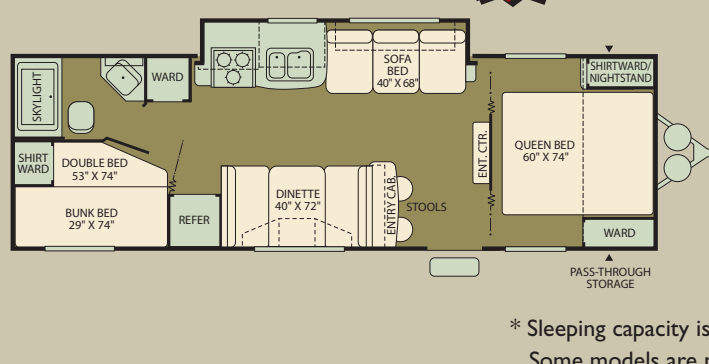

280RLSS
Single Slide-Out • Sleeps 5-6* **NEW FLOOR PLAN**

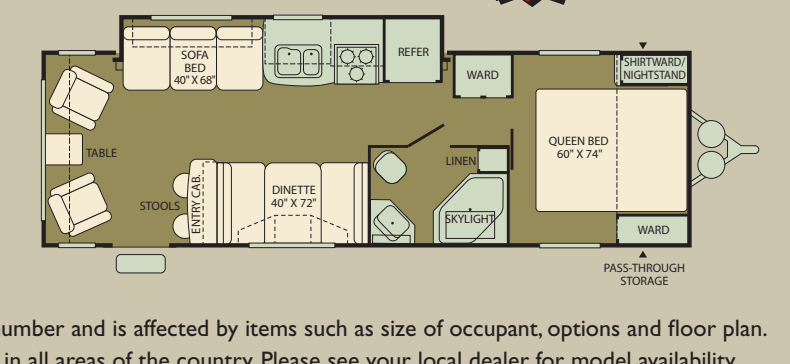

* Sleeping capacity is a variable number and is affected by items such as size of occupant, options and floor plan. Some models are not available in all areas of the country. Please see your local dealer for model availability. Exterior Storage = ▲

WEIGHTS & MEASUREMENTS

WEIGHTS	BACKPACK 7' WIDE				BACKPACK 8' WIDE			BACKPACK 8' WIDE SUPER SLIDE					
	716FD	718FQ	719RB	721FBS	210FQ	210RB	240RKS	230RSS	240RBSS	250RSS	260RKSS	280BHSS	280RLSS
GVWR (lbs) ¹	3,500	3,900	3,950	4,900	5,250	5,200	5,700	N/A	5,900	N/A	6,000	6,300	6,300
Gross Dry Weight (lbs) ^{2,6}	2,405	2,822	2,890	3,558	3,236	3,191	4,263	N/A	N/A	N/A	4,820	4,860	N/A
Cargo Carrying Capacity (lbs) ^{3,6}	1,095	1,078	1,060	1,342	2,014	2,009	1,437	N/A	N/A	N/A	1,180	1,440	N/A
Hitch Dry Weight (lbs) ^{2,6,9}	308	277	424	376	413	392	592	N/A	N/A	N/A	576	612	N/A
DIMENSIONS & CAPACITIES													
Length (Feet & Inches) ^{4,6,8}	16' 10"	18' 10"	19' 11"	23' 0"	23' 4"	22' 4"	26' 5"	27' 3"	27' 10"	28' 3"	28' 11"	30' 8"	30' 10"
Height (Feet & Inches) ^{5,6}	9' 5"	9' 5"	9' 5"	9' 5"	10' 0"	10' 0"	10' 0"	10' 0"	10' 0"	10' 0"	10' 0"	10' 0"	10' 0"
Fresh Water Holding Tank (gal) ^{6,7}	30	30	30	30	30	30	30	30	30	30	30	30	30
Grey Water Holding Tank (gal) ^{6,7}	30	30	30	30	30	30	30/30	30	30	30	30/30	30	30
Black Water Holding Tank (gal) ^{6,7}	20	20	20	20	20	20	30	30	30	30	30	30	30
Propane Capacity (lbs) ^{6,7}	40	40	40	40	40	40	40	40	40	40	40	40	40
Tire Size (Load Range)	ST205/75 14C	ST205/75 14C	ST205/75 14C	ST205/75 14C	ST205/75 14C	ST205/75 14C	ST205/75 14C	ST205/75 14C	ST205/75 14C	ST205/75 14C	ST205/75 14C	ST205/75 14C	ST205/75 14C

- GVWR (Gross Vehicle Weight Rating) is the maximum permissible weight of this trailer when fully loaded. It includes all weight at the trailer axle(s) and tongue or pin.
- All dry weights are based on the standard model and do not include optional features or equipment.
- Cargo Carrying Capacity is determined by subtracting Gross Dry Weight from GVWR. Cargo includes all fluids, optional features, equipment, and personal cargo.
- Length is measured from hitch or pin box to rear bumper (excludes accessories). Trailer length includes hitch; fifth wheel includes standard pin box.
- Actual height may be lower, based on option offerings. Consult with your dealer to obtain actual height for the unit you are interested in.
- Approximate.
- Water weight equals 8.3 lbs per gallon. Propane weight equals 4.2 lbs per gallon.
- Add 10" if equipped with optional spare tire and carrier.
- Hitch weights are dependant upon how the trailer is equipped with options, on-board cargo, and tank fluid levels. Actual hitch weights may be higher or lower than shown. It is recommended that the tow vehicle and hitch for your trailer have sufficient capacity to accommodate the Gross Vehicle Weight Rating of the selected trailer.

N/A = Not available at the time of printing.
 IMPORTANT—PLEASE READ: Product information, photography and illustrations included in this publication were as accurate as possible at the time of printing. For further product information and changes, please visit our website at www.fleetwoodrv.com or contact your local Fleetwood dealer. Prices, materials, design and specifications are subject to change without notice. All weights, fuel, liquid capacities and dimensions are approximate. Fleetwood has designed its recreational vehicles to provide a variety of uses for customers. Each vehicle features optimal seating, sleeping, storage and fluid capacities. The user is responsible for selecting the proper combination of loads (i.e., equipment, fluids, cargo, etc.) to ensure that the vehicle's capacities are not exceeded.

BACKPACK CONSTRUCTION



- ENGINEERED LAMINATED CEILING CONSTRUCTION – Ensures strength and reduced weight.
- ARCTIC WHITE SEAMLESS, ONE-PIECE RUBBER ROOF – Provides the ideal weather seal.
- INTERIOR WALL PANEL – Features a durable, easy-to-clean, decorative vinyl.
- STEEL CHASSIS – Provides optimal strength, durability and performance.
- WOOD DECKING – Provides solid backbone for the roof construction.
- ALUMINUM TUBING – Lightweight, structural studs blend proven framing methods with technologically superior materials.
- HIGH-DENSITY BLOCK FOAM INSULATION – Is custom fit to ensure maximum structural integrity and insulation value.
- SMOOTH GLOSS FIBERGLASS EXTERIOR SIDING – Adds more structural integrity than aluminum siding, provides a glossy surface that is easy-to-clean and adds long lasting beauty.
- LAMINATED PLYWOOD FLOOR – Provides the interior structural strength to the laminated floor construction.
- WOOD SUBSTRATE – Adds structural reinforcement to the exterior fiberglass panel.
- WOOD FLOOR SUBSTRATE – Provides the foundation for the underbelly.
- UNDERBELLY – Is a lightweight seamless, durable, weather barrier.

Drawing is for illustrative purposes only to highlight aspects of Backpack construction. Actual RV design depends on the model and is subject to change.

INTERIOR DÉCOR CHOICES



BACKPACK FEATURES

- | STANDARD | SUPER SLIDE |
|---|---|
| INTERIOR THROUGHOUT <ul style="list-style-type: none"> 6 Gallon Propane Water Heater Under Cabinet Mount AM/FM/CD Player w/Jack for MP3 Player - 4 Speakers Cable TV Hook-Up Hard Valve Window Treatment Throughout Hardwood Mortise & Tenon Cabinet Doors Hydro Flame® Direct Spark Ignition - Furnace w/Thermostat Mini-Blinds Throughout, Except Bunk Windows No Wax Vinyl Flooring Wired for Air Conditioner, TV Antenna & Stereo Water Heater Bypass LIVING ROOM <ul style="list-style-type: none"> 5" Thick Reversible Dinette Cushions Indoor/Outdoor Table (Select Models) Jackknife Sofa Bed (Select Models) Decorative Front Wall Mounted Lights Roof Vent GALLEY <ul style="list-style-type: none"> 3 Burner Cook Top w/16" Oven (8' Wide Models) 3 Burner Cook Top (7' Wide Models) Propane/Electric Refrigerator Acrylic Sink w/Stainless Steel Finish Durable, Removable, Easy to Clean Storage Drawer Bins High Rise Chrome Faucet Microwave Range Hood w/12V Light and Exhaust Fan BEDROOM <ul style="list-style-type: none"> Bedroom Divider Privacy Curtains Bunk Beds (Select Models) | <ul style="list-style-type: none"> Molded Propane Cover Molded Rain Gutters w/Drip Spouts Patio Light Seamless, One-Piece Rubber Roof Sewer Hose Compartment w/Door Single Piece Polyethylene Rotocast Waste & Water Tanks Smooth Fiberglass Siding Spare Tire & Carrier Stabilizer Jacks (4) Sub-Floor Fresh Water Holding Tank (Larger Models) E-Z Lube® Hubs TV Antenna Welded Aluminum Laminated Sidewalls, Floors, Fronts & Rear COMFORT PACKAGE <ul style="list-style-type: none"> 13,500 Btu Air Conditioner Living Room Throw Pillows (Sofa Bed Models) Day/Night Shades - Living Room (8' Wide Models) Night Shades - Bedroom (8' Wide Models) Atwood 6 gal. High Efficiency Gas/Electric Water Heater w/Maximum Recovery Rate of 17.8 gal. per hr. CONVENIENCE PACKAGE <ul style="list-style-type: none"> Large Bath Skylight 6 cu. ft. Double Door Refrigerator (8' Wide Models) Range Cover Sink Lid LED Taillights Protective Chrome Diamond Plating |
| SAFETY/CONVENIENCE <ul style="list-style-type: none"> 120V GFI Circuit Protection (Galley/Bath/Patio) Fire Extinguisher On Demand Water Pump Wall Mounted Systems Monitor Panel 10" Electric Brakes Carbon Monoxide Detector/Alarm Propane Detector/Alarm Smoke Detector/Alarm EXTERIOR THROUGHOUT <ul style="list-style-type: none"> Aluminum Wheels (7' Wide Models) Automotive D-Seal at Windows Awning Black Framed Radius Tinted Safety Glass Windows Dual 20 lb. Propane Tanks Exterior Shower (8' Wide Models) Exterior Marine Grade Speakers (7' Wide Models) Hitch Light (8' Wide Models) Lightweight, Soft-Riding, Rugged, Automotive-Style Steel Leaf Spring Suspension | <ul style="list-style-type: none"> Fully Enclosed Underbelly Painted Lower Body Skirting Large Lend-a-Hand Entry Assist Handle Joy-Ride Rubberized Suspension Raised Panel Upper Cabinet Doors Wood Drawer Boxes Porcelain Toilet w/Foot Pedal Deluxe Full Extension Galley Drawer Guides Crowned Steel Stamped Ceiling Truss In-Ceiling Ducted A/C 19" LCD TV Welded 4" Steel Tube Bumper OPTIONS <ul style="list-style-type: none"> INTERIOR THROUGHOUT <ul style="list-style-type: none"> 19" LCD TV w/DVD Glass Shower Enclosure (8' Wide Models) Overhead Combo Bunk (7' Wide Models) Sleeper Sofa (210FQ) GALLEY <ul style="list-style-type: none"> 6-Panel Deluxe Refrigerator Insert Panel (8' Wide Models) Stainless Steel Appliances EXTERIOR THROUGHOUT <ul style="list-style-type: none"> Aluminum Wheels (8' Wide Models) Double Entry Step (Select Models) Exterior Garage Storage Compartment (8' Wide Models) Marine Grade Speakers (8' Wide Models) Upgrade Radial Tires |

Fresh air. Sweeping vistas. Pristine beauty. There's nothing like being outdoors—except maybe kicking back inside your Backpack after a full day of hiking, fishing, kayaking or whatever sets your spirit free. That's because we've filled your Backpack with all your favorite features, and the room to enjoy them. Yet it's amazingly light. Go ahead, try the Backpack on for size. We think you'll find it's a perfect fit for your lifestyle.

With features like these, you'll want to pack it in every weekend.

The **Galley** is definitely not starved for special features. Not with options like stainless steel appliances, 16" oven and deluxe refrigerator to go with standard amenities like an acrylic sink, 3-burner cook top, microwave and easy-to-clean storage bins. Super Slide models feature wood drawers with fully extending drawer guides.



The **Under-Sink Storage** offers handy pull-out baskets that make packing a breeze. Remove the bins, fill them up with goodies, and slide them back. The ample room to stash all your cleaning supplies in your cleaning supplies in case your teenager wants to earn some allowance money. Or not. Super Slide models feature wood drawers with fully extending drawer guides.



The **Dinette** provides a comfortable place to enjoy sandwiches or family game night.



The **Living Room** features seating that is cushy and stylish, a table big enough for family meals, and residential-quality finishing touches.



Backpack 721FBS shown in Cyberspace Cafe interior with Plantation Cherry wood finish.

The **Master Bedroom** is the perfect place to nest down and recharge for another day in paradise. Of course, when you've got a bed this comfy, what's the hurry? The wilderness isn't going anywhere.



The **Bathroom** has the comforts of home. After all, this is one place you don't want to rough it.



The **19" LCD TV with DVD Player** (optional) is for when you want a different kind of breathtaking view. This feature comes standard on Super Slide models.



BACKPACK

The key to great camping is a light, comfy Backpack.



- All New
- True Ultralight
- Rich Looking Interiors
- 7' Wide & 8' Wide Models
- Laminated Aluminum Construction

2009 BACKPACK

The exterior graphics shown are not available in all locations. To see which exterior graphics are available in your area, please visit your local Fleetwood dealer.



WHY BACKPACK?

- QUALITY** There's no cutting corners. Skilled craftsmen build every Fleetwood RV for maximum durability and longevity.
- WARRANTY** Exclusive RV Ownerscare warranty. See your Fleetwood dealer for details.
- PASSION** We're truly passionate about the RV lifestyle. Fleetwood was founded by RV enthusiasts, and that tradition continues today.
- SERVICE** Help is nearby. When you need an upgrade or repair, you'll find Fleetwood dealers all across North America to assist you.
- TRUST** More people trust Fleetwood. After all, we've spent over 50 years perfecting RVs, earning the loyalty of generations of RVers.

CONTACT US
To locate a dealer near you, visit our website at www.fleetwoodrv.com or call 1-800-444-4905. We can also be contacted at Fleetwood Customer Relations, P.O. Box 1007, Decatur, IN 46733.

FLEETWOOD TRAVELCADE CLUB
As a Fleetwood owner, you're invited to become a member of the Fleetwood Travelcade Club. It's the perfect way to meet other Fleetwood owners who love to travel across America and share in the RV lifestyle. Visit our website at www.fleetwoodrv.com/owners_clubs to learn more and join the fun.

RV OWNERCARE
See your local dealer for complete details.

IMPORTANT—PLEASE READ
Product information, photography and illustrations included in this publication were as accurate as possible at the time of printing. For further product information and changes, please visit our website at www.fleetwoodrv.com or contact your local Fleetwood dealer. Prices, materials, design and specifications are subject to change without notice. All weights, fuel, liquid capacities and dimensions are approximate. Fleetwood has designed its recreational vehicles to provide a variety of uses for customers. Each vehicle features optimal seating, sleeping, storage and fluid capacities. The user is responsible for selecting the proper combination of loads (i.e.: equipment, fluids, cargo, etc.) to ensure that the vehicle's capacities are not exceeded.

Your Local Fleetwood Dealer is:

To Our Customers...
To make sure that you get the maximum satisfaction out of your recreational vehicle purchase, there are several things you should know:

1. Learn all you can about the travel trailer or fifth wheel you're planning to buy. Don't rely on word of mouth. Get the facts about the actual trailer length, width, unloaded weight with options, Gross Vehicle Weight Rating, and Cargo Carrying Capacity. These are usually available in the manufacturer's sales literature or from the Cargo Carrying Capacity Label located in each trailer. Be sure to check this information before you decide which unit to buy.
2. Verify the towing capacity of your tow vehicle. If you don't know, or aren't sure, you can ask at your automotive dealership or contact your tow vehicle manufacturer. Be sure to match your tow vehicle's tow rating to the Gross Vehicle Weight Rating (not dry weight) of the trailer you are considering. To help Fleetwood travel trailer customers estimate this total weight, our Gross Vehicle Weight Ratings reflect the maximum weight of the trailer when fully loaded for camping. Be sure the weight of the tow vehicle plus the Gross Vehicle Weight of your trailer does not exceed the Gross Combined Weight Rating (GCWR) of the tow vehicle.

Taking these simple steps before you buy will help ensure that your trailer and tow vehicle combination is just what you wanted. See you on the trail!