

Mallard Sport and Mallard

WHY DID THE MALLARD CROSS THE COUNTRY? BECAUSE IT CAN.

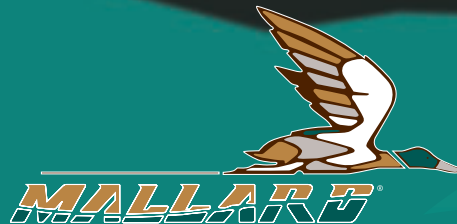

Travel Trailers
and Fifth Wheels



Built-in Value | Quality | Functional Floor Plans | Appealing Décors | Enclosed & Heated Chassis Available



The Large Refrigerator
features double doors with raised panel inserts, leaving plenty of room for treats.



Mallard 26RLS shown in Meadow interior décor with Clear Oak wood finish.

TAKE FLIGHT. WHILE YOUR GREENBACKS STAY PUT. Get ready to take off into the wild blue yonder. Mallard® and Mallard Sport™ are high-quality, feature-packed travel trailers designed for your whole flock. At the same price you'd expect to pay for a used, second-hand trailer, you can camp in comfort in a brand-new Mallard. So head south – or anywhere the wind blows – in Mallard.



AM/FM Radio with CD Player
(available) provides instant relief from the relentless chorus of "99 Bottles of Beer on the Wall."



Spacious Pantry and TV Shelf
so you can enjoy the Fishing Channel and chips at the same time. (TV not included.)



Double-Bowl Acrylic Sink
makes doing the dishes easier with one side for washing and one for rinsing. The high-rise faucet leaves room for big pots.



The Galley
boasts the finest brand names, with a Dometic® refrigerator, Magic Chef® range and HydroFlame furnace.



The Queen-Size Bed

is situated east to west, so you have more space and it's easier to make the bed. That's something you're unlikely to find in competitors' floor plans. (Select models.)



The Shower/Tub Combo

is perfect for cleaning kids who always seem to soak up a mountain's worth of dirt in a day.

NEST IN COMFORT. Inside Mallard, you'll find appealing décors including nice window treatments, warm cabinetry and cozy Flexsteel® furniture. (Select models.)



Rear Lounge with Window

features two comfy lounge chairs and a handy table next to a big picture window that's perfect for birdwatching. (Select models.)



Under-Bed Storage

is the perfect place to stow extra down comforters.



TESTED TO EXTREMES. PROVEN DURABILITY.

You're going to entrust your vacation days to Mallard, so we've tested the day-lights out of the prototypes. They're exposed to miles of durability testing, and those components that don't survive are redesigned until they do. The end result is a tough trailer you can count on for years to come.



Drawing is for illustrative purposes only to highlight aspects of Mallard construction. Actual RV design depends on model and is subject to change.

1. **ENGINEERED RADIUSED CEILING TRUSS** - Helps to ensure strength and water runoff.
2. **ONE-PIECE SEAMLESS SYNTHETIC RUBBER ROOF** - Provides the ideal weather seal.
3. **INTERIOR WALL PANEL** - Features a durable, easy-to-clean, decorative vinyl.
4. **STEEL CHASSIS** - Provides optimal strength, durability and performance.
5. **WOOD DECKING** - Provides a solid backbone for the roof construction.
6. **2" X 2" WOOD FRAMED SIDEWALL** - Provides a solid foundation for the sidewall construction.
7. **R-7 FIBERGLASS INSULATION** - Helps to ensure interior comfort in every season.
8. **.024" ALUMINUM SIDING** - Complete with a baked-on enamel paint, this aluminum siding offers rigidity while still being affordable.
9. **5/8" TONGUE AND GROOVE DECKING** - Provides structural strength floor construction.
10. **2" X 2" STUDS 16" ON CENTER** - Utilizing residential framing methods, this is the structural component of our front section.
11. **2" X 3" FLOOR JOISTS** - Provides the foundation for the enclosed chassis.
12. **ENCLOSED CHASSIS** - Is a lightweight, durable weather barrier (available).

MALLARD INTERIOR DÉCOR CHOICES

- A Throw Pillow & Dinette Cushions
- B Sofa

- C Bedspread & Headboard
- D Window Treatments

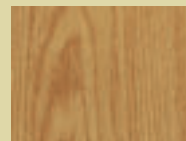

CLEAR OAK



MEADOW

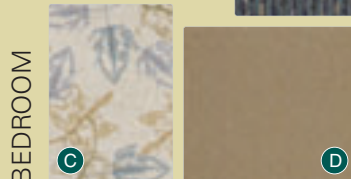
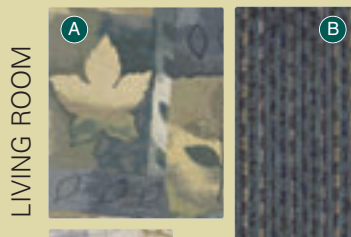

HARVEST

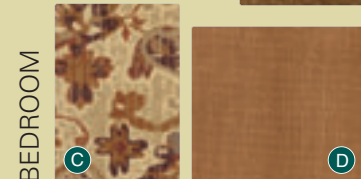
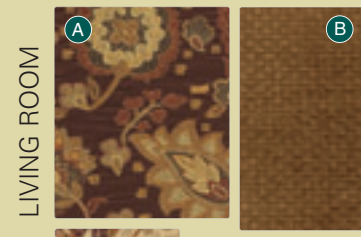

CHESTNUT



The Enclosed Chassis

is available on select Mallard models. No need to migrate to warmer climates. The enclosed chassis allows heating the holding tanks to help prevent freezing in colder weather.



Abundant Cargo Storage

gives you more room for your equipment, toys, and other stuff families need to camp. And it makes loading and unloading a breeze.

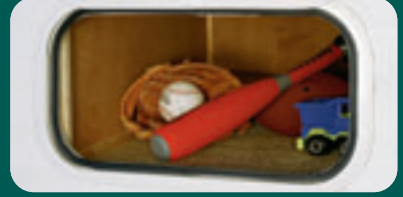

Under-Dinette Storage

is the perfect place to store board games, crafts or toys.

MALLARD SPORT TRAVEL TRAILER FLOOR PLANS

18CK Sleeps 6-7*

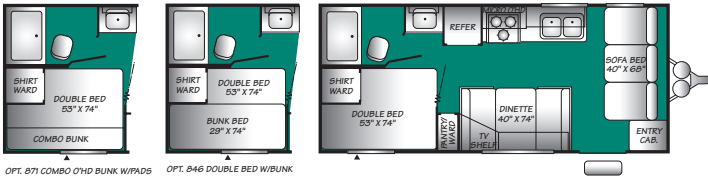

25RL Sleeps 6*

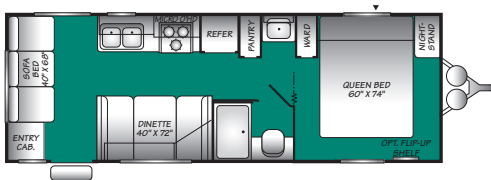

28BH Sleeps 8-9*

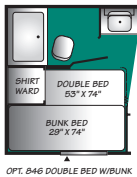
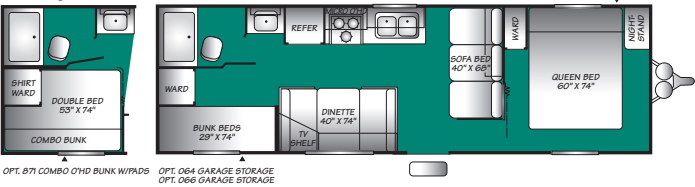

▲ = Exterior Storage

*Sleeping capacity is a variable number and is affected by items such as size of occupant, options and floor plan. Some models are not available in all areas of the country. Please see your local dealer for model availability.

MALLARD SPORT FIFTH WHEEL FLOOR PLAN

235RL Sleeps 6*

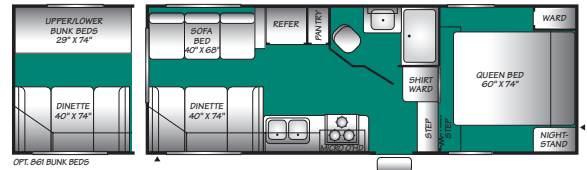

MALLARD TRAVEL TRAILER FLOOR PLANS

20FKS – Sleeps 6-7*, Single Slide-Out

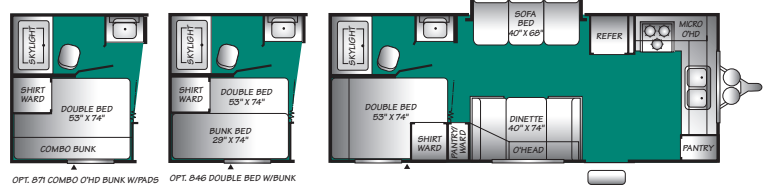

26BHS Sleeps 8*, Single Slide-Out

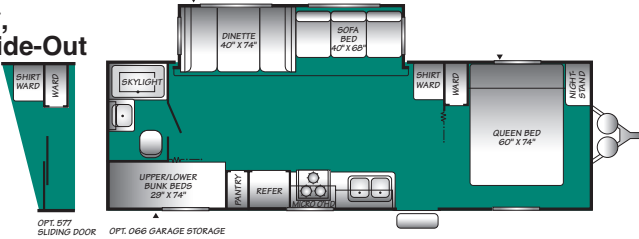

26RLS Sleeps 6* Single Slide-Out

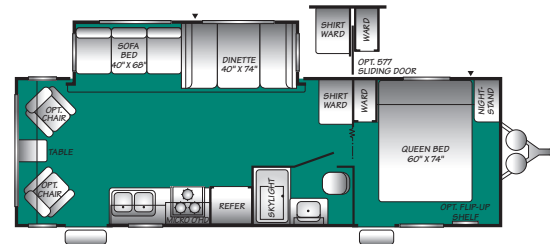

MALLARD TRAVEL TRAILER FLOOR PLANS

27FQS
Sleeps 6*
Single Slide-Out

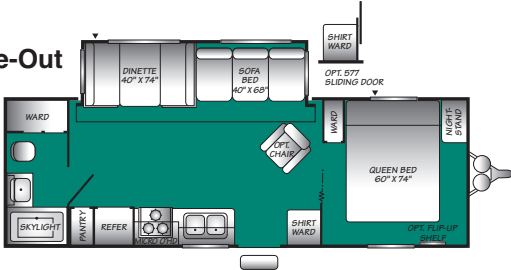

39BD2S
Sleeps 8*, Double Slide-Out

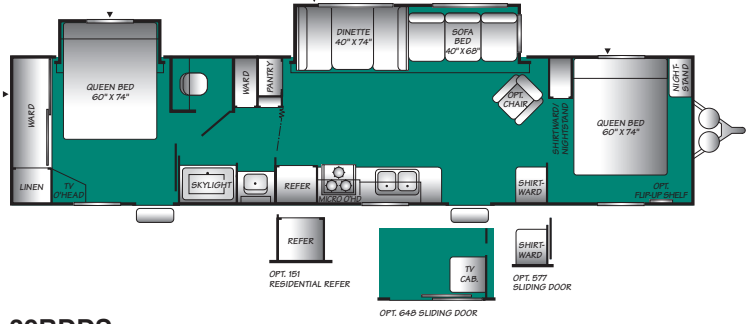

29BHS
Sleeps 8-9*
Single Slide-Out

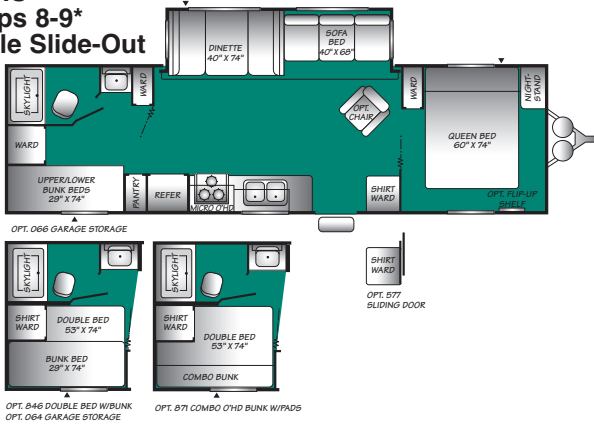

39BDDS
Sleeps 6*, Double Slide-Out

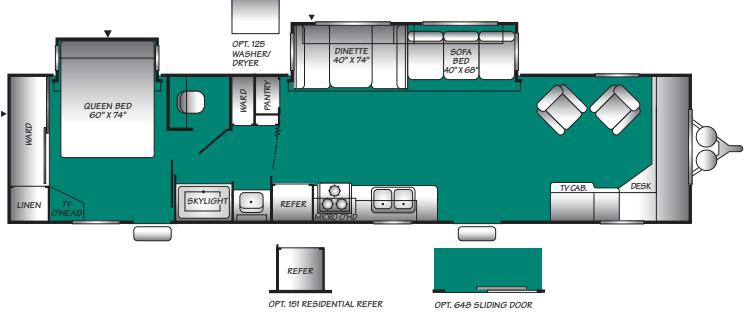

31BD2S
Sleeps 8*, Double Slide-Out

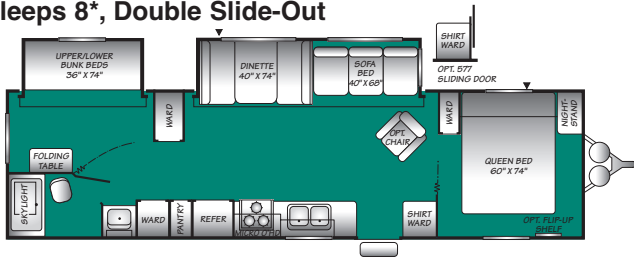

39BHDS
Sleeps 9 - 10*, Double Slide-Out

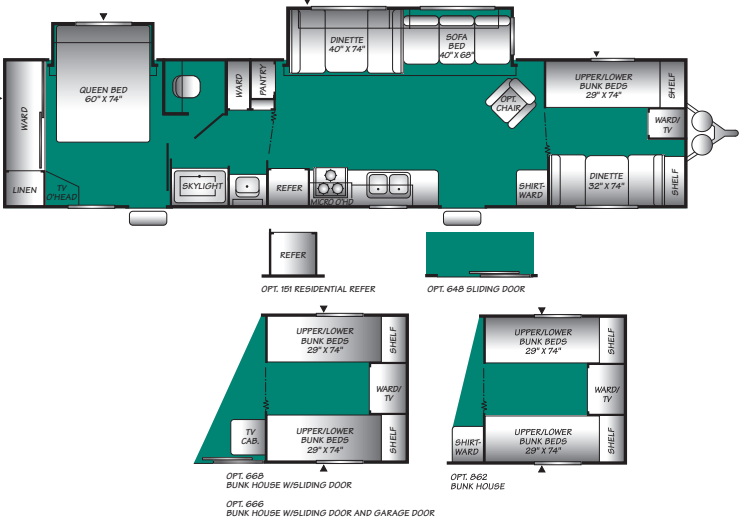

31BHS
Sleeps 10*
Single Slide-Out

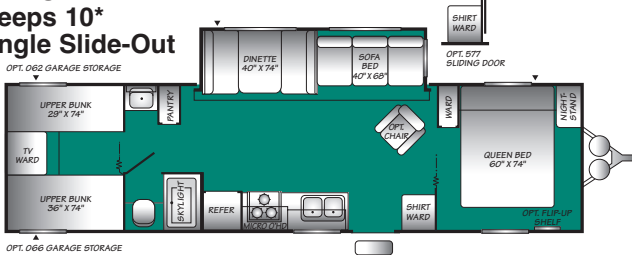

WEIGHTS AND MEASUREMENTS

WEIGHTS	MALLARD SPORT					MALLARD								
	18CK	25RL	28BH	235RL	20FKS	26BHS	26RLS	27FQS	29BHS	31BD2S	31BHS	39BD2S	39BDDS	39BHDS
GVWR (lbs) ¹	5,600	N/A	7,500	7,500	N/A	8,000	7,900	7,500	9,000	9,500	9,200	N/A	N/A	11,000
Gross Dry Weight (lbs) ^{2,6}	3,465	N/A	4,226	4,631	N/A	5,368	5,523	5,114	5,705	6,548	6,010	N/A	N/A	7,253
Cargo Carrying Capacity (lbs) ^{3,6}	2,135	N/A	3,274	2,869	N/A	2,632	2,377	2,386	3,295	2,952	3,190	N/A	N/A	3,747
Hitch Dry Weight (lbs) ^{2,6,9}	419	N/A	602	934	N/A	687	802	708	719	765	736	N/A	N/A	847

DIMENSIONS & CAPACITIES														
Length (Feet & Inches) ^{4,6,8}	22' 2"	26' 5"	29' 7"	24' 9"	23' 11"	29' 2"	29' 1"	27' 11"	32' 2"	34' 0"	34' 1"	39' 8"	39' 8"	39' 8"
Height (Feet & Inches) ^{5,6}	9' 3"	9' 3"	9' 3"	11' 4"	9' 10"	10' 4"	10' 4"	10' 2"	10' 4"	10' 4"	10' 4"	10' 4"	10' 4"	10' 4"
Fresh Water Holding Tank (gal) ^{6,7}	40	40	40	40	50	50	50	50	50	50	50	50	50	50
Grey Water Holding Tank (gal) ^{6,7}	40	40	40	40	70	40	40	40	40	40	40	40	40	40
Black Water Holding Tank (gal) ^{6,7}	40	40	40	40	40	40	40	40	40	40	40	40	40	40
Propane Capacity (lbs) ^{6,7}	60	60	60	40	60	60	60	60	60	60	60	60	60	60
Tire Size (Load Range)	ST205/75R 14C	ST205/75R 14C	ST205/75R 14C	ST205/75R 14C	ST205/75R 14C	ST225/75R 15C	ST225/75R 15C	ST205/75R 15C	ST225/75R 15C	ST225/75R 15C	ST225/75R 15C	ST225/75R 15D	ST225/75R 15D	ST225/75R 15D

FEATURES

INTERIOR

- 120-Volt GFI Circuit Protection (Galley/Bath/Patio) S S
- 120V Central Electrical Panel S S
- 92 5/8" Interior Width S S
- Double-Light Fixtures (Most Areas) S S
- Dual 7-Gallon Propane Cylinders w/Regulator & Auto-Changeover (N/A 235RL) S S
- HydroFlame Forced Air, Direct Spark Ignition Furnace w/Thermostat S S
- In-Ceiling Air Conditioner Ducting (Most Models) S S
- In-Floor Furnace Ducting S S
- Light Colored Interior Wall Coverings S S
- Mini-Blinds Throughout (Except Bunk Windows) S S
- Prewired for Roof Air Conditioner S S
- Prewired for Stereo & Speakers S S
- Solid State Converter w/Built-In Battery Charger S S
- Wall-Mounted Systems Monitor Panel S S
- Wall-Switched Interior Lights S S
- 13,500 BTU Air Conditioner O S
- 15,000 BTU Air Conditioner O S
- 6-Gallon Propane/12V DSI (Direct Spark Ignition) Water Heater (N/A w/Option 958) S S
- Bedroom Carpet (Most Models) O O
- Living Room Carpet (Most Models) O O
- Stereo AM/FM CD Player S S
- Stereo AM/FM/CD/DVD/MP3 Player (N/A w/Option 958) S S
- Large TV Location (Most Models) S S

GALLEY

- 16" Drop in Range w/Oven S S
- Dometic® Double Door Propane/Electric Refrigerator S S
- Double Bowl Sink S S
- Double Handle High Rise Faucet S S
- Large Cabinet Doors S S
- Overhead Storage Cabinet Above Sink S S
- Pantry w/Adjustable Shelves (Most Models) S S
- Range Hood w/12V Light & Exhaust Fan S S
- Wood Grain Refrigerator Insert S S
- Deluxe Wood Grain Refrigerator Insert S S
- Mortise and Tenon Cabinets Doors S S
- Microwave w/Electronic Touch Pad S S

- Range Cover O S
- Sink Covers/Cutting Board S S

BEDROOM

- Bedroom Headboard (Most Models) S S
- Bedside Nightstand (Most Models) S S
- Décor-Coordinated Bedspread S S
- Innerspring Mattress S S
- Lift-Up Bed Platform w/Below Bed Storage (Most Models) S S
- Wardrobes Accommodate Residential Size Clothes Hangers S S

BATHROOM

- ABS Bath Tub Wall Surround O S
- Skylight S S
- 12V Power Exhaust Roof Vent S S
- Medicine Cabinet w/Mirrored Door & Adjustable Shelves S S
- Thetford® Fresh Water Flush Toilet S S
- Towel Bar, Towel Ring, Toilet Paper Holder S S
- Wall-Switched Ceiling Light S S

SAFETY/CONVENIENCE

- Carbon Monoxide Detector/Alarm S S
- Fire Extinguisher S S
- Propane Detector/Alarm S S
- Smoke Detector/Alarm S S

EXTERIOR

- 120V Patio Receptacle S S
- Arctic White Gloss Exterior Metal Finish S S
- Fiberglass Insulation S S
- Full Color Decorative Exterior Graphics S S
- Molded Wheel Well Skirts (Most Models) S S
- Quick Drain Valve Fresh Water Tank S S
- Radius Aluminum Sidewall Skirting (Most Models) S S
- Radius Corner Entry Door S S
- Radius Corner Safety Glass Windows S S
- Radius Corner Luggage Doors S S
- Truss Roof Rafters S S
- Rear Bumper w/Sewer Hose Carrier S S
- Reinforced Screen Door w/Kick Panel S S
- Seamless, One-Piece Rubber Roof S S
- Slide-Out Endwall Window S S
- Enclosed Chassis (Most Models) O S
- Structural I-Beam Cambered Chassis S S

- Sub-Floor Fresh Water Holding Tank S S
- Welded, Dual Battery Rack (N/A 235RL) S S
- Exterior Shower O O
- Garage Storage (Most Models) O O
- Patio Awning (N/A w/Option 958) S S
- Spare Tire and Carrier O O
- TV Antenna S S

SAFETY/CONVENIENCE

- 26" Wide Main Entry Door w/Window (Most Models) S S
- 4-Wheel Electric Brakes S S
- Break-Away Emergency Disconnect Brake S S
- Flush Mount Entry Door Latch w/Deadbolt Lock S S
- Patio Light-Interior Switch S S
- Retractable Entry Step w/Non-Skid Strip S S

STORAGE

- Locking, Insulated Luggage Doors S S

INTERIOR VALUE PACKAGE

- Microwave X X
- 6-Gallon Propane/12V DSI (Direct Spark Ignition) Water Heater (N/A w/Option 958) X X
- Water Heater By-Pass (N/A w/Option 958) X X
- Sink Lids X X
- Stereo AM/FM/CD Player (N/A w/Option 958) X X
- Throw Pillow X X
- Skylight X X
- Range Cover X X
- Deluxe Refer Insert Panel X X

EXTERIOR VALUE PACKAGE

- TV Antenna X X
- Awning (N/A w/Option 958) X X
- LPG Cover (N/A w/Option 958) X X
- Front Gravel Cover (N/A w/Option 958) X X
- Stab Jacks X X
- 13,500 BTU Air Conditioner X X



S = STANDARD O = OPTIONAL

1. GVWR (Gross Vehicle Weight Rating) is the maximum permissible weight of this trailer when fully loaded. It includes all weight at the trailer axle(s) and tongue or pin.
2. All dry weights are based on the standard model and do not include optional features or equipment.
3. Carrying Capacity is determined by subtracting Gross Dry Weight from GVWR. Cargo Carrying Capacity includes all fluids, optional features, equipment, and personal cargo.
4. Length taken from hitch or pin box to rear bumper (excludes accessories). Trailer length includes hitch; fifth wheel includes standard pin box.
5. Actual height may be lower, based on option offerings. Consult with your dealer to obtain actual height for the unit you are interested in.
6. Approximate.
7. Water weight equals 8.3 lbs. per gallon. Propane weight equals 4.2 lbs per gal.
8. Add 10" if equipped with optional spare tire and carrier.
9. Hitch weights are dependent upon how the trailer is equipped with options, on-board cargo and tank fluid levels. Actual hitch weights may be higher or lower than shown. It is recommended that the tow vehicle and hitch for your trailer have sufficient capacity to accommodate actual usage.

* = Estimated weights.

N/A = Not available at the time of printing.

IMPORTANT— PLEASE READ

Product information, photography and illustrations included in this publication were as accurate as possible at the time of printing. For further product information and changes, please visit our website at www.fleetwoodrv.com or contact your local Fleetwood dealer. Prices, materials, design and specifications are subject to change without notice. All weights, fuel, liquid capacities and dimensions are approximate. Fleetwood has designed its recreational vehicles to provide a variety of uses for customers. Each vehicle features optimal seating, sleeping, storage and fluid capacities. The user is responsible for selecting the proper combination of loads (i.e.: equipment, fluids, cargo, etc.) to ensure that the vehicle's capacities are not exceeded.

WHY MALLARD?



PASSION

We're truly passionate about the RV lifestyle. Fleetwood was founded by RV enthusiasts, and that tradition continues today.



QUALITY

There's no cutting corners. Skilled craftsmen build every Fleetwood RV for maximum durability and longevity.



SERVICE

Help is nearby. When you need an upgrade or repair, you'll find facilities all across North America and more than 1,100 dealers ready to assist you.



WARRANTY

Exclusive RV Ownercare warranty. See your Fleetwood dealer for details.



TRUST

More people trust Fleetwood. After all, we've spent over 50 years perfecting RVs, earning the loyalty of generations of RVers.

CONTACT US

To locate a dealer near you, visit our website at www.fleetwoodrv.com or call 1-800-444-4905. We can also be contacted at Fleetwood Customer Relations, P.O.Box 1007, Decatur, IN 46733.

FLEETWOOD TRAVELCADE CLUB

As a Fleetwood owner, you're eligible to become a member of the Fleetwood Travelcade Club. It's a perfect way to meet other Fleetwood owners who love to travel across America and share in the RV lifestyle. Call (877) 577-2560 or visit our website at www.fleetwoodrv.com/owners_clubs to learn more and join the fun!

RV OWNERCARE*

See your local dealer for complete details.

IMPORTANT—PLEASE READ

Product information, photography and illustrations included in this publication were as accurate as possible at the time of printing. For further product information and changes, please visit our website at www.fleetwoodrv.com or contact your local Fleetwood dealer. Prices, materials, design and specifications are subject to change without notice. All weights, fuel, liquid capacities and dimensions are approximate. Fleetwood has designed its recreational vehicles to provide a variety of uses for customers. Each vehicle features optimal seating, sleeping, storage and fluid capacities. The user is responsible for selecting the proper combination of loads (i.e.: equipment, fluids, cargo, etc.) to ensure that the vehicle's capacities are not exceeded.

Your Local Fleetwood Dealer Is:

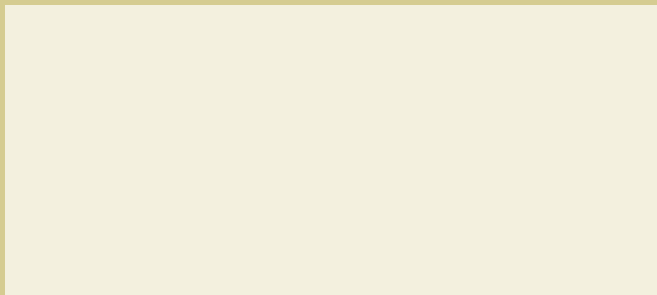

*For complete info see your Fleetwood dealer.

TO OUR CUSTOMERS...

To make sure that you get the maximum satisfaction out of your recreational vehicle purchase, there are several things you should know:

1. Learn all you can about the travel trailer or fifth wheel you're planning to buy. Don't rely on word of mouth. Get the facts about the actual trailer length, width, unloaded weight with options, Gross Vehicle Weight Rating, and Cargo Carrying Capacity. These are usually available in the manufacturer's sales literature or from the Cargo Carrying Capacity Label located in each trailer. Be sure to check this information **before** you decide which unit to buy.

2. Verify the towing capacity of your tow vehicle. If you don't know, or aren't sure, you can ask at your automotive dealership. Be sure to match its tow rating to the loaded (not dry) weight of your trailer. Include the weight of water, additional accessories, clothing, food, and gear. To help Fleetwood travel trailer customers estimate this total weight, our Gross Vehicle Weight Ratings reflect the maximum weight of the trailer when fully loaded for camping. Be sure the weight of the tow vehicle plus the weight of your trailer do not exceed the Gross Combined Weight Rating of the tow vehicle.

Taking these simple steps before you buy will help ensure that your trailer and tow vehicle combination is just what you wanted.

See you on the trail!

treadlightly!
LEAVING A GOOD IMPRESSION



FLEETWOOD
Travel Trailer Division