

Enjoy the wonder of it all

WILDERNESS[®]

W
I
L
D
E
R
N
E
S
S

FLEETWOOD RV

Travel Trailers and Fifth Wheels



The contemporary aerodynamic style of the Ultralite Wilderness Yukon improves towability. And the integrated aluminum framing and fiberglass sidewall construction produces a quality structure that's both lightweight and durable.

TENT MODELS

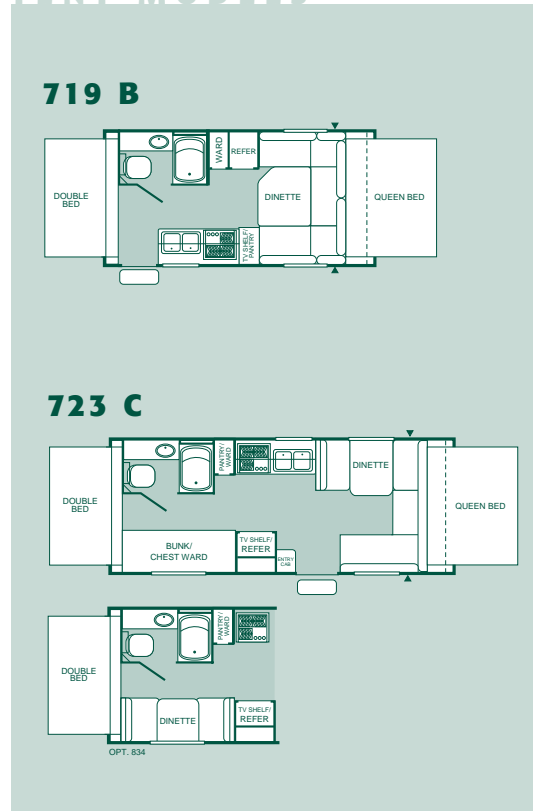

725 H

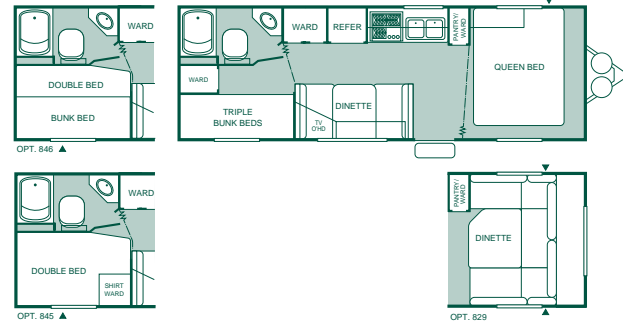

829 T

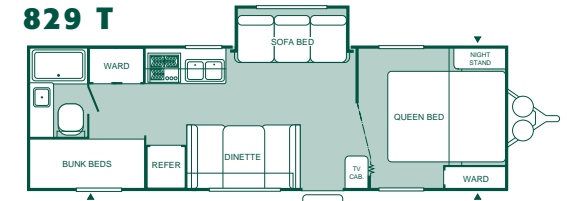

830 Y

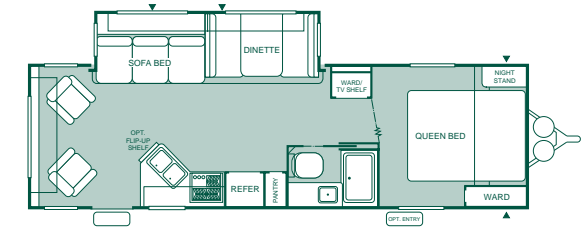

826 M

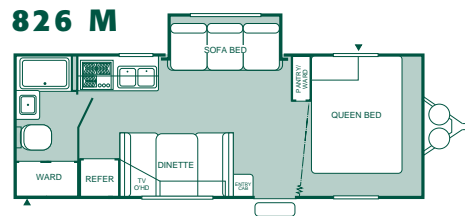

827 5P
Fifth Wheel

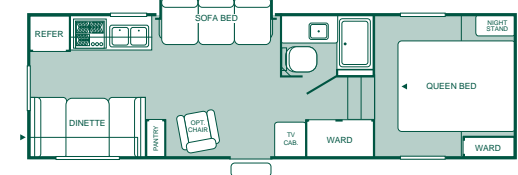

827 5S
Fifth Wheel

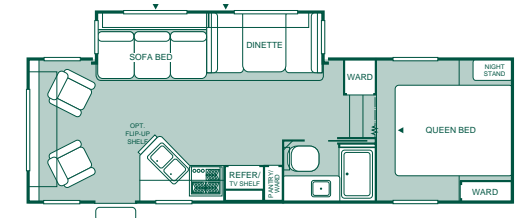

829 S

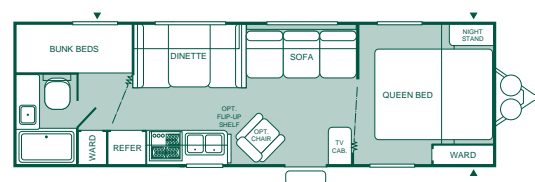

Some models are not available in all areas of the country. Please see your local dealer for model availability.

▲ = Exterior Storage

TENT MODELS

WILDERNESS YUKON MODELS	719 B	723 C	722 F	725 H	826 M	829 S	829 T	830 Y	827 5P	827 5S
GVWR (Gross Vehicle Weight Rating) (lbs.) ¹	3,700	4,600	5,000	4,900	6,200	6,500	6,800	7,200	7,200	7,800
Gross Dry Weight (lbs.) ^{2,6}	2,530	3,150	3,364	3,625	4,090	4,085	4,460	5,241	4,857	5,470
Maximum Carrying Capacity (lbs.) ^{3,6}	1,170	1,450	1,636	1,275	2,110	2,415	2,340	1,959	2,343	2,330
Hitch Dry Weight (lbs.) ^{2,6}	240	340	437	355	450	410	440	627	1,072	1,060
Length (' and ") ^{4,5,8}	19' 1"	23' 4"	22' 11"	25' 11"	26' 2"	29' 11"	29' 11"	30' 11"	27' 11"	27' 11"
Height (' and ") ^{5,6}	8' 11"	8' 10"	8' 11"	8' 11"	9' 1"	9' 1"	9' 1"	9' 11"	10' 7"	10' 9"
Tire Size	14"(C)	13"(B)	13"(B)	13"(C)	14"(C)	14"(C)	14"(C)	14"(C)	14"(C)	14"(C)
Fresh Water Holding Tank (gal.) ^{6,7}	25	25	30	30	40	40	40	40	40	40
Gray Water Holding Tank (gal.) ^{6,7}	30	30	30	30	40	40	40	40	40	40
Black Water Holding Tank (gal.) ^{6,7}	30	30	30	30	40	40	40	40	40	40
LPG Capacity (lbs.) ^{6,7}	40	40	40	40	60	60	60	60	60	60

1 (Gross Vehicle Weight Rating) is the maximum permissible weight of this trailer when fully loaded. It includes all weight at the trailer axle(s) and tongue or pin.

2 All dry weights are based on the standard model and do not include optional features or equipment.

3 Maximum Carrying Capacity is determined by subtracting Gross Dry Weight from GVWR. Maximum Carrying Capacity includes all fluids, optional features, equipment, and personal cargo.

4 Trailer length includes 3' 6" for hitch; fifth wheel includes standard pin box.

5 Add 9" if equipped with optional roof air conditioner.

6 Approximate.

7 Water weight equals 8.3 lbs per gallon. LPG weight equals 4.5 lbs per gallon.

8 Add 10" if equipped with optional spare tire and carrier.

IMPORTANT—PLEASE READ: Product information, photography and illustrations included in this publication were as accurate as possible at the time of printing. For further product information and changes, please visit our website at www.fleetwoodrv.com or contact your local Fleetwood dealer. Prices, materials, design and specifications are subject to change without notice. All weights, fuel, liquid capacities and dimensions are approximate. Fleetwood has designed its recreational vehicles to provide a variety of uses for its customers. Each vehicle features optimal seating, sleeping, storage and fluid capacities. The user is responsible for selecting the proper combination of loads (i.e. occupants, equipment, fluids, cargo, etc.) to ensure that the vehicle's capacities are not exceeded.

LIVABILITY

8' Wide Units - 92 3/8" Interior Width

7 1/2' Wide Units - 87" Interior Width

Double Light Fixtures Throughout

Large Cabinet Doors

Wardrobes Accommodate Residential Size

Clothes Hangers

Lift-Up Bed Platform w/Below Bed Storage (Most Models)

EXTERIOR

Smooth Fiberglass Siding

Aluminum Framed Sidewalls

Rear Bumper w/Sewer Hose Carrier

Locking, Insulated Luggage Doors

One-Piece Seamless Rubber Roof

Roto-Molded Wheel Well Skirts (Not on Tent Models)

26" Wide Main Entry Door w/Window (Most Models)

Radius Truss Roof Rafters

Hitch Light

Patio Light-Interior Switch

Sub-Floor Fresh Water Holding Tank (Not on Tent Models)

Welded, Dual Battery Rack (Travel Trailer Models Only)

INTERIOR

Overhead Storage Cabinets

Innerspring Mattress (Most Models)

Decor Wall Border

Decor-Coordinated Bedspread (Most Models)

Miniblinds Throughout

(Except Bunk Windows)

Bedroom Headboards (Most Models)

Raised Panel Overhead Cabinet Doors

GALLEY

Full-Shelf Storage, Below Sink

Double Bowl Stainless Steel Galley Sink

Residential Height Galley Countertops

BATH

Tub/Shower Surround (8' Wides Only)

Wall-Mounted Bathroom Vanity Mirror

12V Power Exhaust Roof Vent

Wall-Switched Ceiling Light

Two Towel Bars

Thetford® Fresh Water Flush Toilet

APPLIANCES/EQUIPMENT

Dometic® LPG/Electric Refrigerator

3-Burner (1 High-Output), Range w/Oven (Optional on 7 1/2' Wides)

Atwood® 3-Burner Cooktop (7 1/2' Wides Only)

hydroflame® Forced Air, D.S.I. Furnace w/Thermostat

Range Hood w/12V Light and Exhaust Fan Microwave Oven (Optional on Tent Models)

Wall-Mounted Systems Monitor Panel (Optional on Tent Models)

In-Ceiling Rigid Air Conditioner Ducting (Most Models)

6-Gallon LP Gas Water Heater

Water Heater Bypass

ELECTRICAL

40 Amp Solid State Converter w/Built-in Battery Charger

120V Patio Receptacle

Cable TV Hook-Up

Prewired for Roof Air Conditioner

Prewired for Stereo and Speakers

Prewired for TV Antenna

SAFETY

Fire Extinguisher

Smoke Detector/Alarm

LP Gas Leak Detector/Alarm

120-Volt GFI Circuit Protection (Galley/Bath/Patio)

4-Wheel Electric Brakes

(2 Wheel Electric Brakes on 719B)

Break-Away Emergency Disconnect Brake

Radiused, Retractable Entry Step

w/Non-Skid Strip

OPTIONAL FEATURES

Exterior Shower

AM/FM Stereo w/CD

LPG DSI 6-Gallon Water Heater

13.5M Air Conditioner

Heated Holding Tanks

Spare Tire

Safety Glass Windows

Bedroom Carpet (Most Models)

Living Room Carpet (Most Models)

Water Purifier

Range Cover

Fifth Wheel Hitch

Fifth Wheel Front Cap

Freedom Edition Package

INTERIOR DECOR OPTIONS

Rose

Green

Blue

Wilderness Lite, Wilderness and Wilderness GL (designated by 🌿) offer so many floor plans to choose from. All 28 feature a long list of standard features and are an exceptional value. Choose your favorite.

LITE MODELS

20 N

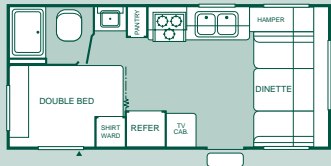

Option: B1
 (Please see pg. 7)

23 W

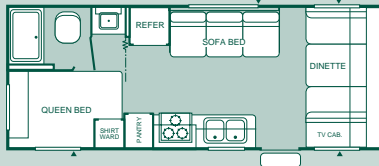

Option: B1
 (Please see pg. 7)

25 J

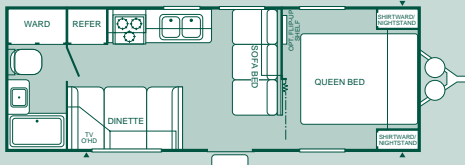

25 Y

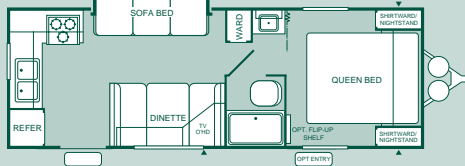

25 Z

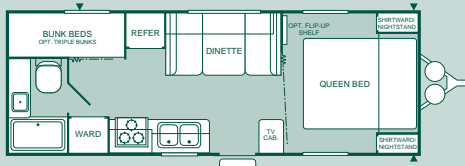

26 K

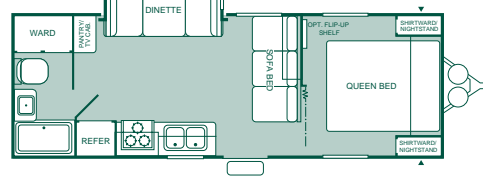

26 W

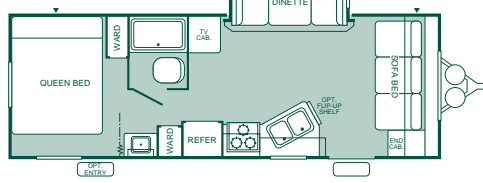

🌿 **27 H** 🌿

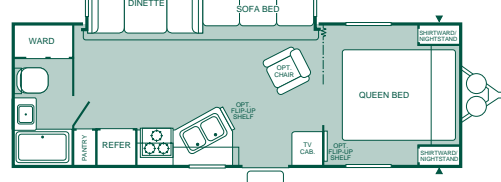

Option: D1
 (Please see pg. 7)

GL ONLY

28 T

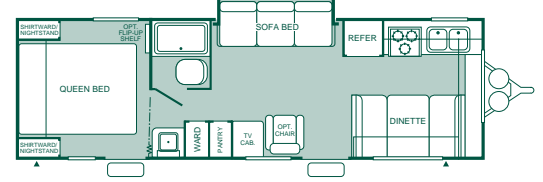

28 X

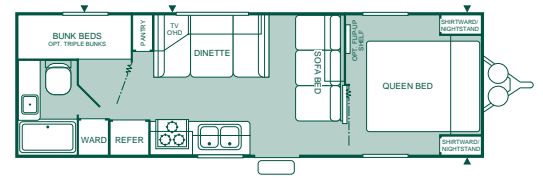

🌿 **29 F**

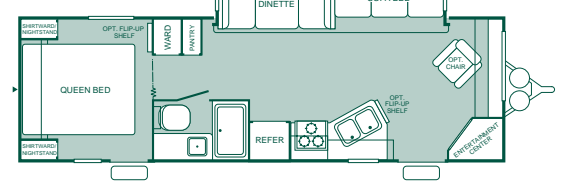

Option: D1
 (Please see pg. 7)

Some models are not available in all areas of the country. Please see your local dealer for model availability.

🌿 Also available as a GL model
 ▲ = Exterior Storage

29 J

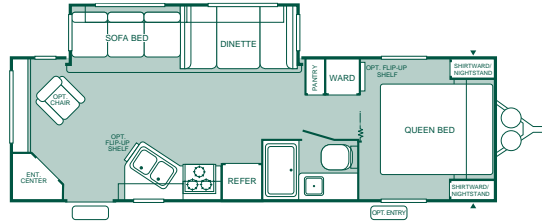

Option: D1
(Please see pg. 7)

30 E

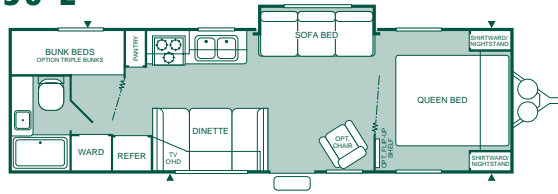

30 N

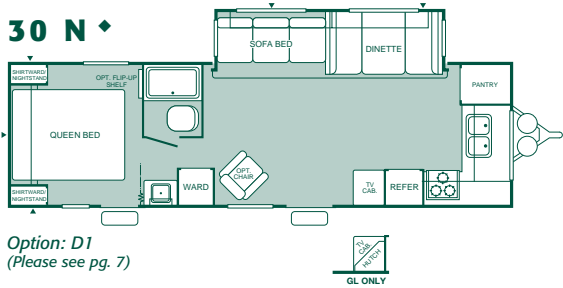

Option: D1
(Please see pg. 7)

Additional Features on GL only:

- ◆ = TV Cabinet/Hutch
- = Entertainment Center

31 G

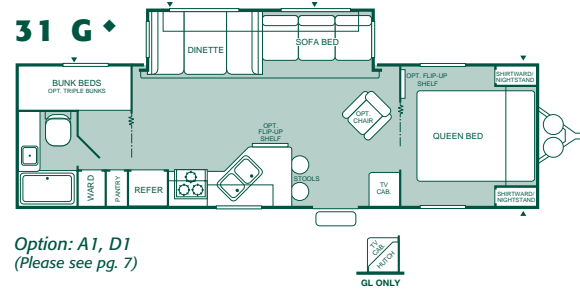

Option: A1, D1
(Please see pg. 7)

33 A

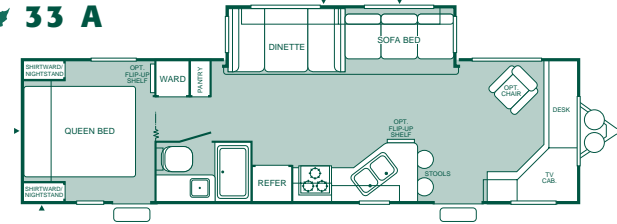

Option: D1
(Please see pg. 7)

39 D

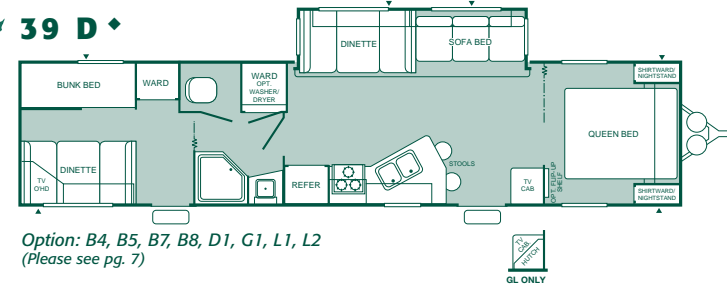

Option: B4, B5, B7, B8, D1, G1, L1, L2
(Please see pg. 7)

39 L

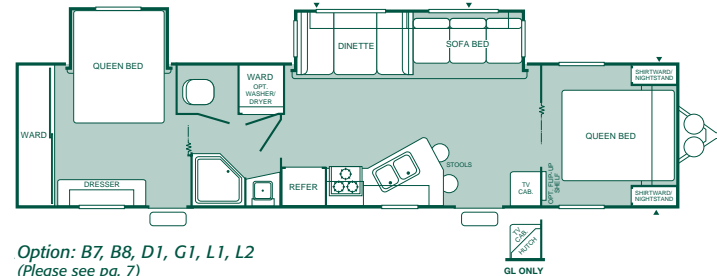

Option: B7, B8, D1, G1, L1, L2
(Please see pg. 7)

LITE MODEL

24 5C
Fifth Wheel

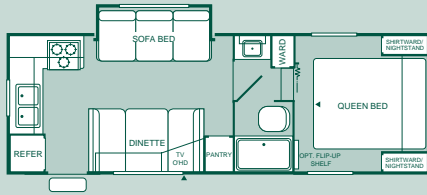

24 5M
Fifth Wheel

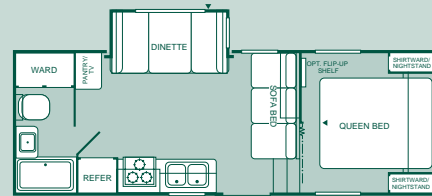

26 5H
Fifth Wheel

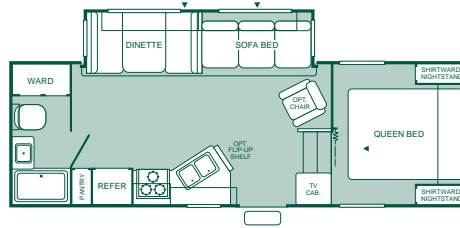

Option: D1
(Please see pg. 7)

27 5A
Fifth Wheel

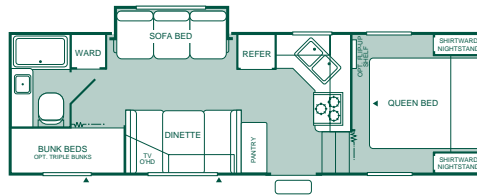

28 5J*
Fifth Wheel

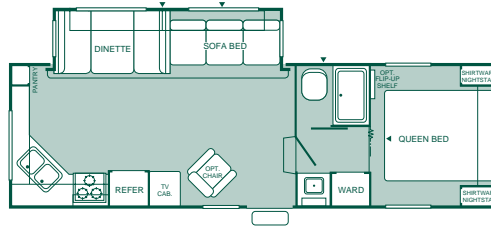

Option: D1
(Please see pg. 7)

30 5S
Fifth Wheel

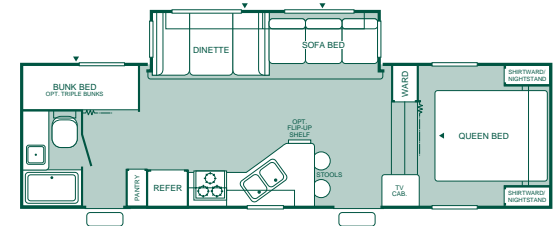

Option: A1, D1
(Please see pg. 7)

31 5G
Fifth Wheel

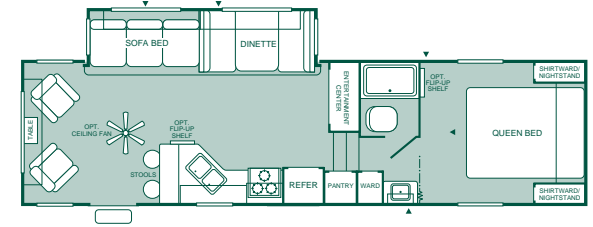

Option: B10, D1
(Please see pg. 7)

Also available as a GL model

▲ = Exterior Storage

Only Available as a GL Model

Floor Plan Options

34 P

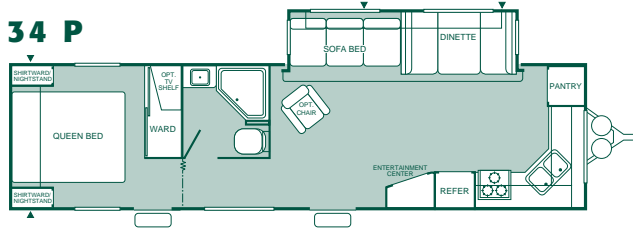

Option: D1, B3
(Please see chart on this page)

32 5D Fifth Wheel

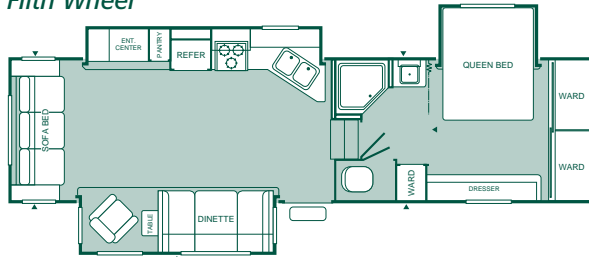

Option: D1
(Please see chart on this page)

33 5F Fifth Wheel

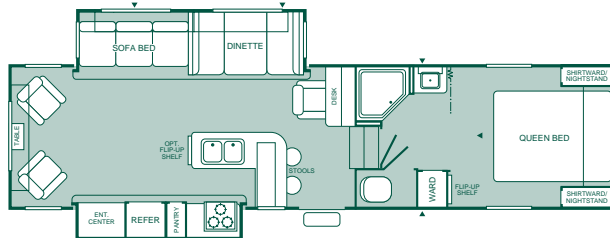

Option: B10, D1
(Please see chart on this page)

Additional Features on GL only:

◆ = TV Cabinet/Hutch ● = Entertainment Center



Option: A1
Alternate Bath

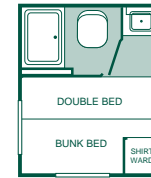

Option: B1
Double Bed w/Bunk

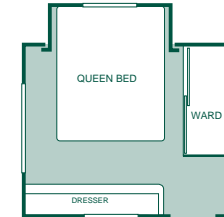

Option: B3
Rear Bedroom Slide

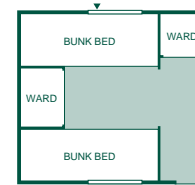

Option: B4
Rear Bunk Beds

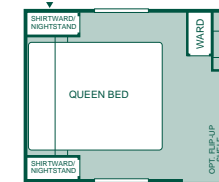

Option: B5
Queen Bed

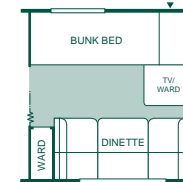

Option: B7
Front Bunk/Dining Combo

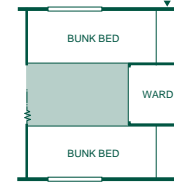

Option: B8
Front Bunk Beds

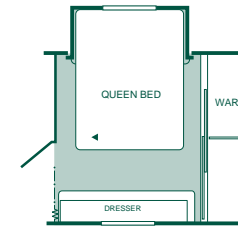

Option: B10
Front Bedroom Slide



Option: D1
Free Standing Dinette



Option: G1
Residential Refrigerator

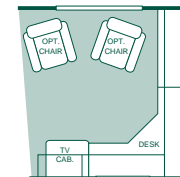

Option: L1
Den



Option: L2
Sliding Doors



Specifications

WILDERNESS LITE & WILDERNESS MODELS	20 N	23 W	25 J	25Y	25 Z	26 K	26 W	27 H	28T
GVWR (Gross Vehicle Weight Rating) (lbs.) ¹	5,700	6,100	6,800	7,000	5,900	7,400	7,300	7,500	7,500
Gross Dry Weight (lbs.) ^{2,6}	3,510	4,006	4,091	4,397	3,920	5,053	4,924	5,088	4,962
Maximum Carrying Capacity (lbs.) ^{3,6}	2,190	2,094	2,709	2,603	1,980	2,347	2,376	2,412	2,538
Hitch Dry Weight (lbs.) ^{2,6}	430	420	562	596	472	678	636	625	740
Length (' and ") ^{4,6,8}	20' 11"	23' 11"	25' 11"	25' 11"	25' 11"	26' 11"	26' 11"	27' 11"	28' 11"
Height (' and ") ^{5,6}	9' 2"	8' 9"	9' 2"	9' 2"	9' 2"	10' 1"	10' 1"	10' 1"	9' 11"
Tire Size	14"(B)	14"(B)	14"(C)	14"(C)	14"(B)	15"(C)	15"(C)	15"(C)	15"(C)
Fresh Water Holding Tank (gal.) ^{6,7}	40	40	40	40	40	40	40	40	40
Gray Water Holding Tank (gal.) ^{6,7}	40	40	40	20/40	40	40	40	40	20/40
Black Water Holding Tank (gal.) ^{6,7}	40	40	40	40	40	40	40	40	40
LPG Capacity (lbs.) ^{6,7}	60	60	60	60	60	60	60	60	60

WILDERNESS MODELS	28 X	29 F	29 J	30 E	30 N	31 G	33A	39 D
GVWR (Gross Vehicle Weight Rating) (lbs.) ¹	7,300	8,700	8,600	7,500	8,700	8,800	9,400	11,000
Gross Dry Weight (lbs.) ^{2,6}	4,433	5,830	5,645	4,866	6,095	5,994	6,362	7,228
Maximum Carrying Capacity (lbs.) ^{3,6}	2,867	2,870	2,955	2,634	2,605	2,806	3,038	3,772
Hitch Dry Weight (lbs.) ^{2,6}	550	903	759	615	891	665	973	920
Length (' and ") ^{4,6,8}	28' 11"	29' 11"	29' 11"	30' 11"	30' 11"	31' 11"	33' 11"	39' 8"
Height (' and ") ^{5,6}	9' 11"	10' 1"	10' 1"	9' 11"	10' 1"	9' 11"	9' 11"	9' 11"
Tire Size	15"(C)	15"(C)	15"(C)	15"(C)	15"(C)	15"(C)	15"(C)	15"(D)
Fresh Water Holding Tank (gal.) ^{6,7}	40	40	40	40	40	40	40	40
Gray Water Holding Tank (gal.) ^{6,7}	40	40	40	40	20/40	40	40	40
Black Water Holding Tank (gal.) ^{6,7}	40	40	40	40	40	40	40	40
LPG Capacity (lbs.) ^{6,7}	60	60	60	60	60	60	60	60

WILDERNESS LITE & WILDERNESS MODELS	39 L	24 5C	24 5M	26 5H	27 5A	28 5J	30 5S	31 5G
GVWR (Gross Vehicle Weight Rating) (lbs.) ¹	11,000	7,500	7,600	8,250	8,000	9,700	10,200	11,000
Gross Dry Weight (lbs.) ^{2,6}	7,628	5,033	5,255	5,702	5,381	6,435	6,765	7,479
Maximum Carrying Capacity (lbs.) ^{3,6}	3,372	2,467	2,345	2,548	2,619	3,265	3,435	3,521
Hitch Dry Weight (lbs.) ^{2,6}	757	885	870	1,162	1,132	1,079	1,317	1,890
Length (' and ") ^{4,6,8}	39' 8"	26' 11"	24' 11"	26' 11"	27' 11"	28' 11"	30' 11"	31' 11"
Height (' and ") ^{5,6}	9' 11"	11' 6"	11' 7"	11' 7"	11' 6"	11' 5"	11' 5"	12' 1"
Tire Size	15"(D)	15"(C)	15"(C)	15"(C)	15"(C)	15"(C)	15"(D)	15"(D)
Fresh Water Holding Tank (gal.) ^{6,7}	40	40	40	40	40	40	40	40
Gray Water Holding Tank (gal.) ^{6,7}	40	20/40	40	40	20/40	20/40	40	40
Black Water Holding Tank (gal.) ^{6,7}	40	40	40	40	40	40	40	40
LPG Capacity (lbs.) ^{6,7}	60	60	60	60	60	60	60	60

1 (Gross Vehicle Weight Rating) is the maximum permissible weight of this trailer when fully loaded. It includes all weight at the trailer axle(s) and tongue or pin.

2 All dry weights are based on the standard model and do not include optional features or equipment.

3 Maximum Carrying Capacity is determined by subtracting Gross Dry Weight from GVWR. Maximum Carrying Capacity includes all fluids, optional features, equipment, and personal cargo.

4 Trailer length includes 3' 6" for hitch; fifth wheel includes standard pin box.

5 Add 9" if equipped with optional roof air conditioner.

6 Approximate.

7 Water weight equals 8.3 lbs per gallon. LPG weight equals 4.5 lbs per gallon.

8 Add 10" if equipped with optional spare tire and carrier.

N/A - Not available at time of printing.

IMPORTANT—PLEASE READ: Product information, photography and illustrations included in this publication were as accurate as possible at the time of printing. For further product information and changes, please visit our website at www.fleetwoodrv.com or contact your local Fleetwood dealer. Prices, materials, design and specifications are subject to change without notice. All weights, fuel, liquid capacities and dimensions are approximate. Fleetwood has designed its recreational vehicles to provide a variety of uses for its customers. Each vehicle features optimal seating, sleeping, storage and fluid capacities. The user is responsible for selecting the proper combination of loads (i.e. occupants, equipment, fluids, cargo, etc.) to ensure that the vehicle's capacities are not exceeded.



WILDERNESS GL MODELS	27 H	29 F	29 J	30 N	31 G
GVWR (Gross Vehicle Weight Rating) (lbs.) ¹	7,600	8,800	8,600	8,800	8,900
Gross Dry Weight (lbs.) ^{2,6}	5,395	6,167	5,950	6,449	6,348
Maximum Carrying Capacity (lbs.) ^{3,6}	2,205	2,633	2,650	2,351	2,552
Hitch Dry Weight (lbs.) ^{2,6}	676	943	800	936	716
Length (' and ") ^{4,6,8}	27' 11"	29' 11"	29' 11"	30' 11"	31' 11"
Height (' and ") ^{5,6}	10' 1"	10' 1"	10' 1"	10' 1"	9' 11"
Tire Size	15"(C)	15"(C)	15"(C)	15"(C)	15"(C)
Fresh Water Holding Tank (gal.) ^{6,7}	40	40	40	40	40
Gray Water Holding Tank (gal.) ^{6,7}	40	40	40	20/40	40
Black Water Holding Tank (gal.) ^{6,7}	40	40	40	40	40
LPG Capacity (lbs.) ^{6,7}	60	60	60	60	60

WILDERNESS GL MODELS	33A	34 P	39 D	39L	26 5H
GVWR (Gross Vehicle Weight Rating) (lbs.) ¹	9,400	10,800	11,000	11,000	8,300
Gross Dry Weight (lbs.) ^{2,6}	6,723	7,129	7,616	7,969	6,030
Maximum Carrying Capacity (lbs.) ^{3,6}	2,677	3,671	3,384	3,031	2,270
Hitch Dry Weight (lbs.) ^{2,6}	1,015	1,060	928	799	1,243
Length (' and ") ^{4,6,8}	33' 11"	34' 11"	39' 8"	39' 8"	26' 11"
Height (' and ") ^{5,6}	9' 11"	9' 11"	9' 11"	9' 11"	11' 7"
Tire Size	15"(C)	15"(D)	15"(D)	15"(D)	15"(C)
Fresh Water Holding Tank (gal.) ^{6,7}	40	40	40	40	40
Gray Water Holding Tank (gal.) ^{6,7}	40	20/40	40	40	40
Black Water Holding Tank (gal.) ^{6,7}	40	40	40	40	40
LPG Capacity (lbs.) ^{6,7}	60	60	60	60	60

WILDERNESS GL MODELS	28 5J	30 5S	31 5G	32 5D	33 5F
GVWR (Gross Vehicle Weight Rating) (lbs.) ¹	9,700	10,200	11,200	12,500	12,400
Gross Dry Weight (lbs.) ^{2,6}	6,797	7,160	7,860	9,302	8,616
Maximum Carrying Capacity (lbs.) ^{3,6}	2,903	3,040	3,340	3,198	3,784
Hitch Dry Weight (lbs.) ^{2,6}	1,163	1,407	1,974	2,196	1,653
Length (' and ") ^{4,6,8}	28' 11"	30' 11"	31' 11"	32' 11"	33' 11"
Height (' and ") ^{5,6}	11' 5"	11' 5"	12' 1"	12' 2"	12' 2"
Tire Size	15"(C)	15"(D)	15"(D)	16"(E)	16"(E)
Fresh Water Holding Tank (gal.) ^{6,7}	40	40	40	40	40
Gray Water Holding Tank (gal.) ^{6,7}	20/40	40	40	40	40
Black Water Holding Tank (gal.) ^{6,7}	40	40	40	40	40
LPG Capacity (lbs.) ^{6,7}	60	60	60	60	60

1 (Gross Vehicle Weight Rating) is the maximum permissible weight of this trailer when fully loaded. It includes all weight at the trailer axle(s) and tongue or pin.

2 All dry weights are based on the standard model and do not include optional features or equipment.

3 Maximum Carrying Capacity is determined by subtracting Gross Dry Weight from GVWR. Maximum Carrying Capacity includes all fluids, optional features, equipment, and personal cargo.

4 Trailer length includes 3' 6" for hitch; fifth wheel includes standard pin box.

5 Add 9" if equipped with optional roof air conditioner.

6 Approximate.

7 Water weight equals 8.3 lbs per gallon. LPG weight equals 4.5 lbs per gallon.

8 Add 10" if equipped with optional spare tire and carrier.

N/A - Not available at time of printing.

IMPORTANT—PLEASE READ: Product information, photography and illustrations included in this publication were as accurate as possible at the time of printing. For further product information and changes, please visit our website at www.fleetwoodrv.com or contact your local Fleetwood dealer. Prices, materials, design and specifications are subject to change without notice. All weights, fuel, liquid capacities and dimensions are approximate. Fleetwood has designed its recreational vehicles to provide a variety of uses for its customers. Each vehicle features optimal seating, sleeping, storage and fluid capacities. The user is responsible for selecting the proper combination of loads (i.e. occupants, equipment, fluids, cargo, etc.) to ensure that the vehicle's capacities are not exceeded.



LIVABILITY

- 92 5/8" Interior Width
- Double-Light Fixtures Throughout
- Contoured Cabinet Treatments—Radius Styling
- Light Colored Interior Wall Coverings
- Large TV Location (Most Models)
- Large Cabinet Doors
- Lift-Up Bed Platform w/Below Bed Storage (Most Models)
- Beside Nightstand (Most Models)
- Wardrobes Accommodate Residential Size Clothes Hangers

EXTERIOR

- Arctic White Gloss Exterior Metal Finish
- Structural I-beam Cambered Chassis
- Rear Bumper w/Sewer Hose Carrier
- Locking, Insulated Luggage Doors
- One-Piece Seamless Rubber Roof
- Radius Aluminum Sidewall Skirting (Most Models)
- Roto-Molded Wheel Well Skirts (Most Models)
- Baked Enamel Color Band
- R-7 Insulation
- 30" Wide Main Entry Door w/Window (Most Models)
- Flush Mount Entry Door Latch w/Dead Bolt Lock
- Reinforced Screen Door w/Kick Panel
- Radius Truss Roof Rafters
- Radius Corner Windows
- Hitch Light
- Patio Light—Interior Switch
- Welded, Dual Battery Rack (Travel Trailer Models Only)
- Waste Tank Single-Point Termination Valve
- Sub-Floor Fresh Water Holding Tank

INTERIOR

- Overhead Dinette Storage Cabinet
- Innerspring Mattress
- Decor Wall Border
- Decor-Coordinated Bedspread
- Miniblinds Throughout (Except Bunk Windows)
- Bedroom Headboards (Most Models)
- Raised Panel Overhead Cabinet Doors

GALLEY

- Residential Height Galley Countertops
- Half-Shelf Storage, Below Sink
- Trash Can Inside Cabinet (Most Models)
- Double Bowl Stainless Steel Galley Sink
- Built-in Knife Rack
- Overhead Storage Cabinet Above Sink
- Pantry w/Adjustable Shelves (Most Models)

BATH

- One-Piece Tub/Shower Walls w/Molded Soap Dish (Except Garden Tub)
- Medicine Cabinet w/Mirrored Door
- Wall-Mounted Bathroom Vanity Mirror (Most Models)
- Thetford® Fresh Water Flush Toilet
- 12V Power Exhaust Roof Vent
- Wall-Switched Ceiling Light
- Towel Bar

APPLIANCES/EQUIPMENT

- Dometic® Double Door LPG/Electric Refrigerator
- Magic Chef® 3-Burner (1 High-Output), Range w/Oven
- hydroflame® Forced Air, D.S.I. Furnace w/Thermostat

APPLIANCES/EQUIPMENT (CONT.)

- Range Hood w/12V Light and Exhaust Fan
- Wall-Mounted Systems Monitor Panel
- In-Floor Rigid Furnace Ducting (Most Models)
- In-Ceiling Rigid Air Conditioner Ducting (Most Models)
- 6-Gallon LP Gas Water Heater
- Dual 7-Gallon LPG Cylinders w/Regulator & Auto-Changeover

ELECTRICAL

- Solid State Converter w/Built-in Battery Charger
- 120V Central Electrical Panel
- 120V Patio Receptacle
- Cable TV Hook-Up
- Prewired for Roof Air Conditioner
- Prewired for Microwave Oven
- Prewired for Stereo and Speakers
- Prewired for TV Antenna
- Wall-Switched Interior Lights

SAFETY

- Fire Extinguisher
- Smoke Detector/Alarm
- LP Gas Leak Detector/Alarm
- 120-Volt GFI Circuit Protection (Galley/Bath/Patio)
- 4-Wheel Electric Brakes
- Radiused Retractable Entry Step w/Non-Skid Strip
- Break-Away Emergency Disconnect Brake

**WILDERNESS LITE & WILDERNESS
OPTIONAL FEATURES**

- *Bath Skylight*
- *Exterior Shower*
- *Stereo AM/FM Cassette*
- *Stereo AM/FM CD Player*
- *TV Antenna*
- *Microwave Oven*
- *LPG DSI 6-Gallon Water Heater*
- *Water Purifier*
- *Folding Tub/Shower Enclosure*
- *13.5M Air Conditioner*
- *Ladder*
- *Awning*
- *Upgraded Mattress*
- *Tinted Safety Glass Windows*
- *Spare Tire*
- *Free Standing Chair (Some Models)*
- *Bedroom Carpet (Most Models)*
- *Living Room Carpet (Most Models)*
- *Fiberglass Exterior*
- *Freedom Edition Package*

**WILDERNESS LITE & WILDERNESS
INTERIORS**

- *Rose*
- *Green*
- *Blue*

**ADDITIONAL WILDERNESS GL
STANDARD FEATURES**

- GL Exterior**
- *Fiberglass Exterior*
 - *Deluxe Graphics*
 - *Aluminum Bumper Cover*
 - *Radius Corner Entry and Luggage Doors*
 - *Chrome Wheel Trim Ring*
 - *Ladder*
 - *Shock Absorbers (Units with 13' Slide-Outs)*
 - *Exterior Shower*
 - *Large Exterior Grab Bar (Most Models)*

- GL Interior**
- *Raised Panel Cabinet Doors—Mortise and Tenon Construction*

- **New!** *Solid Wood Drawer Fronts*
- *LPG DSI 6-Gallon Water Heater*
- *Porcelain Galley Sink*
- *Carpet with Upgraded Carpet Pad*
- *Deluxe Furniture Styling*
- *Upgraded Window Treatments*
- *Bath Skylight*
- *Flip-Up Galley Extension (Most Models)*
- *TV Cabinet Overhead Hutch (Most Models)*
- *Upgraded Mattress*
- *22" Range with Oven*
- *Upgraded Stereo Speakers*
- *Phone Jack*
- *Range Cover*

- **New!** *Two Sink Lids*
- *Flip-Up TV Shelf*

**ADDITIONAL WILDERNESS GL
STANDARD FEATURES (CONT.)**

- *Single Lever Galley Faucet*
- *Foot Pedal Toilet*
- *Folding Tub Enclosure or Glass Shower Enclosure*
- *Living Room Throw Pillows*
- *Bedroom Carpet*
- *Living Room Carpet*
- **New!** *Bedroom Pillow Sham*
- **New!** *Decorative Mirror (Most Models)*

WILDERNESS GL OPTIONAL FEATURES

- *Stereo AM/FM Cassette*
- *Stereo AM/FM CD Player*
- *TV Antenna*
- *Microwave Oven*
- *Water Purifier*
- *13.5M Air Conditioner*
- *Fiberglass Front Cap*
- *Rear Perimeter Cap*
- *Awning*
- *Spare Tire*
- *Free Standing Chair (Most Models)*
- *Sleeper Sofa (Most Models)*
- *6 Panel Refrigerator Door*
- *Freedom Edition Package*

WILDERNESS GL INTERIORS

- *Grey*
- *Green*
- *Neutral*

See dealer for complete information on all available options.



DARE TO COMPARE!!

	<u>Fleetwood RV</u>	<u>Others</u>
Over 50 Years of RV Building Experience	✓	_____
2-Year Full Warranty (Not Limited)	✓	_____
Brand Name Appliances	✓	_____
Toll Free 800 Number for Customer Service	✓	_____



Visit our website at fleetwoodrv.com and join the fun!
(877) 577-2560



Featuring Fleetwood RV branded clothing and products. **Click and Shop!**

RV OWNERCARE THE FLEETWOOD RV TWO-YEAR HITCH TO BUMPER WARRANTY COVERAGE *

This comprehensive program includes systems, appliances, components and construction—with no additional costs to you.



TWO-YEAR FULL WARRANTY*

Leaving the Fleetwood RV dealership after you've purchased your RV doesn't mean leaving Fleetwood's commitment to your satisfaction behind. This complete warranty is unique because it's just that—complete. Some competitive brands only support a one-year warranty and most are limited. Be sure to check.

FULLY TRANSFERABLE*

Because we don't hesitate to stand behind our products, the complete **warranty is fully transferable** during the 24-months of warranty coverage, which is a plus for resale value.

NATIONAL COVERAGE

Traveling to Spokane? Buffalo? We've got you covered with one of the nation's largest trained service networks. In fact, **1,100 Fleetwood dealers** are just a phone call away.

24-HOUR ROADSIDE ASSISTANCE PROGRAM

Flat tire? Locked out? First-year roadside service in the U.S. or Canada is **free**. Just sign up with your dealer. After a year, you can continue this service for a reasonable cost.

Require these features when you purchase your new RV...Fleetwood does!

Your local Wilderness dealer is:

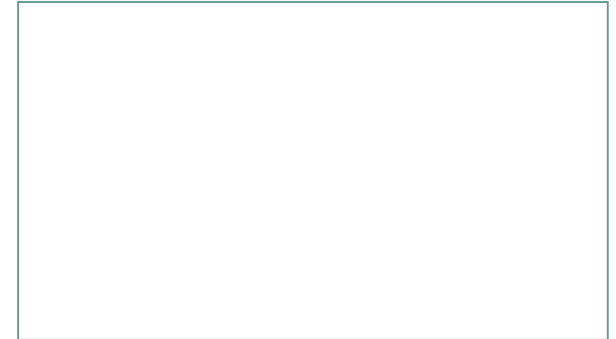

www.fleetwoodrv.com

Visit our website to find a dealer near you or learn more about other Fleetwood products. Or call us toll-free at 1-800-444-4905.

IMPORTANT—PLEASE READ: Product information, photography and illustrations included in this publication were as accurate as possible at the time of printing. For further product information and changes, please visit our website at www.fleetwoodrv.com or contact your local Fleetwood dealer. Prices, materials, design and specifications are subject to change without notice. All weights, fuel, liquid capacities and dimensions are approximate. Fleetwood has designed its recreational vehicles to provide a variety of uses for its customers. Each vehicle features optimal seating, sleeping, storage and fluid capacities. The user is responsible for selecting the proper combination of loads (i.e. occupants, equipment, fluids, cargo, etc.) to ensure that the vehicle's capacities are not exceeded.

*For complete details, see your Fleetwood RV dealer.

FLEETWOOD RV

The World's #1 RV Manufacturer

Fleetwood Enterprises, Inc. • RV Marketing • P.O. Box 7638 • Riverside, CA 92513-7638