

American[®] TRADITION

from American Coach



S T A R T O F A N E W T R A D I T I O N .

Your new home on the range.

Our new “full body paint” exterior is just the beginning of many long lasting traditions that are sure to endure the test of time and beauty. Your choice of exterior graphics can be mixed and matched with interior decors to give your American Tradition® a near customized look and feel that is all your own.

Special accents also add an extra touch to set your motor coach apart from all the others, including color coordinated awnings and shiny polished solid chrome wheels, and optional rear ladder. Just the right amount of flash to catch your eye and capture your heart.



For never ending Adventures.



T r a d i t i o n



Let American Tradition take you where you've never been before. North, south, east or west, you'll always feel right at home knowing your personal belongings and items are stowed down below in spacious storage areas. These lighted compartments feature easy to open swing-up luggage doors, and optional 36" and 54" slide-out trays. A 90" pass through storage tray is also available. As you can tell, storage is not a problem in the American Tradition. Neither is servicing or maintaining this classic motor coach, due to the easy-to-read tank monitoring systems and well lighted, color coded work station for water, sewer and electrical hook-ups. What you see outside also speaks volumes for what you're about to see inside. American Tradition... welcome aboard!

4 0 Q S W I N T E R W H I T E



40 QS PALOMINO INTERIOR (WITH OPTIONAL LEATHER PACKAGE)

K I C K Y O U R B O O T S O F F
and stay a while.



“Meet you back at the ranch” has taken on an all new meaning with the American Tradition. Three additional inches of head space now give plenty of room for guests donning the tallest of ten gallon hats. But the true test of comfort comes with relaxing on

beautiful Flexsteel® fabric or optional leather furniture, while enjoying your SONY® home theatre system. A complete entertainment package consists of a standard 24” SONY® Vega TV, VCR, DVD, AM/FM radio, DSS satellite system and five SONY® cube speakers and subwoofer.

Saddle up in Style.

Thanks to an adjustable Smart Wheel steering system, adjustable pedals and an ergonomically designed cockpit, it's easy to handle the reins of an American Tradition.



The welcome mat at this ranch automatically flips out to greet you when you open the door of an American Tradition. It's actually a durable Corian® stepwell with power step cover. Keyless entry and a lighted door handle make coming home all the more inviting.



Controls are within easy access and large easy-to-read dials and buttons allow you to make adjustments. An optional high tech information system, called Trip Tek, monitors gas mileage, temperatures, travel time and engine data. It also includes a compass and customer service directory.

S m a r t W h e e l





Did somebody ring the dinner bell?

No wagon train would be complete without a fully equipped and well stocked chuck wagon. In an American Tradition, all you need to supply is the grub. Everything else comes standard, including a three burner range with oven, GE microwave, convection oven, four door Norcold® or two door Dometic® refrigerator, polished Corian® counter top and sink covers and a convenient Moen® pull-out faucet. There are also plenty of quality-built cabinets for pots and pans.



D i n n e r t i m e





N O M O R E L O N G I N G F O R T H E
wide open spaces.

There's plenty of room to stretch one's legs in an American Tradition. Especially in the dining room and kitchen areas. An elegant dinette provides comfortable seating for four and features a Corian® table with an extension and four

upholstered chairs. New optional overhead and wall cabinets are available in your choice of four attractive woods, including walnut, cherry, maple and alpine oak. The American Tradition... Now this is living.



40 QS PALOMINO INTERIOR (WITH OPTIONAL SHIRT WARD)

A GREAT PLACE TO
hang your hat.

Instead of sleeping outdoors under the stars, why not trade in that sleeping bag for an optional king size bed and a standard 20" SONY® Vega TV? Not only will you sleep better, but you'll also wake up refreshed and ready to tackle another day

for horsing around and relaxation. American Tradition has a number of large bedroom closets, drawers and storage compartments to stash your duds, boots and personal belongings. Everything you'll need to head 'em up and move 'em out.

For today's urban Cowboys & Cowgirls.



Riding the range all day on horseback often calls for drastic pain relief measures. Nothing answers the call better than a long, relaxing hot shower. American Tradition puts the average bunk house amenities to shame, with not only gold fixtures and a brass trimmed glass shower door, but also an overhead skylight in the shower. You'll also find Corian® topped vanities and a combination washer and dryer in the bath area to keep both you and your riding attire looking great.



T i m e - o u t



A WIDE VARIETY OF COLOR
Inside and Out.

BLUE ILLUSION

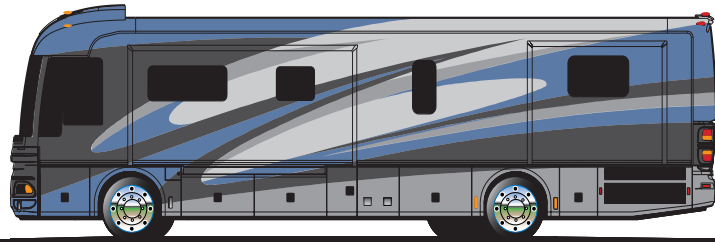

COPPER OASIS

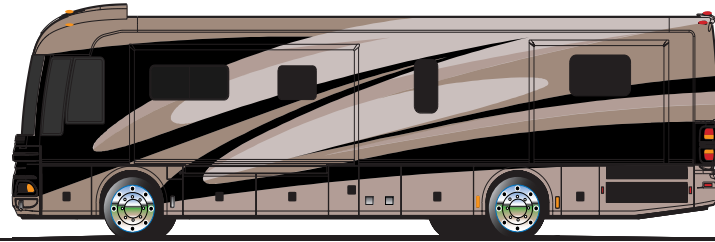

GOLDEN FERN



WINTER WHITE

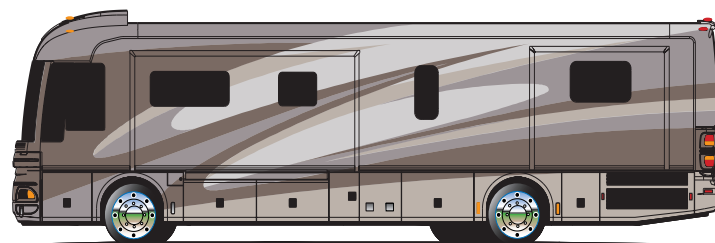

BLUE ILLUSION

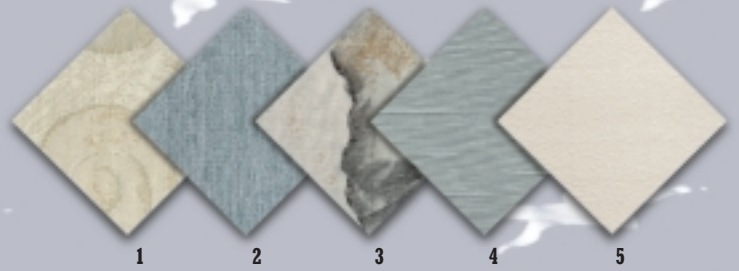

COPPER OASIS

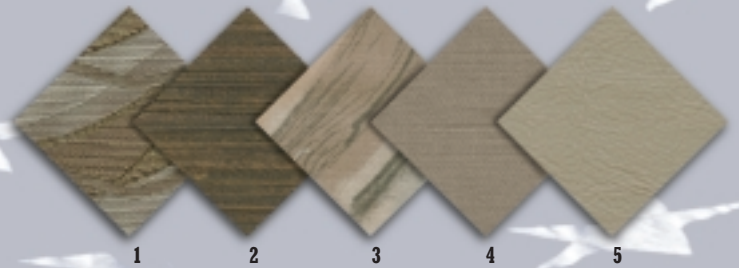

GOLDEN FERN

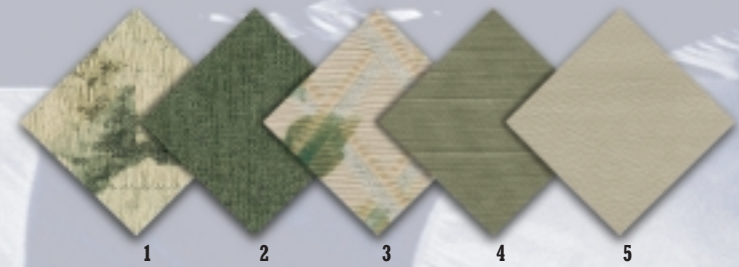

WINTER WHITE



Fabrics

- 1 LIVING ROOM FEATURE
- 2 UPHOLSTERY
- 3 BEDROOM FEATURE
- 4 DRAPERY
- 5 LEATHER

See your dealer for available wood and fabric combinations.



- 1 ANDERSON WALNUT
- 2 CLEAR WHITE MAPLE
- 3 REGENCY CHERRY
- 4 ALPINE OAK

QUALITY CONSTRUCTION
COMES STANDARD ON EVERY
AMERICAN TRADITION.

**7-LAYER FLOOR WITH
ENCLOSED UNDERBELLY**

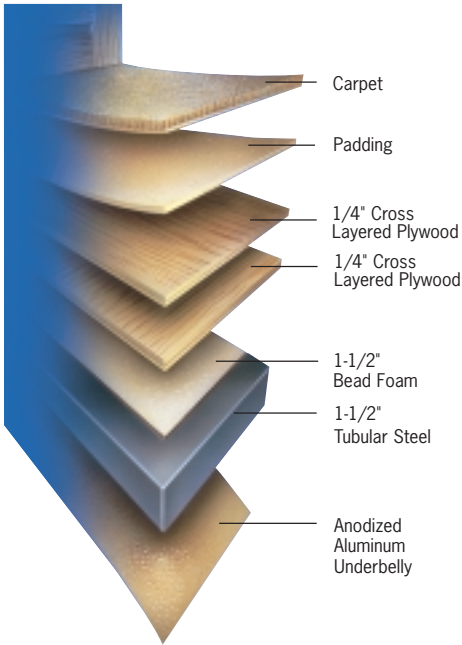

**7-LAYER CEILING
WITH FIBERGLASS ROOF**

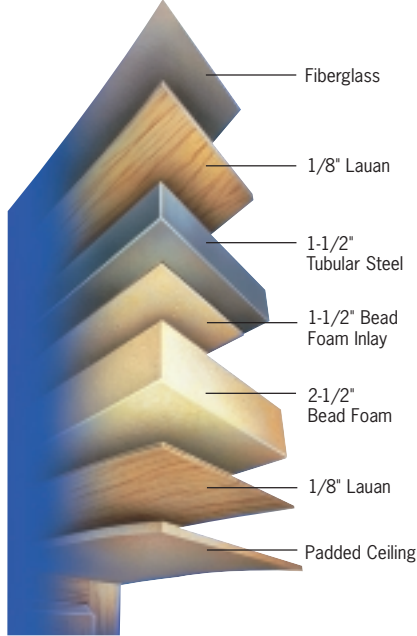

**INSULATED STORAGE
COMPARTMENT**

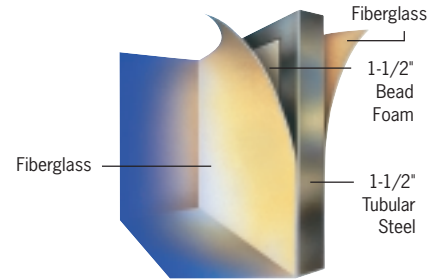

FIBERGLASS SIDEWALLS

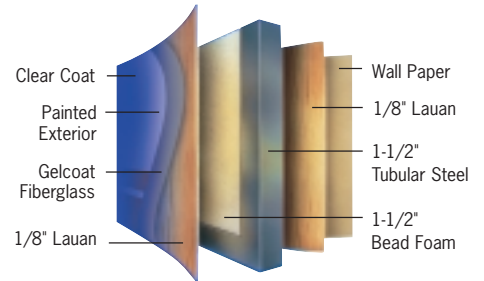

Take any American Tradition for a spin and you'll quickly notice its luxurious ride and superb handling. Spartan custom platform features include a strong foundation with double cross-members reinforced and fastened with the industry's highest quality nuts & bolts. Spartan's Eurotech electrical system is one of the best in the industry. ABS brake testing ensures braking performance before your platform ever leaves the factory. Roadside Companion is Spartan's 24 hour service hotline that gives you the support you need wherever you go.

You'll also be comforted to know your Spartan platform was designed and built by a number of dedicated Spartan engineers who ensure tomorrow's technology is already engineered into each platform today. Rest assured, American Coach wouldn't settle for anything less.



40-G

1. Nightstand w/Overhead
2. Speaker Soffit w/Lighting
3. Queen Bed 60" x 80" Slide-out
4. Rear Wardrobe
5. 20" Rear TV
6. Linen w/Hamper Rollouts
7. Shower
8. Dometic® Side-by-Side Fridge w/Ice-Maker
9. Microwave
10. 3 Burner w/Oven
11. Galley Overhead
12. Table w/Flexsteel® Fabric Chairs
13. Flexsteel® Fabric Easy Bed
14. Flexsteel® Fabric Love Seat
15. Overhead Storage
16. Flexsteel® Fabric Driver/Passenger Seats w/Power Driver Seat/Manual Lumbar
17. 24" Front TV in Overhead

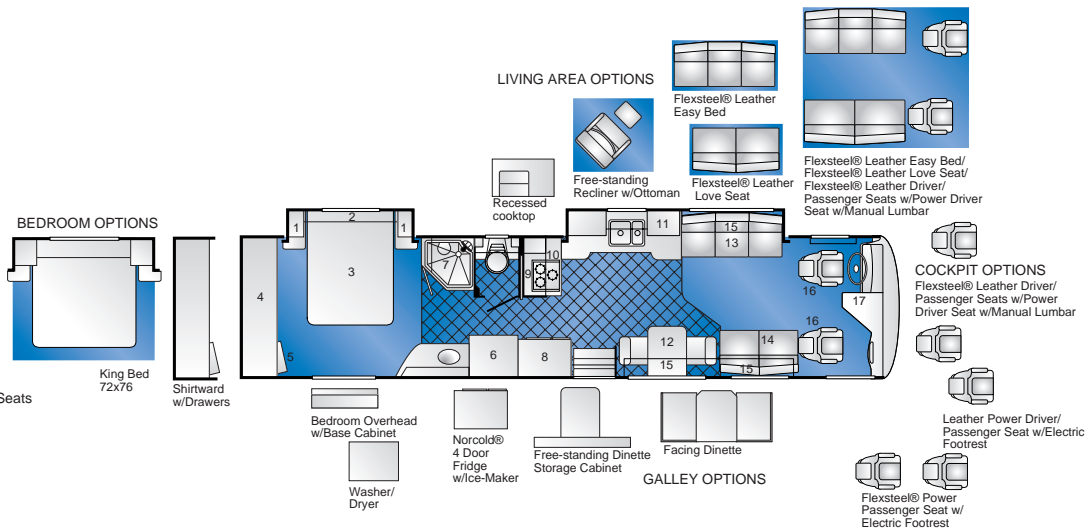

40-W

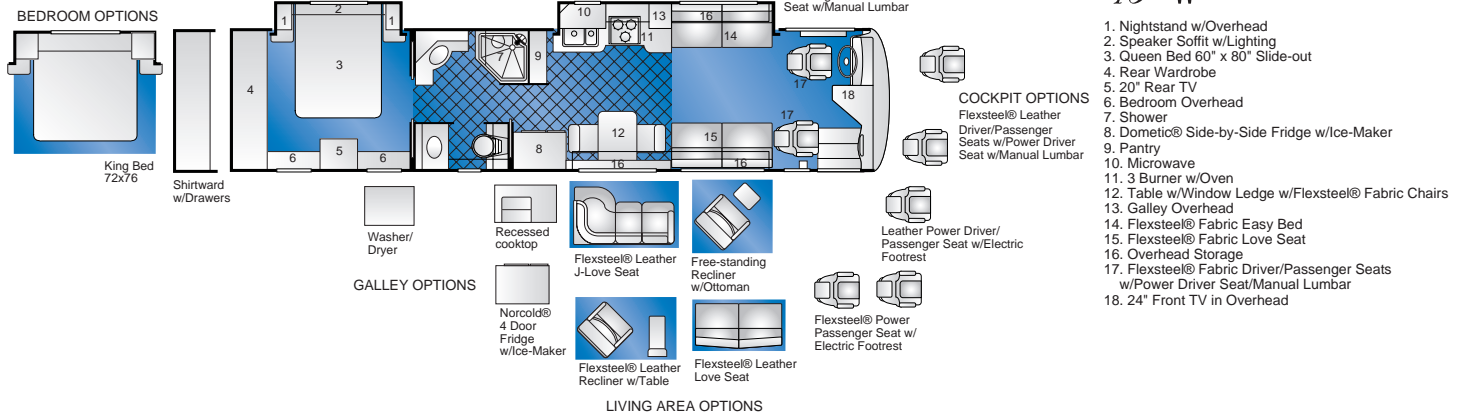

40-T

1. Nightstand w/Overhead
2. Speaker Soffit w/Lighting
3. Queen Bed 60" x 80" Slide-out
4. Rear Wardrobe
5. 20" Rear TV
6. Bedroom Cabinet Overhead
7. Linen Cabinet
8. Shower
9. Norcold® 4-Door Fridge w/Ice-Maker
10. Table w/Flexsteel® Fabric Chairs
11. Microwave
12. 3 Burner w/Oven
13. Galley Overhead
14. Flexsteel® Fabric Sofa Bed
15. Villa® Leather Euro Recliner w/Ottoman
16. Overhead Storage
17. Flexsteel® Fabric Driver/Passenger Seats w/Power Driver Seat/Manual Lumbar
18. 24" Front TV in Overhead

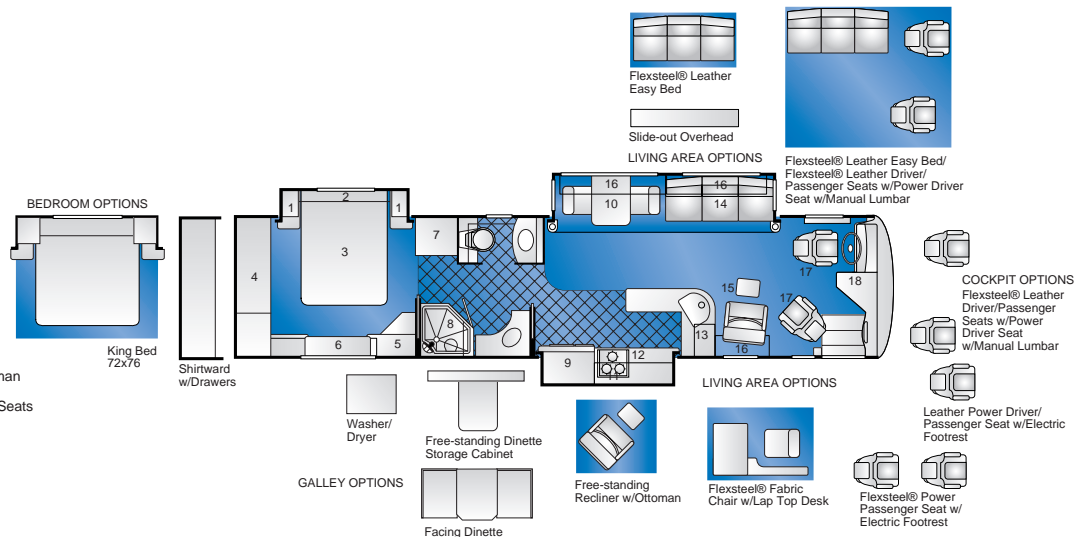

40-M

1. Nightstand w/Overhead
2. Speaker Soffit w/Lighting
3. Queen Bed 60" x 80" Slide-out
4. Rear Wardrobe
5. 20" Rear TV
6. Linen w/1 Drawer Upper Storage
7. Shower
8. Bath Linen Cabinet
9. Pantry
10. Dometic® Side-by-Side Fridge w/Ice-Maker
11. Microwave
12. 3 Burner w/Oven
13. Table w/Flexsteel® Fabric Chairs
14. Galley Overhead
15. Flexsteel® Fabric Easy Bed
16. Flexsteel® Fabric Love Seat
17. Overhead Storage
18. Flexsteel® Fabric Driver/Passenger Seats w/Power Driver Seat/Manual Lumbar
19. 24" Front TV in Overhead

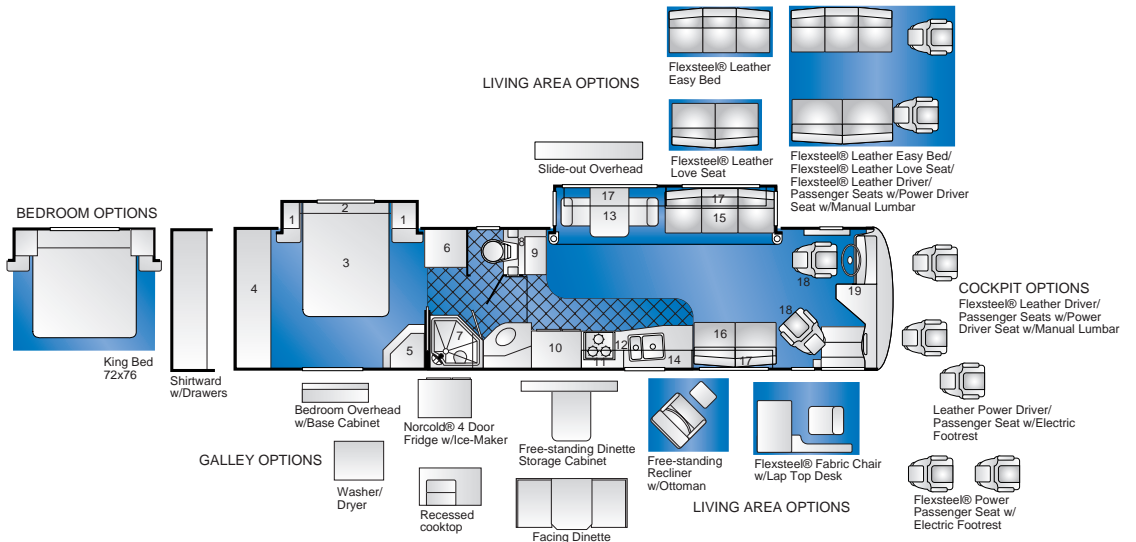

BEDROOM OPTIONS

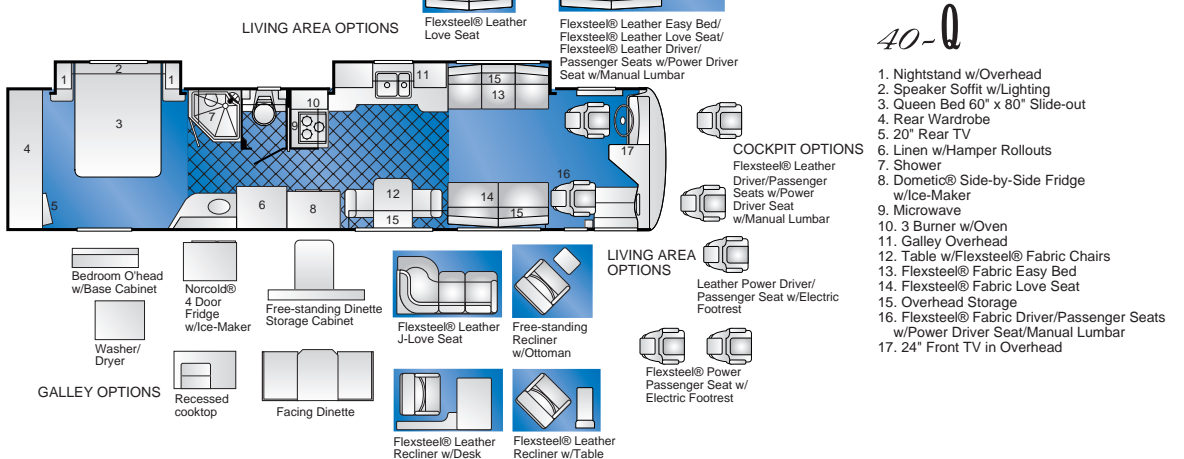
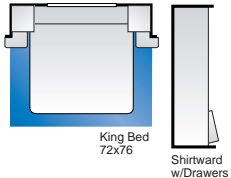

40-Q

1. Nightstand w/Overhead
2. Speaker Soffit w/Lighting
3. Queen Bed 60" x 80" Slide-out
4. Rear Wardrobe
5. 20" Rear TV
6. Linen w/Hamper Rollouts
7. Shower
8. Dometic® Side-by-Side Fridge w/Ice-Maker
9. Microwave
10. 3 Burner w/Oven
11. Galley Overhead
12. Table w/Flexsteel® Fabric Chairs
13. Flexsteel® Fabric Easy Bed
14. Flexsteel® Fabric Love Seat
15. Overhead Storage
16. Flexsteel® Fabric Driver/Passenger Seats w/Power Driver Seat/Manual Lumbar
17. 24" Front TV in Overhead

40-U

1. Nightstand w/Overhead
2. Speaker Soffit w/Lighting
3. Queen Bed 60" x 80" Slide-out
4. Rear Wardrobe
5. 20" Rear TV
6. Linen
7. Shower
8. Dometic® Side-by-Side Fridge w/Ice-Maker
9. Microwave
10. 3 Burner w/Oven
11. Galley Overhead
12. Table w/Fabric Chairs
13. Flexsteel® Fabric Easy Bed
14. Flexsteel® Fabric Love Seat
15. Overhead Storage
16. Flexsteel® Fabric Driver/Passenger Seats w/Power Driver Seat/Manual Lumbar
17. 24" Front TV in Overhead

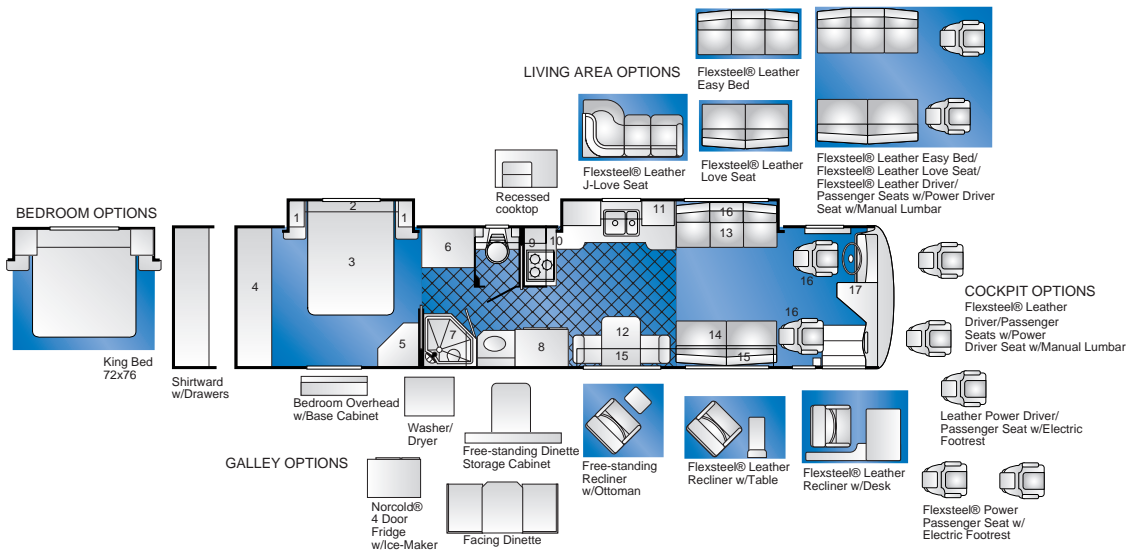

STANDARD & OPTIONAL FEATURES

Automotive

- S Engine - Cummins® C.8.3 Liter, 350 hp ISC Diesel
- S Transmission - Allison® 3000 MH, 6-Speed Automatic
- S Spartan® Mountain Master Chassis
- S Independent Front Suspension
- S Steel Surface on Front Bulkhead/Engine Frame
- S Bus Style 50" Large Windshield
- S Intermittent Wipers
- S Smart Wheel
- S Tilt/Telescoping Steering Wheel
- S Double Swivel Visors
- S Back Lighted Instrument Panel
- S Driver/Passenger Wood Cupholder
- S Slide-Out Battery Tray
- S (4) 6V House Batteries on Slide-out Tray, 440 Amp
- S (2) 12V Chassis Batteries - 2000 CCA
- S Electronic Battery Control Center
- S Undercoating
- S (4) Cast Aluminum Wheels
- S Battery Disconnect Switch
- S Denso Climate Control System
- S Trailer Hitch Receiver 10,000 Lb. Capacity*
- S Cruise Control
- S Auxiliary Start Circuit
- S Auxiliary Fog Lights
- S Michelin Radial Tires
- S Tire Pressure Check Gauge
- S 3-Point Leveling Jacks
- S Flexsteel® Fabric Driver/Passenger Seats w/Manual Lumbar/6-Way Power Driver Seat
- S Rear Vision System with One-Way Audio
- S Visteon® AM/FM Cassette
- S CB Radio Ready
- S Black "Bus-Like" Heated Mirrors with Remote Adjustments
- S Mud Flaps
- S Utility Light - Front & Rear
- S Air Horns
- S I.C.C. Light Switch
- S Driver/Passenger Map Lights
- S Anti-Lock Braking System (ABS)
- S Full Air Brakes with Automatic Slack Adjusters
- S Pneumatic Stepwell Cover (Not Available on G Model)
- S Exhaust Brake
- S Power Driver Window
- S Manual Air Dump Override Switch
- S Sound Insulation In Subfloors, Front & Rear
- S Adjustable Pedals
- 0 V.I.P. Delivery
- 0 Flexsteel® Leather Driver/Passenger Seats w/Manual Lumbar/6-Way Power Driver Seat
- 0 Flexsteel® Power Passenger seat w/Electric Foot Rest (Fabric or Leather)
- 0 XM Satellite Radio
- 0 Hand-Held CB
- 0 Digital Satellite System Trackvision
- 0 GPS System
- 0 Night Vision
- 0 Trip Tek

Structural

- S Stacked Rail Chassis Frame
- S Steel Reinforced Vacubond Sidewall, Roof & Floor Construction
- S Steel Outriggers on Chassis
- S Heated Water & Holding Tank Compartments
- S Vacubond Insulated Storage Area
- S Vacubond Walls with Smooth Exterior Skin
- S Bonded Windshield with Frame

Exterior

- S Domed Fiberglass Roof with Radius Corners
- S Exterior Rinse Hose
- S Full Fiberglass Front & Rear Caps
- S Fiberglass Front Fascia
- S Fiberglass Front & Rear Quarter Panels
- S Fiberglass Molded Front Bumper
- S Porch Light
- S Halogen Headlamps
- S Dual Holding Tank San-T-Flush System
- S One-Piece Domed Fiberglass roof
- S Tank Level Monitor
- S Manual Generator Slide-Out
- S 40 Gallon LPG Tank
- S Exterior Graphics (4 Colors) All Paint with Color Coded Awning Arms
- S Power Single Entry Step
- S 31" Front Entry Door with Dead Bolt & Pneumatic (Air) Lock (Not Available in G Model)
- S Entry Assist Handles
- S Exterior Flip-Up Storage Doors
- S Luggage Compartment Lights
- S Protective Front Cover w/Logo
- S Front & Rear Docking Lights
- S Exterior Convenience Light at Dump Valves
- S Awning/Drip Rail Molding (DS,RS)
- S Dual Pane Windows w/Screens
- S Park Telephone Ready
- S Patio Receptacles
- S Holding Tanks with Low Point Drain Valves
- S Gravity Fresh Water Fill
- S Fiberglass Wheel Trims
- S Window Awnings
- S 20' Carefree Patio Electric Awning (Not Available on T Model)
- S 12' Doorside Window Awning (Not Available on T Model)
- S Front Entry Door Awning (Not Available on G Model)

- 0 Two-Piece Ladder
- 0 Solar Charging Panel
- 0 Keyless Entry
- 0 54" Compartment Slide-Out Storage Tray
- 0 36" Compartment Slide-Out Storage Tray
- 0 90" Compartment Slide-Out Storage Tray
- 0 Electric Awning - Girard (Not Available on T Model)
- 0 Rear Rockguard Mud Flap
- 0 Spotlight
- 0 Power Antenna w/Warning Light
- 0 Exterior Entertainment Center w/TV on Slide-Out Tray
- 0 3M® Clear Front Mask
- 0 3M® Clear Front Mask w/Night Vision

Appliances

- S (2) 13.5 M Low Profile Roof Air Conditioner
- S Onan® 7.5 kw Quiet Diesel Generator Front Slide-out Manual
- S Dual Furnaces w/Thermostat & Automatic Ignition, 34,000 BTU (Each)
- S Dometic® 120V/LPG Electric Side-By-Side Refrigerator w/Ice Maker (Not Available in T Model)
- S Norcold 120V/LPG 4-Door Refrigerator with Ice Maker (T Model only)
- S Recessed 3 Burner Range with Oven & Corian® Cover
- S Microwave/Convection Oven w/Built-In Range Hood
- S Water Filter
- S TV Antenna with 2 Jacks
- S Satellite Ready
- S 24" Sony® Vega TV (Front) w/Remote
- S 20" Sony® Vega TV (Rear) w/Remote
- S VHS - VCR (Stereo)
- S Battery Monitor
- S Multi-Point Water Pump Switching
- S Residential China Bowl Toilet with Flush
- S DSI 10 Gallon Water Heater 120V/LPG
- S Smoke Detector/Alarm
- S Fire Extinguisher
- S LPG Leak Detector/Alarm
- S Carbon Monoxide Detector/Alarm
- S 50 Amp Power Cord
- S Rigid Furnace Ducting System
- S Continuous Ducted Ceiling A/C
- S Water Heater By-Pass
- S Trace RV Series Inverter 2500
- S Energy Management System

- 0 Automatic Generator Start Switch
- 0 Washer/Dryer
- 0 Norcold® 120V/LPG 4-Door Refer w/Ice Maker (Standard in T Model)
- 0 Recessed 3 Burner Range with Corian® Cover (Not Available in T Model)
- 0 Sony® Home Theater Sound
- 0 "In Motion" DSS System w/Sony® Receiver
- 0 Rain Sensor Vents
- 0 Norcold® 12V/120 Chest Freezer (Not Available in T Model)
- 0 CD Changer
- 0 Central Vacuum Cleaner
- 0 Low Profile A/C w/Heat Pump

Galley

- S Corian® Sink Covers
- S Corian® Galley Top
- S Extra Large Stainless Steel Kitchen Sink, Double Bowl (Not Available in T Model)
- S Large Single Corian® Kitchen Sink (T Model only)
- S Moen® Single Lever Galley Faucet (Not Available in T Model)
- S Moen® One Touch Galley Faucet (T Model only)
- S Ceramic Tile Flooring
- S Wood Refrigerator Door Inserts
- S Corian® Dinette Table with Extension & 4 Chairs
- S 120 Volt Outlet & Telephone Jack at Dinette
- 0 Nuheat Heated Tile Floor
- 0 Dinette Base Cabinet

Bath

- S Corian® Lavy Top w/Porcelain Bowl & Moen® Faucet
- S Deluxe Medicine Cabinet
- S Ceramic Tile Flooring
- S Skylight in Shower
- S Deluxe Fiberglass Shower w/Fold-Down Seat
- S Power Bath Vent
- S Residential Size Sink
- S Glass Shower Door
- S Moen® Hand Held Shower Head

- 0 Obscure Glass in Shower
- 0 Nuheat Heated Tile Floor

Bedroom

- S Restonic® Reversible Pillowtop Mattress w/Soft & Firm Sides
- S 60" x 80" Queen Bed
- S Comforter with (2) Shams & Throw Pillows (2)
- S Day/Night Pleated Shades
- S Corian® Nightstand Tops

- 0 King Bed
- 0 Bedroom Base & Overhead Cabinet
- 0 Shirt Wards with Drawers
- 0 12V Ceiling Fan

Interior

- S TV Antenna
- S TV Cable Ready
- S Monitor Panel
- S Alpine Oak, Walnut, Cherry or Clear White Maple Cabinetry
- S Solid Wood Drawers
- S Solid Core Raised Panel Upper Cabinet Doors
- S Non Skid Cabinet Shelves
- S Brass Accessories
- S Vinyl Ceiling
- S Beveled Glass Mirrors
- S Cedar-Lined Wardrobe
- S Wardrobe Light
- S Wall-To-Wall Carpet (Bedroom & Living Areas)
- S Valances with Lambrequins Throughout
- S Windshield Drape Track System
- S Mini-Blinds in Living Room
- S Sofa Pillows (2)
- S Fabric Decor Headboard
- S Roller Guide Drawer Slides with Ship Locks
- S Indirect Fluorescent Decor Lighting
- S Fabric Living Room Furniture by Flexsteel
- S Entry Step Switch at Entry Wall
- S Interior Multi-Plex Switches
- S Wood TV Overhead

- 0 Day/Night Pleated Shades (Living Area & Dinette)
- 0 Flexsteel Leather Furniture

*The chassis manufacturer recommends the installation of a supplemental brake control system to activate the brakes on the vehicle or trailer you are towing.



Settling in at your final destination goes much more smoothly with a brightly lit hook up station that's fully equipped for quick cleanups. You'll also grow to love the new gravity water fill that's now standard on all American Traditions®.



D I M E N S I O N S & C A P A C I T I E S

Weights (pounds)

	40-G	40-W	40-T	40-M	40-Q	40-U
GVWR (lbs.)(1)	33,700	33,700	33,700	33,700	33,700	33,700
Front GAWR (lbs.)(2)	13,700	13,700	13,700	13,700	13,700	13,700
Rear GAWR (lbs.)(2)	20,000	20,000	20,000	20,000	20,000	20,000
Base Weight (lbs.)(3)	27,350	27,750	28,450	27,600	27,450	27,250
GCWR (lbs.)(4)	43,700	43,700	43,700	43,700	43,700	43,700
Hitch Rating Weight (lbs.)*	10,000	10,000	10,000	10,000	10,000	10,000
Tongue Weight (lbs.)*	1,000	1,000	1,000	1,000	1,000	1,000

Measurements

	40-G	40-W	40-T	40-M	40-Q	40-U
Wheel Base	266"	266"	266"	266"	266"	266"
Overall Length (5)	40'	40'	40'	40'	40'	40'
Overall Height w/AC	12' 5.5"	12' 5.5"	12' 5.5"	12' 5.5"	12' 5.5"	12' 5.5"
Overall Width (max) (6)	101.5"	101.5"	101.5"	101.5"	101.5"	101.5"
Interior Height (max)	82"	82"	82"	82"	82"	82"
Interior Width (max)	96"	96"	96"	96"	96"	96"

Tank & Liquid Capacities (gallons)

	40-G	40-W	40-T	40-M	40-Q	40-U
Fresh Water Holding Tank (gal.)	95	95	95	95	95	95
Grey Water Holding Tank (gal.)	60	60	60	60	60	60
Black Water Holding Tank (gal.)	40	40	40	40	40	40
Appliance LPG Tank (WC) (7)	40.3	40.3	40.3	40.3	40.3	40.3
Water Heater Tank (gal.)	10	10	10	10	10	10
Fuel Capacity (gal.)	150	150	150	150	150	150

Chassis

Frame	Spartan® Mountain Master GT Stacked Rail
Engine	Cummins® C.8.3L/350 hp ISC Diesel
Torque	1050 @ 1400 RPM
Transmission	Allison® 3000 MH, 6-Speed w/Electronic Shifter
Alternator Amps	200 Amp Leece Neville
Tires	295/80 R22.5LRH Low Profile Highway Radial

Liquid Weight Reference: Water (gal./ltrs.)=(8.3 lbs./3.8 kgs.), Fuel (gal./ltrs.)=(7.1 lbs./3.2 kgs.), LPG (gal./ltrs.)=(4.2 lbs./1.9 kgs.)
Metric Conversion: Multiply pounds x 0.453 to obtain kilograms, Multiply gallons x 3.785 to obtain liters

- (1) **GVWR (Gross Vehicle Weight Rating):** Means the maximum permissible loading weight of the motor home. GVWR is equal to or greater than the sum of the unloaded vehicle weight plus the net carrying capacity.
- (2) **GAWR (Gross Axle Weight Rating):** Means the maximum permissible loaded weight a specific axle is designed to carry.
- (3) **BW (Base Weight):** Means the weight of the motor home without fuel, options, water, cargo or passengers.
- (4) **GCWR (Gross Combined Weight Rating):** Means the value specified by the motor home manufacturer as the maximum allowable loaded weight of this motor home with its towed vehicle. Towing and braking capacity may differ. Refer to Fleetwood and chassis manufacturer manuals for complete information.
- (5) Length taken from front bumper to rear bumper (excludes accessories).
- (6) Excludes safety equipment and awnings.
- (7) Tank Manufacturer's listed water capacity (WC). Actual LPG capacity is 80% of water listed as required by the safety code.

*The chassis manufacturer recommends the installation of a supplemental brake control system to activate the brakes on the vehicle or trailer you are towing.

IMPORTANT-PLEASE READ: Product information, photography and illustrations included in this publication were as accurate as possible at the time of printing. For further product information and changes, please visit our website at www.fleetwoodrv.com or contact your local Fleetwood dealer. Prices, materials, design and specifications are subject to change without notice. All weights, fuel, liquid capacities and dimensions are approximate. Fleetwood has designed its recreational vehicles to provide a variety of uses for its customers. Each vehicle features optimal seating, sleeping, storage and fluid capacities. The user is responsible for selecting the proper combination of loads (i.e. occupants, equipment, fluids, cargo, etc.) to ensure that the vehicle's capacities are not exceeded.

©2002 Fleetwood Enterprises, Inc. Inventory control number AT03b1 1st Edition 9/02

ELECTRONIC 350

Need a little reassurance for your Rocky Mountain ramblings? Tackle the high country with this fully electronic Cummins® 350 hp ISC diesel engine. It delivers state-of-the-art diagnostics, improved fuel economy, reduced emissions, a quieter ride, more miles between service stops, and the highest power-to-weight ratio in its class.

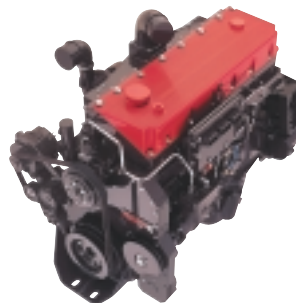

Access to your diesel generator is easy, and should your batteries ever run low, you'll now have peace of mind knowing your generator will automatically take over thanks to a new automatic start feature.

SEE AMERICA FROM A DIFFERENT
Point of View.



We believe the trip is always a little more meaningful when you travel our country in an American Coach. Because you're riding in a motorhome that was built by pride-filled Americans... for Americans. Americans who cherish the freedoms that have made this country the greatest country in the world. And, like you, we're prepared to keep those freedoms intact.

Our optional VIP Delivery Service takes place right here in the heartland at our factory in Decatur, Indiana. We'll do everything in our power to make you feel like part of our family the minute you take possession of your American Coach. It's an ideal opportunity to learn everything about your new vehicle firsthand from the

very people who proudly designed and built it.

Not only will you drive away with a Fleetwood 1 year/3 year RV Ownercare service and warranty card, you'll drive away with peace of mind, knowing you can rely on us wherever you are in the country, for roadside assistance, service and answers to any question you may have.

As an American Coach owner, you're automatically eligible to become a member of three active and fun-loving owner groups. The American Coach Association, American Coach chapter of FMCA and Club Fleetwood... great people who love to travel and party at beautiful resorts and vacation spots all across America.

American
COACH

Come Visit us in Decatur, Indiana and take our plant tour. Call (800) 648-6582 for tour hours.
Fleetwood Motorhomes of Indiana, Inc. • Plant #44 • 1031 U.S. 224 East • Decatur, Indiana 46733-5006 • (260) 728-2121 (800) 648-6582

FLEETWOOD RV™
www.fleetwoodrv.com