



**SPORTSMASTER**  
by EXTREME

BIG  
capture<sup>^</sup> adventures.

**GO BIG  
OR GO HOME!**  
BUY  
  
EXTREME FUN







267TS in Spice Interior

**BIG ADVENTURES**

Let's face it, what's the point of getting out of town in your trailer but not being able to enjoy the view? That's why our new Sportsmaster units feature huge tinted windows throughout the entire coach – take a breather and relax on the ultra-comfy pillow back sofa while enjoying an un-obscured view of the outdoors. Our trailers are Extreme-ly different - incorporating the creature comforts of home with the ease and durability necessary for travel. We offer unique custom features such as arched hardwood cabinet doors (reminiscent of home), a roll-out pantry, a kitchen sink pull-out sprayer (making clean-up a breeze), and even a designer clock. Not only did we use modern styling on the sofa (this isn't your grandmother's trailer!), we incorporated microfiber\* for a soft look and touch, with easy clean up. You'll also notice our trailers are very well lit: extra ceiling lighting, adjustable reading lights over the sofa and bed, and designer wall sconces - all in a custom oil-rubbed bronze finish. The extra details and durability of our Sportsmaster units will make you Extreme-ly comfortable as your entire family heads out to create new memories and have **big family adventures!**

\*model-specific



267TS in Mocha Interior

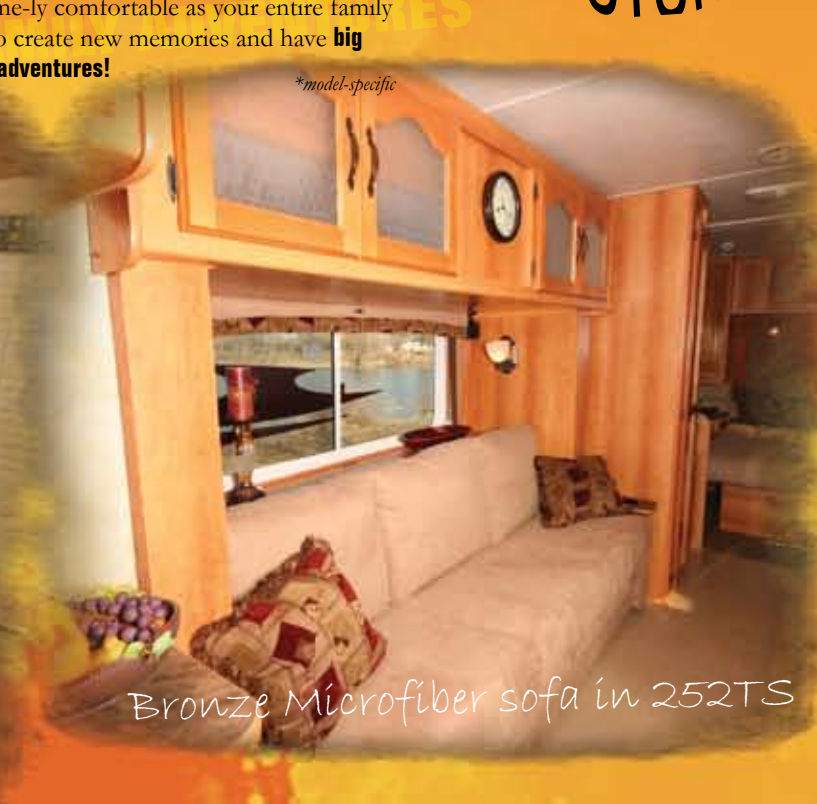

Bronze Microfiber sofa in 252TS



Kitchen in 252TS

**BIG HISTORY**

Extreme RVs, LLC was created from an employee purchase of KIT Manufacturing Company's RV Division on January 29, 2003. Extreme RVs retained the former company's product lines: Companion, Road Ranger, Extreme SUTs, Sportsmaster, and Monterey.

KIT Manufacturing had been started as a co-partnership in October 1945 in Long Beach, California, for the purpose of manufacturing and marketing a pre-fabricated, camper-type, teardrop trailer which could be shipped in a "kit" or package complete with component parts. The sportsman could then assemble the unit himself.

Shortly thereafter, the company began manufacturing a completely finished "teardrop" trailer with innerspring mattress, water tank, and an all-aluminum kitchen with a butane stove and ice box. A strong sales and advertising program was initiated, popularizing the new type trailers through department stores, gasoline stations, trailer dealers, and new and used car dealers. The company grew from 2 units a week to 120 units a week and continued to increase from there.

Over the years, the company developed a reputation for a quality built unit. KIT units, and now Extreme RV units, maintain one of the highest resale values on the market.

**BIG FUTURE**

Extreme RVs proudly carries on the KIT legacy as we continue to manufacture quality products while building a new legacy of introducing cutting-edge decors and affordable luxury features!

252TS Bedroom in Bronze Interior



252TS in Bronze Interior

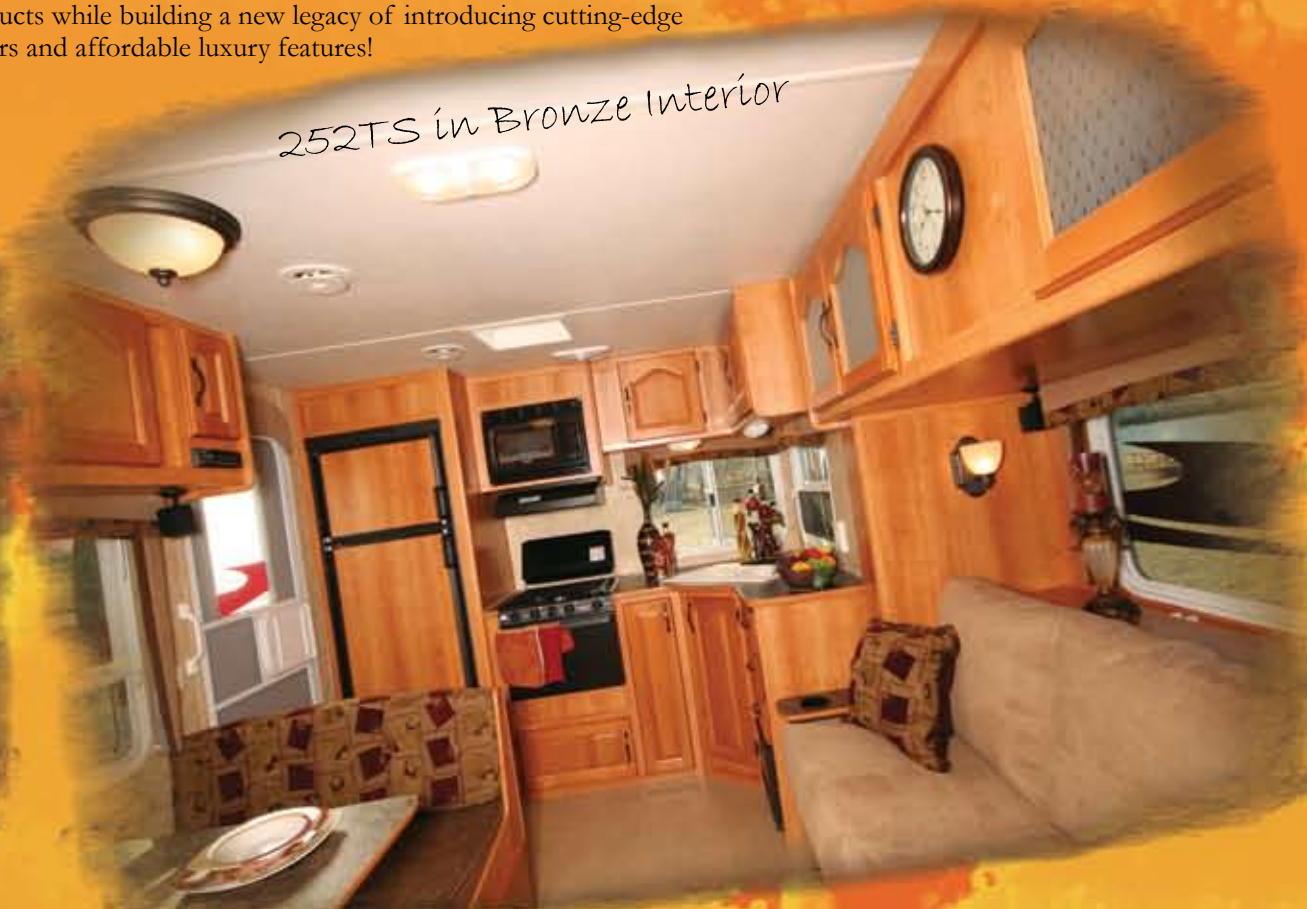



# Travel Trailers

# BIG OPTIONS

194TS

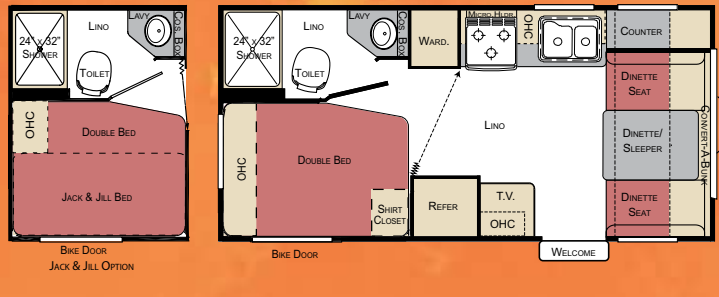

267TS

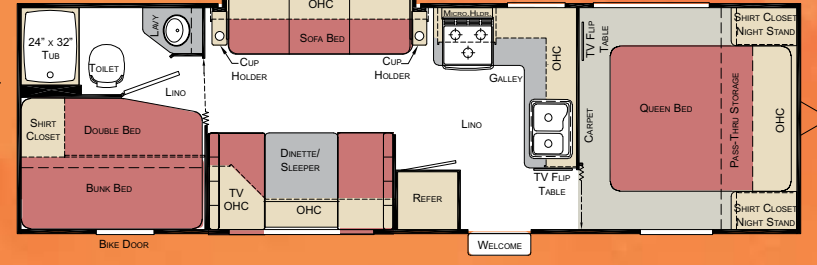

222TS

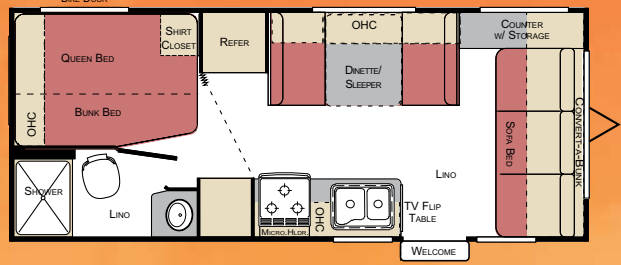

269TS

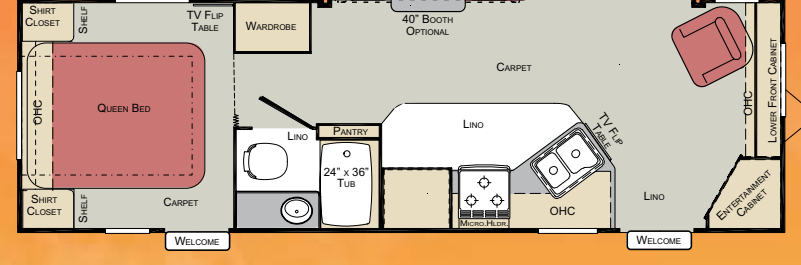

228TS

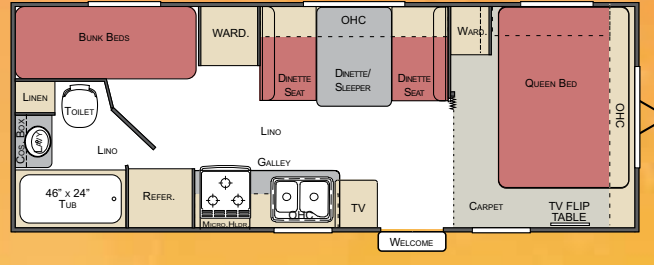

295TS

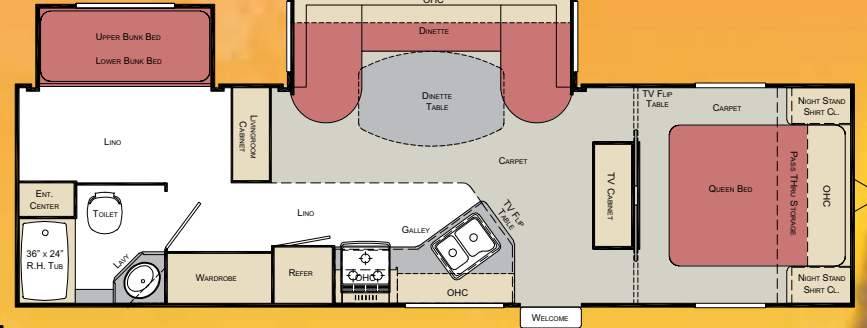

237TS

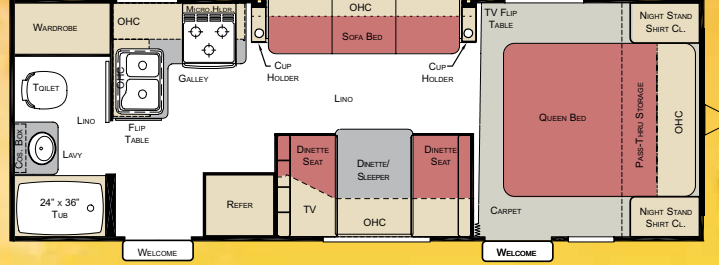

Fifth wheel

252TS

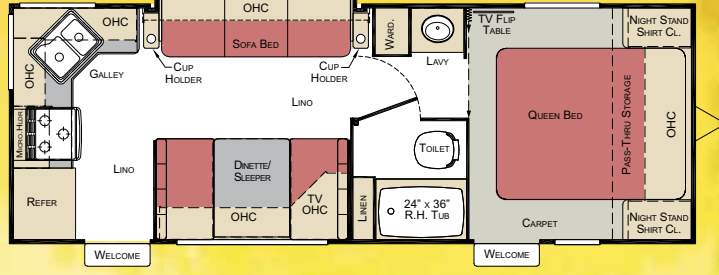

235FS

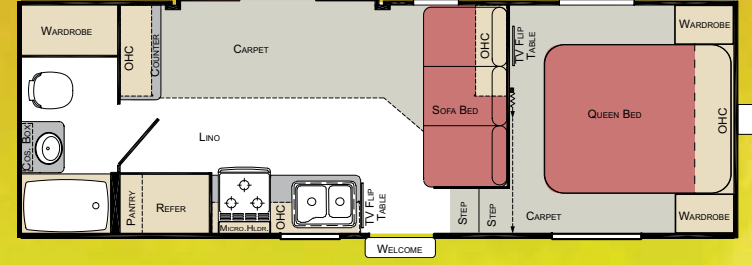

## Specifications

MODEL	194TS	222TS	228TS	237TS	252TS	267TS	269TS	295TS	235FS
<b>Sleeping</b>	3-6	4-7	4-6	4-6	4-6	6-9	3-6	4-6	4-6
<b>CAPACITY</b>									
<b>Furnace</b>	19m	25m	25m	25m	25m	25m	25m	25m	25m
<b>Fresh water</b>	30	40	40	50	50	50	40	50	40
<b>Water heater</b>	6	6	6	6	6	6	6	6	6
<b>Holding black</b>	27	27	40	40	40	27	40	40	40
<b>holding gray</b>	30	30	40	40	40	30	40	40	40
<b>Tire &amp; load range</b>	ST205/75 R15C	ST205/75 R15C	ST205/75 R15C	ST205/75 R15C	ST205/75 R15C	ST205/75 R15C	ST225/75 R15D	ST225/75 R15D	ST225/75 R15D
<b>WEIGHTS</b>									
<b>Overall Wt</b>	3730	4145	4790	5180	5160	5450	6615	7530	6040
<b>hitch</b>	450	435	540	560	730	790	705	930	895
<b>gvwr</b>	7340	7325	7405	7420	7550	7590	9210	9900	9470
<b>carrying capacity</b>	3610	3180	2615	2240	2390	2140	2595	2370	3430
<b>SIZE</b>									
<b>length</b>	19' 11"	22' 11"	24' 11"	25' 11"	25' 11"	29' 9"	29' 2"	33' 1"	25' 2"
<b>width</b>	95"	95"	95"	95"	95"	95"	95"	95"	95"
<b>height</b>	9' 8"	9' 8"	9' 8"	9' 8"	9' 8"	9' 8"	10' 4"	10' 4"	12' 0"
<b>width (int)</b>	91 3/4"	91 3/4"	91 3/4"	91 3/4"	91 3/4"	91 3/4"	91 3/4"	91 3/4"	91 3/4"
<b>height (int)</b>	80"	80"	80"	80"	80"	80"	80"	80"	101"
<b>height (bedroom)</b>									73"

\*The overall weight (or unloaded trailer weight) listed above is an approximate weight. As the weight of component parts and materials installed in each trailer vary, depending on the changing nature of the materials available and used during the manufacturing process, the weights listed above may be greater or lesser by a factor of up to fifteen percent. If the customer has concerns about the towing capacity of the intended tow vehicle and the actual trailer weight, including any dealer installed equipment and gross vehicle weight rating, customer is advised to have the trailer weighed to determine the actual weight of the trailer. Additionally, you are advised to consult your tow vehicle dealer to ensure that your tow vehicle has adequate towing capacity for the trailer and cargo carrying capacity weights listed above.





# Features

## Interior

- ▶ Custom Extreme interiors
- ▶ Stylish & durable linoleum
- ▶ Maple hardwood arched overhead cabinet doors
- ▶ Designer glass cabinet doors in slide-out cabinets (*model specific*)
- ▶ Residential-style oil-rubbed bronze kitchen & bath fixtures & hardware
- ▶ Oil-rubbed bronze kitchen faucet with pull-out sprayer
- ▶ Roll-out pantry in kitchen (*model specific*)
- ▶ Big Drawers under dinette
- ▶ Matching entry floor mat
- ▶ Embroidered kitchen towel
- ▶ HUGE tinted windows in living area
- ▶ Residential-style oil-rubbed bronze wall sconces & dinette lighting
- ▶ Enhanced ceiling lights
- ▶ Custom hard-side valances with logo throughout coach
- ▶ Contemporary sofas with luxurious pillow back
- ▶ Long-lasting, stain-resistant microfiber sofas (*Bronze & Mocha interiors*)
- ▶ Elegant throw pillows in coordinating colors
- ▶ Oil-rubbed bronze deluxe clock
- ▶ Durable retracting shower door
- ▶ Mirrored wardrobe door in lavy (*model specific*)
- ▶ Custom-built medicine cabinet in lavy
- ▶ Matching floor mat for toilet
- ▶ Embroidered bath towels
- ▶ ABS tub/shower wall surround
- ▶ Futon mattress with designer body pillow
- ▶ Designer hardwood headboard with coordinating fabric insert
- ▶ Adjustable oil-rubbed bronze reading lights over bed
- ▶ HUGE tinted windows in bedroom
- ▶ Bedroom carpet & pad (*model specific*)
- ▶ Bedroom TV flip table (*model specific*)

## Exterior

- ▶ Chrome wheels
- ▶ Spare tire cover
- ▶ Custom ABS LPG cover
- ▶ Custom ABS fender skirt
- ▶ Full walk-on roof
- ▶ Radius entry & baggage doors
- ▶ A&E Awning
- ▶ Cable TV jack
- ▶ 6 gal. gas DSI water heater
- ▶ R-18 insulation in roof
- ▶ Double entry steps
- ▶ Long-lasting clear LED clearance & tail lights
- ▶ Diamond plate front rock guard & bumper cover

# Options

## Interior

- ▶ Durable outdoor dishes & silverware
- ▶ 8 cu. ft. refer
- ▶ Microwave
- ▶ Water purifier
- ▶ Flat-screen TV/DVD combo
- ▶ Automotive stereo with MP3 player connection
- ▶ Convert-a-bunk (*model specific*)
- ▶ Mattress with coordinating designer bedspread
- ▶ Jack & Jill Bed (*model specific*)
- ▶ 13.5 ducted & non-ducted A/C (*model specific*)
- ▶ Bath skylight
- ▶ EZ winterization

## Exterior

- ▶ Exterior speakers
- ▶ Outside BBQ
- ▶ Fiberglass exterior
- ▶ Leveling jacks
- ▶ Outside wash station
- ▶ Roof ladder only
- ▶ Rack and ladder
- ▶ Shocks
- ▶ Power jack
- ▶ Hitch and utility lights
- ▶ Large exterior assist handle
- ▶ Digital Satellite System wiring
- ▶ Heated and enclosed fresh water tank



Quality Built since 1945

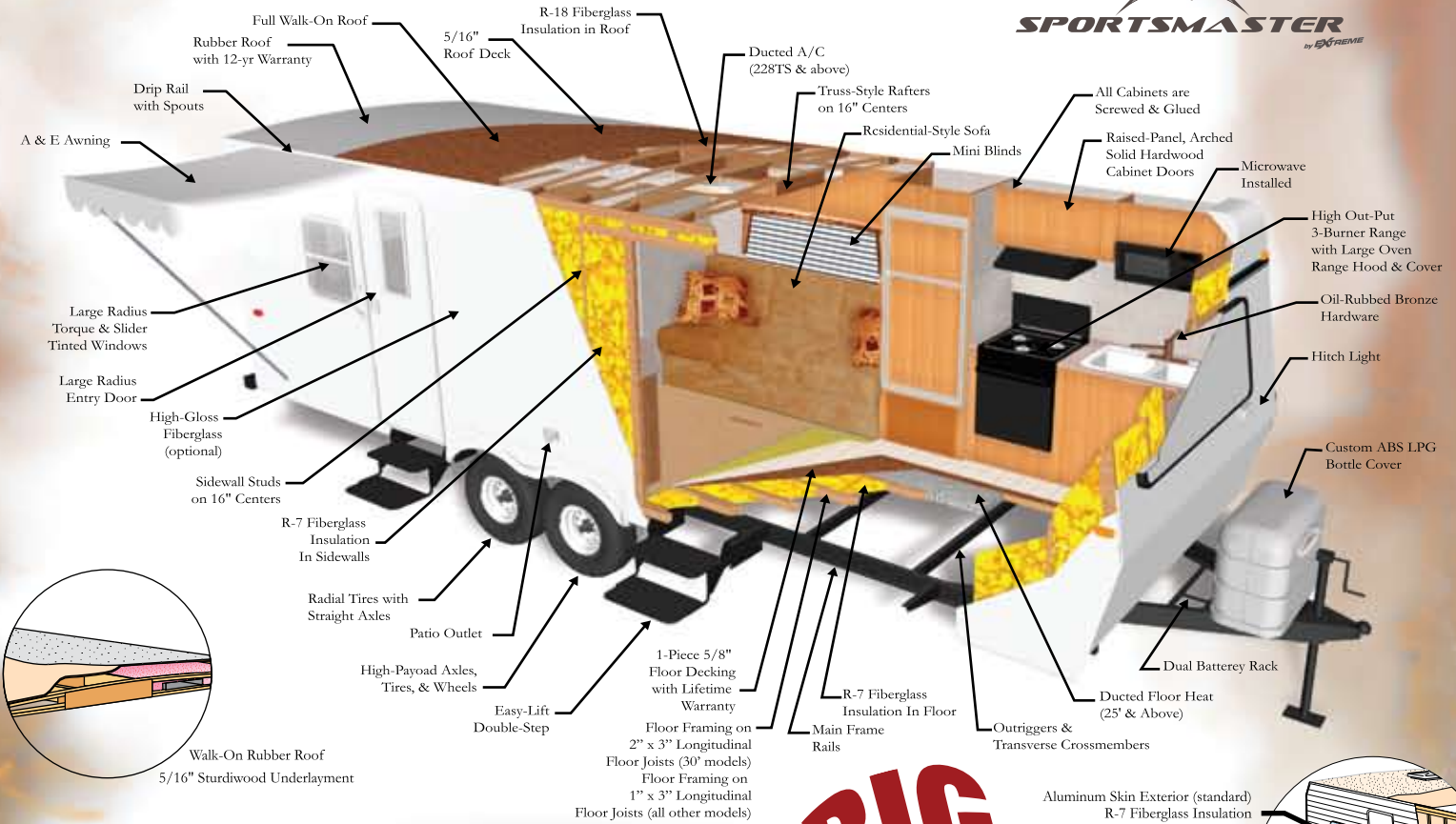

**BIG VALUE**

**BIG EXTRAS**

Extreme utilizes set-wood screws and not dry wall screws. We use wood screws to attach the sidewalls and cabinets together from the outside in, instead of staples like other manufacturers. Set wood screws grip stronger than other fasteners to provide a solid, cleaner looking cabinet installation and also prevents cabinets from sagging as time and travels go by.



Extreme RV's designs and constructs our own chassis with up to 12" engineered I-beam and reinforced outriggers. The superior structure and strength of the chassis provides a strong foundation, assuring a long life without sagging. Full-length outriggers give complete added structural support.



With gusseted truss rafters and O.S.B. roof decking, Extreme roofs are the strongest in the industry. Not only do we stand by our product, we stand on it!

Extreme uses 5/8" x 8' x 24' O.S.B. with a water-resistant phenolic resin. Building with this material means at most one seam per coach, which eliminates the annoying squeaky floor and provides a more solid floor. The O.S.B. floor decking is then glued and fastened to the floor joist to eliminate squeaks and provide a stronger floor.



Our sidewalls are set on top of the floor and secured with long wood screws and a structural adhesive. This construction method allows the weight of the sidewall and roof to rest atop the floor and chassis for a superior structure.



R-18 roof insulation gives you all the comforts of home. The industry standard is R-7 insulation. The upgrade to R-18 makes the RV cooler in the summer and warmer in the winter.



Even when the forecast calls for sunshine, it rains at Extreme! We run our units through our unique rain test system to eliminate the possibility of leaks.



Interiors by: Lachelle & Annette



**BIG  
WARRANTY**

Extreme RVs  
Provides a  
2-Year Structural  
Warranty



**2-Year  
Warranty**

(OEM items have  
separate warranties)

## EXTREME RVs

USES PRODUCTS FROM THESE OUTSTANDING SUPPLIERS:



**BIG  
NAMES**



Extreme RVs, LLC  
PO Box 1420 • 412 S Kit Ave  
Caldwell, ID 83606  
208-453-2500  
sales@extremervs.com  
www.extremervs.com



YOUR AUTHORIZED EXTREME RV DEALER

Manufacturer's Notice: Specifications for products through December 31, 2007. All specifications, equipment, models and prices subject to change without notice. Production of all models subject to seasonal scheduling. Extreme RVs, LLC reserves the right to improve models without incorporating these changes in similar models produced at an earlier date. Manufacturer reserves the right to section fiberglass walls horizontally or vertically. Consult your automobile dealer and your recreational vehicle dealer to assure the proper match between tow vehicle and trailer. Tow vehicle and recreational unit must be properly equalized for efficient product performance and safety. Before you purchase your recreational vehicle, carefully consider the number of people it will accommodate and its end use. For winter travel below 25° F or summer travel 100° F or higher, consult you dealer for appropriate additional equipment to make your travel accommodations more comfortable. Manufacturer's load capacity restrictions and recommendations must be followed for safe and efficient product performance. All RV manufacturers are required to build to the national RVIA standard/code for recreational vehicles. If RVs are to be used for purposes other than recreational use, your RV dealer should be consulted for any additional appropriate equipment or accessories, such as storm windows or other types of upgrades.