

DYNAQUEST XL

TOURING CRUISER



DYNAQUEST - XL340



As powerful as it is luxurious.

A muscular 330-hp Cummins® engine with 1,000 lb. ft. of torque at 2,000 RPM and rugged Freightliner® chassis literally produces tons of towing power. You'll get better drivability, and long lasting reliability, as well. Freightliner® chassis are built for the long haul. And there's lots of storage space inside and out, including a large rear trunk that holds up to 7.5 cubic feet of cargo.





Everything you want in a motorhome. And less.

Just as couples sometimes downsize their homes when the kids move out, many people are interested in downsizing from bulky, bus-style motorhomes to something more manageable. DynaQuest XL, loaded with extraordinary styling is the perfect fit. Luxury features include a color backup camera and monitor, a 26-inch flat-screen LCD TV and a Bose® 3-2-1 AM/FM/DVD system with Surroundsound®.



Mocha/Natural Maple

B



Mocha/Natural Maple

C



Briarwood/Natural Maple

D



Briarwood/Natural Maple

DynaQuest XL340

A

A. Style reigns supreme with beautiful ultraleather upholstery, rich, hardwood cabinetry and accents found in the finest homes.

B. The spacious rear bedroom and a queen size bed offers enough sleeping area for four full-size adults. Plus, there's a large wardrobe for storage.

C. A Flexsteel® EZ Bed Sofa is standard, or choose to upgrade to the optional Flexsteel® sofa with a comfortable fold-out queen size air mattress bed. (option shown)

D. The warm, inviting U-shaped dinette with a deluxe matching ultra leather folding chair seats four comfortably, and folds out for extra sleeping room. Optional on the 320XL.

E. The professional cockpit is designed with lots of leg room. DynaQuest XL includes power windows, cruise control, tilt and telescoping steering column, tinted glass and overhead directional reading lamps. Many drivers option the sophisticated GPS navigation system.



E



ONYX



RUSSET RIDGE



MOCHA



BRIARWOOD



QUICK SILVER

Contemporary paint packages.

DynaQuest XL is available with five eye-catching full-body paint packages. All are enhanced with dramatic, contemporary automotive base coat/clear coat technology.

INTERIOR FEATURES

Elegant interior design schemes.

DynaQuest XL offers a tasteful variety of carpeting, solid wood cabinetry, fabric, hardwood flooring and upholstery design combinations. Choose the one that best fits your style.



ONYX



RUSSET RIDGE



MOCHA

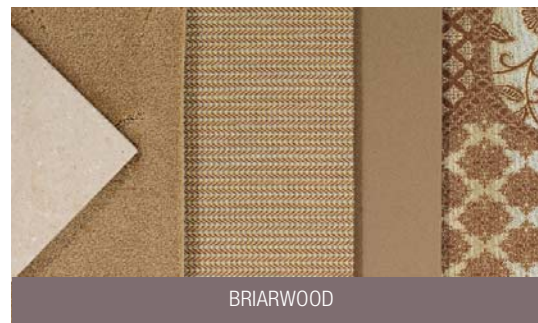

BRIARWOOD

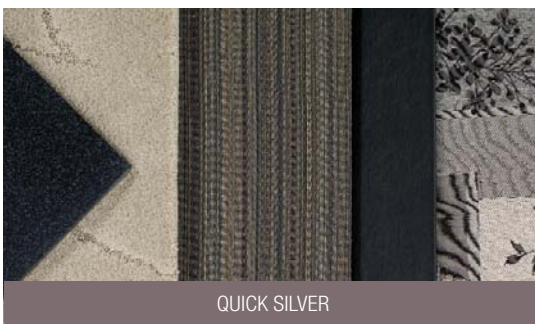

QUICK SILVER

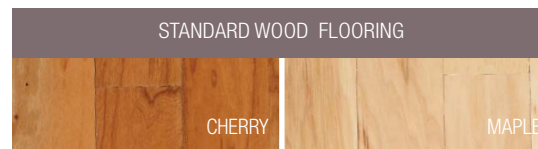

STANDARD WOOD FLOORING

CHERRY

MAPLE

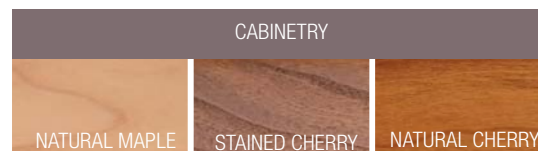

CABINETY

NATURAL MAPLE

STAINED CHERRY

NATURAL CHERRY

FLOORPLANS

Stylized living space is more than colors, fabrics and furnishings. It's thoughtfully designed floorplans that enhance ease of movement, giving you a feeling of roomy comfort and convenience. XL offers a choice of five luxurious arrangements – including a spacious toyhauler.

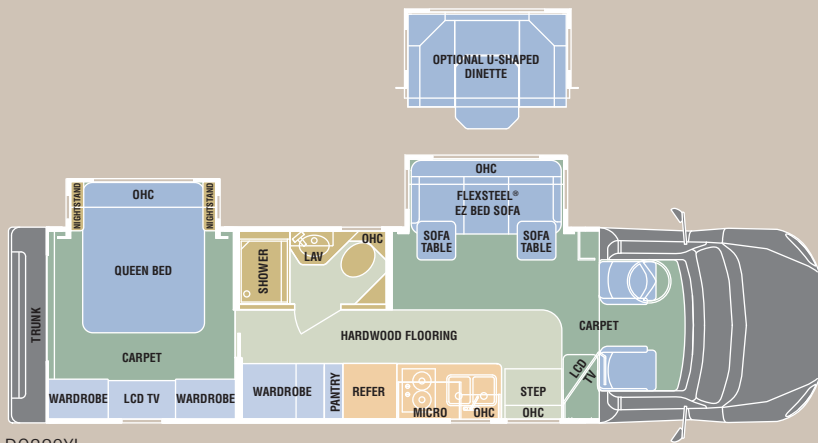

DQ320XL

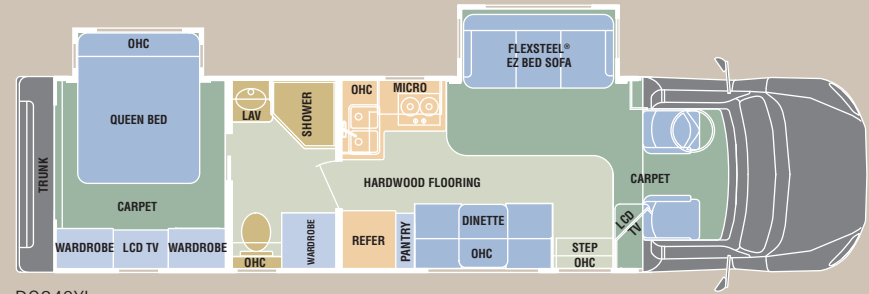

DQ340XL

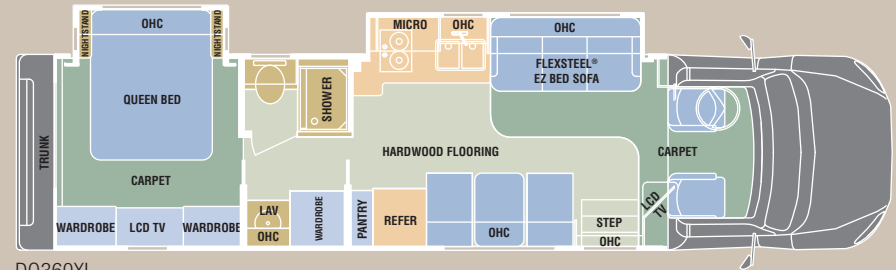

DQ360XL

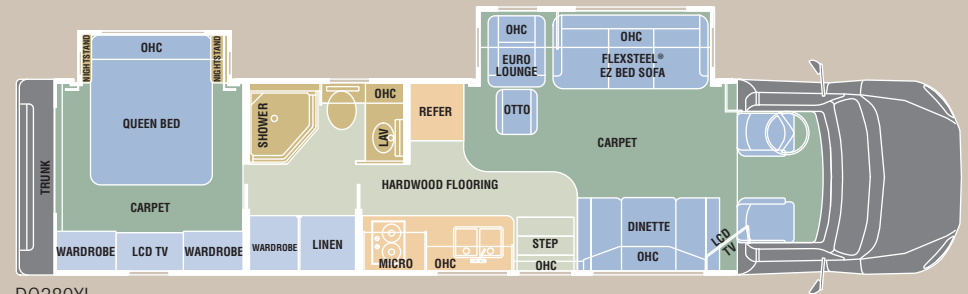

DQ380XL

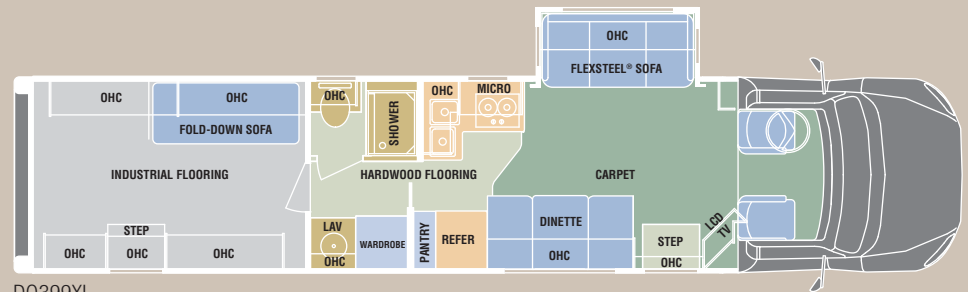

DQ399XL

| KEY DIMENSIONS | DQ320XL | DQ340XL | DQ360XL | DQ380XL | DQ399XL |
|---|------------------|------------------|------------------|------------------|------------------|
| GVWR: | 33,000 lb. | 33,000 lb. | 33,000 lb. | 33,000 lb. | 33,000 lb. |
| GCWR: | 44,500 lb. | 44,500 lb. | 44,500 lb. | 44,500 lb. | 44,500 lb. |
| Overall Length: | 33' 3" | 35' 1" | 36' 1" | 38' 11" | 39' 3" |
| Exterior Width: | 8' 5" | 8' 5" | 8' 5" | 8' 5" | 8' 5" |
| Wheelbase: | 226" | 243" | 247" | 270" | 296" |
| Overall Exterior Height: (includes standard 13,500-BTU roof air conditioner and satellite dome) | 11' 11" | 11' 11" | 11' 11" | 11' 11" | 11' 11" |
| Interior Height: | 6' 6" | 6' 6" | 6' 6" | 6' 6" | 6' 6" |
| Fuel Capacity: | 100 gal. | 100 gal. | 100 gal. | 100 gal. | 100 gal. |
| Water Capacities: | | | | | |
| Fresh | 90 gal. | 90 gal. | 90 gal. | 90 gal. | 90 gal. |
| Grey | 44 gal. | 44 gal. | 44 gal. | 44 gal. | 36 gal. |
| Black | 44 gal. | 44 gal. | 44 gal. | 44 gal. | 33 gal. |
| LPG Capacity: | 20.3 gal./68 lb. | 20.3 gal./68 lb. | 20.3 gal./68 lb. | 20.3 gal./68 lb. | 20.3 gal./68 lb. |

CHASSIS TYPE

- 2008 Freightliner M-2, GVWR - 33,000 lbs.

CHASSIS FEATURES

- Engine: Cummins ISC - 8.3L Diesel
- 2007 EPA/CARB Emission Certification
- 330 Horsepower @ 2,000 RPM
- 1,000 lb. ft. of Torque @ 1,400 RPM
- 2,200 RPM Governed
- 270 Amp Alternator
- 2 Alliance Model 1031, Group 31, 12-Volt Maintenance Free Batteries with 1,520 CCA
- Chassis Battery Shut Off Switch in Cab Mounted by Drivers Seat
- Cummins 18.7 CFM Air Compressor
- C - Brake by Cummins
- Engine After Treatment Device, Automatic Over the Road Regeneration and Dash Mounted Regeneration Request Switch

- 1,100 Square Inch Aluminum Radiator
- 1,000 Watt/115-Volt Block Heater
- Allison 3,200 TRV Six Speed Automatic
- Push Button Electronic Shift Control, Dash Mounted
- Transmission Electronic Oil Level Check

- 12,000 lb. Front Axle
- Cast Iron Front Brake Drums
- Power Steering
- 2 Quart See Through Power Steering Reservoir
- 12,000 lb. Taperleaf Front Suspension
- 21,000 lb. Quiet Ride Single Rear Axle
- 4.88 Rear Axle Ratio
- Cast Iron Rear Brake Drums
- Airliner 21,000 lb. Rear Suspension
- Dual Instant Response Rear Suspension Leveling Valves
- Air Brakes with 4 Wheel ABS
- Brake Line Air Dryer with Heater and Integral Reservoir
- Petcock Drain Valves on all Air Tanks

- Quick Disconnect Fitting with Tire Inflation Kit
- Steel Frame: 11/32" x 3-1/2" x 10-15/16"
- Left & Right Hand 50 Gallon Rectangular Aluminum Fuel Tanks - 100 Gallon Fuel Capacity
- Fuel Filter/Water Separator with Primer Pump
- Auxiliary Fuel Supply and Return Ports (Generator)
- Front & Rear Tires: 275/70R22.5 (16 Ply Radials)
- Freightliner Bevel Turbo 22.5 x 8.25 Polished Aluminum Wheels Rear: (Note: Only Outside Rims Are Polished on Rear)

- 40 Channel CB (Optional)
- Speedometer
- Electronic 3,000 RPM Tachometer
- Windshield Wipers with Delay
- Marker Lights with Separate Interrupter Switch
- One Valve Parking Brake System with Warning Indicator

- 2" Primary & Secondary Air Pressure Gauges
- Electronic Cruise Control
- Digital Display of Odometer, Trip Odometer, Engine Hour, Voltage & Diagnostics
- 2" Electric Fuel Gauge - Reads Driver's Side Fuel Tank Only
- Engine Coolant Temperature Gauge
- 2" Transmission Oil Temperature Gauge
- Engine Oil Pressure Gauge
- Multi-Band AM/FM/WB/CB Left Hand Mirror Mounted Antenna
- 40 Channel CB (Optional)
- Speedometer
- Electronic 3,000 RPM Tachometer
- Windshield Wipers with Delay
- Marker Lights with Separate Interrupter Switch
- One Valve Parking Brake System with Warning Indicator

CAB EXTERIOR:

- Aluminum Cab
- Rubber Mounted
- Chrome Grille
- Chromed Air Intake Grille
- Rectangular Amber Fog Lights
- Daytime Running Lights
- Chrome Heated & Remote Mirrors with 8" Convex Mirrors Mounted Under Primary Mirrors
- Tinted Door Glass with Tinted Operating Wing Windows
- Electric Powered Windows

- 8 Liter Windshield Washer Reservoir with Fluid Level Indicator

CAB INTERIOR

- Grey Vinyl Interior
- Dash Mounted Ash Tray and Lighter
- Alarm Clock in Dash
- 2 Cup Holders in Dash
- Dash Air Conditioning
- Dual Reading Lights
- Electric Door Locks
- Driver & Passenger Air Suspension Seat Pedestals
- Driver & Passenger Seats Swivel
- 3-Point Driver & Passenger Seat Belts
- 18" Leather Wrapped Steering Wheel

CONTROLS & INSTRUMENTS

- Tilt & Telescoping Steering Column
- Wood Grain Instrument Panels
- Low Air Pressure Light & Buzzer
- 2" Primary & Secondary Air Pressure Gauges
- Electronic Cruise Control
- Digital Display of Odometer, Trip Odometer, Engine Hour, Voltage & Diagnostics
- 2" Electric Fuel Gauge - Reads Driver's Side Fuel Tank Only
- Engine Coolant Temperature Gauge
- 2" Transmission Oil Temperature Gauge
- Engine Oil Pressure Gauge
- Multi-Band AM/FM/WB/CB Left Hand Mirror Mounted Antenna
- 40 Channel CB (Optional)
- Speedometer
- Electronic 3,000 RPM Tachometer
- Windshield Wipers with Delay
- Marker Lights with Separate Interrupter Switch
- One Valve Parking Brake System with Warning Indicator

- 40 Channel CB (Optional)
- Speedometer
- Electronic 3,000 RPM Tachometer
- Windshield Wipers with Delay
- Marker Lights with Separate Interrupter Switch
- One Valve Parking Brake System with Warning Indicator

EXTERIOR FEATURES

- Paint:
 - Option # 1 - Mocha (Tan)
 - Option # 2 - Briarwood (Taupe)
 - Option # 3 - Quick Silver (Black & Silver)
 - Option # 4 - Russet Ridge (Burgundy)
 - Option # 5 - Onyx (Black & Gold)
- Four Point Semi - Automatic Hydraulic Leveling Jacks
- Four Point Fully - Automatic Hydraulic Leveling Jacks (Optional)
- 15,000 lb. Hitch Capacity - 1,500 lbs. Tongue Weight/15,000 lbs. Pulling Weight (Standard)
- 20,000 lb. Hitch Capacity - 2,000 lbs. Tongue Weight/20,000 lbs. Pulling Weight (Optional)
- A & E Box Awning (Standard)
- Power Awning (Optional)
- Lighted Grab Handle at Entry Door
- Power Step at Entry Door
- Exterior Storage Compartments with Aluminum Compartment Doors
- E-Coated Steel Compartment Boxes
- Lights in Compartments
- Tank Covers with Rotating Fuel Doors
- Lighted Rear Trunk with 12-Volt & 110-Volt Receptacles

- 6 Docking Lights:

- 1 in Drivers Side Rear Wheel Flare
- 1 in Passenger Side Rear Wheel Flare
- 4 in Rear Bumper (1 Left Corner, 1 Right Corner, 1 on Each Side of Center License Plate)
- Exterior Mounted LP Gas Grill (Optional)
- AC/DC Portable Refrigerator/Freezer (Optional)

INTERIOR FEATURES:

- Interior Decors:
 - Option # 1 - Mocha (Tan)
 - Option # 2 - Briarwood (Taupe)
 - Option # 3 - Quick Silver (Black & Silver)
 - Option # 4 - Russet Ridge (Burgundy)
 - Option # 5 - Onyx (Black & Gold)
- Deluxe Sculpted Carpet (Living Room & Bedroom)
- Hardwood Flooring (Kitchen & Bathroom)
- Ceramic Tile (Optional Kitchen & Bathroom)
- Cabinets: Hardwood
 - Option # 1 - Natural Cherry
 - Option # 2 - Stained Cherry
 - Option # 3 - Natural Maple
- Deluxe Hidden Cabinet Door Hinges
- Posi - Lock Latches on Cabinet Doors
- 26" LCD TV in Living Area
- Satellite: Fully Automatic (Standard)
- Satellite: In-Motion (Optional)
- NEW Intelitec Multiplex Lighting System
 - Multi - Point Switching
 - "All Off" feature located in 4 locations allows the user to completely shut down all 12-Volt by holding one button down in the Driver & Passenger Cockpit, Entry Door, Bathroom or center of unit & Bedroom
 - Flush Mounted Halogen Lights in Ceiling
 - Floor Lighting Through Out
- Bose® 3-2-1 AM/FM/DVD/Surround Sound System (Standard)
- Bose® LS 18 AM/FM/DVD/Surround Sound System (Optional)
- Ceiling Material: Deluxe Padded Ceiling
- Interior Wall Material: Décor Wallboard
- Day/Night Pleated Shades
- Matched Fabric Lambrequins
- Flexsteel® EZ Bed Sofa (Standard)
- Flexsteel® Hide-A-Bed Sofa with Air Mattress (Optional)
- NEW U-shaped Booth Dinette (Optional in place of the sofa on Model DQ320-XL)
- Fantastic Fan Thermostatically Controlled Roof Vents with Rain Sensor (Standard)

SAFETY FEATURES

- LP Gas Leak Detector
- 12-Volt Carbon Monoxide Detector
- Smoke Detector
- Fire Extinguisher

KITCHEN FEATURES

- Corian Countertop with Integrated Double Bowl Sink and Sink Covers
- Single Handle Faucet with Pull Out Spray Head
- 2 Burner LP Cook Top Standard
- Electric 2 Burner Cook Top ILO LP Gas (Optional)
- Over the Range Convection Microwave
- Norcold 10 cu. ft. Stainless Steel Refrigerator
- Norcold 10 cu. ft. Stainless Steel Refrigerator with Ice maker (Optional)
- Front and Rear Facing Dinette with Corian Table (Models DQ340-XL, DQ360-XL, DQ380-XL & DQ399-XL)
- 120 Volt Receptacle
- Free Standing Dinette with Chairs DQ380-XL (Optional)

BATHROOM FEATURES

- Corian Lavatory Top with Integrated Sink
- Deluxe Hardwood Medicine Cabinet
- One Piece Fiberglass Shower with Skylight
- China Macerator Toilet
- Fantastic Vent Fan
- Washer/Dryer Is Available on All Models (Optional)

BEDROOM FEATURES

- 19" LCD TV (Optional)
- Hardwood Wardrobes
- Designer Bedspread & Pillow Shams
- Fantastic Vent Fan: Thermostatically Controlled with Rain Sensor (Standard)
- Bose® 3-2-1 AM/FM/DVD/Surround Sound System (Optional)

DRIVER & PASSENGER COMPARTMENT

- Color Back Up Camera
- Two Side View Cameras (Optional)
- GPS Navigation System (Optional)
- Ultra Leather Lexington Driver & Passenger Captain's Chairs
- AM/FM/CD in Dash Radio
- CB Radio (Optional)
- Roof Mounted Dual Air Horns

CONSTRUCTION HIGHLIGHTS

- Heavy Duty 4" E-coated Steel Floor Frame Mounted on Rubber Isolators
- Radiused & Laminated Side Walls
- Square Tube Aluminum Framed Sidewalls with all thru Wall Cut Outs Framed in Aluminum
- Panoramic Bonded & Dark Tinted Windows
- One Piece Radiused & Laminated Roof
- Square Tube Aluminum Framed Roof Construction

- One Piece Outer Fiberglass Skin on Roof
- R-11 Solid Block Foam Insulation in Floor
- R-8 Solid Block Foam Insulation in Sidewalls & Roof
- Steel Cage Connecting Cab to Sidewalls & Roof
- Aerodynamic Front Fiberglass Cab Transition
- Molded Fiberglass Rear Cap with Trunk
- Hydraulic Slide Outs: Bedroom & Living Room
- Side Cross Flow Vent Windows (Most Models)

UTILITIES

Heating

- 42,000 BTU LP Gas Furnace (Models DQ320-XL, DQ340-XL, DQ360-XL & DQ399-XL)
- 30,000 BTU LP Gas Furnace in Rear & 20,000 BTU LP Gas Furnace in Dinette (Model DQ380-XL)
- Single Thermostat For Heating and Cooling Electrical

- Three Group 31 AGM, 315 - Amp/Hour Coach Batteries
- Three 4D AGM, 630 Amp/Hour Coach Batteries (Optional)
- 1,000 Watt Inverter (Standard)
- 3,000 Watt Inverter (Optional) (Note: Requires Upgrade to 4D Battery Option)

- 50 Amp Land Line
- Onan 6.0 KW Diesel Generator (Standard)
- Onan 8.0 KW Diesel Generator (Optional)
- Auto Generator Start (Optional) (Note: Requires Upgrade to 3,000 Watt Inverter & 4D Battery Options)
- Coach Battery Disconnect in Living Area
- DynaPower Package (Optional)

- 8.0 Generator
- Auto Generator Start
- 3,000 Watt Inverter

- Three 4D AGM Batteries
- Power Cord Reel - 50 Amp

Cooling

- RV Products Polar Mach Dual Low Profile Roof Air Conditioners - 13,500 BTU
- RV Products Polar Mach Dual Low Profile Roof Air Conditioners - 15,000 BTU with Heat Pump (Optional)

Plumbing & Water System

- Six Gallon LP Gas Water Heater
- Six Gallon LP Gas & Electric Water Heater (Optional)
- 12-Volt High Capacity Water Pump
- Heat Pads on Grey & Black Water Tanks
- Power Water Hose Reel (Optional)



We're Performance Driven

2745 Northland Dr • P.O. Box 1948 • Elkhart IN 46515
888-295-7859 • www.dynamaxcorp.com

Actual towing capacity is dependent on your particular loading and towing circumstances, which includes GVWR, GAWR and GCWR, as well as adequate trailer brakes. Please refer to the Owners Manual of your vehicle for further information. Floor plans, features and specifications of the DynaQuest are subject to change without notice.

CLUB MAX

Benefits to the Max

One of the really neat benefits of being a Dynamax owner is membership in the Dynamax owner's club. We call it Club Max. You'll call it a great way to enjoy your new motorhome, as you spend fun time with other owners. It's also a great way to travel and socialize, especially at the Dynamax Rally, held every year. In addition to rallies and special events, there are many other benefits, including *To The Max*, the official news magazine of Club Max; a roadside assistance program; FMCA Membership; KOA value card; a lost key program; and much more. And, of course, the biggest benefit is the network of friends you will soon develop. The camaraderie and spirit of the Dynamax community is a special part of the experience. To learn more, just go to www.myclubmax.com or enter through the Dynamax web site: www.dynamaxcorp.com.



We're Performance Driven

2745 Northland Dr • P.O. Box 1948 • Elkhart IN 46515
888-295-7859
www.dynamaxcorp.com