

1 9 9 7

Sundancer®



31WQDL, 29WQ



ITASCA®

Peace of mind is the knowledge that your motor home was designed and built at the most advanced motor home production facility in the world. (To maintain our high quality standards we manufacture more than 80% of the components that go into our motor homes.) Peace of mind is knowing that each element inside your motor home has been tested and re-tested for absolute integrity. (For example, we water test every unit as it comes off the line to make sure it's completely watertight.) And peace of mind is the knowledge, 75,000 miles down the road, that you're driving a motor home known for its high resale value. While peace of mind might not appear on the specifications page, you'll find it in each 1997 Itasca Sundancer. It's just one of the many things that always sets our motor homes apart.

PEACE OF MIND. WE BUILD IT INTO EVERY SUNDANCER.



31WQ-DL

Here's one feature that's sure to brighten your outlook on life. As a result of extensive dark-room testing, we were able to significantly improve interior lighting. All the lights beneath overhead cabinets feature new opticlear lenses that redirect light output. We also added aisle courtesy lights for nighttime convenience.

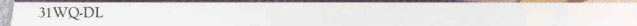

31WQ-DL



31WQ-DL

There's much more to the dinette than meets the eye. This inconspicuous door with a recessed handle offers access to additional storage.



31WQ-DL

The beautifully finished, mirror-doored wardrobe ensures your clothes will always be traveling in style. (NA 29WQ)



Sundancer's intelligent design allows you to spend even the warmest days in total comfort. An available roof ducted air conditioner with wall thermostat and dampered directional air conditioning vents is one of the advantages of the new three-inch thick roof. This powerful air conditioner is available on all 1997 Sundancer models.



31WQ-DL

The galley's features will please even the most discriminating cook. They include easy-cleaning vinyl flooring and a new, larger touch-control microwave.



31WQ-DL

This brass accented bathroom includes vinyl flooring along with a mirrored medicine cabinet, recessed three rod towel rack and handy water pump switch.



31WQ-DL

A large skylight with an auxiliary light has increased the shower's stand-up height to 6'3". The shower/tub includes a flexible shower head and pleated fabric door.



31WQ-DL

The pull-out pantry has adjustable shelves to store various items. A latch prevents the cabinet from opening unexpectedly. (NA 29WQ)

WE TAKE A DIFFERENT APPROACH TO INTERIORS.

There may be many ways to craft a motor home's interior, but after nearly 40 years of experience, we've found none better than what we call Home Comfort Design. This is the process our staff of interior designers uses when creating each interior; a process exclusive to Winnebago Industries motor homes. Home Comfort Design means selecting the highest quality fabrics, window treatments, wall coverings and carpeting, and subjecting them to a number of tests to ensure they meet our high standards for comfort and durability. And that's something you'll appreciate more and more with every mile you drive.



31WQ-DL

The available overhead entertainment center has a 19" remote control color TV with a slideout single bunk. A VCR with switching system is also available to allow video viewing on either the front TV or a TV hooked up to the rear jack.



31WQ-DL

Even when you're on vacation, you still need a place to get away from it all. And there's no better place than Sundancer's roomy bedroom. Warm woodwork combines with the coordinated bedspread, pillow shams and window treatments to create a look unlike any other. Reading lights, mirrored overhead cabinetry, nightstands, shirt closets and large underbed storage area round out this bedroom's many features.



31WQ-DL

Our available, weather-resistant custom awning adds good looks while making outdoor relaxation more comfortable. When not in use, the awning quickly and easily retracts to the aluminum awning rail. For 1997, we've increased driving safety by adding a center rear high mount brake light to all our motor homes.

IT'S DESIGNED TO FIT LIKE A 29 FOOT GLOVE.

If you like the Sundancer now, just wait until

you've driven it for a few months. You'll appreciate it even more. Years of experience and extensive customer input have helped us design motor homes that meet the day-to-day needs of today's motorhomers. With a wide variety of floorplan options and available features, Sundancer offers you the chance to build the perfect motor home for your family. So whether you'll be using your Sundancer for weekend getaways or extended travel, you can rest assured that your motor home is going to feel like it was designed just for you. Which, in fact, it was.



29WU

New for 1997, a sectional-style sofa is now available to replace the forward facing couch and driver's side lounge chair on both the 29WQ and 29WU. (NA 31WQ)



29WQ

In the lounge, the cabinet with a roll-up tambour door is a standard feature. The available 13" television and new video cassette player are locked in place.



29WU

This galley includes a 3-burner range with oven, stainless steel sink with single control faucet and available coffee maker with clock and timer. The new Norcold refrigerator/freezer incorporates repositioned controls located between the doors for greater convenience.

The 1997 Sundancer's pass-through basement storage system has been redesigned for more efficient use of space. Other benefits include items usually found only on Class A models; such as, sleek, fully-hinged valance panel doors, gas struts on most compartments and a single latch for easy access.



29WQ

Sundancer is much more than just a comfortable motor home. It's also remarkably durable, featuring construction advantages you just won't find on competitively priced motor homes. Like our unique twelve-step electrocoating process. Or our one-of-a-kind floor and ceiling joints. Or our welded framework that's strong enough to pass a drop test. Or the steel pillar in the bunk area to increase strength and occupant safety. You get the point. There's simply no better way to build a motor home.

MOTOR HOMES BUILT TO THE TOUGHEST STANDARDS IN THE INDUSTRY.



We developed Thermo-Panel® sidewall construction which combines light weight, structural integrity and durability.

A third exterior brake light is a safety feature other manufacturers only put on high-end models. We have one on all our motor homes.



Drive as far as you want and still get TV reception. The available digital satellite system offers more than 175 channels, CD-quality sound, and superior picture. Available with or without receiver. (Program activation fees not included. Receiver not available in Canada.)



We fasten the sidewall to the frame and cab using our interlocking joint system. This makes a more durable, stable and better-sealed body.



29WU

Our new, larger storage compartments feature weatherproof seals and lining, and hinged valance panels with a single latch system and non-corrosive locks.

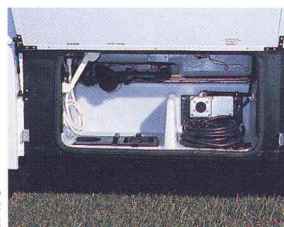

29WU

In keeping with Sundancer's efficient layout, the service compartment neatly organizes the sewer, power, water and cable TV hook-ups in one heated location.

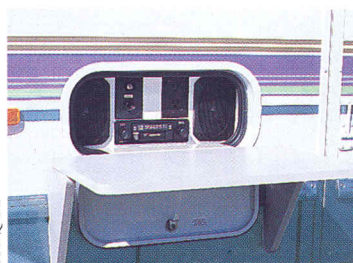

31WQ-DL

Our available entertainment center adds to your outdoor fun. It includes an AM/FM/cassette radio with two speakers, TV jack, electrical outlets and a convenient removable table.



31WQ-DL

The available electric mirrors make adjustments easy, even while you're driving. These mirrors are standard with the deluxe upgrade package option.

For outdoor enjoyment, the available entertainment center has an AM/FM/cassette player, radio antenna, TV jack, two speakers and a removable TV table, all in a lockable compartment.



Winnebago Industries has been designated a Qualified Vehicle Modifier by Ford Motor Company. The QVM program promotes high standards for manufacturers who build motor homes on Ford chassis, and we are proud to be one of the first motor home manufacturers to qualify. Meeting QVM standards is a part of our policy of continuous quality improvement.

A standard service center puts the water fill valve, power cord and water pump switch in one handy, heated compartment. It also houses a cable TV jack and exterior shower.

The available DL package comes with many extras, including an automotive rear bumper, additional graphics and paint, fiberglass running boards with wheel well trim and electric mirrors with defrost.

Every unit features a 3" thick roof and is pre-wired for an available ducted roof air conditioner.

Computer simulated or physical drop testing, performed on various models, is unique to Winnebago Industries. This testing aids in evaluating structural integrity, panels/panel joints, appliance attachments and window/door operations.

Our seamless fiberglass roof won't tear like rubber and comes with our standard 10-year limited parts and labor warranty, the only one in the industry.

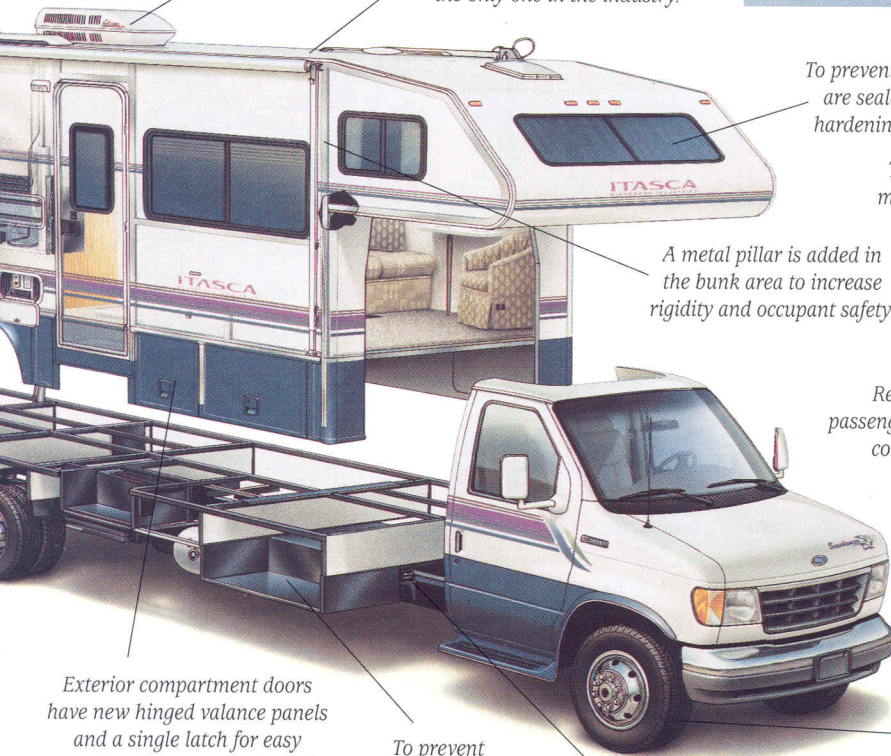

Exterior compartment doors have new hinged valance panels and a single latch for easy opening. Doors are laminated, with smooth fiberglass skin on both sides of block foam insulation, for energy efficiency and sound absorption.

To prevent corrosion, we electrocoat all steel in the storage compartments.

To reduce noise and vibration, the body is attached to the floor supports which are fastened to the Ford rubber isolation system.

Available electronic control mirrors defrost and have a breakaway design for added safety. Convex mirrors on both sides improve rear vision.

Select appliances are secured with steel tie-downs, an exclusive Winnebago Industries safety feature. It's not something we're required to do. It just makes sense.



New lighting enhancements include courtesy lights along the floor, a larger skylight in the bath area and opticlear lenses on lights beneath upper cabinets.

ITASCA

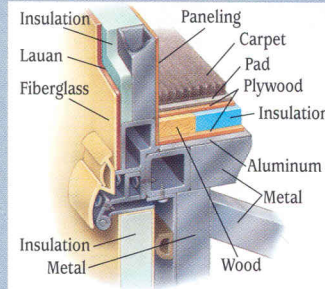

COMPETITOR

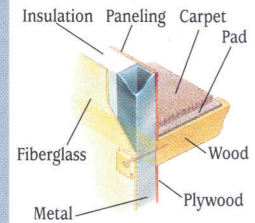

Our innovative sidewall-to-floor joint is engineered to provide greater strength by transferring sidewall weight to the floor with a welded aluminum framework and steel perimeter frame. In addition, by embedding this framework into the block foam insulation, and adding flooring insulation, we create better temperature retention and sound deadening capabilities. Other designs simply fill in around framework and mount the sidewall flush to the floor with screws.

As an added safety feature, cabinets are secured to metal plates embedded in the sidewalls and roof.

Steel angles are strategically placed to reinforce the roof and wall joints.

To prevent leaks, windows are sealed with a non-hardening butyl sealant.

To maintain quality control, we make over 80% of everything that goes into our motor homes.

A metal pillar is added in the bunk area to increase rigidity and occupant safety.

Not only will you find three-point shoulder and lap seat belts with retractors in the cab, lap belts are standard in selected areas of the coach as well.

Restyled driver's and passenger's seats provide more comfort and support.

An available 14' patio awning increases outdoor living space (Not available in Canada). The awning rail is standard.

Block foam insulation increases R-value and decreases noise inside the coach.

To make sure each unit is watertight, we conduct a water test simulating an intense rainfall.

A computer evaluates every unit for wheel alignment and checks 75 chassis points to ensure proper handling.

For easier entry, a double electric step is now standard. New rubber matting and a non-slip tread strip make getting in and out safer.

Seamless rotocast holding tanks with heated compartments make the best use of available space.

We letter code our wiring every three inches to make service diagnosis easier and faster.



Our three-point seat belts connect directly to the seat frame in the cab and are bolted to the steel cab substructure. Always use your seat belt.

1997 SUNDANCER FLOORPLANS*

Choose from over sixty floorplan combination possibilities

29WQ	
Length	29'4"
Exterior Width	8'3.9"
Interior Height	6'7"
Interior Width	8'
Fuel Capacity	55 gal.
Fresh Water w/Heater	37 gal.
Holding Tank Capacity - Black/Gray	34 gal./31 gal.
LP Capacity	60 lbs.
Wheelbase	190"
Exterior Height w/Roof Air*	11'4"
Exterior Storage	82.2 cu. ft.
GVWR	14,050 lbs.

29WU	
Length	29'4"
Exterior Width	8'3.9"
Interior Height	6'7"
Interior Width	8'
Fuel Capacity	55 gal.
Fresh Water w/Heater	37 gal.
Holding Tank Capacity - Black/Gray	34 gal./31 gal.
LP Capacity	60 lbs.
Wheelbase	190"
Exterior Height w/Roof Air*	11'4"
Exterior Storage	83.6 cu. ft.
GVWR	14,050 lbs.

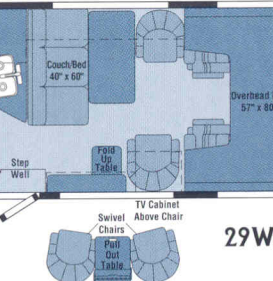
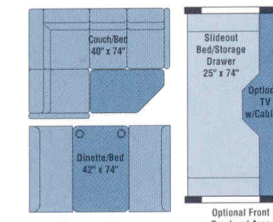
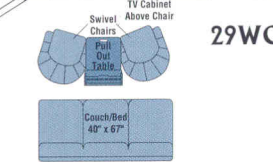
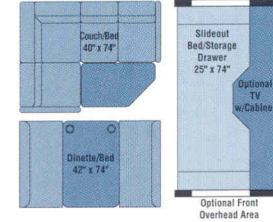
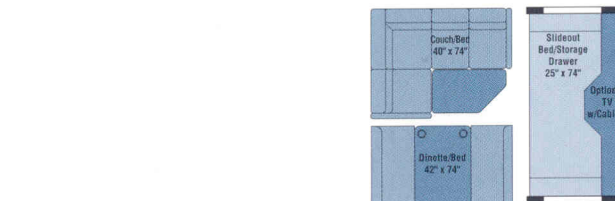
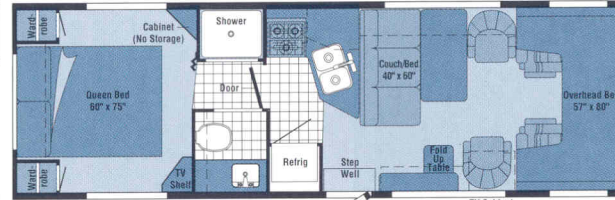
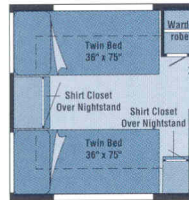
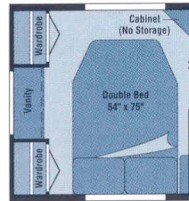

Standard Vinyl

Note: Dimensions shown are for sleeping space only and dashed lines denote overhead storage areas.

29WQ

29WU

31WQ	
Length	30'10"
Exterior Width	8'3.9"
Interior Height	6'7"
Interior Width	8'
Fuel Capacity	55 gal.
Fresh Water w/Heater	37 gal.
Holding Tank Capacity - Black/Gray	34 gal./31 gal.
LP Capacity	60 lbs.
Wheelbase	205"
Exterior Height w/Roof Air*	11'4"
Exterior Storage	96.9 cu. ft.
GVWR	14,050 lbs.



*The height of each model is based on the curb weight of a typically equipped unit on the standard chassis. The actual height of your vehicle may vary by as much as 2" depending on chassis or equipment variations.

◆These floorplans feature a widebody design - over 96" in width. In making your purchase decision, you should be aware that some states restrict access on some or all roads to 96" in body width. Before making your purchase decision, you should confirm the road usage laws in the states of interest to you.

1997 SUNDANCER INTERIORS

	COZUMEL[▲]	FOREST FLOOR[▲]	GEMSTONE (DL)[▲]	LAPIS (DL)[▲]	
Waterford Oak					
Main	Accent	Carpet	Main	Accent	Carpet

▲The style of chair shown is not available on the motor home you purchase. It is shown to represent fabric color and pattern only.

1997 SUNDANCER SPECIFICATIONS

AUTOMOTIVE			
	29WQ	29WU	31WQ
Chassis - Ford 6.8L Super-Duty V-10 Fuel-Injected Gasoline Engine ('97 Chassis), Automatic Transmission w/Overdrive & Cooler, 650-CCA Battery/130-Amp. Alternator, Dual Air Bags ('97 Chassis)	S	S	S
Engine* - Diesel 7.3L Navistar	O	O	O
California Emissions*	O	O	O
Tires & Spare (Radial)	O	O	O

DL UPGRADE PACKAGE			
	29WQ	29WU	31WQ
Deluxe Upgrade Package* Exterior: Wheel Liners, Automotive Rear Bumper, Rear Wheelwell Trim, Radius Transition Panel, Additional Graphics & Paint, Fiberglass Running Boards w/Wheel Well Trim, Electric Mirrors w/Defrost	O	O	O
Interior: Deluxe Cab Seats, Upgraded Cab Trim Panels, Adjustable Reading Lights, Raised Panel Cabinet Doors w/Brass Trim (Overhead), Upgraded Wall Lamp, Upgraded Window Treatment, Range Hood w/Monitor Panel, Upgraded Furniture Style, Lounge Pillow (Couch Module), Black Galley Appliances, Upgraded Convenience Tray			

DRIVER CONVENIENCES			
	29WQ	29WU	31WQ
3-Point Retracting Seat Belts (Drv./Frt. Pass.) Seats w/Armrests, Recline, Swivel/Slide Pedestal*, Lumbar Support	S	S	S
Battery Charge Control Dual, Automatic	S	S	S
Beverage Holder w/Storage	S	S	S
Cab Carpet & Rubber Floor Mats	S	S	S
Cigarette Lighter/12-V Electrical Supply	S	S	S
Convenience Tray	S	S	S
Cruise Control	S	S	S
Divider Curtain Cab	S	S	S
Dome Light	S	S	S
Heating/Air Conditioning Automotive Blend Air System	S	S	S
Hood Release Interior	S	S	S
Mirrors (Rear View) Exterior, Plate Mount	S	S	S
Mirrors (Rear View)* Exterior, Electric Remote w/Defrost	O	O	O
Power Door Locks & Windows	O	O	O
Start Circuit Auxiliary	S	S	S
Steering Power Assisted w/Tilt Wheel	S	S	S
Sunvisors	S	S	S
Trim Panels Driver & Passenger Doors (Chassis Supplied)	S	S	S
Windshield Wipers (Intermittent)	S	S	S

ENTERTAINMENT			
	29WQ	29WU	31WQ
Entertainment Center (Patio) AM/FM Radio, Cassette Deck, Speakers (2), DC Receptacle, 110-V Outlet, TV Jack, Radio Antenna, Removable TV Table, Locking Door	O	O	O
Inverter* 110-V for TV/VCR, 130-Watt	O	O	O
Stereo (Cab) AM/FM Cassette Deck, Speakers (4)	S	S	S
TV, Lounge (13" Color)* & VCP w/Remote Slide/Swivel Shelf, Locking Safety Latch	O	O	O
TV, Front (19" Color)* & VCR w/Remote Switching System, w/Slideout Single Bunk	O	O	O
TV, Front (19" Color)* w/Remote w/Slideout Single Bunk	O	O	O
TV Enhancement Package* Antenna (Amplified), DC Receptacles (2), Interior Jacks (2), Coax Wiring, Cable Input, Bedroom TV Shelf or Stand	S	S	S
Satellite System Pre-Wiring	S	S	S
Satellite System[∞] With or Without Receiver	O	O	O

INTERIOR			
	29WQ	29WU	31WQ
Bed (Front Overhead) Sliding Side Windows, Privacy Curtain, Storage Cabinet	S	S	S
Carpeting w/Pad Stain Resistant	S	S	S
Ceiling Lights	S	S	S
Ceiling Vent Powered, Bathroom	S	S	S
Ceiling Ventilator Fan Powered, Front Bunk	O	O	O
Ceiling Vents* Non-Powered, Bedroom, Front Overhead Bed & Galley	S	S	S
Clock Decorator Style	S	S	S
Color Themes (Interior) Choice of Cozumel (Blue/Multi), Forest Floor (Taupe), Both w/Waterford Oak	S	S	S
Color Themes (Interior) DL Upgrade Choice of Gemstone, Lapis, Both w/Solar Maple	O	O	O
Courtesy Lights w/Wall Switches	S	S	S
Decorative Overhead Door Exchange Exchanges Mirrored Doors To Wood	O	O	O
Decorator Lamp	S	S	
Ladder* Overhead Bed	O	O	O
Wardrobe Carpeted Floor, Clothes Rod, Mirrored Door (Drawers & Shelf On 31WQ)		S	S
Windows Tinted	S	S	S
Windows Dual Glazed, Thermo-Insulated	O	O	O

GALLEY			
	29WQ	29WU	31WQ
Coffee Maker w/Clock & Timer	O	O	O
Counter Extension Flip-Up	S		
Flooring (Vinyl)	S	S	S
Folding Chairs* (2)			O
Galley Rail	S	S	S
Microwave Prep Kit	S	S	S

	29WQ	29WU	31WQ
Microwave Oven Touch Control	S	S	S
Pantry		S	S
Range Hood w/Light, Powered Vent	S	S	S
Range w/Oven 3 Burners	S	S	S
Refrigerator/Freezer Double-Door, Flush Mounted	S	S	S
Sink (Double) Stainless Steel, Single Control Faucet, Recessed w/Countertop Cover	S	S	S
Spice Rack	S	S	
Storage below Dinette Seat	S	S	S
Table & Chairs (2)			O

BEDROOM

	29WQ	29WU	31WQ
Mattress(es), Bedspread(s), Pillows, Pillow Shams	S	S	S
Underbed Storage Gas Spring Bed Lifts	S	S	S
Wardrobe(s)	S	S	S

BATHROOM

	29WQ	29WU	31WQ
Clothes Rod Removable (Shower Area)	S	S	S
Flooring (Vinyl)	S	S	S
Lavatory Cabinet	S	S	S
Linen Cabinet			S
Medicine Cabinet	S	S	S
Mirror Wall-Mounted	S		
Shower Flexible Shower Head	S		
Shower/Tub Flexible Shower Head		S	S
Shower Door Pleated	S	S	S
Shower Light	S	S	S
Sink Rectangular, Molded Soap Dishes	S	S	S
Skylight	S	S	S
Tissue Holder	S	S	S
Toilet Marine Style	S	S	S
Towel Bar	S		
Towel Rack (3) Built into Door	S	S	S
Towel Ring	S		S

EXTERIOR

	29WQ	29WU	31WQ
Awning* Patio	O	O	O
Awning Rail	S	S	S
Bumper Front: Chrome	S	S	S
Entrance Door Step (Electric)	S	S	S
Entrance Door w/Screen Door Deadbolt Lock	S	S	S
Holding Tank Compartment Heated	S	S	S
Ladder	S	S	S
Mud Flaps Rear	S	S	S
Outlet 110-V, Curbside	S	S	S
Porch Light Interior Switch	S	S	S
Power Cord 30-Amp.	S	S	S
Running Boards (Aluminum)	S	S	S
Sewer Hose w/Storage	S	S	S
Storage Compartments Locking Doors	S	S	S
Tire Tool Lug Wrench	S	S	S
Trailer Towing Package w/Class II Hitch	O	O	O
Trailer Wiring Extension	S	S	S
Wash Station w/Water Pump Switch	S	S	S
Wheel Covers*	S	S	S
Wheel Liners Stainless Steel*	O	O	O

SYSTEMS

	29WQ	29WU	31WQ
Air Conditioning Pre-Wiring Roof	S	S	S
Air Conditioner Roof, 15,000-BTU Ducted	O	O	O
Battery (Auxiliary) Deep Cycle	S	S	S
2nd Battery (Auxiliary)* Deep Cycle	O	O	O
Battery Disconnect System	S	S	S
City Water Hookup	S	S	S
AC/DC Electrical Distribution System Load Center Combination, 40 Amp. Converter/Charger	S	S	S
Furnace Ducted, Low Profile, 30,000-BTU	S	S	S
Generator Prep Kit* Gas Line, 12-V Wiring	S	S	S
Generator* 4,000-Watt, Hourmeter, 110-V Wiring, Switches, Gas	O	O	O
Generator* 3,600-Watt, LP	O	O	O
Monitor Panel Water, Holding & LP Tank Levels, Battery Condition Gauge, Water Pump Switch, Water Heater Ignition Switch w/Pilot Indicator Light, Located in Galley	S	S	S
Water Drain System through Floor	S	S	S
Water Fill Door Lockable	S	S	S
Water Heater 6-Gal., Electronic Ignition	S	S	S
Water Heater (Motoraid) & Rear Automotive Heater	O	O	O
Water Heater Winterizing By-Pass Valve	S	S	S
Water Pump (Demand)	S	S	S
Water System Winterizing Valve	S	S	S

SAFETY

	29WQ	29WU	31WQ
3-Point Seat Belts (Drv./Frt. Pass.)	S	S	S
Assist Handle* Exterior	S	S	S
Assist Handle Interior, Wood	S		S
Assist Strap Interior	S	S	S
Carbon Monoxide Detector/Alarm	S	S	S
Escape Window	S	S	S
Fire Extinguisher (10-B.C.)	S	S	S
Ground Fault Interrupter	S	S	S
High Mount Rear Brake Light	S	S	S
LP Leak Detector/Alarm	S	S	S
Lap Belts in Selected Areas	S	S	S
Smoke Detector/Alarm	S	S	S

S Standard

O Optional

* Not all options available in combination. See dealer for details.

∞ TV satellite system options do not include programming activation. Quality reception is only available in the lower 48 States. Receiver not available in Canada.

Winnebago Industries' continuing program of product improvement makes specifications, equipment, model availability and prices subject to change without notice. Comparisons to other motor homes are based on the most recent information available.

DRIVING CUSTOMER SATISFACTION HOME.

Before you buy your next motor home, drop by your local Winnebago Industries dealership to ask the service manager a few questions. Like, who builds the best motor homes? Who backs them best? Who has the best parts system? And who provides the best training to dealers? Chances are, most often you'll hear the same name – Winnebago Industries. To understand why service managers rate our motor homes so highly, you need look no further than our warranty package and Preferred Care Program.

Each Itasca motor homes are protected by the most comprehensive warranty package in the industry. Here are some of the highlights:

- Transferable 12-month/15,000 mile basic coverage including all appliances and equipment we install
- 36-month/36,000 mile limited warranty on sidewalls and backwall lamination
- 10-year limited parts and labor warranty coverage on the roof

Each Itasca also includes a one year membership in our industry-leading Preferred Care Program. This newly expanded 24-hour nationwide assistance plan includes:

- Emergency dispatching for road service and towing
- Free battery jump-start, tire change, fuel delivery, and lockout assistance
- Equipment service questions, provider recommendations, appointment scheduling and directions to the service location

Preferred Care assistance is provided through an exclusive 24-hour toll-free telephone number, staffed by experienced RV service professionals and supported by a network of more than 20,000 prequalified service providers. After the first year of ownership has passed, the Preferred Care Program can be extended through membership in the Winnebago-Itasca Travelers Club.



Two great ways to enjoy your new Itasca are in the Winnebago-Itasca Travelers (WIT) Club and as a member of the Winnebago Motorsports Team.



WIT members enjoy the RV lifestyle by participating in organized caravans and rallies – like the WIT Grand National Rally held every summer in Forest City. Other benefits and services include a monthly magazine, trip routing, mail forwarding and available Preferred Care.



As a Winnebago Motorsports Team member, you can stay with the pack week after week. All across the country, members follow the action at the track from the comfort of their motor home. Members receive a quarterly newsletter and the opportunity to purchase Premium Road Service and to participate in race-day events at selected tracks. For more information about either club, see your dealer or call 1-800-643-4892.



With a commercial vehicle from Winnebago Industries, your business is never in the wrong location. We custom build everything from mobile hair salons and news stations to mobile medical clinics and ATMs. A variety of sizes and models is available. Contact your dealer for more information.

To learn more about Itasca motor homes, visit the Winnebago Industries factory in Forest City, Iowa. Call us at (515) 582-3535 for a free factory tour.

For Sales and Service Information Contact:



©1996 Winnebago Industries, Inc.

Printed in USA

Seat belts are your most important hookup. Always buckle up.