

TUSCANY XTE

**MADE TO FIT**  
YOUR AMBITIONS



**TUSCANY XTE**

 BY THOR MOTOR COACH

**MAKE**  
IT A REALITY





34ST | AVANT-GARDE | HIGH-GLOSS GLAZED RESORT CHERRY



40GQ | LUNA CREST | HIGH-GLOSS GLAZED MILAN CHERRY



36MQ | IVORY SONATA | HIGH-GLOSS GLAZED RESORT CHERRY



WHEN WE SAY *MADE TO FIT*,  
WE MEAN IT.

With so many unique models available, Thor Motor Coach motorhomes are priced to fit anyone's budget – from families buying their first motorhome to full-timers looking for a roaming "dream home". No matter how you choose to spend your time or your money, there's a TMC motorhome that fits your needs.

By building a variety of unique styles, sizes and floor plans, Thor Motor Coach offers motorhomes that feel custom-made – at a truly competitive price.

Welcome to the Tuscany XTE, the motorhome that is *Made to Fit* your ambitions.



# WHERE YOU SPEND YOUR TIME...



AVANT-GARDE



PORCELAIN TILE FLOORING



IVORY SONATA

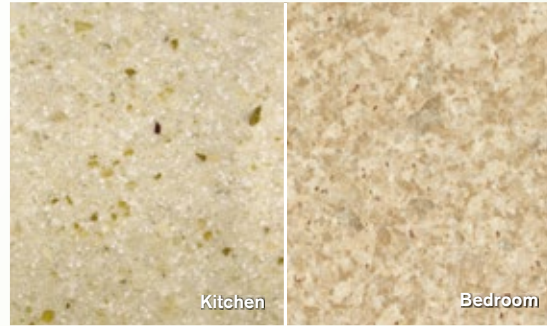

COUNTERTOPS

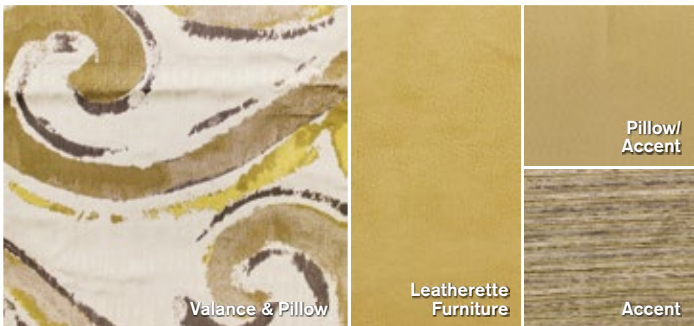

LUNA CREST



HIGH-GLOSS GLAZED MILAN CHERRY



HIGH-GLOSS GLAZED RESORT CHERRY





40AX | AVANT-GARDE | HIGH-GLOSS GLAZED RESORT CHERRY

 **THOR**  
MOTOR COACH  
Made to fit.



40GQ | LUNA CREST | HIGH-GLOSS GLAZED MILAN CHERRY



34ST | AVANT-GARDE | HIGH-GLOSS GLAZED RESORT CHERRY





40GQ | LUNA CREST | HIGH-GLOSS GLAZED MILAN CHERRY

 **THOR**  
MOTOR COACH  
Made to fit.

## WHAT PEOPLE WILL BE TALKING ABOUT

A combination of striking good looks and functional necessities make the Tuscany XTE the perfect choice. Choose from four exterior paint and graphics packages to make the exterior of the motorhome a perfect fit for your style.

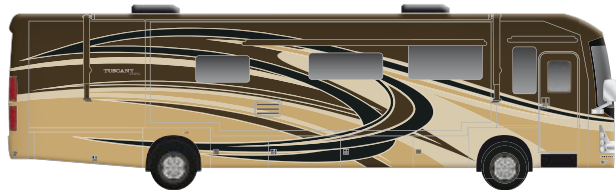

MIRAGE FULL-BODY PAINT

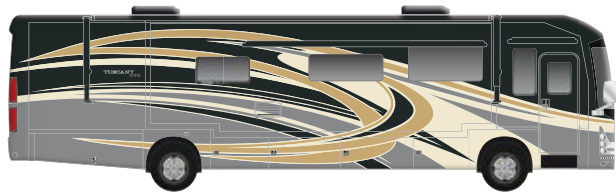

OLYMPUS FULL-BODY PAINT

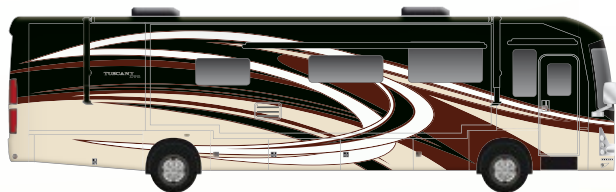

PALISADE FULL-BODY PAINT

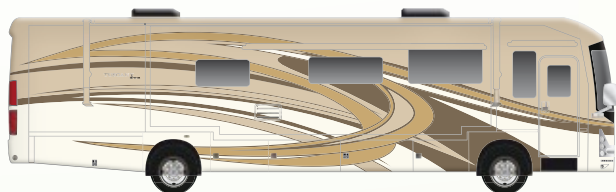

VERONA FULL-BODY PAINT







**A | FULL-BODY PAINT**

A striking exterior graphics design provides a jaw-dropping experience. The paint process includes alternating layers of paint and clear coat to provide a silky exterior finish.

**B | FRAMELESS WINDOWS**

Sleek, automotive-style frameless windows look great with an added twist of functionality. The windows are hinged to open outward for ventilation, even in rainy weather.

**C | POWER PATIO AWNING WITH INTEGRATED LED LIGHTING**

A legless, lateral arm awning is fully encased in a metal box protecting it during driving. When extended, the awning does not have legs intruding into the camp area and it has the ability to self-retract in windy situations.

**D | 3TRAX™ WALL SLIDE SYSTEM**



An in-wall slideout system on select models, housing all the moving and mechanical parts within the sidewall of the motorhome. What sets 3TRAX™ apart is the patented rail system, in-floor roller guides, and electric motor design. This triple track design supports large rooms ensuring simple, reliable, maintenance-free operation.

**E | SIDE VISION CAMERAS**

Side vision cameras, integrated into the exterior mirror housing, vastly increase the line of sight along the side of the coach, keeping you safe on the road.

**F | LED ACCENT LIGHTING**

A beautifully sculpted front cap is fully illuminated with LED accents, including the Tuscany nameplate and accompanying driving lights.

# LAY THE GROUNDWORK FOR SAFE TRAVELS

A home needs a strong foundation and that is especially true for the home that rolls down the road. The custom engineered structure and Freightliner chassis under the Tuscany XTE provide an excellent base to construct your new motorhome.



**Driven By You**

**A | FRONT DISC BRAKES**

Large 17-inch air disc brakes help stop the coach quickly, while dissipating heat to help prevent brake fade.

**B | 55° WHEEL CUT**

With 55-degrees of wheel cut, turning circles can be drastically reduced. The Tuscany XTE can turn around in even the tightest of spaces.

**C | FREIGHTLINER® & MOR/RYDE® CHASSIS**

We have partnered with Freightliner Custom Chassis and Mor/Ryde manufacturing to engineer the best foundation in the business. Freightliner's advanced chassis technology provides a safe and stable platform for maneuvering the coach down the road, while Mor/Ryde's steel structure ensures the perfect integration of chassis to the home.

**D | DIESEL EXHAUST FLUID**

Almost all truck stops offer diesel exhaust fluid (DEF) in bulk at the pump, but only on the driver's side of the island. The Tuscany XTE is thoughtfully designed to include the DEF tank on the driver's side of the coach.

**E | 10,000-LB. HITCH**

The diesel engine has plenty of torque to pull the heaviest of towed vehicles. The hitch includes a 7-pin round connector.



# BACKED BY CUMMINS ONAN® POWER

You don't have to settle for second best. That's why we chose Cummins®, the number-one choice for diesel power.



The Tuscany's Cummins Onan® ISB-XT 6.7L diesel engine is mated to a 6-Speed Allison MH-3000 automatic transmission, providing 360-horsepower and 800 lb.-ft. of torque. This combination delivers maximum performance, reliability and durability.



The 8,000-watt Cummins Onan® RV diesel generator provides all the power needed to make your motorhome self-contained. Run all the appliances, air conditioners, TVs and lights without ever plugging into an electrical outlet.

Taking the extra time to ensure the best possible structure is exactly what you deserve, and this is why Thor Motor Coach insists on vacuum-bond laminating not only the sidewalls of the motorhome, but also the floor and roof. Vacuum-bonding is the optimum manufacturing process to ensure multi-layer integrity.



### ROOF

- A** One-piece exterior TPO membrane
- B** Luan panels
- C** Aluminum structure with bowed framing
- D** Block foam insulation
- E** Interior panel with soft touch vinyl covering

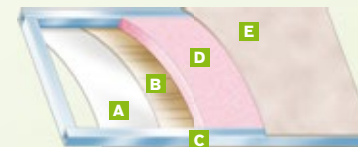

### SIDEWALLS

- A** High-gloss or gel-coat fiberglass
- B** Luan panels
- C** Aluminum structure with framing at all openings
- D** Block foam insulation
- E** Interior panel with designer wall covering



### FLOOR

- A** Porcelain tile flooring
- B** 1/4" cement board underlayment
- C** OSB structure wood base
- D** Structural steel framing
- E** Block foam insulation
- F** Luan with woven plastic exterior finish



36MQ | IVORY SONATA | HIGH-GLOSS GLAZED RESORT CHERRY



40AX | AVANT-GARDE | HIGH-GLOSS GLAZED RESORT CHERRY



36MQ | IVORY SONATA | HIGH-GLOSS GLAZED RESORT CHERRY

 **THOR**  
MOTOR COACH  
Made to fit.

# FLOOR PLANS

Maximum living and seating space is at the forefront of the Tuscany XTE. Lush, well-appointed decors enhance the handcrafted high-gloss glazed cabinetry, along with the high-end amenities, making these wide open spaces feel just like home. The Tuscany XTE offers a wide variety of floor plans made to fit your lifestyle. Optional furniture packages help customize the interior to fit your individual taste.

## 34ST

Chassis	Freightliner XC-R
Gross Vehicle (GVWR)	32,400
Gross Combined (GCWR)	42,400
Wheel Base	208"
Exterior Length	35'-4"
Exterior Height (w/AC)	12'-7"
Exterior Width (w/o mirrors)	101"
Interior Height (living area)	85"
Awning Size	16'-5"
Fuel (gal)	100
LPG (lbs)	126
Fresh/Waste/Gray Water (gal)	91 / 51 / 51
Water Heater (gal)	10
Furnace (BTUs)	Dual 20,000
Exterior Storage Capacity (cu. ft.)	140

## 34ST

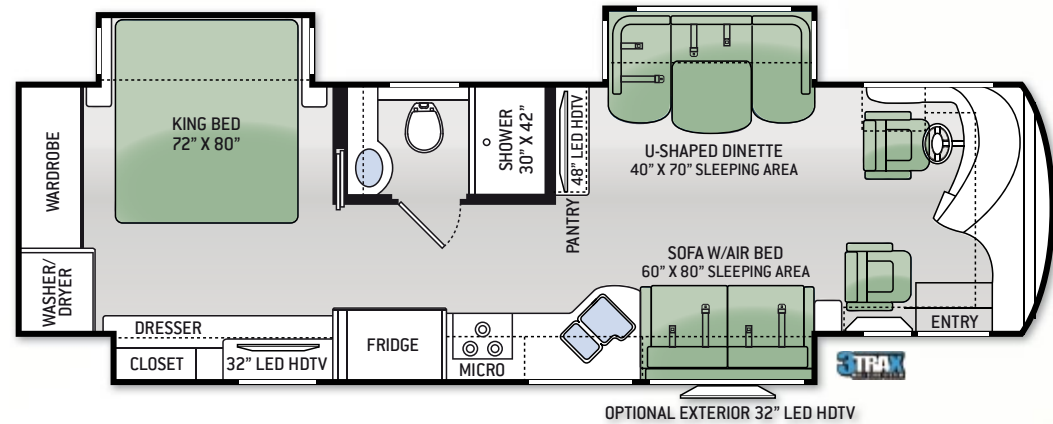

## 36MQ

Chassis	Freightliner XC-R
Gross Vehicle (GVWR)	32,400
Gross Combined (GCWR)	42,400
Wheel Base	236"
Exterior Length	37'-8"
Exterior Height (w/AC)	12'-7"
Exterior Width (w/o mirrors)	101"
Interior Height (living area)	85"
Awning Size	13'-1"
Fuel (gal)	100
LPG (lbs)	126
Fresh/Waste/Gray Water (gal)	91 / 51 / 51
Water Heater (gal)	10
Furnace (BTUs)	Dual 20,000
Exterior Storage Capacity (cu. ft.)	185

## 36MQ

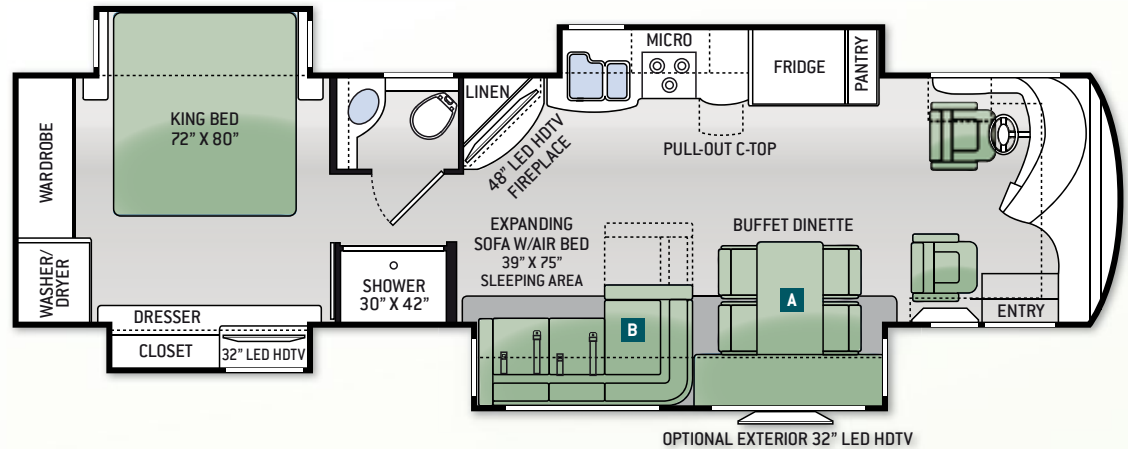

## OPTIONS \*\*EXTERIOR TV NOT AVAILABLE ON 36MQ WHEN DREAM DINETTE IS OPTIONED

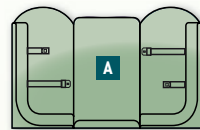

OPTIONAL DREAM DINETTE  
36" X 62" SLEEPING AREA

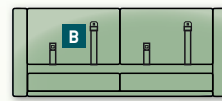

OPTIONAL SOFA W/AIR BED  
60" X 80" SLEEPING AREA



OPTIONAL DREAM DINETTE  
36" X 62" SLEEPING AREA

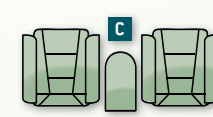

OPTIONAL DUAL EURO RECLINERS

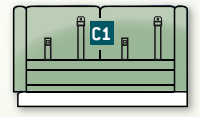

OPTIONAL JACK-KNIFE SOFA  
40" X 68" SLEEPING AREA



### 40AX

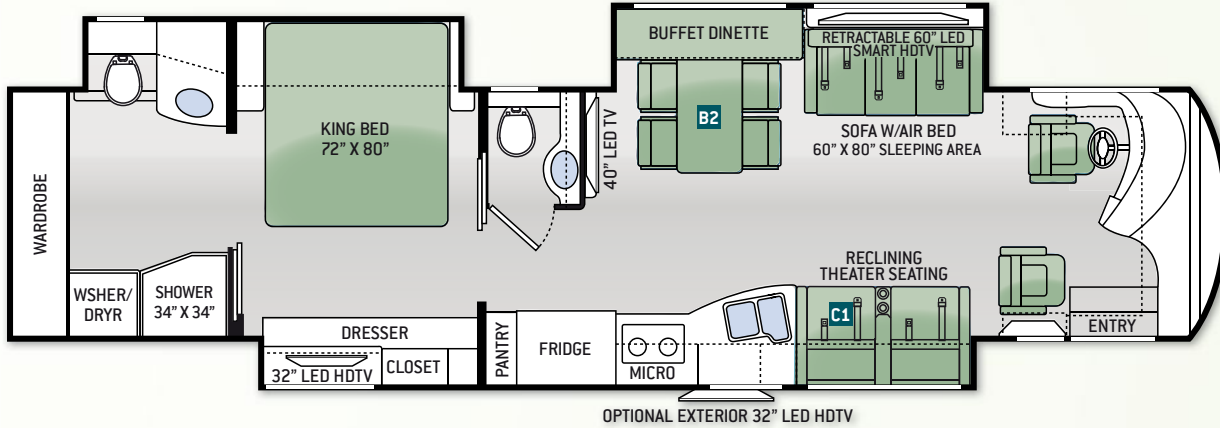

### 40AX

Chassis	Freightliner XC-R
Gross Vehicle (GVWR)	32,400
Gross Combined (GCWR)	42,400
Wheel Base	276"
Exterior Length	41'
Exterior Height (w/AC)	12'-7"
Exterior Width (w/o mirrors)	101"
Interior Height (living area)	85"
Awning Size	16'-5"
Fuel (gal)	100
LPG (lbs)	126
Fresh/Waste/Gray Water (gal)	91 / 51 / 51
Water Heater (gal)	10
Furnace (BTUs)	20,000 & 25,000
Exterior Storage Capacity (cu. ft.)	225

### 40BX

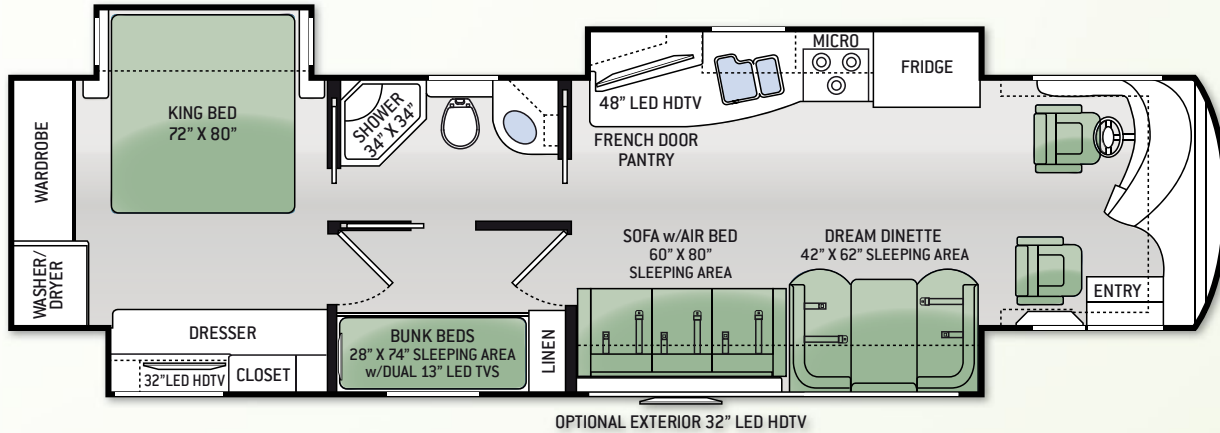

### 40BX

Chassis	Freightliner XC-R
Gross Vehicle (GVWR)	32,400
Gross Combined (GCWR)	42,400
Wheel Base	276"
Exterior Length	41'
Exterior Height (w/AC)	12'-7"
Exterior Width (w/o mirrors)	101"
Interior Height (living area)	85"
Awning Size	16'-5"
Fuel (gal)	100
LPG (lbs)	126
Fresh/Waste/Gray Water (gal)	91 / 51 / 51
Water Heater (gal)	10
Furnace (BTUs)	20,000 & 25,000
Exterior Storage Capacity (cu. ft.)	225

### 40GQ

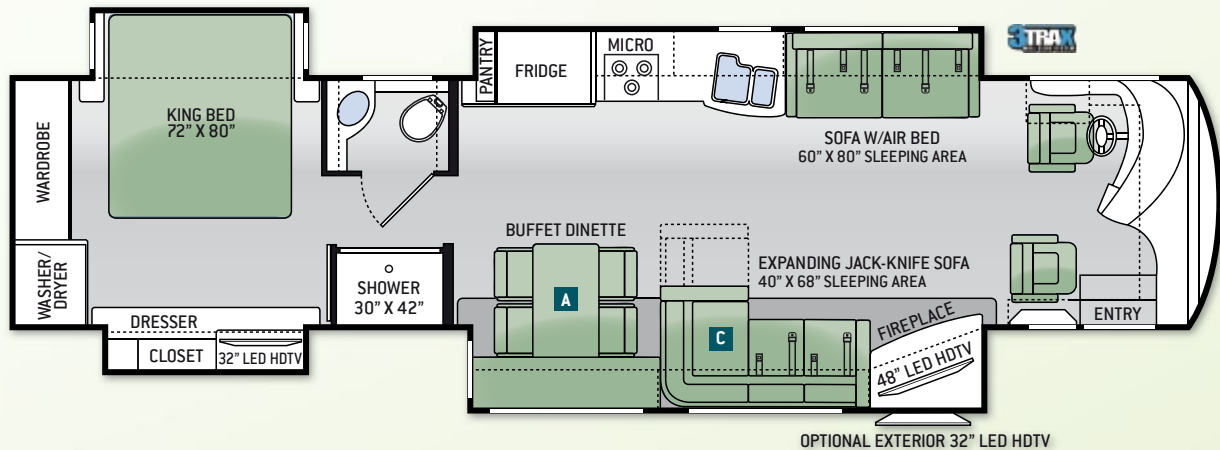

### 40GQ

Chassis	Freightliner XC-R
Gross Vehicle (GVWR)	32,400
Gross Combined (GCWR)	42,400
Wheel Base	276"
Exterior Length	41'
Exterior Height (w/AC)	12'-7"
Exterior Width (w/o mirrors)	101"
Interior Height (living area)	85"
Awning Size	16'-5"
Fuel (gal)	100
LPG (lbs)	126
Fresh/Waste/Gray Water (gal)	91 / 51 / 51
Water Heater (gal)	10
Furnace (BTUs)	20,000 & 25,000
Exterior Storage Capacity (cu. ft.)	225

# STANDARDS & OPTIONS

## CONSTRUCTION & EXTERIOR

- Freightliner® XC-R Raised Rail Chassis
- Cummins® ISB-XT Diesel Engine with 360HP, 800 lb.-ft. Torque
- 6-Speed Allison MH-3000 Automatic Transmission
- Air-Ride Suspension
- I-Beam Front Axle with 55° Wheel Cut
- Full Air Front Disc & Rear Drum Anti-Lock Brakes
- Exhaust Brake
- Sachs® Shock Absorbers
- Under-Hood Light
- Dual Fuel Fills
- One-Piece Fiberglass Front & Rear Caps
- Invisible Bra
- One-Piece Tinted Windshield
- Full-Body Paint Package with Gel-Coat Sidewalls
- Automatic Leveling Jacks with Touchpad Controls
- Side-Hinged Compartment Doors
- Full Basement Pass-Through Storage
- Easy Slide Storage Tray
- Power Entry Door & Patio Awnings with Integrated LED Lighting
- Slideout Topper Awnings
- 3TRAX™ Wall Slide System (34ST & 40GQ) 
- Roof Ladder
- Fog Lights
- Frameless Dual Pane Windows
- Outside Shower

## AUTOMOTIVE & COCKPIT

- Touchscreen Dash Radio with CD Player & Back-Up Monitor

- Chrome Heated/Power Mirrors with Integrated Side View Cameras
- Leatherette Reclining/Swivel Captain's Chairs with 6-Way Power Adjustment
- Driver & Passenger Overhead Storage Cabinetry
- Cruise Control
- Dash Fans
- Air Horn
- Electric Windshield Solar & Privacy Shade
- Manual Side Window Solar & Privacy Shades
- Electric Step Cover
- 10,000-lb. Trailer Hitch with 7-pin Round Connector
- 275/70R 22.5" Radial Tires with Aluminum Wheels

## INTERIOR

- Porcelain Tile Throughout
- High-Gloss Glazed Raised Panel Hardwood Cabinetry\*
- Hardwood Veneer in Select Areas
- LED Ceiling Lights
- Window Solar & Privacy Shades
- Fireplace (36MQ & 40GQ)
- Leatherette Expanding Sofa with Air Bed (36MQ)
- Leatherette Expanding Jack-Knife Sofa (40GQ)
- Leatherette Theater Seating with Footrest (4OAX)
- Leatherette U-Shaped Dinette (34ST)
- Buffet Dinette with Four (4) Chairs (36MQ, 4OAX & 40GQ)

## INTERIOR OPTIONS

- Leatherette Sofa with Air Bed (OPT 36MQ / STD 34ST, 4OAX, 40BX & 40GQ)
- Dual Leatherette Euro Recliners with End Table (40GQ)

- Leatherette Jack-Knife Sofa (4OAX)
- Leatherette Dream Dinette™ Booth (OPT 36MQ\*\*, 4OAX & 40GQ / STD 40BX)

## KITCHEN

- Stainless Steel Residential Refrigerator with In-Door Ice & Water Dispenser
- 3-Burner Gas Cooktop
- 1.9 cu. ft. Stainless Steel Over-the-Range Convection Microwave Oven
- Solid Surface Kitchen Countertop, Range Cover & Sink Covers
- Large Double Bowl Kitchen Sink with Single Handle Faucet & Sprayer
- Designer Backsplash with Tile Accent
- 12-Volt Attic Fan

## BEDROOM & BATHROOM

- Denver Mattress® King Size Bed
- Bedspread with Throw Pillows
- Bunk Beds (40BX)
- Porcelain Toilet
- Oversized Full Height Shower with Glass Door
- Power Vent in Bathroom

## ENTERTAINMENT

- 48" LED HDTV in Living Area (34ST, 36MQ, 40BX & 40KQ)
- 40" LED HDTV & 60" LED Smart HDTV in Living Area (4OAX)
- Entertainment Center including Blu-Ray/DVD Player & Surround Sound in Living Area
- 32" LED HDTV in Bedroom
- Dual 13" LED TVs with DVD Player in Bunk Bed Area (40BX)
- Cable TV & HDMI Video Ready

## ENTERTAINMENT OPTIONS

- 32" LED HDTV in Cockpit Overhead (OPT 34ST, 36MQ, 40BX & 40GQ / STD 4OAX)
- Exterior 32" LED HDTV\*\*
- Winegard™ Traveler HD Satellite

## ELECTRICAL & PLUMBING

- Cummins Onan® RV QD 8000 Diesel Generator
- Automatic Generator Start
- 50-amp Shoreline Power Cord
- 2000-watt Inverter /100-amp Converter
- Dual 15,000 BTU Low-Profile Ducted Air Conditioners with Heat Pumps
- Dual 20,000 BTU Ducted Electronic Ignition Furnace (34ST & 36MQ)
- (1) 20,000 & (1) 25,000 BTU Ducted Electronic Ignition Furnace (4OAX, 40BX & 40GQ)
- Energy Management System
- Emergency Start Switch
- Four (4) Auxiliary House Batteries
- Battery Disconnect Switch
- Exterior GFCI Recept
- 10-gallon DSI Gas/Electric Water Heater
- Enclosed Heated Potable & Holding Tanks
- E-Z Flow Water Panel with Whole-House Water Filtration
- Black Water Tank Flush
- Systems Control Center
- Stackable Washer & Dryer
- Central Vacuum System

\* INCLUDED ON UNITS BUILT AFTER 10/1/14

\*\* EXTERIOR TV NOT AVAILABLE ON 36MQ WHEN DREAM DINETTE IS OPTIONED

Thor Motor Coach is the industry leader in innovative design and builds a variety of unique styles, sizes and floor plans that feel custom-made – at a truly competitive price.

**IMPORTANT - PLEASE READ:** This brochure reflects product design, fabrication, material, components and specifications at the date of printing, which date is disclosed on the last page. PLEASE VISIT US ONLINE AT THORMOTORCOACH.COM OR CONSULT WITH YOUR SELLING DEALERSHIP FOR THE LATEST IN STANDARDS, OPTIONS, SPECIFICATION AND TECHNICAL INFORMATION. Photographs in the brochure may depict optional equipment or may only be available in certain floor plans. Components, appliances and the chassis may have been manufactured in a calendar year before the vehicle's designated model year. All capacities are approximate. The actual length of the vehicle may differ from that indicated in the brochure due to variances in the manufacturing processes and/or installed components. All dry weights are based on standard model features and do not include optional features or equipment. Component part and appliance manufacturers issue limited warranties covering portions of the vehicle not covered under the limited warranty we issue.

Copyright Thor Motor Coach, Inc. © 12/15/14

YOUR LOCAL THOR MOTOR COACH DEALER



Made to fit.

P.O. Box 1486, Elkhart, IN 46515  
Sales Department: 800.860.5658  
Customer Service: 877.855.2867

TuscanyRV.com/XTE

