

# TUSCANY XTE

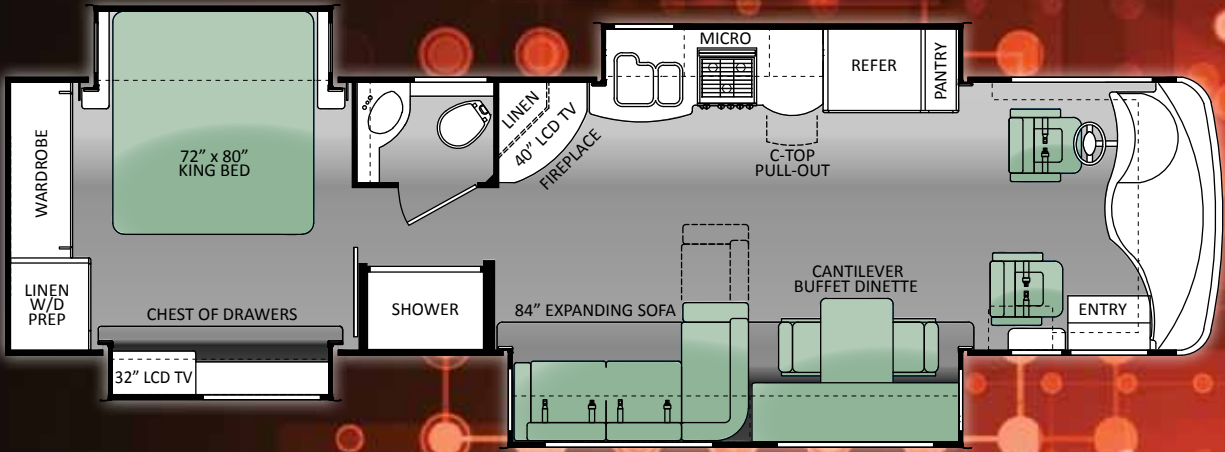

36MQ



40EX

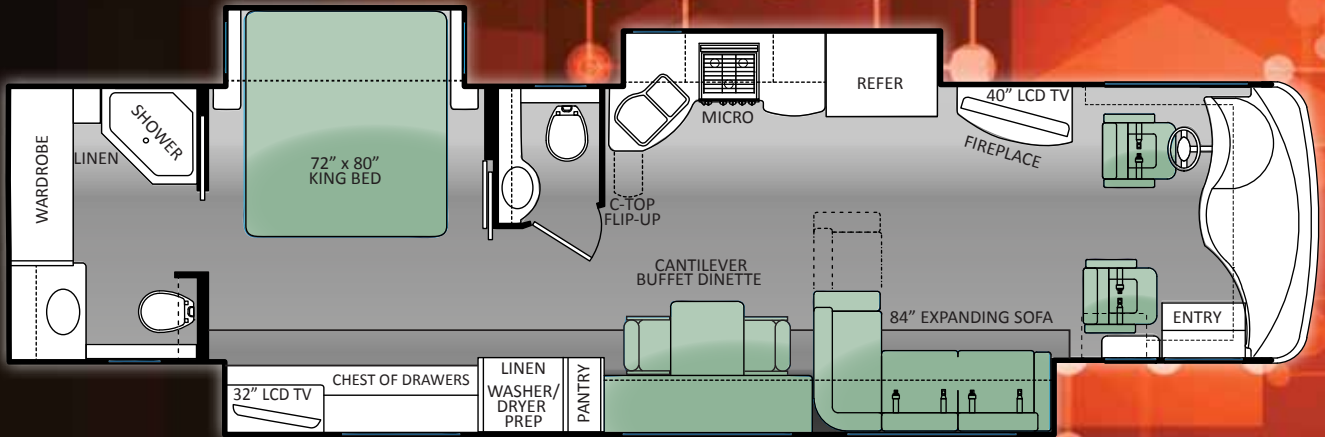

## FLOOR PLANS

## DECOR



OLYMPIC CHERRY



VINTAGE MAPLE



MYSTIC BRONZE



SAND CASTLE



TOASTED ALMOND

## SPECS

36MQ	Chassis	Freightliner XC
	Gross Vehicle Weight Rating (GVWR)	32,400
	Gross Combined Weight Rating (GCWR)	42,400
	Wheel Base	236"
	Exterior Length (without ladder)	37'-4"
	Exterior Height (with air conditioning)	12'-8"
	Exterior Width (without mirrors)	101"
	Interior Height	85"
	Awning Size	13'
	Fuel (gallons)	100
	LPG (pounds)	126
	Fresh Water (gallons)	91
	Grey Water (gallons)	51
	Waste Water (gallons)	51
	Water Heater (gallons)	10
	Furnace (BTUs)	2 (20,000)
	Exterior Storage Capacity (cubic feet)	185

40EX	Chassis	Freightliner XC
	Gross Vehicle Weight Rating (GVWR)	32,400
	Gross Combined Weight Rating (GCWR)	42,400
	Wheel Base	266"
	Exterior Length (without ladder)	39'-10"
	Exterior Height (with air conditioning)	12'-8"
	Exterior Width (without mirrors)	101"
	Interior Height	85"
	Awning Size	16'-5"
	Fuel (gallons)	100
	LPG (pounds)	126
	Fresh Water (gallons)	91
	Grey Water (gallons)	51
	Waste Water (gallons)	51
	Water Heater (gallons)	10
	Furnace (BTUs)	(2) 20,000
	Exterior Storage Capacity (cubic feet)	215

# STANDARD & OPTIONS

## CHASSIS

- Freightliner XC Raised Rail Chassis
- ISB-XT 360-hp Cummins Engine with 800 ft lb of Torque
- 6 Speed Allison MH-3000 Automatic Transmission
- 22.5" Radial Tires with Aluminum Wheels
- Full Air Brakes with Auto Slack Adjusters
- Air-Ride Suspension
- Exhaust Brake
- Under-Hood Light
- Dual Fuel Fills
- Emergency Start Circuit
- Full Width Stainless Stone Guard with Tuscany XTE Emblem
- 10,000 lb Trailer Hitch
- Automatic Hydraulic 4-Point Leveling Jacks

## CONSTRUCTION & EXTERIOR

- Fiberglass Front and Rear Caps
- Tinted One Piece Windshield
- Black Framed Dual Pane Windows
- Full Body Paint with Gel Coat Wall
- Invisible Bra
- Electric Entry Door Awning
- Lateral Arm Electric Patio Awning
- Slide Out Topper Awnings
- Fog Lights
- Full Basement
- Fiberglass Basement Storage Compartments
- Pass-Through Storage
- Easy Slide Storage Tray

- Side-Hinged Locking Aluminum Compartment Doors
- Rear Ladder

## AUTOMOTIVE & COCKPIT

- Electric Windshield Day / Night Privacy Shade
- Manual Side Day / Night Privacy Shades
- 6 Way Power Ultra Leather Reclining Driver and Passenger Seats
- Driver and Passenger Overhead Storage Cabinetry
- Front Mount Power Mirrors with Heat and Integrated Side View Camera System
- Back-up Monitor System with Audio
- Premium AM/FM Radio with In-Dash CD Player
- Electronic Cruise Control
- Air Horn
- Dash Fans
- Electric Step Cover

## MULTIMEDIA

- 40" High Definition LCD Television in Living Area
- 32" High Definition LCD Television in Bedroom
- Surround Sound Home Theater
- Blu-Ray Disc/DVD Player
- Satellite Dish Prep

## MULTIMEDIA OPTIONS

- 32" High Definition LCD Television in Cockpit Overhead
- 32" High Definition LCD Television in Exterior

Entertainment Center

- In-Motion Satellite Dish

## INTERIOR

- Solid Wood Raised Panel Cabinet Doors Throughout
- Solid Surface Kitchen Countertop, Range Cover, Sink Covers and Lavatory Countertop
- Tile Kitchen Backsplash
- Day / Night Roller Shades in Living Area & Bedroom
- Porcelain Tile Throughout
- Halogen Lighting Throughout
- Ultra Leather Furniture
- Cantilever Buffet with Computer Workstation and Two Chairs
- Two Folding Chairs
- King Bed with Pillow Top Mattress
- Bedspread with Throw Pillows

## INTERIOR OPTIONS

- Ultra Leather Sofa/Air Bed on Passenger Side

## KITCHEN

- Stainless Steel Residential Refrigerator with In-Door Ice & Water Dispenser
- 3-Burner Cooktop
- 30" Over-the-Range Convection Microwave Oven
- Single Lever Faucet with Sprayer

## KITCHEN OPTIONS

- 12-volt 4-Door Stainless Steel Refrigerator with Ice Maker

## ELECTRICAL & PLUMBING

- Dual 13.5K BTU Ducted Central Air Conditioning with Heat Pumps
- Fantastic® Power Vent in Kitchen
- (2) 20,000 BTU Ducted Electronic Ignition Furnace
- 50-AMP, 120-volt Service
- Onan RV QD 8000 Diesel Generator
- Auto Gen Start
- 2000-watt inverter / 100-amp Converter
- (4) 6-volt Auxiliary House Batteries
- Battery Disconnect
- Energy Management System
- Carbon Monoxide, Propane & Smoke Detectors
- Monitor Panel with Propane Readout
- 10-gallon Gas/Electric Water Heater with Electric Ignition
- Water Heater By-Pass Kit
- Stackable Washer and Dryer Prep
- Full Height shower with Door
- Skylight in Shower
- Foot Flush Porcelain Toilet with Sprayer
- Enclosed Heated Potable and Holding Tanks
- Black Tank Flush
- E-Z Flow Water Panel with Whole-House Water Filtration
- Exterior Shower

## ELECTRICAL & PLUMBING OPTIONS

- Stacking Washer and Dryer

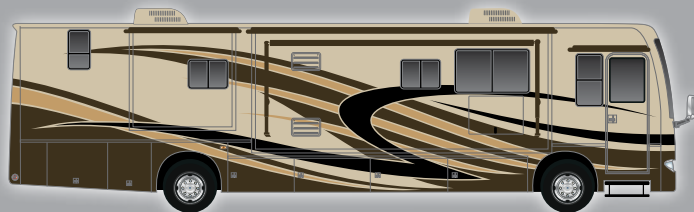

**AUTUMN RIDGE FULL BODY PAINT**

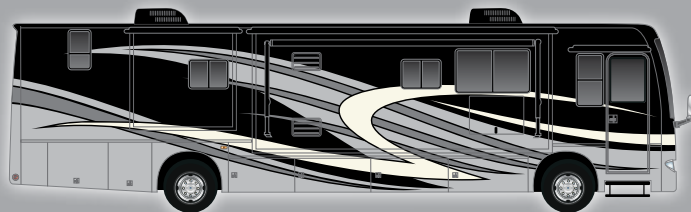

**STEEL GREY FULL BODY PAINT**

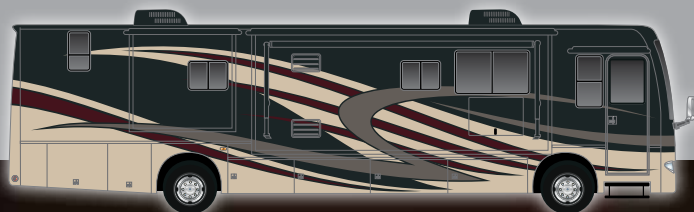

**SEDONA FULL BODY PAINT**

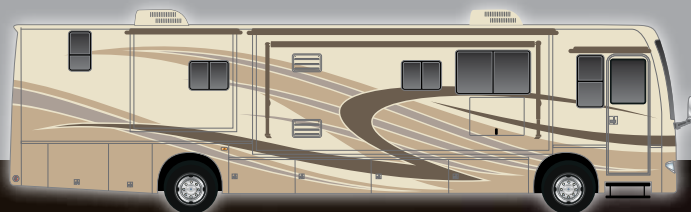

**VANILLA BEAN FULL BODY PAINT**

**IMPORTANT - PLEASE READ:** Information published within this brochure reflects product design, fabrication, material, components and specifications at the date of printing. If your vehicle was manufactured before this brochure was published this information may not be accurate because vehicles assembled before the brochure was published may not have the same design, fabrication, materials, components and specification as represented in the brochure. If your vehicle was manufactured after this sales brochure was published the representations may not be accurate because, for product improvement reasons, we reserve the unilateral right, at any time, without prior notice, to make changes in product design, material, components and specifications. The date the brochure was published (i.e. "Julian date") is set forth on the last page of the brochure. IF CERTAIN INFORMATION PUBLISHED WITHIN THIS BROCHURE IS SIGNIFICANT TO YOUR PURCHASING DECISION, PLEASE CONSULT WITH YOUR SELLING DEALERSHIP TO CONFIRM THAT THE INFORMATION IS ACCURATE WITH RESPECT TO THE VEHICLE YOU ARE CONSIDERING PURCHASING. Photographs in the brochure may depict optional equipment or may only be available in certain floor plans. We reserve the right to make changes in prices and models and to discontinue models without notice or obligation. Components, appliances and the chassis may have been manufactured in a calendar year before the vehicle's designated model year. All capacities are approximate. The actual length of the vehicle may differ from that indicated in the brochure due to variances in the manufacturing processes and/or installed components. All dry weights are based on standard model features and do not include optional features or equipment. Components, appliances and features may differ to conform to local codes. Due to EPA environmental restrictions, engine power and torque ratings may change during any model year. The Thor Motor Coach logo and its design are registered trademarks. Other products and company names are trademarks and/or registered trademarks of their respective manufacturer. While the color of the motorhome's exterior and the interior fabrics depicted in this brochure are fair and reasonable depictions, the colors depicted may not be exact match of the actual colors because of variances in photo processing and printing. Component part and appliance manufacturers issue limited warranties covering portions of the vehicle not covered under the limited warranty we issue. To learn specific details regarding warranty coverage please consult your selling dealership or review the warranty packet inside the vehicle.

# TUSCANY XTE



**YOUR LOCAL TMC DEALER:**

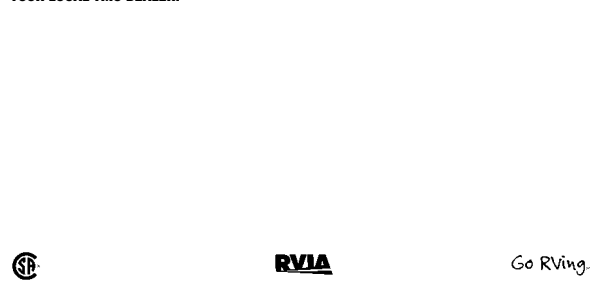

Go RVing.