

Four Winds

Class C Motorhomes

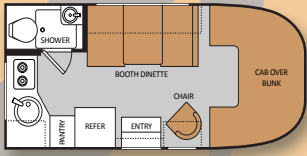

19G

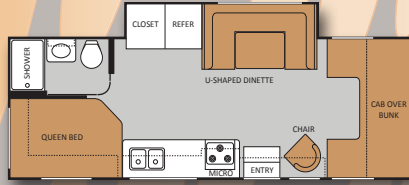

25C

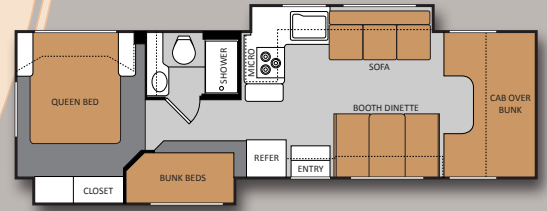

31A

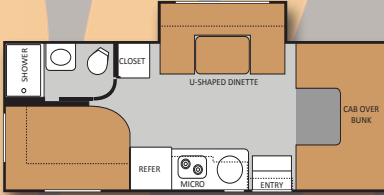

23S

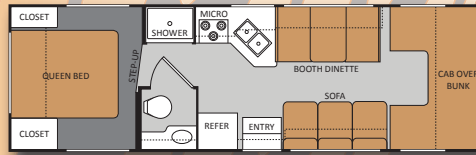

28A MEGA STORAGE

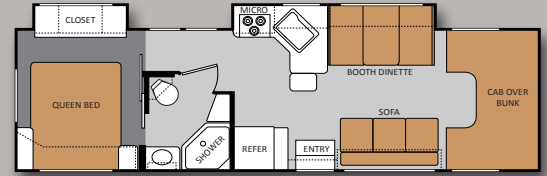

31F NEW FLOOR PLAN

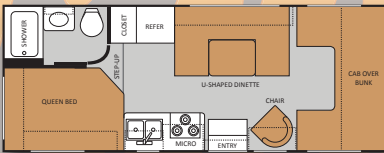

23U MEGA STORAGE

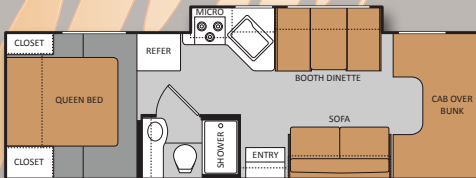

28Z MEGA STORAGE

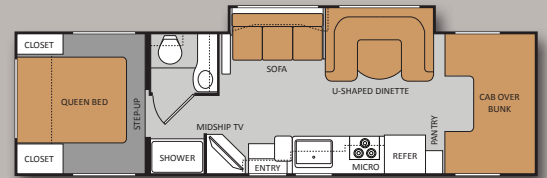

31K

Specifications

	Model	19G	23S	23U	25C	28A	28Z	31A	31F	31K
WEIGHT RATING (LBS.)	Ford Chassis with Triton engine	5.4L/V-8	N/A	6.8L/V-10	6.8L/V-10	6.8L/V-10	6.8L/V-10	6.8L/V-10	6.8L/V-10	6.8L/V-10
	Gross Vehicle (GVWR)	10,050	N/A	12,500	14,500	12,500	14,500	14,500	14,500	14,500
	Gross Combined (GCWR)	13,000	N/A	18,500	22,000	18,500	22,000	22,000	22,000	22,000
	Chevy Chassis with 6.0L Vortec engine	N/A	N/A	V-8	V-8	V-8	N/A	N/A	N/A	N/A
	Gross Vehicle (GVWR)	N/A	N/A	12,300	14,200	12,300	N/A	N/A	N/A	N/A
	Gross Combined (GCWR)	N/A	N/A	18,500	20,000	18,500	N/A	N/A	N/A	N/A
MEASUREMENTS	Sprinter Chassis with 3.0L diesel engine	N/A	V-6	N/A	N/A	N/A	N/A	N/A	N/A	N/A
	Gross Vehicle (GVWR)	N/A	11,030	N/A	N/A	N/A	N/A	N/A	N/A	N/A
	Gross Combined (GCWR)	N/A	15,250	N/A	N/A	N/A	N/A	N/A	N/A	N/A
	Exterior Length without ladder (Ford)	19'10"	24'9"	24'10"	27'4"	29'9"	29'11"	32'2"	32'2"	32'7"
	Exterior Length without ladder (Chevy)	N/A	N/A	25'4"	27'11"	30'3"	N/A	N/A	N/A	N/A
	Exterior Height (with air conditioning)	10'3"	11'	10'10"	10'10"	10'10"	10'10"	10'10"	10'10"	10'10"
CAPACITIES	Exterior Width (without mirrors)	91"	90"	99"	99"	99"	99"	99"	99"	99"
	Interior Height	80"	80"	82"	82"	82"	82"	82"	82"	82"
	Awning Size (manual/electric)	8'/-	15'/15'	15'/15'	18'/18'	14'/14'	14'/14'	10'6"'/-	16'/16'	16'/16'
	Fuel - Ford/Chevy (gallons)	40/-	26.4	55/57	55/57	55/57	55/-	55/-	55/-	55/-
	LPG (pounds)	40	68.2	40.9	40.9	40.9	40.9	40.9	40.9	40.9
	Fresh/Waste (gallons)	20.5/17	40/38	40/24.5	40/24.5	40/25	40/26	40/26	40/28	40/31
Gray Water (gallons)	16.5	34	38.5	38.5	22	22	31	28/23	29/23	
Water Heater (gallons)	6	6	6	6	6	6	6	6	6	
Furnace (BTUs)	16,000	25,000	25,000	30,000	30,000	30,000	30,000	30,000	30,000	
Exterior Storage Capacity (cubic feet)	6	65	69	69	108	108	53	99	99	

Four Winds Class C Standard & Optional Features

BODY CONSTRUCTION/EXTERIOR		Spare tire (N/A 19G)	S	Fantastic® fan in kitchen area	O	Bunk beds in hallway slide room (31A)	S
Fully welded tubular aluminum roof and sidewall cage construction	S	Aluminum wheels (19G only)	S	Fantastic® fan in overhead bunk (N/A on 19G & 23S)	O	Bedsread and pillow shams (N/A 19G)	S
Vacu-Bond laminated roof, walls and floors with high-density block foam insulation	S	Wheel liners (N/A 19G)	O	GALLEY		China bowl toilet (N/A 19G)	S
Slick fiberglass exterior	S	Cockpit Carpet Mat	O	Single door refrigerator (19G only)	S	Skylight in shower	S
Exterior graphics package	S	Power driver's seat (Ford Chassis Only)	O	Double door refrigerator (N/A on 19G)	S	Shower with pleated shower curtain (19G only)	S
Exterior graphics/partial paint package	O	Leatherette driver and passenger captain's chairs	O	2-burner cooktop (19G & 23S only)	S	Shower with glass door (N/A 19G)	O
Exterior rear Mega Storage compartment (Select Models)	S	Back-up monitor	O	INTERIOR		SAFETY & CONVENIENCE	
Seamless roto-cast storage compartments	S	Residential linoleum (Galley, Bath and Living Area)	S	3-burner high-output gas range top	S	Entry door with deadbolt lock	S
Flush mount radius luggage doors	S	Residential Linoleum throughout the coach (19G, 23U & 23S only)	S	3-burner high-output gas range top with oven (N/A on 19G & 23S)	O	Smoke, LPG, carbon monoxide detector and fire extinguisher	S
Premium one-piece TPO roof	S	Metal entry grab handle	S	Microwave oven	S	Passenger seat belts in select areas	S
Manual patio awning	S	Windshield privacy curtain	S	Convection microwave	O	Child safety seat tether anchor	O
Electric patio awning (N/A 19G & 31A)	O	13,500 BTU roof air conditioner in front	S	Pantry (31F & 31K Only)	S	Convenience Package: includes keyless entry and valve stem extenders (N/A on 19G & 23S)	O
Slide-out room awning	S	15,000 BTU roof air conditioner in front (N/A on 19G & 23S)	O	Laminate countertops	S	ELECTRICAL & PLUMBING	
Roof ladder	S	Ceiling ducted air conditioning system (N/A on 19G & 23S)	S	Large single bowl sink (19G & 23S only)	S	Onan® Microquiet™ 4.0 gas generator (4000-watt)(N/A 23S)	S
Rubber Tread Entry Steps	S	Cherry cabinetry	S	Large double bowl sink (N/A 19G & 23S)	S	Onan® 3.6 LP generator (3600-watt) (Std. 23S)	S
Drop-down stairwell entrance step (N/A 23S)	S	Glazed maple cabinetry	O	Flip-up countertop extension (23U, 31A, 31F & 31K only)	S	Onan® 3.2KW diesel generator (3200-watts)(23S only)	O
Automatic electric entrance step (23S Only)	S	Raised panel upper cabinet doors	S	Full extension metal drawer guides	S	30-amp service with shoreline power cord and battery disconnect switch	S
Outside shower	O	Hardware with Brushed Nickel finish	S	ENTERTAINMENT & ACCESSORIES		Automatic generator transfer switch	O
AUTOMOTIVE/COCKPIT		Night shades throughout	S	19" LCD television on swivel in cab-over (N/A 28Z & 31K)	O	Emergency start switch (N/A 23S)	S
3,500-lb. trailer hitch (19G & 23S only)	S	Vinyl ceiling	S	22" LCD television (28Z only)	S	Second auxiliary house battery (N/A 19G)	O
5,000-lb. trailer hitch (N/A 19G & 23S)	S	Fabric barrel chair (Select Models)	S	26" television in front overhead with electric swivel in cab-over (N/A 19G, 28Z & 31K)	O	6-gallon DSI gas water heater	S
AM/FM dash radio with large buttons, CD player and weather band tuner	S	Leatherette euro recliner with ottoman in place of barrel chair (Select Models)	O	Living room entertainment center w/ 32" LCD television (31K only)	S	6-gallon DSI gas/electric water heater	O
3-point seat belts for driver and passenger	S	Fabric jackknife sofa (28A, 28Z, 31A & 31F Only)	S	19" LCD television in bedroom - can be removed and mounted to exterior hook-ups (N/A on 19G, 23U, 25C & 31A)	O	Water heater bypass system	S
Power window and door locks	S	Leatherette jackknife sofa (28A, 28Z, 31A & 31F Only)	O	Two 13" LCD televisions with DVD Player in bunk beds (31A only)	O	Holding tanks with heat pads	O
Deluxe exterior mirrors (N/A on 23S)	S	Leatherette hide-a-bed sofa with air mattress (STD 31K)	S	Coach radio system with DVD Player (23S only)	O		
Deluxe heated remote mirrors (N/A 19G)(Std. 23S)	O	Booth dinette (N/A 23S, 23U, 25C & 31K)	S	Television antenna and booster	S		
Aluminum running boards (N/A 23S)	S	Fabric U-shaped dinette (23S, 23U, 25C & 31K only)	S	BEDROOM/BATHROOM			
Fiberglass running boards (23S only)	S	Leatherette U-shaped dinette (23S, 23U, 25C & 31K only)	O	Queen-size bed with innerspring mattress (N/A 19G)	S		

Four Winds



VEHICLE LOADING: Every effort has been made to provide the greatest number of options for the recreation vehicle owner. Along with these choices comes the responsibility to manage the loads that are imposed by the choices so that they remain within the manufacturer's specified chassis weight limits. Do not overload the recreation vehicle.

IMPORTANT: Towing capacity may vary by chassis model, floorplan, options and loading of the vehicle. This may result in a towing capacity which is less than the maximum capacity of the hitch. Do not exceed the vehicle's Gross Combined Weight Rating

(GCWR), or the hitch rating. A separate functioning brake system is required for any towed vehicle or trailer weighing more than 1,000 lbs. (450 KG) when fully loaded. Liquid capacities and weights are approximations only.

WARNING: This information is intended as a guide only. Weights of individual vehicles may vary. Consult your owner's manual and weight sticker affixed to each vehicle for complete loading, weighing, and towing instructions.

WARRANTY: The vehicles are provided with a twelve (12) month, 15,000-mile limited warranty. Chassis,

component part and appliance manufacturers may issue limited warranties covering those portions of the vehicle not covered by the limited warranties issued by Thor Motor Coach. To learn what portions of the vehicle are excluded from coverage under the limited warranties issued by Thor Motor Coach, please contact your selling dealership or Thor Motor Coach directly, or review the warranty packet inside the vehicle.

Product information, specifications, and photography in this brochure were as accurate as possible at time of printing. Photographs may contain some

features that are optional on your vehicle. Since we continually strive to improve our products, actual products may differ. The manufacturer reserves the right, at any time, to make changes in product design, materials, component specifications and pricing, without notice. All capacities are approximate and dimensions are nominal. Some features or options may be different or unavailable in Canada.

