

**2010**

**Quest**



***Turns Heads While Turning Corners.***

**2010 QUEST**

**FLEETWOOD RV**



# FLOOR PLANS

24E

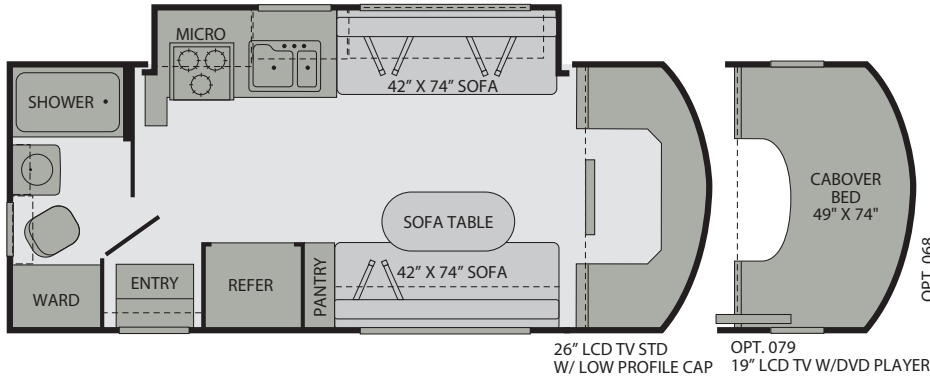

24L

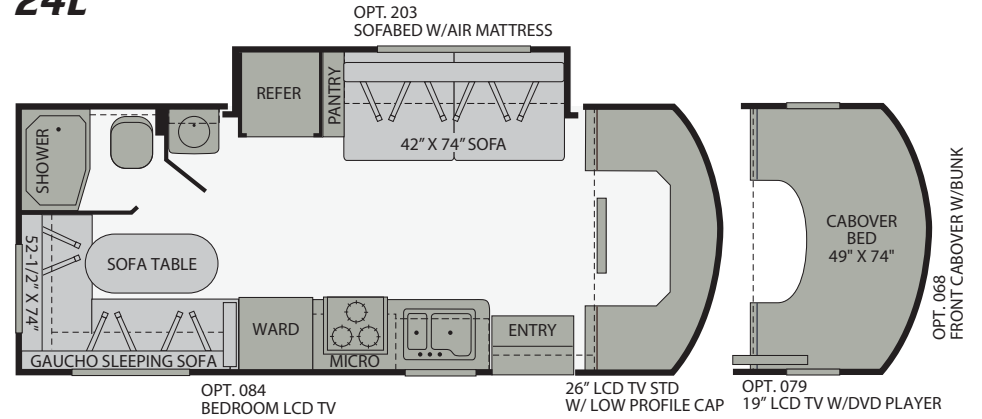

Seatbelt configuration may vary depending on options chosen.

## INTERIOR PHOTOS

**Galley** - The galley contains an Apollo Half Time Convection Oven, a 3-burner cook top and refrigerator/freezer - everything you need to cook your family favorites on the road.



**Cabover Entertainment Center** - Don't miss your favorite shows - just turn on the crystal clear 26" LCD TV wherever you are.



**Gauchito Dinette** - At the end of a long day exploring, enjoy dinner in your spacious dinette. After dinner, convert it into a comfortable double bed.

## STANDARD FEATURES

### INTERIOR THROUGHOUT

- Complete TuffPEX Plumbing System
- 80" Interior Height
- 12V Water Pump, Demand Operation
- 13,000 Btu Conventional Air Conditioner
- 25,000 Btu Furnace, Wall Mounted Thermostat
- 6 Gallon Propane Water Heater w/Electronic Ignition
- Hardwood Raised Panel Upper Cabinet Doors
- Hidden Cabinet Door Hinges
- Auxiliary Battery w/Disconnect Switch
- Deluxe Roller Bearing, Full Extension Drawer Guides & Transit-Ship Locks
- Water Pump with On/Off Switch at monitor panel
- Quality Constructed Furniture by Flexsteel®
- Water Heater Bypass Valve Fresh Water System Winterization
- Central Monitor Panel
- GFI Circuit Protection
- Full Length Linoleum
- Pleated Night Shades in Living Room & Bedroom
- AC/DC Load Center w/12V Converter/ Battery Charger
- Pre-Finish Lined Shelves in Overhead Cabinets
- Ozite Lined Ceilings

### DRIVER CONVENIENCE

- Dodge® Sprinter Chassis, Turbo Diesel w/Adaptive ESP®, 3.0L CDI 6-Cylinder, 154HP, Automatic 5-Speed Transmission, Independent Front Suspension
- Driver/Front Passenger Adjustable/ Reclining Bucket Seats w/Armrest & Comfort Headrest
- Folding Key w/Keyless Door Lock
- 3 Point Seat Belts at Driver & Front Passenger Seats
- Auxiliary Emergency Start Assist Switch on Dash
- In-Dash AM/FM/Radio w/CD Player & 4 Speakers

- Power Windows & Door Locks
- Driver/Front Passenger Airbag Supplemental Restraint System
- Cockpit Area w/Tilt Wheel, Cruise Control, Dome Light, Beverage Cup Holders, Map Pockets, Courtesy Lights

### LIVING ROOM

- Ceiling Lights w/Wall Switches (Entry & Bath)
- Pedestal Sofa Table w/Locking Legs (Select Models)
- Flexsteel® Fabric Jackknife Sofa Bed w/Armrests (Select Models)
- Cabover Entertainment Center w/26" LCD TV

### GALLEY

- 3 Burner Range w/High Output/Piezo Igniter
- Decorative Wall Border
- Dometic® 6 cu. ft. Refrigerator/Freezer
- Apollo Half Time Convection Oven w/Integrated Range Hood Fan and Light
- Stainless Steel Sink
- Appliance Black Refer Inserts
- Cooktop Cover
- Laminate Countertops w/Bull Nose T-Molding Edge
- Power Roof Fan-Tastic® Vent Fan

### BEDROOM (24L ONLY)

- Wall Space for TV w/AC Receptacle & Cable Jack
- Decorative Reading Lights

### BATHROOM

- Bath Door w/Residential Passage Lock & Towel Bars (Select Models)
- China Bowl Toilet
- Medicine Cabinet
- Shower Head w/Flexible Hose Extension
- Skylight/Roof Vent w/12V Fan
- Molded ABS Shower/Tub
- Residential Style Faucet
- Shower Curtain

### EXTERIOR THROUGHOUT

- High Gloss Tuff-Coat® Smooth Fiberglass Exterior
- Lg. 1" (Inside Diameter) Water Tank Drain

- Sewer Hose Storage in Bumper
- Debris Awning Above All Slide-Out Rms.
- Trailer Hitch w/7 Pin Electrical Hook-Up<sup>1</sup>
- Up to 3,500 lbs. Hitch w/350 lbs. Tongue Weight
- Stainless Steel Wheel Simulators
- Dual 6V Deep Cycle Auxiliary Batteries
- Full Size Spare Tire w/Carrier
- Wash Unit w/Faucet, Flexible Shower Hose
- Conveniently Located Fuel Fill on Driver Side B-Pillar

### BODY STRUCTURE

- One-Piece Molded Fiberglass Front End Cap
- Vacu-bond® Hull Lamination Process
- Vacu-bond® Floor
- Royal Tuff-Ply Radius Roof w/Ducted A/C
- Sidewalls Framed w/1-1/2" Aluminum Tubing
- Corrosion Resistant Aluminum Tube Hull Framing
- Molded Rear Wheel Trim Flares
- Steel Powder Coated Rear Bumper
- 26" Wide Radius Corner Entry Door w/Obscured Window
- Extruded Aluminum Running Boards w/Molded Rubber Inserts

### STORAGE

- Pass Through Storage
- Roto-Molded Polyethylene Luggage Compartments (Where Applicable)
- Galvanized Battery Compartment Container & Lid

### SAFETY & CONVENIENCE

#### INTERIOR

- 10 ABC Fire Extinguisher
- Carbon Monoxide Detector/Alarm
- Exterior & Interior Entry Assist Handle
- Propane Detector/Alarm
- Smoke Detector/Alarm
- Multiple Seatbelt Locations
- Power Electric Step

#### EXTERIOR

- 30 Amp, 30' Power Cord, Compartment Storage

- AC Duplex GFI Receptacle on Patio Side
- Amber Porch Light w/Interior Switch
- Automotive Safety Glass
- Side Mirrors w/Power Adjust & Heat Control
- Entry Door w/Screen Door & Deadbolt Lock
- High Mounted Large Taillights
- 4 Wheel Anti-Lock Brakes
- Traction Control
- Adaptive Electronic Stability Program
- Power Electric Step
- Radius Tinted Windows

## OPTIONS

### INTERIOR

- Front Cabover w/Bunk
- Fantastic Power Roof Vent
- LCD TV and DVD Player
- Bedroom LCD TV (24L)
- Sofa Bed w/Air Mattress (24L)
- Satellite Radio
- Whole Coach Water Filtration System
- Dual Glaze Windows

### EXTERIOR

- Exterior Entertainment Center
- Dodge® Chassis 3.0L Diesel
- CSA Package (Canadian Specs)\*\*
- Manual Awning
- Rear Ladder
- Clear Front Protective Mask
- Onan® 3.6kW MicroQuiet LP Generator
- Diesel Generator
- Sani-Flush Black Tank
- Holding Tank Heater
- Exterior Wash Unit
- Rear Vision Camera

\*\* CSA standards may require substitution or deletion to achieve conformance





# FABRICS

## ANTELOPE



## DESERT SAND



## WOOD FINISH



Bijoux Cherry



Symphony Cherry

# WEIGHTS AND MEASUREMENTS

## DODGE® SPRINTER CHASSIS

Models	24E	24L
Engine Displacement (Liters)	3.0	3.0
Wheelbase (Inches)	170"	170"
GVWR (lbs) <sup>1</sup>	11,030	11,030
Front GAWR (lbs) <sup>2</sup>	4,410	4,410
Rear GAWR (lbs) <sup>2</sup>	7,720	7,720
GCWR (lbs) <sup>3</sup>	14,530	14,530
Hitch Rating Weight (lbs) <sup>†</sup>	3,500	3,500
Tongue Weight (lbs) <sup>†</sup>	350	350

### Liquid Weight Reference:

Water (gal) = (8.3 lbs/3.8kgs) Fuel (gal) = 7.1 lbs/3.2 kgs)  
Propane (gal) = (4.2 lbs/1.9 kgs)

### Metric Conversion:

Multiply pounds x 0.453 to obtain kilograms.  
Multiply gallons x 3.785 to obtain liters.  
Multiply liters x 61 to obtain cubic inches.

## DIMENSIONS & CAPACITIES

Models	24E	24L
Overall Length <sup>4</sup>	25' 2"	25' 2"
Overall Height (with A/C)	11' 4"	11' 4"
Overall Width (maximum) <sup>5,6</sup>	91.5"	91.5"
Interior Height (maximum)	80"	80"
Interior Width (maximum)	88"	88"
Fuel Capacity (gal)	26.4	26.4
Fresh Water Holding Tank (gal)	29	29
Grey Water Holding Tank (gal)	33	33
Black Water Holding Tank (gal)	33	33
Water Heater Tank (gal)	6	6
Appliance Propane Tank (gal) (WC) <sup>7</sup>	24	24

- GVWR (Gross Vehicle Weight Rating) is the maximum permissible weight of this fully loaded motor home. The GVWR is equal to or greater than the sum of the (UVW) unloaded vehicle weight plus the (CCC) cargo carrying capacity\*.
  - GAWR (Gross Axle Weight Rating) is the maximum permissible loaded weight a specific axle is designed to carry.
  - GCWR (Gross Combined Weight Rating) is the value specified by the motor home manufacturer as the maximum allowable loaded weight of this motor home with its towed vehicle. Towing and braking capacities may be different. Refer to Fleetwood and chassis manufacturer's manuals for complete information.
  - Length measured from front bumper to rear bumper (excludes accessories).
  - Excludes safety equipment and awnings.
  - Motor homes feature a body-width over 96" which will restrict your access to certain roads. Before purchasing, you should research any state and/or province road laws which may affect your usage.
  - Tank manufacturer's listed water capacity (WC). Actual propane capacity is 80% of water listing as required by the safety code.
- † The chassis manufacturer recommends the installation of a supplemental brake control system to activate the brakes on the vehicle or trailer you are towing. Hitch receiver ratings expressed are maximum for the hitch receiver installed and may require the purchase of additional equipment that is dependent on the weight of the towed load. Consult with hitch receiver manufacturer for further information.

\* UVW and CCC are found on the cargo carrying capacity label in each RV.

**IMPORTANT — PLEASE READ:** Product information, photography and illustrations included in this publication were as accurate as possible at the time of printing. For further product information and changes, please visit our website at [www.fleetwoodrv.com](http://www.fleetwoodrv.com) or contact your local Fleetwood dealer. Prices, materials, design and specifications are subject to change without notice. All weights, fuel, liquid capacities and dimensions are approximate. Fleetwood has designed its recreational vehicles to provide a variety of uses for its customers. Each vehicle features optimal seating, sleeping, storage and fluid capacities. The user is responsible for selecting the proper combination of loads (i.e. occupants, equipment, fluids, cargo, etc.) to ensure that the vehicle's capacities are not exceeded.

## CONTACT US

To locate a dealer near you, visit our website at [www.fleetwoodrv.com](http://www.fleetwoodrv.com) or call 1-800-444-4905. We can also be contacted at Fleetwood Customer Relations, P.O. Box 1007, Decatur, IN 46733.

## CHASSIS

Model: Dodge® Sprinter      Torque: 280 lb-ft @ 1200-2400 RPM      Horsepower: 154HP  
Engine: Mercedes-Benz® 3.0L CDI 6-Cylinder      Alternator: 180 Amp      Transmission: 5-Speed Automatic