

REMEMBER YOUR FIRST LOVE



2010 AMERICAN EAGLE

AMERICAN EAGLE FLOOR PLANS

42M

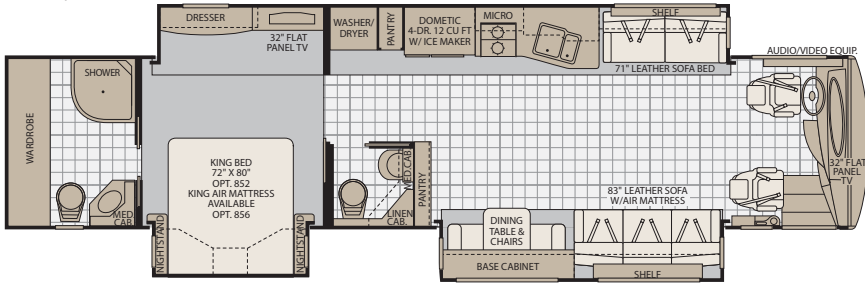

Available Options: 205, 345, 816, 828, 856, 881

42P

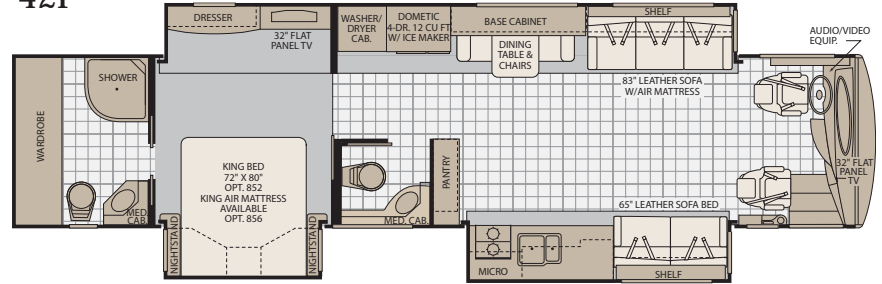

Available Options: 205, 345, 816, 828, 856, 881

45B

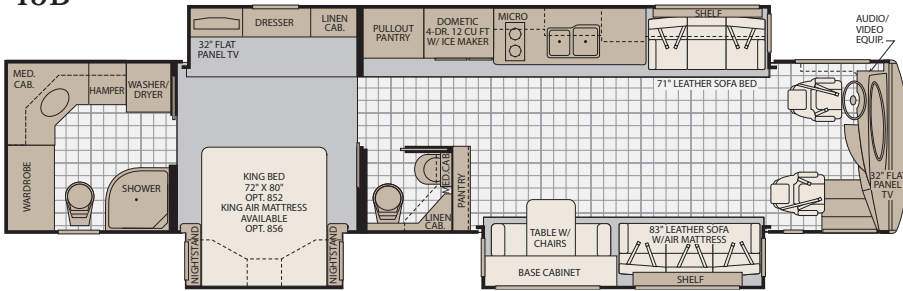

Available Options: 205, 345, 816, 828, 856, 881

45D

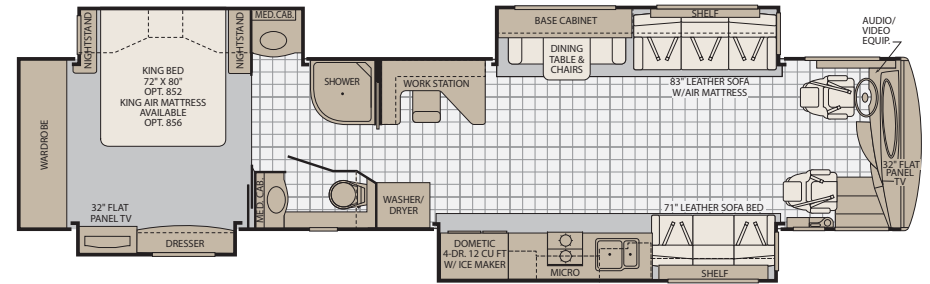

Available Options: 205, 355, 816, 828, 856

OPTIONS

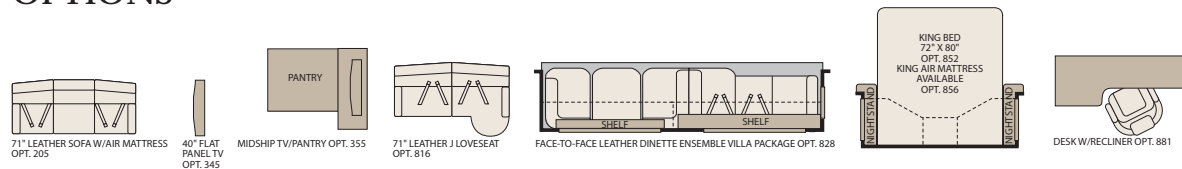

Not all available options are shown. See your American Coach dealer or visit our website at www.AmericanCoach.com to see all available options. Seatbelt configuration may vary depending on options chosen.

AMERICAN EAGLE FEATURES AND OPTIONS

FEATURES - INTERIOR

GENERAL AMENITIES

- Outlets (Multiple Locations)
- Decorative Throw Pillows
- Masland® Carpeting
- Decorative Wood Window Treatments
- Accent Rope Lighting
- Decorative Wood Trimmed Fan-Tastic® Rain Sensor, Power Roof Vents w/3-Speed Fan (3)
- Interior MultiPlex™ Power Management Plus System™
- TV Cable Ready
- Solid Wood Face Framed Cabinetry & Moldings
- Solid Wood Cabinet Doors
- Lined Cabinet Interior Bottoms and Shelves
- Decorative Ceiling and Air Plenum
- Flush Bolt Latch Decorative Hardware on Pocket Doors
- Polished Porcelain Tile Floor w/Décor Accents at Entry, Galley & Bathroom

OPTIONAL

- Custom Interior Request
- Factory V.I.P. Delivery
- Canadian Standards Build
- 5 Premium Wood & 4 Fabric Décor Choices
- Premium Glaze Wood Finish

DRIVER CONVENIENCE

- Dash Stereo; AM, FM, Single CD, MP3, Camera Monitor w/One Way Audio
- Dual Dash Monitors
- GPS Navigation System
- Tire Pressure & Chassis Monitoring
- Hardwood Dash Cabinetry w/Corian® Top & Storage Drawers
- 6-Way Power Driver Seat w/Heat, Power Lumbar & Adjustable Arms (Leather)
- 6-Way Power Passenger Seat w/Heat, Power Lumbar, Adjustable Arms & Electric Footrest (Leather)
- Sirius Satellite Radio
- Cruise Control
- I.C.C. Light Switch
- Smart Wheel w/Leather & Burl Wood Trim w/Manual Tilt, Tip, Telescope
- Top Mounted Intermittent Windshield Wiper System w/Wet Arm
- Power Sun Shades and Blinds
- Power Driver Window
- One Piece Windshield Bonded to Steel
- Windshield Washer Bottle, 2 Gallon Reservoir
- Driver & Passenger Drink Holder
- Driver & Passenger Map Reading Lights
- Halogen Head Lamps
- SGM Dash Climate Control System
- Adjustable Brake and Throttle Pedals
- Compass and Exterior Temperature Gauge
- Low Profile Automotive Style Dash Instrumentation, Back Lit Gages & Switches
- Chassis Monitoring System
- Tag Axle Dump Switch
- Keyless Entry Door Access w/Key Fob
- Auxiliary Fog Lamps
- Auxiliary Start Switch
- CB Radio Ready (Power and Antenna)
- Hadley® Air Horns
- Low Level Washer Fluid Indicator
- Multiple Auxiliary 12-Volt Dash Receptacles

LIVING ROOM

- Power Step Well Cover
- Entry Step Switch at Entry Wall
- Lighted Step Well Area
- Large Passenger Window
- 12V Halogen Ceiling Lighting & Reading Lights
- Centralized Audio-Electronics
- Day/Night Pleated Shades

- Hardwood Front TV Overhead Cabinetry
- Raised Panel Cabinet Doors
- Centralized Command Center
- Automatic Generator Start System
- Inverter and Battery Monitor
- Full Tile Standard
- Central Vacuum System

OPTIONAL

- Power Shade/Blind Package

GALLEY

- Solid Surface Galley Top, Range & Sink Covers
- Solid Surface Double Bowl Galley Sink
- Porcelain Tile and Accent Glass Backsplash
- Recessed 2 Burner Cook Top
- Solid Hardwood Drawer Fronts
- Roller Bearing Drawer Guides, Full Extension
- Adjustable Shelves
- Cabinet Storage for Sink and Range Covers
- Task Halogen Lighting
- Kohler High Rise Galley Faucet w/Pullout Sprayer
- Silverware Tray

BEDROOM

- Solid Wood 6 Panel Bath & Bedroom Doors
- Solid Wood Framed Headboard w/Padded Fabric Accent
- Quilted Bedspread
- Queen Innerspring Pillow Top Mattress (60" x 80")
- Lift Up Bed w/Under Bed Storage
- Polished Mystera® Counter & Nightstand Tops
- Over Head Cabinet Above the Bed
- Wall Sconce Light Fixtures
- 30" Deep Bedroom Slides
- Day/Night Pleated Shades
- Remote Generator Start Switch
- Cedar Lined Wardrobe
- Wardrobe Lighting
- Full Length Rear Wardrobe
- Recessed Bedroom Ceiling Fan
- Key Actuated Hidden Safe

OPTIONAL

- King Bed with Pillow Top (72" x 80")
- Select Comfort Queen Air Mattress w/2 Remotes
- Select Comfort King Air Mattress w/2 Remotes

BATHROOM

- Polished Mystera® Lavvy Countertop w/Solid Surface Sink & Residential Kohler Faucet
- Porcelain Tile & Venetian Accent Glass Backsplash
- Medicine Cabinet
- LED Floor Lights
- Solid Surface Shower Pan Skylight in Shower
- Residential Hand Held Shower Head
- Clear Glass Style Decorative Shower Glass Enclosure
- Residential China Bowl Flush Toilet w/Hand Sprayer
- Micro Mini Blind (Bathroom Window)
- Residential China Bowl Vacuum Flush Toilet (Rear Bath, Select Models)
- Toilet Paper Dispenser, Towel Bar, Towel Rings, and Robe Hook

FURNITURE

- Villa® Leather Sofa Bed w/Air Mattress
- Villa® Leather Sofa Bed w/Removable Arms
- Solid Surface Dinette Table, Slide Out Extension, 2 Decorative Chairs, 2 Folding Chairs
- Decorative Dinette & Folding Guest Chairs Not Available w/Face to Face Dinette Options

- Dinette w/Deep Base Cabinet Storage, File Storage & Keyboard Tray Wood & Fabric Dinette Chairs

OPTIONAL

- Villa® Leather J-Love Seat
- Dinette Face-to-Face Wrap Around Ensemble (Villa w/Leather)
- Desk w/Recliner

APPLIANCES

LIVING ROOM

- Sony® 32" LCD HDTV
 - Bose® Lifestyle 18 Home Entertainment System
 - TracVision® R5 Series "In Motion" HDTV Compatible, Domed Digital Satellite System
- #### OPTIONAL
- Sony® 40" LCD
 - Mid Ship 40" LCD HDTV (Select Models)
 - TracVision® R6 Series

BEDROOM

- Sony® LCD HDTV/32" LCD HDTV
- Sony DVD Player

GALLEY

- Dometic 12 cu. ft. 4 Door Refrigerator, Icemaker, Water Dispenser, 120V/Propane
- GE Advantium® Over the Range Convection Microwave Oven

OPTIONAL

- Insta-Hot: Hot Water Dispenser
- Dometic® 14 cu. ft., Sidewise Refrigerator, 120V/Propane, Icemaker, Brushed Stainless Finish
- Recessed 3 Burner Range & Oven
- Dishwasher w/Cabinet Wood Front
- Residential Refrigerator w/Icemaker
- Electric Cook top w/Dishwasher
- Electric Cook top

GENERAL

- Combination Washer/Dryer (Vented)

OPTIONAL

- Stacked Washer/Dryer
- Washer/Dryer Ready w/Shelves

HEATING/PLUMBING

- AquaHot Heating System, 50,000 Btu
- Heated Basement
- (3) 15.0M Low Profile Roof Air Conditioners
- Heat Pump on Rear AC Unit
- Hinged Plumbing & Access Panels (Galley & Bath Areas)
- Propane (LPG) Tank
- Fresh Water Gravity Fill
- Holding Tanks w/Low Point Drain Valves
- Multi-Point Water Pump Switching
- Variable Speed Water Pump
- Whole Coach Water Filtration System
- Dual Holding Tank San-T-Flush™ System

OPTIONAL

- Heated Full Tile Floor
- Waste Management System (Macerator)

SAFETY

- Smoke Detector/Alarm
- Carbon (CO) Monoxide Detector
- Fire Extinguisher
- Propane (LP) Leak Detector
- 3 Point Integrated Seat Belts at Driver & Passenger Seats
- Side Docking Lamps (4)
- Momentary Courtesy Lighting at Entry and Passenger Area
- Lighted Exterior Grab Handle w/Logo
- Emergency Egress Windows (2)
- Turn Signal Indicators

EXTERIOR AMENITIES

GENERAL AMENITIES

- Diamond Shield Protective Front Mask
- 2800-Watt Pure Sine Wave Inverter / Charger

- Maintenance Free (4) Absorbed Glass Mat 6- Volt Batteries (Group GC2)
- Inverter & Battery Monitor
- Surge Guard™ - Electrical System Protection (Includes Surge Protection)
- Energy Management System (50 Amp)
- Battery Disconnect Switches for House & Chassis
- Hella Docking Lamps (4)
- Sliding Front Fiberglass Cap (Bottom)
- Power Generator Slide
- Utility Light-Front & Rear
- Dual Locking Fuel Fill Doors
- Fresh Water Hoses (25')
- Sensa Tank Level Monitoring System (Interior and Exterior Monitor)
- Spray Wand w/Soap Dispenser & Paper Towel Holder
- Chrome Headlight Bezels
- Power Cord Reel, 50 AMP
- Full Width Rear Rock Guard w/Stainless Logo Panel
- Mud Flaps, Front & Rear
- Roof Mounted Engine Air Intake
- Two Piece Aluminum Rear Ladder
- Integrated Rear Upper Fiberglass Wing Deflector
- Large Rear Engine Access Door w/Lift Assist Struts
- Brushed Chrome Rear Access Grill
- Solar Charging Panel (63w)
- Power Luggage Door Locks (Select Doors) w/Remote Key Fob
- Hinge Pin Retention System (Holds Luggage Doors Open)
- Porch Light
- Keyless Entry Touch Pad / Entry Handle Integrated
- "One Key" System (Luggage & Entry Doors)
- Brushed Stainless Kick Plate Under Entry Door
- Power Double Entry Step "Bus Style" Compartments
- Electrical Outlets in Exterior Luggage Compartments
- Air Inflation Hose w/Fittings
- Chrome, Heated Side View Mirrors w/ Remote Adjustment, Turn Signal Indicators & Side Vision Cameras are Integrated into the Mirrors
- Convenience Light in Utility Compartment

OPTIONAL

- 2 Exterior Graphic Design Choices - Glory or Freedom Graphic Schemes
- Power Water Hose Reel
- Power Cord Remote (Key FOB)
- Custom Exterior Paint Color Request
- 1st Full Bay 90" Slide Tray
- 1st Full Bay 36" & 54" Slide Tray
- 2nd Full Bay 90" Slide Tray (Select Models)
- 2nd Full Bay 36" & 54" Slide Tray (Select Models)
- 2nd Full Bay 54" Slide Tray w/AquaHot System

CONSTRUCTION

- Electro-Coated Heavy Duty
- Steel Framing (Liberty Chassis)
- Aluminum Framed Wall Construction
- Interlocking Aluminum Framing Connections; Roof, Sidewall, Floor
- Steel Construction on Front Bulkhead
- vacu-bond® Sidewall, Roof, Floor & Rear Wall
- Dense Bead Foam Insulation Throughout
- 5 Layer Flooring w/3" Bead Foam Insulation
- 6 Layer Roof w/5 1/4" Bead Foam Insulation (at Centerline)
- DuPont® Exterior Automotive Full Body Paint w/Sand and Buff Finish

- Gel Coat Fiberglass Exterior Sidewalls w/No Wood Substrate
- Full Fiberglass Front & Rear Caps
- Fiberglass Front & Rear Quarter Panels
- Fiberglass Molded Front Bumper
- One-Piece Fiberglass Roof w/Radius Corners & Seamless Transition to Caps
- Insulated Aluminum Framed & Paneled Luggage Compartment Doors
- Sound Absorption Material Front, Rear & Engine
- Pebble Finished Fiberglass Basement Lining
- Heated Water & Holding Tank Compartments
- Central Electrical Panel for 120V/12V AC/DC
- TuffPEX® Plumbing System

CHASSIS / ENGINE

- Liberty Chassis (Patent Pending) w/Electro Coated Platform
- Independent Front Suspension w/55 Degree Steering Angle
- Allison® 3000 MH, 6-Speed Automatic Transmission (w/425 HP Engines)
- Allison® 4000 MH, 6-Speed Automatic Transmission (w/500 & 650 HP Engines)
- 3 Stage Engine Brake (650HP)
- 2 Stage Engine Brake (425HP - 500HP)
- 315/80R LRH 22.5" Radial TiresFront Only
- 295/80R 22.5" Radial Tires (Tag & Drive)
- 200 Amp Leece Neville Alternator
- Group 31 Chassis Batteries (2)
- Air Ride Suspension w/Bilstein® Shocks
- Aluminum Wheels
- Anti-Lock Brake System (ABS)
- Automatic 4-Point Hydraulic Leveling System
- Automatic Traction Control
- Chassis Filter Service Center
- Engine Block Heater
- Full Air Brakes w/Automatic Slack Adjusters
- Tire Pressure Check Gauge (Manual)
- Automatic 4-Point Dual Leveling, Air & Hydraulic
- Trailer Hitch Receiver 15,000 lbs.†

OPTIONAL

- Spartan® MGMT, Modular Chassis System w/Cummins ISL 425HP (42' Models)
- Spartan® K2, Modular Chassis System w/Cummins ISM 500HP (42' - 45' Models)
- Spartan® K3, Modular Chassis System w/Cummins ISX 650HP (45' B Model)

APPLIANCES

- Onan® 10.0kW Quiet Diesel Generator, Power Slide-Out
- Power TV Antenna w/Audible "Antennae Up" Warning

OPTIONAL

- Exterior TV – Sidewall Mounted (Includes Sony 32" LCD HDTV, Sony AM/FM/CD/DVD w/Remote)
- Additional 2000-Watt Pure Sine Inverter / Charger, (4) AGM Batteries

AWNINGS / WINDOWS / DOORS

- 30" Avionics Entry Door with Dead Bolt & Pneumatic Air Latches
- Entry Screen Door with Logo Kick Plate
- Powered Entry Door Awning
- Slide-Out Topper Awnings
- Tinted Dual Pane Windows w/ Screens
- Roof Mounted Girard Power Awnings with Wind Sensor System (2 Door Side Awnings, Sofa-Dinette Window Awning)

OPTIONAL

- Girard Roof Mount Awnings w/Auto Valance

AMERICAN EAGLE WEIGHTS AND MEASUREMENTS

WEIGHTS	42M	42P	45B (500HP)	45B (650HP)	45D
GVWR (lbs) ¹	46,600	46,600	48,600	50,600	48,600
Front GAWR (lbs) ²	16,600	16,600	16,600	16,600	16,600
Rear GAWR (lbs) ²	20,000	20,000	20,000	20,000	20,000
Tag Axle GAWR (lbs) ²	10,000	10,000	12,000	14,000	12,000
GCWR (lbs) ³	61,600	61,600	63,600	65,600	63,600
Hitch Rating Weight (lbs) [†]	15,000	15,000	15,000	15,000	15,000
Tongue Weight (lbs) [†]	1,500	1,500	1,500	1,500	1,500
DIMENSIONS AND CAPACITIES	42M	42P	45B (500HP)	45B (650HP)	45D
Wheelbase	302"	302"	304"	304"	304"
Overall Length ⁴	42' 11.5"	42' 11.5"	44' 11.5"	44' 11.5"	44' 11.5"
Overall Height (w/ Sat Dome)	13' 2¼"	13' 2¼"	13' 2¼"	13' 2¼"	13' 2¼"
Overall Width (maximum) ^{5,6}	102"	102"	102"	102"	102"
Interior Height (maximum)	84"	84"	84"	84"	84"
Interior Width (maximum)	96"	96"	96"	96"	96"
Fresh Water Holding Tank (gal)	90	90	90	90	90
Grey Water Holding Tank (gal)	70	70	100	100	100
Black Water Holding Tank (gal)	40	40	60	60	60
Appliance Propane Tank (gal) (WC) ⁷	30.6	30.6	30.6	30.6	30.6
Fuel Capacity (gal)	150	150	150	150	150
Std. Girard Patio Awnings Front/Rear	18' / 16'	18' / 16'	18' / 18'	18' / 18'	18' / 18'

Liquid Weight Reference: Water (gal) = (8.3 lbs/3.8 kgs) Fuel (gal) = (7.1 lbs/3.2 kgs) Propane (gal) = (4.2 lbs/1.9 kgs)
Metric Conversion: Multiply pounds x 0.453 to obtain kilograms. Multiply gallons x 3.785 to obtain liters.
 Multiply liters x 61 to obtain cubic inches.

CHASSIS - CUMMINS® 425 (42M, 42P Models)	CHASSIS - CUMMINS® 500 (42M, 42P, 45B, 45D Models)
Frame: Liberty Chassis	Frame: Liberty Chassis
Engine: ISL 425 HP, 8.8L	Engine: ISM 500 HP, 10.8L
Torque: 1200 lb-ft @ 1300 RPM	Torque: 1550 lb-ft @ 1200 RPM
Transmission: Allison® 3000 MH, 6 Speed w/Electronic Shifter	Transmission: Allison® "Gen-4"4000 MH, 6 Speed w/Electronic Shifter
Alternator Amps: 200 Amp, Leece Neville	Alternator Amps: 200 Amp, Leece Neville
Tires: 315/80R 22.5 Michelin® Radial (2)	Tires: 315/80R 22.5 Michelin® Radial (2)
Tires: 295/80R 22.5 Michelin® Radial (6)	Tires: 295/80R 22.5 Michelin® Radial (6)

CHASSIS - CUMMINS® 650 (45B Model)
Frame: Liberty Chassis
Engine: ISX 650 HP, 11.9L
Torque: 1950 lb-ft @ 1300 RPM
Transmission: Allison® "Gen-4"4000 MH, 6 Speed w/Electronic Shifter
Alternator Amps: 200 Amp, Leece Neville
Tires: 315/80R 22.5 Michelin® Radial (2)
Tires: 295/80R 22.5 Michelin® Radial (6)

- GVWR (Gross Vehicle Weight Rating) is the maximum permissible weight of this fully loaded motor home. The GVWR is equal to or greater than the sum of the (UVW) unloaded vehicle weight plus the (OCCC) occupant cargo carrying capacity*.
- GAWR (Gross Axle Weight Rating) is the maximum permissible loaded weight a specific axle is designed to carry.
- GCWR (Gross Combined Weight Rating) is the value specified by the motor home manufacturer as the maximum allowable loaded weight of this motor home with its towed vehicle. Towing and braking capacities may be different. Refer to American Coach and chassis manufacturer's manuals for complete information.
- Length measured from front bumper to rear bumper (excludes accessories).
- Excludes safety equipment and awnings.
- Motor homes feature a body-width over 96" which will restrict your access to certain roads. Before purchasing, you should research any state and/or province road laws which may affect your usage.
- Tank manufacturer's listed water capacity (WC). Actual propane capacity is 80% of water listing as required by the safety code.

N/A = Not Applicable

* UVW and OCCC are found on the label containing the federal certification tag in each RV.

† The chassis manufacturer recommends the installation of a supplemental brake control system to activate the brakes on the vehicle or trailer you are towing. Hitch receiver ratings expressed are maximum for the hitch receiver installed and may require the purchase of additional equipment that is dependant on the weight of the towed load. Consult with hitch receiver manufacturer for further information.

IMPORTANT — PLEASE READ: Product information, photography and illustrations included in this publication were as accurate as possible at the time of printing. For further product information and changes, please visit our website at www.AmericanCoach.com or contact your local American Coach dealer. Prices, materials, design and specifications are subject to change without notice. All weights, fuel, liquid capacities and dimensions are approximate. American Coach has designed its recreational vehicles to provide a variety of uses for its customers. Each vehicle features optimal seating, sleeping, storage and fluid capacities. The user is responsible for selecting the proper combination of loads (i.e. occupants, equipment, fluids, cargo, etc.) to ensure that the vehicle's capacities are not exceeded.



American Coach[®]
 THE OFFICIAL LUXURY COACH OF THE AMERICAN ROAD

For more information, visit us at
www.AmericanCoach.com or call us toll free at
 800.854.1344