

Quailridge

Park Models By Forest River

Value Added Quality by Design™



Quailridge Park Models by Forest River



- ▲ The spacious home-style kitchen of the 39AKML affords the friendliness of a cozy eating bar and the luxury of custom cabinetry. Full-sized appliances include an 18 cu. ft. double door refrigerator, 30-inch gas range and a space saver microwave. Expansive self-edged countertops provide extra workspace while the double composite sink and high-rise single-lever faucet makes clean up a snap.
- ▲ This living room features a cozy fireplace that adds a warm ambience as you slumber on the comfortable hide-a-bed that converts to a queen bed. If you want to watch TV or read a book, get comfortable in the beautiful recliner – or just relax, you're at home.

- ▶ The heart of the home is the kitchen. This one has all the conveniences of home with a complete array of full-sized appliances. It is complimented with a warm and inviting dining room that will allow you to lay out the most sumptuous meals possible. The beautiful residential style dining table is complete with four high-backed chairs. Overhead cabinetry and a china hutch add a touch of elegance to this magnificent floor plan.



- ◀ His & hers lighted wardrobes are available on most models. The cabinetry features raised panel doors, deep drawers for maximum storage and a convenient vanity with mirror.

Standards and Options

EXTERIOR FEATURES

- 8" I-Beam Steel Mains - Basement Frame
- Detachable Hitch
- Metal Underbelly
- 2" x 6" Traverse Floor Joist 16" on Center
- Central Floor Heat Duct
- 5/8" Tongue and Groove Plywood Floor Decking
- 2" x 4" Sidewalls studs 16" on Center
- Insulative Board - W/A
- Residential Thermopane Single Hung Windows and Solid Vinyl Patio Door
- Vinyl Siding with Lifetime Warranty
- Residential Shutters - W/A
- Rear Door with Deadbolt Lock with Screen
- Scissors Rafters 16" on Center
- Roof Decking Overlaid with Felt Paper
- Asphalt Architectural Upgrade Roofing Shingles (30 Year Warranty)
- R-11 Fiberglass Insulation with Vapor Barriers
- 110V Recept at City Water Fill

LIVING GROUP

- Hide-A-Bed Sofa and Recliner
- Solid Wood End Table with Lamp
- Entertainment Center with TV Jack - W/A
- Ceiling Fan with Light Kit (1)
- Vertical Blind on Patio Door
- Residential Crown Molding - W/A
- Coordinated Chair Rail
- Designer Style Window Coverings with Faux Wood Blinds and Box Valance
- Decorative Shelves - Dining Room, Bedroom - W/A

KITCHEN/DINING GROUP

- 18' 2 Door Frost Free Refrigerator - White - W/A
- Gas Range - White 30" - W/A
- Custom Kitchen Cabinets Featuring Raised Panel Doors
- Single Lever Faucet
- Composite Sink
- No Wax Vinyl Floor
- Rectangle Dinette Table with Leaf and 4 Fabric Color Coordinated Storage Chairs
- Self-Edged Countertops with Backsplash

- Dining Room Hutch in Certain Models
- Space Saver Microwave - W/A

BATH GROUP

- 1-Piece Fiberglass Tub/Shower with Grab Bar and Shower Curtain
- Residential Style Ceramic Commode
- Power Exhaust Fan with Light
- Custom Hardwood Medicine Cabinet with Light
- Linen Cabinet - W/A
- Vanity Top with Sink and Faucet
- GFI Protected Receptacle

BEDROOM GROUP

- 60"x75" Short Queen
- His and Her Lighted Wardrobes (Most Models)
- TV Jack
- Chest-O-Drawers - W/A
- Night Stand with Lamp
- Ceiling Light/Fan with Light Kit - W/A
- Bedspread with Shams
- Overhead Cabinets and Shelf

ADDITIONAL FEATURES

- 50 Amp Service with Heavy Duty Power Cord
- 56,000 BTU Upright Furnace Electronic Ignition - W/A
- 20 Gal. Electric Water Heater with Exterior Door
- Frost Proof Exterior Faucet - W/A
- Exterior GFI Receptacle
- Porch Light
- Smoke Detector
- LP Detector - W/A
- Fire Extinguisher
- LP Gas Line - W/A
- Touch Control Wall Switches
- All Drawers on Roller Guides
- Hurricane Tie Down Strap
- RPTIA Seal
- Seaspray Gypsum Ceiling Board

AVAILABLE OPTIONS

- Gas/Electric Water Heaters
- 15,000 BTU Floor Ducted A.C.
- Dining Room Walk-A-Bay
- Front Trap Windows
- Telephone Jack
- Home Theater System
- Dining Room Hutch - W/A

Quailridge Floor Plans

Loft Units

38FL

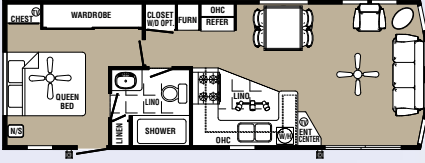

38FLD

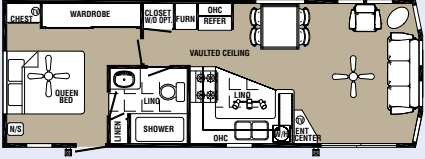

38FLA

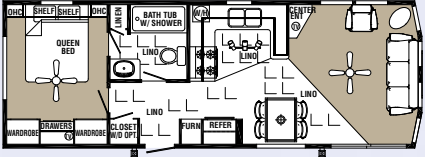

38FLAD

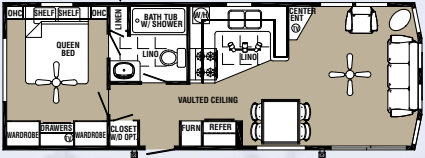

39LSB

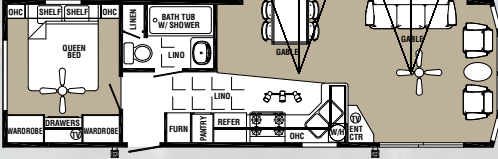

39FLSK

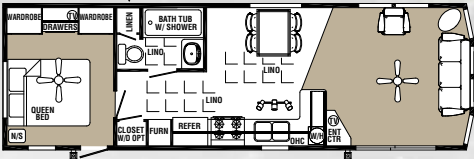

39PLSB

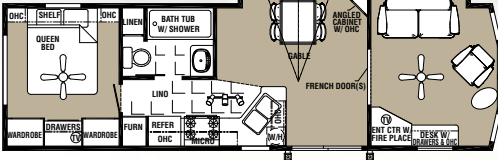

39FK

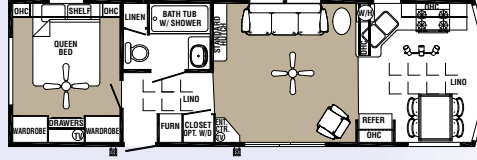

39AKFL

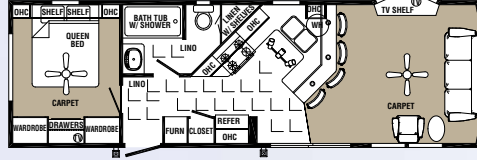

39BLFR

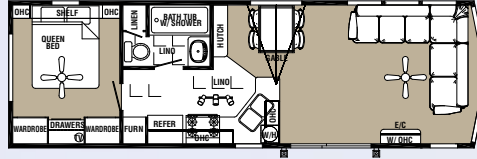

38BH

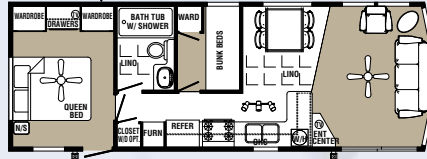

392B

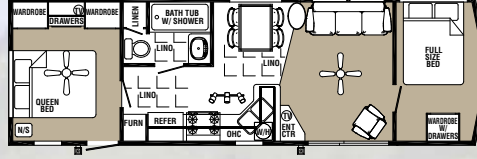

39FD

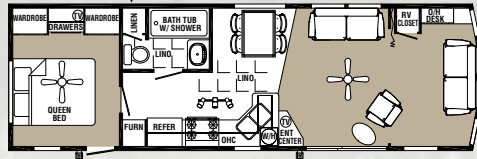

39JJ

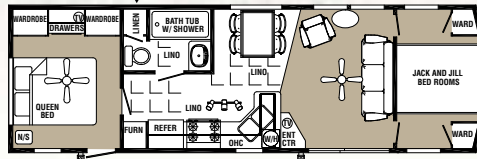

39CLKD

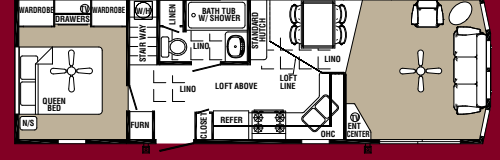

39DLB2

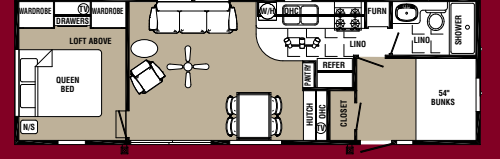

39FMLM

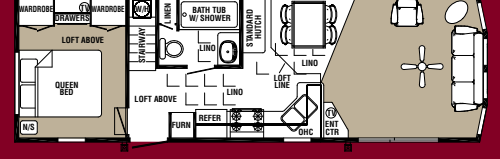

39FKML

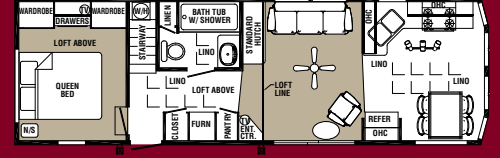

39FDML

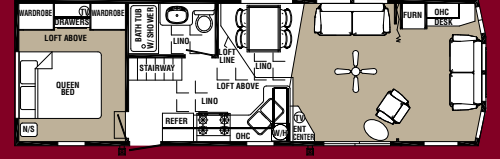

39SBML

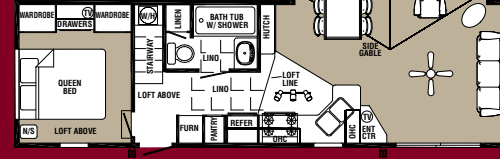

39AKML

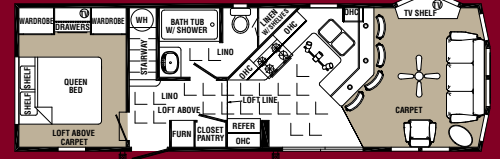

W.A.B Option

Model number of any particular unit does not necessarily reflect the overall length of the unit itself.



A Berkshire-Hathaway Company

Forest River Inc. • Park Model Division
28936 Phillips Street • Elkhart, IN 46514
Phone: 574-264-7163 • Fax: 574-264-7364
www.forestriverinc.com



All illustrations and specifications contained in this literature are based on the latest product information at time of publication. Forest River reserves the right to make changes in prices, colors, materials, equipment and specifications at any time without notice and assumes no responsibility for any error in this literature. Photographs may contain optional materials. All units are shipped F.O.B. Elkhart, Indiana. CONSULT YOUR LOCAL DEALER FOR WARRANTY INFORMATION.