

ADRENALINE™ FIFTH WHEELS

BY COACHMEN



BECAUSE LIFE'S A RUSH



ADRENALINE™ 400 DS FIFTH WHEEL

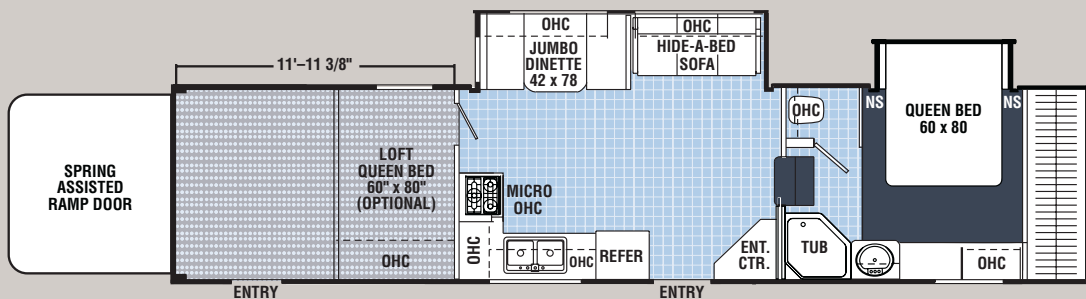

Base Weight	12,552
GVWR (lbs.)	18,000
Carrying Capacity	5,448
Axle Weight	9,387
Interior Height	8' 10"
Exterior Height*	12' 2"
Exterior Length	41' 5"
Exterior Width	8' 6"
Sleeping Capacity	4/10
Fresh Water Capacity (gal.)**	150
Waste Water Capacity (gal.)	60
Grey Water Capacity (gal.)	118
Water Heater Capacity (gal.)	6
LP Gas Capacity (lbs.)	80
Furnace Rating (x 1,000) BTU	34
Tire Size	■
Awning Size	21'

* Does not include roof A/C

** Does not include water heater capacity

■ ST235/80R16D

ADRENALINE™

FIFTH WHEELS BY COACHMEN

FABRIC SELECTIONS

A = Main
B = Accent 1
C = Accent 2



Blue Blaze



Brickyard Red



Cobblestone Suede

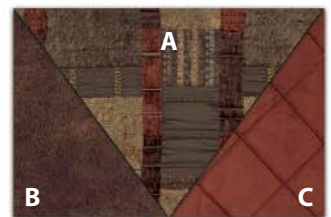

Sedona Clay

CABINETRY SELECTIONS



Carbon Fiber

Brazilian Cherry

STANDARD FEATURES

INTERIOR APPOINTMENTS

- Brazilian Cherry Cabinetry
- Oil Rubbed Bronze Hardware
- Designer Seamless Countertops
- Linoleum Flooring (Kitchen & Living Area)
- Carpet (Bedroom)
- Fuel Resistant Seamless TPO Flooring (Cargo Area)
- Designer Box Valance Window Treatments (Coach Area)
- Pleated Shades - Coach
- Mini Blinds - Cargo Area
- Hide-A-Bed Sofa
- Booth Dinette
- Techwood Drawer Sides
- Cargo Area TV LCD Mounting Bracket
- Cargo Floor D-Ring Tie Downs
- Diamond Plate Protected Lower Corners in Cargo Area

GALLEY

- Black Appliances
- 3-Burner Hi Output Range w/21" Oven
- Range Hood w/ Vent & Light
- Centralized Command Panel
- Large Double Bowl Sink
- High Spout Kitchen Faucet
- Silverware Drawer
- Coat/Equipment Hooks

BATH AND WATER

- Porcelain Toilet w/Foot Pedal
- Power Bath Vent
- Water Heater By-Pass Valve
- Demand Water Pump
- Decorative Bath Hardware
- One-Piece Shower Surround
- Gravity & City Water Hookups
- 6-Gallon Gas/Electric E.I. Water Heater
- 156 Gallon Fresh Water System

SLEEPING

- Innerspring Mattress - 312 Coil
- Designer Bedspread
- Pillow Shams
- Bedlift Storage System

ELECTRICAL/HEATING/AC

- 75 Amp Electronic Converter
- 50-Amp Service
- GFI Circuit
- (2) Exterior GFI Receptacles
- Patio Light
- Hitch Light
- Fluorescent Light Above Kitchen Sink
- Double 40 LB LP Bottles w/Auto Change-over
- 34,000 BTU E.I. Furnace
- Pre-Wired for 2nd Air Conditioner
- Wired for Generator
- Satellite/Cable Exterior TV Jack

EXTERIOR/CONSTRUCTION

- 102" Wide Body Design
- Dove Tail Cargo Floor at Ramp Door
- 2,500 lb Rated Ramp Door
- Posi Lock Ramp Door Closure System
- Grip Star Slip Resistant Ramp Door Covering
- Lift Assist Steel Coil Ramp Door Hinges
- Flush Cargo Floor (No Intrusive Wheel Wells)
- Tinted Safety Glass Windows
- Fiberglass Sidewalls
- Aluminum Framed Laminated Sidewalls and Floor
- Aluminum Framed Crowned Roof
- 6000 lb. EZ Lube Wide Track Axles
- Triple Axles
- 16" Load Range "D" Radial Tires
- Break Away Switch
- (2) Retractable Stabilizer Jacks
- Large Pass Through Storage
- Radius Entry & Baggage Doors
- 30" Entrance Door
- Flush Floor Main Slide-Out Rooms
- Triple Entry Step
- I-Beam Chassis Construction
- Fully Enclosed Underbelly w/Heated Tanks
- Adjustable Spring Hangers
- Propane Quick Disconnect for Grill Hookup

SAFETY

- LP Leak Alarm
- Fire Extinguisher
- Smoke Detector
- CO Detector

OPTIONAL FEATURES

- Carbon Fiber Cabinetry
- Single Electric Trac Queen Bed
- Double Electric Trac Queen Beds
- Double Electric Trac Sofa/Queen Bed
- Residential Dinette w/4 Chairs
- 26" LCD TV - Coach
- 20" LCD TV - Bedroom
- Stainless Steel Portable Gas Grill
- 16-Gallon Effective Gas/Electric Water Heater
- Vapor Barrier Divider Wall w/Loft Bed
- 2nd 13,500 BTU Ducted Roof Air Conditioner
- 5.5KW Gas Onan Generator & Fuel Pump Station w/2 Tanks
- Generator Ready & Gas Fuel Pump Station w/2 Tanks
- Senco Power Plus 6-in-1 Jump Start System
- Roof Mounted Spotlight w/Remote
- High Gloss Exterior Sidewalls
- Owners Information Package

RUSH Package (Mandatory Option)

- TV Antenna & Rotor Package
- Cable TV Jacks (Coach & Bedroom)
- Quad Exterior Lighting Package
- 5.1 Surround Sound System w/DVD Player
- Dual Motor Power Front Jacks
- Large Double Door Refrigerator
- Microwave Oven
- Glass Shower Door
- Patio Awning
- Skylight Over Shower
- Add-A-Wall
- Shurflo Roof Fan w/Remote (Cargo Area)
- (2) Exterior Marine Grade Speakers
- Roof Ladder
- Spare Tire Kit - 16"
- Spray Away Outside Shower w/15 ft. Coiled Hose
- Blank Tank Flush
- Folding Assist Entry Door Handle
- Shock Absorbers
- 15,000 BTU Ducted Roof Air Conditioner w/Quick Cool Feature

Coachmen®
Recreational Vehicles

Coachmen Recreational Vehicle Company, LLC
P.O. Box 30, Middlebury, IN 46540
P.O. Box 948, Fitzgerald, GA 31750

Visit our website at:
www.coachmenrv.com

©2006 Coachmen Recreational Vehicle Company, LLC
All rights reserved. Litho in USA 11/06

All information contained in this brochure is believed to be accurate at the time of publication. However, during the model year, it may be necessary to make revisions and Coachmen reserves the right to make all such changes without notice, including changes in prices, colors, materials, equipment and specifications, as well as the addition of new models and the discontinuance of models shown in this brochure. Therefore, please consult with your Coachmen dealer and confirm the existence of any materials, design or specifications that are material to your purchase decision.