

2007 ULTRA-LITE TRAVEL TRAILERS & EXPANDABLES



*Explore Your Horizons*



THE LEADER IN ULTRA-LITE TECHNOLOGY

# LESS IS MORE



**8 Floor plans, loaded with standard features, starting at 2622 lbs.**

*Cub from Aerolite.*

**The Original Ultra-Lite Expandable Travel Trailer.**

*The 23TT features (3) 60" x 80" queen beds, self-supporting bunk ends. (shown above)*

# CUB

## ULTRA-LITE EXPANDABLES

For active families on the go, Cub expandable travel trailers add sleeping space without the additional length and weight of traditional travel trailers. The ultra-lite design and aerodynamic profile make Cub a dream to tow. Plus, the interior of Cub is packed with high-end features, including designer décor, large kitchens with abundant storage, expansive living spaces and comfortable sleeping areas.

So, when it is time for your next travel trailer, choose Cub, your best value in ultra-lite expandable travel trailers.

**Cub - The Leader in Ultra-lite Technology.**

*Cub 214 in Dune Blue*



THE LEADER IN ULTRA-LITE TECHNOLOGY



Cub 214 in Dune Blue

## THE INDUSTRY'S BEST EXPANDABLE



### Cavlar 2000 Tents

Cub Expandables are built exclusively with premium Cavlar 2000, the best vinyl tent in the industry. Cavlar 2000 is a 15 ounce vinyl fabric

that resists mold and mildew and wicks away condensation. Plus, Cavlar 2000 is made with UV protector that prevents damage and fading from the sun.



### Key-Locking Bunk End Doors

Key-locking "Easy Latch" tent doors eliminate the use of unsecured, crank-style door hardware. Simply unlock the tent door, push the release button, open the cam arm and drop the door into the open position.



### Self-Supporting Bunk Ends

Cub Expandable's bunk ends are self-supporting. This revolutionary system suspends the 60" x 80" queen bed from the wall of the trailer. Cub does not require exterior tent poles to support the bunk ends.

Plus, each bed has a 1200 lb. capacity, the highest capacity in the industry!

## REVOLUTIONARY NEW FASTASLEEP TENT OPTION



## EXCLUSIVELY CUB

Cub, the leading innovator in ultra-lite RV technology, and Therm-a-Rest, inventor of the self-inflating camping mattress and manufacturer of premium outdoor equipment, have teamed up to develop the innovative new FastAsleep tent. Cub chose Therm-a-Rest to design this groundbreaking product because of the company's 30-plus years of experience enhancing the comfort of outdoor enthusiasts. The result is an RV tent that features easier setup, more livable comfort, and greater protection than anything that's come before. (Optional on Cub Expandables)



# ULTRA-LITE EXPANDABLES

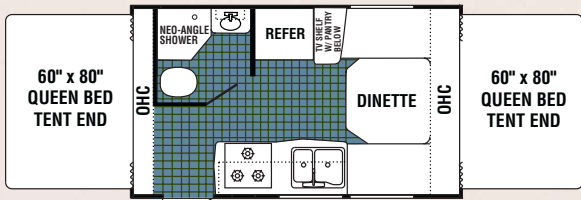

160

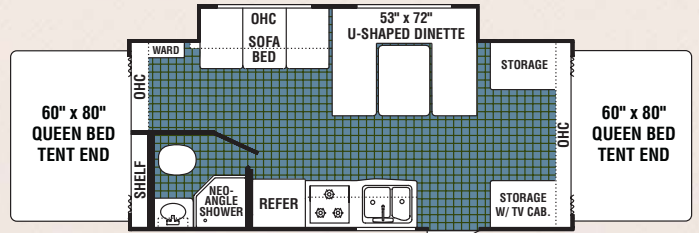

214

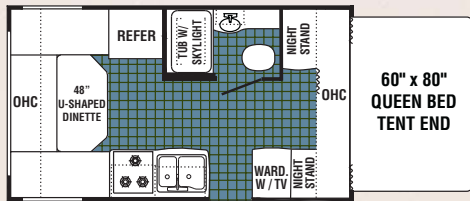

170FL

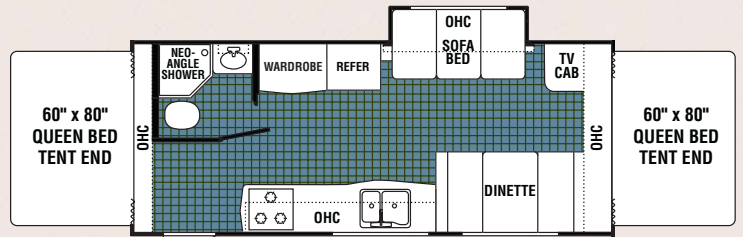

235

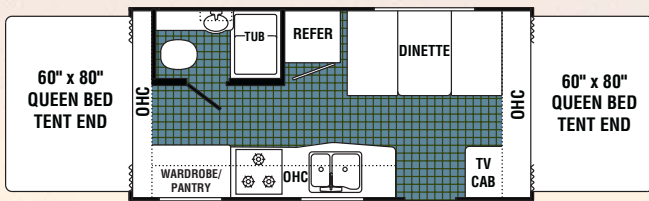

195

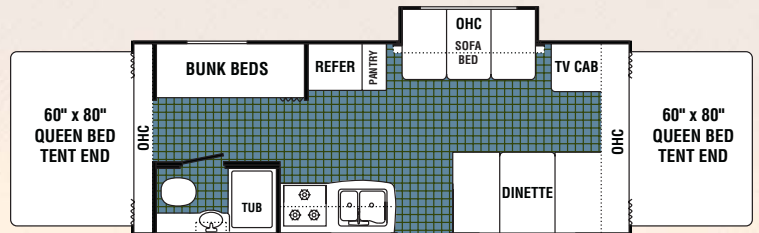

23BH

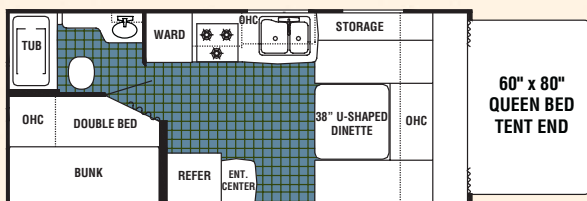

210DB

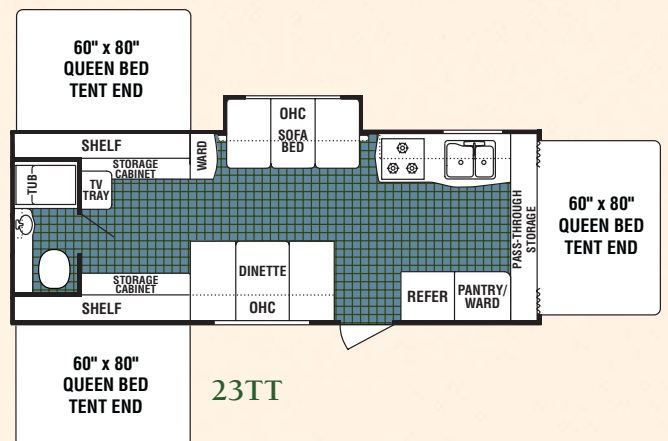

23TT

# INTRODUCING

# THULE<sup>®</sup> SWEDEN

# SMART RV

Thule, the industry leader in cargo management systems for cars and trucks, has partnered with Aerolite to create the Smart RV System. This patented system allows Aerolite owners to create a functional outdoor living area that's easy to set up and enjoy.

The Smart RV system uses a number of factory-installed anchor pods mounted on the exterior of the trailer. \* The accessories mount to the pods in seconds using Thule's innovative quick-release latch system.

The optional Thule Smart RV Camping Package includes:

- Smart RV table with 2 chairs
- 2 Universal hooks
- Smart RV countertop

### Smart RV Universal Hook

Here's a great way to wrap cables and cords, hang lanterns and bug zappers, or just dry out your towels!

- 2 Universal hooks per kit
- Rugged powder-coated steel tubes
- Foam padding offers cushion and extra grip



### Smart RV Countertop

The perfect surface for a blender, a radio or anything else you've just gotta have to enjoy the great outdoors!

- Blow-molded 40" x 16" polyethylene countertop
- Support arms adjust to ensure a level table surface



### Smart RV Table and Chairs

Bring the dining room outdoors with our patented "stable table" system.

- 48" x 24" Heavy duty polyethylene table top with power coated adjustable legs
- (2) Camping chairs with Thule logo. Made with black, weather resistant fabric



\*Thule system is for use on units built after serial number #166463 (Cub Expandables) and serial number #120671 (Aerolite Travel Trailers). Units include wall bracing to accept Thule Pods.

## DECOR OPTIONS Available on Cub & Aerolite

Earth

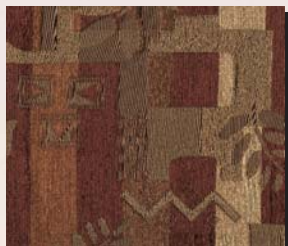

Dune Blue



Desert



Raisin

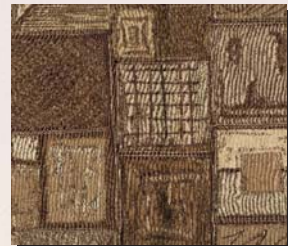

**1/2 TON  
SERIES**

## CUB ULTRA-LITE EXPANDABLES

	160	170FL	195	210DB	214	235	23BH	23TT
*Axle Weight	2318	2367	2985	2979	3511	3331	3480	3695
*Dry Hitch Weight	304	321	204	368	300	345	421	408
*Unloaded Vehicle Weight	2622	2688	3189	3347	3811	3676	3901	4103
GVWR	3850	3850	4840	4840	4840	4840	4840	6000
Net Cargo Capacity	1228	1162	1651	1493	1029	1164	939	1897
Exterior Length (closed)	17'5"	19'2"	20'8"	23'4"	24'4"	24'4"	26'4"	26'4"
Exterior Height with A/C	9'4"	9'4"	9'4"	9'4"	9'4"	9'4"	9'4"	9'4"
Exterior Width	8'	8'	8'	8'	8'	8'	8'	8'
Fresh Water Capacity	38	38	38	38	38	38	38	38
Gray Water Capacity	36	36	36	36	36	36	36	36
Black Water Capacity	22	22	22	NA	22	32	22	22
Furnace Size (BTUs)	19,000	19,000	19,000	19,000	19,000	19,000	19,000	19,000

Tire Size (all models): ST205/75D14(C) Interior Height (all Cub models): 6'4"

\*Axle weight, dry hitch weight and unloaded vehicle weight (UUVW) are base weights of units without options. Each unit includes a weight label which lists specific weight information for that unit. **Vehicle Loading** - Every effort has been made to provide the greatest number of options for the recreation vehicle owner. Along with these choices comes the responsibility to manage the loads that are imposed by the choices so that they remain within the manufacturer's specified chassis weight limits. Do not overload the recreation vehicle. **Net carrying capacity (NCC)** determined by subtracting unloaded vehicle weight (UUVW) from gross vehicle weight (GVWR) and includes fluids, options and cargo. Liquid capacities and weights are approximations only. **Warning:** This information is intended as a guide only. Weights of individual vehicles may vary. Consult your owner's manual for complete loading, weighing and towing instructions. Product information, specifications, and photography in this brochure were as accurate as possible at time of printing. Photographs may contain some features that are optional on your vehicle. Since we continually strive to improve our products, actual products may differ. Prices and specifications are subject to change without notice. All capacities are approximate and dimensions are nominal. Some features shown are optional and may be different or unavailable in Canada. Vehicles are designed for recreational use only and not intended for use as a primary residence.

TWO YEAR STRUCTURAL AND APPLIANCE WARRANTY • ONE YEAR BUMPER TO HITCH WARRANTY

**ULTRA-LITE  
CONSTRUCTION**  
The Original, and Still the Best!

**AEROLITE vs. The Competition**

**IMPROVED AERODYNAMICS**

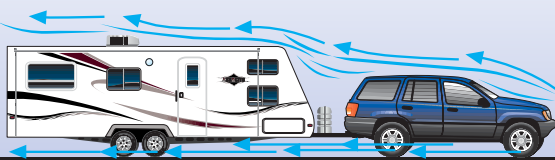

Lower profile - more aerodynamic!

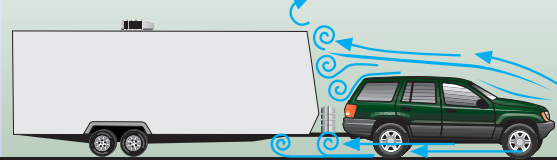

Flat front profile - less aerodynamic



Well balanced low profile design

**LOWER CENTER OF GRAVITY**

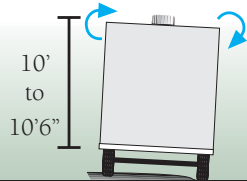

Higher center of gravity - top heavy design

Torsion "independent suspension" axles

Leaf spring solid axles

**AXLE TO HITCH WEIGHT RATIO**



Optimal axle to hitch ratio for smooth towing



Excessive tongue weight causes more wear on tow vehicle

Well-balanced design - axle and hitch

Excessive hitch weight

**Aerolite**, North America's first ultra-lite travel trailer is specifically designed to be towed by most light trucks, and sport utility vehicles. Aerolite's aerodynamic profile is designed to push air up the front wall and over the roof to *improve towability and fuel economy*. Plus, we position the axles and balance the weight of each floorplan to create the optimal hitch/weight/axle ratio for *towing with light trucks or SUVs*. And, Aerolite incorporates rubber torsion "independent suspension" axles on a European-style frame. Torsion axles allow each wheel to travel independently, unlike leaf spring axles that transfer variations in the road to the opposite wheel. Plus, the torsion axles *improve towing stability* by lowering the trailer to the ground and reducing the center of gravity.

**Improved aerodynamics, optimal weight balance and a lower center of gravity results in the best towing characteristics possible in an ultra-lite travel trailer.**



**Large Fresh Water Tank**

38 gallon fresh water tank with Quick Drain feature. Tank design prevents water from standing in tanks during storage.

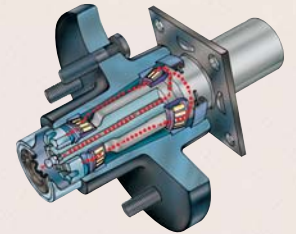

**Easy-Lube Hubs**

Aerolite includes Ultra-Lube hubs as a standard feature. This allows for easy maintenance of your wheel bearings. (N/A on Cub Expandables.)



**Al-Ko Torsion Axles**

Cub and Aerolite ride on rubber torsion "independent suspension" axles. Torsion axles soften the ride by absorbing road vibrations and making towing more comfortable. The center of gravity is lowered with torsion axles, which improves aerodynamics and maneuverability.



**HAPPI-JAC® Slide System**

Most Cub and Aerolite floorplans feature the HAPPI-JAC® secure track slide system. This low profile 12V electric slide system takes up less space, which frees up room for larger slide rooms and more storage.

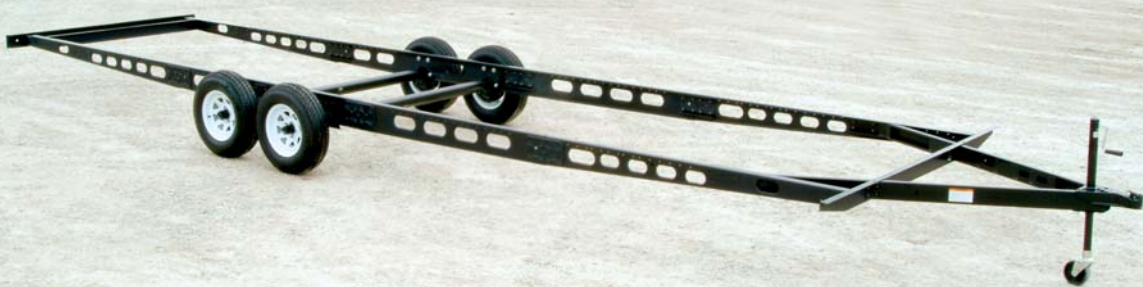

**Ultra-lite Frame**

Cub and Aerolite feature an ultra-lite European-style chassis. This durable chassis is 400 pounds lighter than the traditional box-style chassis, which reduces weight and increases cargo capacity. The frame features a powder coat over E-coat paint finish, backed by a lifetime rust through warranty.

**An Aerolite Exclusive**

# 6-WAY ALUMINUM FRAMED CONSTRUCTION

**AERODYNAMIC,  
ULTRA-LITE  
DESIGN FOR  
BETTER FUEL  
ECONOMY!**

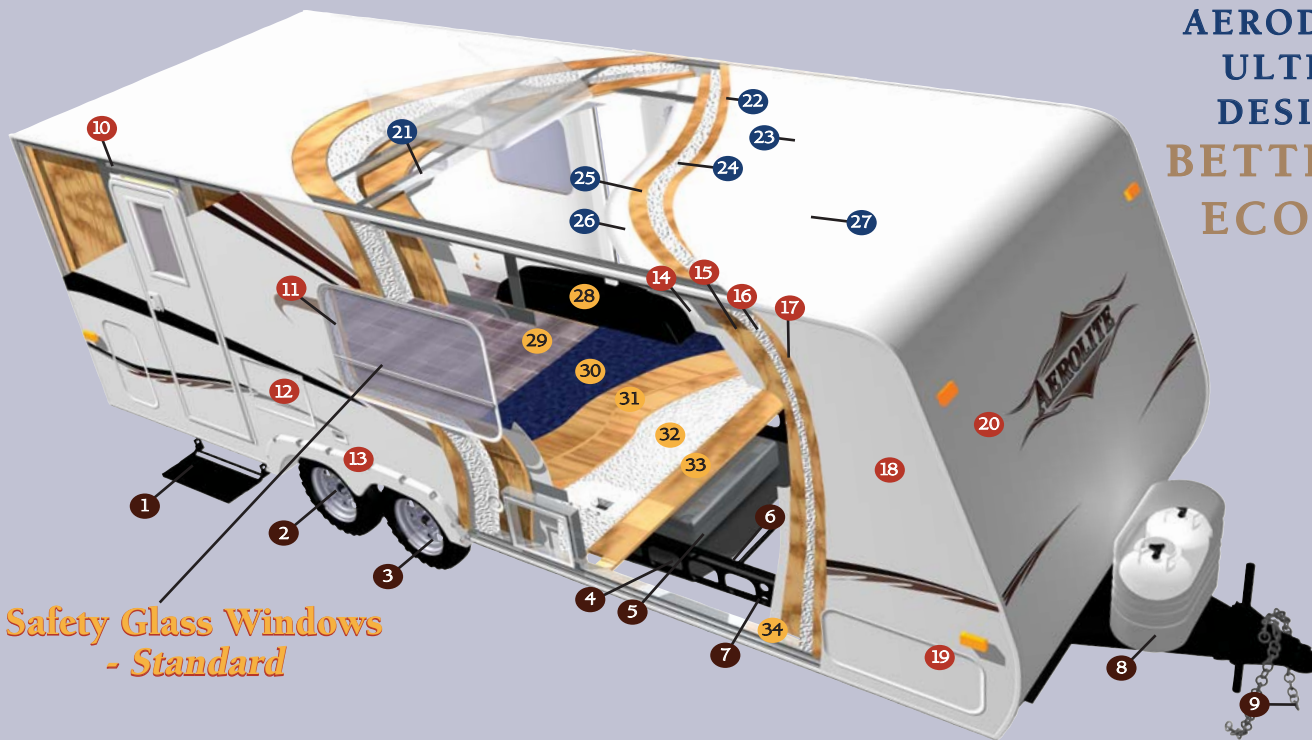

**Safety Glass Windows  
- Standard**

## CHASSIS

*Cub and Aerolite feature the European-style, ultra-lite weight chassis. Aerolite is the first company in the industry to use European-style frames in ultra-lites!*

1. Folding entry step – low step height for easy entry
2. Easy-lube hubs. Grease Zerk makes wheel bearings easy to lube. Extends life of bearings (most models)
3. Torsion “independent suspension” axles – the smoothest ride in the industry
4. All tanks mounted in frame. Lowers the center of gravity, and saves valuable interior storage space
5. 38 gallon fresh water tank with Quick Drain feature. Tank design prevents water from standing in tanks during storage.
6. Optional enclosed underbelly protects tanks and floor from the hazards of the road (most models)
7. Ultra light weight chassis with lifetime powder coat over E-coat paint finish
8. (2) 30 lb. LP tanks with standard ABS cover (Aerolite) or (2) 20 lb. LP tanks with ABS cover (Cub), with dual battery rack
9. Integrated safety chains

## WALLS

*5-ply aluminum framed laminated construction.*

10. Tubular aluminum welded frame reinforced around door.
11. Radius corner, safety glass windows
12. Insulated baggage doors with key locks and finger locks
13. ABS fender skirts
14. Decorative wall finish
15. Luan wood backer
16. High density structural foam insulation
17. Luan plywood backer
18. Smooth fiberglass with premium graphics package
19. Pass-through storage compartment (where available)
20. Aerodynamic front profile

## ROOF

*5-ply aluminum framed laminated construction.*

21. Tubular aluminum welded framed roof, reinforced at A/C
22. Luan wood backer
23. One-piece EPDM rubber roof with 12 year manufacturer's material warranty
24. High density structural foam insulation
25. Luan wood backer
26. Decorative ceiling finish
27. 5" Thick arched roof (Aerolite)

## FLOOR

*5-ply aluminum framed laminated floor structure.*

28. One-piece composite wheel wells
29. Armstrong residential vinyl flooring – full length of coach
30. Residential carpet with pad (optional)
31. Two layers of floor decking over foam
32. High density structural foam
33. Plywood base with polypropylene waterproof vapor barrier
34. Tubular welded aluminum framed floor

*Explore Your Horizons*

## QS REAR SLIDE FLOOR PLANS

*Many Aerolite floor plans include slide-out rooms to maximize interior space.*

*The QS models with rear bed slide is a first in the industry. It's all electric, self-supporting, and gives you a full 60"x80" queen bed.*



**8" EXTRA CLEARANCE!**

## EXTREME OUTDOORS OFF ROAD PACKAGE

*For those who need extra ground clearance for off road campsites:*

- 8" Body lift kit
- Extended jack and stabilizers
- Double entry step
- Dunlop Rover LT235/75R15 mud and snow tires (Also available with standard ST205/75D14)



*Aerolite 24RB-SL in Desert*

## **THE ORIGINAL ULTRA-LITE TRAVEL TRAILER**

**16 floor plans as light as 2688 lbs, loaded with standard features.**

Aerolite. The original Ultra-Lite travel trailer features 16 innovative floor plans ranging from 19' to 30'. With units light enough to be towed by SUV's and light trucks, we are sure to have the model that best fits your family's needs. Just because Aerolite is an Ultra-Lite, it doesn't mean your trailer is light on storage. With spacious countertop and cabinet space, oversized pass-through exterior storage and innovative features like the optional "Pac-n-Play" storage compartment, it's easy to take everything along on your next adventure. Aerolite – The leader in Ultra-Lite technology.





# AEROLITE

## Lightest Frames in the Industry!

Aerolite features aluminum framed dinette, bed, bunks and pass through storage frames. Aluminum frames are more durable than wood framed structures and save weight.



Upgrade your Aerolite with a 5-in-1 surround sound system with CD/DVD player and a 15" LCD flat panel TV.



Aerolite kitchens feature a 3-burner range with large oven, large two bowl sink with high-rise faucet and a residential microwave.

30BH kitchen shown at right.



Aerolite 30BH



# EXCLUSIVELY AEROLITE

The Original Ultra-Lite Travel Trailer.

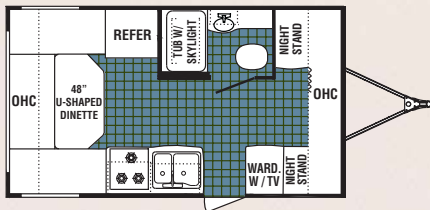

17FL

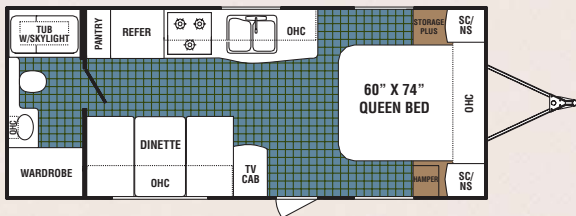

19FL

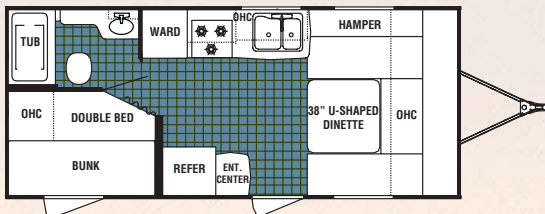

21DB

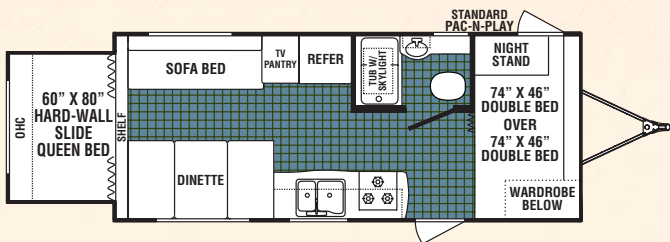

21QS

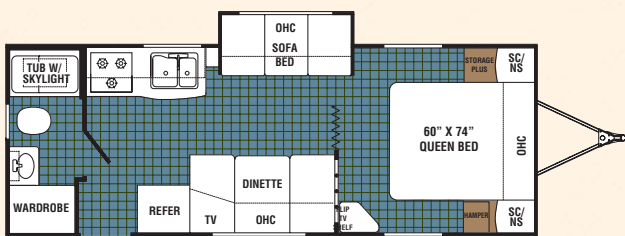

24RB-SL

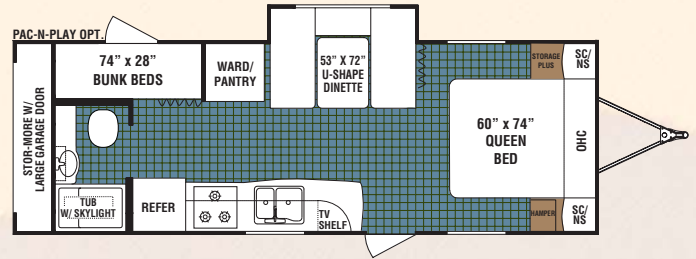

25RGB-SL

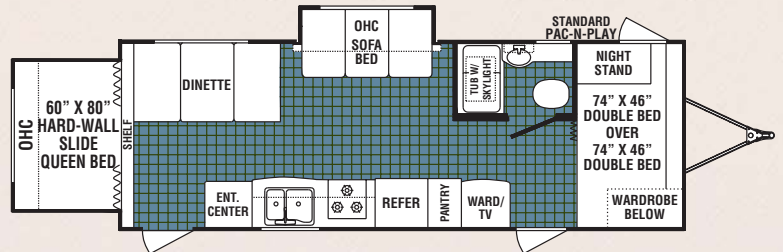

25QS

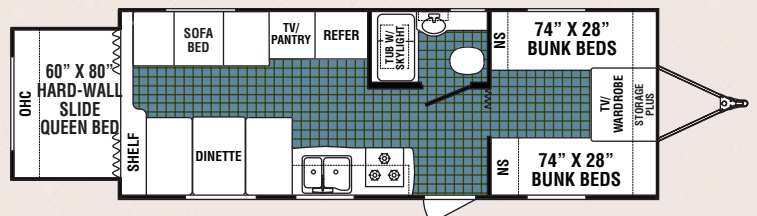

26QS

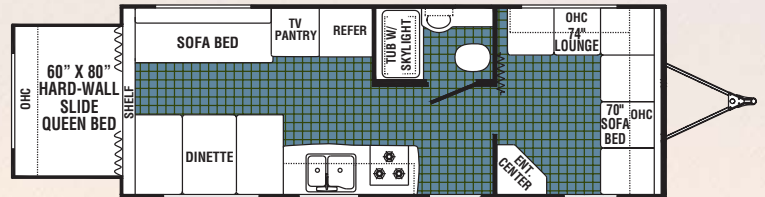

26QSL

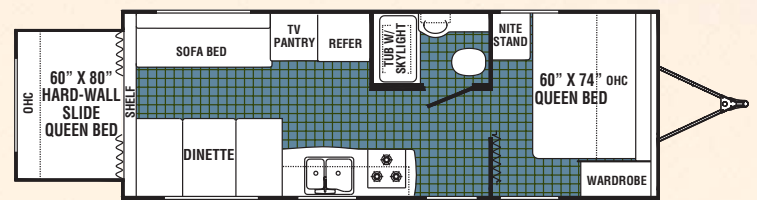

26QSQ

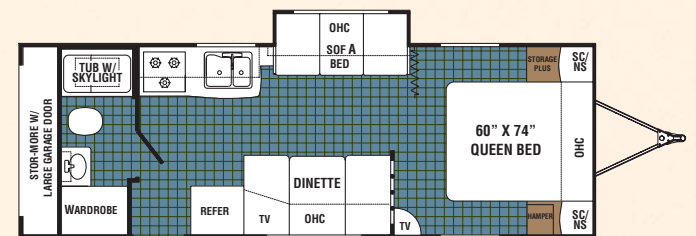

26RG-SL

# AEROLITE ULTRA-LITE TRAVEL TRAILERS

**1/2 TON  
SERIES**

	17FL	19FL	21DB	21QS	24RB-SL	25RGB-SL	25QS	26QS	26QSL	26QSQ	26RG-SL	26RK-SL	27BH	27RB-SL	27RS-SL	30BH-SL
*Axle Weight	2367	3113	3009	3559	3467	3826	3935	3960	3847	3778	3772	3563	3757	3937	4334	3989
*Dry Hitch Weight	321	327	338	373	482	385	388	359	364	351	475	392	464	487	482	451
*Unloaded Vehicle Weight	2688	3440	3347	3932	3949	4211	4323	4319	4211	4129	4247	3955	4221	4424	4816	4440
GVWR	3850	6000	4840	6000	6000	6000	6000	6000	6000	6000	6000	6000	6000	6000	6000	6000
Net Cargo Capacity	1162	2560	1493	2068	2051	1789	1677	1681	1789	1871	1753	2045	1779	1576	1184	1560
Exterior Length	19'2"	24'4"	23'4"	24'5"	26'4"	28'8"	27'1"	27'1"	27'1"	27'1"	28'8"	27'1"	30'4"	30'4"	30'4"	30'4"
Exterior Height w/A/C	9'4"	9'8"	9'4"	9'8"	9'8"	9'8"	9'8"	9'8"	9'8"	9'8"	9'8"	9'8"	9'8"	9'8"	9'8"	9'8"
Exterior Width	8'	8'	8'	8'	8'	8'	8'	8'	8'	8'	8'	8'	8'	8'	8'	8'
Fresh Water Capacity	38	38	38	38	38	38	38	38	38	38	38	38	38	38	38	38
Gray Water Capacity	36	36	36	36	36	36	36	36	36	36	36	36	36	36	36	36
Black Water Capacity	22	22	22	22	22	22	22	22	22	22	22	22	22	34	22	22
Furnace Size (BTUs)	19,000	19,000	19,000	19,000	19,000	19,000	30,000	30,000	30,000	30,000	19,000	30,000	30,000	30,000	30,000	30,000

Tire Size (all models): ST205/75D14(C) Interior Height (all Aerolite models): 6'4"

\*Axle weight, dry hitch weight and unloaded vehicle weight (UVW) are base weights of units without options. Each unit includes a weight label which lists specific weight information for that unit. Vehicle Loading – Every effort has been made to provide the greatest number of options for the recreation vehicle owner. Along with these choices comes the responsibility to manage the loads that are imposed by the choices so that they remain within the manufacturer's specified chassis weight limits. Do not overload the recreation vehicle. Net carrying capacity (NCC) determined by subtracting unloaded vehicle weight (UVW) from gross vehicle weight (GVWR) and includes fluids, options and cargo. Liquid capacities and weights are approximations only.

Warning: This information is intended as a guide only. Weights of individual vehicles may vary. Consult your owner's manual for complete loading, weighing and towing instructions. Product information, specifications, and photography in this brochure were as accurate as possible at time of printing. Photographs may contain some features that are optional on your vehicle. Since we continually strive to improve our products, actual products may differ. Prices and specifications are subject to change without notice. All capacities are approximate and dimensions are nominal. Some features shown are optional and may be different or unavailable in Canada.

Vehicles are designed for recreational use only and not intended for use as a primary residence.

See Page 5 for Décor Choices

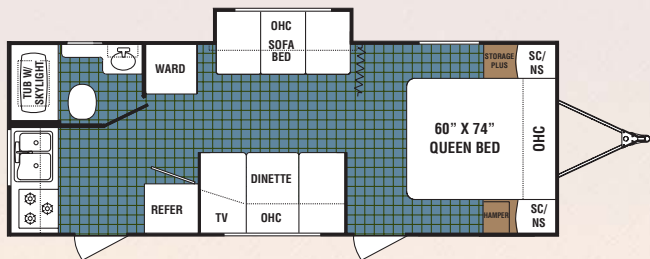

26RK-SL

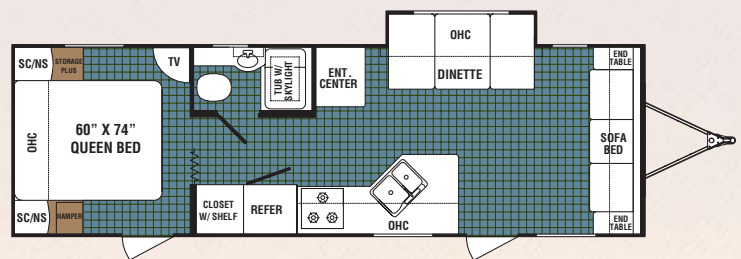

27RB-SL

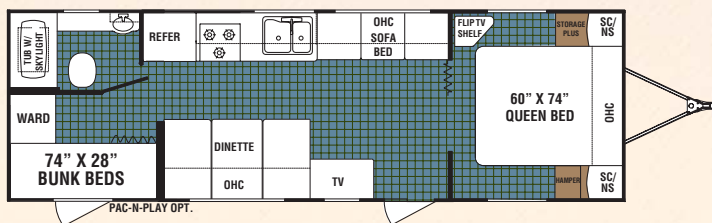

27BH

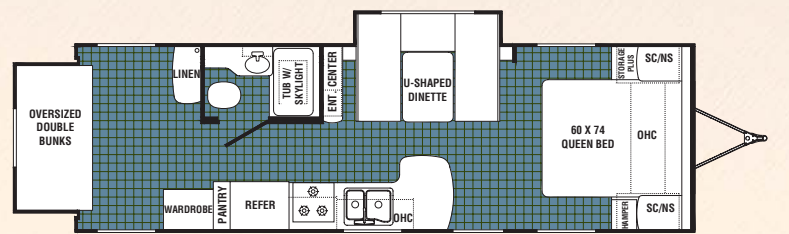

27RS-SL

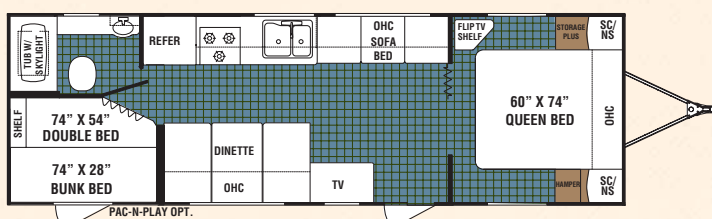

27BH Shown with Double Bed option

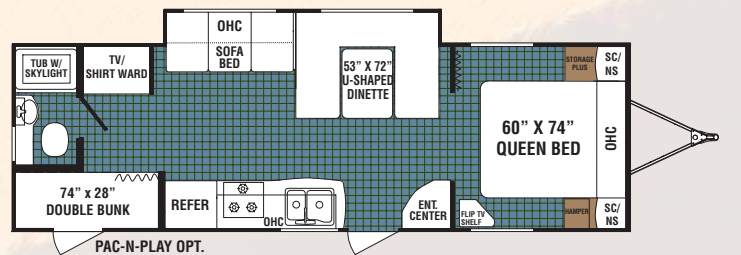

30BH-SL (available with Pac-n-Play storage option)

# MORE FEATURES STANDARD

FROM THE LEADER IN ULTRA-LITE TECHNOLOGY

Exterior Features	Cub	Aerolite
8' Wide floorplans	STD	STD
2-20 lb LP bottles with ABS cover	STD	N/A
Two 30 lb LP bottles with ABS cover	N/A	STD
Key-locking "Easy Latch" tent doors	STD	N/A
Self-Supporting bunk ends – no poles required	STD	N/A
60" x 80" queen beds in tents	STD	N/A
60" x 80" queen bed in hard-wall slide	N/A	STD
26" radius corner entry door	STD	STD
Flush combo entry latch/deadbolt lock	STD	STD
ABS wheel wells	STD	STD
Tandem axles with 4-wheel electric brakes	STD	STD
6-Way welded aluminum laminated superstructure (roof, floor and walls)	STD	STD
Lite-weight European-style frame with lifetime rust through warranty	STD	STD
Rubber torsion "independent suspension" axles	STD	STD
ABS fender skirts	STD	STD
EPDM one-piece seamless rubber roof	STD	STD
Corrosion free laminated underbelly	STD	STD
Patio, step, & dump valve service lights	N/A	STD
High-end designer graphics	STD	STD
Rain gutter with corner downspouts	STD	STD
Rear bumper and corner guards	STD	STD
Single entry step	STD	STD
Tinted radius clamp ring windows	STD	STD
Exterior step light with switch	STD	STD
Entry-assist handle at door	STD	STD
Break-away trailer switch	STD	STD
120V Exterior outlet	STD	STD
Safety glass	STD	STD
Roof ducted for air conditioning	N/A	STD*

Interior Features	Cub	Aerolite
5" Thick, reversible dinette seats	STD	STD
Bathroom medicine cabinet	STD	STD
Designer window treatments	STD	STD
Fiberlink bathtub	STD	STD
Shower curtain	STD	STD
Residential tile-like linoleum	STD	STD
Mini blinds throughout	STD	STD
Power roof vent in bathroom	STD	STD
Color-coordinated bedspread	N/A	STD
Clothes hamper/laundry basket with access to Storage Plus (See floorplan for availability)	N/A	STD

Appliances & Electrical	Cub	Aerolite
12V Electric slide-out motor	STD	STD
Forced air DSI furnace with wall thermostat	STD	STD
30 Amp power cord with storage compartment	STD	STD
6 Gallon gas water heater with bypass	STD	STD
12V interior lights with wall switch	STD	STD
Fire extinguisher	STD	STD
LP detector	STD	STD
Carbon monoxide detector	STD	STD
Smoke detector	STD	STD
Norcold single door gas/electric refrigerator	STD	N/A
6 Cubic ft. Norcold double door gas/electric refrigerator	OPT	STD
Pre-wired for air conditioning	STD	STD
Pre-wired for cable TV and stereo	STD	STD
Range hood with 12V light and exhaust fan	STD	STD
Solid state converter with built-in battery charger	STD	STD
Systems monitor panel	STD	STD
Demand water pump	STD	STD
Stainless steel appliances	N/A	STD
Foot flush toilet	N/A	STD
3 Burner range/oven	OPT	STD

\*NA on 17FL, 19FL, 21DB

## Options

### Cub Pack Group:

- 13.5 BTU air conditioning with wall thermostat
- AM/FM/CD player with two speakers
- A&E 8300 series awning
- TV antenna with cable prep
- Microwave
- Bunk end lights with fan
- Oven with three burner range

### Aerolite Pack Group:

- 13.5 BTU air conditioning with wall thermostat
- AM/FM/CD player with four speakers
- A&E 8300 series awning
- TV antenna with cable prep
- Microwave

Other Optional Features	Cub	Aerolite
Exterior sound system	OPT	OPT
Surround sound system with CD/DVD	N/A	OPT*
15" Flat screen TV with wall mount	N/A	OPT*
Heated bunk mattress	OPT	N/A
Custom bike rack	OPT	OPT
Spare tire with cover	OPT	OPT
6.3 Cubic ft. double door refrigerator	OPT	STD
3 Burner high-output range	OPT	STD
DSI water heater (gas/electric)	OPT	OPT
Heated holding tanks (3)	N/A	OPT
Hot/Cold Exterior shower	OPT	OPT
Stove cover	OPT	OPT
Tub surround	OPT	OPT
Water filter system	OPT	OPT
Exterior barbeque grill	OPT	OPT
Bedroom carpet	N/A	OPT
Aluminum rims	OPT	OPT
Enclosed underbelly	OPT	OPT
Fantastic vent	N/A	OPT
Four corner stabilizer jacks with sand pads	STD	OPT
Roof ladder	N/A	OPT*
Bi-fold shower door	OPT	OPT



**Why A Thor Product Is Your Best RV Value:**

Thor Industries, Inc., listed on the New York Stock Exchange, proudly traces its history back over seventy years to the pioneering days of the RV industry with the founding of Airstream, the industry's oldest and most renowned brand. Our total commitment to quality and our philosophy of putting our customers first has led to our continuous growth. Today, Thor is the largest builder of RVs. Thor's strong financial condition and years of solid growth are your assurance that we will be here to serve you for years to come. We think this extra peace of mind is important when you are making a significant investment. Because our customers are always #1 with us, we work harder than other manufacturers to satisfy you.

©2006 Thor Industries, Inc.

ACrev1.11-06



2164 Caragana Court  
Goshen, IN 46526  
Sales: 574.534.1224  
Fax: 574.975.0556

Parts & Service: 574.537.0700

[www.aero-rv.com](http://www.aero-rv.com)



1 YEAR BUMPER TO HITCH LIMITED WARRANTY

2 YEAR STRUCTURAL & APPLIANCE LIMITED WARRANTY

We're so confident in the design and construction of our products that they are covered by Thor's Limited Warranty program.

\*See owner's manual for complete warranty details.

Your Local Dealer

Explore Your Horizons

TWO YEAR STRUCTURAL AND APPLIANCE WARRANTY • ONE YEAR BUMPER TO HITCH WARRANTY