

# ADIRONDACK

2005 LITE-WEIGHT TRAVEL TRAILERS & FIFTH WHEELS



*Share the Adventure  
of a Lifetime*





# ADIRONDACK

2005 LITE-WEIGHT TRAVEL TRAILERS & FIFTH WHEELS



**28RK-M5**

When it's time for that well deserved vacation, the luxury and comfort of Adirondack will help you relax in style. Adirondack's charming interior décor is inspired by premium European designs. Featuring raised panel Harmony white cabinets, microfiber fabrics and residential style furnishings, Adirondack is sure to impress the most discriminating buyer.



*Adirondack's large tinted bay windows offer picturesque views of the great outdoors.*

You will find plenty of pleasing touches in every Adirondack model. Large living areas, spacious kitchens with generous storage, and sizeable bedroom and bathrooms make Adirondack your best value when it comes to lite-weight travel trailers and fifth wheels.



*Relax in comfort when you stretch out on the premium sofa bed. The microfiber sofa includes attached arm pillows.*



# DÉCOR CHOICES



Adirondack features large bathrooms with a standard skylight and window. Select floorplans feature a neo-angle shower with glass door.



31BK-DSL shown in Jostile Blue.

**Main Fabric –**  
Taupe Skylar  
Microfiber: sofa,  
bedspread and  
dinette  
seat.



Eating in has never been so enjoyable when you dine in Adirondack's oversized arched dinette. Five-inch thick vinyl-backed cushions are covered with premium Skylar fabrics.



It's the little touches like cathedral arched harmony cabinets and premium designer lights that make Adirondack your best value.



You'll find plenty of storage space in the two large storage drawers under the bed. They slide out easily so everything's accessible. (Travel Trailers)

**Accent Fabrics –**  
Dinette and valances,  
headboard, and  
pillows.

28RK-M5 Kitchen



Preparing something to eat will be a treat for the family chef. Adirondack features spacious kitchens with lots of countertop and storage space. Stainless steel appliances are standard.

All models feature Taupe Frieze carpet. See floorplans for details.

Skylar  
Plum

Jostile  
Blue

Bryn with  
Taupe or  
Green  
Accents

Share the Adventure of a Lifetime



# ADIRONDACK

## 2005 LITE-WEIGHT TRAVEL TRAILERS

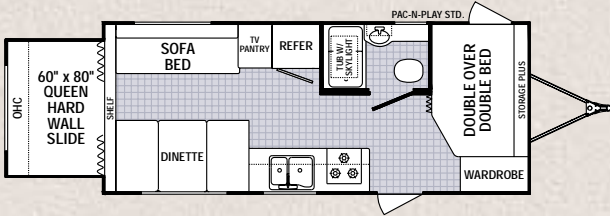

21QS

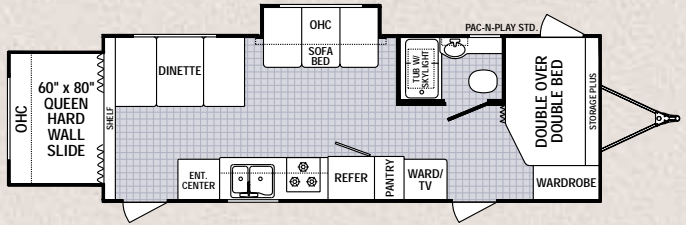

25QS

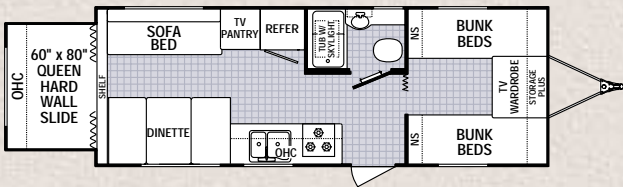

26QS

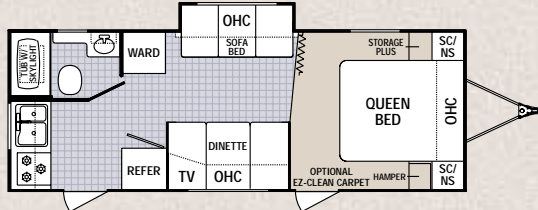

26RK-SL

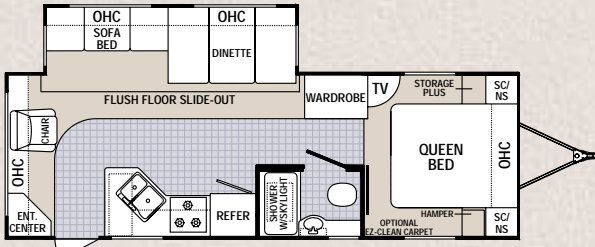

26RL-DSL

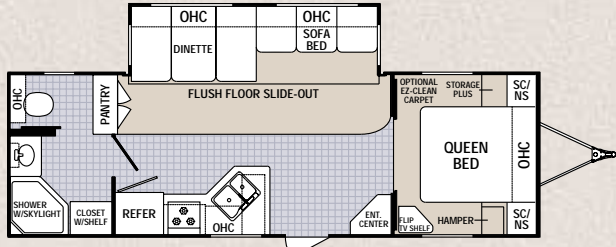

27FB-DSL

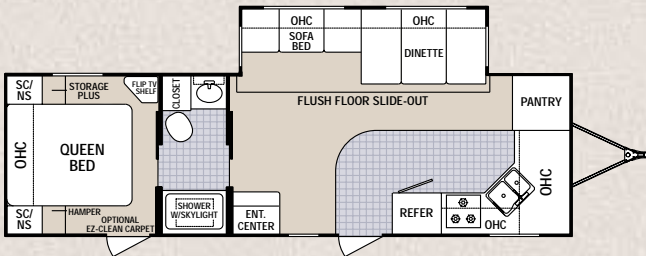

27FK-DSL

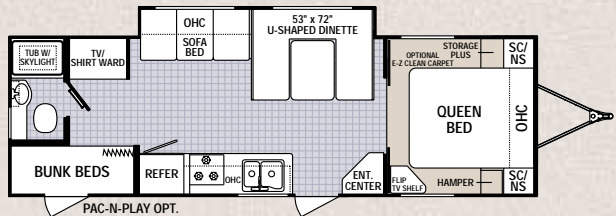

30BH-SL (available with Pac-n-Play storage option)

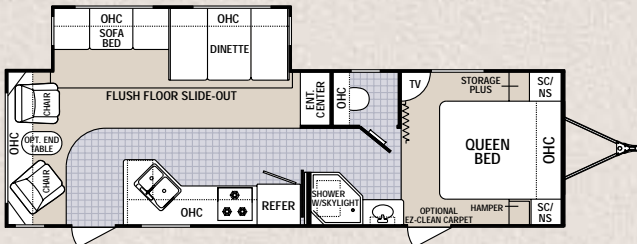

30RL-DSL

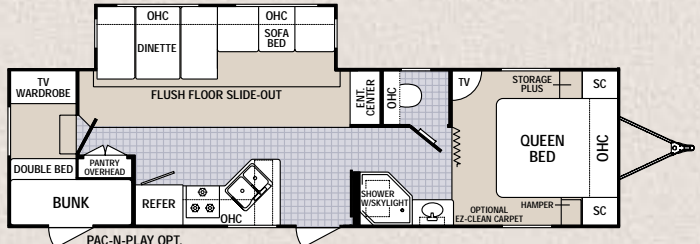

31BK-DSL (available with Pac-n-Play storage option)

Many floorplans include slide-out rooms to maximize interior space. The QS models with rear bed slide is a first in the industry. It's all electric, self supporting and gives you a full 60" x 80" queen bed.



TRAVEL TRAILERS	21QS	25QS	26QS	26RK-SL	26RL-DSL	27FB-DSL	27FK-DSL	30BH-SL	30RL-SL	31BK-DSL
*Axle Weight	3680	3954	3857	3871	4898	4828	4898	4051	5224	5338
*Dry Hitch Weight	275	392	397	479	837	683	837	479	715	861
*Unloaded Vehicle Weight	3956	4328	4254	4350	5736	5511	5735	4530	5940	6199
GVWR	6000	6000	6000	6000	7700	7700	7700	6000	7700	7700
Cargo Capacity	2004	1672	1746	1650	1964	2189	1965	1470	1760	1501
Exterior Length	24'4"	27'1"	26'9"	26'9"	32'9"	30'3"	32'2"	30'3"	32'9"	35'1"
Exterior Width	8'	8'	8'	8'	8'	8'	8'	8'	8'	8'
Exterior Height w/A/C	9'8"	9'8"	9'8"	9'8"	10'8"	10'8"	10'8"	9'8"	10'8"	10'8"
Fresh Water Tank	46	46	46	46	46	46	46	46	46	46
Grey Water Tank	34	34	34	34	34	68	68	34	34	34
Black Water Tank	22	22	22	22	34	34	34	22	22	34
Tire Size	ST205/75D14(C)	ST205/75D14(C)	ST205/75D14(C)	ST205/75D14(C)	ST205/75R15(C)	ST205/75R15(C)	ST205/75R15(D)	ST205/75D14(C)	ST205/75D15(C)	ST205/75R15(C)
Furnace Size	19,000	19,000	30,000	30,000	30,000	30,000	30,000	30,000	30,000	30,000

**Vehicle loading** – Every effort has been made to provide the greatest number of options for the recreation vehicle owner. Along with these choices comes the responsibility to manage the loads that are imposed by the choices that they remain within the manufacturer's specified chassis weight limits. Do not overload the recreation vehicle. Net carrying capacity (NCC) is determined by subtracting unloaded vehicle weight (UVW) from gross vehicle weight (GVWR) and includes fluids, options and cargo. Liquid capacities and weights are approximations only. **Warning** – This information is intended as a guide only. Weights of individual vehicles may vary. Consult your owner's manual for complete loading, weighing and towing instructions.

\*Axle weight, UVW and Dry Hitch Weight are base weights of units without options. Each unit includes a weight label which lists specific weight information for that unit.

## 2005 LITE-WEIGHT FIFTH WHEELS

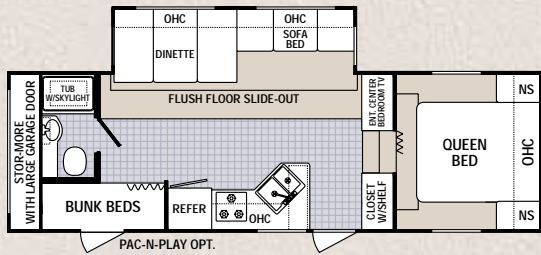

24RGB-M5 (available with Pac-n-Play storage option)

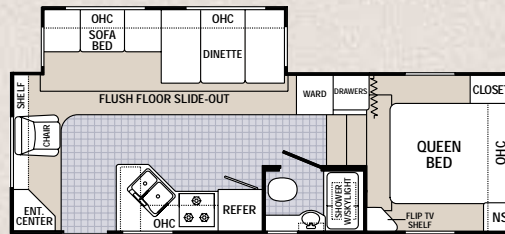

24RL-M5

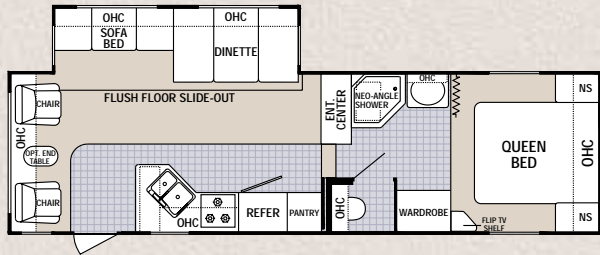

27RL-M5

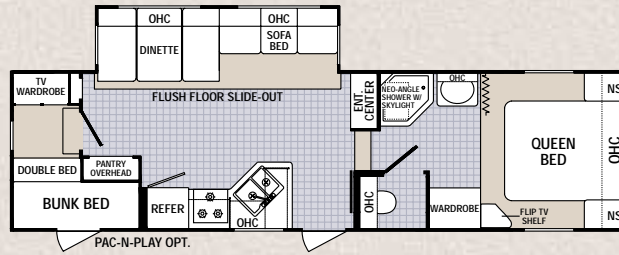

28BH-M5 (available with Pac-n-Play storage option)

FIFTH WHEELS	24RL-M5	24RGB-M5	27RL-M5	28BH-M5	28RK-M5
*Axle Weight	4973	4970	5628	5826	5614
*Dry Hitch Weight	983	1119	1275	1201	1267
*Unloaded Vehicle Weight	5956	6089	6903	7027	6881
GVWR	8400	8400	8400	9200	9200
Cargo Capacity	2444	2311	1497	2172	2319
Exterior Length	26'11"	30'3"	31'1"	33'8"	32'6"
Exterior Width	8'	8'	8'	8'	8'
Exterior Height	12'1"	11'5"	12'1"	12'1"	12'1"
Fresh Water Tank	46	46	46	46	46
Grey Water Tank	34	34	68	N/A	68
Black Water Tank	34	34	22	34	34
Tire Size	ST205/75R15(C)	ST205/75R15(C)	ST205/75R15(C)	ST225/75R15(D)	ST225/75R15(D)
Furnace Size	30,000	30,000	30,000	30,000	30,000

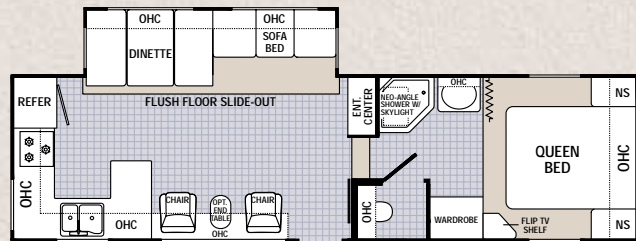

28RK-M5



### ADIRONDACK'S EXTREME OUTDOORS OFF ROAD PACKAGE

For those who need extra ground clearance for off road campsites:

8" Body lift kit ■ Extended jack and stabilizers

■ Double entry step ■ Dunlop Rover LT235/75R15

mud and snow tires (Also available with standard ST205/75D14 tires.)



# ADIRONDACK

## LITE-WEIGHT CONSTRUCTION

### CHASSIS

1. Folding entry step – low step height for easy entry
2. Ultra-lube hubs. Grease Zerk makes wheel bearings easy to lube. Extends life of bearings
3. Al-Ko torsion “independent suspension” and axles – the smoothest ride in the industry. (SL and non-slide models)
4. All tanks mounted in frame. Lowers the center of gravity, and saves valuable interior storage space
5. 46 gallon fresh water tank with Quick Drain feature. Tank design prevents water from standing in tanks during storage. The largest fresh water tank in the industry!
6. Standard enclosed underbelly protects tanks and floor from the hazards of the road
7. Norco ultra light weight chassis with lifetime powder coat over E-coat paint finish (non-slide and SL models). DSL travel trailers and fifth wheels feature traditional steel frames with E-coat paint finish
8. Twin 30 lb. LP tanks with optional ABS cover (most models). SL slide and non-slide models feature the “Pair-n-a-spare” triple LP bottle system
9. 12,000 lb. safety chains

### WALLS

**5-ply construction. Fully laminated, aluminum framed construction.**

10. Tubular aluminum welded frame – reinforced around door
11. Dark tinted radius corner windows
12. Insulated baggage doors with key locks and finger pulls
13. ABS fender skirts
14. Decorative wall board
15. Lauan wood backer
16. High density structural foam insulation
17. Lauan plywood backer
18. Smooth Filon fiberglass with premium graphics package
19. Pass-through storage compartment (where available)
20. Aerodynamic front profile

### ROOF

**5-ply construction. Fully laminated, aluminum framed construction.**

21. Tubular aluminum framed roof reinforced at A/C
22. Lauan wood backer
23. One-piece EPDM rubber roof with 12 year manufacturer’s material warranty
24. High density structural foam insulation
25. Lauan wood backer
26. Decorative ceiling board

### FLOOR

**5-ply construction. Fully laminated, aluminum framed floor structure.**

27. One-piece composite wheel wells (non-slide and SL models)
28. Residential vinyl flooring – full length of coach
29. Residential carpet with pad (most models)
30. Two layers of floor decking over aluminum frame and foam
31. High density structural foam
32. Plywood base with polypropylene waterproof vapor barrier
33. Tubular aluminum framed floor, reinforced at tanks

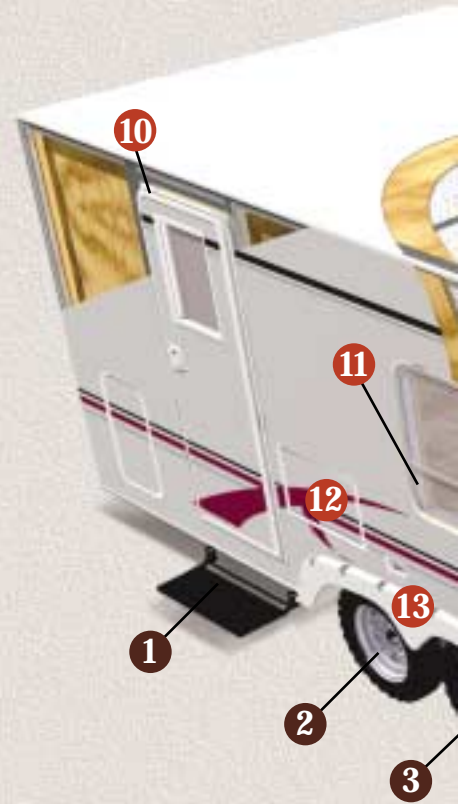

The standard enclosed underbelly enhances the aerodynamics on Adirondack and protects the fresh water, holding tanks and floor from the hazards of the road.



The carpet is removable! Take it out for cleaning or store it away on those wet and muddy days. (optional)

5-spoke aluminum rims are standard on Adirondack!





# Two Year Structural and Appliance Warranty One Year Bumper to Hitch Warranty

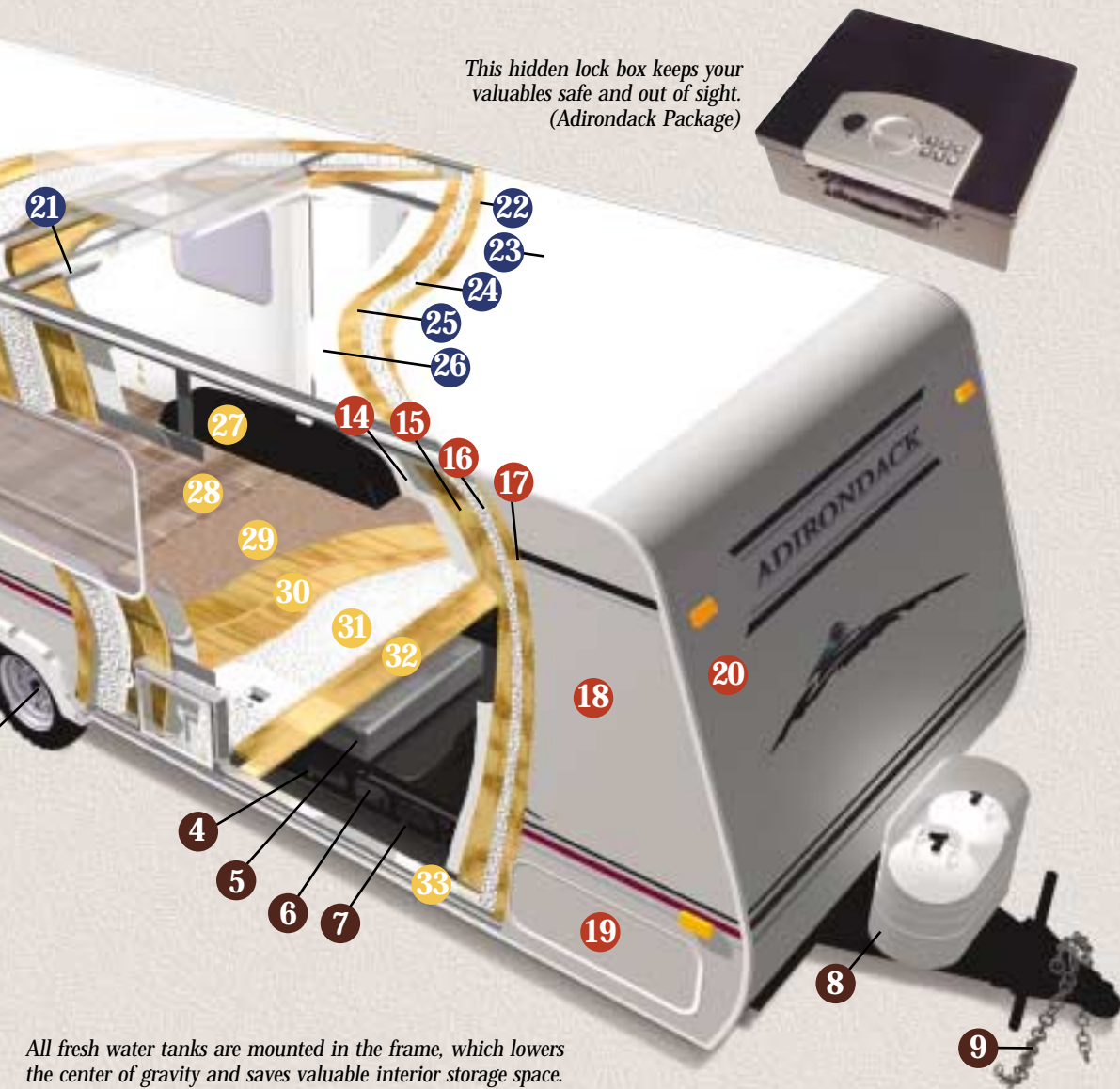

This hidden lock box keeps your valuables safe and out of sight. (Adirondack Package)



Adirondack's dinette seat, bunk beds, queen beds and pass-through storage compartments are aluminum framed. They are lighter and more durable than the competitors' wood frame structures.



Adirondack's exterior shower features hot and cold water, a quick connect coil hose and a sprayer. (optional)



Audiovox two-way radios include 4 five mile range radios and a 12V charger base station. (optional)

All fresh water tanks are mounted in the frame, which lowers the center of gravity and saves valuable interior storage space. The 46 gallon fresh water tank features a quick drain design that prevents water from standing in the tanks during storage. This is the largest fresh water tank in the industry!



Centered under the awning, this 8" security light brightens your camp site at night.

Oversized, pass-through storage compartment is carpeted and includes a convenience light. (most models)

With three residential-sized LP gas bottles, you've got a pair and a spare! You can use the third bottle as a spare, for your grill, or other LP camping equipment. (SL and non-slide models)



Take your cooking outside with Adirondack's exterior barbecue grill. (optional)





# ADIRONDACK

2005 LITE-WEIGHT TRAVEL TRAILERS & FIFTH WHEELS

## STANDARD FEATURES

### Standard Exterior Features

- Lite-weight aerodynamic design
- Grey Filon fiberglass exterior with color coordinated trim
- Norco lightweight frame with highly durable E-Coat powder coat finish (travel trailers – non-DSL models)
- I-beam cambered chassis with durable E-Coat finish (fifth wheels and DSL travel trailers)
- Al-Ko rubber torsion “independent suspension” axles with 4-wheel electric brakes (SL and non-slide models)
- Leaf spring axles and suspension (fifth wheels and DSL models)
- Laminated 5" crowned roof structure
- EPDM one piece seamless rubber roof
- Enclosed underbelly
- Welded aluminum/laminated superstructure (roof, floor and walls)
- Radius corner entry door with deadbolt lock
- Aluminum rims
- ABS wheel wells
- Folding entry step

- High end designer graphics
- Rain gutters with corner downspouts
- Color ABS fender skirts
- Dark-tint, radius clamp ring windows
- Step light with switch (exterior)
- Entry-assist handle at door
- “Storage Plus” pass-through exterior storage with light (most models)
- Ozite carpet in pass-through storage areas
- LP systems:
  - Travel trailers, non-slides and SL models: Three 20 lb. LP tanks (N/A 21QS, 25QS)
  - Travel trailers with DSL: Two 30 lb. LP tanks
  - Fifth wheels: Two 30 lb. LP tanks
- Break-away trailer switch
- 120V exterior outlet
- Courtesy light at hitch
- Electric slide motor
- Electric front jack (fifth wheels)

### Appliances and Electrical

- Stainless steel appliances
- Norcold double-door gas/electric refrigerator

- 3 Burner range with “quick boil” burner and large oven
- Range hood with 12V light and exhaust fan
- Systems monitor panel
- 6 Gallon gas water heater with DSI
- Forced air DSI furnace with wall thermostat
- Ducted heat
- Roof ducted for A/C
- Pre-wired for A/C
- Pre-wired for stereo
- Solid state converter with built in battery charger
- LPG/Smoke/CO detector
- Fire extinguisher
- Data/phone jack
- 30 Amp power cord with storage compartment
- Demand water pump
- Backers for awning toppers

### Standard Interior Features

- Harmony white raised panel cabinet doors with cathedral arch
- Residential vinyl flooring
- Interior décor wallboard with easy clean vinyl coating
- 5" Thick, reversible arched back dinette seats

- European-style light fixtures
- Décor coordinated wallpaper border
- Mini blinds throughout
- Designer window treatments
- Premium sofa with arm rests
- Skylight roof vents
- TV shelf/cabinet
- Designer glass light over dinette table (most models)

### Kitchen Features

- Residential single lever faucet
- Trash bag holder below sink
- Double bowl stainless steel sink
- Stainless steel appliances

### Bedroom Features

- Designer lights in bedroom
- Décor coordinated bedspread and headboard
- Mirrored wardrobe closets

### Bath Features

- Power roof vent in bathroom
- Skylight over tub/shower
- Medicine cabinet (most models)
- Six panel bathroom door
- Fiberlink bathtub with curtain or neo-angle shower tub
- Tub/shower surround

## OPTIONAL FEATURES

### Adirondack Pack Option

- Pillow shams
- Sofa pillows
- Coat and towel hooks
- ABS LP bottle cover (travel trailers)
- Dual sink covers
- Interior exit assist handle at door
- Large scare light with switch
- Storage drawers on metal glides under bed (travel trailers)
- Security lock box

### Comfort Group Option

- 13.5 BTU air conditioner with wall thermostat
- AM/FM/CD player with four speakers
- A&E 8500 series awning
- TV antenna with cable prep
- Large microwave

### Other Optional Features

- Four corner stabilizer jacks
- Roof ladder (N/A QS models, 24RG, 26RK)
- Exterior Barbecue

- Exterior hot and cold spray away station
- (3) 12V heat pads for holding tanks
- Safety glass
- Water filter system with spout
- Fantastic vent
- Removable easy clean carpet in bedroom (travel trailers)
- Day/Night shades
- Pac-n-Play storage compartment
- Bike rack

- Stove cover
- 6-Gallon gas/electric water heater with DSI
- Free standing dinette
- Audiovox two-way radio system includes 4 radios and wall mounted charger
- Exterior sound system with 2 speakers
- Recliner option
- Swivel rocker option
- Spare tire with cover
- Power tongue jack
- Bi-fold shower door



### The Industry's Best Warranty – By Far!

We're so confident in the design and construction of our products that they are covered by Thor's Limited Warranty program.

Your warranty includes:

- One Year Bumper to Hitch Limited Warranty
- Two Year Structural and Appliance Limited Warranty

\*See owner's manual for complete warranty details.

Your Local Dealer:



### Why A Thor Product Is Your Best RV Value:

Thor Industries, Inc., listed on the New York Stock Exchange, proudly traces its history back over seventy years to the pioneering days of the RV industry with the founding of Airstream, the industry's oldest and most renowned brand. Our total commitment to quality and our philosophy of putting our customers first has led to our continuous growth. Today, Thor is the largest builder of RVs. Thor's strong financial condition and years of solid growth are your assurance that we will be here to serve you for years to come. We think this extra peace of mind is important when you are making a significant investment. Because our customers are always #1 with us, we work harder than other manufacturers to satisfy you.

Photographs may contain some features that are optional on your vehicle. Since we continually strive to improve our products, actual products may differ. Prices and specifications are subject to change without notice. All capacities are approximate and dimensions are nominal. Some features shown are optional and may be different or unavailable in Canada.

### Adirondack

2164 Caragana Court ■ Goshen, IN 46526  
(574) 534-1224 ■ Fax: (574) 975-0556  
www.adirondack-rv.com

©Thor Industries, Inc.

ADRI 10/04