

2005



ULTRA-LITE
EXPANDABLES &
TRAVEL TRAILERS

Explore Your Horizons



THE LEADER IN ULTRA-LITE TECHNOLOGY

LESS IS MORE



10 floor plans loaded with standard features as light as 2,675 lbs.

Cub from Aerolite.

The Original Ultra-Lite Expandable Travel Trailer.

The 23TT features (3) 60" x 80" queen beds, self-supporting bunk ends. (shown above)



ULTRA-LITE EXPANDABLES

For active families on the go, Cub expandable travel trailers add sleeping space without the additional length and weight of traditional travel trailers. The ultra-lite design and aerodynamic profile make Cub a dream to tow. Plus, the interior of Cub is packed with high-end features, including designer décor, large kitchens with abundant storage, expansive living spaces and comfortable sleeping areas.

So, when it is time for your next travel trailer, choose Cub, your best value in ultra-lite expandable travel trailers.

A feeling of home starts in the kitchen. Residential accents like raised panel upper cabinet doors, tasteful designer décor, a spacious double-bowl composite sink with high-rise faucet, 3-burner range with optional oven, large storage areas and tons of countertop space make Cub your best value.



*Cub 236 in
Natural Green*

THE LEADER IN ULTRA-LITE TECHNOLOGY



23TT shown Adage Rose

Cub's comfortable 60" x 80" queen bed bunk ends include a 5" thick mattress, zippered room darkening shades and a privacy curtain. A bunk light end fan is available as an option.

Optional heated bunk mattresses are available on Cub to help keep you warm on those chilly nights.



Cub bunk ends are self-supporting. This revolutionary system suspends the 60" x 80" queen bed from the wall of the trailer. Cub does not require exterior tent poles to support the bunk ends. Plus, each bed has a 1200 lb. capacity, the highest capacity in the industry!



Cub expandables are built exclusively with premium Cavlar 2000, the best vinyl tent in the industry. Cavlar

2000 is a 15 ounce vinyl fabric that resists mold and mildew and wicks away condensation. Plus, Cavlar 2000 is made with UV protector that prevents damage and fading from the sun, and has a five-year materials warranty.



Key-locking "Easy Latch" tent doors eliminate the use of unsecured, crank-style door hardware. Simply unlock the tent door, push the release button, open the cam arm and drop the door into the open position.

CUB

ULTRA-LITE EXPANDABLES

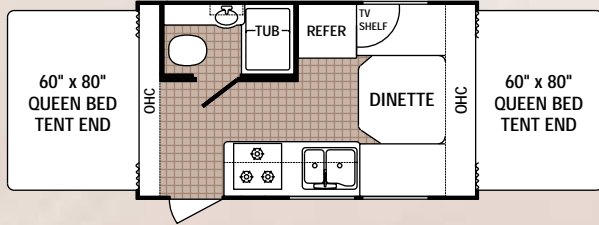

160

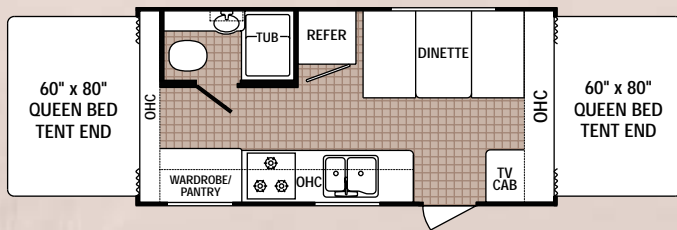

195

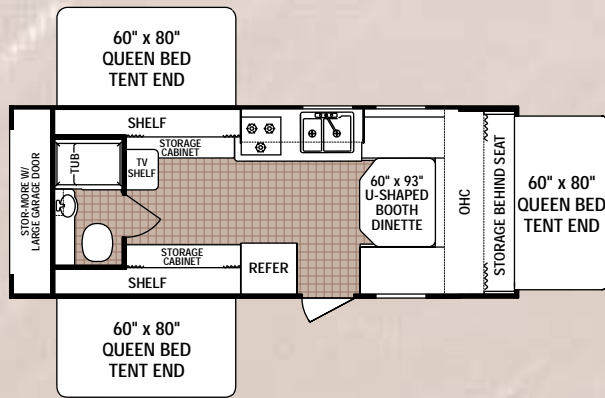

21TT

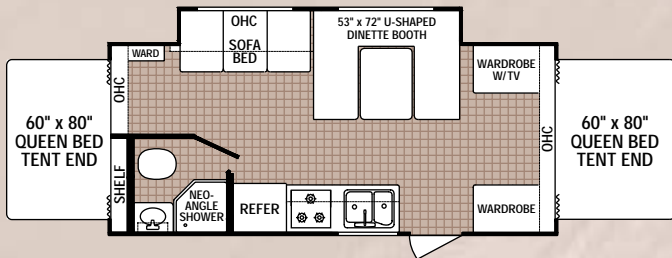

214

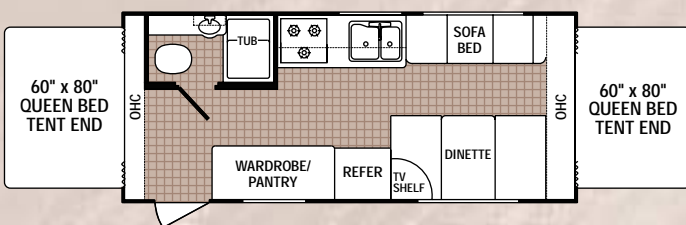

215

 VINYL

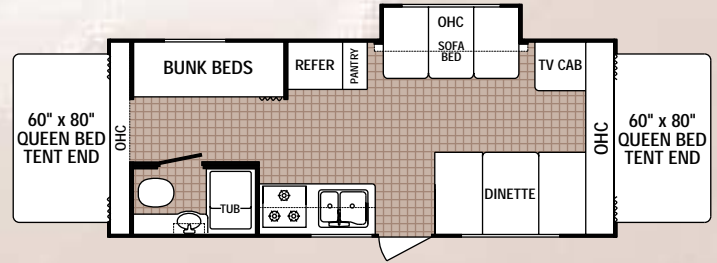

23BH

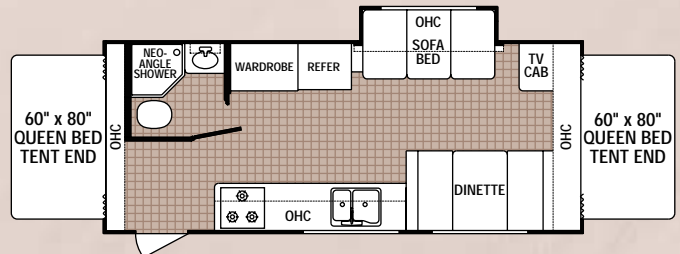

235

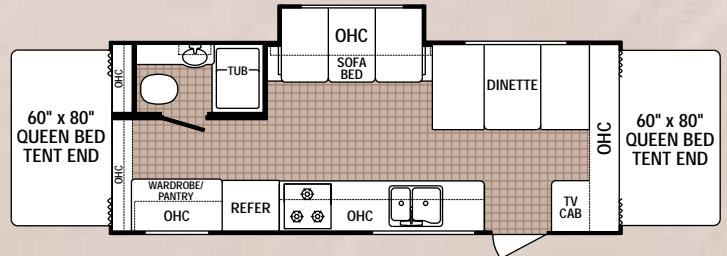

236

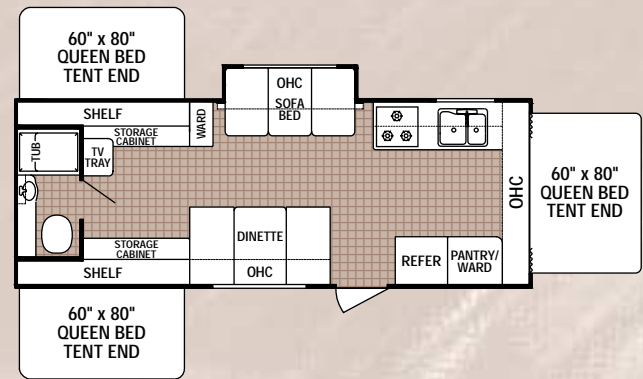

23TT

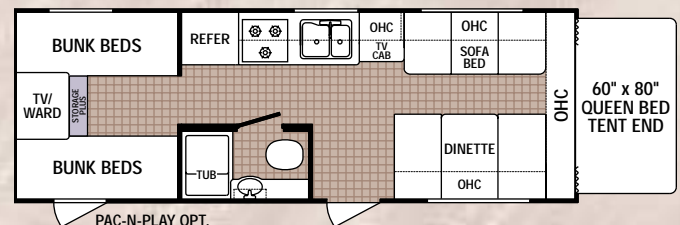

25QB (available with Pac-n-Play storage option)

EXCLUSIVELY CUB

The interior of the 2005 Cub is our best looking ever. The designer décors with luxurious fabrics, raised panel upper cabinet doors, and residential vinyl flooring make the Cub your best choice when it comes to expandable travel trailers.



23TT shown Adage Rose



Both Cub and Aerolite are available with the optional spray and wash station, featuring hot and cold water and a 6' long retractable, quick disconnect hose and sprayer.



Take your cooking outside with Cub's exterior barbecue grill. (optional)



Audiovox two-way radios include 4 radios and base. (optional)

CUB EXPANDABLES	160	195	214	215	21TT	23TT	235	236	23BH	25QB
*Axle Weight	2451	2899	3297	3001	3283	3497	3269	3413	3401	3075
*Dry Hitch Weight	221	231	351	299	461	513	345	315	461	547
*Unloaded Vehicle Weight	2672	3130	3648	3300	3744	4110	3614	3728	3862	3622
GVWR	3850	4840	4840	4840	4840	6000	4840	4840	4840	4840
Net Cargo Capacity	1178	1710	1192	1540	1096	1890	1226	1112	978	1218
Exterior Length (closed)	17'2"	20'8"	24'4"	22'8"	24'4"	26'4"	24'4"	24'4"	26'4"	26'4"
Exterior Height with A/C	9'4"	9'4"	9'4"	9'4"	9'4"	9'4"	9'4"	9'4"	9'4"	9'4"
Exterior Width	8'	8'	8'	8'	8'	8'	8'	8'	8'	8'
Fresh Water Capacity	46	46	46	46	46	46	46	46	46	46
Gray Water Capacity	34	34	34	34	34	34	34	34	34	34
Black Water Capacity	22	22	22	22	22	32	22	22	22	22
Furnace Size (BTUs)	19,000	19,000	19,000	19,000	19,000	19,000	19,000	19,000	19,000	19,000

Tire Size (all models): ST205/75D14(C)

Interior Height (all Aerolite and Cub models): 6'4"



THE INDUSTRY'S
BEST WARRANTY
By Far!

We're so confident in the design and construction of our products that they are covered by Thor's Limited Warranty program.

Your warranty includes:

One Year Bumper to Hitch Limited Warranty

Two Year Structural and Appliance Limited Warranty

*See owner's manual for complete warranty details.

*Axle weight, dry hitch weight and unloaded vehicle weight (UVW) are base weights of units without options. Each unit includes a weight label which lists specific weight information for that unit.

Vehicle Loading - Every effort has been made to provide the greatest number of options for the recreation vehicle owner. Along with these choices comes the responsibility to manage the loads that are imposed by the choices so that they remain within the manufacturer's specified chassis weight limits. Do not overload the recreation vehicle.

Net carrying capacity (NCC) determined by subtracting unloaded vehicle weight (UVW) from gross vehicle weight (GVWR) and includes fluids, options and cargo. Liquid capacities and weights are approximations only.

Warning: This information is intended as a guide only. Weights of individual vehicles may vary. Consult your owner's manual for complete loading, weighing and towing instructions.

Product information, specifications, and photography in this brochure were as accurate as possible at time of printing. Photographs may contain some features that are optional on your vehicle. Since we continually strive to improve our products, actual products may differ. Prices and specifications are subject to change without notice. All capacities are approximate and dimensions are nominal. Some features shown are optional and may be different or unavailable in Canada.

Vehicles are designed for recreational use only and not intended for use as a primary residence.

ULTRA-LITE CONSTRUCTION

The Original, and Still the Best!

AEROLITE vs. The Competition

IMPROVED AERODYNAMICS

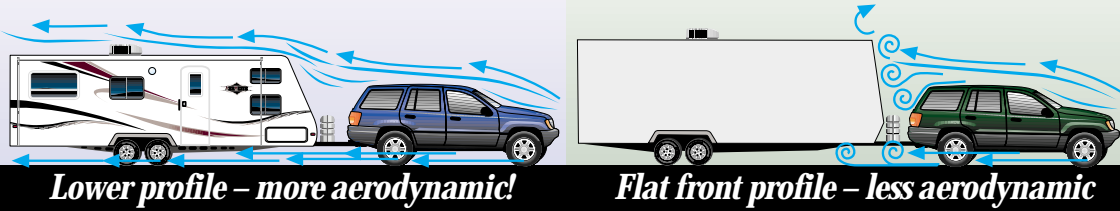

LOWER CENTER OF GRAVITY

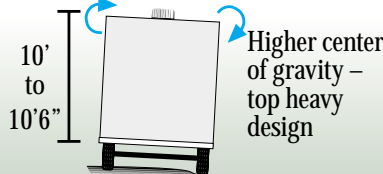

Torsion “independent suspension” axles

Leaf spring solid axles

AXLE TO HITCH WEIGHT RATIO

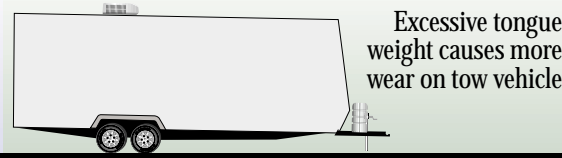

Well balanced design – axle and hitch

Excessive hitch weight

Aerolite, North America's first ultra-lite travel trailer is specifically designed to be towed by most light trucks, and sport utility vehicles. Aerolite's aerodynamic profile is designed to push air up the front wall and over the roof to improve towability and fuel economy. Plus, we position the axles and balance the weight of each floorplan to create the optimal hitch/weight/axle ratio for towing with light trucks or SUVs. And, Aerolite incorporates Al-Ko rubber torsion “independent suspension” axles on the Norco European-style frame. Al-Ko axles allow each wheel to travel independently, unlike leaf spring axles that transfer variations in the road to the opposite wheel. Plus, the Al-Ko axles improve towing stability by lowering the trailer to the ground and reducing the center of gravity.

Improved aerodynamics, optimal weight balance and a lower center of gravity results in the best towing characteristics possible in an ultra-lite travel trailer.



Large fresh water tank
46 gallon fresh water tank with Quick Drain feature. Tank design prevents water from standing in tanks during storage.

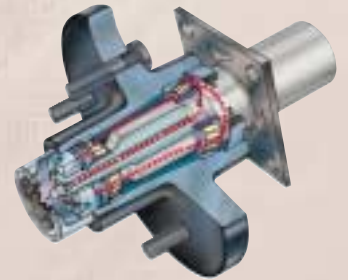

Ultra-Lube hubs
Aerolite includes Ultra-Lube hubs as a standard feature. This allows for easy maintenance of your wheel bearings. (N/A on Cub Expandables.)

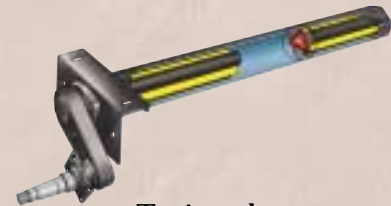

Torsion axles
Cub and Aerolite ride on Al-Ko rubber torsion “independent suspension” axles. Torsion axles soften the ride by absorbing road vibrations and making towing more comfortable. The center of gravity is lowered with torsion axles, which improves aerodynamics and maneuverability.

Norco-Bal® ultra-lite frame
Cub and Aerolite feature a Norco-Bal ultra-lite European style chassis. This durable chassis is 400 pounds lighter than the traditional box-style chassis, which reduces weight and increases cargo capacity. The Norco-Bal frame features a powder coat over E-coat paint finish, backed by a lifetime rust through warranty.



6-WAY ALUMINUM FRAMED CONSTRUCTION

Most Cub and Aerolite feature the HAPPI-JAC® secure track slide system. This low profile 12V electric slide system takes up less space, which frees up room for larger slide rooms and more storage.

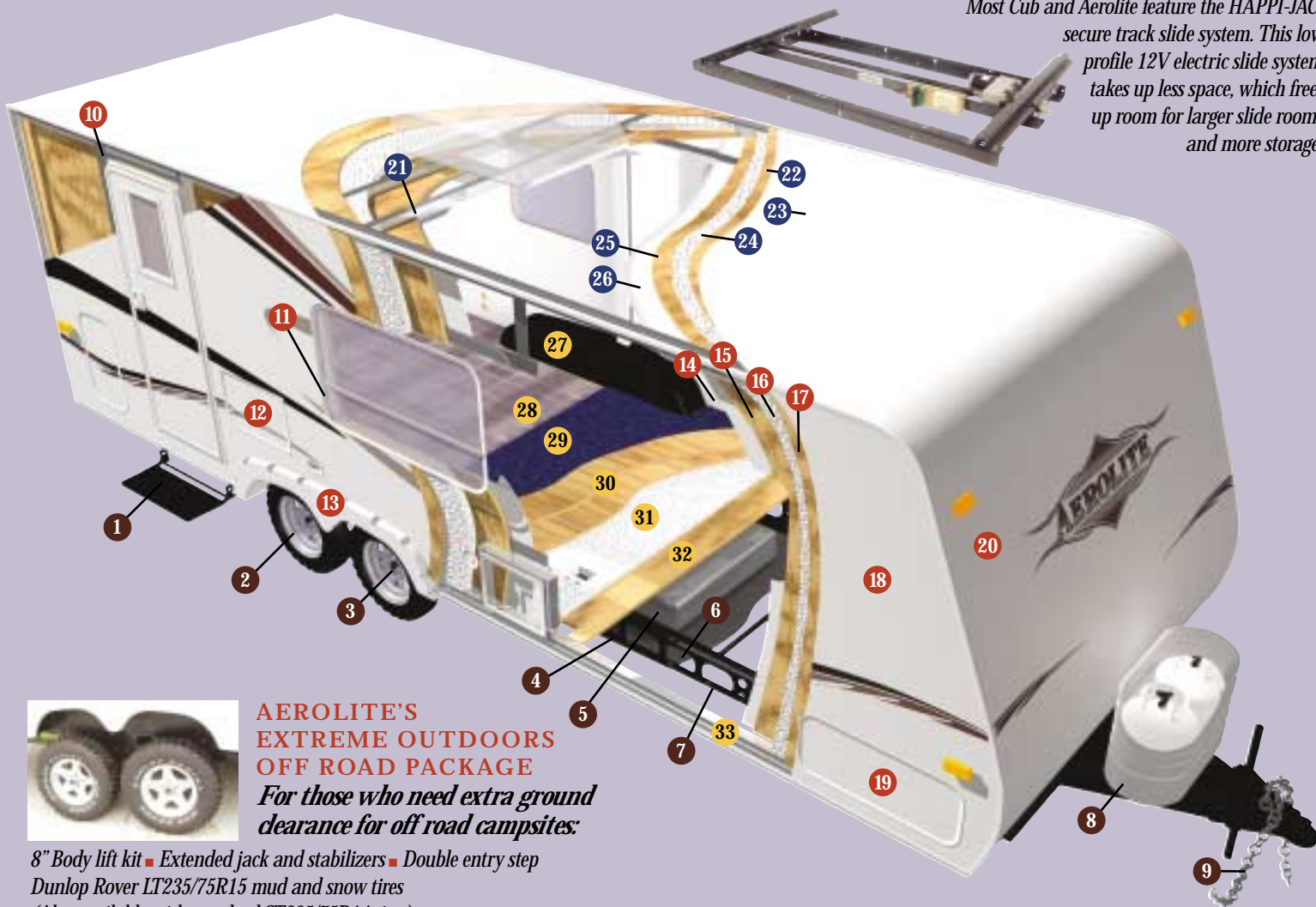

**AEROLITE'S
EXTREME OUTDOORS
OFF ROAD PACKAGE**
*For those who need extra ground
clearance for off road campsites:*



8" Body lift kit ■ Extended jack and stabilizers ■ Double entry step
Dunlop Rover LT235/75R15 mud and snow tires
(Also available with standard ST205/75D14 tires)

CHASSIS

Cub and Aerolite feature the Norco European style, ultra-lite weight chassis. Aerolite is the first company in the industry to use European style frames in ultra-lites!

1. Folding entry step – low step height for easy entry.
2. Ultra-lube hubs. Grease Zerk makes wheel bearings easy to lube. Extends life of bearings.
3. Al-Ko torsion "independent suspension" axles – the smoothest ride in the industry.
4. All tanks mounted in frame. Lowers the center of gravity, and saves valuable interior storage space.
5. 46 gallon fresh water tank with Quick Drain feature. Tank design prevents water from standing in tanks during storage. The largest fresh water tank in the industry!
6. Optional enclosed underbelly protects tanks and floor from the hazards of the road.
7. Norco ultra light weight chassis with lifetime powder coat over E-coat paint finish.
8. (2) 30 lb. LP tanks with optional ABS cover (Aerolite). (2) 20 lb. LP tanks with optional ABS cover (Cub).
9. 12,000 lb. safety chains.

WALLS

5-ply aluminum framed laminated construction.

10. Tubular aluminum welded frame reinforced around door.
11. Tinted radius corner windows
12. Insulated baggage doors with key locks and finger locks
13. ABS fender skirts
14. Decorative wall board
15. Luan wood backer
16. High density structural foam insulation
17. Luan plywood backer
18. Smooth Filon fiberglass with premium graphics package
19. Pass-through storage compartment (where available)
20. Aerodynamic front profile

ROOF

5-ply aluminum framed laminated construction.

21. Tubular aluminum welded framed roof, reinforced at A/C
22. Luan wood backer
23. One-piece EPDM rubber roof with 25 year manufacturer's material warranty
24. High density structural foam insulation
25. Luan wood backer
26. Decorative ceiling board

FLOOR

5-ply aluminum framed laminated floor structure.

27. One-piece composite wheel wells
28. Armstrong residential vinyl flooring – full length of coach
29. Residential carpet with pad (optional)
30. Two layers of floor decking over foam
31. High density structural foam
32. Plywood base with polypropylene waterproof vapor barrier
33. Tubular welded aluminum framed floor, reinforced at tanks

Explore Your Horizons



*Aerolite 30BH
in Natural Green*



**ULTRA-LITE
TRAVEL TRAILERS**



THE ORIGINAL **ULTRA-LITE** TRAVEL TRAILER

**11 floor plans loaded with
standard features as light as 3,470 lbs.**

Aerolite. The original Ultra-Lite travel trailer features eleven innovative floor plans, ranging from 19' to 30'. With base weights starting at 3,470 lbs. we are sure to have the model that best fits your family's needs.

Designer residential furnishings and fabrics, spacious kitchens, living areas and bedrooms are core features of the Aerolite product line. And just because Aerolite is an Ultra-Lite, it doesn't mean your trailer is light on storage. With spacious countertop and cabinet space, oversized pass-through exterior storage and innovative features like the optional "Pac-n-Play" storage compartment and rear "Stor-More" garage, it's easy to take everything along on your next adventure. Aerolite – The leader in Ultra-Lite technology.

THE LEADER IN ULTRA-LITE TECHNOLOGY



Aerolite kitchens feature a 3-burner range with large oven, large two bowl sink with high-rise faucet and a residential microwave. 30BH kitchen shown at right.



Aerolite features aluminum framed dinette, bed, bunks and pass through storage frames. Aluminum frames are more durable than wood framed structures and save weight.



Get maximum storage with Aerolite's pass-through "Storage Plus" compartments. They are lined with ozite carpeting and include a 12V light.



Need more cargo space? Several floor plans include the large "Stor-More" storage garage.



An Aerolite exclusive – our 53" x 72" U-shaped booth dinette!
Aerolite's innovative slide room construction allows for the largest dinette in Ultra-Lites! The "U-shaped" booth seats six and folds into a massive 53" x 72" queen bed!





EXCLUSIVELY AEROLITE

11 floor plans loaded with
standard features under 3,470 lbs.

The Original Ultra-Lite Travel Trailer.

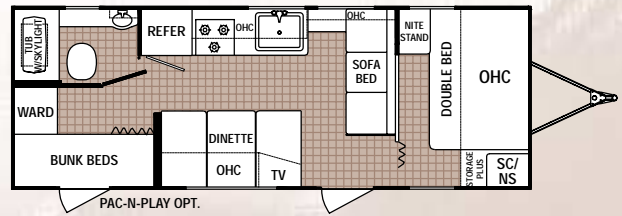

26BH (available with Pac-n-Play storage option)

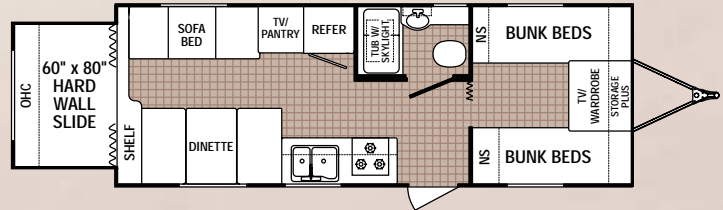

26QS

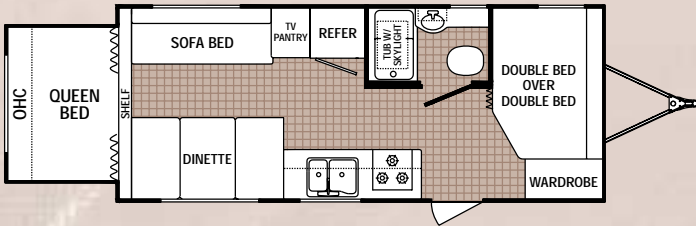

21QS

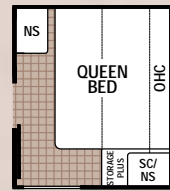

26QS Corner queen bed option

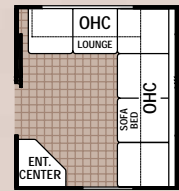

26QS Front lounge option

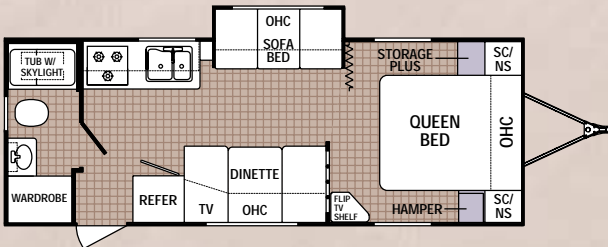

24RB-SL

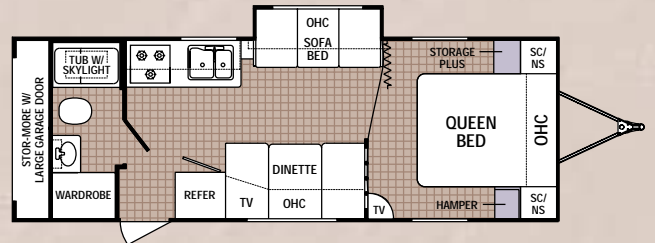

26RG-SL

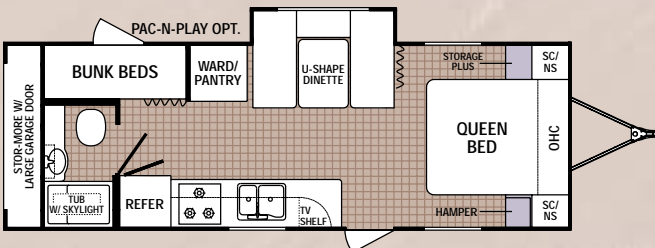

25RGB-SL (available with Pac-n-Play storage option)

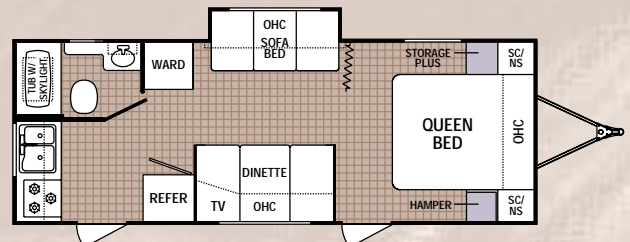

26RK-SL

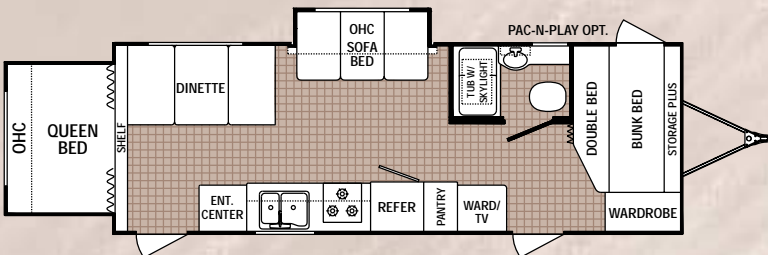

25QS (available with Pac-n-Play storage option)

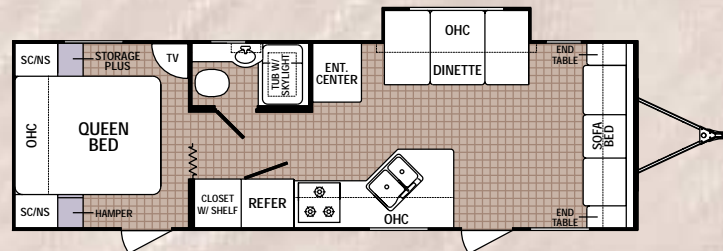

27RB-SL

AEROLITE ULTRA-LITE TRAVEL TRAILERS

AEROLITE	21QS	24RB-SL	25RGB-SL	25QS	26BH	26QS	26RG-SL	26RK-SL	27RB-SL	27RG	30BH-SL
*Axle Weight	3680	3469	3738	3954	3430	3857	3779	3841	3745	3944	4051
*Dry Hitch Weight	275	433	383	392	389	397	409	479	605	428	479
*Unloaded Vehicle Weight	3956	3902	4122	4328	3988	4254	4188	4350	4350	4372	4530
GVWR	6000	6000	6000	6000	6000	6000	6000	6000	6000	6000	6000
Net Cargo Capacity	2004	2098	1878	1672	2180	1746	1812	1650	1650	1628	1470
Exterior Length	24'4"	26'4"	28'7"	27'1"	27'1"	26'9"	28'7"	26'9"	30'3"	31'11"	30'3"
Exterior Height w/A/C	9'8"	9'8"	9'8"	9'8"	9'8"	9'8"	9'8"	9'8"	9'8"	9'8"	9'8"
Exterior Width	8'	8'	8'	8'	8'	8'	8'	8'	8'	8'	8'
Fresh Water Capacity	46	46	46	46	46	46	46	46	46	46	46
Gray Water Capacity	34	34	34	34	34	34	26	34	34	34	34
Black Water Capacity	22	22	22	22	22	22	22	22	22	22	22
Furnace Size (BTUs)	19,000	19,000	19,000	30,000	30,000	30,000	19,000	30,000	30,000	30,000	30,000

Tire Size (all models): ST205/75D14(C)

Interior Height (all Aerolite and Cub models): 6'4"



Choose the Pac-n-Play option on floorplans with bunks to maximize your exterior storage. It's large enough to store bikes, golf clubs, coolers and more.

*Axle weight, dry hitch weight and unloaded vehicle weight (UVW) are base weights of units without options. Each unit includes a weight label which lists specific weight information for that unit.

Vehicle Loading – Every effort has been made to provide the greatest number of options for the recreation vehicle owner. Along with these choices comes the responsibility to manage the loads that are imposed by the choices so that they remain within the manufacturer's specified chassis weight limits. Do not overload the recreation vehicle.

Net carrying capacity (NCC) determined by subtracting unloaded vehicle weight (UVW) from gross vehicle weight (GVWR) and includes fluids, options and cargo. Liquid capacities and weights are approximations only.

Warning: This information is intended as a guide only. Weights of individual vehicles may vary. Consult your owner's manual for complete loading, weighing and towing instructions.

Product information, specifications, and photography in this brochure were as accurate as possible at time of printing. Photographs may contain some features that are optional on your vehicle. Since we continually strive to improve our products, actual products may differ. Prices and specifications are subject to change without notice. All capacities are approximate and dimensions are nominal. Some features shown are optional and may be different or unavailable in Canada.

Vehicles are designed for recreational use only and not intended for use as a primary residence.

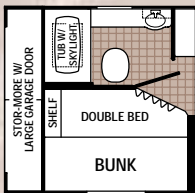

VINYL



CARPET

This hidden lock box keeps your valuables safe and out of sight. (Aerolite package)



27RG Double bed with bunk option

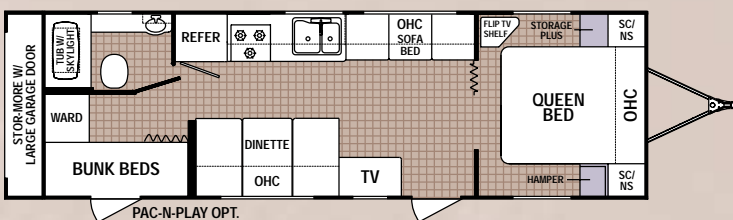

27RG

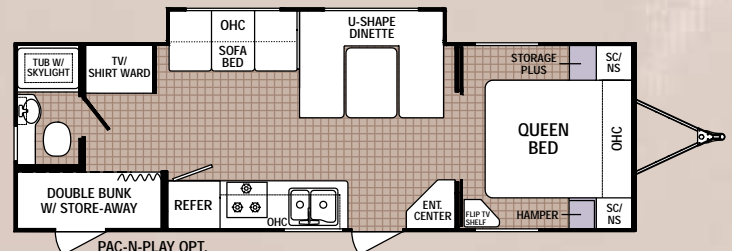

30BH-SL (available with Pac-n-Play storage option)

MORE FEATURES STANDARD

FROM THE LEADER IN ULTRA-LITE TECHNOLOGY

Exterior Features

	Cub	Aerolite
8' Wide floorplans	■	■
2-20 lb LP bottles with ABS cover	■	N/A
Two 30 lb LP bottles with ABS cover	N/A	■
Key-locking "Easy Latch" tent doors	■	N/A
Self-Supporting bunk ends – no poles required	■	N/A
60" x 80" queen beds in tents	■	N/A
26" radius entry door	■	■
Flush combo entry latch/deadbolt lock	■	■
ABS wheel wells	■	■
Tandem axles with 4-wheel electric brakes	■	■
6-Way welded aluminum laminated superstructure (roof, floor and walls)	■	■
Norco light weight European-style frame with lifetime rust through warranty	■	■
Al-Ko rubber torsion "independent suspension" axles	■	■
ABS fender skirts	■	■
EPDM one-piece seamless rubber roof	■	■
Corrosion free laminated underbelly	■	■
Patio light	■	■
High-end designer graphics	■	■
Rain gutter with corner downspouts	■	■
Rear bumper and corner guards	■	■
Single entry step	■	■
Tinted radius clamp ring windows	■	■
Exterior step light with switch	■	■
Entry-assist handle at door	■	■
Break-away trailer switch	■	■
120V Exterior outlet	■	■
Ozite carpet in pass through storage areas	N/A	■
Window in bathroom (most models)	N/A	■
Roof ducted for air conditioning	N/A	■

Interior Features

	Cub	Aerolite
5" Thick, reversible dinette seats	■	■
Bathroom medicine cabinet	■	■
Designer window treatments	■	■
Fiberlink bathtub	■	■
Shower curtain	■	■
Glass décor light over dinette table	■	■
Mini blinds throughout	■	■

Power roof vent in bathroom	■	■
Residential tile-like linoleum	■	■
Color-coordinated bedspread	N/A	■
Clothes hamper/laundry basket with access to Storage Plus	N/A	■

Appliances and Electrical

	Cub	Aerolite
12V Electric slide-out motor	■	■
19M BTU forced air DSI furnace with wall thermostat	■	N/A
30M BTU forced air DSI furnace with wall thermostat (most models)	N/A	■
Ducted heat	■	■
30 Amp power cord with storage compartment	■	■
6 Gallon gas water heater with bypass	■	■
12V interior lights with wall switch	■	■
Fire extinguisher	■	■
LP detector	■	■
Carbon monoxide detector	■	■
Smoke detector	■	■
Norcold single door gas/electric refrigerator	■	N/A
6 Cubic ft. Norcold double door gas/electric refrigerator	OPT	■
Pre-wired for air conditioning	■	■
Pre-wired for cable TV and stereo	■	■
Range hood with 12V light and exhaust fan	■	■
Solid state converter with built-in battery charger	■	■
Systems monitor panel	■	■
Demand water pump	■	■



2164 Caragana Court ■ Goshen, IN 46526
Sales: 574.534.1224 ■ Fax: 574.975.0556
Parts & Service: 574.537.0700
www.aero-rv.com

Options

Cub Pack Group:

- 13.5 BTU air conditioning with wall thermostat
- AM/FM/CD player with two speakers
- A&E 8300 series awning
- TV antenna with cable prep
- Microwave
- Bunk end lights with fan
- Oven with three burner range

Aerolite Pack Group:

- 13.5 BTU air conditioning with wall thermostat
- AM/FM/CD player with two speakers
- A&E 8300 series awning
- TV antenna with cable prep
- Microwave

Other Optional Features

	Cub	Aerolite
Exterior sound system	■	■
Audiovox two-way radio system with four 5-mile handsets and 12V wall mounted charger	■	■
Heated bunk mattress	■	N/A
Custom bike rack with truck receiver accessory	■	■
Spare tire with cover	■	■
6 Cubic ft. double door refrigerator	■	STD
3 Burner high-output range	■	STD
DSI water heater (gas/electric)	■	■
Heated holding tanks (3)	N/A	■
Safety glass	■	■
Hot/Cold Exterior shower	■	■
Stove cover	■	■
Tub surround	■	■
Water filter system	■	■
Exterior barbeque grill	■	■
Bedroom carpet	N/A	■
Aluminum rims	N/A	■
Enclosed underbelly	N/A	■
Fantastic vent	N/A	■
Four corner stabilizer jacks with sand pads	STD	■
Roof ladder	N/A	■
Bi-fold shower door	■	■



Why A Thor Product Is Your Best RV Value:

Thor Industries, Inc., listed on the New York Stock Exchange, proudly traces its history back over seventy years to the pioneering days of the RV industry with the founding of Airstream, the industry's oldest and most renowned brand. Our total commitment to quality and our philosophy of putting our customers first has led to our continuous growth. Today, Thor is the largest builder of RVs. Thor's strong financial condition and years of solid growth are your assurance that we will be here to serve you for years to come. We think this extra peace of mind is important when you are making a significant investment. Because our customers are always #1 with us, we work harder than other manufacturers to satisfy you.

©2004 Thor Industries, Inc.

ARI.1004

Décor Options

Mount
Blanc
Blue

Natural
Green

Adage
Rose

(Aerolite only)
Sunset
Taupe



Your Local Dealer

Explore Your Horizons

TWO YEAR STRUCTURAL AND APPLIANCE WARRANTY • ONE YEAR BUMPER TO HITCH WARRANTY