

Skamper Sport

Escape the Ordinary

Standard Features & Options

Skamper Sport

2003

Exterior Features



Exterior

- Powder Coated Tube Frame
- Single Entry Step
- AL-KO Leaf Spring Axles
- 12" Tires - 8' to 12' Models
- 13" Tires - 14' Models
- 2 Stabilizer Jacks - 8' to 10' Models
- 4 Stabilizer Jacks - 12' to 14' Models
- 20 lb. LP Tank
- Welded Aluminum Frame Walls
- Fiberglass Laminated Exterior Walls
- One Piece Fiberglass Laminated Roof
- 110 Volt GFI Protected Outlet
- Patio Light
- Seamless Undercoated Structurewood Floor
- CAVLAR-15 Sectionalized Tent (5 Year Warranty)
- 5/8" Exterior Grade Plywood Bunk Ends
- 13 Gallon Below Floor Fresh Water Tank (except 8' Models)

Interior

- Stove Surround
- 2 Burner Indoor/Outdoor Cook Top
- Ice Box
- Pre-Wired for A/C
- Free-Standing Dinette
- 4" Thick Bunk Mats
- 4" Thick Dinette Cushions
- Tinted Vinyl Windows
- Laminated Counter Tops
- Residential Linoleum
- Bed Rollers for Bunk Ends
- Power Roof Vent (opt. 8' Models)
- Pass Thru Storage in U-Shaped Dinette Models
- Inside Access Door to Extra Storage
- 8 Storage Pockets in Tent
- 1 Piece Bath with Cassette Toilet (Select Models)

Options

- Deluxe Package (Not Sold Separately):**
- Two Bunk Lights with Fans
 - Towel Bar
 - Spice Rack
 - Sink Cover
 - Space Net
 - Norcold Three-Way Refrigerator
 - Furnace
 - Awning
 - Outside Shower on Slide-Out Models
 - Vitco RVQ Grill
 - Screen Room
 - Electric Brakes
- Value Package (Not Sold Separately):**
- Spare Tire
 - Tire Bracket
 - Tire Cover
 - Vinyl LP Cover
 - Privacy Curtains
 - Valance

Just Show Your Card and Go!



We build our products better and we protect you with the industry's best warranty coverage, but we know that sometimes things can go wrong on the road. So when you become the proud owner of a new Skamper, it's just the beginning of our exclusive 'round-the-clock Customer Care Program.

Customer Care provides complete and fully paid roadside assistance, emergency road service, and special warranty support benefits that go with you wherever you travel. You get immediate access to fast, dependable service when and where you need it.

Add our toll-free warranty and service appointment assistance and a technical assistance hot-line and you have the security and peace of mind of full-time support.

Our exclusive 24-hour Customer Care benefits include:

- Fully paid emergency roadside assistance
- Free jump starts
- Free fuel delivery
- Free lock-out service
- Free on-site mechanical service in the event of a break-down
- 24-hour technical hot-line
- Toll-free service appointment scheduling nationwide
- Warranty service assistance at over 6,800 qualified service agencies
- Free customer trip routing and map service.

We want you to be able to enjoy your new trailer or fifth wheel to the fullest. That's why we've provided Skamper Customer Care to take care of the problems that could spoil your travels.

The Industry's Best Warranty... By Far!

We're so confident in the design and construction of our products that they are covered by Thor's exclusive Full 2-Year Standard Warranty: "Hitch-to-bumper" coverage to protect your RV investment. The best protection in the RV industry—by far:

Your Full 2-Year Warranty Includes:*

- Refrigerator
- Power converter
- TV antenna
- Water pump
- And much more...
- Slide-out Mechanisms
- Water heater
- Microwave
- Doors
- LP tanks
- Range
- Electrical
- Awnings
- Furnace
- Plumbing
- Lavatory
- House stereo

*See individual company warranty statements for details.

Why a Thor Product Is Your Best RV Value:

Thor Industries, Inc., listed on the New York Stock Exchange, proudly traces its history back over seventy years to the pioneering days of the RV industry with the founding of Airstream, the industry's oldest and most renowned brand. Our total commitment to quality and our philosophy of putting our customers first has led to our continuous growth. Today, Thor is the largest builder of RVs. Thor's strong financial condition and years of solid growth are your assurance that we will be here to serve you for years to come. We think this extra peace of mind is important when you are making a significant investment. Because our customers are always #1 with us, we work harder than other manufacturers to satisfy you.

Your Local Dealer:

Product information, specifications, and photography in this brochure were as accurate as possible at time of printing. Photographs may contain some features that are optional on your vehicle. Since we continually strive to improve our products, actual products may differ. Prices and specifications are subject to change without notice. All capacities are approximate and dimensions are nominal. Some features shown are optional and may be different or unavailable in Canada.



This brochure is printed on recycled paper as part of Thor's corporate effort to minimize waste and conserve our natural resources. Providing safe, fuel-efficient recreational vehicles is Thor's way of further demonstrating our role as the industry leader in safeguarding our nation's environment.



305 Steury Ave. • Goshen, IN 46528
(574) 534-1224 • www.aero-rv.com



The Best Tent in the Industry

Our folding trailers have the strongest, heaviest, and most durable tent in the industry. Our exclusive CAVLAR-15 weighs a full 15 ounces per running yard and is constructed with a full 10 ounces of vinyl and 5 ounces of fabric. Most of the competition uses a 13 ounce tent with only 10 ounces of vinyl and fabric. Our tent material will not separate, crack, or peel and resists damaging UV rays and mold. It is designed for long-term wear. That's why we give it a 5 year warranty!

Laminate Vinyl vs. CAVLAR-15

The Real Story

Our exclusive CAVLAR-15 is superior to tent materials used by other manufacturers.

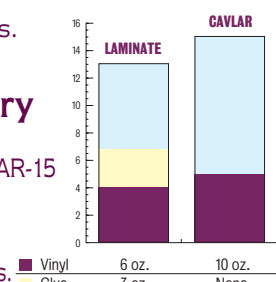

* Information based on "weight per running yard" and measured in ounces



Skamper Sport

The Skamper Sport lives up to its name. Loaded with standard features not found on competitor's folding trailers, the Sport is always ready for family fun. You'll find everything you need to enjoy your weekend outings or cross-country excursions. Best of all, the Skamper Sport's durable construction will deliver years of pleasure and miles of adventure.

Fold-down sink: Galley flips to the side, not the aisle—more storage while traveling!



Interior Features

- 8 Storage pockets (Built into tent sides)
- Carpeted bed step
- 4" Bed mats and dinette cushions
- Vinyl-backed dinette cushions—no stains!
- Residential grade linoleum
- Color coordinated drapes and valances
- Free-standing inside/outside dinette table
- Tinted vinyl windows
- Ice box—standard
- Bed rollers for bunk ends
- Inside access to storage area
- Below-floor water tank—more storage space! (10' and up)

Skamper Sport Floor Plans & Weights

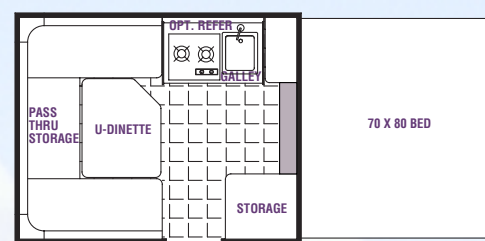

800

Sleeps 4

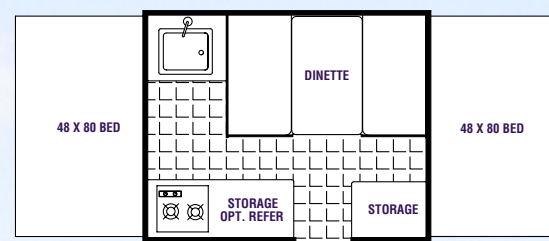

801

Sleeps 6

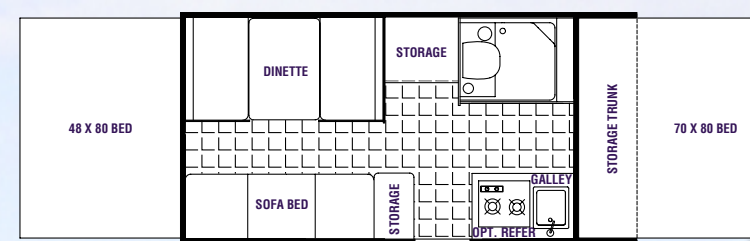

1201 XS

Sleeps 6

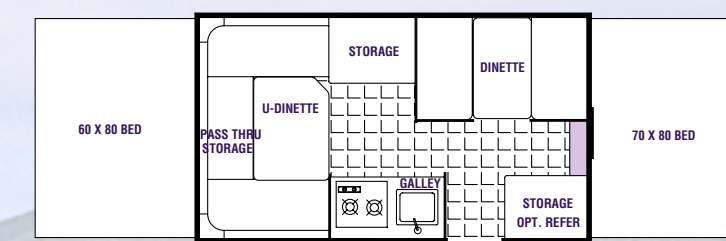

1205

Sleeps 8

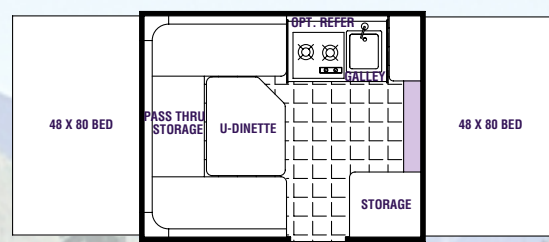

806

Sleeps 6

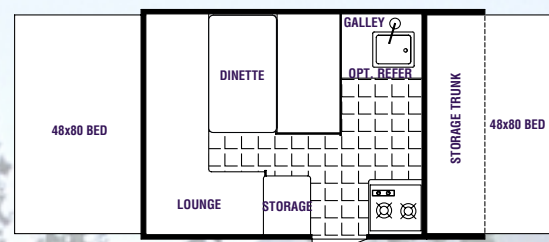

810 XS

Sleeps 6

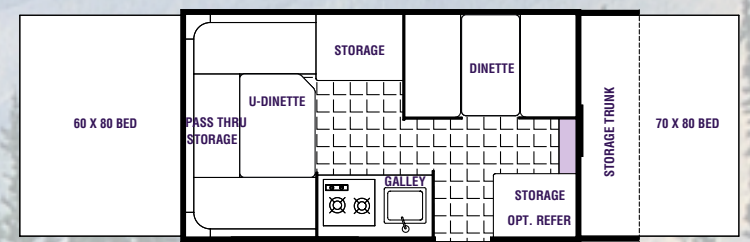

1205 XS

Sleeps 8

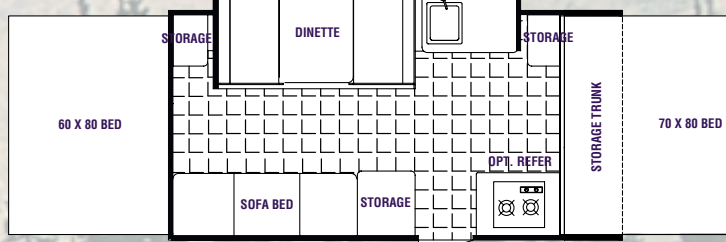

1210 XS

Sleeps 8

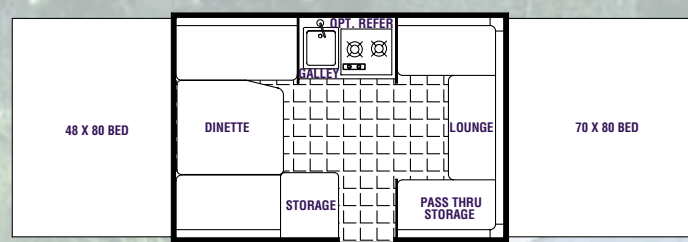

1002

Sleeps 8

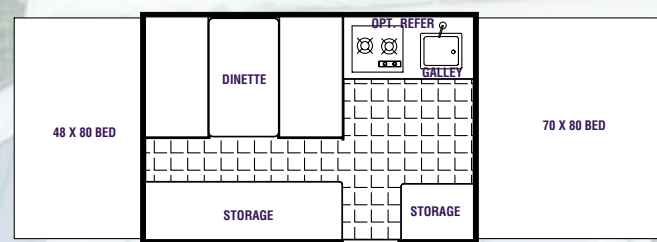

1006

Sleeps 6

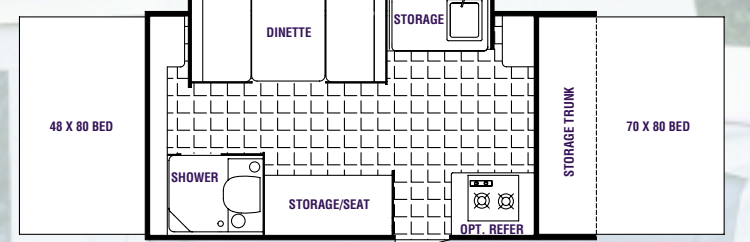

1211 XS

Sleeps 6

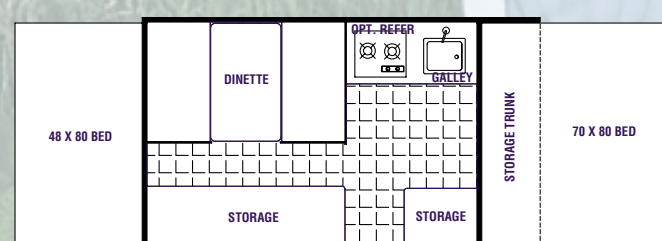

1006 XS

Sleeps 6

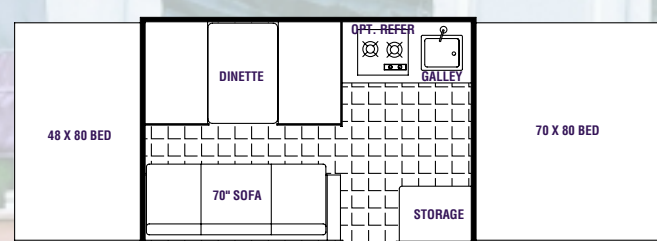

1007

Sleeps 8

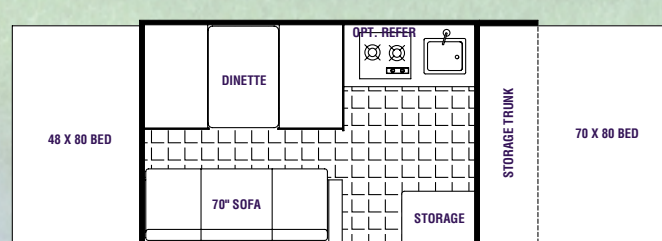

1007 XS

Sleeps 8

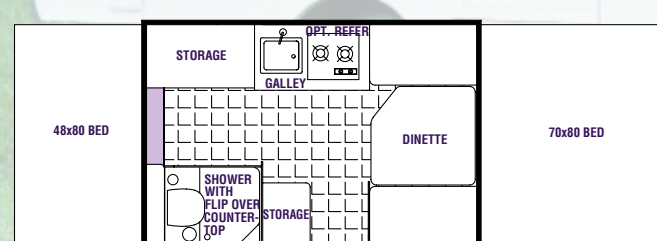

1008

Sleeps 6

Vehicle Loading—Every effort has been made to provide the greatest number of options for the recreation vehicle owner. Along with these choices comes the responsibility to manage the loads that are imposed by the choices so that they remain within the manufacturer's specified chassis weight limits. Do not overload the recreation vehicle.

Dry Weights based on standard features; optional equipment not included. Net carrying capacity (NCC) determined by subtracting unloaded vehicle weight (UVW) from gross vehicle weight (GVWR) and includes fluids, options, and cargo. Liquid capacities and weights are approximations only.

Warning: This information is intended as a guide only. Weights of individual vehicles may vary. Consult your owner's manual for complete loading, weighing, and towing instructions.

SPECIFICATIONS

2003 SPORT	800	801	806	810XS	1002	1006	1006XS	1007	1007XS	1008	1201XS	1205	1205XS	1210XS	1211XS
GVWR	2316	2252	2308	2290	2316	2344	2278	2346	2278	2312	TBD	2328	2906	TBD	2882
Gross Dry Weight	1392	1480	1462	1584	1579	1676	1814	1678	1810	1490	TBD	1868	2104	TBD	2292
Carrying Capacity	924	772	846	706	694	668	464	668	468	522	TBD	460	802	TBD	590
Hitch Dry Weight	216	162	218	200	226	254	188	256	188	222	TBD	238	186	TBD	132
Travel Length	12' 1"	12' 1"	12' 1"	13' 9"	13' 9"	13' 9"	15' 7"	13' 9"	15' 7"	13' 9"	17' 8"	15' 7"	17' 6"	TBD	TBD
Expanded Liv. Leng.	16' 7"	16' 7"	16' 7"	16' 7"	19' 9"	19' 9"	20' 1"	19' 9"	20' 1"	19' 9"	22' 8"	22' 6"	22' 8"	TBD	TBD
Width	7'	7'	7'	7'	7'	7'	7'	7'	7'	7'	7'	7'	7'	TBD	7'
Height	4' 3"	4' 3"	4' 3"	4' 3"	4' 3"	4' 3"	4' 3"	4' 3"	4' 3"	4' 3"	4' 4"	4' 4"	4' 4"	TBD	4' 4"
Fresh Water	10	6	6	6	10	10	10	10	10	10	10	10	10	10	10
LPG Cap. (1) lbs.	20	20	20	20	20	20	20	20	20	20	20	20	20	20	20
Radial Tire Size	ST5.30/12	ST5.30/12	ST5.30/12	ST5.30/12	ST5.30/12	ST5.30/12	ST5.30/12	ST5.30/12	ST5.30/12	ST5.30/12	ST175/80D13	ST175/80D13	ST175/80D13	ST175/80D13	ST175/80D13