

THIS IS LUXURY TOO
AFFORDABLE TO RESIST.

2001 INTRUDER

Face it. You're ready to step up. You've been RVing for quite some time now, and you've got definite ideas about what makes a good RV. But if you think a hefty price tag is one requirement, Damon® says think again. A 2001 Intruder™ Motorhome lets you step up without losing the balance of your budget.

What you'll notice first is Intruder's styling. It's refreshingly clean and contemporary with home-like touches that invite you to settle in. Look closer, and you'll find an array of truly upscale amenities — the kind more often found on the priciest motorhomes. Yet Intruder offers them for thousands of dollars less. You can thank Damon's cost-efficient manufacturing for that. And you can step up to an Intruder today.

- A 20,500-pound Ford® V-10 chassis makes Intruder especially roadworthy. Its stability and handling are exceptional.
- Intruder's exterior has a smooth, sleek, highline appearance, thanks to its high-gloss gelcoated walls.
- Aluminum framing all around lends strength and necessary rigidity to the coach while keeping the weight down.
- Big bus-style sideview mirrors offer an extra measure of safety and convenience.
- Intruder also gives you the benefits of Damon's exclusive Total Quality Service™ (TQS) initiative. Ask your dealer for details.

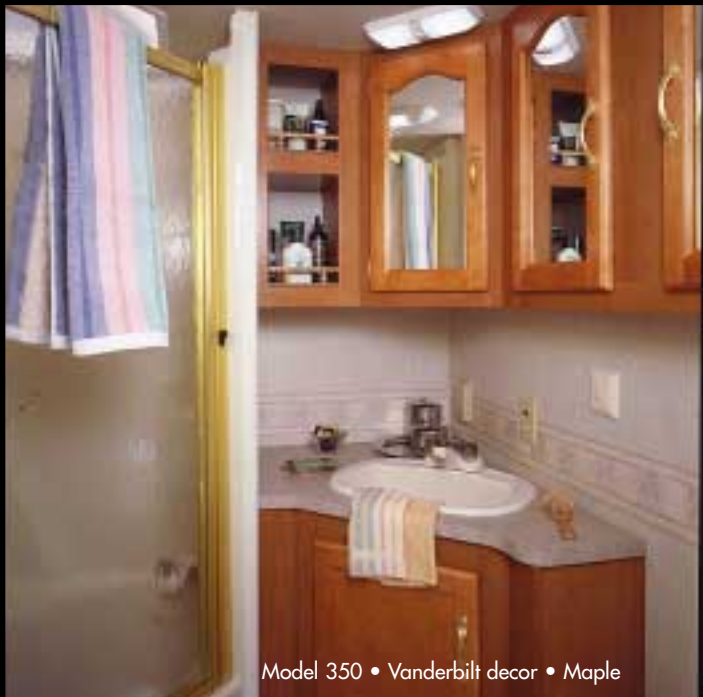

Model 350 • Vanderbilt decor • Maple

- A unique StepSaver™ kitchen puts everything well within reach to make meal preparation quick and easy.
- Thanks to its solid surface, the kitchen countertop is especially easy to clean.
- Hardwood plank flooring lends beauty and functionality to the kitchen area.
- Intruder provides an incredible amount of storage space — including pass-through basement storage compartments.
- Among Intruder's finest options are a back-up monitor, a driver's door with a power window, a six-way power driver's seat, and a 7.0 Onan® Marquis Gold Generator.



A MOVEABLE FEAST

2001 INTRUDER

Model 359 • Windsor decor • Light Oak

A SOFT REPOSE

2001 INTRUDER

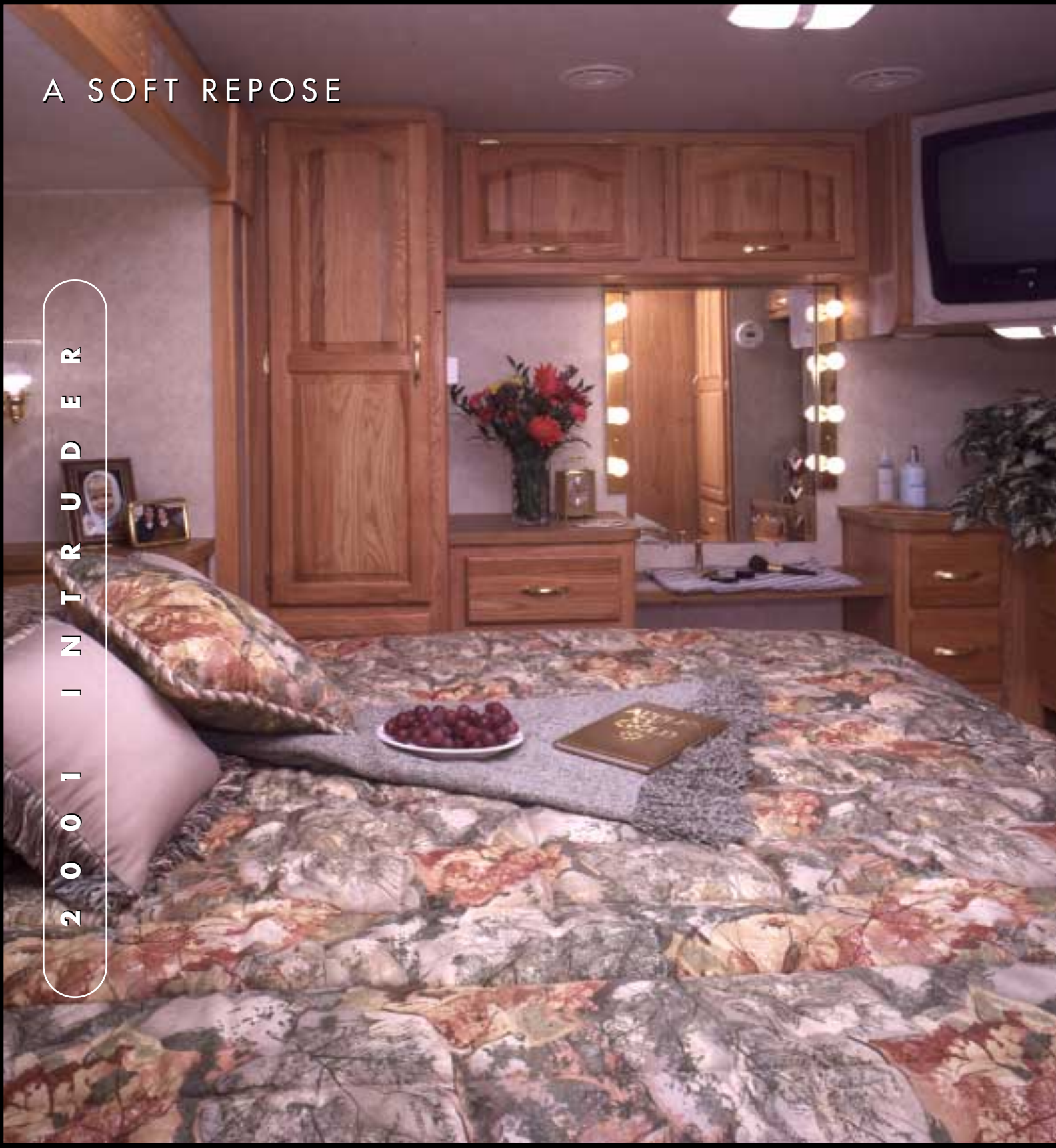

- If you've wished RV bedrooms could be a bit bigger (for easier dressing), you'll love Intruder's bedroom slideout. It really opens up the living space.
- For your entertainment, Intruder has a VCR and control center with two 19" TVs.

- You'll take comfort in knowing your 2001 Intruder has passed a strenuous 400-point inspection test as part of Damon's StartRight Quality Assurance™ program.

Model 359 • Windsor decor • Light Oak

INTRUDER VALUE ALL AROUND



- Aerodynamic styling
- Easy-access engine
- Large windshield with pantographic wipers



- High-mount brake light
- Automotive taillights
- Standard roof-mount ladder



- Awning, standard
- Stainless steel wheel liners
- Innovative bedroom slideout



- No-mess termination dump valve
- Optional driver's door
- Pass-through storage under slideout



- Leveling jacks, standard
- Additional awning over slideout
- Smooth rack and pinion slideout operation



- Huge storage trunks made of durable rotocast polyethylene
- Full-basement pass-through storage
- Storage space in stairwell

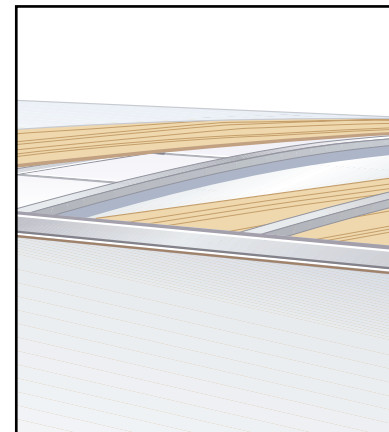

- ABS-ducted air conditioning with unblocked plenums
- Aluminum-frame crowned roof with beaded block-foam insulation
- Residential-styled ceiling

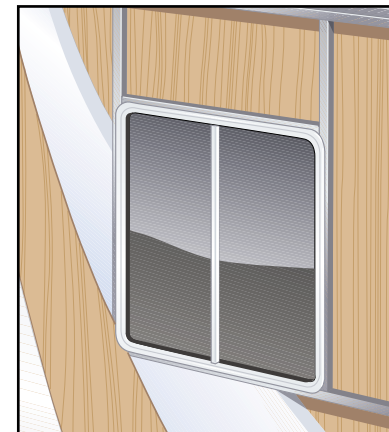

- Aluminum-framed walls and openings
- Vacuum-bonded with beaded block-foam insulation
- White powdercoated window frames

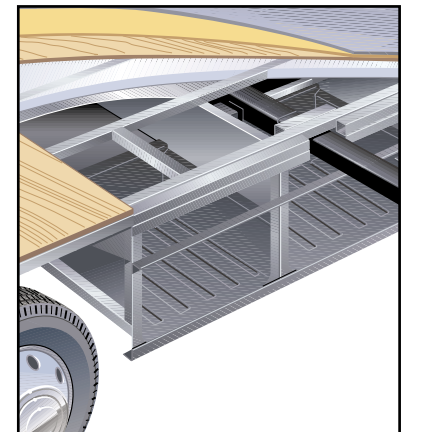

- Steel firewall and steel truss structure system
- Insulated floor system with structurewood and beaded block-foam insulation
- Heated tank area with insulated doors

www.damonrv.com

DECOR



Vanderbilt



Windsor

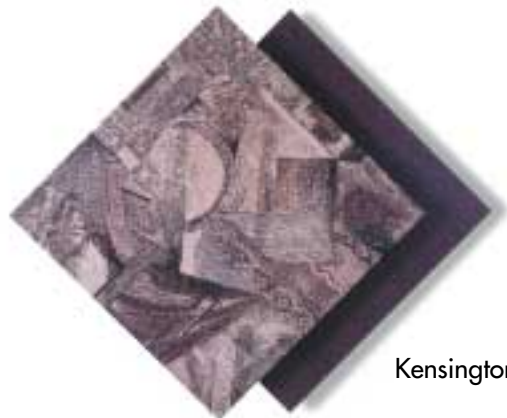

Kensington

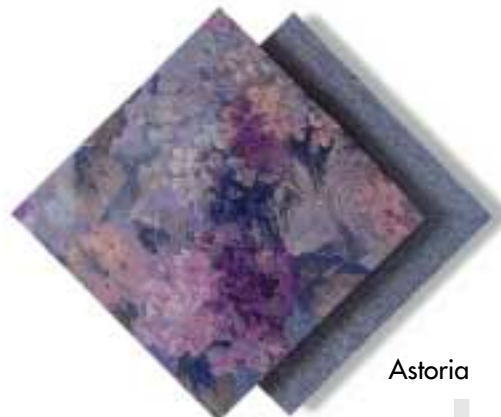

Astoria



Light Oak
(standard)

Maple
(optional)

PAINT



Desert Gold



Aspen



Aqua Marine

FLOOR PLANS

MODEL 341

Chassis	Ford
Wheelbase (in.)	228
GVWR (lbs.)	20,500
GCWR (lbs.)	26,000
Overall length	36'6"
Overall width	100"
Overall height with A/C	11'7"
Fresh water system (appx. gal.)	100
Grey water (appx. gal.)	50
Black water (appx. gal.)	50
LP (lbs.)	105
Sleeping capacity	4

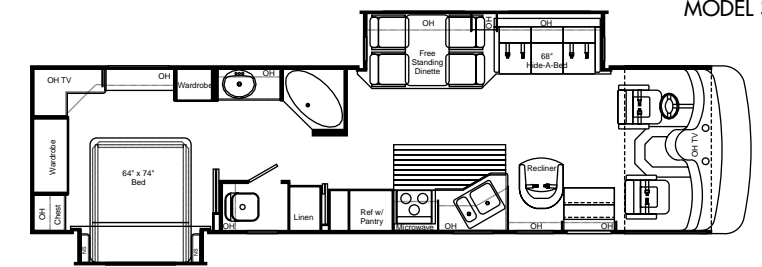

Slideout living area • Freestanding dinette • Slideout bedroom

MODEL 341

MODEL 349

Chassis	Ford
Wheelbase (in.)	228
GVWR (lbs.)	20,500
GCWR (lbs.)	26,000
Overall length	36'6"
Overall width	100"
Overall height with A/C	11'7"
Fresh water system (appx. gal.)	100
Grey water (appx. gal.)	50
Black water (appx. gal.)	50
LP (lbs.)	105
Sleeping capacity	4

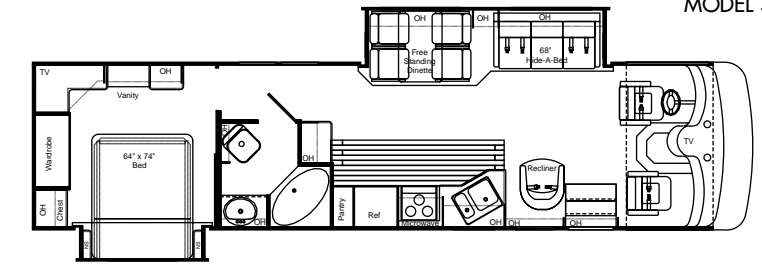

Slideout living area • Freestanding dinette • Slideout bedroom

MODEL 349

MODEL 350

Chassis	Ford
Wheelbase (in.)	228
GVWR (lbs.)	20,500
GCWR (lbs.)	26,000
Overall length	36'6"
Overall width	100"
Overall height with A/C	11'7"
Fresh water system (appx. gal.)	100
Grey water (appx. gal.)	50
Black water (appx. gal.)	50
LP (lbs.)	105
Sleeping capacity	4

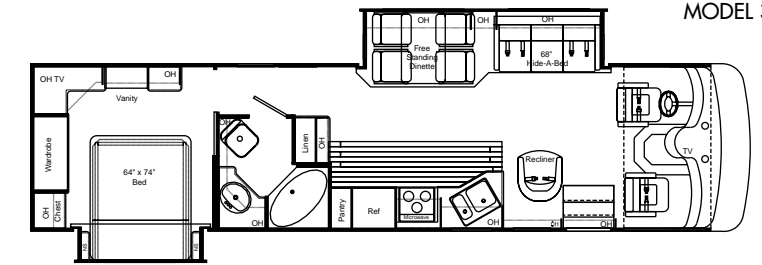

Slideout living area • Freestanding dinette • Slideout bedroom
• Washer/dryer hookup

MODEL 350

MODEL 351

Chassis	Ford
Wheelbase (in.)	228
GVWR (lbs.)	20,500
GCWR (lbs.)	26,000
Overall length	36'6"
Overall width	100"
Overall height with A/C	11'7"
Fresh water system (appx. gal.)	100
Grey water (appx. gal.)	50
Black water (appx. gal.)	50
LP (lbs.)	105
Sleeping capacity	4

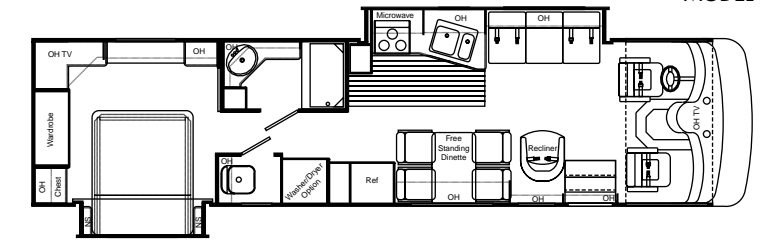

Slideout kitchen • Freestanding dinette • Slideout bedroom
• Washer/dryer hookup

MODEL 351

MODEL 359

Chassis	Ford
Wheelbase (in.)	228
GVWR (lbs.)	20,500
GCWR (lbs.)	26,000
Overall length	36'6"
Overall width	100"
Overall height with A/C	11'7"
Fresh water system (appx. gal.)	100
Grey water (appx. gal.)	50
Black water (appx. gal.)	50
LP (lbs.)	105
Sleeping capacity	4

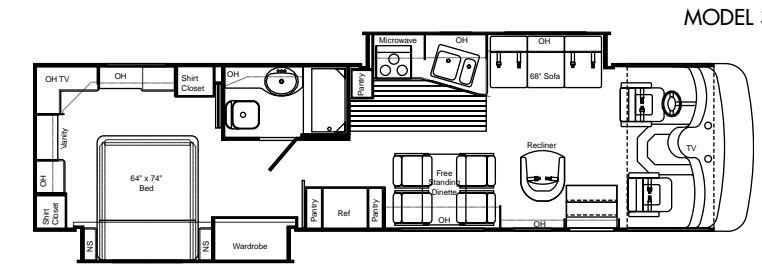

Slideout kitchen • Freestanding dinette • Slideout bedroom and wardrobe

MODEL 359

Options:



Booth Dinette Option
Deletes Standard Free-Standing Dinette

Models available:
341, 349, 350



Optional Booth Dinette
Deletes Standard Free-Standing Dinette

Models available:
351, 359

SPECIFICATIONS

Intruder Exterior	341	349	350	351	359
Gelcoat fiberglass walls	S	S	S	S	S
Aerodynamic front fiberglass cap	S	S	S	S	S
Aerodynamic rear fiberglass cap	S	S	S	S	S
Contoured front and rear integrated bumpers	S	S	S	S	S
Paint package	S	S	S	S	S
Fog lights	S	S	S	S	S
Two porch lights	S	S	S	S	S
White-trimmed, radius top entrance door	S	S	S	S	S
Entry-assist lighted grab handle	S	S	S	S	S
Awning rail	S	S	S	S	S
Side-mounted patio awning*	S	S	S	S	S
Side-mounted awning over slideout	S	S	S	S	S
Carefree electric patio awning	O	O	O	O	O
Full basement pass-through storage	S	S	S	S	S
Easy to clean, lighted, rotocast storage compartments	S	S	S	S	S
Locking exterior storage doors	S	S	S	S	S
Gas pistons on exterior storage doors	S	S	S	S	S
Radius-cornered domed roof	S	S	S	S	S
Roof vents	S	S	S	S	S
Roof ladder	S	S	S	S	S
Rubber roof	S	S	S	S	S
White-framed radius corner windows	S	S	S	S	S
Dual pane windows	O	O	O	O	O
Wide-body design	S	S	S	S	S

* Awnings not available on wide-body models in some locations. Check local regulations for applicable laws.

Intruder Kitchen	341	349	350	351	359
Booth dinette with padded top and wood-edge table	O	O	O	O	O
Freestanding dinette with 4 chairs	S	S	S	S	S
Refrigerator: large double-door	S	S	S	S	S
Refrigerator: solid wood front*	S	S	S	S	S
Refrigerator: ice maker in large double-door	O	O	O	O	O
Refrigerator: side-by-side with ice maker IPO standard refrigerator and pantry	O	O	O	O	O
Pantry	S	S	S	S	S
3-burner range and oven	S	S	S	S	S
Folding range cover with solid-surface accents	S	S	S	S	S
Lighted power range hood and monitor panel with LPG readout	S	S	S	S	S
Microwave oven	S	S	S	S	S
Microwave/convection oven	O	O	O	O	O
Double-bowl sink with oversized dish bowl	S	S	S	S	S
Single-lever faucet with sprayer	S	S	S	S	S
Two solid-surface sink covers	S	S	S	S	S
Solid-surface countertops	S	S	S	S	S
Solid wood cabinet doors throughout*	S	S	S	S	S
Wood-plank flooring*	S	S	S	S	S
Fantastic® power vent	O	O	O	O	O
Wallpaper border	S	S	S	S	S
Mini blind	S	S	S	S	S
Fire extinguisher	S	S	S	S	S

* Oak or maple

Intruder Utilities	341	349	350	351	359
Air conditioner: 13,500-BTU ducted central (front)	S	S	S	S	S
Air conditioner: 15,000-BTU ducted central upgrade (front) (N/A with solar battery charger)	O	O	O	O	O
Air conditioner: 11,000-BTU ducted central (rear)	S	S	S	S	S
Generator: Onan® Marquis Gold 5.5 kW	S	S	S	S	S
Generator: Onan® Marquis Gold 7.0 kW	O	O	O	O	O
5-watt chassis solar battery charger (N/A with 15,000-BTU A/C)	O	O	O	O	O
Electronic battery distribution center	S	S	S	S	S
Battery disconnect	S	S	S	S	S
Dual 6-volt auxiliary batteries	S	S	S	S	S
Exterior GFCI receptacle	S	S	S	S	S
Exterior shower	S	S	S	S	S
Cable TV/satellite hookup	S	S	S	S	S
Pre-wire for roof-mounted satellite dish	S	S	S	S	S
DSS manual satellite	O	O	O	O	O
Telephone hookup	S	S	S	S	S
Water filtration system	O	O	O	O	O
City water hookup	S	S	S	S	S
6-gallon gas/electric water heater	S	S	S	S	S
Enclosed heated potable and holding tanks	S	S	S	S	S
Blackwater tank flush	S	S	S	S	S
Water heater bypass kit	S	S	S	S	S
Washer/dryer prep	N/A	N/A	O	O	N/A
Washer/dryer combo	N/A	N/A	O	O	N/A
12-volt demand water pump	S	S	S	S	S
50-AMP, 120-volt service	S	S	S	S	S
50-AMP, 120-volt detachable power cord	S	S	S	S	S
55-AMP, 12-volt power converter	S	S	S	S	S
35,000-BTU — electronic ignition floor ducted furnace	S	S	S	S	S
400-watt entertainment inverter	O	O	O	O	O
Carbon monoxide detector	S	S	S	S	S
LP gas detector	S	S	S	S	S
Smoke detector	S	S	S	S	S

Intruder Living Area	341	349	350	351	359
19" color TV with full-function remote in front overhead with antenna, booster and jacks	S	S	S	S	S
Video package (VCR and control center)	S	S	S	S	S
Extra-large cloth recliner with footrest	S	S	S	S	S
Extra-large ultra-leather recliner with footrest	O	O	O	O	O
Hide-a-bed	S	S	S	N/A	N/A
Sofa bed	N/A	N/A	N/A	S	S
Day/night shades	S	S	S	S	S
Fabric ceiling	S	S	S	S	S
Decorator wall vinyl	S	S	S	S	S
Decorator clock and mirror	S	S	S	S	S
Aisle lights	S	S	S	S	S
100% nylon carpeting with stain treatment and padding	S	S	S	S	S

S = Standard O = Optional N/A = Not Available IPO = "In place of"

SPECIFICATIONS

Intruder Chassis	341	349	350	351	359
Radial tires	S	S	S	S	S
Stainless steel wheel liners	S	S	S	S	S
Spare tire	S	S	S	S	S
Front and rear mud flaps	S	S	S	S	S
Trailer hitch (3,500 lbs.)	S	S	S	S	S
Leveling jacks	S	S	S	S	S
4-speed auto transmission with overdrive	S	S	S	S	S
Emergency start circuit	S	S	S	S	S
Under-hood light	S	S	S	S	S
Layer of neoprene vibration dampener	S	S	S	S	S

Intruder Bedroom	341	349	350	351	359
Bedspread	S	S	S	S	S
Rear wardrobe with side bed	S	S	S	S	N/A
Pillow-top mattress	S	S	S	S	S
Day/night shades	S	S	S	S	S
Jalousie windows	S	S	S	S	S
Lined wardrobe with mirrored doors	S	S	S	S	S
Wardrobe lights	S	S	S	S	S
AM/FM stereo	O	O	O	O	O
TV area with jack	S	S	S	S	S
19" TV	S	S	S	S	S

Intruder Bathroom	341	349	350	351	359
Power vent	S	S	S	S	S
Full-height fiberglass tub or shower with door	S	S	S	S	S
Skylight in tub/shower	S	S	S	S	S
Medicine cabinet with solid wood door and mirror	S	S	S	S	S
Foot-flush porcelain toilet with sprayer	S	S	S	S	S
Wallpaper border	S	S	S	S	S

S = Standard O = Optional N/A = Not Available

Intruder Cockpit	341	349	350	351	359
Molded ABS dash	S	S	S	S	S
Burl instrument panel	S	S	S	S	S
Full instrumentation	S	S	S	S	S
Cruise control	S	S	S	S	S
Power steering	S	S	S	S	S
Tilt steering wheel	S	S	S	S	S
Electric trumpet horns	O	O	O	O	O
Dash fans	S	S	S	S	S
Electronically controlled dash air conditioning	S	S	S	S	S
Tinted wraparound windshield	S	S	S	S	S
Windshield privacy drape	S	S	S	S	S
Protector® sun visors (pair)	S	S	S	S	S
Driver's door with power window	O	O	O	O	O
Storage above driver/passenger window	S	S	S	S	S
Forward-mount power mirrors	S	S	S	S	S
Back-up monitor system	O	O	O	O	O
Reclining swivel captain's chairs	S	S	S	S	S
Ultra-leather captain's chairs (set of two)	O	O	O	O	O
Power 6-way seat (driver only)	O	O	O	O	O
3-point, wall-mounted seatbelts	S	S	S	S	S
Floor mats	S	S	S	S	S
Map lights	S	S	S	S	S
Drink tray	S	S	S	S	S
4-speaker sound	S	S	S	S	S
AM/FM/cassette upgrade stereo	S	S	S	S	S
AM/FM/cassette with 10-disc CD changer	O	O	O	O	O

Intruder Entry	341	349	350	351	359
Electric entrance step	S	S	S	S	S
Integrated entrance step	S	S	S	S	S
Storage in stairwell	S	S	S	S	S
Battery access in stairwell	S	S	S	S	S
Interior entry-assist handle	S	S	S	S	S
Deadbolt door lock	S	S	S	S	S

MORE DAMON VALUE



Battery access in step



Trumpet horns



Standard pillowtop mattress



5.5 kW Onan generator



Pre-wired for satellite dish



Six-way power driver's seat

Damon
Value by Design®

DAMON® INTRUDER™ MOTORHOME FOR 2001



Your Intruder dealer:

Due to constant product improvements, the specifications, component parts and standard/optional equipment are subject to change without notice or obligation. Product photography or diagrams may show equipment that is optional. Damon Corporation reserves the right to make changes in prices and models and to discontinue models without notice or obligation. Components, parts or chassis may have been manufactured at times other than the model year indicated. All capacities are approximate and dimensions are nominal. All dry weights are based on standard model features and do not include optional features or equipment. Various RV components and features may differ to conform to local codes.

DC 10/00
© 2000 Damon Corporation
Printed in U.S.A.

Damon Corporation • P.O. Box 2888 • Elkhart, IN 46515
219-389-0179 • 800-577-5692 www.DamonRV.com