

ESCAPE THE ORDINARY ...  
FOR A SONG.

2 0 0 1 E S C A P E R

Maybe it's that dream vacation you've been putting off. Or maybe you and your spouse are finally ready for fulltime travel. Whatever the reason, whatever the goal, this is the year you make your getaway. And nothing will "get you gone" as fast as a 2001 Escaper™ Diesel Motorhome.

For starters, it's priced to go. Damon's long manufacturing experience has taught the company how to build for value and pass the savings on. Result? You get a gorgeous, luxuriously appointed RV that often surpasses those costing \$60,000 to \$100,000 more than Escaper. This is luxury that'll make you lightheaded — but won't unduly lighten your wallet.

Powerful engine and chassis combinations put the "escape" in Escaper. Damon gives you a wide choice, too: Depending on the model, you can get a 330-hp Caterpillar® diesel engine with 860 foot-pounds of torque on a Freightliner® chassis ... a 330-hp Cummins® diesel engine with 950 foot-pounds of torque on a Spartan® Mountain Master chassis ... or 350-hp Cummins diesel engine with 1,050 foot-pounds of torque on a Spartan Mountain Master chassis.

- Escaper's road performance is exceptional, thanks to a 6-speed Allison® transmission, full air brakes with antilock technology, air-ride suspension and a Jacobs® exhaust brake.
- A custom-designed front entrance door makes it easier to get into and out of the coach than a conventional cab door.
- An electric rear-view monitor system helps you back up safely and easily.
- A raised-rail chassis permits roomy, easily accessible underfloor storage.
- Escaper's aluminum-alloy Alcoa® wheels resist the corrosive effects of the elements and retain their bright lustre for years.
- A space-adding slideout gives you more freedom to move about and to stretch out and relax inside.





Model 3970 • Park Avenue decor • Light Oak

- A unique StepSaver® kitchen puts everything well within reach to make meal preparation quick and easy. You'll especially like the standard full pantry (which is not available if you elect to purchase the optional side-by-side, icemaker refrigerator).
- Fabric-lined overhead cabinets reduce interior noise during travel.
- Hardwood plank flooring, standard, lends beauty and functionality to the kitchen and bath areas. Hand-laid tile or linoleum flooring are options.
- Escaper provides an incredible amount of storage space — including a massive pass-through basement storage compartment.



A MOVEABLE FEAST

2001 ESCAPER

Model 3970 • Park Avenue decor • Light Oak



## A SOFT REPOSE



- If it's uncommon comfort you're after, you'll want to option the extra-wide, ultra-leather J-lounger.
- For your entertainment, Escaper has an exceptional Masterworks® audio system with four speakers, a subwoofer and a 400-watt inverter.
- An optional Web TV Internet unit by Phillips Magnavox® lets you "surf the net with your TV set." Web TV Plus service also lets you send and receive e-mail and get stock quotes, news stories, local weather, sports scores and more right from your TV. Other features include seven days of onscreen interactive TV listings, one-touch VCR programming that easily lets you record your favorite programs and WebPIP, which lets you watch TV and surf the Internet at the same time.

- With Escaper's optional VA70 Real-Time Global Positioning System (GPS), you can plan a trip, then instantly see where you are and get voice-prompts on where to go. The system includes a 7" Panasonic® liquid-crystal, color display monitor, changeable road-map CDs, an 8-disc CD changer, a radio with 10 presets and a built-in color backup monitor.
- You'll take comfort in knowing your 2001 Escaper has passed a strenuous 400-point inspection test as part of Damon's StartRight Quality Assurance™ program.
- Escaper also gives you the benefits of Damon's exclusive Total Quality Service® (TQS) initiative. Ask your dealer for details.

Model 3970 • Boardwalk decor • Light Oak

## ESCAPER VALUE ALL AROUND



- Custom-designed front entrance door
- 6.3 kW Onan® LP generator, standard
- Large, front-mounted bus-style sideview mirrors



- 330 HP engine standard – 3970, 3980  
350 HP engine standard – 3979, 3989
- Full air-ride, air-brake chassis with an antilock system
- A backup monitor, standard



- Alcoa® aluminum-alloy wheels
- Awning, standard
- Solar-charged chassis battery



- HWH leveling jacks, standard
- Easy-turn, 50° cramp angle
- Hadley® air horns — a distinctive sound



- Additional awning over slideout
- Smooth rack and pinion, slideout operation



- Raised-rail, full-basement pass-through compartment
- Lighted storage bays
- Automotive, bulb-style door seals

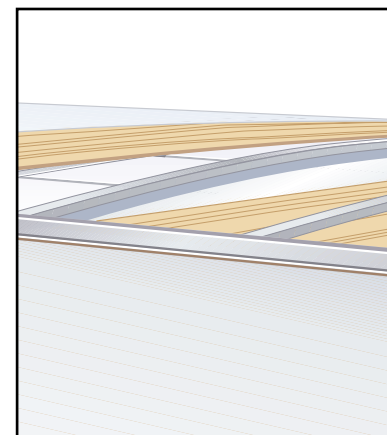

- ABS-ducted air conditioning with unblocked plenums
- Aluminum-frame crowned roof with beaded block-foam insulation
- Residential-styled ceiling

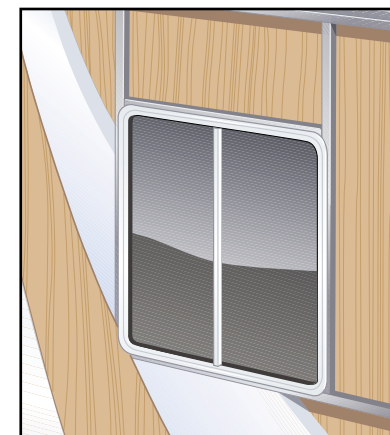

- Aluminum-framed walls and openings
- Vacuum-bonded with beaded block-foam insulation
- White powdercoated window frames

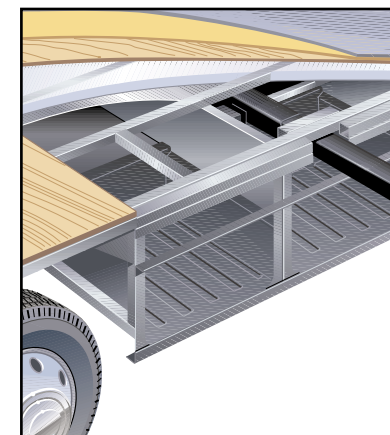

- Steel firewall and steel basement truss structure system
- Insulated floor system with structure-wood and beaded block-foam insulation
- Heated tank area with insulated doors



## DECOR



Boardwalk



City Lights



Park Avenue



White Diamond



Light Oak  
(standard)



Maple  
(optional)

## PAINT



Taupe Frost



Steel Blue



Glacier Green

## FLOOR PLANS

### MODEL 3970

Chassis	Spartan/Freightliner
Wheelbase (in.)	242/242
GVWR (lbs.)	27,400/27,910
GCWR (lbs.)	37,400/32,910
Overall length	39'2"
Overall width	100"
Overall height with A/C	12'6"
Fresh water system (appx. gal.)	100
Grey water (appx. gal.)	50
Black water (appx. gal.)	50
LP (lbs.)	128
Sleeping capacity	4

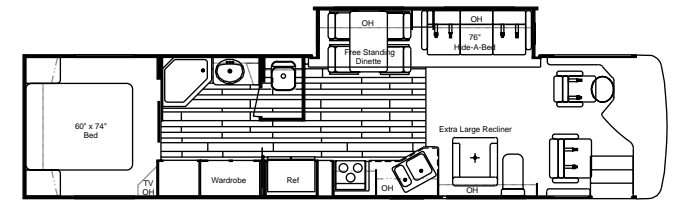

MODEL 3970

Slideout living area • Freestanding dinette • Neo-angle shower • Washer/dryer hookup

### MODEL 3979

Chassis	Spartan
Wheelbase (in.)	242
GVWR (lbs.)	31,000
GCWR (lbs.)	37,400
Overall length	39'2"
Overall width	100"
Overall height with A/C	12'6"
Fresh water system (appx. gal.)	100
Grey water (appx. gal.)	50
Black water (appx. gal.)	50
LP (lbs.)	128
Sleeping capacity	4

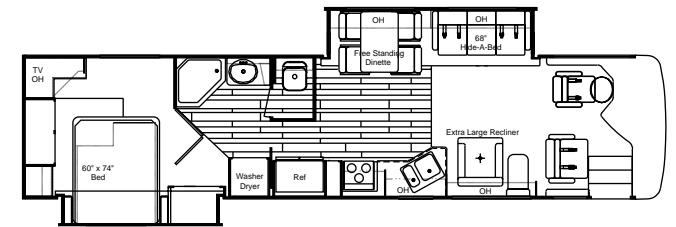

MODEL 3979

Slideout living area • Freestanding dinette • Neo-angle shower • Washer/dryer hookup

### MODEL 3980

Chassis	Spartan/Freightliner
Wheelbase (in.)	242/242
GVWR (lbs.)	27,400/27,910
GCWR (lbs.)	37,400/32,910
Overall length	39'2"
Overall width	100"
Overall height with A/C	12'6"
Fresh water system (appx. gal.)	100
Grey water (appx. gal.)	50
Black water (appx. gal.)	50
LP (lbs.)	128
Sleeping capacity	4

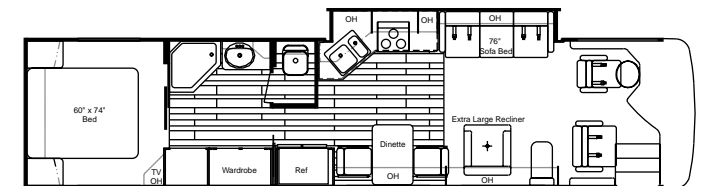

MODEL 3980

Slideout kitchen • Freestanding dinette • Neo-angle shower • Washer/dryer hookup

### MODEL 3989

Chassis	Spartan
Wheelbase (in.)	242
GVWR (lbs.)	31,000
GCWR (lbs.)	37,400
Overall length	39'2"
Overall width	100"
Overall height with A/C	12'6"
Fresh water system (appx. gal.)	100
Grey water (appx. gal.)	50
Black water (appx. gal.)	50
LP (lbs.)	128
Sleeping capacity	4

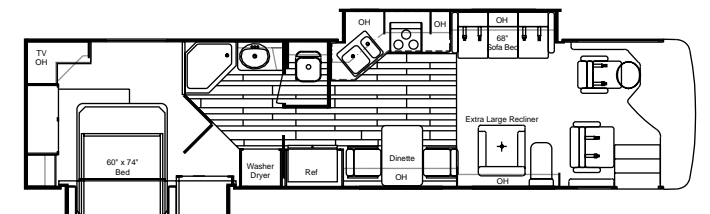

MODEL 3989

Slideout kitchen • Freestanding dinette • Neo-angle shower • Washer/dryer hookup

Options:

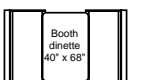
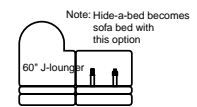
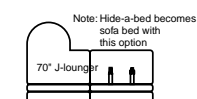

Models available:

3970, 3980

3979, 3989

3970, 3979





SPECIFICATIONS

Escaper Living Area	3970	3979	3980	3989
Hide-a-bed: cloth (N/A with J-lounger)	S	S	N/A	N/A
Hide-a-bed: ultra-leather (N/A with J-lounger)	O	O	N/A	N/A
Sofa bed: cloth*	O	O	S	S
Sofa bed: ultra-leather*	O	O	O	O
J-lounger: cloth**	O	O	O	O
J-lounger: ultra-leather**	O	O	O	O
J-lounger with recliner: cloth**	O	O	O	O
J-lounger recliner ultra-leather**	O	O	O	O
Extra large recliner with footrest: cloth	S	S	S	S
Extra large recliner with footrest: ultra-leather	O	O	O	O
Lounge table (N/A with J-lounger)***	S	S	S	S
Day/night shades	S	S	S	S
19" color TV with remote, antenna, booster and jack	S	S	S	S
Video package (control center & VCR)	S	S	S	S
DSS satellite prep	S	S	S	S
Web TV with internet access	O	O	O	O
Masterworks® audio with theater TV/VCR sound	S	S	S	S
AM/FM/CD stereo with CD changer	S	S	S	S
Fantastic® vent	S	S	S	S
Fluorescent lighting	S	S	S	S
100% continuous-filament nylon carpeting with carved insert	S	S	S	S
Wood molding accent over slideout room	S	S	S	S

- \* Sofa bed must replace hide-a-bed in units with a J-lounger  
\*\* Not available with hide-a-bed  
\*\*\* Oak or maple

Escaper Kitchen	3970	3979	3980	3989
Freestanding dinette with 4 chairs	S	S	N/A	N/A
Freestanding dinette with 2 chairs	N/A	N/A	S	S
2 folding dining chairs	O	O	O	O
Booth dinette	O	O	N/A	N/A
Refrigerator: large double-door with solid wood front*	S	S	S	S
Refrigerator: side-by-side with ice maker	O	O	O	O
Full pantry (N/A with side-by-side refrigerator)	S	S	S	S
3-burner range and oven	S	S	S	S
Folding range cover with solid surface accent	S	S	S	S
Cooktop IPO range and oven	O	O	O	O
Microwave/convection oven	S	S	S	S
Solid-surface countertops	S	S	S	S
Solid-surface, double-bowl kitchen sink	S	S	S	S
Two solid-surface sink covers	S	S	S	S
Single-lever faucet with sprayer	S	S	S	S
Raised panel hardwood cabinet doors throughout*	S	S	S	S
Lined overhead cabinets	S	S	S	S
Wood-plank flooring package* (kitchen and bath)	S	S	S	S
Linoleum flooring package (kitchen and bath)	O	O	O	O
Hand-laid tile flooring package (kitchen and bath)	O	O	O	O
Fire extinguisher	S	S	S	S
Wall-mounted monitor panel with LPG readout	S	S	S	S
Micro mini blind	S	S	S	S

\* Oak or maple

Escaper Entry	3970	3979	3980	3989
Electric entrance step	S	S	S	S
Entry assist handle	S	S	S	S
Dead-bolt door lock	S	S	S	S
Remote keyless entry	S	S	S	S

Escaper Chassis	3970	3979	3980	3989
Raised rail chassis	S	S	S	S
350 HP Cummins® engine with 1050 ft. lb. torque on a Spartan chassis	N/A	S	N/A	S
330 HP Cummins® engine with 950 ft. lb. torque on a Spartan chassis	S	N/A	S	N/A
330 HP Caterpillar® engine with 860 ft. lb. torque on a Freightliner® chassis	O	N/A	O	N/A
Allison® MH-3000 automatic transmission — 6-speed	S	S	S	S
Air suspension system	S	S	S	S
Independent front suspension (Spartan only)	S	S	S	S
Full air brakes with auto slack adjusters front and rear	S	S	S	S
Wabco® antilock brakes	S	S	S	S
Jacobs® exhaust brakes	S	S	S	S
Bilstein® shock absorbers front and rear	S	S	S	S
22.5" radial tires	S	S	S	S
Mud flaps — front and rear	S	S	S	S
Alcoa® wheels	S	S	S	S
Dual fuel fills	S	S	S	S
Trailer hitch (5,000 lbs.)	S	S	S	S
Hadley® air horns	S	S	S	S
Leece Neville® 160-amp, 12-volt alternator	S	S	S	S
In-block engine heater	S	S	S	S
Midland® Pure-Air-Plus™ heated air dryer	S	S	S	S

Escaper Cockpit	3970	3979	3980	3989
Driver's seat: ultra-leather, 8-way power	S	S	S	S
Passenger seat: ultra-leather, buddy-style 8-way power	S	S	S	S
3-point integrated seat and shoulder belts	S	S	S	S
Molded ABS dash	S	S	S	S
Burl instrument panel	S	S	S	S
Full instrumentation	S	S	S	S
Electronic cruise control	S	S	S	S
Power steering	S	S	S	S
Padded VIP steering wheel	S	S	S	S
Douglas® tilt/telescoping steering column	S	S	S	S
Dash fans	S	S	S	S
Tinted wrap-around windshield	S	S	S	S
Windshield privacy wrap	S	S	S	S
Rosen® full-size sun visors	S	S	S	S
Back-up monitor system	S	S	S	S
Map lights	S	S	S	S
Floor mats	S	S	S	S
Power flush-floor stepwell cover	S	S	S	S
400-watt entertainment inverter	S	S	S	S
Second generation automotive-style wiring harness	S	S	S	S
VA70 GPS/audio with monitor	O	O	O	O

Escaper Bedroom	3970	3979	3980	3989
Pillowtop sleep-well mattress (60" X 74")	S	S	S	S
Bedspread with pillow shams and toss pillows	S	S	S	S
Diamond-beveled mirror with designer headboard	S	S	S	S
TV cabinet and jack	S	S	S	S
13" color TV	S	S	S	S
Pin-up lights	S	S	S	S
Wardrobe lights	S	S	S	S
Carpet-lined wardrobe with mirrored front	S	S	S	S
AM/FM stereo	S	S	S	S
Micro mini blinds	S	S	S	S
Boxed window treatments	S	S	S	S

S = Standard      O = Optional      N/A = Not Available

SPECIFICATIONS

Escaper Utilities	3970	3979	3980	3989
Air conditioner: 13,500-BTU ducted central front and rear	S	S	S	S
Air conditioner: low profile (N/A with 5-watt solar panel)	O	O	O	O
35,000-BTU electronic ignition floor-ducted furnace	S	S	S	S
6.3 kW Onan® LP generator	S	S	S	S
7.5 kW Onan® QD diesel generator	O	O	O	O
5-watt chassis solar battery charger (N/A with low profile A/C or heat pump)	S	S	S	S
Heat pump with 15,000-BTU A/C and 12,700-BTU heat	O	O	O	O
Battery disconnect	S	S	S	S
Dual 6-volt auxiliary batteries	S	S	S	S
Thermail batteries, house	S	S	S	S
60-watt solar panel for house batteries	O	O	O	O
Exterior GFCI receptacle	S	S	S	S
Cable TV hookup	S	S	S	S
DSS manual satellite	O	O	O	O
Telephone hookup	S	S	S	S
City water hookup	S	S	S	S
Exterior shower	S	S	S	S
12-volt demand water pump	S	S	S	S
Water heater bypass kit	S	S	S	S
10-gallon gas/electric water heater	S	S	S	S
Enclosed heated potable and holding tanks	S	S	S	S
Blackwater tank flush	S	S	S	S
Washer/dryer prep	S	S	S	S
Washer/dryer combo	O	O	O	O
50-amp, 120-volt service	S	S	S	S
50-amp, 120-volt detachable power cord	S	S	S	S
55-amp, 12-volt power converter	S	S	S	S
2000-watt inverter with extra batteries	O	O	O	O
Carbon monoxide detector	S	S	S	S
LP gas detector	S	S	S	S
Smoke detector	S	S	S	S

S = Standard      O = Optional      N/A = Not Available

Escaper Exterior	3970	3979	3980	3989
Molded and gelcoated fiberglass sidewalls	S	S	S	S
Aerodynamic front fiberglass cap	S	S	S	S
Aerodynamic rear fiberglass cap	S	S	S	S
Paint and graphics	S	S	S	S
Radius corner domed roof	S	S	S	S
Rubber roof	S	S	S	S
Roof vents	S	S	S	S
Leveling jacks	S	S	S	S
Large, white-trimmed windows	S	S	S	S
Dual pane windows	O	O	O	O
Awning rail	S	S	S	S
Side-mount awning over slideout	S	S	S	S
Side-mount front door awning	O	O	O	O
A&E® patio awning*	O	O	O	O
Carefree® electric patio awning*	O	O	O	O
Remote control for Carefree® electric patio awning*	O	O	O	O
Bus-style front-mounted power mirrors	S	S	S	S
Custom-designed front entry door with screen	S	S	S	S
Exterior entertainment center	O	O	O	O
Under-hood light	S	S	S	S
Pass-through basement storage	S	S	S	S
Easy-slide storage tray in basement	O	O	O	O
Gas pistons on exterior storage doors	S	S	S	S
Lighted storage compartments	S	S	S	S
Locking exterior storage compartments	S	S	S	S
Sewer hose storage	S	S	S	S
Rear ladder	O	O	O	O
Porch lights on street and curb side	S	S	S	S
Fog lights	S	S	S	S

\* Awnings not available on wide body models in some locations.  
Check local regulations for applicable laws.

Escaper Bathroom	3970	3979	3980	3989
Solid-surface countertop	S	S	S	S
Power vent	S	S	S	S
Porcelain toilet with sprayer	S	S	S	S
Solid-surface sink	S	S	S	S
Shower with easy-clean surround	S	S	S	S
Bathroom skylight	S	S	S	S
Medicine cabinet with mirrored hardwood framed door	S	S	S	S
Wallpaper border	S	S	S	S

DAMON VALUES



Backup monitor



Web TV, optional



Tile floor, optional



Fluorescent lighting



Pre-wired for satellite dish



GPS/audio with monitor, optional



**DAMON® ESCAPER™ MOTORHOME FOR 2001**



Your Escaper dealer:

Due to constant product improvements, the specifications, component parts and standard/optional equipment are subject to change without notice or obligation. Product photography or diagrams may show equipment that is optional. Damon Corporation reserves the right to make changes in prices and models and to discontinue model without notice or obligation. Components, parts or chassis may have been manufactured at times other than the model year indicated. All capacities are approximate and dimensions are nominal. All dry weights are based on standard model features and do not include optional features or equipment. Various RV components and features may differ to conform to local codes.

DC 10/00  
© 2000 Damon Corporation  
Printed in U.S.A.