

GREET THE DAWN OF A
WHOLE NEW RV EXPERIENCE.

2001 DAYBREAK

You've been dying for a full-size, honest-to-goodness motorhome. But the prices? Yikes! Unless you go for "entry level." And then, what do you get? Some stripped-down, "bare necessities only" RV? That's the norm. But Damon breaks it ... with DayBreak™.

Here you have a richly appointed, full-size, wide-body motorhome that sells for a mini motorhome's price. No kidding! Damon can do it, because it has the experience and know-how to keep manufacturing costs low. And that lets them pass the savings on to you — with no sacrifices in style or comfort.

Yes, the 2001 DayBreak is an entry-level motorhome. But you can't tell by looking at it. It's stunning. And its range of amenities goes well beyond what other, similarly priced motorhomes offer. Why keep ondreaming about the ideal RV? Wake up to the pleasure of DayBreak.

- Exterior storage is easy to get at — much more so than with similarly priced Class C motorhomes.
- Ceiling-ducted air conditioning does a better job of cooling the coach and is up, out of the way of cabinets. Wall-mounted thermostatic control is optional.
- DayBreak's light weight and superb road handling are largely the result of its aluminum framing.
- For a more rigid and durable coach, DayBreak has 2" floor construction and thick sidewalls with 1½" polystyrene block-foam insulation.
- Fully enclosed and heated holding tanks enable camping year-round or in cooler climates.
- For added convenience, consider equipping your DayBreak with an optional driver's side door.
- The optional electric entrance step is easy to get out of the way when not in use.



Model 3270 • Harmony decor • Light Oak



A MOVEABLE FEAST

2001 DAYBREAK

- For your entertainment, DayBreak offers an AM/FM/cassette/CD player and, standard in the front overhead, a 19" color TV with full-function remote, an antenna booster and a jack.
- DayBreak's unique StepSaver™ kitchen puts everything well within reach to make meal preparation quick and easy.
- Cabinet doors are made of solid wood for added durability and a richer look.
- Hardwood plank flooring lends beauty and functionality to the kitchen area.
- DayBreak provides an incredible amount of storage space — inside and out.

Model 3270 • Harmony decor • Light Oak

A SOFT REPOSE

2001 DAYBREAK



- The master bedroom is a marvel of comfort with its queen-size bed, designer bedspread with a matching headboard and matching window treatments, and abundant cabinets (including a convenient nightstand shelf that slides out of the way when not needed).

- You'll take comfort in knowing your 2001 DayBreak has passed a strenuous 400-point inspection test as part of Damon's StartRight Quality Assurance™ program.
- DayBreak also gives you the benefits of Damon's exclusive Total Quality Service™ (TQS) initiative. Ask your dealer for details.

Model 3280 • Melody decor • Light Oak

DAYBREAK VALUE ALL AROUND



- Aerodynamic styling
- Easy-access engine
- Large windshield with pantographic wipers



- Lower wheelbase taper
- 3,500 lb. hitch, standard
- Sleek, automotive styling



- Awning, standard
- Stainless steel wheel covers
- Jalousie windows



- Optional driver's door
- Optional exterior shower
- Dual arm windshield wipers



All slideout models include:

- Leveling jacks, standard
- Awning over slideout
- Smooth rack and pinion slideout operation



- Carpeted basement storage
- Lighted storage compartment
- Baggage doors insulated with thick foam

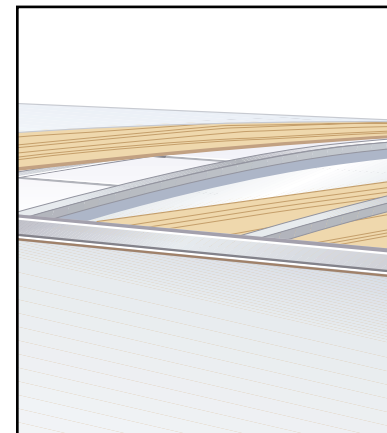

- ABS-ducted air conditioning with unblocked plenums
- Aluminum-frame crowned roof with beaded block-foam insulation
- Residential-styled ceiling

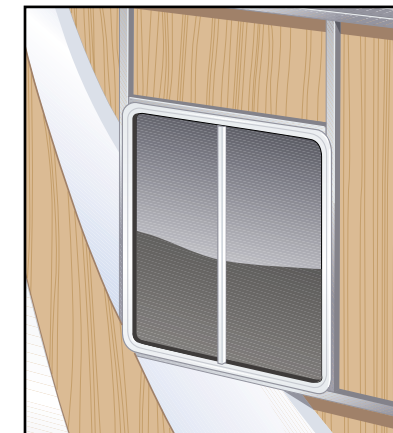

- Aluminum-framed walls and openings
- Vacuum-bonded walls with beaded block-foam insulation
- White powdercoated window frames

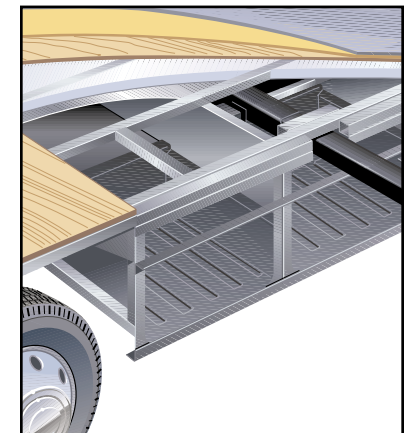

- Steel firewall and steel truss structure system
- Insulated floor system with structurewood and beaded block-foam insulation
- Heated tank area with insulated doors

DECOR



Jazz



Light Oak
(standard)



Maple
(optional)



Harmony



Melody

PAINT



Royal Blue



Aspen



Desert Gold



Laser

FLOOR PLANS

MODEL 2740

Chassis	Workhorse
Wheelbase (in.)	158.5
GVWR (lbs.)	15,000
GCWR (lbs.)	19,000
Overall length	29'7"
Overall width	100"
Overall height with A/C	11'3"
Fresh water system (appx. gal.)	38
Grey water (appx. gal.)	40
Black water (appx. gal.)	40
LP (lbs.)	82
Sleeping capacity	3

MODEL 2740

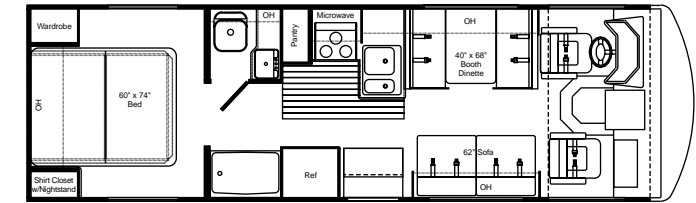

Booth dinette • Private toilet • Tub with surround

MODEL 2960

Chassis	Workhorse
Wheelbase (in.)	178
GVWR (lbs.)	15,000
GCWR (lbs.)	19,000
Overall length	31'3"
Overall width	100"
Overall height with A/C	11'3"
Fresh water system (appx. gal.)	56
Grey water (appx. gal.)	40
Black water (appx. gal.)	40
LP (lbs.)	82
Sleeping capacity	4

MODEL 2960

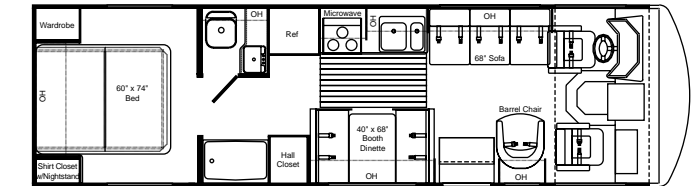

Booth dinette • Private toilet • Tub with surround

MODEL 3130

Chassis	Workhorse
Wheelbase (in.)	216.5
GVWR (lbs.)	17,000
GCWR (lbs.)	21,000
Overall length	33'4"
Overall width	100"
Overall height with A/C	11'3"
Fresh water system (appx. gal.)	56
Grey water (appx. gal.)	40
Black water (appx. gal.)	40
LP (lbs.)	82
Sleeping capacity	4

MODEL 3130

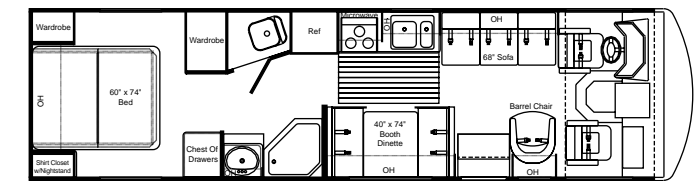

Booth dinette • Neo-angle shower • Private toilet

MODEL 3270

Chassis	Workhorse
Wheelbase (in.)	216.5
GVWR (lbs.)	17,000
GCWR (lbs.)	21,000
Overall length	34'10"
Overall width	100"
Overall height with A/C	11'3"
Fresh water system (appx. gal.)	56
Grey water (appx. gal.)	40
Black water (appx. gal.)	40
LP (lbs.)	82
Sleeping capacity	4

MODEL 3270

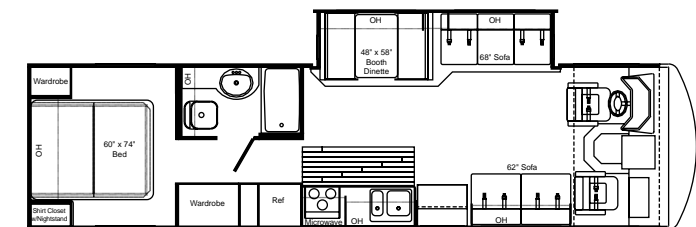

Slideout living area • Booth dinette • Tub with surround

MODEL 3280

Chassis	Workhorse
Wheelbase (in.)	208
GVWR (lbs.)	17,000
GCWR (lbs.)	21,000
Overall length	32'3"
Overall width	100"
Overall height with A/C	11'3"
Fresh water system (appx. gal.)	56
Grey water (appx. gal.)	40
Black water (appx. gal.)	40
LP (lbs.)	82
Sleeping capacity	4

MODEL 3280

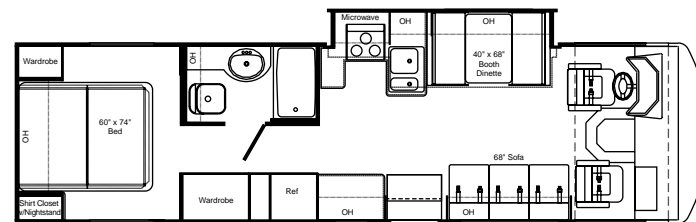

Slideout kitchen • Booth dinette • Tub with surround

Options:

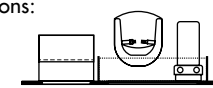

Optional Barrel Chair & Table
Deletes 62" Sofa
Models available: 3270

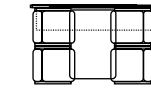

Optional Free Standing Table
Deletes 40" x 68" Booth Dinette
Models available: 3270, 3280

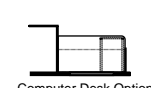

Computer Desk Option
Deletes Hutch Base Cabinet
Next to Ref
Models available: 3280

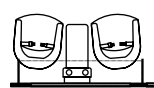

Barrel Chairs & Table Option
Deletes 68" Sofa
Models available: 3280



SPECIFICATIONS

DayBreak Exterior	2740	2960	3130	3270	3280
White smooth fiberglass exterior with deluxe graphics	S	S	S	S	S
Aerodynamic front fiberglass cap	S	S	S	S	S
Contoured, integrated front bumper	S	S	S	S	S
Automotive-style rear bumper	S	S	S	S	S
Wide-body design	S	S	S	S	S
Paint package	O	O	O	O	O
Laser stripe	O	O	O	O	O
Roof rack	O	O	O	O	O
Roof ladder	S	S	S	S	S
Roof vents	S	S	S	S	S
Rubber roof	S	S	S	S	S
Radius-cornered domed roof	S	S	S	S	S
Awning rail	S	S	S	S	S
Side-mounted patio awning*	S	S	S	S	S
Side-mounted awning over slideout	N/A	N/A	N/A	S	S
Entry-assist handrail	S	S	S	S	S
Locking exterior storage doors	S	S	S	S	S
White trimmed, radius-topped entrance door	S	S	S	S	S
White frame radius-corner windows	S	S	S	S	S
Dual pane windows	O	O	O	O	O
Porch light	S	S	S	S	S
Lined and lighted storage compartments	S	S	S	S	S
Pass-through storage compartment	S	S	S	S	S
Sewer hose storage	S	S	S	S	S

* Awnings not available on wide-body models in some locations. Check local regulations for applicable laws.

DayBreak Chassis	2740	2960	3130	3270	3280
Leveling jacks	O	O	O	S	S
Spare tire, wheel and bracket	O	O	O	O	O
Stainless steel wheel liners	O	O	O	O	O
Stainless steel wheel covers	S	S	S	S	S
4-speed auto transmission with overdrive	S	S	S	S	S
Front and rear mud flaps	S	S	S	S	S
Radial tires	S	S	S	S	S
Under-hood light	S	S	S	S	S
Trailer hitch (3,500 lbs.)	S	S	S	S	S
Emergency-start circuit	S	S	S	S	S

DayBreak Bedroom	2740	2960	3130	3270	3280
Innerspring mattress	S	S	S	S	S
Upgrade innerspring mattress	O	O	O	O	O
Bedsprad and headboard	S	S	S	S	S
TV area and jack	S	S	S	S	S
Jalousie windows	S	S	S	S	S
Roller shades with drapes	S	S	S	S	S
Mini blinds	O	O	O	O	O
Valance window treatments	S	S	S	S	S
Solid wood cabinet doors*	S	S	S	S	S
13" TV	O	O	O	O	O

* Oak or maple

DayBreak Utilities	2740	2960	3130	3270	3280
Air conditioner: 13,500-BTU ducted central (front)	S	S	S	S	S
Air conditioner: 11,000-BTU ducted central (rear)	O	O	O	O	O
Air conditioner: 15,000-BTU ducted central upgrade (front)	O	O	O	O	O
Wall-mount thermostatically controlled air conditioning	O	O	O	O	O
31,000-BTU electronic ignition floor-ducted furnace	S	S	S	S	S
Pre-wired for generator with auto changeover	S	S	S	S	S
Generator: Onan® 5.0 kW	O	O	O	O	O
Generator: Onan® 6.5 kW (requires 50-amp service)	O	O	O	O	O
Pre-wired for roof-mounted satellite dish	S	S	S	S	S
Cable TV/satellite hookup	S	S	S	S	S
DSS manual satellite	O	O	O	O	O
Battery disconnect	S	S	S	S	S
Electronic battery distribution center	S	S	S	S	S
Dual 6-volt auxiliary batteries	S	S	S	S	S
30-amp/120-volt service	S	S	S	S	S
50-amp/120-volt service	O	O	O	O	O
Solid-state 45-amp, 12-volt power converter	S	S	S	S	S
12-volt demand water pump	S	S	S	S	S
6-gallon gas water heater with electric ignition	S	S	S	S	S
Water heater bypass kit	S	S	S	S	S
Enclosed and heated holding tanks	S	S	S	S	S
City water hookup	S	S	S	S	S
Telephone hookup	S	S	S	S	S
Exterior shower	O	O	O	O	O
Exterior GFCI receptacle	S	S	S	S	S
Smoke detector	S	S	S	S	S
Carbon monoxide detector	S	S	S	S	S
LP gas detector	S	S	S	S	S

DayBreak Living Area	2740	2960	3130	3270	3280
Sofa bed	S	S	S	S	S
Hide-a-bed	N/A	N/A	N/A	O	N/A
One barrel chair and table	N/A	N/A	N/A	O	N/A
IPO sofa	N/A	N/A	N/A	N/A	O
Two barrel chairs IPO sofa	N/A	N/A	N/A	N/A	O
Computer desk IPO hutch	N/A	N/A	N/A	N/A	O
Decorator clock and mirror	S	S	S	S	S
Mini blinds	O	O	O	O	O
Roller shades with drapes	S	S	S	S	S
Valance window treatments	S	S	S	S	S
Video package (VCR and control center)	O	O	O	O	O
19" color TV with full-function remote in front overhead	S	S	S	S	S
TV antenna, booster and jack	S	S	S	S	S
Carpeting with pad	S	S	S	S	S

S = Standard O = Optional N/A = Not Available

IPO = "In place of"

SPECIFICATIONS

DayBreak Cockpit	2740	2960	3130	3270	3280
Burl instrument panel	S	S	S	S	S
Molded ABS dash	S	S	S	S	S
AM/FM cassette stereo	S	S	S	S	S
AM/FM cassette/CD	O	O	O	O	O
Cruise control	S	S	S	S	S
Power steering	S	S	S	S	S
Dash fans	S	S	S	S	S
Driver's door with slider window	O	O	O	O	O
Tinted wraparound windshield	S	S	S	S	S
Side-mount power mirrors	O	O	O	O	O
Upgrade side-mount mirrors	S	S	S	S	S
Windshield privacy drape	S	S	S	S	S
Floor mats	O	O	O	O	O
Full instrumentation	S	S	S	S	S
Map lights	S	S	S	S	S
Reclining swivel captain's chairs	S	S	S	S	S
3-point, wall-mounted seat belts	S	S	S	S	S
Sun visors	S	S	S	S	S
Tilt steering wheel	S	S	S	S	S
Electronically controlled dash air conditioning	S	S	S	S	S
Backup monitor system	O	O	O	O	O
Drink tray	S	S	S	S	S
Pull-down bunk	O	O	O	N/A	N/A

DayBreak Entry	2740	2960	3130	3270	3280
Electric entrance step	O	O	O	O	O
Integrated entrance step	S	S	S	S	S
Interior entry-assist hand rail	S	S	S	S	S
Deadbolt door lock	S	S	S	S	S
Battery access in stairwell	S	S	S	S	S

DayBreak Kitchen	2740	2960	3130	3270	3280
Refrigerator: flush-mount, double door	S	S	S	S	S
Refrigerator: large flush-mount double door	O	O	O	O	O
Refrigerator: large double door with icemaker	O	O	O	O	O
Refrigerator: solid wood front*	O	O	O	O	O
Booth dinette with padded top	S	S	S	S	S
Freestanding dinette with 4 chairs	N/A	N/A	N/A	O	O
Solid wood cabinet doors*	S	S	S	S	S
Wood-plank flooring*	S	S	S	S	S
Double-bowl sink with oversized dish bowl	S	S	S	S	S
Sink cover	S	S	S	S	S
Cutlery drawer	N/A	S	S	S	N/A
3-burner range and oven	S	S	S	S	S
Folding range cover	S	S	S	S	S
Lighted power range hood and monitor panel (includes LPG readout)	S	S	S	S	S
Microwave oven	S	S	S	S	S
Mini blind	S	S	S	S	S
Self-edged countertops throughout	S	S	S	S	S
Fire extinguisher	S	S	S	S	S

* Oak or maple

DayBreak Bathroom	2740	2960	3130	3270	3280
Tub with surround	S	S	N/A	S	S
Shower with surround	N/A	N/A	S	N/A	N/A
Shower with glass door	N/A	N/A	S	N/A	N/A
Bypass shower door	O	O	N/A	O	O
Skylight in tub/shower	S	S	S	S	S
Hand-flush toilet	S	S	S	S	S
Foot-flush toilet	O	O	O	O	O
Power vent	S	S	S	S	S
Hardwood-framed mirror	S	S	S	S	S
Medicine cabinet	S	S	S	S	S

S = Standard O = Optional N/A = Not Available

MORE DAMON VALUE



Pre-wired for satellite dish



Cutlery drawer (Standard on: 2960, 3130, 3270)



19" color TV



Double-bowl sink with oversized dish bowl



Solid wood cabinet doors

Chosen #1 Motorhome in Its Class



DAMON® DAYBREAK™ MOTORHOME FOR 2001



Your DayBreak dealer:

Due to constant product improvements, the specifications, component parts and standard/optional equipment are subject to change without notice or obligation. Product photography or diagrams may show equipment that is optional. Damon Corporation reserves the right to make changes in prices and models and to discontinue models without notice or obligation. Components, parts or chassis may have been manufactured at times other than the model year indicated. All capacities are approximate and dimensions are nominal. All dry weights are based on standard model features and do not include optional features or equipment. Various RV components and features may differ to conform to local codes.

DC 09/00
© 2000 Damon Corporation
Printed in U.S.A.

Damon Corporation • P.O. Box 2888 • Elkhart, IN 46515
219-389-0179 • 800-577-5692 www.DamonRV.com