



Damon

DayBreak Class A Motorhomes



Now is the time.

If you ever wanted a Class A motorhome, but didn't think you could afford one ... If you ever wanted the absolute most value for your hard-earned money ... And if you ever wanted a spacious motorhome that, feature for feature, cannot be matched by anything in its price range ... Now is the time to get acquainted with the DayBreak Class A Motorhome from Damon Corporation.

DayBreak's standard side-mount awning increases the size of your outdoor living area, plus provides cool shade on hot summer days.

Model 2960 • Butter Rum decor



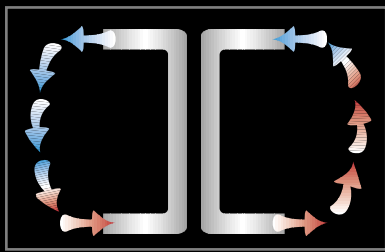

Summer / Winter

Our exclusive Comfort Control Center™ improves on most roof-mounted RV air conditioning units. Combined with well-insulated walls and ceiling, this smartly engineered system circulates air and regulates temperatures inside your DayBreak. In winter, heated air is circulated up through floor ducts to keep you toasty warm; in summer, cold air is circulated down so you're always cool and comfortable.



Model 3270 • Tin Roof decor



With the simple push of a button, this convenient slide-out room will add up to 30 square feet to your living space. This floor plan offers a free-standing sofa and dinette set which can be rearranged to fit your changing needs. Notice the super-size vista windows.

Model 2960 • Butter Rum decor

Comfortable, roomy interior has lots of large windows and airy space. The barrel chair swivels to accommodate several conversations. Under the comfy sofa you'll find an extra large storage compartment.

The convenient StepSaver™ kitchen features beautiful hardwood-crafted oak plank flooring, oak cabinet doors and raised-panel oak refrigerator doors as options. Everything's at your fingertips: special color coordinated counter tops, double-door refrigerator, large 3-burner stove, double-bowl sink and microwave oven. The handy dinette folds down and becomes an extra bed. Plus, Damon gives you double-metal glides in all drawers, so they open as smoothly as those at home.

Damon craftsmen assemble and install all cabinets with screws for added strength and stability, unlike staples used by many of our competitors.



DayBreak Class A Motorhomes



Nobody even comes close

When it comes to value, DayBreak stands in a class by itself. No other comparable motorhome on the market comes close to matching it. In fact, with just one walk-through and just one test drive, you'll see what we mean.

Storage is everything when traveling, so we do all we can to maximize it whenever possible. For instance:

We provide extra kitchen storage by converting unused space under the sink into a convenient silverware drawer.



Pass-through exterior storage compartments stow extra large cargo. They're lighted for convenience; and fully lined so your cargo doesn't rattle.



The beautiful solid oak wardrobes and overhead cabinets provide spacious storage for clothing and other personal belongings.



You'll find efficiently-designed overhead cabinets in DayBreak's slide-out room.



Block foam insulation cut, fitted and glued into every cavity in the floor and roof, providing excellent insulation value.

Standard aluminum roof ladder for convenient access to roof storage.

Full-integrated rear fiberglass cap (29' and larger) features large rear window.

DayBreak's Ice White™ exterior is constructed of durable, easy-to-maintain, one-piece fiberglass.

Jalousie windows are standard in your DayBreak bedroom to provide ventilation even in the rain!

Aluminum perimeter framing prevents leakage and increases strength.

White anodized radius aluminum window frames with large, sliding glass windows tinted to offer solar heat reflection.

Sturdy, lightweight 1-5/16" block foam insulated baggage doors provide maximum access.

High-quality residential carpet and padding provides comfort and insulation on top of your seamless, one-piece floor deck.

Every DayBreak has undercoating and foam seal to provide an added barrier from the elements.

WARRANTY INFORMATION

One-piece Rubber Roof – 12 years

Awning – 5 years

Water Heater – 2 years

Heating/Air Conditioning System – 2 years

Range and Microwave – 2 years

Gas Sensor – 2 years

Brake System – 2 years

Toilet – 2 years

Power Converter – 2 years

TV Antenna – 2 years

Everything Else – 1 year

Totally enclosed, heated waste water holding tank compartments provide worry-free, extended seasonal use.



The StartRight Quality Assurance™ program is our strenuous 400-point plus inspection test. It's performed on every DayBreak before it leaves the factory — so every Damon RV passes our test before it passes yours.



Modern, computer-aided design and innovative manufacturing technologies ensure Damon Corporation's high tech engineering and high quality products.

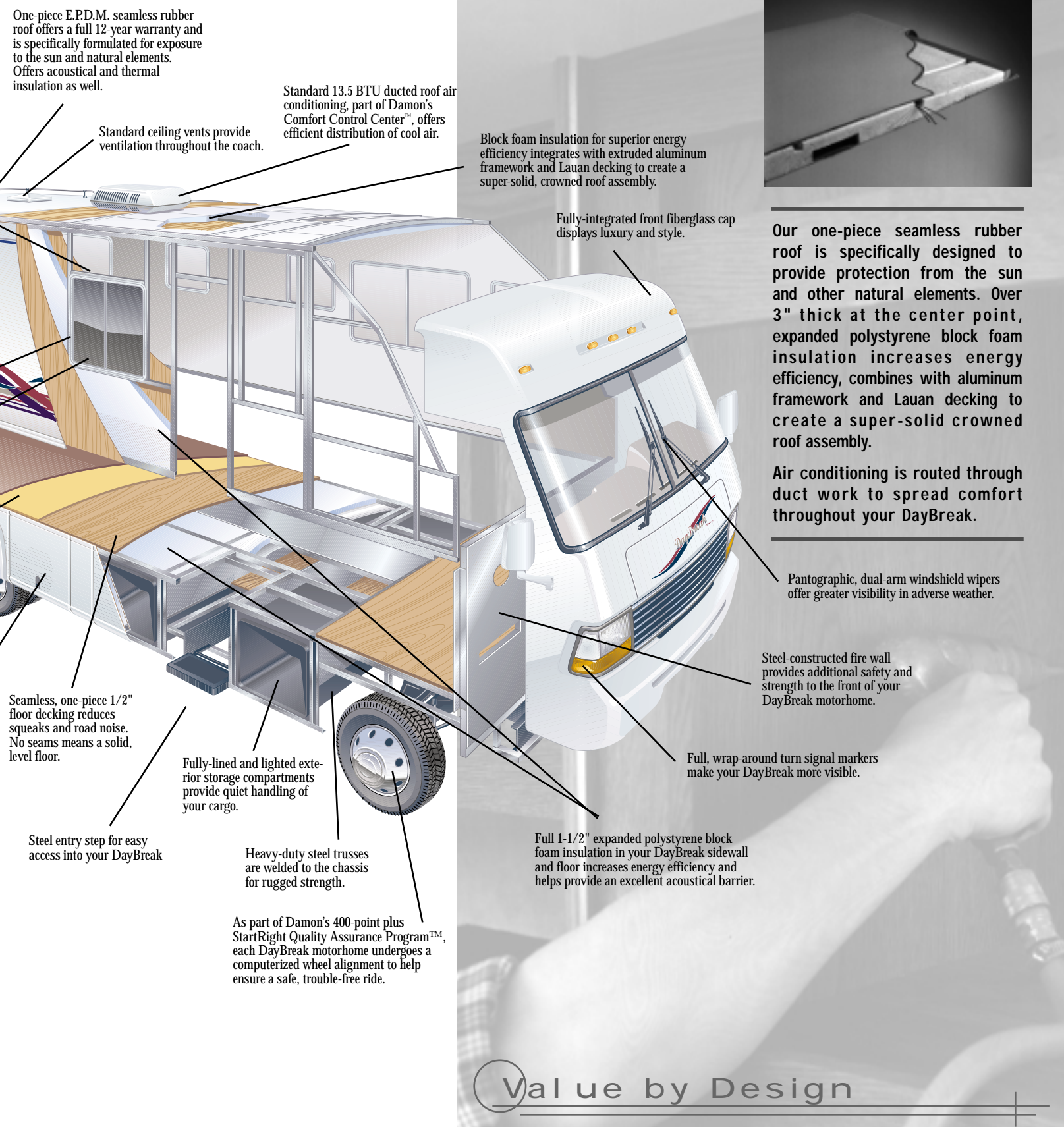

One-piece E.P.D.M. seamless rubber roof offers a full 12-year warranty and is specifically formulated for exposure to the sun and natural elements. Offers acoustical and thermal insulation as well.

Standard 13.5 BTU ducted roof air conditioning, part of Damon's Comfort Control Center™, offers efficient distribution of cool air.

Standard ceiling vents provide ventilation throughout the coach.

Block foam insulation for superior energy efficiency integrates with extruded aluminum framework and Luan decking to create a super-solid, crowned roof assembly.

Fully-integrated front fiberglass cap displays luxury and style.

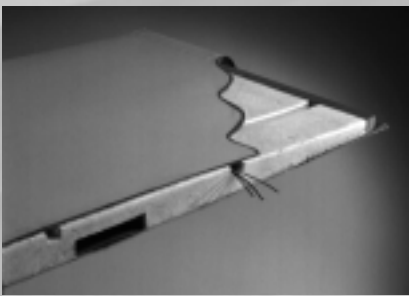

Our one-piece seamless rubber roof is specifically designed to provide protection from the sun and other natural elements. Over 3" thick at the center point, expanded polystyrene block foam insulation increases energy efficiency, combines with aluminum framework and Luan decking to create a super-solid crowned roof assembly.

Air conditioning is routed through duct work to spread comfort throughout your DayBreak.

Pantographic, dual-arm windshield wipers offer greater visibility in adverse weather.

Steel-constructed fire wall provides additional safety and strength to the front of your DayBreak motorhome.

Full, wrap-around turn signal markers make your DayBreak more visible.

Full 1-1/2" expanded polystyrene block foam insulation in your DayBreak sidewall and floor increases energy efficiency and helps provide an excellent acoustical barrier.

Seamless, one-piece 1/2" floor decking reduces squeaks and road noise. No seams means a solid, level floor.

Fully-lined and lighted exterior storage compartments provide quiet handling of your cargo.

Steel entry step for easy access into your DayBreak

Heavy-duty steel trusses are welded to the chassis for rugged strength.

As part of Damon's 400-point plus StartRight Quality Assurance Program™, each DayBreak motorhome undergoes a computerized wheel alignment to help ensure a safe, trouble-free ride.

DayBreak Class A Motorhomes



**Yours.
By Design.**

With five exciting floor plans, plus many other individual options including twin beds and comfortable swivel chairs, you'll find plenty of ways to make DayBreak a unique reflection of your own special taste and personality.

1998 FLOOR PLANS

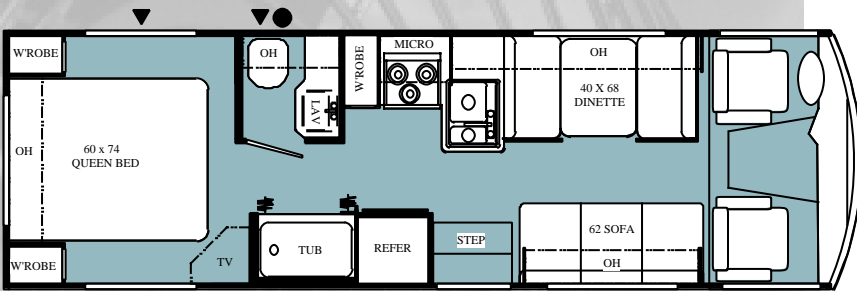

2740 / Available Options - A, B

14' AWNING

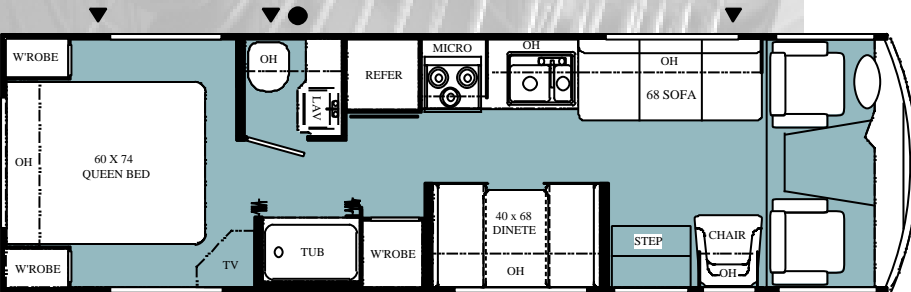

2960 / Available Options - C, D

14' AWNING

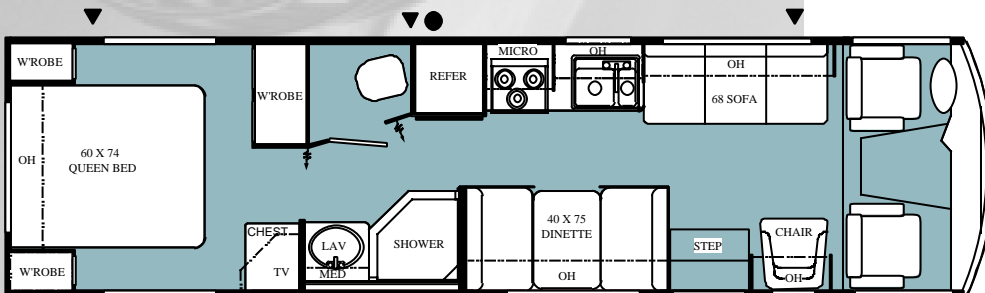

3130 / Available Options - D, F

16' AWNING

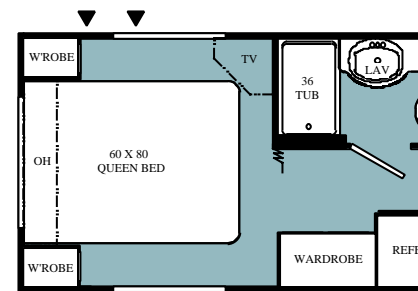

3210 / Available Options - C, D, E

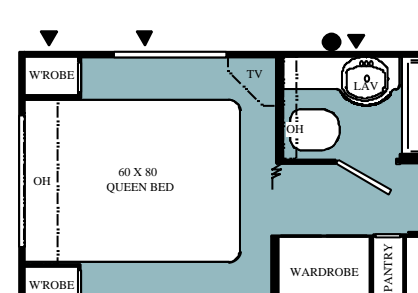

3270 / Available Options - D, E, F

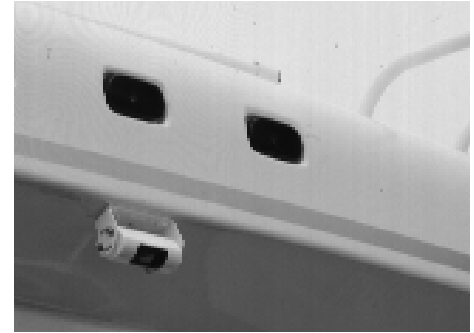

For safety's sake, DayBreak's optional backup monitor system enables you to look directly behind your motorhome when backing up. The monitor is placed conveniently so it can be viewed without losing sight of the side view mirror.

DAYBREAK VIDEO OFFER

See a DayBreak up close and personal, both inside and out, with Damon Corporation's special video tour – just \$10.00 by mail. Send your check, name and address to:

Damon Corporation – DayBreak Fifth Wheel Video
P.O. Box 1107
Elkhart, IN 46515

At this point, the single-piece laminated wall stops. Everything below this point is hinged to maximize exterior storage. Storage doors are laminated fiberglass for strength and reliability. Plus they're designed for easy opening with convenient push-button locks. And, in case of damage, only the effected panel would have to be replaced rather than an entire sidewall.

The DayBreak cockpit is designed to give you the utmost in driveability and comfort. Features include automatic transmission, power steering and cruise control to take the burden of long-range driving. Dash instruments are easy to see and are placed within quick reach. And notice the extra large windshield.

Also available is an optional driver's side door for easy entering and exiting. Both driver and passenger seats swivel so people can participate in indoor conversations after a long day on the road.



DayBreak's optional dash fans come in handy when defrosting the windshield in cold or rainy weather. Also helps circulate the air to keep drivers cool in summer, warm in winter.

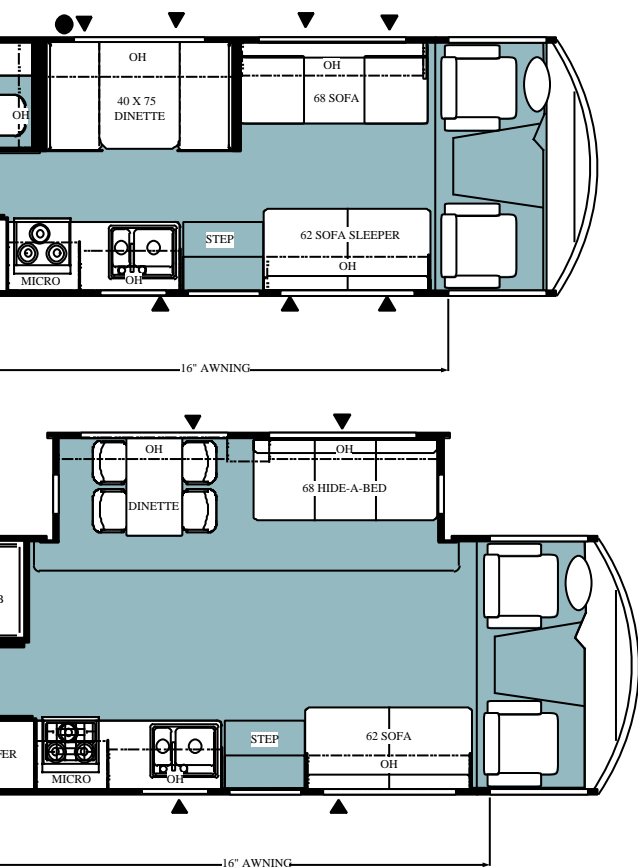

1998 FLOOR PLAN OPTIONS

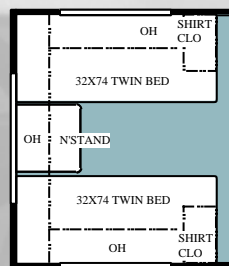

Option A

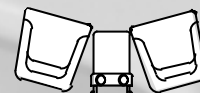

Option B



Option C

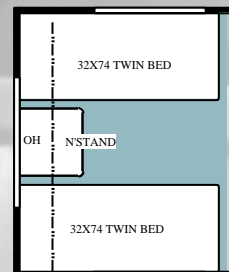

Option D

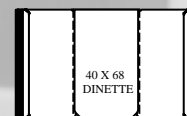

Option F



Option E

Yours by Design

dayBreak Class A Motorhomes

The decorator-inspired bedroom features coordinated bedspread and valances. There's plenty of storage in hardwood-framed closets and cabinets, plus under the bed. Note the nice little nightstand shelf that conveniently slides out of the way during the day.



Model 2960 • Butter Rum decor

Comfortable bathroom features large airy shower with skylight and sliding bi-fold door; matching counter tops, medicine cabinet with hardwood-framed mirror and under-sink storage.



Butter Rum



Spumoni

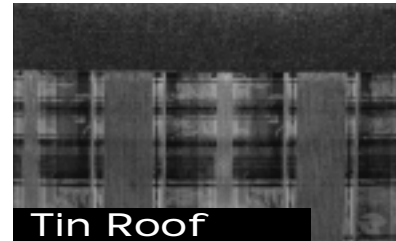

Tin Roof



Light
Oak



Medium
Oak

Model 3130 • Butter Rum decor



Damon
s n r t l s

All of our exclusive Designer Details add up to one big difference in quality and value. Like rich oak cabinet doors, raised-panel oak refrigerator doors, and hardwood plank flooring. Oak adds a touch of elegance that's not found in similar competitively priced models.

Your nearest dealer:

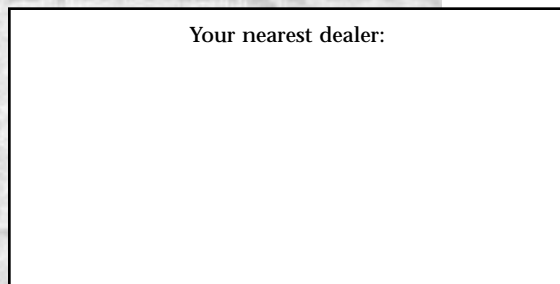

P.O. Box 1107
Elkhart, IN 46515
1-800-860-5658



Go RVing™