

Outback

Built for a Lifetime of RVing

Sydney Edition



Fifth Wheels & Travel Trailers

Sydney Edition



Experience the Wonder of Sydney: Focused on aerodynamic and tasteful design throughout and fashioned with lighter interiors for the fresh look of today. Outback has earned a reputation for high-end quality at a mid-range price point.

From its smooth exterior, finished with no exposed fittings, to the concealed hinges of the easy maintenance Thermofoil lightweight cabinetry, Outback strives for durability as well as style, using the latest materials technology to combine strength with lightness. With the growth and development of the Sydney edition, Outback is providing for those who want to step up to an even more pleasingly appointed fifth wheel or travel trailer. You'll be amazed at the value of Sydney's standard features, and the appealing options, like our free-standing dining table with pedestal base and slatted wood chairs.

How can anything so light in weight be so sturdy, innovative and attractive? Ask any Sydney owner!

31 FRL

Sydney Russet

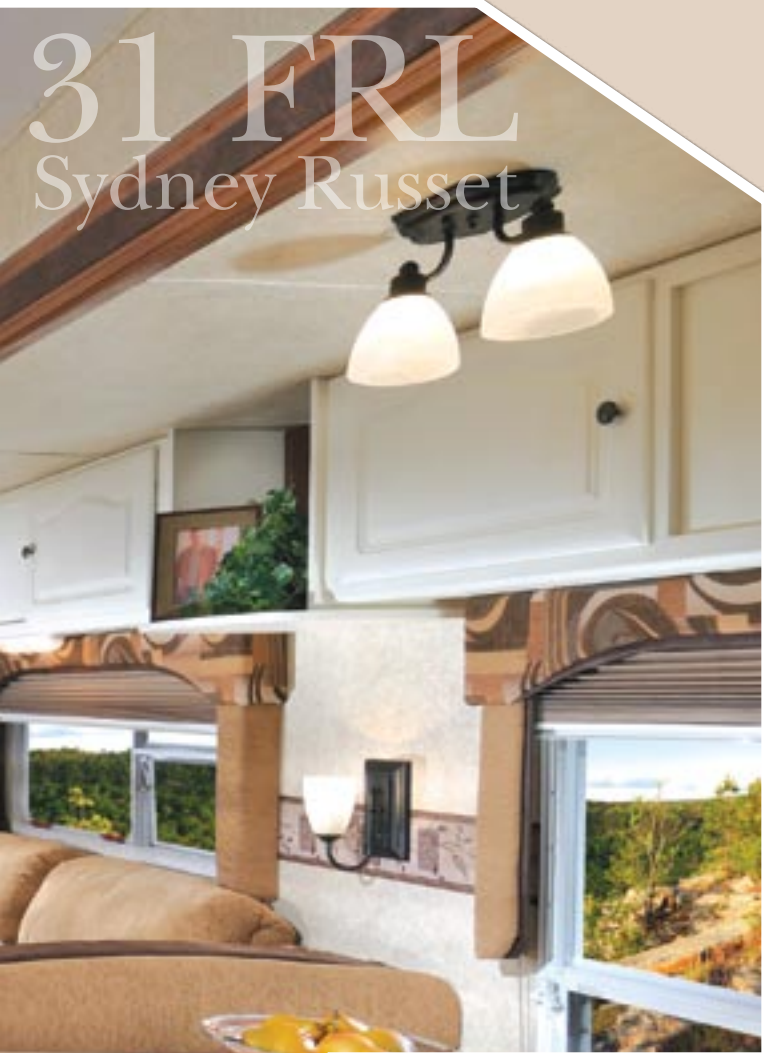

31 FRL

Sydney's neo-angle shower features a skylight. Notice that the vanity has drawers for extra storage.



Sydney's luxurious master bedroom suite features a queen bed slide-out (some models), soft queen bed with quilted spread matching headboard and curtains, wall sconce and a vanity built higher just for your comfort! The tall sliding mirrored wardrobe is part of the ample storage available, along with overheads, drawers and a second wardrobe.

31 FRL

Sydney Russet

32 BHDS Sydney Havana



Decor

This travel trailer floor plan shows the deluxe entertainment center and the dark cherry wood plank-look flooring. As your eye moves from the kitchen to the slide-out, notice the angled sink, overheads and side windows.

Fern



Russet

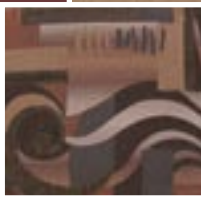

Havana

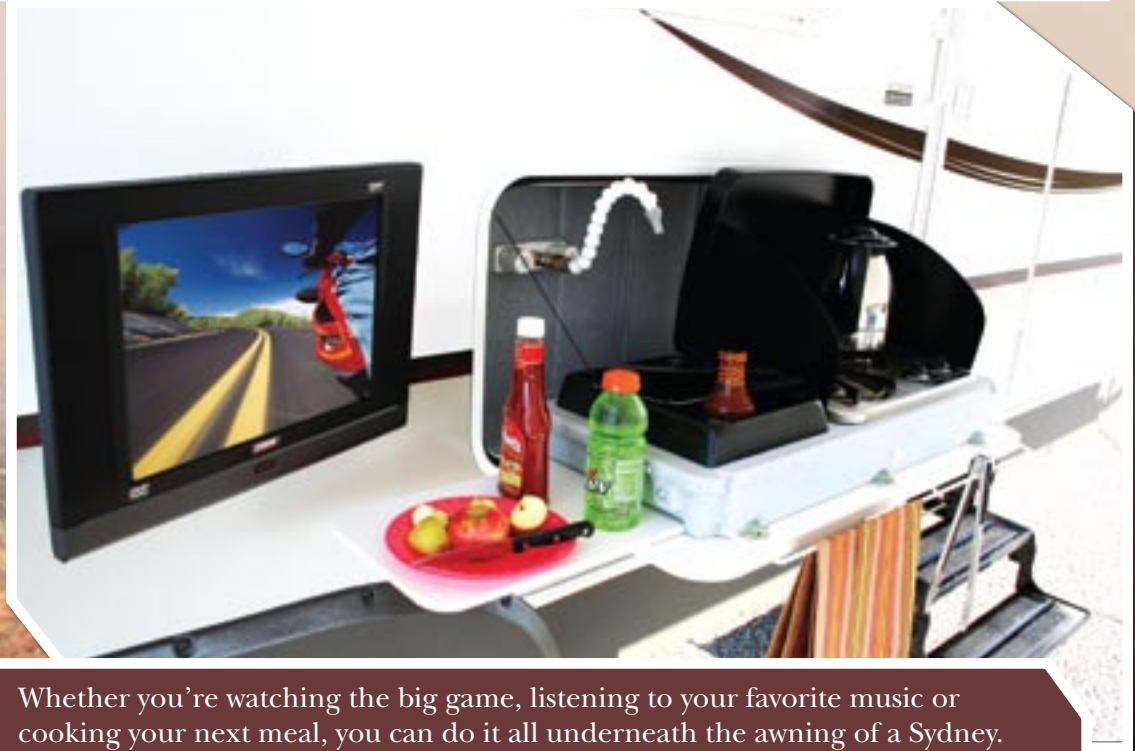

Whether you're watching the big game, listening to your favorite music or cooking your next meal, you can do it all underneath the awning of a Sydney. Sydney features an LCD Campsite Theatre that includes a 19" LCD TV that can be mounted on an exterior clip provided underneath the awning. The Outside Camp Kitchen includes a 2-burner Cook Top, H/C Water Faucet, 20' Water Hose, Cutting Board and Towel Bar. Also for your convenience are Exterior Security Lights, Exterior Speakers and a 110 Volt Electrical Outlet.

Travel Trailer Features



1. Sydney features 8 Cu Ft refrigerators in all models.
2. 19" LCD TV mounted in the living area also comes with a outside mounting bracket.
3. Stay cool with Sydney's Quick Cool Air Conditioning System.
4. Sydney trailers come with a protective front diamond plating.

Fifth Wheel Features



1. Oversized pass-through storage compartments on every Sydney model. Go ahead and bring it all with you!
2. Sydney 5th wheels come with a second 26" LCD TV in the living area.

Turning Made Easy

The most aerodynamic front fiberglass cap in the industry ensures your Sydney fifth wheels will tow like a dream and improve fuel efficiency. With the addition of the hitch mirror and lights, hooking up will be a breeze. Adding to the already sleek design are grooves molded into the cap to direct the airflow increasing safety and tow ability. Turning radius is drastically improved more than 30% making turning easier for today's short bed trucks.

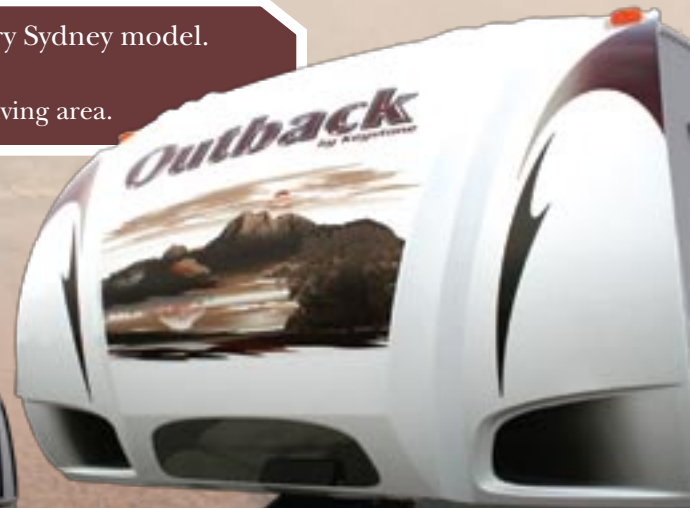

Travel Trailer Floor Plans

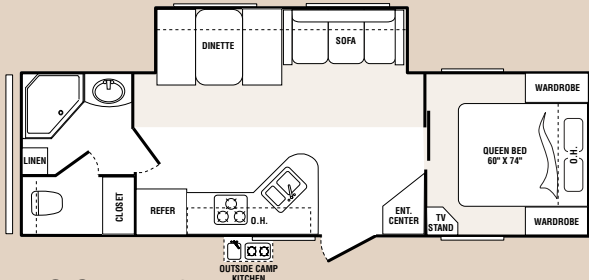

26 RBS

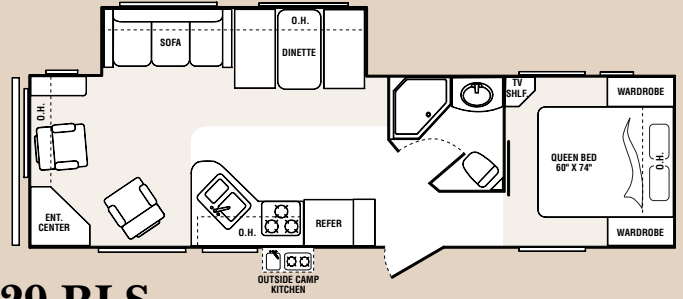

29 RLS

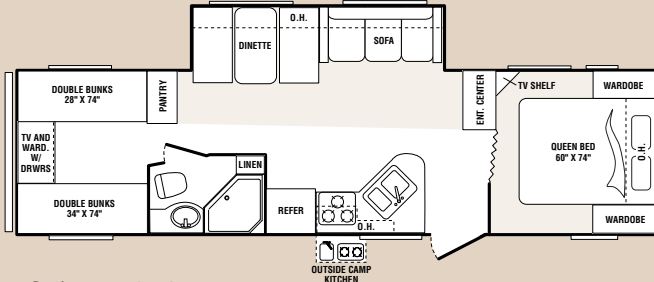

31 RQS

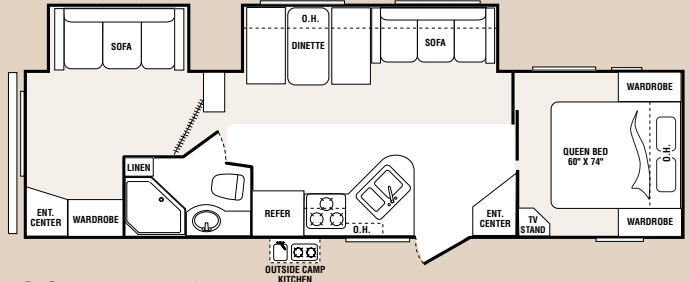

32 BHDS

	26 RBS	29 RLS	31 RQS	32 BHDS
Shipping Weight	6745	6990	7205	7650
Carrying Capacity	2855	2610	2395	1950
Hitch	610	795	745	810
Exterior Length	31' 3"	33' 6"	35' 1"	35' 1"
Exterior Width	8'	8'	8'	8'
Ext Height - A/C top	11' 1"	11' 1"	11' 1"	11' 1"
Awning	17'	19'	16'	16'

Sydney Tank Capacities

LP Capacity	60 lbs.
Fresh Water	50 gal.
Grey Water	80 gal.*
Waste Water	40 gal.
* 40 gal. on 29 RLS	

R Values

Roof R-14 / Floor R-14 /
Wall R-9

It's What You Can't See that Counts the Most



2" X 3" Floor Joist with 5/8" thick floor decking makes Sydney's floor one of the strongest.



Sydney's heated underbelly encloses tanks and valves, helping to extend the camping season. On the road, the smooth underside greatly improves air flow for better towability.



All Sydney's come with Keystone Kream Thermofoil wrapped cabinet doors. Easy to clean and very durable they provide a refreshing alternative to the traditional wood grain interior.

Fifth Wheel Floor Plans

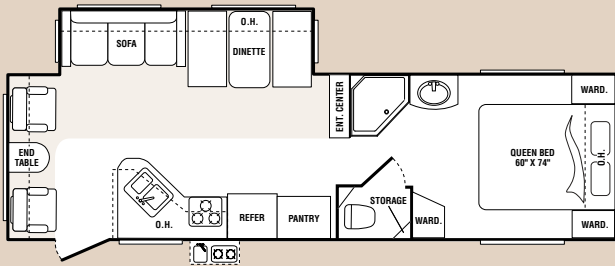

28 FRLS

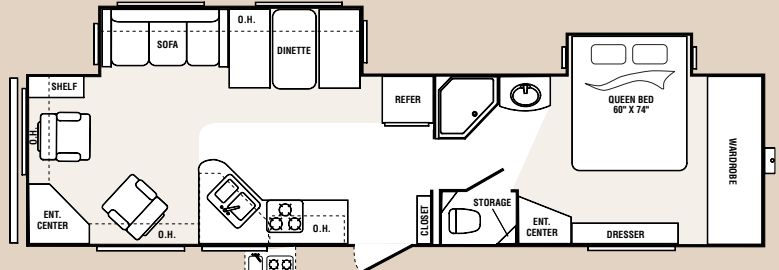

31 FRL

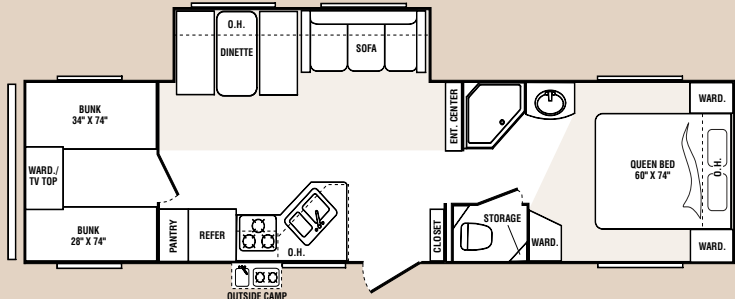

31 FQBHS

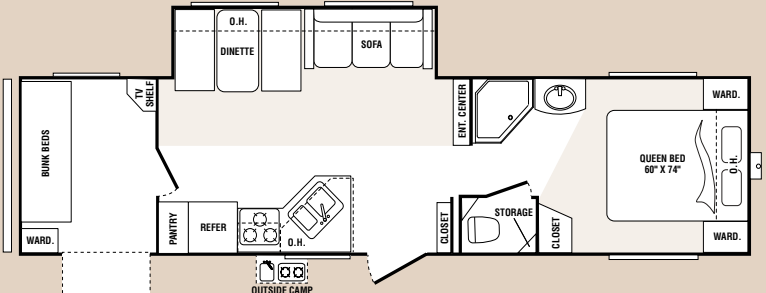

31 KFW

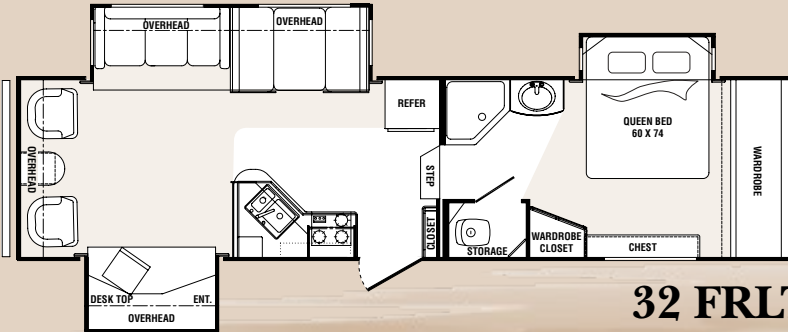

32 FRLT

	28 FRLS	31 FRL	31 FQBHS	31 KFW	32 FRLT
Shipping Weight	7825	9060	8410	8465	TBD
Carrying Capacity	1975	2440	2790	2735	TBD
Hitch	1545	1890	1860	1825	TBD
Exterior Length	30' 8"	35' 1"	35' 2"	35' 2"	TBD
Exterior Width	8'	8'	8'	8'	TBD
Ext Height - A/C top	12' 3"	12' 6"	12' 6"	12' 6"	TBD
Awning	17'	19'	19'	20'	TBD

Sydney Tank Capacities	
LP Capacity	60 lbs.
Fresh Water	50 gal.
Grey Water	80 gal.
Waste Water	40 gal.

R Values	
Roof	R-14 / Floor R-14 / Wall R-9



Sydney frames are all treated in an 11 step process before painting making them more rust resistant than the competitor's frames.

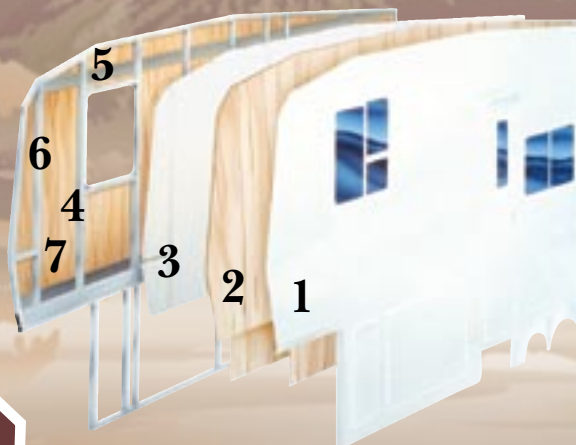

- Durable Construction**
1. Filon Fiberglass
 2. 1/8" Luan Wood Backer
 3. Solid Block EPS Foam Insulation
 4. Radius Window Corner Blocks
 5. Metal Backing Strips
 6. 2" Welded Aluminum Sidewall Studs
 7. Interior Decorative Plywood Paneling

Standards & Options

Interior Standards

Living Area

- Grab handle inside entry door
- Custom designed box valances
- Pleated shade
- Linoleum flooring
- Thermofoil residential raised panel doors with concealed hinges throughout
- Wood side drawers with steel guides
- Skylight (most models)
- 6'2" extra tall slide out with 16" cabinets (Fifth wheels only)
- Water, soil, stain resistant fabrics
- Large overhead cabinets
- Decorative wall lights
- Residential sleeper sofa

Kitchen

- 60/40 deep sink with 3" drains
- Trash can
- High-rise faucet
- Spice rack (most models)
- Sink cutting board
- Utensil tray

Bedroom

- Deluxe innerspring mattress
- TV hook-up
- 19" LCD TV (Fifth wheel only)
- Wall lights
- Deluxe wardrobe
- Residential bedspread with headboard

Bathroom

- Residential Neo-angle shower
- Glass shower door
- Residential height vanity
- Porcelain foot flush toilet
- Deluxe medicine cabinet

Appliances

- AM/FM/CD stereo with DVD player
- 8 cu. ft. two-door refrigerator
- Three-burner range
- Six gallon gas/electric DSI heater water heater by-pass
- Wall mounted thermostat controlled A/C
- 30,000 BTU furnace

Exterior Standards

- Tinted jalousie safety glass windows
- Extra large baggage doors
- 1" thick with continuous hinge and rubber D-seal
- Folding entry handle (Fifth wheel only)
- Extra tall 30" main entry doors
- Front diamond plate (Travel trailers only)
- Hitch lights (Fifth wheel only)
- Hitch vision mirror (Fifth wheel only)
- Satellite prep
- Molded fiberglass front cap (Fifth wheel only)
- Extended drip caps, full length drip rails
- Two security lights (one on each side)
- Heated enclosed underbelly including tanks and valves
- Ladder (Fifth wheel only)
- Porch light
- Snap pins on front jacks (Fifth wheel only)
- Exterior 120V receptacle
- Weather encapsulated body trim
- Automotive style fender skirt
- Aluminum bumper cover
- Exterior Speakers
- Exterior TV mount

Walls – Construction

- Two-tone exterior fiberglass
- 2" welded aluminum framed side walls and end walls
- Solid block foam insulation

Roof

- 5" tapered truss on 16" centers
- 3/8" roof decking
- One-piece EPDM rubber roof
- Blanket insulation

Floor

- 3" welded aluminum floor joist 13" centers
- 5/8" seamless one-piece floor deck
- Blanket insulation
- Wrapped vapor barrier
- Polypropylene enclosed heated underbelly encloses tanks, and valves

Chassis

- Leaf spring equalizing suspension system
- 8" powder coated I-beam
- 10" powder coated I-beam
- EZ lube axles
- 12" electric brakes
- 225 75/15 radial tires

Utilities

- 55-amp converter
- 2- 30 lbs. LP bottles with auto changeover
- TV antenna with booster cable TV
- 30-amp shore power line

Safety

- LP leak detector
- Smoke detector
- Carbon monoxide detector
- Fire extinguisher
- Tint safety glass windows
- Break-away switch
- Safety chains (Travel trailers only)

Optional Features

- Designer Package
- Comfort Package
- Oven
- Large entry door
- 6 gal. gas/electric DSI water heater
- LCD campsite theatre
- Electric front jacks (Fifth wheel only)
- Carbon monoxide detector
- Free standing table and chairs
- Stabilizer jacks (4)- Travel Trailers) (2)- Fifth wheels)

Sydney Comfort Package

- Roof air conditioner
- TV antenna with booster
- Patio awning
- AM/FM stereo
- Folding entry handle
- Microwave

Sydney Designer Package

- Wallpaper border
- Shower door
- Bathroom accessories
- Utensil tray
- Residential sleeper sofa
- 6 panel raise refer
- Chrome bumper cover
- Recessed cutting board
- Trash container

Sydney Edition

www.keystone-sydney.com



2642 Hackberry Dr.
Goshen, IN 46526

Member



Product information is as accurate as possible as of the date of publication of this brochure. Features, floor plans, and specifications are subject to change without notice. Please also consult Keystone's web site at keystonerv.com for more current product information and specifications. **Tow Vehicle Disclaimer.** CAUTION: Owners of Keystone recreational vehicles are solely responsible for the selection and proper use of tow vehicles. All customers should consult with a motor vehicle manufacturer or their dealer concerning the purchase and use of suitable tow vehicles for Keystone products. Keystone disclaims any liability or damages suffered as a result of the selection, operation, use or misuse of a tow vehicle. **KEYSTONE'S LIMITED WARRANTY DOES NOT COVER DAMAGE TO THE RECREATIONAL VEHICLE OR THE TOW VEHICLE AS A RESULT OF THE SELECTION, OPERATION, USE OR MISUSE OF THE TOW VEHICLE.** January 2008