

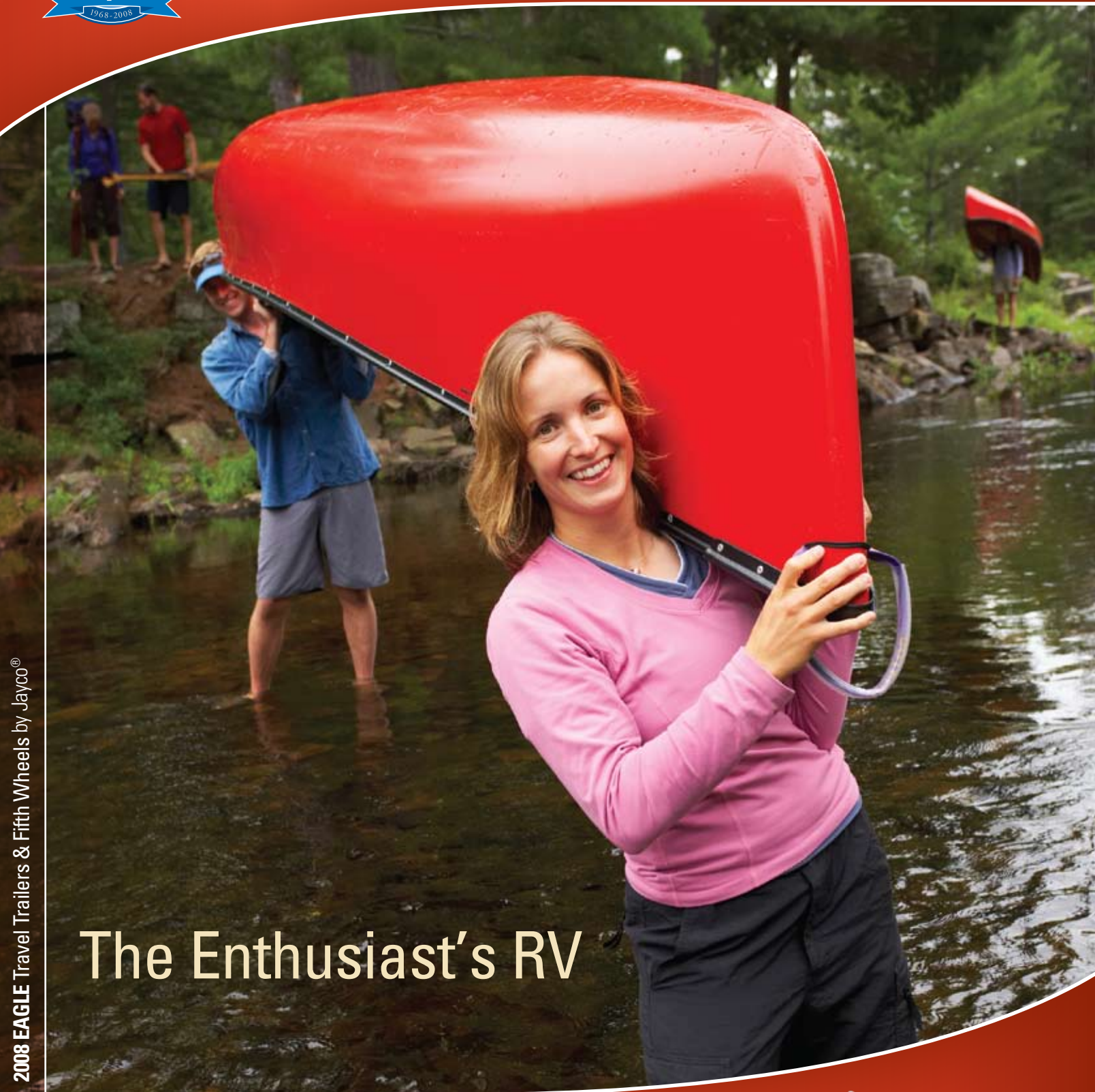

Eagle™

2008 Travel Trailers & Fifth Wheels by Jayco®



The Enthusiast's RV

2008 EAGLE Travel Trailers & Fifth Wheels by Jayco®



Travel Trailer



Super Lite



Fifth Wheel



AMERICA'S MOST LIVEABLE RV'S.



Eagle

2008 TRAVEL TRAILERS & FIFTH WHEELS

You're an experienced RVer with many journeys behind you and you know exactly what you like and what works best for your lifestyle. Eagle travel trailers and fifth wheels are designed especially for enthusiasts like you. The Eagle offers high-end features at a mid-range price — a combination that makes it a very smart choice when you're ready to upgrade. If you've always wanted to experience the renowned quality of a Jayco RV, the Eagle is the one to choose.

10 Reasons to Move Up to Eagle

- » Durable Tuff-shell™ vacuum-bonded laminated construction
- » Lightweight, welded aluminum-framed sidewalls for easier towing
- » 5/8" tongue-and-groove plywood floor stays secure (fifth wheel only)
- » Underbelly is enclosed to protect from road debris and heated to extend your camping season
- » American-made Norcold® 8 cu. ft. refrigerator lets you adjust the temperature
- » Solid wood cabinet doors crafted with mortise-and-tenon joints and screwed stile construction
- » Jake Plate™ adjustable axle hangers for more level towing (fifth wheel only)
- » I-Class™ structural steel I-beam frame is designed to last
- » E-Z Lube™ axles make maintenance a snap
- » Customer Value Package enhances comfort and convenience



No Other RV Offers So Much Value

Which Eagle Fits Your Style?



Eagle Travel Trailer

- » Variety of floorplans that sleep 5 to 8
- » Ideal upgrade from an entry-level travel trailer
- » Comfortable choice for long trips



Eagle Super Lite

- » Variety of floorplans that sleep 5 to 9
- » Lightweight fifth wheel design
- » Step-up bedroom area



Eagle Fifth Wheel

- » Variety of floorplans that sleep 4 to 9
- » Most spacious Eagle model
- » All floorplans feature at least one slideout
- » Available with largest selection of residential-style amenities



Celebrating 40 Years of Liveability

The Jayco story began in 1968 with a humble desire to build more comfortable and practical ways for families to explore the world together. Jayco has grown to become the largest privately owned manufacturer of recreation vehicles in North America. While our product line is more diverse than ever before, every unit we build shares a common attribute—liveability. Because we believe every journey should be easy to enjoy.

Eagle Travel Trailer™



» For the Added Comfort to Enhance Your Trips

You already love the RV lifestyle. Take your interest even farther with the well-appointed Eagle travel trailer. It gives you more living space, more home-like furnishings and more convenient features, which will make every trip that much more enjoyable.

tread lightly!
OFFICIAL SPONSOR



Jayco proudly sponsors Tread Lightly!®, a nonprofit organization whose mission is to empower generations to enjoy the outdoors responsibly through education and restoration.





In the spacious bedroom, the deluxe pillow-top mattress is surrounded by the warmth of beautiful hardwood cabinetry.



Feel right at home in this residential-style bathroom, complete with a one-piece tub/shower surround, mirrored wood medicine cabinet and foot-flush toilet. A skylight, included in the Customer Value Package, brightens the space.



A Great Year to Buy

In honor of Jayco's 40th Anniversary, we've added special features to selected 2008 Eagle models including an electric awning, flat screen LCD TV and adjustable dream dinette table. Ask your Jayco dealer for complete details.



Eagle Super Lite™



» For a Lightweight and Affordable Fifth Wheel

Want to enjoy the floorplan advantages of a fifth wheel and still maintain the fuel efficiency of a lighter weight RV? Then the Eagle Super Lite is a great choice for you. Its multi-level fifth wheel design offers more separation for the bathroom and bedroom areas, and there's plenty of comfortable seating and convenient storage throughout. With the Eagle Super Lite, you'll be equipped for all the adventures ahead.



The bedroom with adjoining bathroom features a 312-coil innerspring mattress, ample storage and a bookshelf headboard.



You'll enjoy the thoughtful touches in the bathroom including a large sink and shelves in the shower.



Everything's at your fingertips in the convenient kitchen featuring a 3-burner range, oversized oven and acrylic residential-style sink.



Eagle Fifth Wheel™



» For the Spacious Style to Enhance Your Journeys

At last, give yourself the space to stretch out and really relax. The Eagle fifth wheel is designed with plenty of room for preparing meals, watching a movie with friends or just taking a leisurely nap. There's even a handy desk area for catching up on correspondence. And everything inside is easy on the eyes, from the antique brass hardware and lighting to the beautiful Manchester Oak cabinetry. You won't want your trips to end.

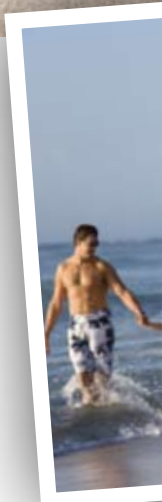



Great style and convenience are combined in the kitchen thanks to generous storage, radius-cornered countertops and an 8 cu. ft. refrigerator with double door.



The bedroom slideout creates a cozy alcove for the queen bed, complete with windows to enjoy the view.



Jayco Builds Lasting Value

Jayco's Eagle product line is constructed with high quality materials using production techniques perfected over the past 40 years. Count on yours to look good, perform well for years and provide excellent resale value.



1. Large, lockable storage compartments with pass-through design to permit access from either side
2. FRP smooth fiberglass sidewalls for low maintenance and abrasion resistance
3. 1/8" plywood
4. Bead-foam insulation in sidewalls (R-9 in FW, R-7 in TT & Super Lite FW)
5. Seamless one-piece rubber roof with 12-yr. warranty
6. Roof rafters, constructed of residential-style tapered 4½" trusses, allow for greater water run-off
7. 2"x 3" longitudinal floor studs placed on 16" centers (FW) or unitized, 1½" laminated construction of floor (TT & Super Lite FW)
8. 5/8" tongue-and-groove plywood floor decking (FW only)
9. Carpet pad for enhanced durability and comfort
10. Attractive, easy-care carpet
11. Carefree® 12 volt electric Travel'r awning quickly creates shaded space
12. Electro Galvanized (EGS) metal backing strips
13. R-7 fiberglass insulation in FW floor and TT roof, R-11 fiberglass insulation in FW roof, R-9 bead foam insulation in TT and Super Lite FW floor
14. Insulated foam A/C ducts for improved air flow and cooling
15. Enclosed, insulated (R-7) and heated underbelly with one-piece moisture barrier covering greatly reduces drag for better fuel economy and protects from grime and debris
16. Tinted safety glass windows
17. TuffShell™ vacuum-bonded laminated sidewalls offer durable, lightweight construction
18. Electric-powered front jacks and snap jacks are standard (FW only)
19. 3/8" plywood roof decking
20. Galvanized steel wheel wells are longer lasting
21. Aerodynamic fiberglass endcap is reinforced and dent resistant with new design for tighter turn radius (FW)



A LEGACY OF CRAFTSMANSHIP.

Jayco's dedicated production team includes Amish craftsmen who build with well-honed woodworking techniques passed down for generations and skilled seamstresses who produce our upholstery, bedding and draperies with great attention to detail.



- A.** Jayco's V-Tec™ flush-floor slideout systems increase living space with the push of a button.
- B.** EZ-Lube® axles with removable caps make maintenance a snap.
- C.** (Left) End view of Jayco's I-Class™ structural steel chassis frame made of 8" heavy-gauge steel. (Right) End view of the welded I-beam frame used by many competitors that is subject to warping.
- D.** Jake Plate™ adjustable axle hanger plates let you adjust the height of your fifth wheel up to 2 inches for more level towing.
- E.** Dream dinette table features easy-to-use hydraulic mechanism to lower table to bench height for use as a sleeping area.
- F.** Diamond-plate front panel and sturdy gas bottle cover protect from road debris (TT only).
- G.** Cabinet drawers are built with ball bearing glides for easy movement (FW only).
- H.** Reflective foil insulation under the slideout room carpet helps keep the interior comfortable.

Eagle Standards & Options

Standard Bathroom Equipment

	Fifth Wheel	Super Lite	Travel Trailers
ABS tub/shower surround	•••	•••	•••
Bar and towel ring	•••	•••	•••
Glass shower door	••	••	••
Large sink in bathroom	••	••	••
Laundry hamper	••	••	••
Marine toilet w/foot flush	•••	•••	•••
Medicine cabinet w/mirror	•••	•••	•••
Residential 6-panel passage door	•••	•••	•••
Shower curtain with curved shower track	••	••	••
Switches for all lights	•••	•••	•••
Thetford porcelain toilet w/foot flush	••	••	••
Toilet paper holder	•••	•••	•••
Towel holder	•••	•••	•••
Vanity light fixture	••	••	••
Vinyl flooring	•••	•••	•••

Standard Bedroom Equipment

	Fifth Wheel	Super Lite	Travel Trailers
312 coil innerspring mattress w/bed struts	•	•	•
Accordion door to bedroom (select models)	••	••	••
Ceiling vent	•	•	•
Coordinated, quilted bedspread	••	••	••
Decorative headboard	•••	•••	•••
Dresser lamp	••	••	••
Large pass-through storage (select models)	•	•	•
Pleated night shades	••	••	••
Privacy curtains (select models)	•	•	•
Trackless carpeting w/pad	•••	•••	•••
TV cabinet or flip-up TV shelf (select models)	•••	•••	•••
Under bed storage, bed lifts easily on gas struts	•••	•••	•••

Standard Construction Features

	Fifth Wheel	Super Lite	Travel Trailers
2"x 3" longitudinal floor studs placed on 16" centers	•	•	•
4 1/2" arched truss roof rafters with R-7 insulation	••	••	••
4 1/2" arched truss roof rafters with R-11 insulation	•	•	•
5/8" tongue and groove plywood main floor decking	•	•	•
8" & 10" Cambered structural steel I-Beam frames	•••	•••	•••
81" living room ceiling height	•••	•••	•••
Aerodynamic wrap around front fiberglass cap	••	••	••
Bead-foam insulation in sidewalls (R-7) and floor (R-9)	••	••	••
Bead-foam insulation in sidewalls (R-9)	•	•	•
Cabinetry crafted with screwed stile construction	•••	•••	•••
Electric-powered slideout	•••	•••	•••
FRP smooth fiberglass sidewall exteriors	•••	•••	•••
Fully-decked roof with 3/8" plywood	•••	•••	•••
Heated & enclosed fresh water tank & holding tanks	•••	•••	•••
Pin box, long	••	••	••
Platforms for dinette, bed and bunks are constructed of 1/2" plywood	•••	•••	•••
PolyFlex™ one piece moisture barrier underbelly covering	••	••	••
Reflective foil insulation in main floor and all slideout floors (R-15)	•	•	•
Seamless one-piece rubber roof	•••	•••	•••
TuffShell™ vacuum-bonded laminated sidewalls	•••	•••	•••
Unitized, 1-1/2" laminated construction of floor	••	••	••
Welded tubular-aluminum sidewall framework	•••	•••	•••

Standard Exterior Equipment

	Fifth Wheel	Super Lite	Travel Trailers
12V hitch light	•	•	•
15" radial tires	••	••	••
16" radial tires	•	•	•
Amber patio light w/inside switch	•••	•••	•••
Baggage doors, lockable, insulated and radius-cornered	•••	•••	•••
Big Easy entrance step with 10" deep treads.	•••	•••	•••
Bumper with drain hose carrier and end caps	•••	•••	•••
Chrome hub caps	•••	•••	•••
Cover for propane bottle made of molded ABS	•	•	•
Diamond-plated panel on front	•	•	•
Durable fender skirts	•	•	•
Electric-powered front jacks	••	••	••
E-Z Lube® axles	•••	•••	•••
Front jacks with quick release pins	••	••	••

	Fifth Wheel	Super Lite	Travel Trailers
Front window includes fiberglass stoneguard (322 FKS)	•	•	•
Galvanized steel wheel wells (insulated on non-slide models)	•••	•••	•••
Heavy-duty grab handle for entry assistance	••	••	••
Jake Plate™ adjustable axle hangers	••	••	••
Ladder to roof	••	••	••
Radius-cornered fiberglass entrance door w/screen door	•••	•••	•••
Rain guttering, molded with drip spouts	•••	•••	•••
Screened egress bunk windows	•••	•••	•••
Spare tire with carrier	••	••	••
Stabilizer jacks on rear (1 pair)	••	••	••
Stabilizer jacks (2 pair)	••	••	••
White-framed radius fiberglass main entry door	•	•	•

Standard Heat, Power and Water Equipment

	Fifth Wheel	Super Lite	Travel Trailers
6-gal. gas/electric DSI auto-ignition water heater	••	••	••
110V G.F.C.I. protected exterior receptacle	•••	•••	•••
12V demand water pump	•••	•••	•••
12V electrical system w/deluxe 110V, 45-amp. power converter	••	••	••
12V electrical system w/deluxe 110V, 80-amp. power converter	•	•	•
30-amp. power cord	••	••	••
50-amp. power cord	•	•	•
ABS holding tanks	•	•	•
A/C chill grill	•••	•••	•••
Auto-ignition furnace w/thermostat	•••	•••	•••
Battery box for two batteries	••	••	••
Black holding tank sprayer	••	••	••
Cable and satellite TV prepped	•	•	•
Double 30-lb. propane tanks with regulator	•••	•••	•••
Hook-up for city water	•••	•••	•••
In-floor ducted heating	•••	•••	•••
Outside shower	•••	•••	•••
Outside utility center in front basement area (select models)	•	•	•
Systems monitor panel	•••	•••	•••
Water heater bypass system	•••	•••	•••
Water system winterization kit	•••	•••	•••

Standard Interior Equipment

	Fifth Wheel	Super Lite	Travel Trailers
20" LCD TV in living area	•	•	•
26" LCD High Definition TV, living area	••	••	••
Antique brass cabinet hardware	••	••	••
Antique brass lighting at sofa and dinette	••	••	••
Arched step treads into bathroom	•	•	•
Cable TV hookup w/RG6 coax cabling	•••	•••	•••
Ceiling fan	••	••	••
Crank-up TV antenna w/signal booster	••	••	••
Decorative nickel lighting over sofa and dinette	•	•	•
Fabric-covered box valances with lambrequin legs	•••	•••	•••
Free standing end table (n/a 325 BHS, 345 BHS)	•	•	•
Hardwood Message Center (select models)	•••	•••	•••
Hide-a-bed sofa	••	••	••
High-intensity 12V lighting package	••	••	••
J-Steel™ convertible sofa	•	•	•
Linoleum floor in entryway	•••	•••	•••
Manchester Oak raised-paneled doors and drawers throughout	•••	•••	•••
Oak trim around main entrance door	••	••	••
Overhead cabinets in slideout room above sofa w/ decorative glass	•••	•••	•••
Pleated night shades	•••	•••	•••
Residential furniture, designed and made by Jayco®	•••	•••	•••
Residential trim package throughout	•	•	•
Roof-mounted antenna for radio	•••	•••	•••
Solid hardwood interior grab handle for main entrance door	••	••	••
Swivel rocker(s) (select models)	••	••	••
Trackless carpeting w/pad	•••	•••	•••
TV overhead cabinet	•	•	•
Transom window with wood trim above main slideout room	•	•	•
Ventilating windows on slideout end walls	••	••	••

Wallpaper border

Standard Kitchen Equipment

	Fifth Wheel	Super Lite	Travel Trailers
3-burner range w/9,000-BTU SuperBurner™ and piezo igniter	•••	•••	•••
8 cu. ft. Flush-mounted refrigerator with double door 17" oven	••	••	••
Acrylic residential-style sink	•	•	•
Antique brass high-rise faucet	••	••	••
Ball bearing drawer guides throughout	•	•	•
Bi-fold cover for range	••	••	••
Color-coordinated countertops	•••	•••	•••
Decorative wood spindles on base cabinets	•	•	•
Deep-lipped overhead cabinetry	••	••	••
Deep residential-style sink	••	••	••
Deep storage drawers under booth dinette	•••	•••	•••
Drawer for silverware, divided for utensils	•••	•••	•••
Dream Dinette™ mechanism, raises and lowers dinette table top	•••	•••	•••
Extra large dinette picture window	•••	•••	•••
Mixing high-rise faucet	•	•	•
Oversized 21" oven	••	••	••
Range hood w/light and exhaust fan	•••	•••	•••
Removeable kitchen countertop extension (30.5 RLS)	•	•	•
Sink cover/cutting board (1)	••	••	••
Spice rack, built-in under kitchen sink (select models)	••	••	••

Standard Safety Equipment

	Fifth Wheel	Super Lite	Travel Trailers
Break-away switch	•••	•••	•••
Carbon monoxide alarm	•••	•••	•••
Dead-bolt lock on entrance door	•••	•••	•••
Dual hitch safety chains	••	••	••
Fire extinguisher	•••	•••	•••
Multiple egress windows	•••	•••	•••
Propane alarm	•••	•••	•••
Smoke alarm	•••	•••	•••
Tinted safety glass windows	•••	•••	•••

Options

	Fifth Wheel	Super Lite	Travel Trailers
2 Euro chairs ILO 2 swivel chairs	••	••	••
2 Rocker recliners ILO 2 swivel rockers	••	••	••
2nd 13,500 BTU A/C in bedroom	•	•	•
5500 W generator	•	•	•
Aluminum rims	•	•	•
CD stereo in bunk	•	•	•
CSA Standards	•••	•••	•••
Customer Value Package	•••	•••	•••
Customer Value Package with 15,000 BTU central air upgrade	••	••	••
Double bed bunks (325 BHS)	•	•	•
Euro chair w/ ottoman ILO swivel chair	•	•	•
Extendable dinette (select models)	•••	•••	•••
Exterior entertainment center	••	••	••
Free-standing table with 4 chairs	•••	•••	•••
Glass shower door	•	•	•
Generator prep	•	•	•
Hide-a-bed	•	•	•
Linoleum floor in living area	•••	•••	•••
Portable, outside gas grill	•••	•••	•••
Rocker recliner ILO swivel rocker	•	•	•
Roof ladder	••	••	••
Slideout awnings	••	••	••
Sofa ILO 2 chairs	•	•	•
Spare tire and tire carrier w/vinyl tire cover	•	•	•
Thermal pane tinted safety glass	••	••	••
Trundle bed ILO J-Cube™ futon	•••	•••	•••
Washer/Dryer combination	•	•	•
Water purification system	•	•	•

Customer Value Package

	Fifth Wheel	Super Lite	Travel Trailers
A Deluxe pillow-top mattress	•	•	•
Double 30-lb. propane bottles w/regulator	•	•	•
Extra insulation in roof	•	•	•
Floor mounted safe	•	•	•
Foldable, exterior grab handle	•	•	•
6-gal gas/electric DSI auto-ignition water heater	•	•	•
9-gal. XLT gas/electric DSI auto-ignition water heater	•	•	•
ABS tub surround	•	•	•
A/C central (13,500 or 15,000 BTU) and wall thermostat with louvered-directional ceiling vents	•	•	•
Bathroom power vent	•	•	•
Bi-fold cover for range	•	•	•
Carefree® Trav'l'r 12 volt patio awning	•	•	•
B Home theater system, Dolby® Digital 5.1 Surround Sound w/DVD	•	•	•
C Microwave oven with carousel	•	•	•
Quilted bedspread	•	•	•
Security lights (2)	•	•	•
Skylight in tub/shower	•	•	•
Shirt wardrobes in bedroom	•	•	•
Sink cover/cutting board(1)	•	•	•
Water heater bypass system	•	•	•
Water purification system	•	•	•

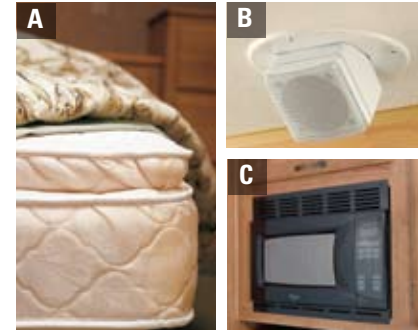

Eagle Travel Trailer & Fifth Wheel



Boston Berry



Monterey Moss



Traverse City Taupe

Eagle Super Lite

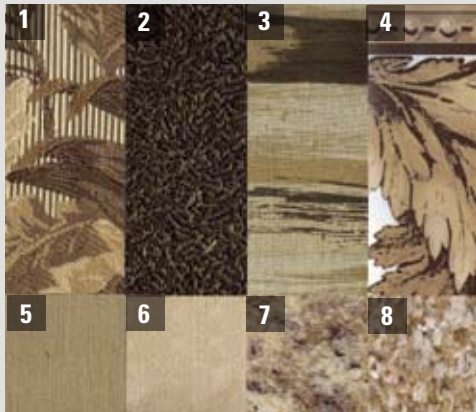

Whole Wheat



Blue Moon



Desert Sage

1. Main 2. Chair Upholstery 3. Bedspread 4. Wallpaper 5. Drapery 6. Accent Panel 7. Counter Top 8. Carpet



Baggage doors lockable, insulated and radius-cornered



Big Easy entrance step with 10" deep treads

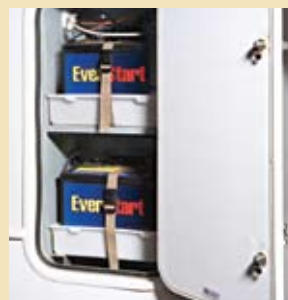

Battery box for two batteries (FW only)



Hardwood Message Center (select models)



8 cu. ft. Flush-mounted refrigerator with double door

Travel Trailers

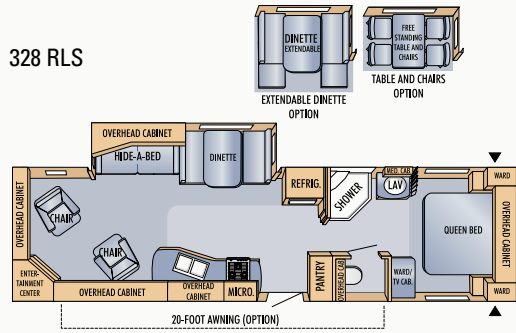
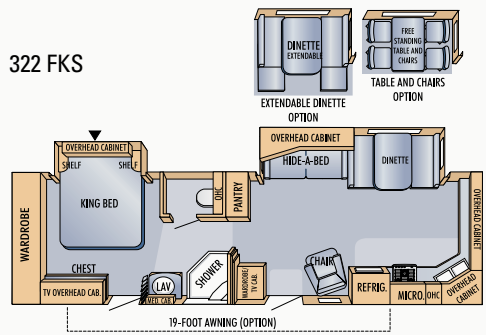
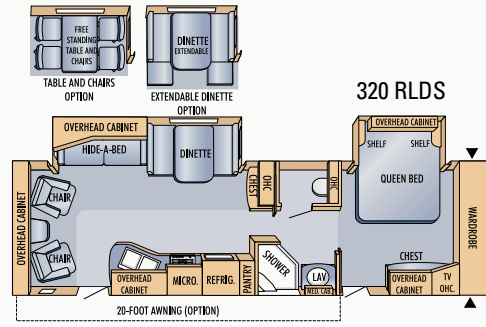
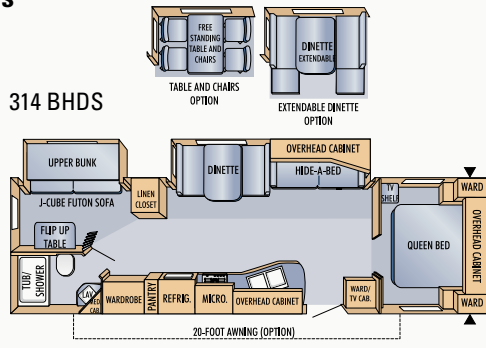

Super Lite

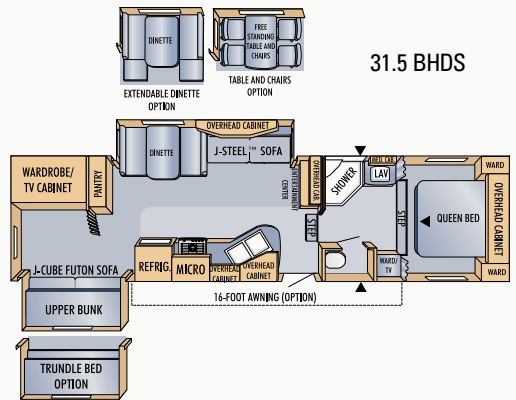
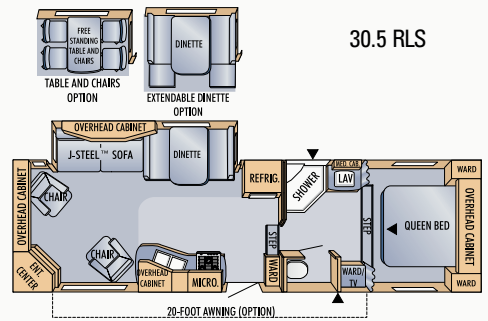
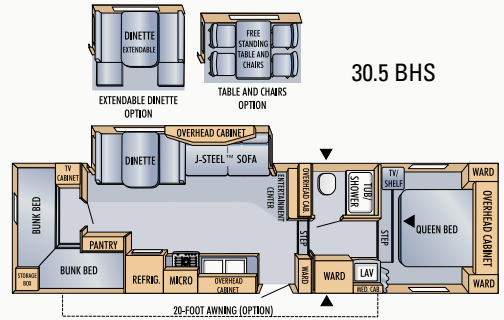
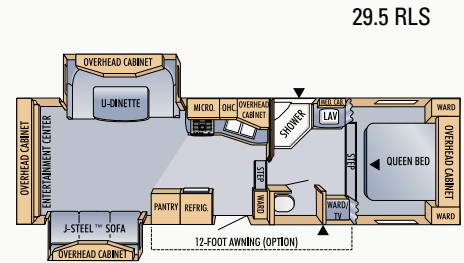

Super Lite

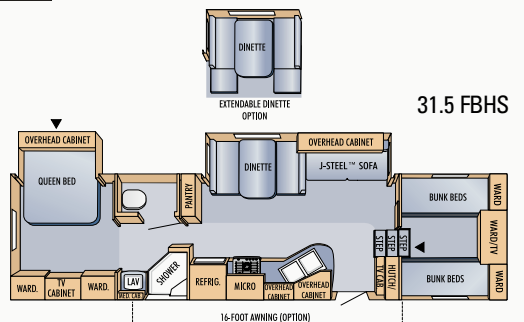
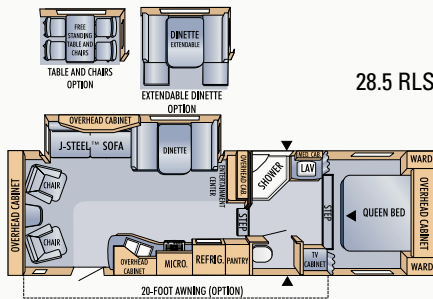
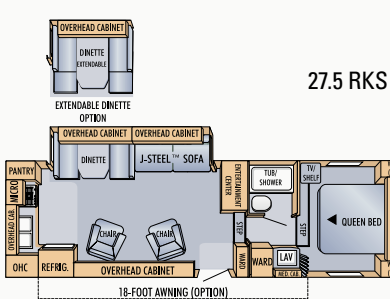

Fifth Wheels

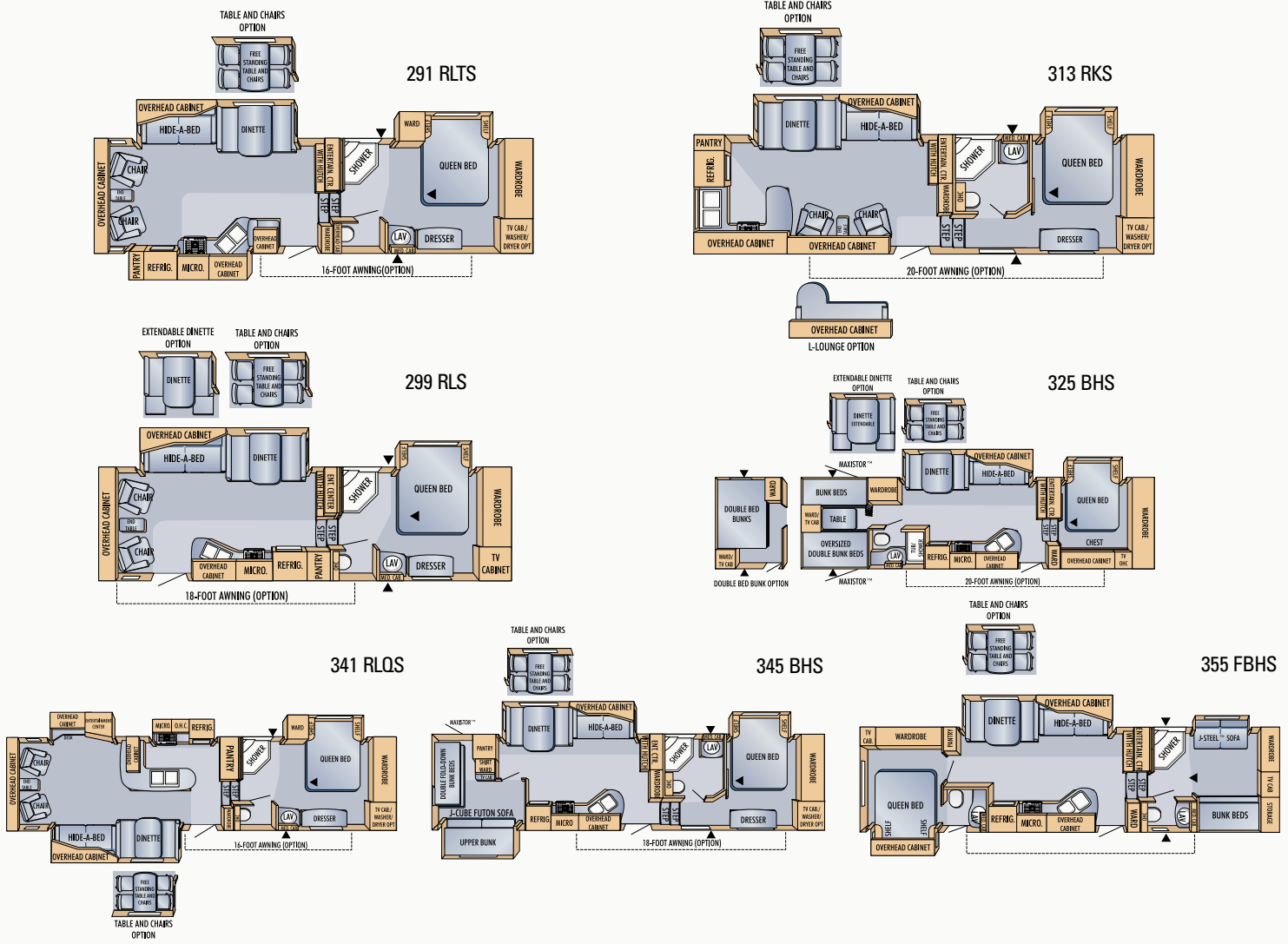

2008 Specifications and Measurements

	Floorplans	Exterior Length	Exterior Height (with A/C)	Interior Height	Unloaded Vehicle Weight (lbs.)	Dry Hitch Weight (lbs.)	Gross Vehicle Weight Rating (lbs.)	Cargo Carrying Capacity (lbs.)	Fresh Water Capacity (gal.)	Gray Wastewater Capacity (gal.)	Toilet/Black Wastewater Capacity (gal.)
Eagle TT	314 BHDS	33' 11"	134"	81"	7,535	850	9,500	1,965	46	37	37
	320 RLDS	35' 6"	134"	81"	8,020	1,070	9,900	1,880	46	37	37
	322 FKS	33' 11"	134"	81"	7,910	1,140	9,750	1,840	46	85.5	48.5
	328 RLS	34' 11"	134"	81"	7,205	1,015	9,500	2,295	46	74	37
	329 RLQ	34' 11"	134"	81"	7,205	1,015	9,500	2,295	46	74	37
Eagle FW	291 RLTS	35' 4"	148"	76"	10,655	2,415	13,500	2,845	46	72	35
	299 RLS	30' 9"	158"	77"	9,395	1,825	12,500	3,105	46	80	45
	313 RKS	34' 11"	157"	77"	10,120	2,440	13,000	2,880	46	70	35
	325 BHS	36'	157"	76"	10,152	1,940	13,000	2,848	46	82	45
	341 RLQS	37' 4"	157"	77"	11,430	2,315	14,500	3,070	46	70	35
	345 BHS	37' 9"	157"	77"	10,985	2,275	14,500	3,515	46	70	35
	355 FBHS	38' 5"	157"	77"	11,165	2,290	14,500	3,335	46	80	80
Eagle Super Lite FW	27.5RKS	29' 8"	145"	76"	6,940	1,290	87.50	1,810	46	65	32.5
	28.5RLS	30' 6"	142"	76"	7,300	1,495	9,700	2,400	46	65	32.5
	29.5RLS	31' 7"	143"	76"	7,815	1,425	10,000	2,185	46	65	32.5
	30.5BHS	32' 8"	142"	61"	7,650	1,410	9,900	2,250	46	65	32.5
	30.5RLS	32' 2"	142"	76"	7,410	1,605	9,900	2,490	49	65	32.5
	31.5BHDS	33' 11"	144"	76"	8,345	1,385	10,700	2,355	46	65	32.5
	31.5FBHS	33' 11"	145"	61"	8,260	1,565	10,700	2,440	46	65	32.5

It is important for your safety and enjoyment that your tow vehicle be adequately sized and equipped to tow and handle the GVWR of the RV you select. Review weights and rating of your tow vehicle and consult a competent advisor for questions or advice. Whether you are new to RVing or a veteran, get a feel for the performance of your tow vehicle and the RV together before heading out on the roadways. When you tow an RV, you must drive differently than you do when driving a single vehicle. Practice hooking up, driving, backing up and braking in a safe environment or seek out professional instruction. Jayco affixes a weight label to each RV which lists weight information for that vehicle. See specification chart to the left.

Unloaded Vehicle Weight (UWV): Sometimes referred to as "Dry Weight," UWV means the typical weight of this trailer as built at the factory. The UWV, as used in product literature and other promotional materials, does not include cargo, fresh water, propane, options or dealer-installed accessories.

Gross Vehicle Weight Rating (GVWR): GVWR means the maximum permissible weight of the trailer, including the UWV plus passengers, personal items, all cargo, fluids, options, and dealer-installed accessories. The GVWR is equal to or greater than the sum of the UWV and the CCC.

Cargo Carrying Capacity (CCC): CCC means the maximum weight of all passengers, personal items, food, fresh water, propane, tools, other cargo and dealer-installed accessories that can be carried by the trailer. CCC is equal to less than GVWR minus UWV. The addition of options will decrease the CCC.

Hitch Weight (HW): The hitch weight, as used in product literature and other promotional materials, does not include cargo, fresh water, propane gas, options or dealer-installed accessories. The addition of these types of items will either add to or subtract from the stated hitch weight.

Customer First Roadside Assistance

Travel worry-free in your Eagle with Jayco's Customer First Roadside Assistance program, yours at no cost during your first year of ownership. This program is offered through Coach-Net®, the largest RV emergency road service in the country, and gives you immediate access to dependable roadside assistance and support services with a simple phone call.

- Free jump starts
- Free tire changes
- Free fuel delivery
- Free lockout service
- Free traveler's checks
- 24-hour toll-free emergency message service
- Toll-free nationwide service appointment assistance
- Free custom trip routing and full color map service
- Free dispatch of on-site mechanical service
- \$1,000 auto theft or hit-and-run reward
- \$2,000 trip interruption reimbursement

We Back What We Build.

The Jayco Co-Pilot Warranty is a manufacturer's limited warranty. It comes from the people who build Jayco recreation vehicles to the people who buy them. Each Jayco is warranted to the original purchaser for twenty-four (24) months or twenty-four thousand (24,000) miles (mileage limitation applies to motorized products only), whichever occurs first, from the original date of purchase against defects in materials and workmanship. Jayco's limited warranty is not transferable. Go ahead and compare the Jayco warranty with other manufacturers' warranties. You'll find it's the best in the business!

For a copy of the limited warranty with full terms and conditions, ask your local Jayco dealer.



Your Jayco Dealer

JayPlus

Protect your RV investment. Ask your Jayco dealer about our exclusive JayPlus program today.



As a Jayco owner, you can be part of the Jayco Jafari International Travel Club. Ask your dealer about the Jafari "flight" in your area, write Jayco or visit our website.



AMERICA'S MOST LIVEABLE RVs.

Jayco, Inc., P.O. Box 460, Middlebury, IN 46540 www.jayco.com

See dealer for further information and prices. All information in this brochure is the latest available at the time of publication approval. Jayco reserves the right to make changes and to discontinue models without notice or obligation. Photos in this brochure may show optional equipment or props used for photography purposes. RVs built for sale in Canada may differ to conform to Canadian codes. RVQ is a registered trademark of Vitco, Inc. E-Z Lube is a registered trademark of the Dexter Axle Company. Carefree is a registered trademark of Carefree of Colorado. Dolby and the double-D symbol are registered trademarks of Dolby Laboratories. ©2007 Jayco, Inc. 08-EAGL-PL 0108-50K Printed in U.S.A. 