

*The Shape of
Things to
Come*



2007

Challenging Convention

► a story of progress

During a brainstorming session on new product ideas, we raised a number of simple, yet thought provoking questions about standard Travel Trailer design.

- Why waste three feet of the frame at the front of a travel trailer?
- Why build travel trailers with a wind deflecting, flat front wall?
- Why place the LP bottles exposed on the front frame where they become dented and rusted?
- Why use 30 pound bottles when they are heavy and have to be refilled instead of exchanged?
- Why use narrow axles which cause the unit to sway while being towed?



VR1 realized the answers to these questions were obvious and it was time to rethink the conventional design used for the past forty years.

After two years of designing, engineering, and thorough testing, Keystone RV has developed the most aerodynamic, easy-to-tow and spacious travel trailer on the road.



► floorplans

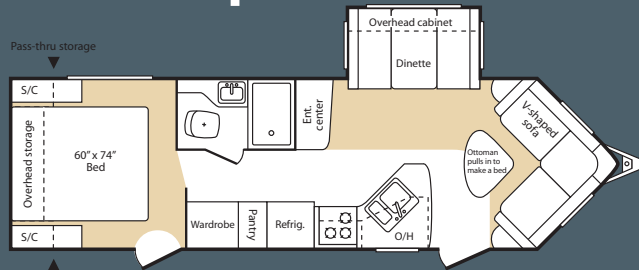

279 FLS

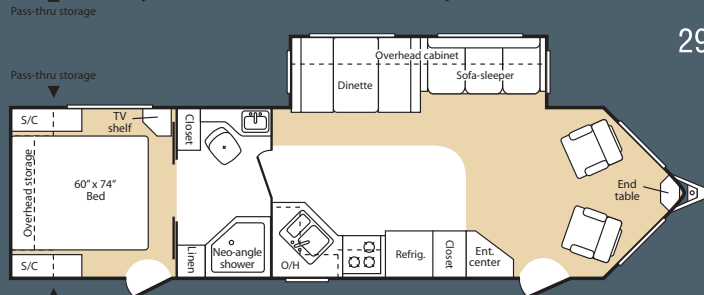

297 FLS

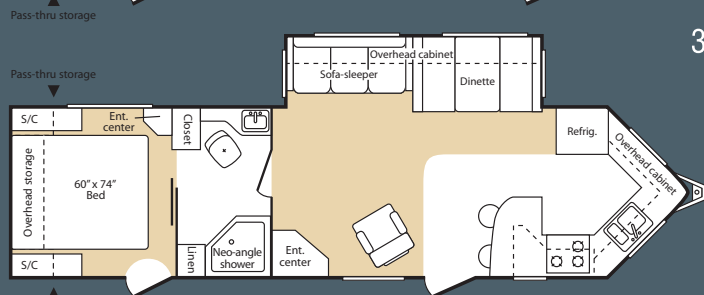

305 FKS

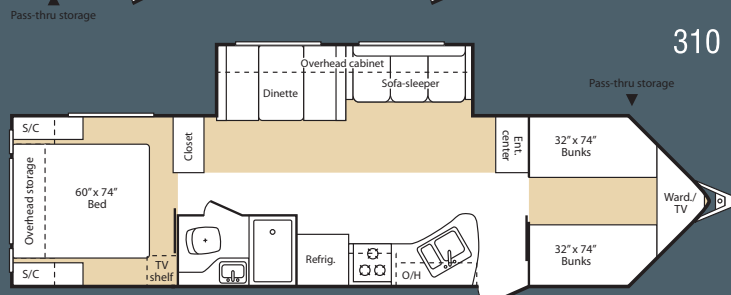

310 BHS

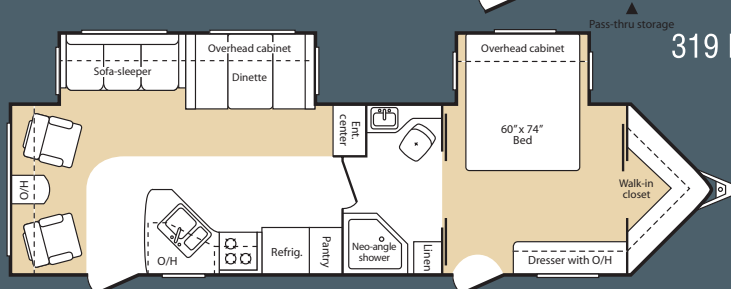

319 RLDS

► the shape of performance

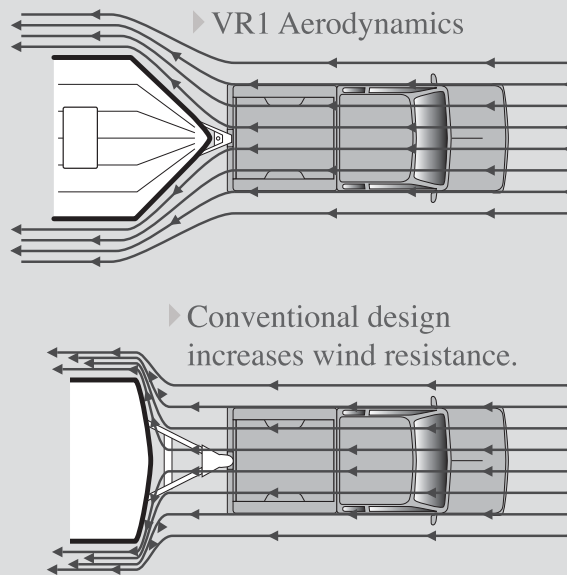

► decor options

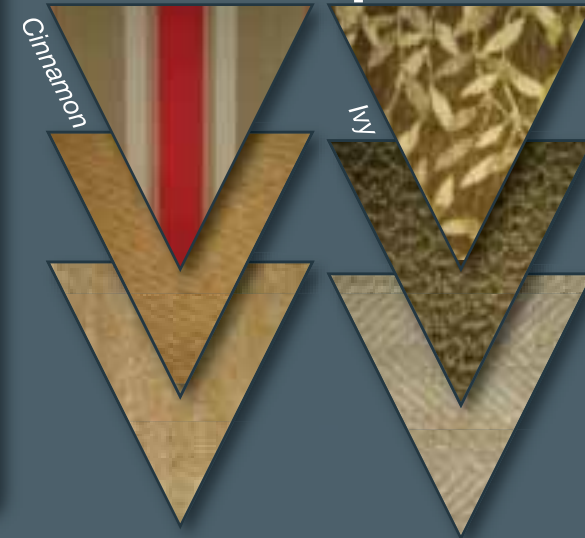

► specifications

	275FBS	279FLS	297FLS	305FKS	310BHS	319RLDS	328BHDS
Shipping Weight	6430	6485	6775	6900	6995	7615	TBD
Carrying Capacity	3030	3220	2850	2855	2620	1935	TBD
Hitch	660	905	825	955	780	750	TBD
Exterior Length	30' 1"	29' 9"	32' 9"	33'	33' 11"	33' 11"	33' 11"
Ext Height	11' 3"	11' 2"	11' 2"	11' 3"	11' 3"	11' 3"	11' 3"
Fresh Water	45	45	45	45	45	45	45
Waste Water	30	30	30	30	30	30	30
Grey Water	30	30	30	60	30	30	30
LPG Capacity (lb)	60	60	60	60	60	60	60
Tire Size	225/75D15D	225/75D15D	225/75D15D	225/75D15D	225/75D15D	225/75D15D	225/75D15D
Number of Slides	1	1	1	1	1	2	2
Awning	19'	17'	17'	17'	17'	17'	17'



**Keystone RV
Company**

Your VR1 Dealer:



2642 Hackberry Dr. • Goshen, IN • 46526 • 574.535.2100 • www.keystone-vr.com



Cinnamon décor shown in our flush floor, super slide-room. The extra-deep overhead cabinets provide ample storage and accommodate full size dinner plates.



► Standards

Exterior:

- Welded, aluminum framed walls • Laminated, gel coated filon fiberglass sidewalls • 5" trussed roof rafters • Fully heated and enclosed underbelly including: water and holding tanks, water lines, and dump valves • 15" tires • Seamless, one piece floor decking • Rubber roof • Rain gutters with down spouts • Aero-dynamic molded TPO front top cap

Interior:

- All wood cabinet stiles, predrilled and screwed together • Entertainment center with TV cabinet • Flush floor slide room in living room • Flip up TV shelf in bedroom • Deluxe innerspring mattress • Steel drawer glides with ball bearing rollers • Deep acrylic sinks with metal faucets

Value Package:

- CD/AM/FM stereo with four speakers • 6 gallon gas/electric water heater with direct spark ignition • TV antenna • Cable hook-up • Skydome over shower • Four crank down stabilizer jacks • Water heater bypass switch • Porcelain toilet • Exterior shower • 15" spare tire kit • Carbon monoxide detector • LP leak detector

"V" Executive Package:

- Mor/ryde rubber tongue suspension • Black trimmed, tinted safety glass windows • Upgraded jack knife sofa • Hi output range with auto ignitor and 22" oven • Microwave oven • 13,500 BTU air conditioner • ALKO Kober EZ lube axles • Wide stance axles • A & E awning

► Options

- Swivel rocker chairs • Hide a bed sofa ipo Jack knife • Free standing dinette with four chairs • 15,000 BTU A/C • 20" TV in Living Room



Our Ivy décor and warm accent lighting create an inviting atmosphere. Additional enhancements include the optional Hide-a-Bed sofa, free-standing dinette, solid wood table, and four chairs with cushion seat storage.



Left: By using the extra space provided by our V design, we were able to build a unique kitchen with more countertop surface area and cabinet storage than any other travel trailer.

Right: Wide-open entry ways between rooms eliminate the "closed in" feeling noticeable on most RV's. Our deluxe innerspring mattress with matching décor bedspread and headboard provide a touch of elegance to your bedroom.