

2007

Hornet

by Keystone

Based on a true story, Yours





Imagine...

a vacation with less preparation, packing, planning and no need to call ahead for reservations. Now imagine yourself in a stylish retreat that includes all the comforts of home. With a wide range of floor plans and features that are typically seen on more expensive trailers, Hornet gives you a high-end look without the high-end price.



Hornet's model 30FKS features a deep double-bowl sink, high-rise faucet and oversize countertop. All cabinetry is securely assembled with screws featuring raised panel upper cabinet doors and solid wood drawer fronts.



Hornet Model 30BHS features extra storage areas which are carefully designed to not impede precious floor space.

Model Year '07 Decor Choices

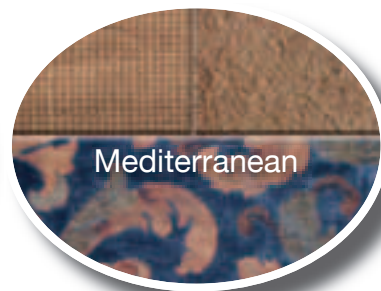

Eighteen

versatile floor plan options
from which to choose the ideal
travel trailer or fifth wheel.
Hornet has them all!

26RBS



27DBS

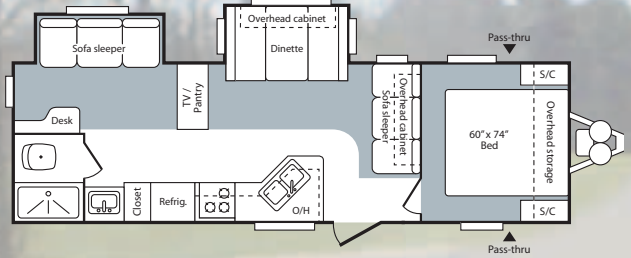

245RK Fifth Wheel

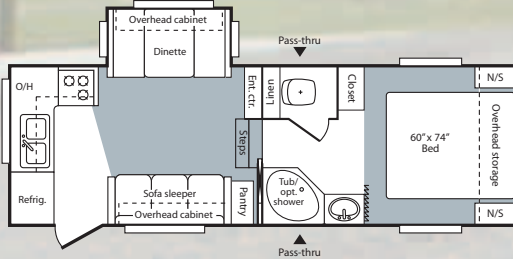

27BHS

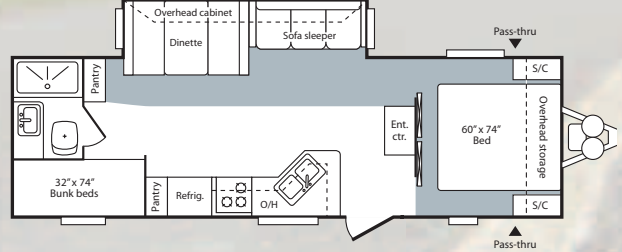

258BH Fifth Wheel

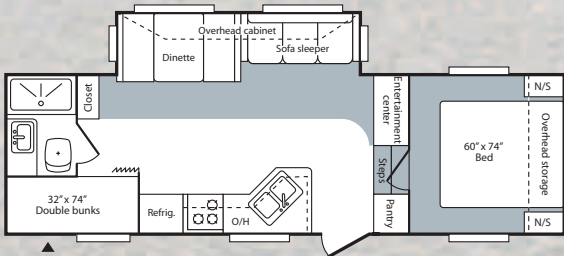

27FLDS

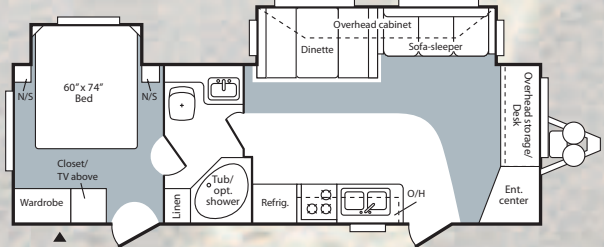

295BH Fifth Wheel

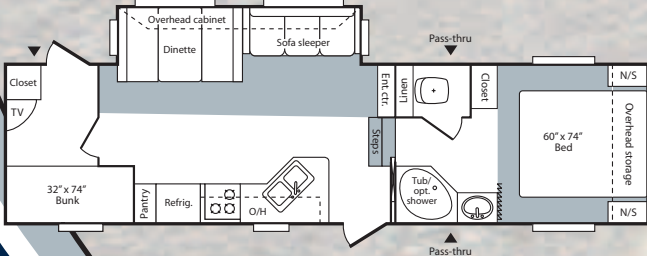

You look forward to the many conveniences and comforts an RV provides; it's the ultimate freedom vehicle! So whether you choose to travel on the weekend or park at a permanent campsite, the Retreat's residential features and special towable design allow for maximum flexibility.

38BHDS

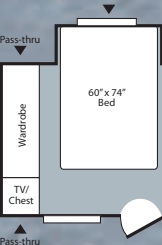

28BHDS

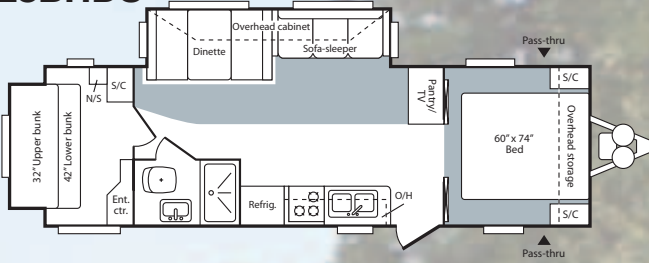

29RLS

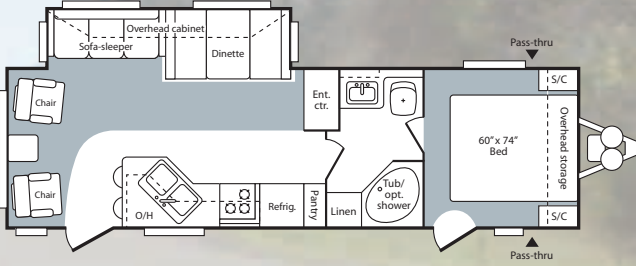

31RLDS

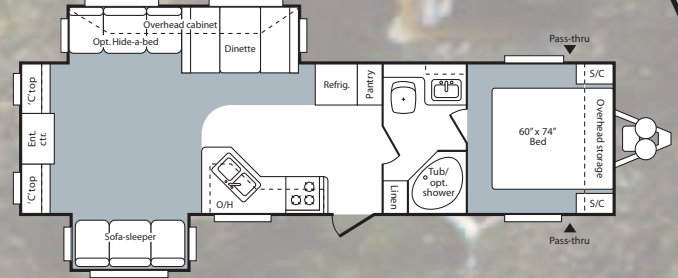

30BHS

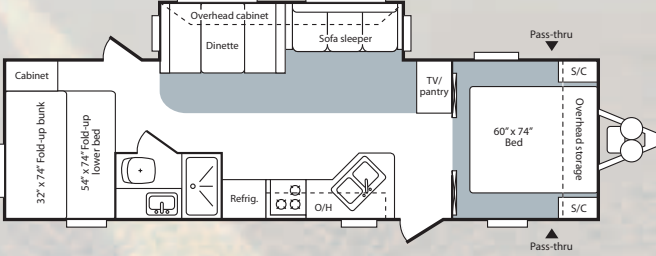

32BHDS

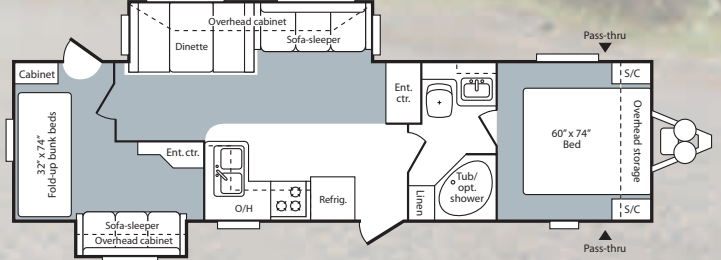

30FKS

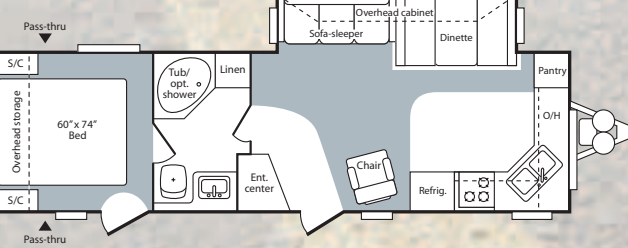

33FLDS

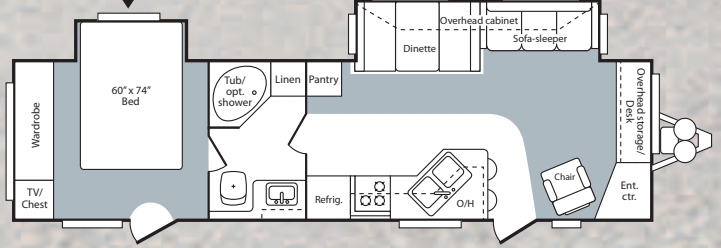

37FKDS

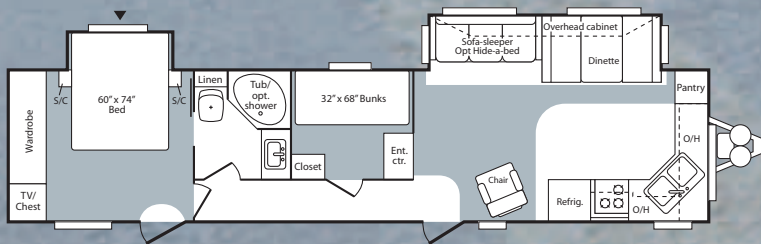

38DQDS

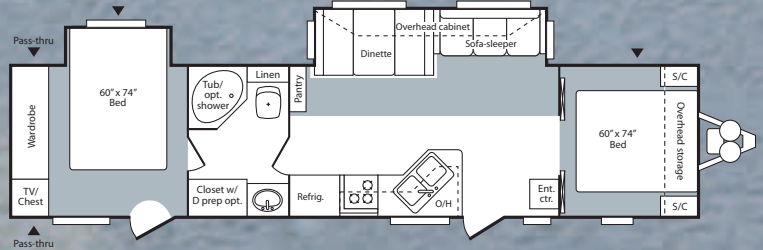

38BHDS Bunk Opt.

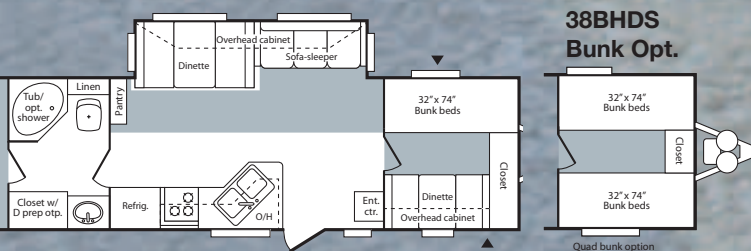

38FLDS

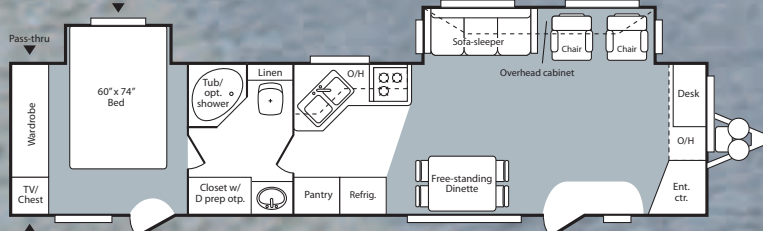



Hornet's 30BHS adds even more versatility with flip-down bunk beds. When flipped up, these remarkably comfortable beds add an additional 180 cubic feet of living space.

Unbeatable options

Hornet Travel Trailer and Fifth Wheel Models

Interior Standards

- Raised oak cabinet doors (uppers)
- Oak framed cabinet doors (tongue and groove)
- Lumbercore cabinet stiles (screwed together)
- Oak drawer fronts
- AM/FM/CD Stereo with 4 speakers (True Sound DVD: mandatory option)
- Mini blinds
- Decorative light at dinette and pin up light
- Clock
- Swivel Rocker (29RLS, 30FKS, 33FLDS)
- Second swivel rocker (29RLS)
- Wallpaper border
- Extra large double bowl kitchen sink
- High rise kitchen faucet
- Sink cover
- 3 burner range with oven
- Microwave
- 6 cubic ft. fridge with temperature control
- Countertop extension (where available)
- Knife rack
- Silverware tray
- Storage door at dinette (1) - booth dinette only
- Bar stools (29RLS & 33FLDS)

- Bedspread with pillows
- Bed lifters
- Foot flush porcelain toilet
- Tub surround
- 13.5 BTU Ducted A/C with "Quick Cool"
- 6 Gallon gas/electric water heater w/ DSI
- TV antenna & cable hookup

Exterior Standards

- .024 gauge mesa metal exterior
- Tinted safety glass
- Diamond plate front rock guard
- Stabilizer jacks
- Dual 30-lb. LP bottles with cover and auto change
- Ultra lube axles
- Awning
- Hitch light
- Enclosed and heated fresh water tank
- EZ glider entry step
- White radius clamping windows
- Rubber roof
- Drip rails and downspouts
- Pass-thru storage (most models)

- Electric slide mechanism(s) (single slide models and 27FLDS / 28BHDS)
- Hydraulic slide mechanisms (33FLDS, 32BHDS)

Optional Equipment

- 15,000 BTU A/C with "Quick Cool" in place of 13.5 BTU A/C
- True Sound Entertainment System with DVD (Mandatory option - all models)
- Patio door with vertical blind (30FKS, 33FLDS, 36BHS)
- 8 cu ft. fridge (32BHDS, 33FLDS)
- Free standing table and chairs
- Hide-A-Bed sofa (N/A 245RK)
- Garden shower (27FLDS, 29RLS, 30FKS, 32BHDS, 33FLDS)
- Spare tire carrier and cover
- Exterior shower
- Rear ladder (N/A 28BHDS)
- Carbon monoxide detector (Mandatory)
- RVIA
- CSA
- Under-mount spare tire (mandatory 28BHDS, N/A all other models)



All Hornet Retreat models feature a full-wall wardrobe in the bedroom as well as a bed slide to give you the spacious feel of home.

The large bathroom offers additional closet space as well as a large garden tub (shown) or optional shower.



Retreat

Hornet "Retreat" Models

Interior Standards

- Raised oak cabinet doors (uppers)
- Oak framed cabinet doors (tongue and groove)
- Lumbercore cabinet stiles (screwed together)
- Oak drawer fronts
- AM/FM/CD Stereo with 4 speakers (True Sound DVD: mandatory option)
- Mini blinds
- Decorative light at dinette and pin up light
- Clock
- 2 Swivel rockers (38FLDS only)
- Wallpaper border
- Extra large double bowl kitchen sink
- High rise kitchen faucet
- Water purifier
- Sink cover
- 3 burner range with oven
- Microwave
- 8 cubic ft. fridge with temperature control
- Countertop extension
- Knife rack
- Silverware tray
- Foot flush porcelain toilet
- Storage door at dinette (1) - booth dinette only
- Bedspread with pillows

- Bed lifters
- Tub surround
- 15.0 BTU Ducted A/C with "Quick Cool"
- 6 Gallon gas/electric water heater with DSI
- TV antenna & cable hookup
- Exterior Shower

Exterior Standards

- .024 gauge mesa metal exterior
- Tinted safety glass
- Diamond plate front rock guard
- Dual 30-lb. LP bottles with cover and auto change
- Ultra lube axles
- Awning
- Hitch light
- Enclosed and heated fresh water tank
- Large folding entry assist handle
- EZ glider entry step
- White radius clamping windows
- Rubber roof
- Drip rails and downspouts
- Pass-thru storage (most models)
- Hydraulic slide mechanisms

Optional Equipment

- Prep for second A/C (requires 50 AMP service)
- 50 AMP service
- Washer/Dryer prep with 50 AMP Service (NA 37FKDS)
- 10 gallon gas/electric water heater with DSI
- True Sound Entertainment System with DVD (Mandatory option - all models)
- Residential Refrigerator
- Patio door with vertical blind
- Free standing table and chairs (standard in 38FLDS)
- Hide-A-Bed sofa
- Quad bunk (in front of 38BHDS only)
- Garden shower
- Spare tire carrier and cover
- Stabilizer jacks
- Rear ladder
- Carbon monoxide detector (Mandatory)
- CSA

all in the details...



1. Stabilizer jacks standard on all models (excluding Hornet Retreat).
2. Ultra-lube axles eliminate the need to re-pack your bearings.
3. Look for the ▲ on Hornet floor plans for the location of exterior access (pass-thru on most models) storage space.
4. Large windows help to enhance your views. Tinted safety glass is standard on all models.

5. The oversized residential kitchen sink is large enough for pots and pans.
6. 30# LP bottles with cover and hitch light. The diamond plate front rock guard helps to protect from road debris.
7. Extra storage space under your sofa is an added convenience (not available with hide-a-bed option).

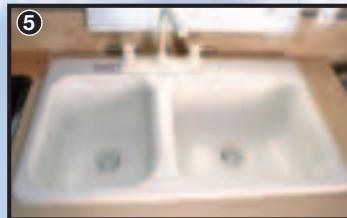
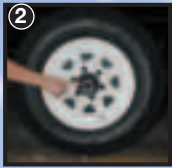

Hornet Travel Trailers

	26RBS	27BHS	27DBS	27FLDS	28BHDS	29RLS	30BHS	30FKS	31RLDS	32BHDS	33FLDS
Shipping Weight	6365	6455	6835	6965	6885	6750	6765	6755	7595	7870	7895
Carrying Capacity	3635	3545	3165	3035	3115	3250	3235	3245	3465	3190	3330
Hitch	815	805	665	965	910	715	780	1115	900	900	1065
Exterior Length	30' 1"	30' 7"	30' 11"	29' 10"	30' 10"	31' 10"	33' 1"	32' 2"	34' 4"	35' 6"	35' 6"
Exterior Width	8'	8'	8'	8'	8'	8'	8'	8'	8'	8'	8'
Ext Height	10' 10"	10' 9"	10' 10"	10' 9"	10' 1"	10' 9"	10' 9"	10' 9"	10' 10"	10' 10"	10' 10"
Fresh Water Capacity	45	45	45	45	45	45	45	45	45	45	45
Waste Water Capacity	38	38	32	38	38	38	38	38	38	38	38
Grey Water Capacity	70	38	38	38	38	38	38	76	38	76	38
Tire Size	225/75D15D	225/75D15D	225/75D15D	225/75D15D	225/75D15D	225/75D15D	225/75D15D	225/75D15D	225/75D15D	225/75D15D	225/75D15D
Awning	16'	16'	16'	16'	18'	18'	18'	18'	12'	16'	21'

Hornet Retreat

	37FKDS	38BHDS	38DQDS	38FLDS
Shipping Weight	8450	8485	8390	8565
Carrying Capacity	3110	2800	2975	2855
Hitch	1400	1225	1205	1260
Exterior Length	39' 10"	39' 10"	39' 10"	39' 10"
Exterior Width	8'	8'	8'	8'
Ext Height	10' 10"	10' 10"	10' 10"	10' 10"
Fresh Water Capacity	45	45	45	45
Waste Water Capacity	38	38	38	38
Grey Water Capacity	76	38	38	38
Tire Size	225/75D15D	225/75D15D	225/75D15D	225/75D15D
Awning	21'	21'	21'	21'

Hornet Fifth Wheels

	245RK	258BH	295BH
Shipping Weight	6705	7015	7800
Carrying Capacity	3295	2985	3700
Hitch	1065	1460	1500
Exterior Length	25' 11"	28' 2"	31' 8"
Exterior Width	8'	8'	8'
Ext Height - Top of A/C	11' 8"	11' 8"	11' 8"
Fresh Water Capacity	45	45	45
Waste Water Capacity	38	32	38
Grey Water Capacity	70	38	76
Tire Size	225/75D15D	225/75D15D	225/75D15D
Awning	16'	18'	21'

Your Hornet Dealer:



Keystone RV Company



2642 Hackberry Dr., Goshen, IN 46526
574-535-2100 • www.keystone-hornet.com

Product information is as accurate as possible as of the date of publication of this brochure. Features, floor plans, and specifications are subject to change without notice. Please also consult Keystone's web site at keystone-rv.com for more current product information and specifications. Tow Vehicle Disclaimer. CAUTION: Owners of Keystone recreational vehicles are solely responsible for the selection and proper use of tow vehicles. All customers should consult with a motor vehicle manufacturer or their dealer concerning the purchase and use of suitable tow vehicles for Keystone products. Keystone disclaims any liability or damages suffered as a result of the selection, operation, use or misuse of a tow vehicle. KEYSTONE'S LIMITED WARRANTY DOES NOT COVER DAMAGE TO THE RECREATIONAL VEHICLE OR THE TOW VEHICLE AS A RESULT OF THE SELECTION, OPERATION, USE OR MISUSE OF THE TOW VEHICLE.