



2007 Ultra-Lite Travel Trailers

All Models Weigh Less
Than 3000 Pounds!





ECO, the next generation in ultra-lite travel trailers.

Weighing under 3000 lbs., *Eco* can be towed by most midsize SUV's and minivans. Plus, the aerodynamic design and 7' wide body reduces wind drag to increase fuel economy.

Eco may be light in weight, but it's not on features and value. All floorplans feature multiple sleeping locations and a full bathroom. Plus, *Eco* features all the appliances found in larger RV's including a 2-burner cooktop, refrigerator, microwave, AM/FM/CD stereo, furnace, and water heater.

ECO - The smart choice!

Premium Interior Design

Eco features designer décors with luxurious fabrics, hard wood upper cabinet doors and residential vinyl flooring. Plus, storage is not compromised in *Eco*. All models feature wardrobes, overhead cabinets and a spacious exterior compartment.



Comfortable and Spacious Sleeping Spaces

The multiple sleeping locations are designed to be spacious and comfortable. The dinette folds into a bed, and all models include a folding overhead bunk. *Eco's* floorplans sleep up to 5 people. Choose the model that fits your family!



FLOORPLANS & SPECIFICATIONS

Axle Weight	2006	Exterior Height with A/C	9'6"
Dry Hitch Weight	201	Exterior Width	7'
Unloaded Vehicle Weight	2207	Fresh Water Capacity	27
GVWR	3450	Gray Water Capacity	36
Net Cargo Capacity	1243	Black Water Capacity	22
Exterior Length	14' 9"	Furnace Size (BTUs)	16,000
Tire Size	205/75D14C		

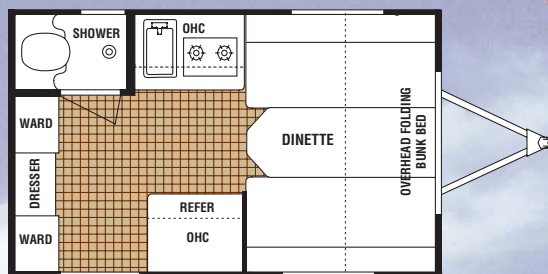

713FD

Axle Weight	2207	Exterior Height with A/C	9'6"
Dry Hitch Weight	174	Exterior Width	7'
Unloaded Vehicle Weight	2381	Fresh Water Capacity	27
GVWR	3850	Gray Water Capacity	36
Net Cargo Capacity	1469	Black Water Capacity	22
Exterior Length	16' 9"	Furnace Size (BTUs)	16,000
Tire Size	205/75D14C		

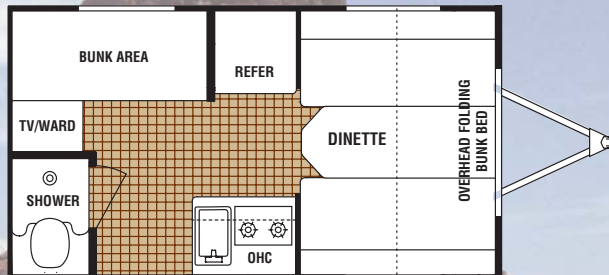

716FD

Axle Weight	2545	Exterior Height with A/C	9'6"
Dry Hitch Weight	231	Exterior Width	7'
Unloaded Vehicle Weight	2776	Fresh Water Capacity	27
GVWR	4840	Gray Water Capacity	36
Net Cargo Capacity	2064	Black Water Capacity	22
Exterior Length	18' 9"	Furnace Size (BTUs)	16,000
Tire Size	205/75D14C		

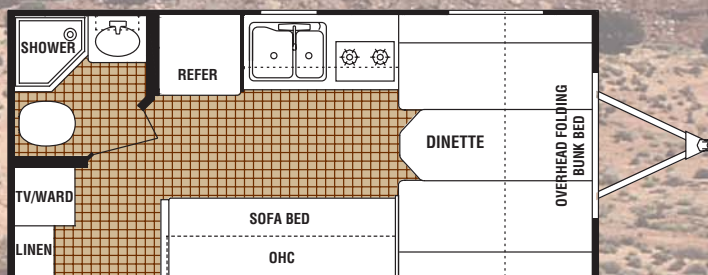

718FD

Axle Weight	2571	Exterior Height with A/C	9'6"
Dry Hitch Weight	249	Exterior Width	7'
Unloaded Vehicle Weight	2760	Fresh Water Capacity	27
GVWR	4840	Gray Water Capacity	36
Net Cargo Capacity	2080	Black Water Capacity	22
Exterior Length	18' 9"	Furnace Size (BTUs)	16,000
Tire Size	205/75D14C		

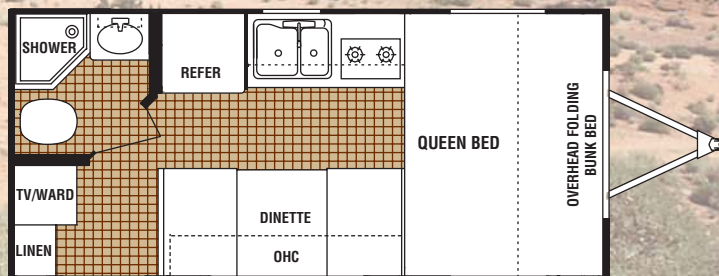

718QB



Vehicle Loading - Every effort has been made to provide the greatest number of options for the recreation vehicle owner. Along with these choices comes the responsibility to manage the loads that are imposed by the choices so that they remain within the manufacturer's specified chassis weight limits. Do not overload the recreation vehicle. Net carrying capacity (NCC) determined by subtracting unloaded vehicle weight (UVW) from gross vehicle weight (GVWR) and includes fluids, options and cargo. Liquid capacities and weights are approximations only. Warning: This information is intended as a guide only. Weights of individual vehicles may vary. Consult your owner's manual for complete loading, weighing and towing instructions.

Eco - Easy-to-Tow and Easy on Your Fuel Bill!



STANDARD & OPTIONAL FEATURES

Standard Features

Exterior

- 7' Wide floorplans
- 6-Way welded-aluminum, laminated superstructure (roof, floor and walls)
- Lite-weight European-style frame with lifetime rust-through warranty
- Rubber torsion "independent suspension" axle
- Two 20 lb. LP bottles with ABS cover
- 26" radius corner entry door
- Flush combo entry latch/deadbolt lock
- Single axle with electric brakes (713FD & 716FD)
- Tandem axles with 4-wheel electric brakes (18' floorplans)
- ABS fender skirts
- EPDM one-piece seamless rubber roof
- Corrosion free laminated underbelly
- Patio light
- High-end designer graphics
- Rain gutter with corner downspouts
 - Single entry step
 - Aluminum rims

- Radius corner, clamp-ring windows
- Entry-assist handle at door
- Break-away trailer switch
- 120V Exterior outlet

Interior Features

- Wet bath - shower & toilet combo (some models)
- Power roof vent and skylight in bath
- 4" Thick, reversible dinette seats
- Designer window treatments
- Mini blinds throughout
- Residential tile-like linoleum

Appliances and Electrical

- 16,000 BTU forced air DSI furnace with wall thermostat
- 30 Amp power cord with storage compartment
- 6 Gallon gas water heater with bypass
- 12V interior lights
- Fire extinguisher
- LP detector
- Carbon monoxide detector
- Smoke detector

- Norcold single door gas/electric refrigerator
- Pre-wired for air conditioning
- 12V Water pump
- Pre-wired for cable TV and stereo
- Range hood with 12V light and exhaust fan
- Solid state converter with built-in battery charger
- Systems monitor panel

Optional Features

- 13,500 BTU Roof air conditioning
- Awning
- Microwave
- AM/FM/CD stereo with 2 speakers
- Outside speakers
- TV antennae with booster
- Gas/electric/DSI 6 gallon water heater
- Hot and cold exterior spray away shower
- Exterior barbecue grill
- Fantastic fan
- Spare tire

TWO YEAR STRUCTURAL AND APPLIANCE WARRANTY • ONE YEAR BUMPER TO HITCH WARRANTY

*See owner's manual for complete warranty details

Product information, specifications, and photography in this brochure were as accurate as possible at time of printing. Photographs may contain some features that are optional on your vehicle. Since we continually strive to improve our products, actual products may differ. Prices and specifications are subject to change without notice. All capacities are approximate and dimensions are nominal. Some features shown are optional and may be different or unavailable in Canada. Vehicles are designed for recreational use only and not intended for use as a primary residence.

All product brand names used in this brochure are registered trademarks of Thor Industries, Inc. Unauthorized use of trademarks is prohibited by law.

2164 Caragana Court • Goshen, IN 46526
Sales: 574.537.0600 • Fax: 574.975.0556
Parts & Service: 574.537.0700

www.eco-rv.com

DECORS



FOLIAGE



SPICE



RETRO RED



YOUR LOCAL DEALER

ECORev2 2/07

©2007 Thor Industries, Inc.